

Bradas®

PL INSTRUKCJA OBSŁUGI Kompostownik

50CM

TQ-K09050BOX

75CM

TQ-K09075BOX

105CM

TQ-K09105BOX

125CM

TQ-K09050BOX

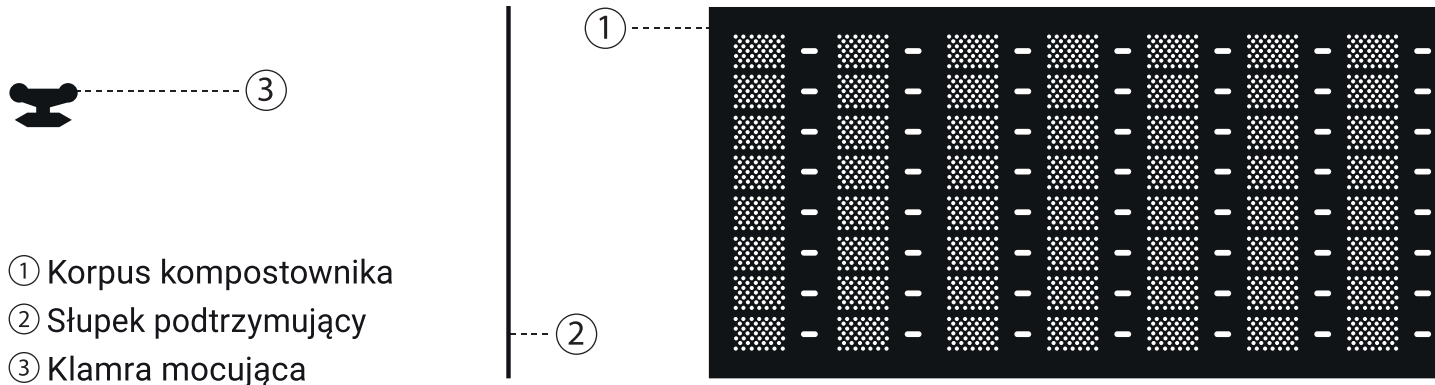

MONTAŻ KOMPOSTOWNIKA

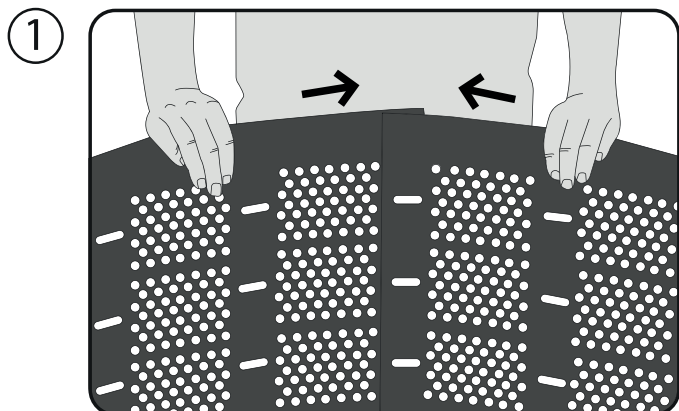

Zwinąć korpus kompostownika do żądanego rozmiaru.

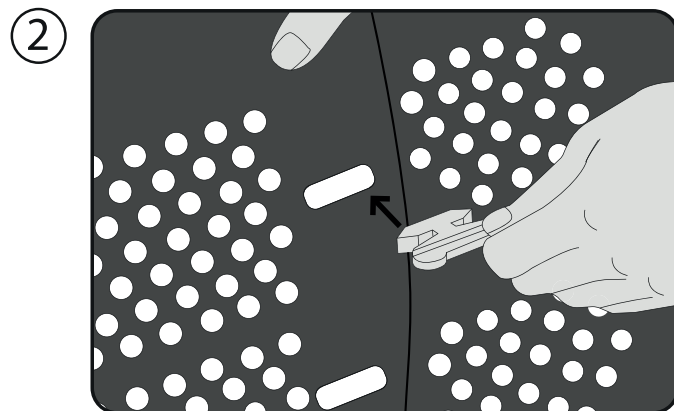

Zamontować klamry mocujące.

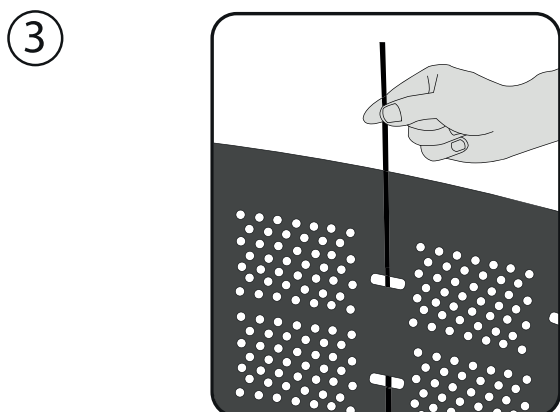

Przełożyć słupki podtrzymujące przez poprzeczne otwory, aby usztywnić konstrukcję

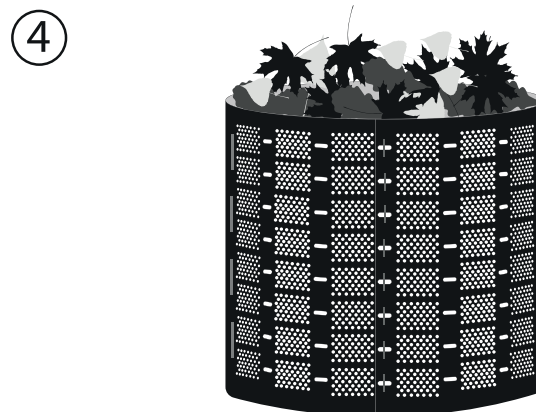

Kompostownik jest gotowy do użycia.

INSTRUCTION Compost bin

50 CM

TQ-K09050BOX

75 CM

TQ-K09075BOX

105 CM

TQ-K09105BOX

125 CM

TQ-K09050BOX

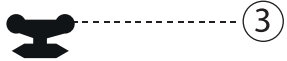

- ① Compost bin body
- ② Support stake
- ③ Mounting clamp

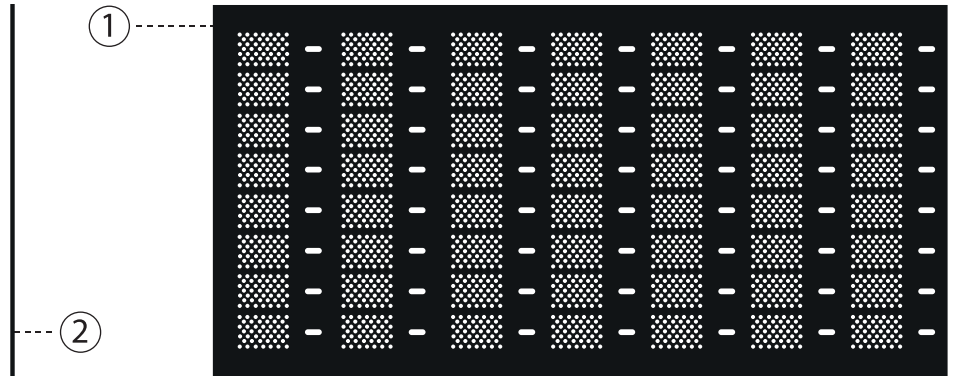

COMPOST BIN ASSEMBLY

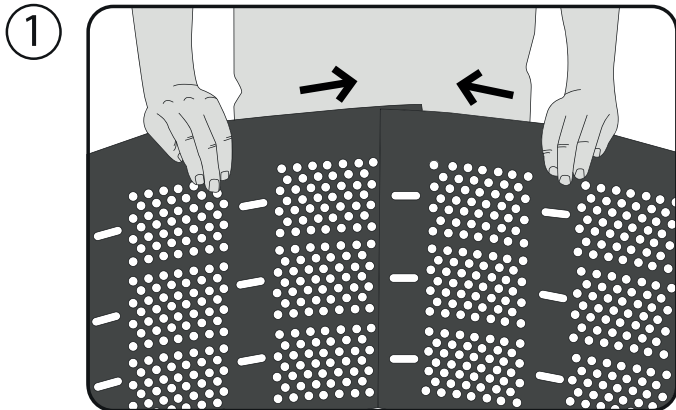

Roll compost bin body for the desired size.

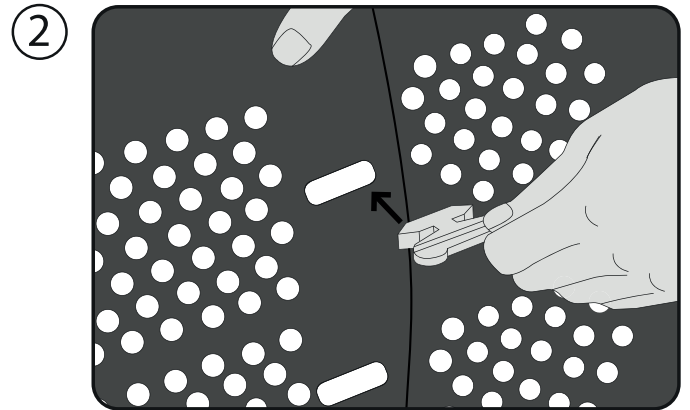

Assemble mounting clamps.

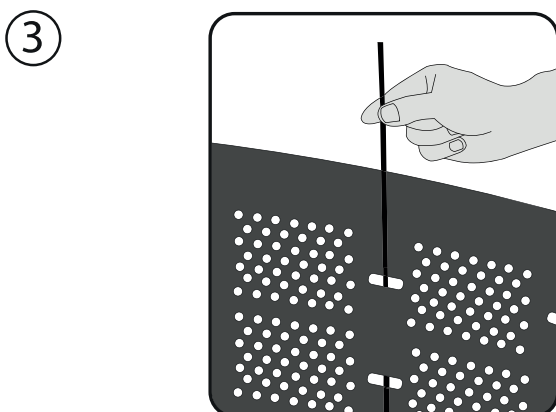

Insert support stakes through the transversal holes to stiffen whole construction.



Compost bin is ready to use.