



# 用户手册

# AG ONE

8K鼠标

Multi-modes Mouse  
User Manual

快速开始指南 ►  
Quick Start Guide

# 感谢您购买及使用本产品



为了给您带来更好的使用体验，在使用产品前请仔细阅读本说明书，并请妥善保管，以便日后参观。

## 产品外观

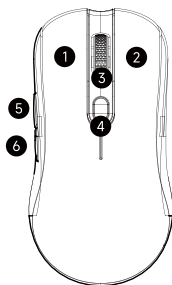

对称式设计，通过手型，适应于大多数用户握法  
不论您是游戏或者办公，AG ONE 都会让您十分舒适

- ① 左键
- ② 右键
- ③ 滚轮键+中键
- ④ DPI键，快速切换DPI
- ⑤ 前侧键，网页前进
- ⑥ 后侧键，网页后退

## AG ONE 独立指示灯

| 状态     | 指示灯位置 | 回连    | 配对    | 连接成功 |
|--------|-------|-------|-------|------|
| 有线     | 无     | 无     | 无     | 无    |
| 2.4G   | DPI旁  | 指示灯慢闪 | 指示灯快闪 | 常亮2s |
| BT     | DPI旁  | 指示灯慢闪 | 指示灯快闪 | 常亮2s |
| 状态     | 指示灯位置 | 指示方式  |       |      |
| 低电     | DPI   | 快闪    |       |      |
| 充电     | DPI   | 常亮    |       |      |
| 充满     | DPI   | 熄灭    |       |      |
| DPI第1档 | DPI   | 红灯    |       |      |
| DPI第2档 | DPI   | 橙灯    |       |      |
| DPI第3档 | DPI   | 黄灯    |       |      |
| DPI第4档 | DPI   | 绿灯    |       |      |
| DPI第5档 | DPI   | 青灯    |       |      |
| DPI第6档 | DPI   | 蓝灯    |       |      |
| DPI第7档 | DPI   | 紫灯    |       |      |
| DPI第8档 | DPI   | 白灯    |       |      |

## AG ONE 底部外观

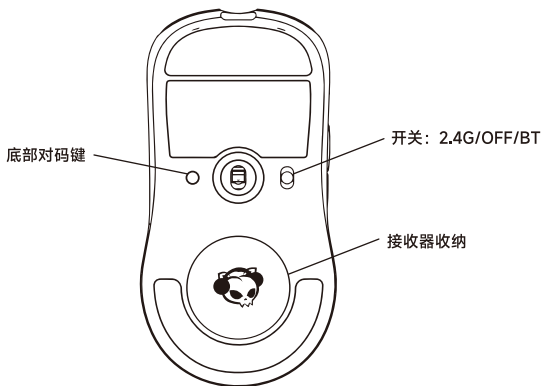

|       |                                             |        |               |
|-------|---------------------------------------------|--------|---------------|
| 型号    | AG ONE 鼠标                                   | 类型     | 2.4G+蓝牙+有线    |
| 尺寸    | ≈125*67*37mm                                | 接收器接口  | USB           |
| 重量    | ≈65g                                        | 有效距离   | ≥10m          |
| 对码键   | 长按3S进入配对模式                                  | 锂电池容量  | 3.7V / 500mAh |
| 传感器   | PAW3395                                     | 充电     | USB 5V        |
| 底部开关  | 2.4G/OFF/BT                                 | 左右按键寿命 | 1亿次           |
| 回报率默认 | 蓝牙125Hz / 2.4G 8000Hz / 有线8000Hz            |        |               |
| DPI   | 400/800/1200/1600(默认)/3200/6400/10000/26000 |        |               |

# AG ONE 回报率

| 状态   | 档位(Hz)                           | 描述      |
|------|----------------------------------|---------|
| 有线   | 125/500/1000/2000/4000/8000 (默认) | 驱动6档可调节 |
| 蓝牙   | 125(默认)                          | 不可调节    |
| 2.4G | 125/500/1000/2000/4000/8000 (默认) | 驱动6档可调节 |

## Akko保修和服务声明

1. Akko为中国大陆的客户提供一年保修。对于其他地区，请联系您的卖家（Akko分销商）以了解具体的保修政策。
2. 如果保修期到期，客户需要支付维修费用。如果用户喜欢自己修理鼠标，Akko也会提供说明。用户应对自行修复过程中发生的任何损失承担全部责任。
3. 由于私自拆卸产品、使用不当和安装不当而导致的缺陷不在保修范围内。
4. 官方售后服务时间为每周一至周五上午10：00至下午18：00  
节假日以国家法定节日休息为准。
5. 退货和保修政策在不同的平台上可能有所不同，并在购买时取决于具体的经销商。

公司：深圳银宸科技有限公司  
地址：深圳市宝安区松岗街道碧头第一工业区朗碧路33号  
电话：0755-23216420  
网址：www.akkogear.com  
产地：中国 • 深圳  
Company: Shenzhen Yincheng Technology Co., Ltd  
Address: 33 Langbi Rd, Bitou First Industrial Zone, Bao'an District, Shenzhen, China



中国制造 / Made in China

To provide you with a better user experience, please read this manual carefully before using the product.

## Specifications

The AG ONE features a symmetrical design with a universal grip, making it suitable for most users in both gaming and working environments.

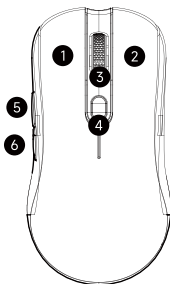

- 1 Left mouse button
- 2 Right mouse button
- 3 Scroll wheel + Middle key
- 4 DPI button
- 5 Forward button
- 6 Back button

## AG ONE Indicator

| Status        | Indicator       | Re-Connecting   | Pairing       | Connected         |
|---------------|-----------------|-----------------|---------------|-------------------|
| Wired mode    | N/A             | N/A             | N/A           | N/A               |
| 2.4G          | Next to DPI key | Slow flashing   | Fast flashing | Steady LED for 2s |
| BT            | Next to DPI key | Slow flashing   | Fast flashing | Steady LED for 2s |
| Status        | Indicator       | Indicating mode |               |                   |
| Low Battery   | DPI             | Fast flashing   |               |                   |
| Charging      | DPI             | Steady          |               |                   |
| Fully Charged | DPI             | OFF             |               |                   |
| 1st DPI Step  | DPI             | Red LED         |               |                   |
| 2st DPI Step  | DPI             | Orange LED      |               |                   |
| 3st DPI Step  | DPI             | Yellow LED      |               |                   |
| 4st DPI Step  | DPI             | Green LED       |               |                   |
| 5st DPI Step  | DPI             | Cyan LED        |               |                   |
| 6st DPI Step  | DPI             | Blue LED        |               |                   |
| 7st DPI Step  | DPI             | Purple LED      |               |                   |
| 8st DPI Step  | DPI             | White LED       |               |                   |

# AG ONE Bottom Spec

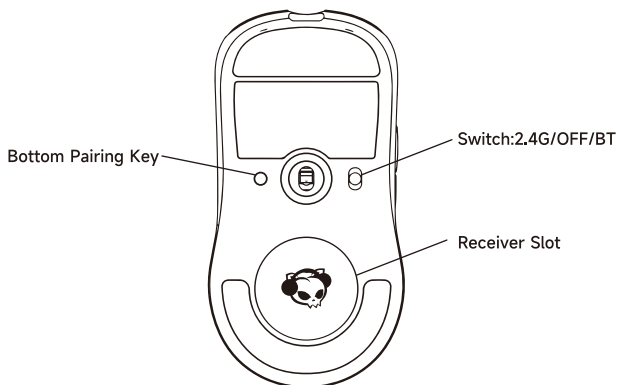

|               |                                                  |                        |                            |
|---------------|--------------------------------------------------|------------------------|----------------------------|
| Model         | AG ONE                                           | Connection             | 2.4G+Bluetooth+Wired       |
| Size          | ≈125*67*37mm                                     | Receiver Interface     | USB                        |
| Weight        | ≈65g                                             | Effective Distance     | ≥10m                       |
| Pairing Key   | Long press 3S to enter Pairing mode              | Battery Capacity       | 3.7V / 500mAh              |
| Sensor        | PAW3395                                          | Rating of Charger      | USB 5V                     |
| Bottom Switch | 2.4G/OFF/BT                                      | Hit left and right key | One hundred million timesn |
| Polling Rate  | Bluetooth 125Hz /2.4G 8000Hz / Wired 8000Hz      |                        |                            |
| DPI           | 400/800/1200/1600(Default)/3200/6400/10000/26000 |                        |                            |

## AG ONE Polling Rate

| Status     | Rates                                 | Note                                 |
|------------|---------------------------------------|--------------------------------------|
| Wired mode | 125/500/1000/2000/4000/8000 (Default) | 6th Level DPI Adjustable in Software |
| Bluetooth  | 125 (Default)                         | Non-Adjustable                       |
| 2.4G       | 125/500/1000/2000/4000/8000 (Default) | 6th Level DPI Adjustable in Software |

## AKKO Warranty and Service Statement

1. Akko provides One-Year warranty for customers in mainland China. For other regions, please contact your seller (Akko distributor) for specific warranty policy.
2. If the warranty window expires, customers need to pay for repairs. Akko will also provide instructions if users prefer to repair the mouse by themselves.  
However, users shall take full responsibility for any loss happened during self-repair.
3. Defects resulting from disassembly of our product, improper usage and incorrect installation are not covered by warranty.
4. The return and warranty policy may vary in different platforms and are subject to the specific distributor at the time of purchase.

Company: Shenzhen Yinchen Technology Co., Ltd

Address: 33 Langbi Rd, Bitou Community 1st Industrial Zone, Bao'an District, Shenzhen, China

Tel: 0755-23216420

Website: [www.akkogear.com](http://www.akkogear.com)

Origin: Shenzhen, China



中国制造 / Made in China



[www.akkogear.com](http://www.akkogear.com)

