

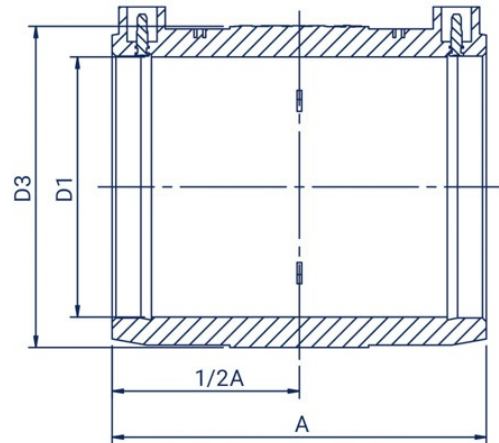

- material: PE 100-RC
- application: water and gas
- 16 bar water, 10 bar gas
- MRS - 10 MPa
- removable centre stop
- no centre stop in 355-630 mm diameters



D1 (mm)	Code	D3 (mm)	A (mm)	SDR	Net Weight (kg)	Packing
140	ME14011	168	176	11	1.11	14

