 Boost Fin Long-Range

# Quick Start Guide



Scan the code to get the  
manual in your language.

For more in depth information and  
videos please visit the following page:

[boostsurfing.com/start](https://boostsurfing.com/start)

1

## See what's in the box

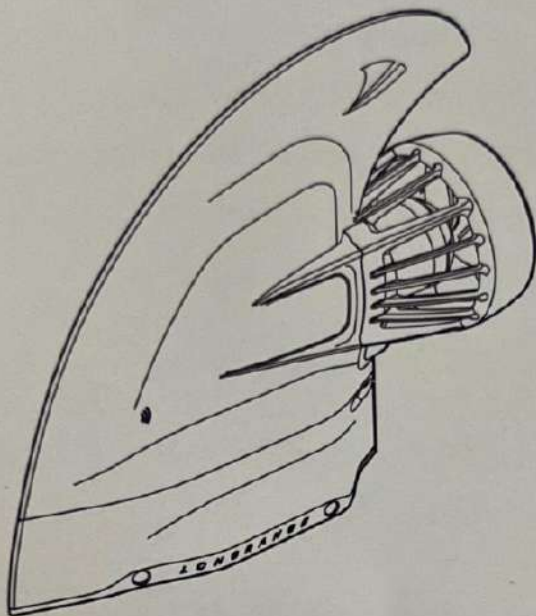

Boost Electric Fin

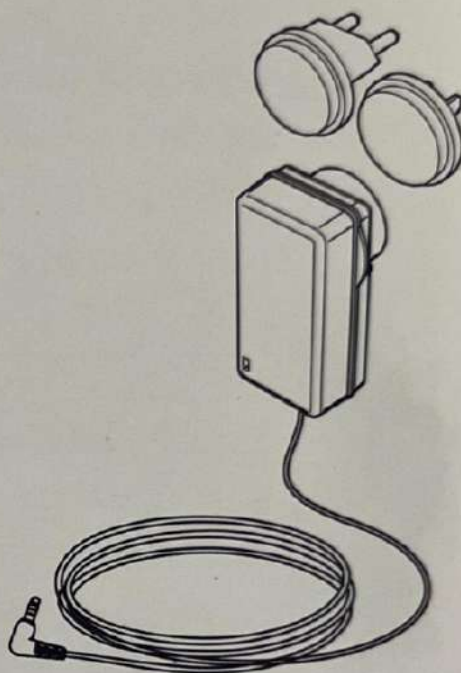

Charger with US/EU  
Plug Adapters



Remote Control

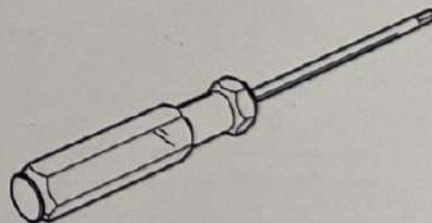

Screwdriver

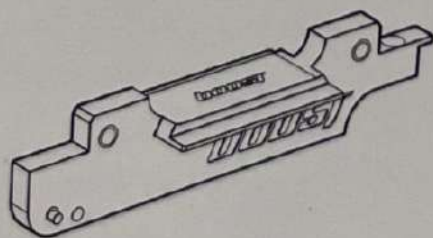

Longboard adapter  
(futures US)



## 2

## Charging the Fin

After unboxing and before turning Boost Fin on, you need to fully charge it. To charge it, connect the charger plug into a socket, after removing the rubber plug (1).

The indicator (2) on the charger will show:

Red light - charging

Green light - charging is finished or Boost Fin is not connected

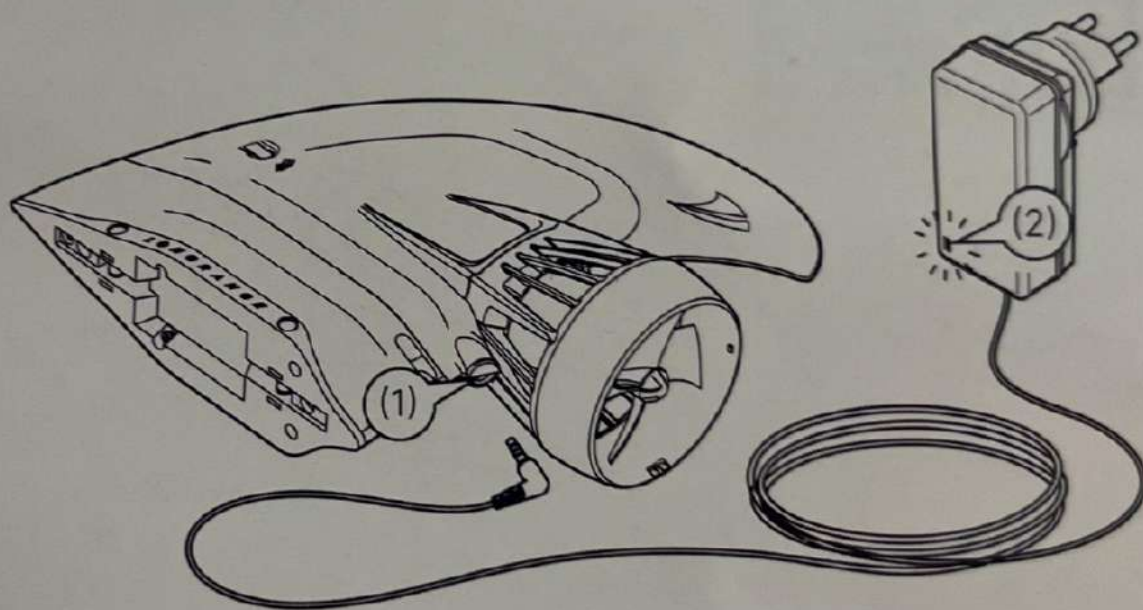

A full charge takes up to 5 hours depending on a battery discharge level.



After charging the battery, be sure to close the charging socket (1) of the Fin tightly with the rubber plug to avoid water ingress.

## 3.1 Installing the Longboard adapter (US Fin Box)

Before installing the adapter (1) make sure that the mount of the adapter matches the fin box of your board. We provide the Longboard adapter (US Fin Box) as a standard with the Boost Fin. If this adapter doesn't fit your board and you haven't ordered a separate adapter with a required mount, you can order it here - [store.boostsurfing.com](http://store.boostsurfing.com).

If you have a standard US fin box, then the adapter provided with your order will fit on your board. Installing the Longboard adapter (US Fin Box) is similar to installing a standard US fin.

Fit any suitable screw and nut into the longboard screw plate of the adapter and insert it into your board.

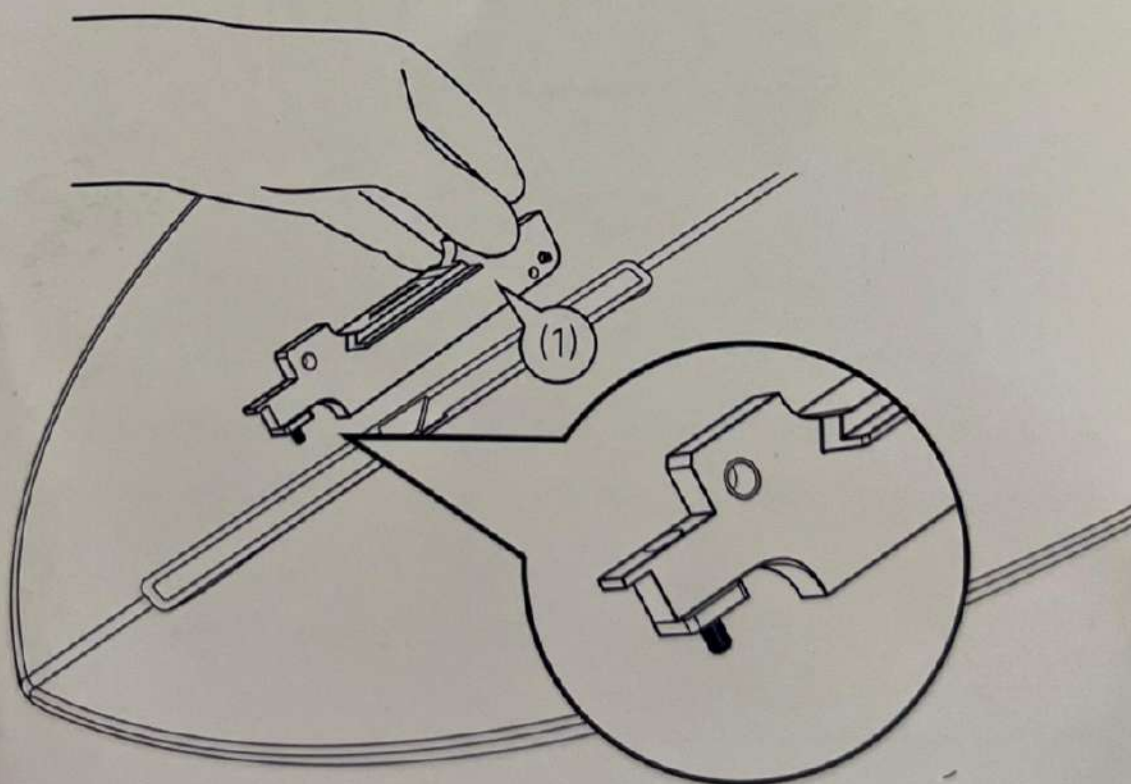

**WARNING!** For safety, turn the Fin on only if it's attached to the board.



## 3.2 Installing the Longboard adapter (US Fin Box)

Insert the adapter into the fin box of your board. Mount the Fin onto the adapter without fixating it. Look at the gaps between the Fin and the board. If there are gaps at the front and at the back of the fin (1) and (2) they are different, adjust the lock on the adapter (3) to the lowest position as shown in the picture. Depending on the configuration of the US mount in your board, you can install the adapter retainer in the adjacent hole (4).

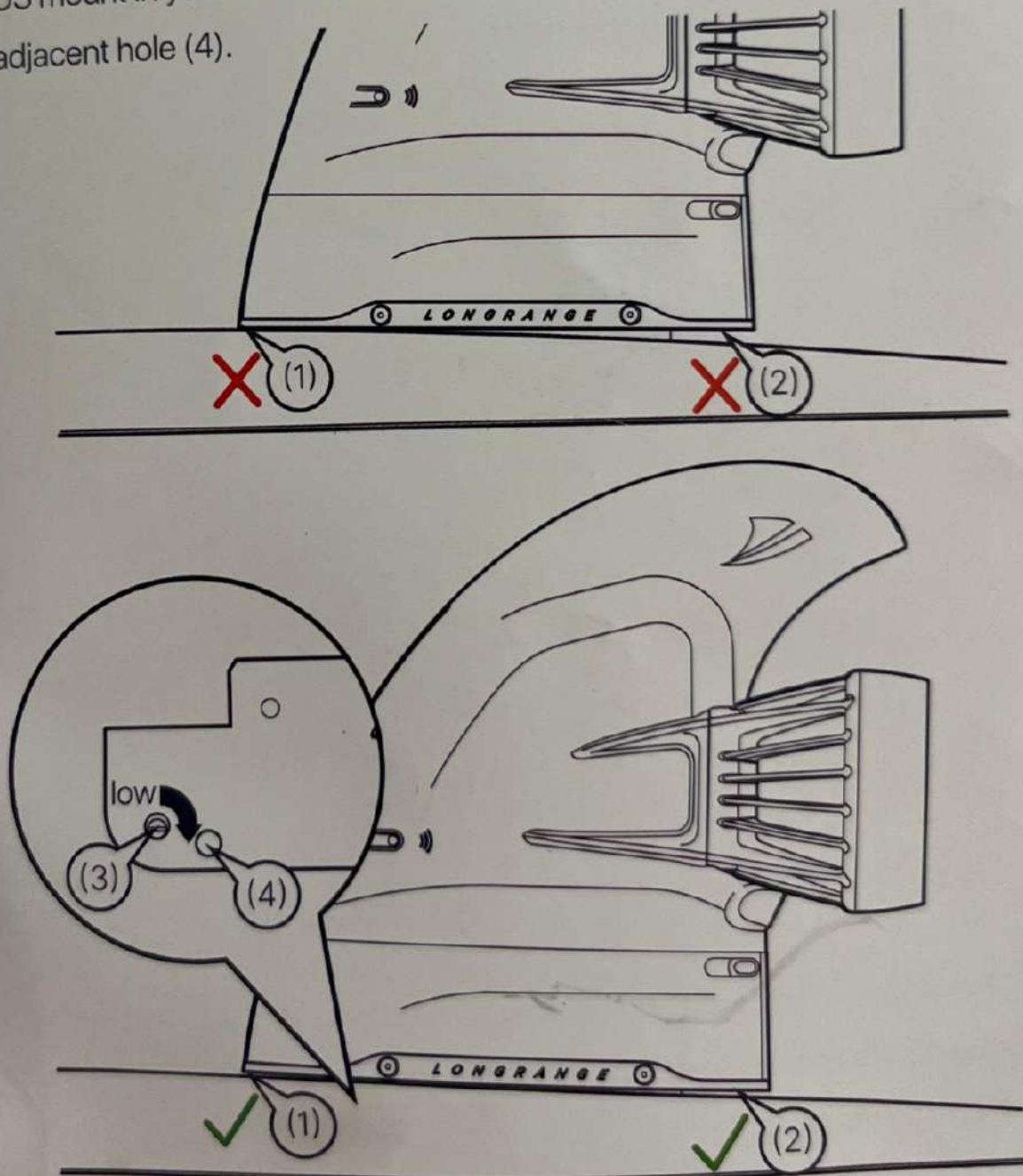

# 4

## Installing the Fin

Attach the Fin to the adapter using a screwdriver (1) and two screws (2) supplied.



Make sure that the Fin is firmly attached to the adapter, the attached Fin should not be loose.

The screws (2) must be tightened without effort. If you feel resistance or if they don't screw in, then there is a misalignment of the adapter hole and the hole in the Fin (3). Try to repeat the previous step 3.2, adjust the adapter retainer and align them properly (4).

If you are experiencing any difficulties with installing the Boost Fin, contact us at [help.boostsurfing.com](mailto:help.boostsurfing.com)

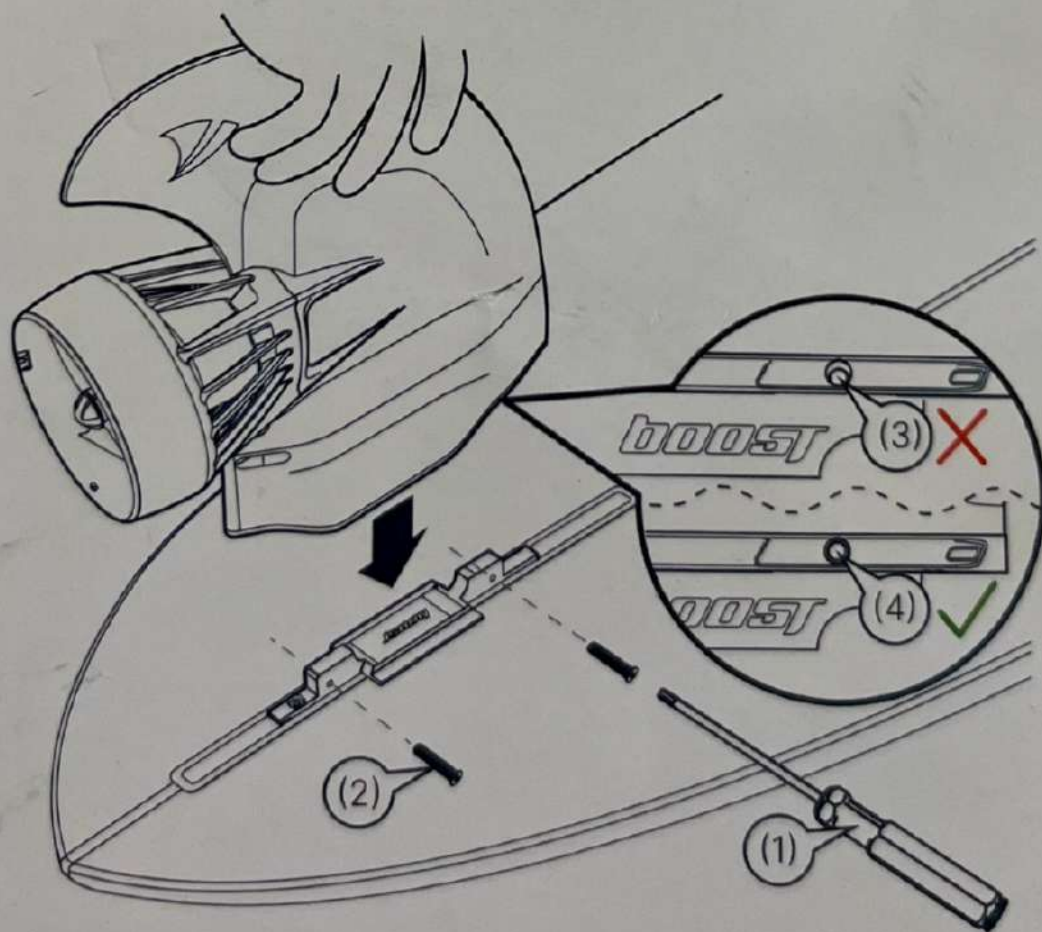



# 5

## Switching on standby mode

Before starting to use the Fin, do a short initial turn on and off. We recommend doing it without submerging the Fin in the water.

Use the screwdriver (1) to activate the standby mode. The screwdriver handle is equipped with a magnet that activates the standby mode.

Place the back of the screwdriver on the switch-on sensor on the Fin body. At this time, you will hear a sound and the green indicator in the Fin body will light up. This means that the Fin is on and in standby mode.

Standby mode lasts for 30 minutes. After this time, the Fin will turn off automatically.

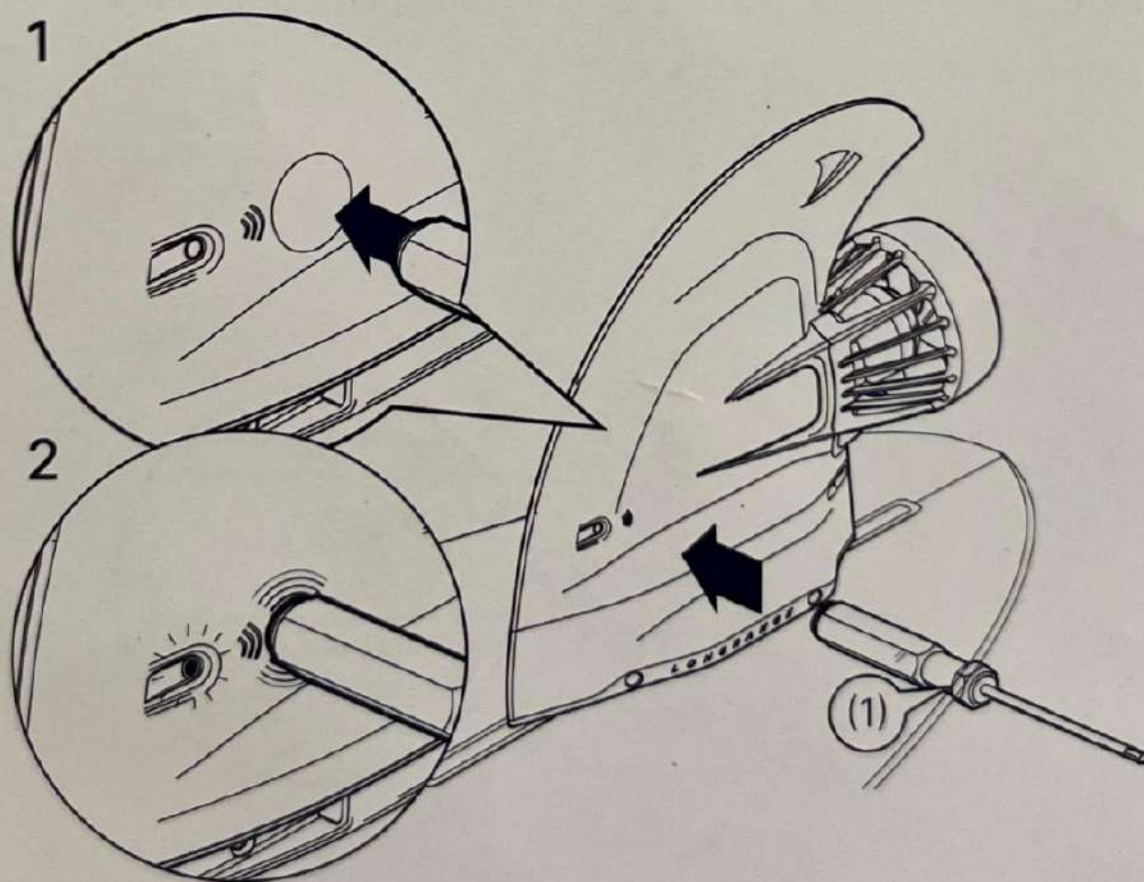

# 6

## Light indication

A light indicator is built-in on the Boost Fin, which shows the battery charge level in standby mode.

Light indication readings:

100-80% - Constant green light

79-50% - Blinking green light

49-10% - Blinking green/red light

Less than 10% - Constant red light

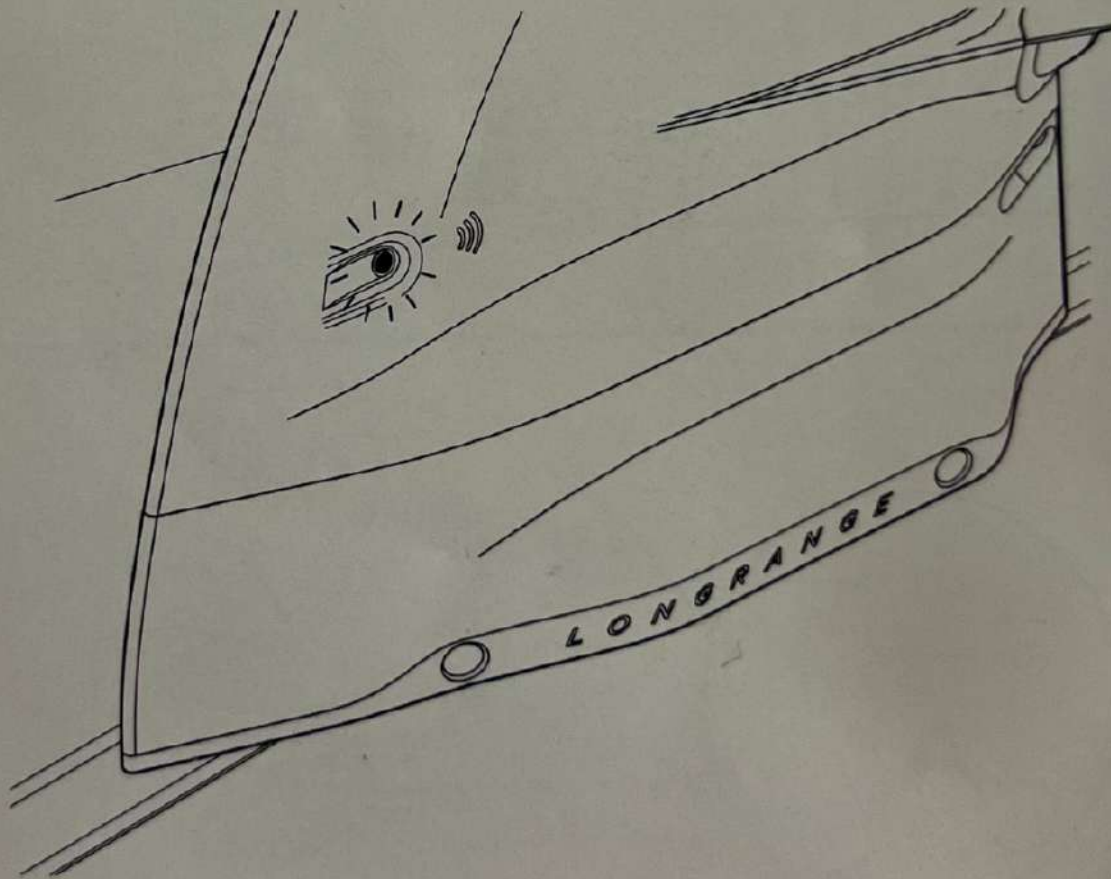

These are the light indication modes for charging only. You can find other light indication readings manual in the FAQ section on the website and in the app.



# 7

## Turn on, off rotation mode

There are two modes of Fin rotation:

Mode 1 (1) - short boost

Mode 2 (2) - long boost

Both modes are activated with the remote control provided.

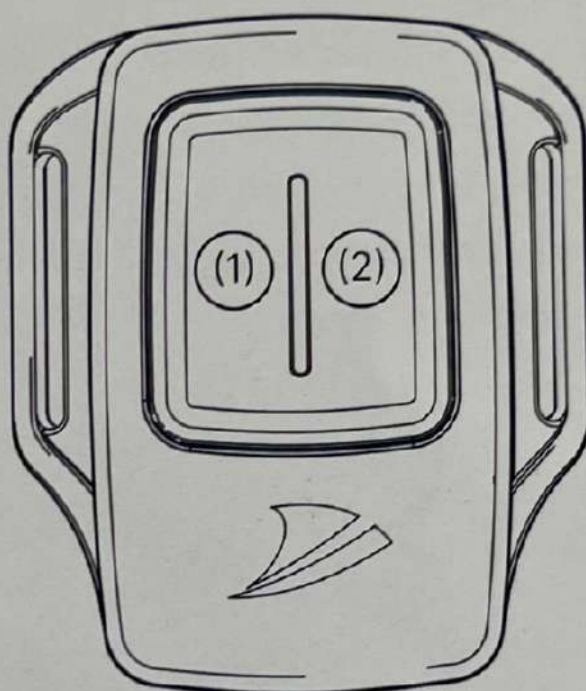

To turn on the rotation mode (in the active standby mode), press the desired button on the remote control. Rotation mode will be activated.



Read Safety Precautions on page 9 before engaging the Fin rotation.

When the rotation mode is on (the motor is running), you can turn off the motor by pressing any button on the remote control. Other modes can be found by downloading the app - [boostsurfing.com/app](https://boostsurfing.com/app).

# 8

## Connect the Boost Fin

The provided Remote control should be paired with the Boost Fin via the Boost Surfing App. To do that, download the app and follow the instructions.



Scan to download the Boost Surfing App



App Store



Google play

[boostsurfing.com/app](https://boostsurfing.com/app)

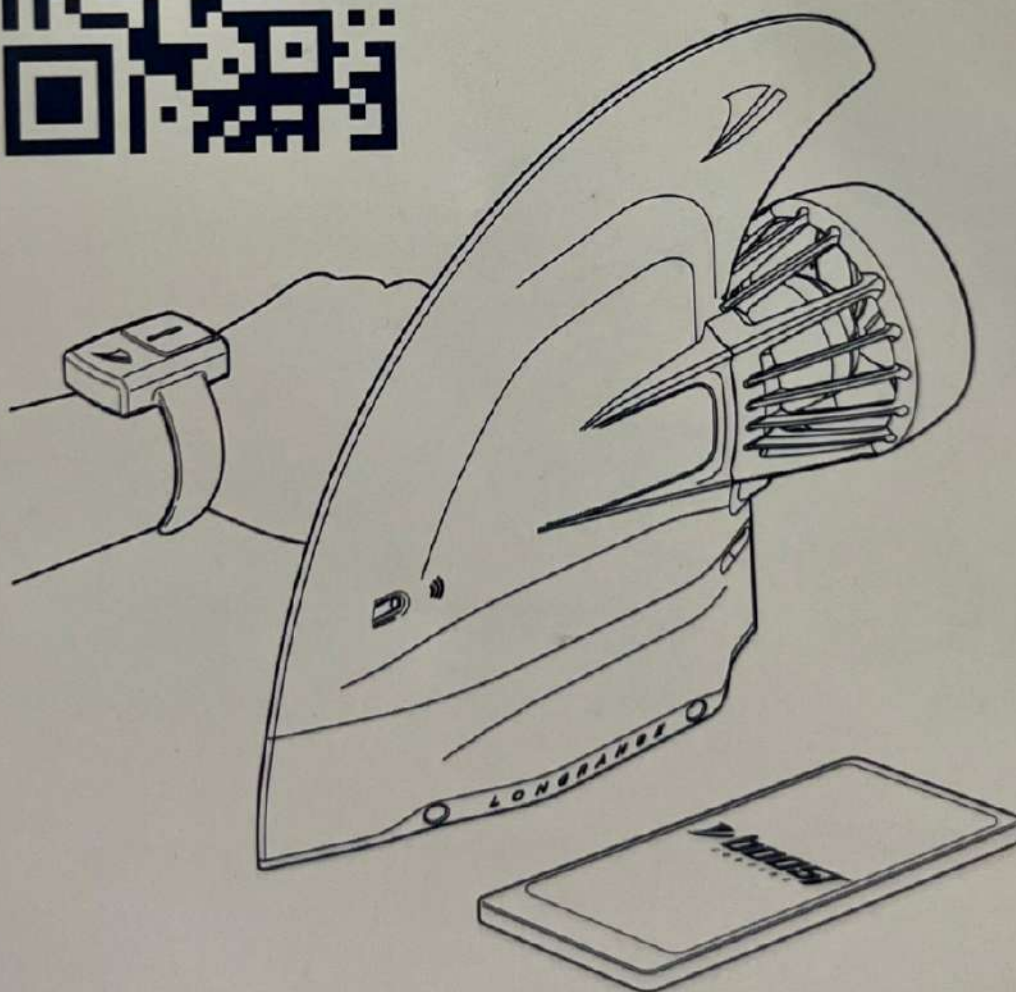

Read the safety precautions on page 7 before turning the Boost Fin rotation mode on.



# 9

## Precautions



1. Turn on the rotation mode only when the Fin is attached to the board! Do not turn the rotation mode on, if: the Fin is in your hands, the Fin is lying on the surface of the water or submerged in the water but not attached to the board. Do not turn the Fin on indoors.



2. Before turning on the rotation mode, make sure there are no foreign objects in the propeller area.



3. When the rotation mode is on, do not block the propeller with any objects.



4. To maximise safety, install the safety guard included in the package to avoid any potential damage in case anything gets into the propeller area.



5. Keep children away from the Fin without supervision by an adult.



6. In case of any malfunction, do not try to disassemble the Fin.

# 10

## The Boost Surf Support Service



Scan the code to access the most recent information about new features and updates, detailed set-up guides and FAQ in Boost Help Center at [help.boostsurfing.com](http://help.boostsurfing.com)

Still experiencing problems?

Email us at [support@boostsurfing.com](mailto:support@boostsurfing.com) for help.

Typos might be present in the text.

The appearance of the product and its components might differ from the images on the packaging and the website.

Version longrange 1