

DUMPING DEVICE FOR BATH



Sauflex

Sauflex
SAUNA ACCESSORIES

Operating instructions
Before installing and operating the product, carefully read the instructions..



PRODUCT DESCRIPTION

The dumping device is special equipment for baths and saunas. Its main function is to provide water procedures, especially after being in the steam room. It creates the effect of an ice shower, which helps to harden the body and boost immunity.

The device is a container with a swivel mechanism that ensures the tipping of the container using a chain with a handle. Compact dimensions allow placing the device even in small rooms with low ceilings. The flexibility of the design ensures the possibility of mounting both on the wall and the ceiling.

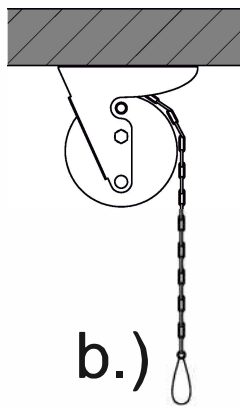
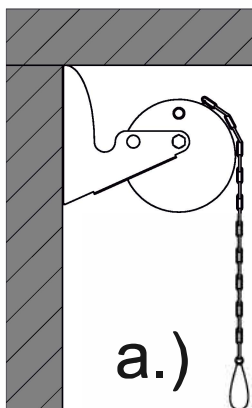

1

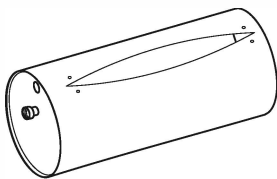

X 1

2



X 2

3



X 1

4



X 1

5



X 1

6



X 1

7



X 1

8



X 1

9



X 1

10



X 1

a.)

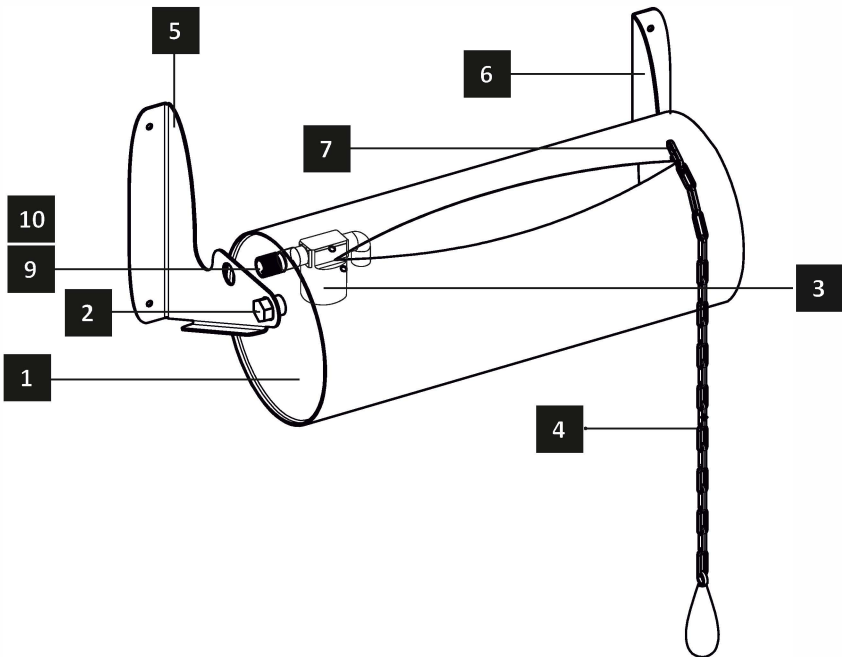
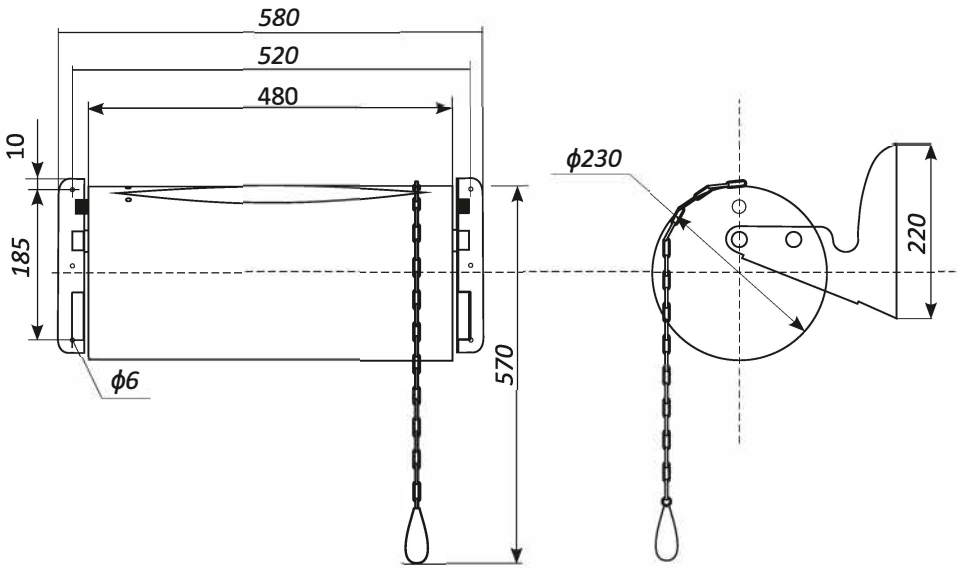

b.)

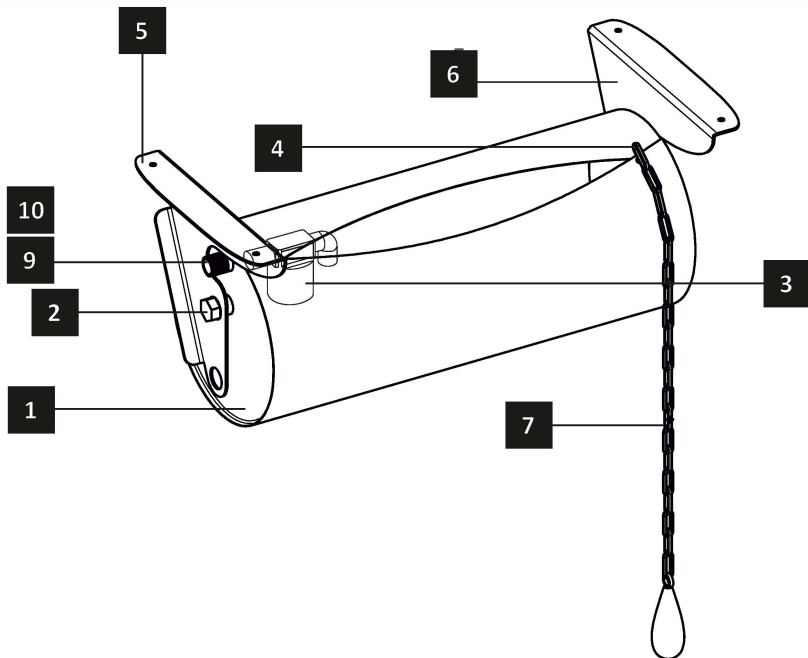
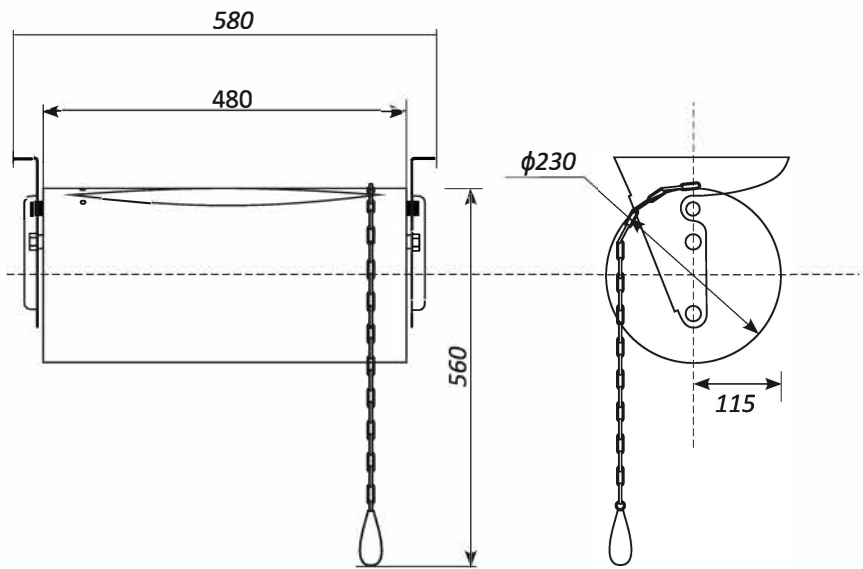

ASSEMBLY ORDER

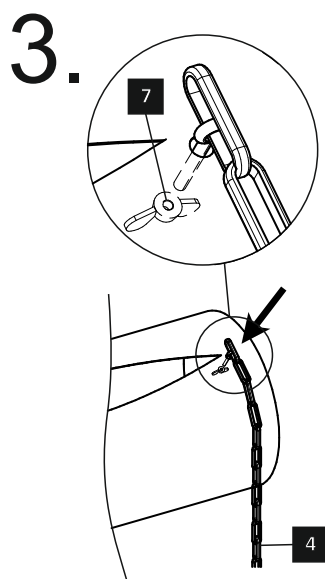
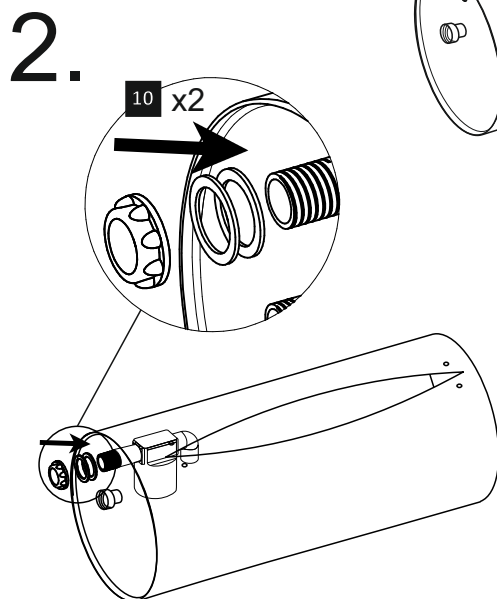
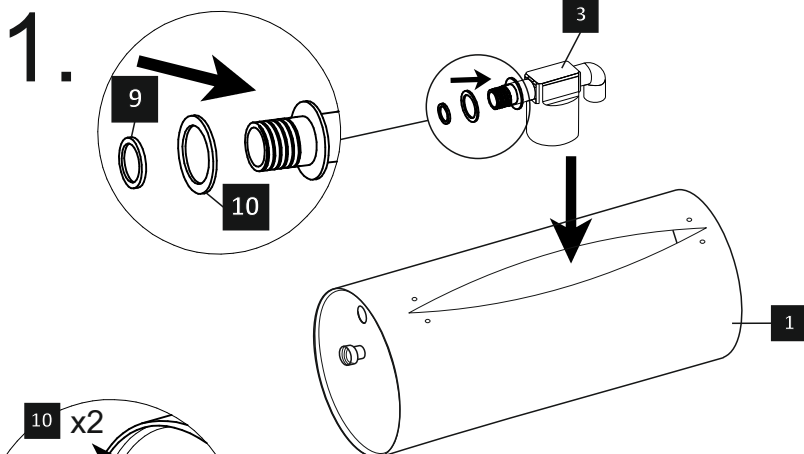

4.

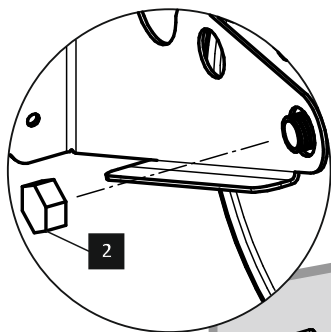
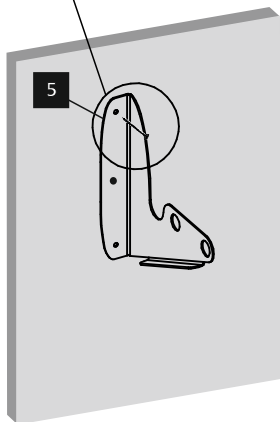
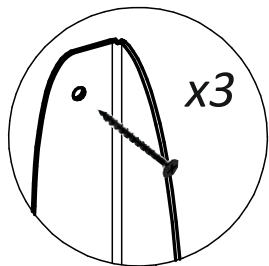

5.

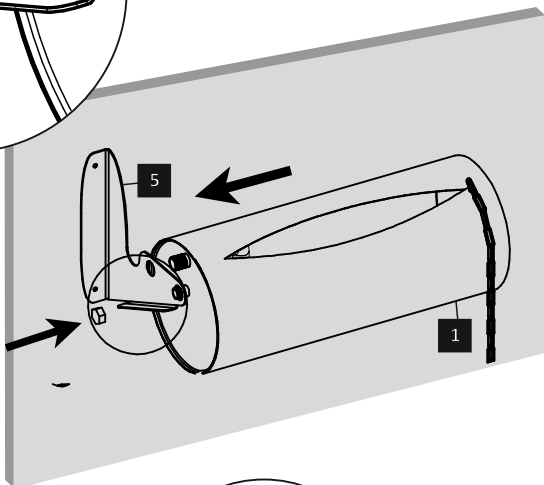

7.

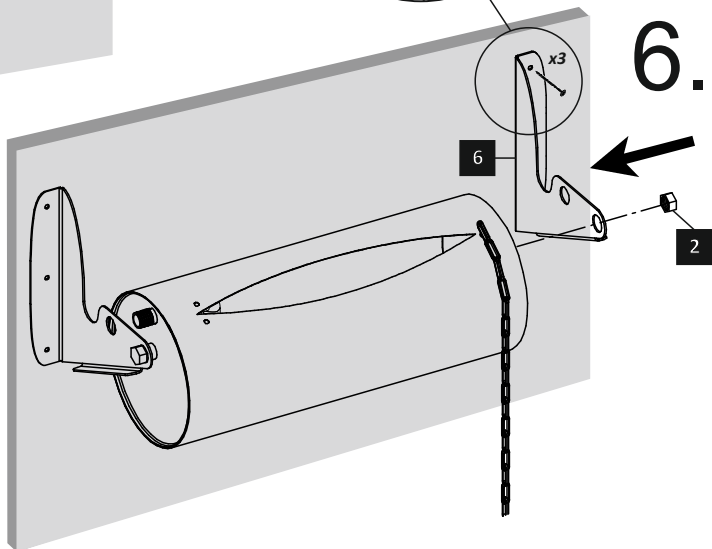
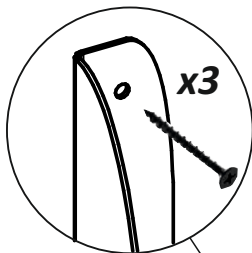

6.

8.

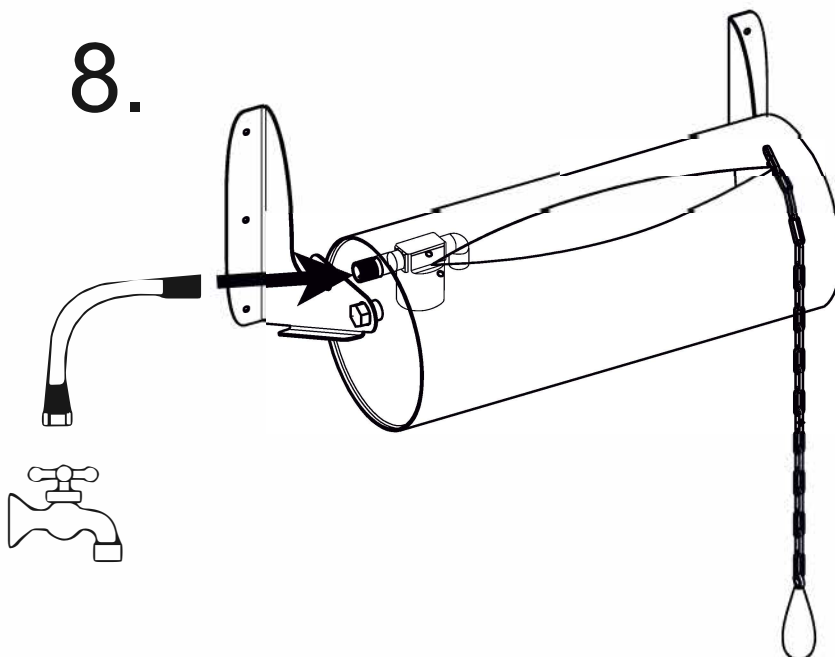

After connecting the water supply or storage tank and turning on the water supply, the body of the dumping device will begin to fill with water automatically.

! When the tank fills to the desired level, the water supply will automatically stop. After this, the device is ready for use as intended. The tilting of the body with water is carried out using the swivel mechanism, including the chain with a handle. When the handle is released, the water flow stops, the body returns to its original position, and it refills with water.