

JOYROOM

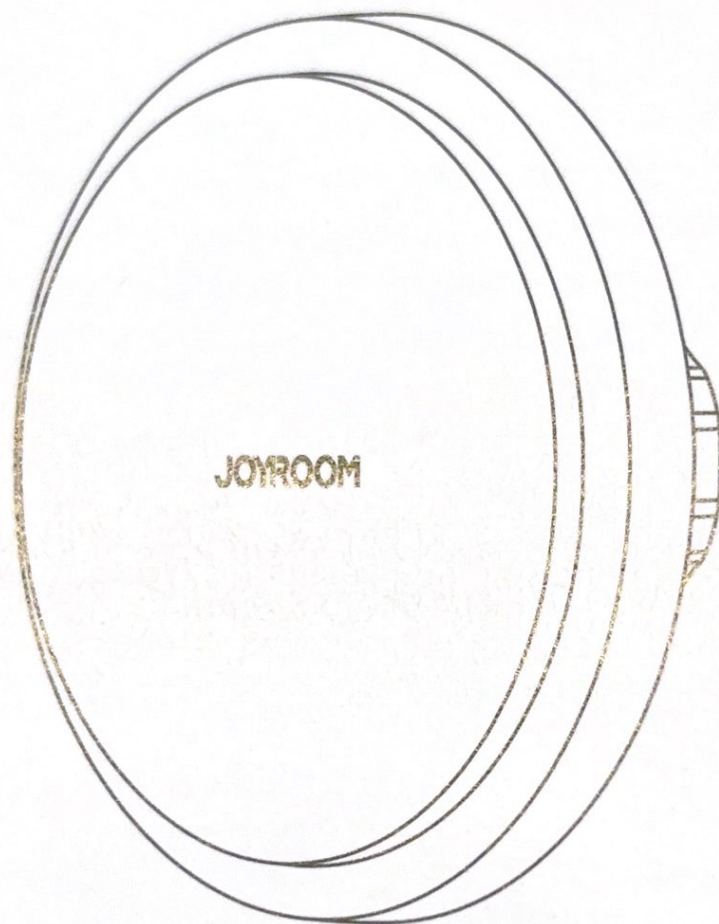

User Manual

Magnetic Wireless
Car Charger Holder



Parameters

Model	JR-ZS291
Name	Magnetic Wireless Car Charger Holder
Material	ABS+PC
Input	5V \Rightarrow 2A 9V \Rightarrow 2A 12V \Rightarrow 2A
Output	5W/7.5W/10W/15W (MAX)
Input port	Type-C
Applicable phone size	4.7-6.7"

Indicator light

Power on	Crystal edge light turn on
Standby	Constant crystal edge light
Charging	Crystal edge light turns off
FOD	Flashing crystal edge light

Product diagram

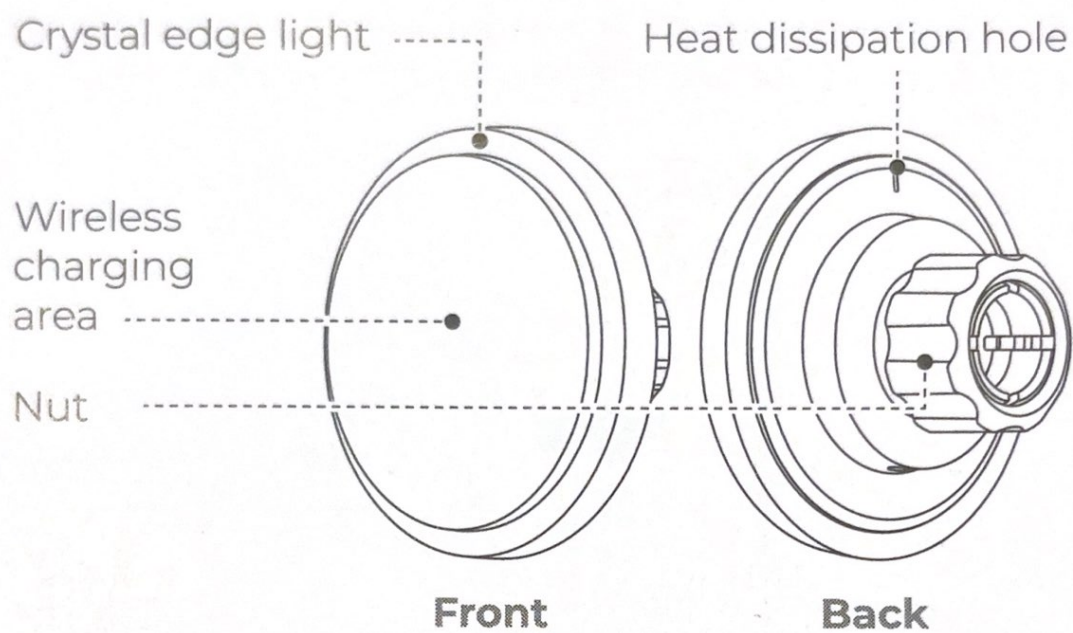

Air vent clip hook

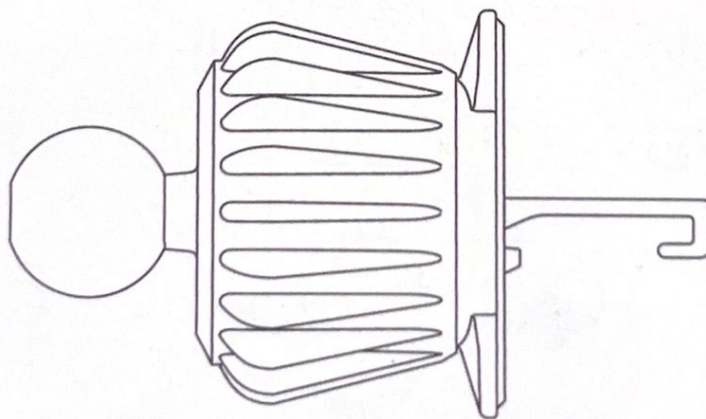

Operation steps

1. Put the ball head into the nut first, then insert it into the socket on the back of the holder, tighten the nut clockwise.

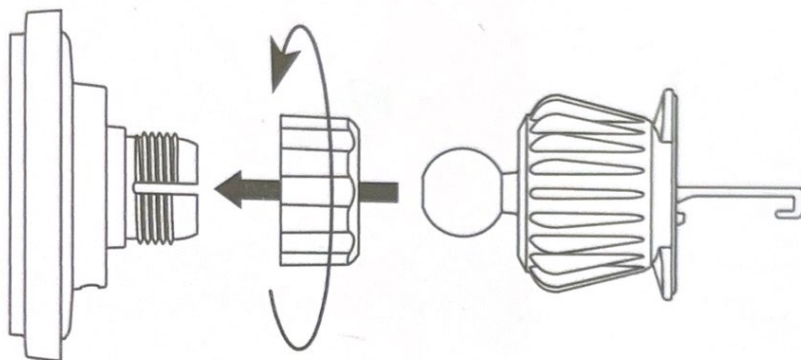

2. Loosen the knob and open the hook, insert the hook onto vent blade, then fasten the knob.

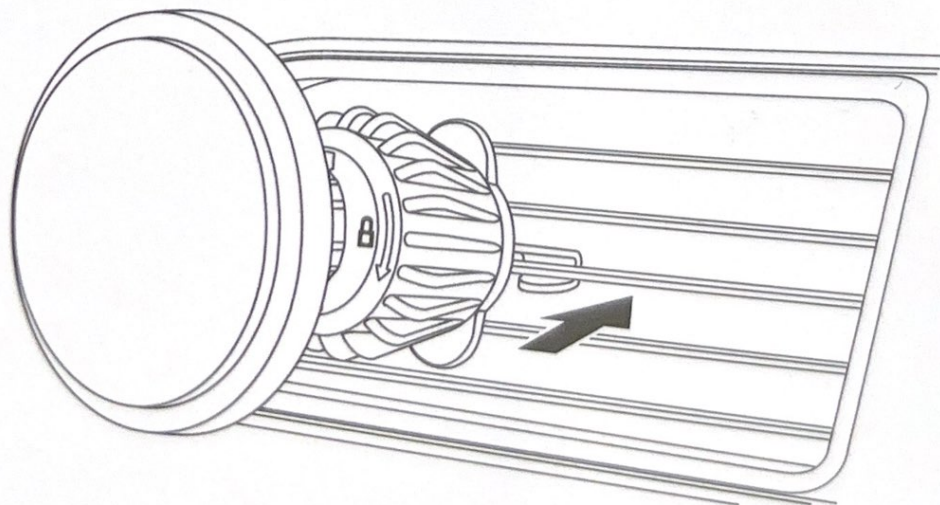
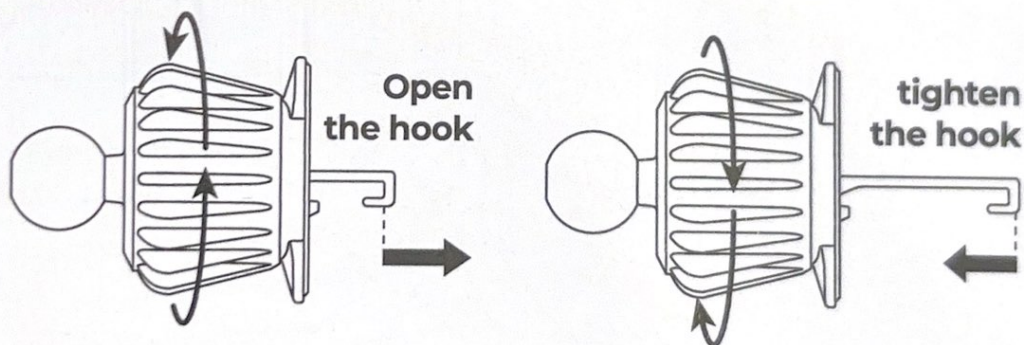

3. Use the Type-C charging cable in the package to connect the holder and the car charger.

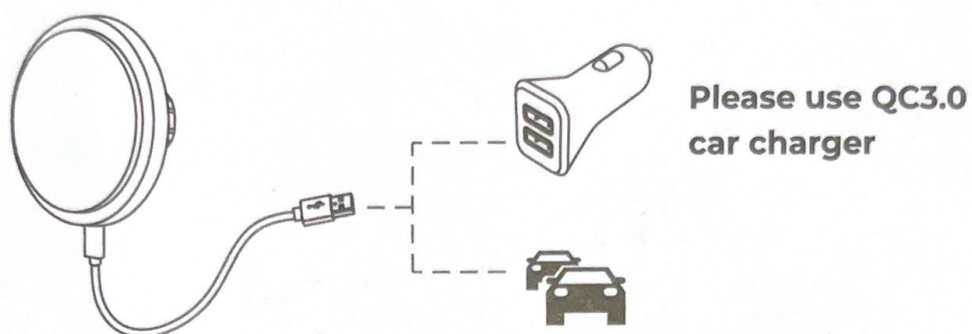

4. Place your phone. It will be securely attached to the charger holder with its auto alignment function.

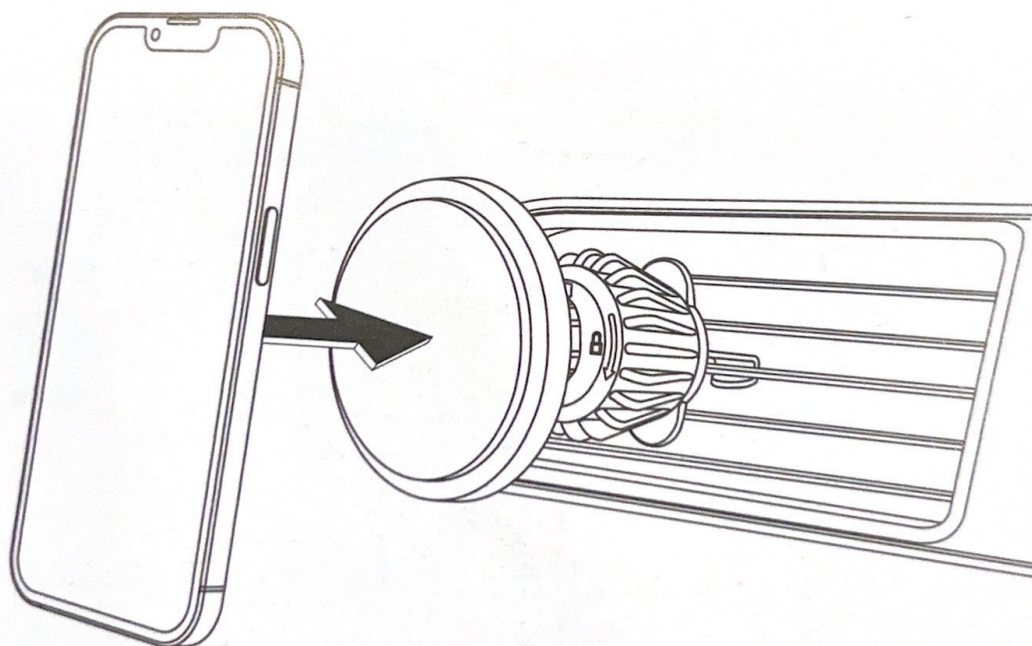

Note:

The product will automatically hold and charge your iP 12/13 once sensing it. If you don't want to take off your phone case, we suggest using magnetic cases.

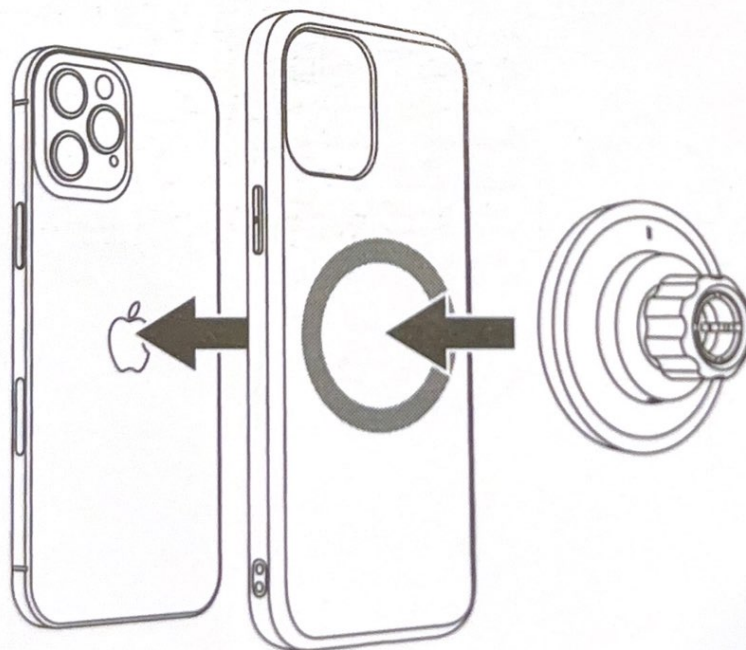
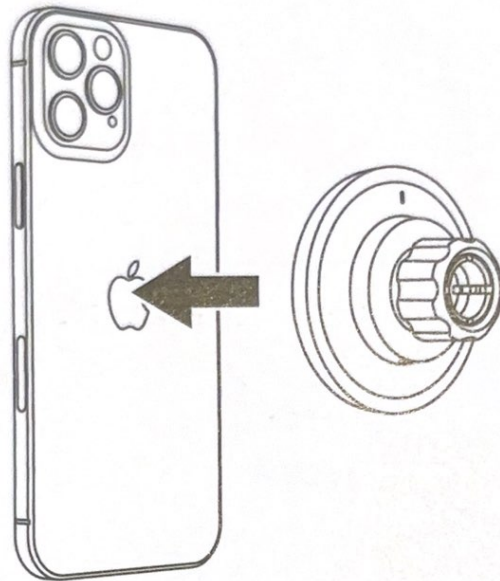

Warning

1. Do not disassemble or refit the product.
2. Do not store it in a wet environment.
3. Please keep the product away from heat and do not charge it near a heat source.
4. Please prevent water or other liquid from entering the product interface. Otherwise the product may be damaged.
5. Do not install the wireless car charger holder over an air bag cover or within the air bag deployment zone.
6. During charging, make sure to remove the metallic/magnetic protective case or cards (like bank cards), etc. from your device.
7. During charging, the charger may heat up. This is a normal occurrence and won't affect its performance. If the charger or your phone gets too hot, please disconnect the power supply and let it cool down before restarting the charging process.
8. Avoid using bent or damaged USB cables.