

# HOME SKIN BEAUTY INSTRUMENT

## INSTRUCTIONS FOR USE

### Directory

Safety Precautions-----	01
Product structure-----	02
Product Profile-----	03
Preparation before use-----	04
Use Operation-----	05
User Care-----	06
Cleaning and Maintenance-----	07
Warrant-----	08

### SAFETY PRECAUTIONS

Do not apply any gel or care products (aloe vera gel, etc.) before use! Please be sure to assemble and use the product according to the regulations contained in the instruction manual. Please read the instructions for use carefully and keep it for inquiry. If you have any questions during use, please contact online customer service in the required language.

### DANGEROUS

- Warning: Do not use this product near a bathtub, shower tub, washbasin or other utensils. Please keep his product and the power adapter dry; if the product is damaged, do not touch any internal parts to avoid electric shock;
- Do not insert any objects into the product, please do not place this product at will;
- Do not use this product around the eyes. Protective glasses can indeed protect the common operation of users, but if you operate around the eyes, protective glasses may not be able to completely block energy from being absorbed by the iris melanin in your eyes at close range;
- We recommend that you wear protective glasses every time you use them. Although light will not directly affect your eyes, high speed flash light may affect your eyesight;
- When you need back hair removal or ice application, you may need an assistant, which is our suggestion, because you may be risky to use it alone;
- If your hair is longer than 1mm, please shave it first. Excessive hair absorbs heat on the surface of the skin, which will cause the skin to become red and swollen, and the hair will burn and produce peculiar smell, which will affect your experience of using the product;
- If the skin of the irradiated area is not dry or clean, it will affect the use effect, and it may also cause the product to not flash or accidentally flash
- Please pay attention to prevent children under the age of 15 from contacting this product, and also please keep away from children under the age of 15 when operating the instrument;
- For different body parts, please use different light intensity gears as needed for different body parts, because their skin color is not the same

### ▲BE CAREFUL

- |   |  |   |  |
|---|--|---|--|
|  | Do not use this instrument for natural black skin                        |  | Do not expose yourself to the sun before hair removal. |
|  | Please shave before hair removal (do not use chemical hair removal)      |  | Do not expose yourself to the sun before hair removal. |
|  | It is forbidden to use in dark light environment.                        |  | Please wear light-proof glasses when using             |
|  | Do not use it in a direct sunlight environment; to avoid machine failure |  | Do not violently impact and shake this instrument.     |

### STRUCTURE

(ICE FREEZING IPL HAIR REMOVAL)

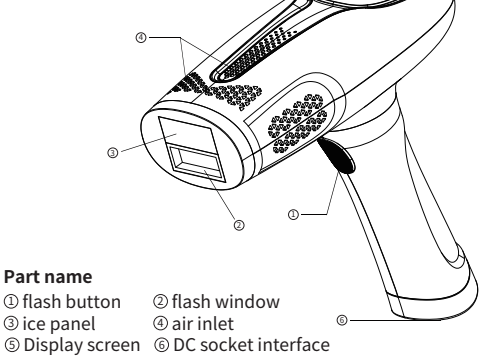

#### Part name

- |                  |                       |
|------------------|-----------------------|
| ① flash button   | ② flash window        |
| ③ ice panel      | ④ air inlet           |
| ⑤ Display screen | ⑥ DC socket interface |

### STRUCTURE

(NON-ICE FREEZING IPL HAIR REMOVAL)

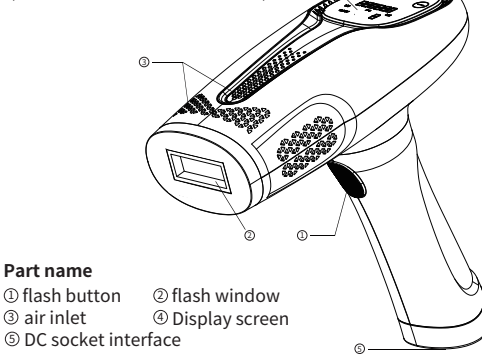

#### Part name

- |                       |                  |
|-----------------------|------------------|
| ① flash button        | ② flash window   |
| ③ air inlet           | ④ Display screen |
| ⑤ DC socket interface |                  |

### PRODUCT INTRODUCTION

BHRL-04/BHRL-04B

ICE freezing point household hair removal instrument, first use a shaver to clean the hair on the surface of human skin, and then irradiate the skin with IPL, intense pulsed light generated, causing structural changes of hair follicles and surrounding tissues due to temperature rise, thereby inhibiting hair growth and causing hair atrophy and loss.

This product subverts the experience of similar products and innovates and integrates the ice sensing system. After the ice application mode is turned on, the ice side can be removed, the skin can be quickly relieved, the skin can be reduced, and the hair removal experience can be more painless and lasting.

At the same time, the flash speed is upgraded, hair removal is more time-saving and labor-saving. This product takes male soil coarse hair as the target and female hair removal effect as the basis. Experiments show that most male soil has obvious hair effect, female soil has better hair removal effect, and male hair removal effect is slightly different from that of female.

This product has a long life without replacing the integrated lamp. This product has a long life without replacing the integrated lamp holder, which saves you expensive lamp holder replacement costs, does not need to purchase accessories frequently, and has no hidden additional costs. In addition, it has a perfect filtering system, which can filter invalid short wavelength and harmful light well, and effectively avoid the danger of light leakage caused by poor contact of spliced structure replacement.

The product test results show that except for black skin, it is suitable for various types of skin colors. For those who are not applicable, please refer to Safety Precautions.)

Thank you for choosing BHRL-04 /BHRL-04B household epilator. Please read the instructions carefully before you use the product.

Model	Specification parameters	
BHRL-04 / BHRL-04B	Weight: 0.32Kg	Atmospheric pressure: 86.0kPa ~106.0kPa
	Voltage: AC220V 50Hz	Environmental Requirements: Avoid DirectLight
	Power: 36W-48W	Light intensity: 9 gear adjustable
	Cooling method: cold air	Length of hair removal light wave: 600-1200nm
	Ambient temperature: 5-40 Celsius	Implementation standard: GB4706.1
	Relative humidity: ≤80%	

### PREPARE BEFORE USE



- Thoroughly clean the skin to ensure that the skin is free from hair, completely dry, and free from oily substances (perfume, lotion, fragrant body fluids, sunscreen) and other residues.
- Make sure that there is no dirt residue such as dust and hair at the irradiation port, and there is no damage or abnormality. If there is dirt, please clean it up to avoid product failure, deterioration and skin problems.

- Do not apply any gel or care products (aloe vera gel, etc.) before use.

#### Radiation intensity setting

This product is specially developed for people with trapped hair, so its light energy is softer and provides 9 different light energies. You can adjust the light energy to fit your skin and body hair color, and keep yourself in a comfortable position. The light energy meter recommended below will help you determine the appropriate light energy.

1. Please refer to the table below to determine which light intensity is suitable for your skin and hair color. Tip: You can put the form in the Quick Start Guide on your skin and compare it with your skin color. Tip: It is recommended that you save the Quick Start Guide for future reference.

2. If you feel any pain or discomfort, please reduce the light intensity. People with darker skin tones are more likely to develop skin allergies because the skin absorbs more light. Therefore, it is recommended that people with darker skin color use lower light intensity. Shined skin may feel warm or hot. It is a normal phenomenon.

color of skin	white	Beige	Light brown	Brown	Dark brown	Brown black or darker
White/Grey	x	x	x	x	x	x
Red	x	x	x	x	x	x
Light gold	x	x	x	x	x	x
Dark gold/Light brown	✓	✓	✓	✓	x	x
Brown	✓	✓	✓	✓	x	x
Dark brown	✓	✓	✓	✓	x	x
Black	✓	✓	✓	✓	x	x

(Note: X is not applicable)  
Note: To confirm whether your skin type is suitable for this device, please refer to the skin color table in the Quick Use Guide.  
Note: Due to the existence of various reasons, your skin may have different reactions due to different irradiation times and occasions. Note: X is not applicable)

### Skin irradiation test

If this product is used for the first time or similar hair removal products have been carried out recently, skin tests should be carried out on each site to be irradiated. The test is needed to check whether the skin responds to the irradiation and determine the correct lighting settings for each body part.

1. Select a site near the site to be irradiated.  
Note: Do not try to use this product on extremely difficult or sensitive parts (bare feet or bones)
2. Press the switch key for 2 seconds to start the machine, and make sure to select the 1st gear.
3. Place the instrument vertically on the skin to make the flash port contact with the skin.
4. Press the flash button to emit a flash.
5. Slide the instrument against the skin to the next site to be irradiated.
6. Increase the setting step by step, emit a flash, and then slide the instrument to the next part. Repeat this operation for all levels within the recommended light intensity range for your skin type.
7. After skin test, skin condition after 2 hours. If there is no abnormality (redness, blisters) at the time of the photo, you can use this product with confidence.

### Essentials of Hair Removal

#### Essentials of Hair Removal in Various Parts

1. Hair removal under the armpit
  - Before hair removal, please wipe clean the antiperspirant, perfume, cream and other cosmetics applied under your armpits. For flabby parts of the skin, stretch the skin first, and then depilate.
  - It is normal for the skin to have a slight burning sensation when irradiating the mouth.
2. Bikini hair removal
  - Pigment accumulation, dark color parts please use low gear, please use 1 gear before adapting.
3. Hairy of hands and feet
  - Bones, potholes and uneven ground bones and places that resist bumps will be more painful than officials in ather parts.
4. Do not use the following parts:
  - There are burn marks, dark-colored parts, around the eyes, frostbite, moles and other parts, eyebrows, hair, sun burns and other parts.
  - After hair removal, avoid places with ultraviolet rays for 24 hours to prevent sunlight from burning the skin in hair removal.
  - Please be careful not to look directly at the flash.

### INSIRUCTIONS

#### Intermittent Flash Mode Usage Steps

- 01/Use a shaver to shave off the hair on the part that needs care.
- 02/Connect the power supply, press the power-on button for 2 seconds to start up, and display the remaining number of starts, gear and intermittent flash mode after starting up.
- 03/Compare your skin with a skin color card. Please do not use it if your skin color belongs to X. This skin color card indicates the most suitable gear. For different skin colors, but it is recommended to start with 1st gear for the first time.
- 04/At this time, adjust the gear according to your skin color, and short press the minus key to adjust the cyclic selection between gears 1-9. It is recommended to start from the first gear for the first use. Without damaging the skin, the higher the gear, the better the hair removal effect.
- 05/Turn on the cooling key to appear the cooling symbol, and turn on the side ice mode, which can reduce the burning sensation and realize painless hair removal. (ONLY FOR ICE STYLE (BHRL04))
- 06/Select manual/automatic flash mode, manually stick the skin and press the light key to flash: press the light key to enter the automatic flash mode without sticking the skin. No need to press the key, stick the skin to flash.
- 07/Wear the professional protective glasses attached to this product during operation. Avoid eye injury caused by flash.
- 08/At this time, place the product vertically on the part that needs to be removed, the body lamp head is completely attached to the skin, the white indicator light flashes, and the irradiation button will flash, or select the automatic flash mode to start hair removal. (Note: The lamp cap of the fuselage U does not fully fit the skin, and the indicator light will not flash)

#### Procedures for using ice compress care mode (ONLY FOR ICE STYLE (BHRL04))

- 01/After the hair removal is completed, short press the snowflake key diagram to open the nursing mode, and the screen displays the snowflake logo lighting function to turn off. Press the snowflake key briefly again to exit the nursing mode.
- 02/Stick the refrigerator piece of the lamp cap of the instrument to the ne
- 03/After completing the care, you can press the power button for 2 seconds to shut down.

(If all modes are not used for 5 minutes, the instrument will automatically shut down)

### Using steps and working principles of three major functions

- 01/Use a shaver to shave off the hair on the part that needs care.
- 02/Connect the power supply, press the power-on button for 2 seconds to start up, and display the remaining number of starts, gear and intermittent flash mode after starting up.
- 03/Compare your skin with a skin color card. Please do not use it if your skin color belongs to X. This skin color card indicates the most suitable gear. For different skin colors, but it is recommended to start with 1st gear for the first time.
- 04/At this time, adjust the gear according to your skin color, and short press the minus key to adjust the cyclic selection between gears 1-9. It is recommended to start from the first gear for the first use. Without damaging the skin, the higher the gear, the better the hair removal effect.
- 05/Turn on the cooling key to appear the cooling symbol, and turn on the side ice mode, which can reduce the burning sensation and realize painless hair removal. (ONLY FOR ICE STYLE (BHRL04))
- 06/Select manual/automatic flash mode, manually stick the skin and press the light key to flash: press the light key to enter the automatic flash mode without sticking the skin. No need to press the key, stick the skin to flash.
- 07/Wear the professional protective glasses attached to this product during operation. Avoid eye injury caused by flash.
- 08/At this time, place the product vertically on the part that needs to be removed, the body lamp head is completely attached to the skin, the white indicator light flashes, and the irradiation button will flash, or select the automatic flash mode to start hair removal. (Note: The lamp cap of the fuselage U does not fully fit the skin, and the indicator light will not flash)

### NOTICE

- Do not use antiperspirant immediately after irradiation of the armpit;
- Please confirm and clean the dirt at the irradiation port regularly to avoid burns and malfunctions during use;
- Do not turn the irradiation port close to articles that are easy to demagnetize, so as not to cause malfunction and damage;
- Do not use it under the condition of blocking the vent to avoid smoke and fire;
- Do not illuminate black objects facing the mouth, so that the machine cannot run properly;
- Do not irradiate clothes, hair and other items to avoid blackening, discoloration and damage;
- Do not use it on pets to avoid injury;
- Do not use this product around the eyes to avoid eye injury;
- After use, please wipe the hair and skin care products attached to the epilator clean to avoid malfunction and skin damage;
- Do not use it around children, the epilator will emit strong light and easily hurt eyes;
- Please set the irradiation intensity according to your skin condition, and be sure to start with the first gear for the first time;
- If the skin is slightly hot and red after use, it is a normal phenomenon, you can open the ice compress function to relieve skin discomfort;
- When you need back hair removal operation, it is recommended to have a helper, which may be risky to operate alone;
- After the product is turned on, it cannot be unattended. After the product is used, please close it in time;

- Please shut down the product in time after using it. Clean the skin to ensure that there is no hair residue on the skin surface, completely dry and free from oily substances;
- If the temperature difference in the operating environment reaches more than 20 degrees (from low temperature environment to high temperature environment, or vice versa), please shut down the instrument and let it stand for about 2 hours before using it;
- Do not use it near flammable and explosive materials (sprayers, gas stations, etc.), which are easy to cause fire, electric shock and other dangerous tests;
- The use environment temperature of this epilator is 5-40 degrees;
- Do not touch the light outlet after use. Due to the high temperature generated by the light outlet, it is easy to cause burns;
- If the skin of the irradiated area is not dry or clean, it will affect the use effect of pulsed light, and it may also cause the product to not flash or accidentally flash;
- With in 24 hours after irradiation, please avoid direct ultraviolet radiation on the irradiated part;
- If the skin of the irradiation site is not dry and clean, the use effect of pulse light will be affected, and the product may not flash or accidentally flash;
- Do not place the product in the sun or in the long room under the ultraviolet lamp, which will seriously damage the product;
- The rear fan does not run when the power is turned on (no buzzing sound is heard), do not use it to avoid smoke and fire failure;

#### Uncomfortable groups and conditions

Pregnant women, women during lactation, women; menstrual period, body surface scars, diabetes, fragile skin and light-sensitive skin should not be used; severe heart disease, moderate to severe hypertension, malignant tumors, folliculitis, infectious skin diseases, Burn skin, anti-suspected blood disorders are prohibited;  
Do not use poems for those with abnormal collagen metabolism, including scar history and poor wound healing, do not use poems for those with vascular diseases, such as varicose veins and vasodilation at the time of exposure; Do not use if the skin is sensitive to light and prone to rash or allergies;  
Do not use if the irradiation site is infected, herpes simplex, skin lesions, hematoma, etc;  
Suppressing immune response diseases Suppressing immune response diseases (including HIV/AIDS infection, Lupus erythematosus, porphyria, etc.) Do not use;  
Any hemorrhagic disease patients with contraindicated, topical isotretinoin acid (AHA), salicylic acid (BHA) or azalea acid contraindicated;  
For those who use chemical hair removal within 30 days, please use skin whitening products or cosmetics containing vitamin A in a short period of time with caution;  
It cannot be used in the same period as essential oil products. Please ensure that the skin on the illuminated area is clean, dry and does not use cream, lubricating fluid and other cosmetics  
If the skin shows that it is not clean, dry, and may affect the use experience of the product, it may damage the product;  
it may be banned during aspirin medication, immunosuppressants, and isotretinoin acid medication. Recent use of light-sensitive drugs (such as tetracycline, sulfonamide, etc.) is not recommended for the time being;

Light damage light damage (sunburn) please wait for skin repair before using, mucosa and other sensitive parts are prohibited;

Any type of wound is not healed is strictly prohibited to use this product, hirsutism and other diseases induced skin if you take painkillers, it will reduce the skin's sensitivity to heat. It is recommended to use it with caution before the effect is relieved. If your skin and hair color are not suitable, it is forbidden to use this product;

(If necessary, please consult your doctor and use it later)

#### Do not use for the following body parts or the presence

- |                                     |                                |
|-------------------------------------|--------------------------------|
| 1.Oral cavity, pudendal mucosa, etc | 2.Plastic and surgical sites   |
| 3.Adam's apple                      | 4.Eyeball, eyelid, around eyes |
| 5.Head                              | 6.Spot and mole site           |
| 7.Eyebrows, hair                    | 8.Acne site                    |
| 9. Nipple, areola                   | 10. Inside the navel           |
| 11.Ears                             | 12. Large vein                 |
| 13.Tattoos and body painting        |                                |

(Note: This list is not exhaustive. If you are not sure whether you can use this product, it is recommended that you consult a doctor.)

### SKINCARE

(It is recommended to avoid touching water within 6 hours after hair removal. After that, moisturizer can be used to moisturize the irradiated parts.

Do not use perfume, facial mask and cosmetics containing frosted beads after skin hair removal. Please avoid UV exposure within 24 hours after hair removal operation, and apply sunscreen if necessary.

If you feel unwell, consult a surgeon.

Sunbathing is likely to cause skin blackening or sunburn. Irradiation here will cause redness, swelling, inflammation and other conditions. Therefore, during the use of this product, be careful not to expose to the sun, and the repair time for sunburn is not less than 1 week.

During the hair removal operation, exposure to the hair removal area is strictly prohibited within 18 hours after the hair removal operation. Even if exposure is required after 18 hours, attention should be paid to whether there are any adverse conditions on the skin at all times. Please use SPE30 sunscreen for sun protection after 72 hours.

Artificial tanning skin is not allowed during hair removal operations.

If you need to perform plastic surgery after hair removal (only refers to the hair removal area), please consult a doctor.

### USING INTERVAL

Time interval	Week 1-4	Week 5-8	Over the 8th week
	use 2 times a week	used once for 1-2 week	once every 15 or 30 days

Please use it many times according to the growth of hair. Heavy hair can be appropriately increased in gear and frequency on this basis. The specific situation varies from person to person.

### CLEANING AND MAINTENANCE

#### Machine care

In order to ensure that the product achieves the best effect and the longest service life, please clean the product before and after each hair removal to avoid long-term accumulation of hair deposits and dust. If you do not clean up normally, this product will not get its due effect.



Check this product, especially the light-transmitting window and body parts. Make sure they are all clean and tidy.  
Do not clean this product and its accessories under the faucet or in the dishwasher.  
Do not use steel wire balls, abrasive cleaners (toothpaste, etc.) or corrosive liquids (gasoline, engine oil, acetone, etc.) to clean the product.

Note: If you can no longer clean the light-transmitting window, please stop using this product.



Turn off the product, unplug the power plug and let it cool down. When using this product, the flash window will heat up. Make sure it is cool before cleaning.  
If necessary, clean the outside of the product with a clean soft cloth.  
Wet the soft cloth with a few drops of water, and then use it to clean the following parts

- Flash window
- Ice panel

Note: If the water cleaning effect is not good, you can use a few drops of high-concentration alcohol (no more than 96%) to clean the above parts.

When disposing of the product, please do not throw it together with the general domestic waste, but hand it over to the designated recycling center, which is conducive to environmental protection.

#### Electromagnetic Field (EMF)

This product complies with all applicable standards and regulations regarding exposure to electromagnetic fields.