

## Kit JUBPE-AB

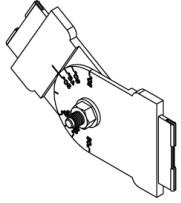

x2

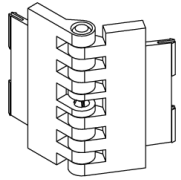

x2

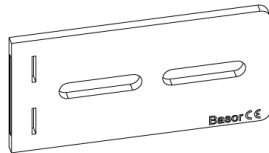

x4

Models (H): 60; 100

Material: PVC "UVM1 7035"

Characteristics:

- Non metallic component
- Non-flame propagating component
- Without electrical continuity
- Electrical insulating component
- Minimum temperature -20 °C
- Maximum temperature 60 °C
- Fire behavior M1, UNE 23727
- Self-extinguishing glow-wire test at 960 °C, UNE-EN 60695-2-11
- UL 94-VO, ANSI/UL 94-1995
- Low Oxygen Index LOI>50%, UNE EN ISO 4589
- RoHS compliant, 2011/65/UE

## ASSEMBLY INSTRUCTIONS

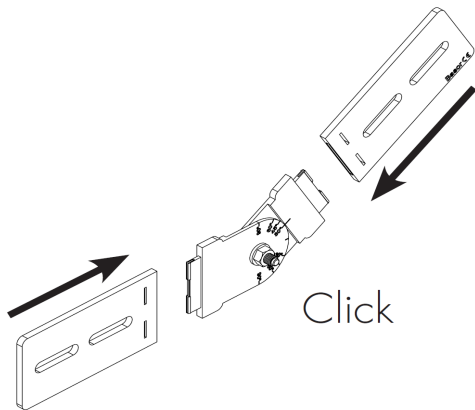

kit JUBPE-AB could be used assembling its components as horizontal hinged joint or as vertical articulated joint . To obtain these pieces:

- Select the hinge or the vertical knee depending on your needs.
- Introduce the clipping flanges into the union plates.
- Use two unions, one on each side of the tray.
- Support the tray line near to the jointed union at less than 400 mm.
- All the components of the kit are recyclable. Keep this in mind when disposing of the components you are not using.

