

80mm

## Poco X403

### TWS Bluetooth Hearing Amplifier

#### Instruction Manual

#### WHAT'S IN THE BOX?

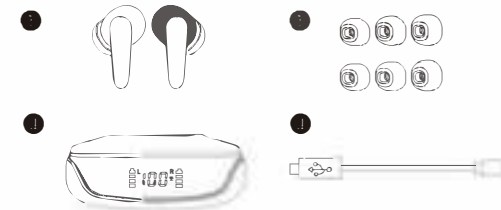

- 1. Poco X403 (L+R)
- 2. Charger Case
- 3. Silicone dome(Extra three sets)
- 4. Type-C charging cable

#### FEATURES

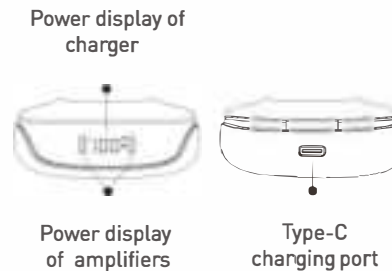
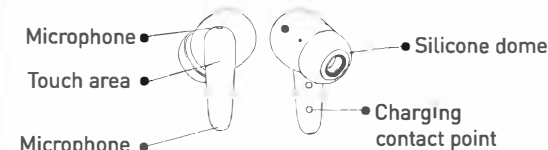

#### TURN ON AND OFF

Automatically turned on when pick out from case, and turned off when place into case.

\* Manually turn on by long press for 3 seconds, and manually turn off by long press for 5 seconds.

\* When the charger case run out of battery, the device will be turned on automatically and make some pitch sound, please charge the case once it happens, or you can turn off the devices manually if you do not use the devices in a short time.

#### OPERATION



The same effect can be obtained with left ear or right ear operation.

Hearing Enhancement	Press twice	Switch to next listening program (Wait for indicator)
Phone call	Press twice	Answer/Hang up phone call
Activate Siri	Long press for one second	Long press for one second to reject a call
Music Streaming	Control the music setting through your music APP on your phone	

#### HOW TO CONNECT AMPLIFIER WITH YOUR PHONE

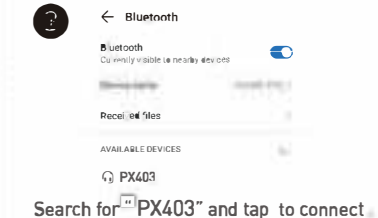
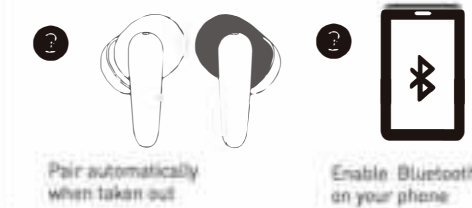

#### HOW TO WEAR

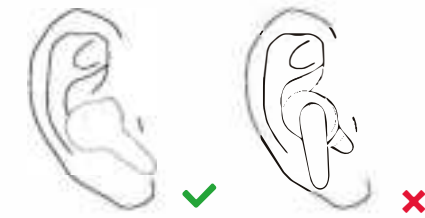

560mm

80mm

## CHARGING INDICATOR

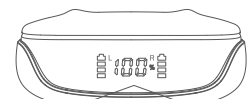

**Charging**

The light icon of the charger case blinks.

**Fully charged**

The battery icon stops flashing when 100% fully charged.

**Note:** When the hearing amplifier is in low battery condition, you will hear voice indicator of "Battery Low". Please charge in time. It takes about 2 hours for a full charge.

## HOW TO CHARGE AMPLIFIER

1. Open the charger case cover.
2. Put the hearing amplifiers in the relative left and right charging port and close the cover. The battery icon will start to flash, which means that the relative hearing amplifier is charging. The battery icon stops flashing when the recharge has been completed and shows full power.
3. A full charge takes about 2 hours.



## HOW TO CHARGE THE CHARGER

1. Insert the Type-C charging cable into the charger port and connect the power supply.
  2. The flashing light of number indicates that the power has been charged.
- Once the flashing white light is extinguished, it means that the charging is complete.
3. The charger can provide 4 times of recharge cycle for both amplifiers.

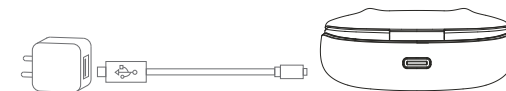

## HOW TO USE THE APP

**Download**

Search SoundWear in



Or Scan to Install



## Connect

- Step 1: Wear on your devices.
- Step 2: Enable the Bluetooth on your phone.
- Step 3: Pair your devices with your phone by following section: "HOW TO CONNECT AMPLIFIER WITH YOUR PHONE" first; Search the devices "PX403".
- Step 4: Tap to connect your devices with your phone.
- Step 5: You can adjust the volume, switch listening program and many other customized adjustments through the APP.



## TROUBLESHOOTING

### 1. Unable to charge

Check and clean the contact points of both hearing device and the charger case. Use the originally provided charging cable to recharge again.

### 2. The voice becomes smaller

\*Checking whether the ear dome is dirty, if so, clean or replace with a new one.

\*\* Check if the amplifier is in low battery. Recharge the devices if needed.

### 3. Whistling happen and can not stop?

The whistling may be heard if the device is turned on but not positioned securely in your ear. Once properly inserted, whistling will stop. Try the following steps.  
Step 1: Change another size dome which fits your canal.

- Step 2: Place into the charging case, and it will automatically turn off.
- Step 3: Clean your ear canal.
- Step 4: Take out again, and get ready to wear again. Do not touch the microphone when you holding the device.
- Step 5: Wear it on again.

560mm

FCC Statement

This equipment has been tested and found to comply with the limits for a Class B digital device, pursuant to part 15 of the FCC Rules. These limits are designed to provide reasonable protection against harmful interference in a residential installation. This equipment generates, uses and can radiate radio frequency energy and, if not installed and used in accordance with the instructions, may cause harmful interference to radio communications. However, there is no guarantee that interference will not occur in a particular installation. If this equipment does cause harmful interference to radio or television reception, which can be determined by turning the equipment off and on, the user is encouraged to try to correct the interference by one or more of the following measures:

- Reorient or relocate the receiving antenna.
- Increase the separation between the equipment and receiver.
- Connect the equipment into an outlet on a circuit different from that to which the receiver is connected.
- Consult the dealer or an experienced radio/TV technician for help.

Caution: Any changes or modifications to this device not explicitly approved by manufacturer could void your authority to operate this equipment.

This device complies with part 15 of the FCC Rules. Operation is subject to the following two conditions: (1) This device may not cause harmful interference, and (2) this device must accept any interference received, including interference that may cause undesired operation.

RF Exposure Information

The device has been evaluated to meet general RF exposure requirement. The device can be used in portable exposure condition without restriction.