

SHALL®

CORDLESS MINI CHAIN SAW

ORIGINAL SAFETY AND OPERATING INSTRUCTIONS

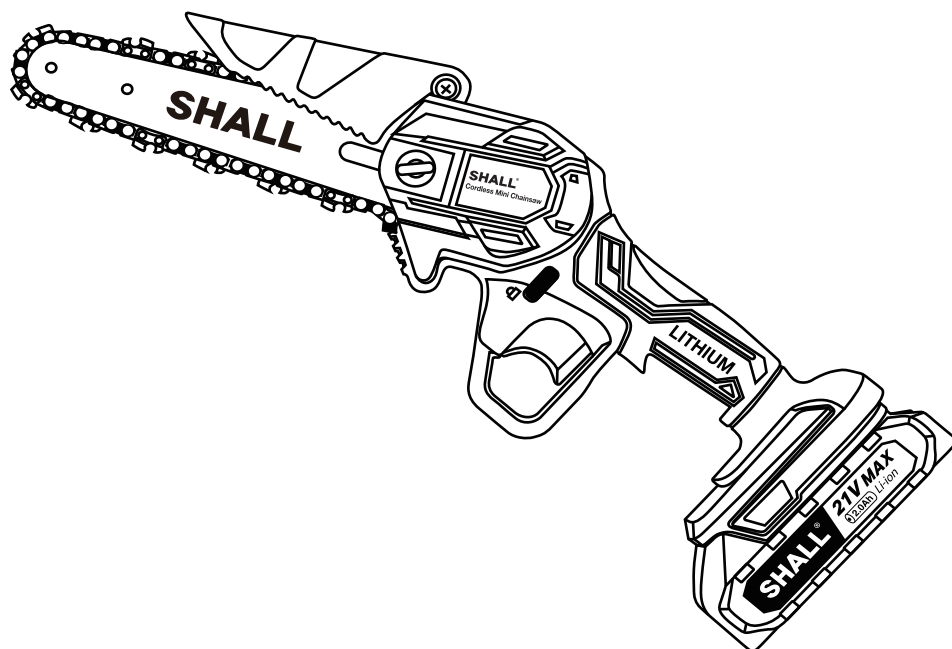

Thank you for buying a SHALL cordless mini chainsaw. Your cordless mini chainsaw has been engineered and manufactured to SHALL's high standard for dependability, ease of operation, and operator safety. When properly cared for, it will give you years of rugged, trouble-free performance.



WARNING: To reduce the risk of injury, the user must read and understand the operator's manual.

SAVE THIS MANUAL FOR FUTURE REFERENCE



Distributed by:
ZHEJIANG SHALL TOOLS CO.,LTD.
No.9 Chunchao Road, Xiaoshan Economy&Technology Zone,
Hangzhou, Zhejiang, China
www.shalltools.com

KNOW YOUR PRODUCT

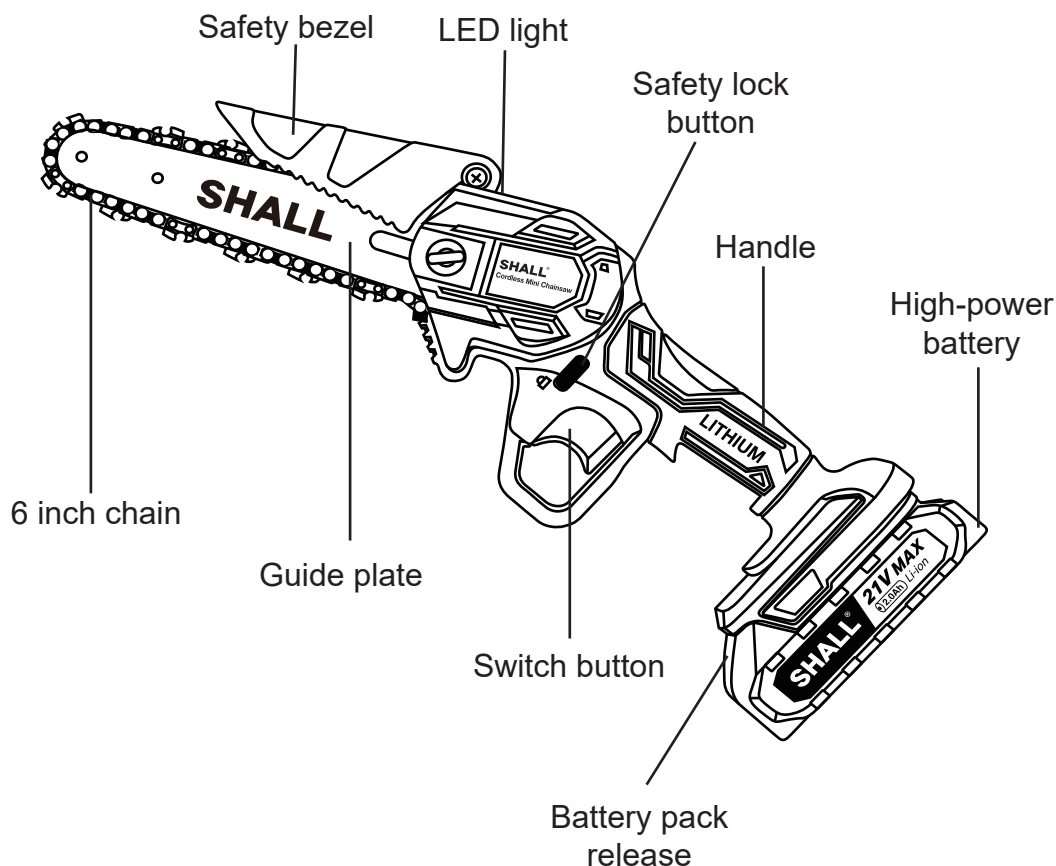

Input voltage	100-240V AC	Guide plate type	Sprocket
Guide	4-inch guide plate	Chain length	4inch & 6inch
Fast charge	1.5-2 hours	Chain speed	8M/S

Important Tips for Use

1 Battery Charging: the red light will be on while charging; the green light will be on when the battery is fully charged.

2 Install the chain as per the operation diagram.CAUTION: Make sure to unplug the battery pack before installation of the guide plate or the chain.

3 Before use each time, test start with no load first and observe whether the chainsaw can run normally without an issue.

4 It is not advised to cut hard objects, such as metal, rock, bricks etc., otherwise it may break the product or reduce the product life.

SAFETY INSTRUCTIONS

1. Keep the workplace clean and orderly. Do not use the product in a messy workplace or counter top. Such a working environment is more likely to cause accidents.
2. Pay attention to the environment of the workplace. Do not work in dark and wet places. Power tools should not be exposed to rain (water); do not use power tools where flammable liquid or gas are stored.
3. Do not operate chainsaw unless you have a clear workspace and secure footing. Pay attention to the material that you plan to cut and think about possible consequences and make remedy plans before cutting.
4. Wear comfortable and fitting clothes while operating. Pay attention to any belt on clothes or your hair that may be entangled in the chainsaw.
5. Depending on objects being cut, it is advised to wear eye protection as well as hearing and head protection when operating the chainsaw.
6. Always be aware of what you are doing when operating the chainsaw. Do not operate when you are tired, ill or under influence of alcohol, drugs or medication.
7. Always carry the chainsaw with the chain blade facing away from your face and body. Only push the safety lock when you are ready to cut.
8. Make sure to unplug the battery pack when you 1) clean the chain and guide plate 2) install/remove the chain or guide plate. 3) are not using it.
9. Keep your operating hand and the handle of the chainsaw dry, clean and free of oil and grease while operating.
10. Check whether the chainsaw is complete in parts before each use, if you see noticeable moving parts out of defects or damages, please do not use.
1. Always operate the chainsaw with a proper stance. Keep the chainsaw in your vision during use.
2. Do not use the chainsaw if the switch does not turn on. Contact with online customer service.
3. Do not try to cut very hard materials that are not supposed to be cut by a chainsaw, using your common sense. The chainsaw works great on wood materials such as trees, logs and sometimes it can also cut PVC materials. H. To avoid injury, always keep it away from children's possible reach. Do not let anyone use the chainsaw unless this person has thoroughly read the safety precautions.

BATTERY PACK USE

- 1.The product is compatible with tailor-made battery packs with 21V.
2. When the battery pack is fully charged, please unplug the power.
3. The battery pack is with temperature protection, low voltage protection and over-current protection.
4. For testing purposes, the battery pack is partially charged ex-factory. It does not necessarily mean that you have received a used product. It is advised to give the battery pack a full charge before your first time use.
5. In case when you find the battery pack is over-heating, has noticeable sparks, smoke or burning smell coming out, please immediately stop use and/or disconnect the power and contact online customer service.
6. Always store the battery pack, together with the chainsaw and charger in an environment that is not wet, damp or too-high/low temperature.

CHARGER USE

1. Please only use the charger included in the pack for charging the battery pack. In case you want to use a third-party charger please contact online customer service for verification before use.
2. When plugging the charger into an electric socket, the indicator light will turn on green. When you plug the DC connector into the battery pack for charging, the indicator light on the charger will turn on red.
3. Unplug the charger from the electric socket when not charging. Place it back to the chainsaw case to avoid it mixed with other chargers.

OPERATION INSTRUCTIONS

To Adjust saw chain tension, perform the following steps:

1. Turn the screw clockwise to tighten the chain. Turn the screw counterclockwise to loosen the chain.

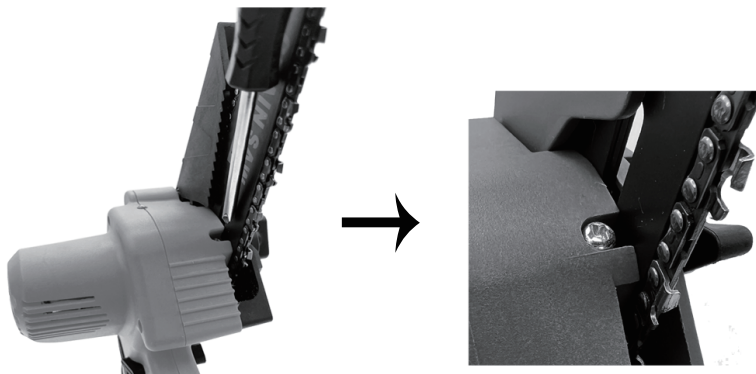

2. Make sure there is a 0.5cm gap between chain and guide bar .

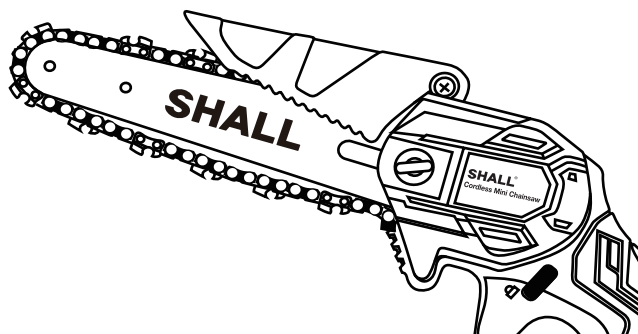

Replace the chain or clear debris, perform the following steps:

1. Remove the sprocket cover

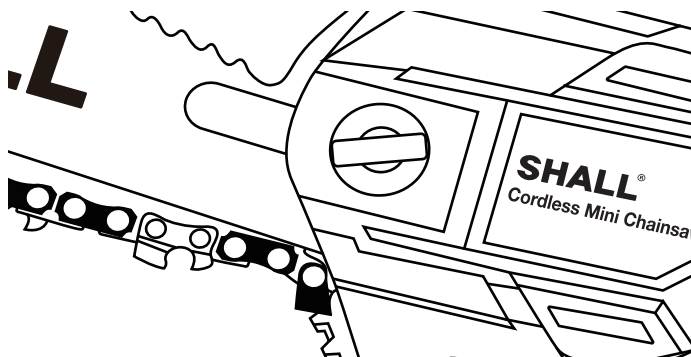

2.Adjust the tension screw counterclockwis to the end.Loosen the chain and guide .
Remove the saw chain and guide bar from the chain saw the body.



3. Rest the guide plate in place on the new chain saw .(The guide hole needs to be installed to the tension screw)Make sure the direction of the chain .
The arrow mark on the chain shows the direction of the chain.

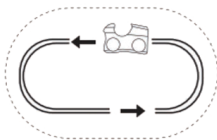

4.Turn the lever clockwise until the sprocket cover is securedthen return it to the original position.

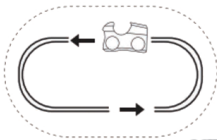

5.Turn the screw clockwise to tighten the chain.Replacement completed .



MAINTENANCE

1. Calibrate the tightness of the chain.

Calibrating the tightness of the chain on the guide plate can offer you the best using experience. If the chain is too tight on the guide plate, then there will be more friction so it will wear the guide plate and consume the battery faster. If the chain is too loose on the guide plate, then sometimes the chain can fall out during use. To calibrate the tightness of the chain, simply use a screwdriver to adjust the screw behind the guide plate. No need to take off the guide plate cover), clockwise for tighter chain and anti-clockwise for looser chain. The proper tightness should be when you are able to pull the chain off the guide plate edge baseline by 3-4 mm (0.12-0.15 inch)



2. Remove accumulated wood dust

The chain and guide plate does not require oil maintenance normally as long as you maintain the two parts clean. It is advised to do a thorough cleaning after a few uses. Use the wrench to open the guide plate cover and remove the accumulated wood dust etc.

3. Replace chain

By a quick examination by eyes, if you find the blades on the chain become noticeably blunt and the chainsaw does not cut things as sharp as it used to be, then it is time to replace with a new chain. For compatible replacement chain information and ordering, you can contact online customer service.

DISPOSAL

Disposal of the appliance



This product has been marked with a symbol relating to removing electric and electronic waste. This means that this product shall not be discarded with household waste but that it shall be returned to a collection system.

It will then be recycled or dismantled in order to reduce the impact on the environment. Electric and electronic equipment can be hazardous for the environment and for human health since they contain hazardous substances.



Li-ion

To preserve natural resources, please recycle or dispose of the battery properly. This battery pack contains Li-ion batteries. Consult your local waste authority for information regarding available recycling and/or disposal options. Discharge your battery by operating your tool, then remove the battery pack from the tool housing and cover the battery connections with heavy-duty adhesive tape to prevent shortcircuit and energy discharge. Do not attempt to open or remove any of the components.

Disposal of the packaging



The packaging consists of cardboard and correspondingly marked plastics that can be recycled. Make these materials available for recycling.

EC DECLARATION OF CONFORMITY

Here with we,

Nantong Yizheng Electromechanical Technology Co.,LTD

Group 33, Caiyuan Village, Lvsigang Town, Qidong City, Jiangsu Province, P.R.C

Declare that the following Appliance complies with the appropriate basic safety and health requirements of the EC Directives(see item 4) based on its design and type, as brought into circulation by us.

This declaration relates exclusively to the machinery in the state in which it was placed on the market, and excludes components which are added and/or operations carried out subsequently by the final user.

1. Product: **Cordless mini chainsaw**

2. Model No.: **D-06 / SH112004EU**

3. Serial number: **N/A**

4. Applicable EC Directives :

Low Voltage Directive 2014/35/EU

EMC Directive 2014/30/EU

Used Harmonized Standards:

EN 60745-1:2009+A11:2010

EN 60745-2-13:2009+A1:2010

EN IEC55014-1:2021

EN IEC 55014-2: 2021

EN IEC 61000-3-2:2019IA1: 2021

EN 61000-3-3:2013/A1:2019

5. Responsible for documentation: **eVatmaster Consulting GmbH Bettinastr.30 60325 Frankfurt am Main, Germany contact@evatmaster.com**

6. Additional used EC Directives: **N / A**

7. Date/place/Name/Authorized signature
2023-3-20/Nantong

8. Title of Signatory:
Engineer

