

**ACTIVE BIKE PRO 2**

**ACTIVE BIKE PRO 3**



LIT Pritvirtinimo instrukcijos  
PL Instrukcja montażu  
CZ Návod na montáž  
SK Návod na montáž  
SLO Navodila za pritrjevanje  
HR Uputa za sastavljanje  
HU A felszerelés módja  
GR Οδηγίες συναρμολόγησης  
UA Інструкція з монтажу  
BY Інструкцыя па мантажы  
RO Instrucțiuni de montare  
TK Uydurma talimat  
N Monteringsveiledning

I Istruzioni per il montaggio  
GB Fitting instructions  
F Instructions de montage  
D Montageanleitung  
E Instrucciones de montaje  
NL Montage-instructies  
DK Montering instruktion  
FIN Asennusohje  
S Monteringsanvisning  
RU Инструкция по установке  
PT Instruções de Montagem  
EST Paigaldusjuhend  
LAT Stiprināšanas instrukcija

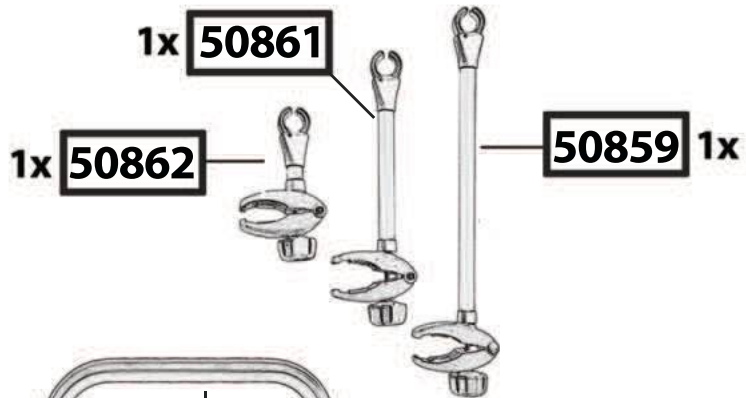

## ACTIVE BIKE PRO 2

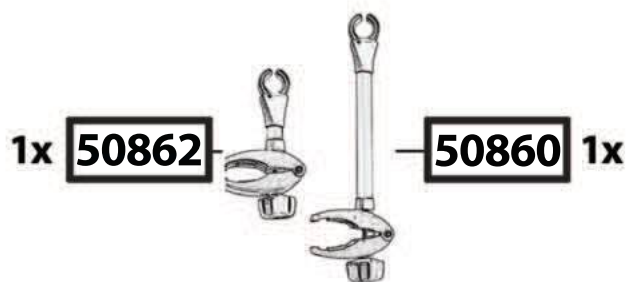
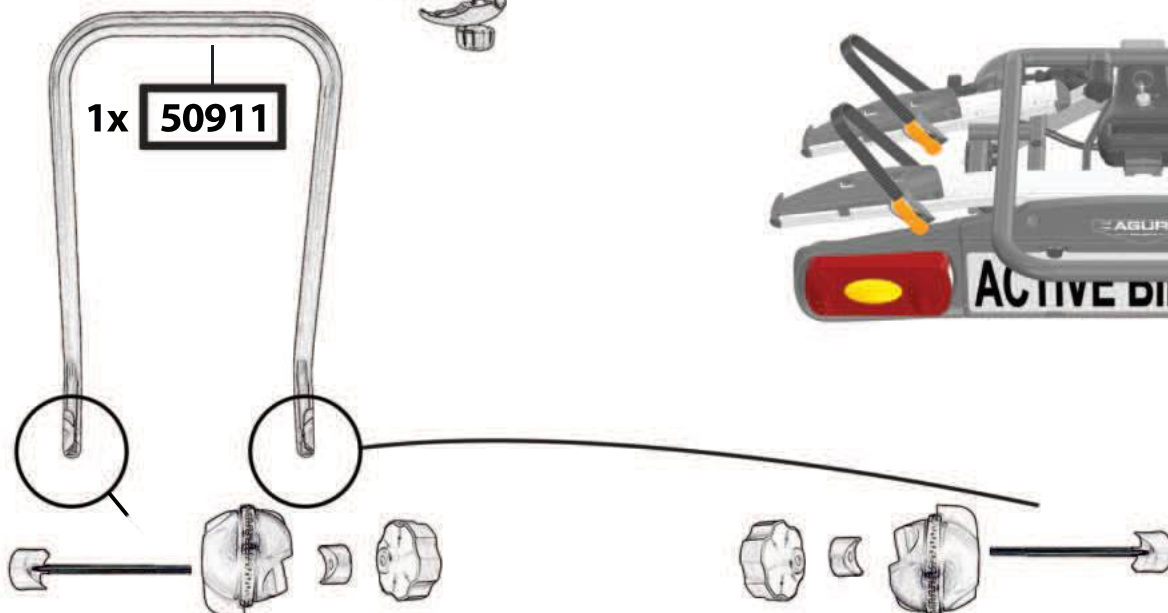

## ACTIVE BIKE PRO 3

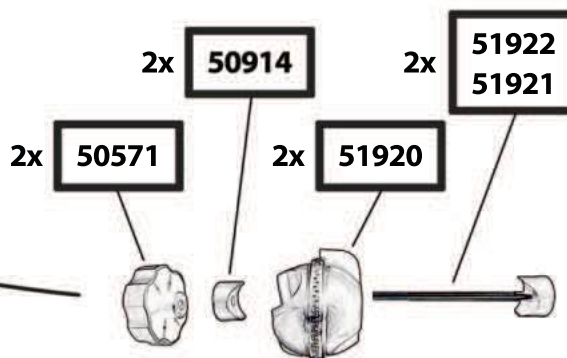
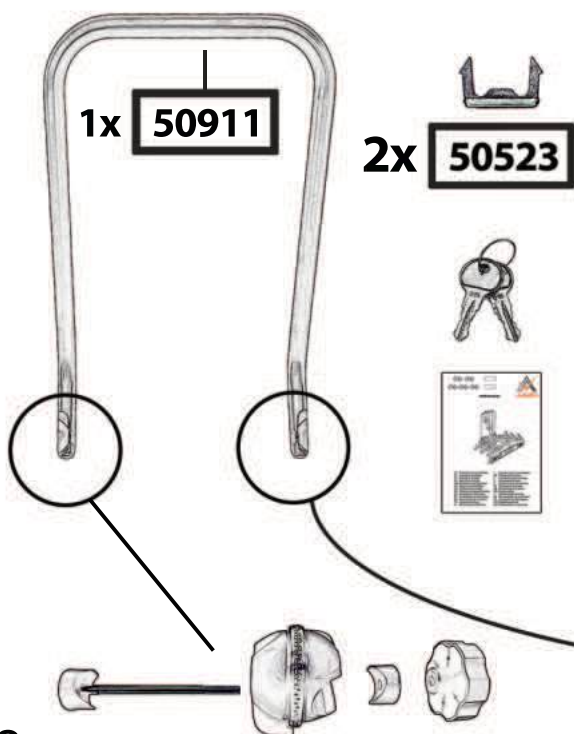

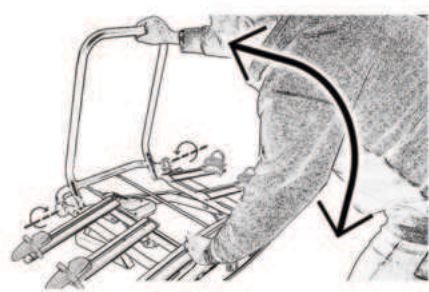
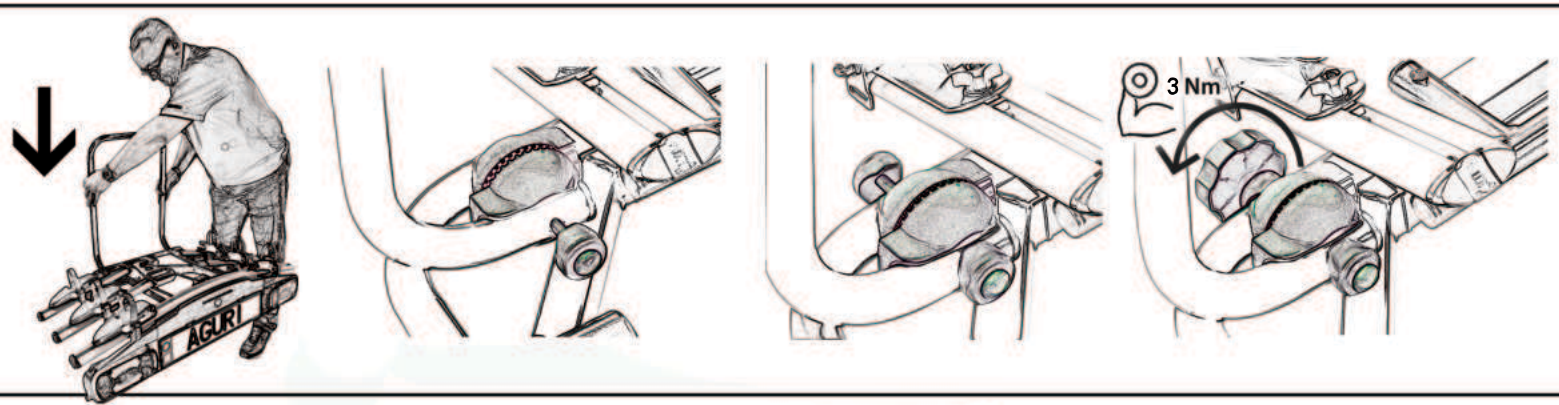
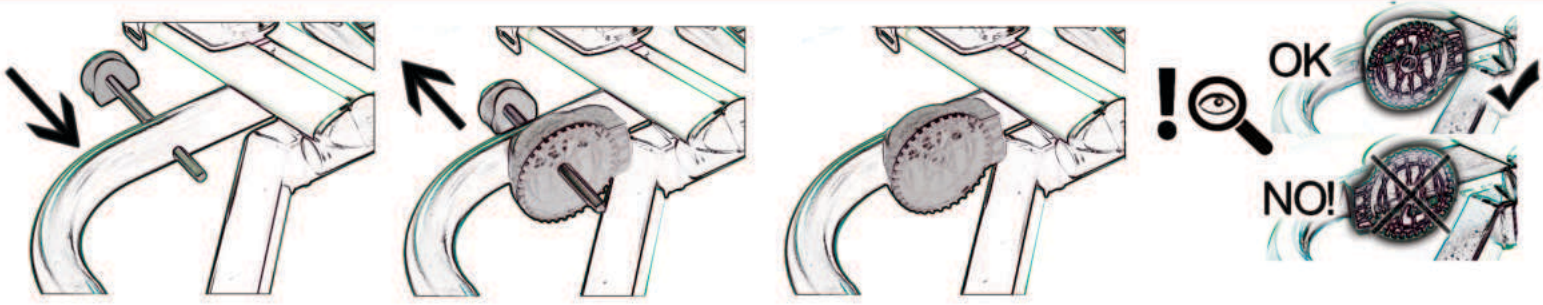

	ACTIVE BIKE PRO 2		ACTIVE BIKE PRO 3	
 KG				
	19,5 KG		21 KG	
50 KG	-19,5 KG	30,5 KG	-21 KG	29,5 KG
60 KG	-19,5 KG	40,5 KG	-21 KG	39,5 KG
70 KG	-19,5 KG	50,5 KG	-21 KG	49,5 KG
80 KG	-19,5 KG	60,5 KG	-21 KG	59,5 KG

1.

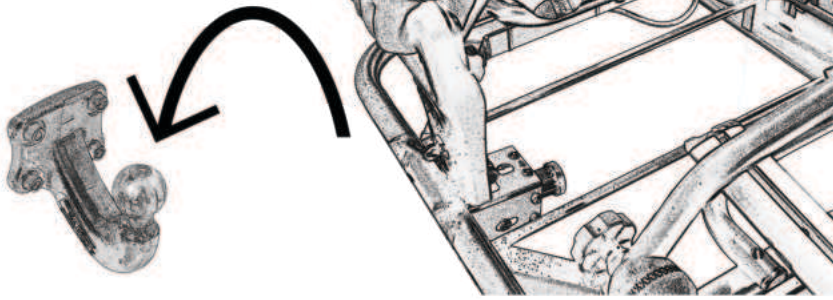

2.

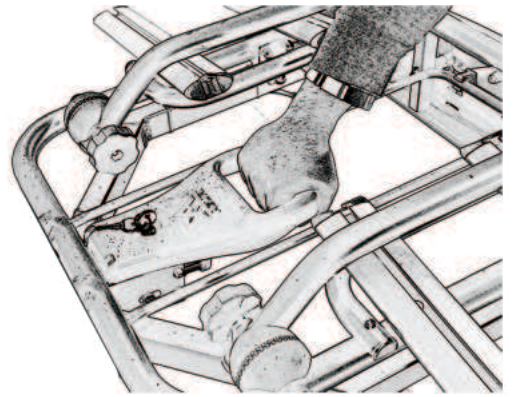

3.

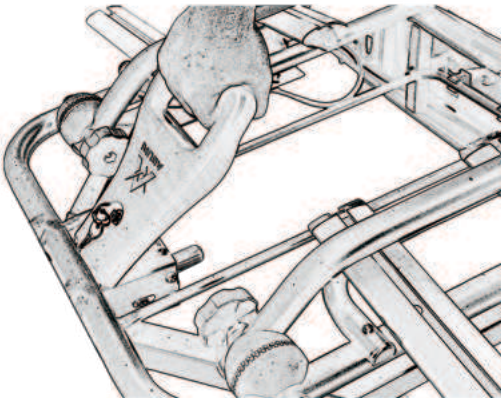

4.

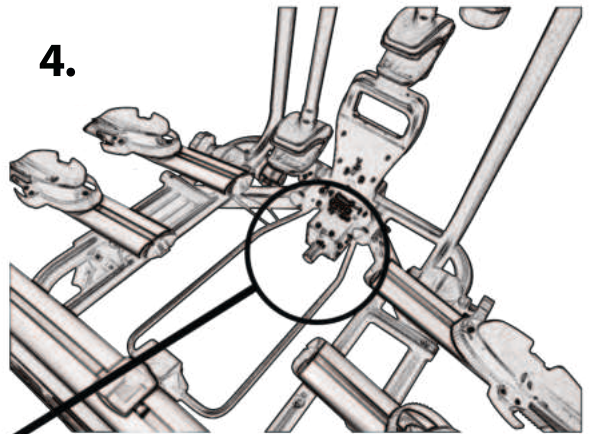

5.

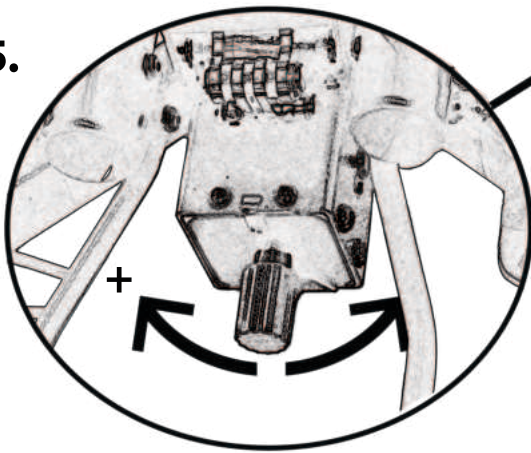

6.

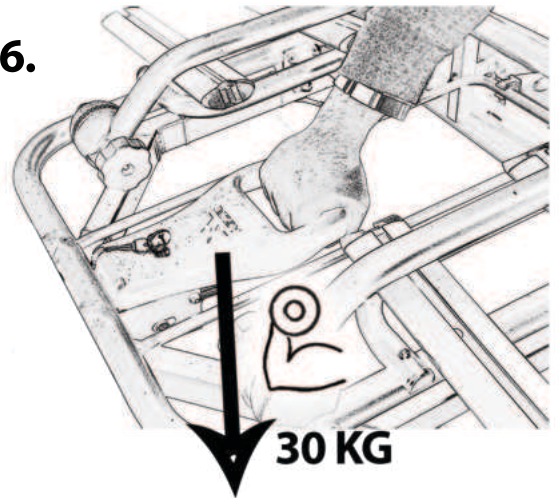

7.

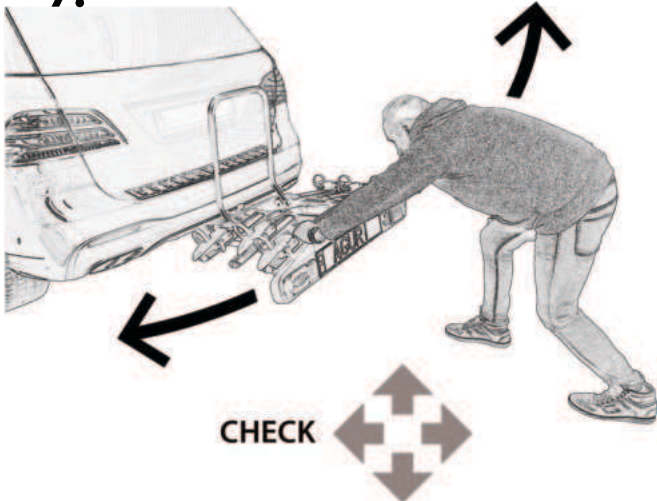

8.

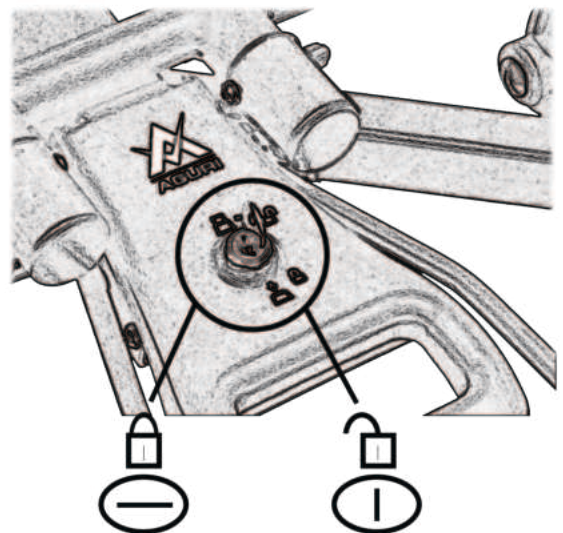

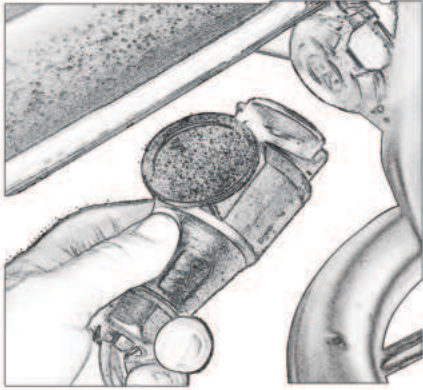

**13 PIN**

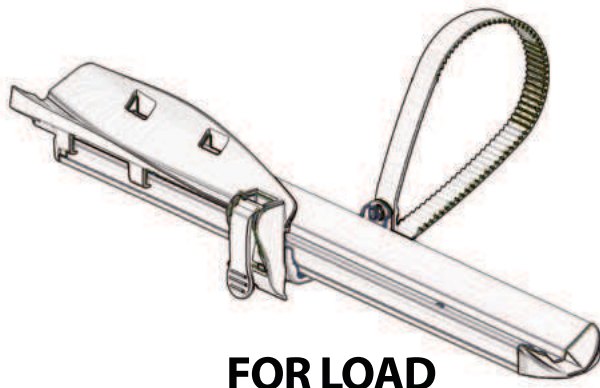
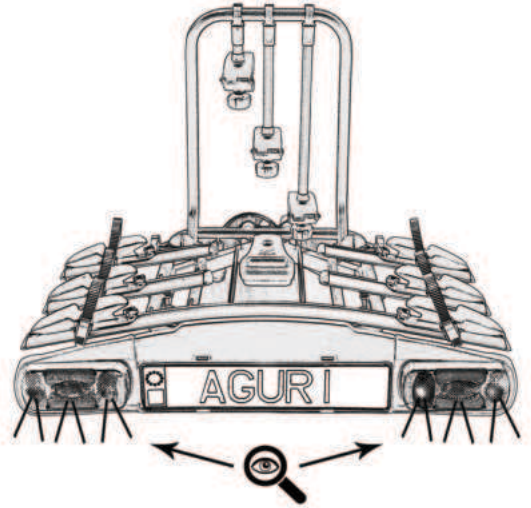

**FOR LOAD**

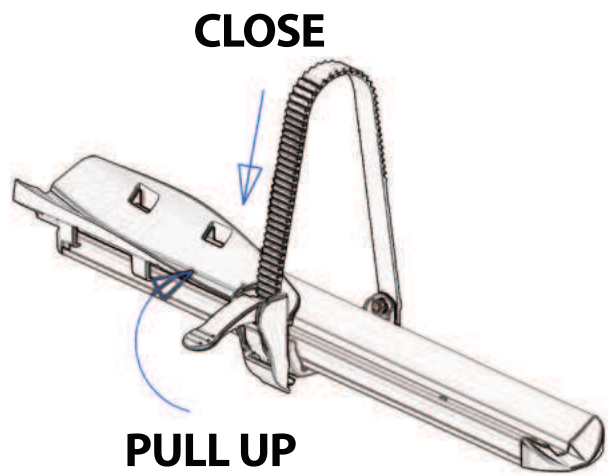

**CLOSE**

**PULL UP**

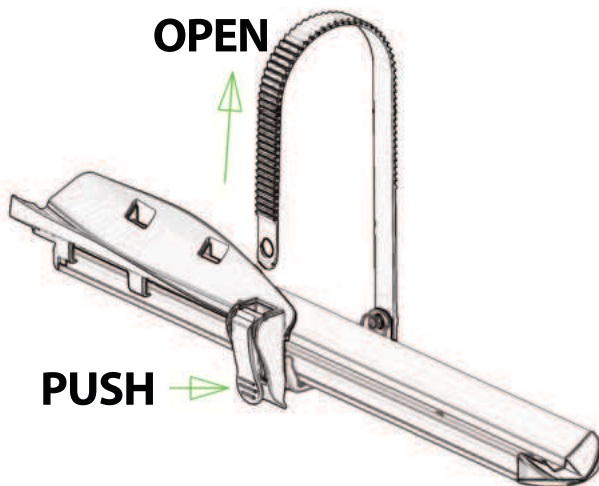

**OPEN**

**PUSH**

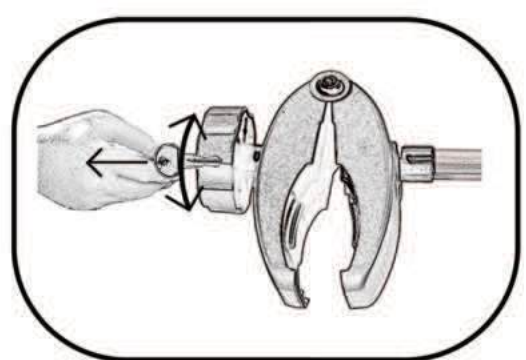
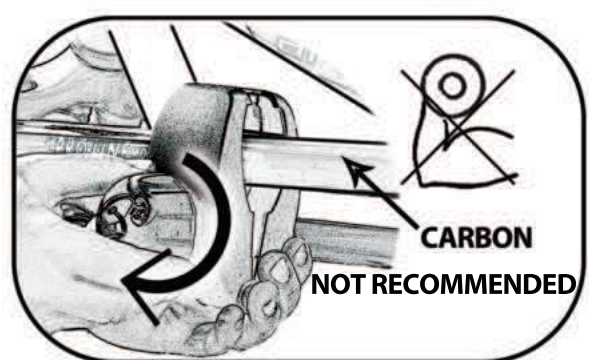
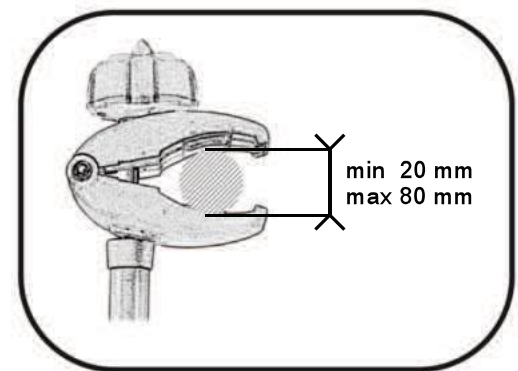
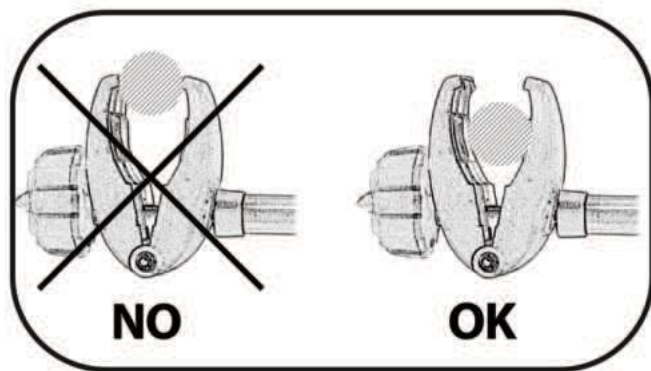
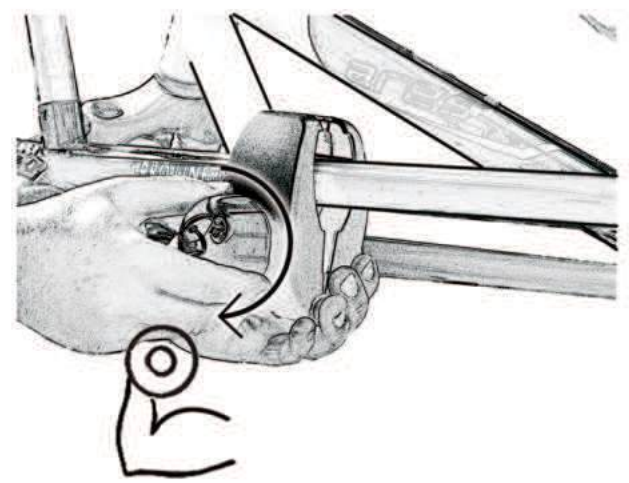
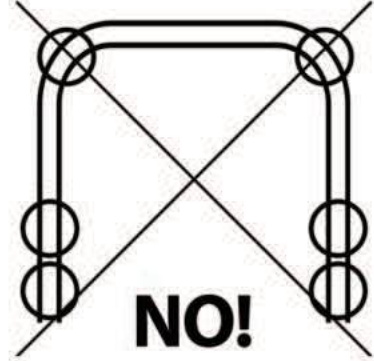
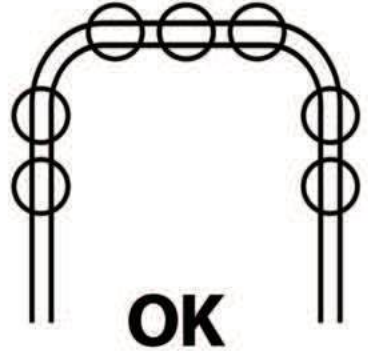
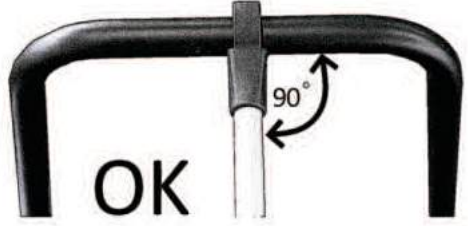
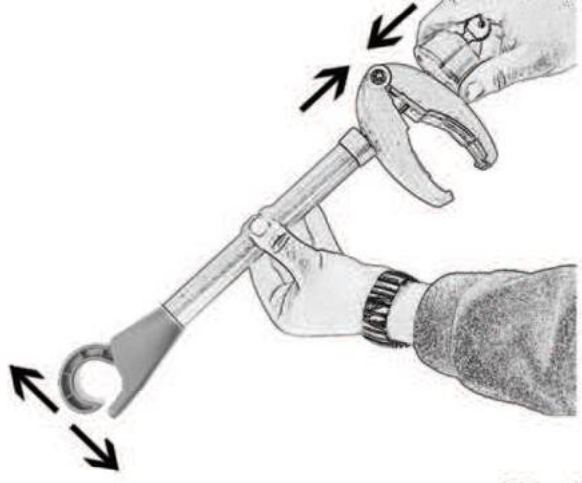

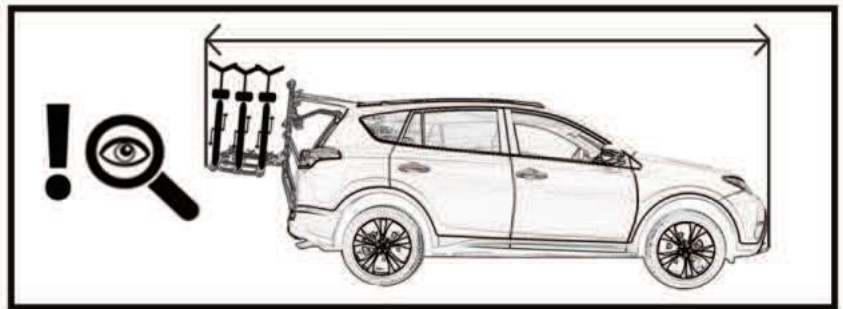
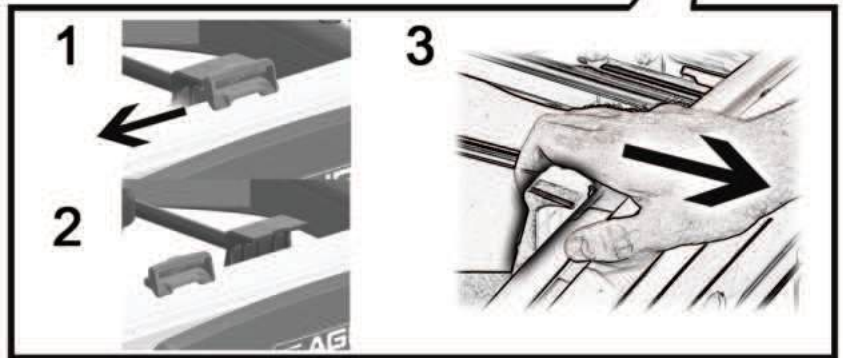
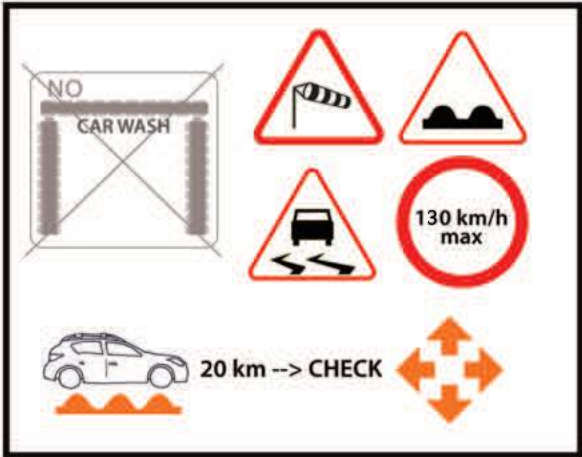
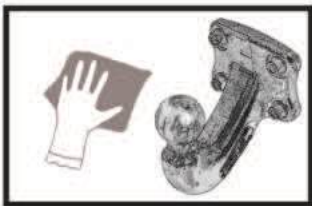
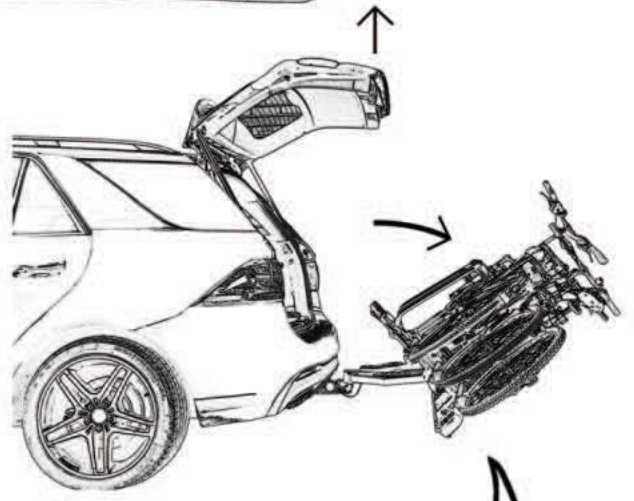
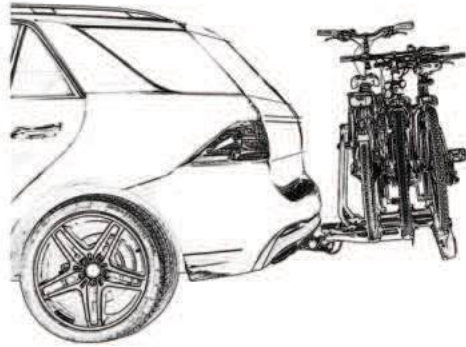
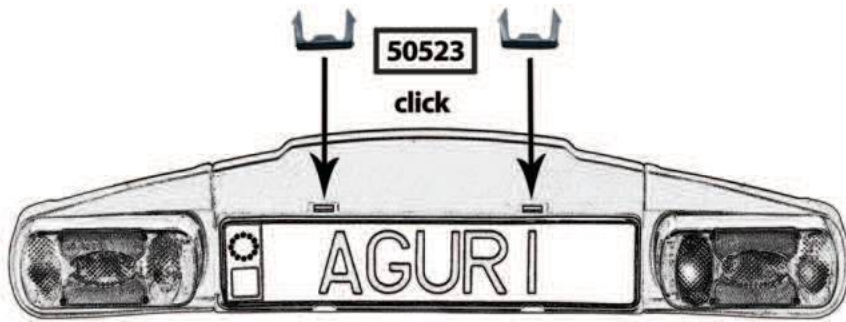

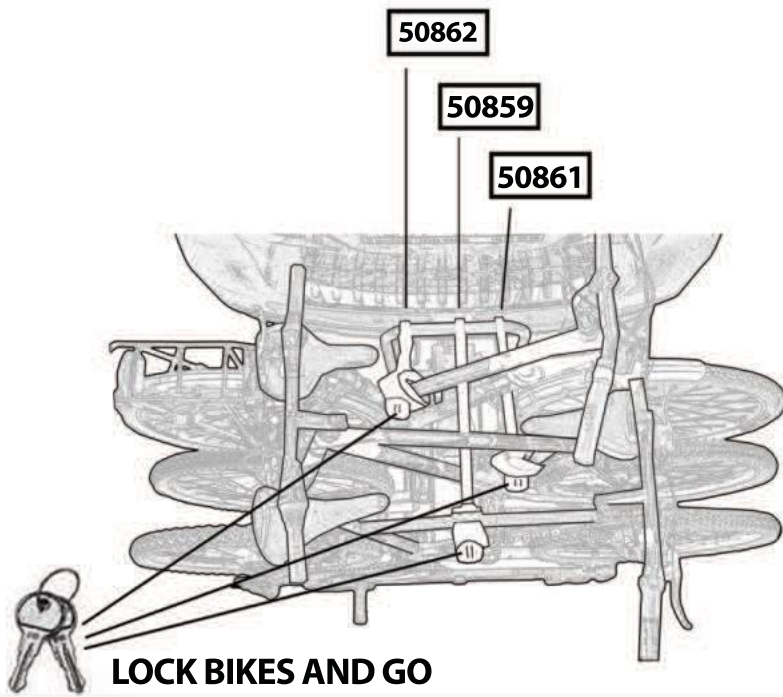

**LOCK BIKES AND GO**

- 1.
- 2.
- 3.

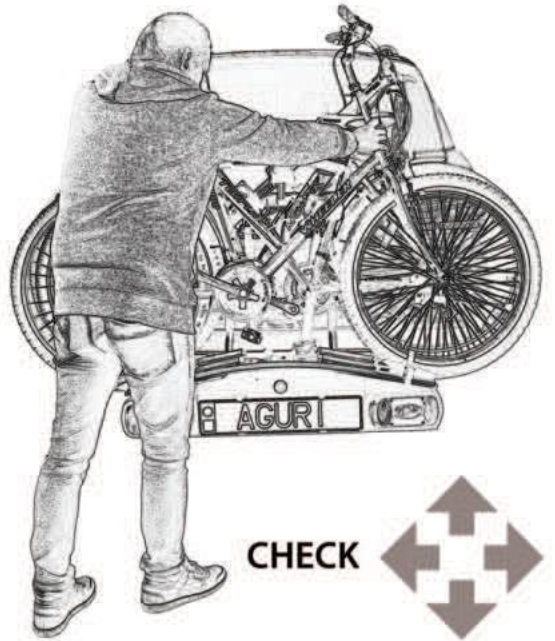

**CHECK**

**ACCESSORIES**

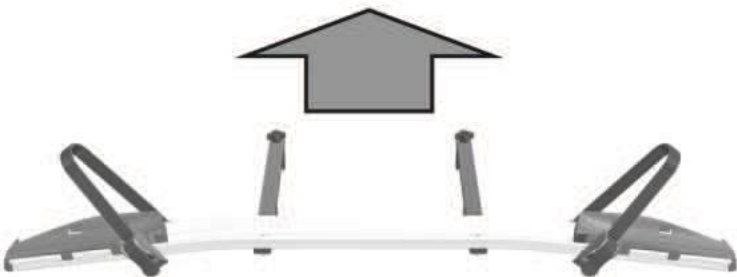

**3/4th BIKE ADAPTER**  
**53004 SILVER 53005 BLACK**

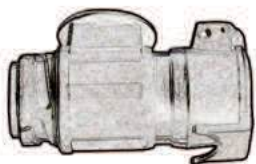

**13 PIN / 7 PIN**

**50072**



**50532**

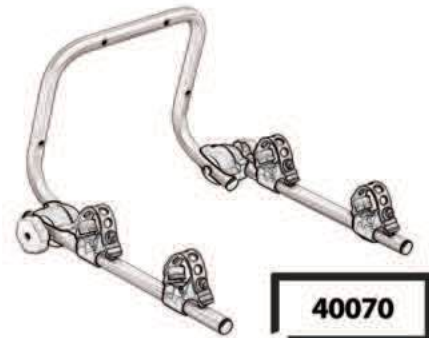

**40070**



**50484**  
**LOADING RAMP**