



# ***USER GUIDE***

*Cordless Vacuum Cleaner*



# ***V2***

Please read this manual carefully before  
using the vacuum cleaner and keep this manual properly.

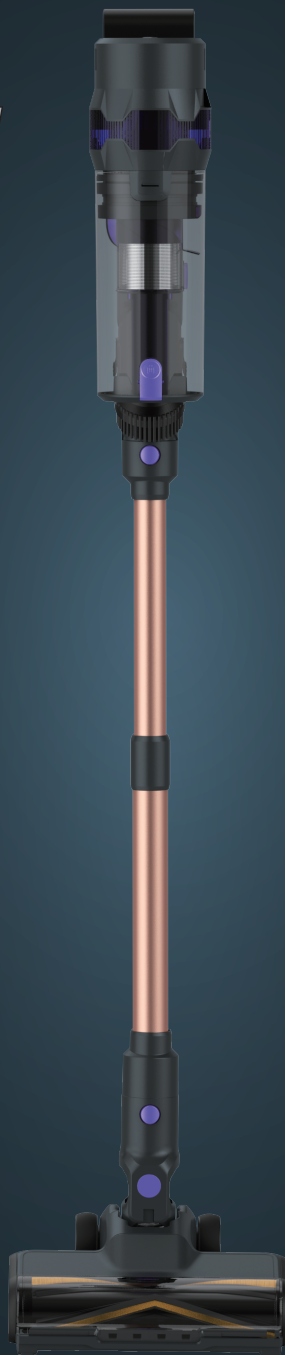

# IMPORTANT SAFETY INSTRUCTIONS

## READ CAREFULLY BEFORE USE

### WARNING:

To reduce risk of injury, fire, electrical shock, or property damage from improper use of this appliance, carefully follow these instructions. This unit contains electrical connections and moving parts that could present risk if instructions are not followed.

**PLEASE READ THESE INSTRUCTIONS AND WARNINGS CAREFULLY AND KEEP THEM FOR REFERENCE:**

1. There are NO serviceable parts. DO NOT attempt to make your own repairs.
2. DO NOT use the hand vacuum on any liquids.
3. DO NOT immerse any parts in water or other liquids.
4. DO NOT use if vacuum, charger, or power cord is damaged.
5. Inspect vacuum, charging dock and power cord for any damage before use to avoid fire, explosion, or injury.
6. DO NOT use damaged vacuum or charging dock.
7. DO NOT use outdoors or on wet surfaces. Use only on dry surfaces.
8. If vacuum cleaner is not working, or has been dropped, damaged, left outdoors, or immersed in water, DO NOT use it.
9. DO NOT handle charger or vacuum cleaner if hands are wet.
10. DO NOT leave vacuum cleaner powered on when not in use or unattended
11. Keep the hand vacuum, power cord and charger away from heated surfaces.
12. Turn off vacuum before connecting to the charging dock.
13. Use only the charging stand and power supply provided with this product.
14. Always use the charging dock on a flat and stable surface.
15. DO NOT incinerate this appliance as lithium-ion battery may explode and cause a fire.
16. DO NOT vacuum hard or sharp objects such as glass, nails, screws, or coins that could damage the vacuum cleaner.
17. DO NOT vacuum sawdust, drywall dust, ashes, or embers.
18. DO NOT vacuum objects that are smoking or burning, such as hot coals, cigarette or cigar butts, or matches.
19. DO NOT vacuum toxic chemicals such as chlorine bleach, ammonia, or drain cleaner.
20. DO NOT use the vacuum in an enclosed space where toxic or combustible vapors are present.
21. DO NOT immerse vacuum cleaner in water or other liquids.
22. Use extra care when cleaning on stairs.
23. DO NOT stretch or strain the power cord. Keep wall mount and power cord away from traffic areas and where it will not be stepped on or tripped over. Do not run over cord with the vacuum or close a door on it.
24. An extension cord is not recommended with this appliance.
25. Unplug the charging cord when not in use for extended periods of time.
26. Only use the power charger and removable lithium-ion battery pack provided with this product. Only replace the battery with one specified for this unit. Other types of batteries may not be compatible and may cause damage or injury.

# IMPORTANT SAFETY INSTRUCTIONS

## GENERAL CAUTIONS

1. DO NOT carry by the cord or disconnect from an outlet improperly.
2. Always grasp the plug at the power outlet and pull it straight out to disconnect.
3. Use this product only as directed in this manual.
4. Always turn off the vacuum cleaner before picking it up or carrying it, attaching, or detaching the charger, dust bin, filter, or accessory tools.
5. DO NOT place any objects into openings or obstructing openings.
6. DO NOT use if any opening is blocked; keep free of dust, lint, hair, or anything that could restrict airflow.
7. KEEP OUT OF REACH OF CHILDREN. This vacuum cleaner is not a toy, and must not be played with, cleaned, or operated by children or persons with reduced physical or mental capabilities.
8. DO NOT operate without the dust bin and filter installed.
9. Keep the nozzle away from face, hair, fingers, or loose jewelry and clothing.
10. Only use the attachments provided with this product.
11. DO NOT charge at temperatures below 50°F (10°C) or above 104°F (40°C). Charging improperly or at temperatures outside of the specified range may damage the battery and increase the risk of fire.
12. Store the appliance indoors. DO NOT use or store it below 37.4°F (3°C).
13. The appliance must be at room temperature before operating it.
14. Do not spray or apply any fragrances to the filter. Some fragrances contain chemicals that are flammable and can cause fire.

## BATTERY CAUTION

The lithium ion battery included with this product is sealed and under normal circumstances does Not pose any safety concerns. In the unlikely event that the battery pack becomes damaged Causing liquid to leak, do not touch the liquid and observe the following precautions:

- Skin contact can cause irritation. Wash with soap and water.
- Inhalation can cause respiratory irritation. Breathe fresh air and seek medical advice.
- Eye contact can cause irritation. Flush eyes with fresh water for 15 minutes. Seek medical attention.
- Wear gloves to dispose leaking battery following local ordinances and regulations.
- Use only with battery pack D01BAT\_1.
- For use only with adapter type E-TEK ZD048M350120US .

# LOCATION OF CONTROLS

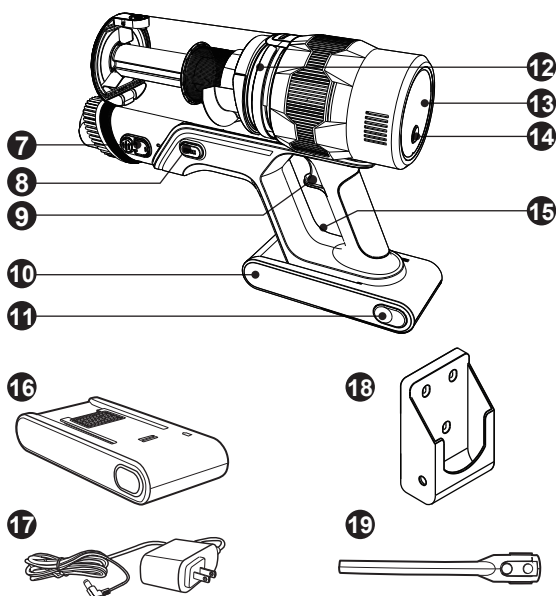
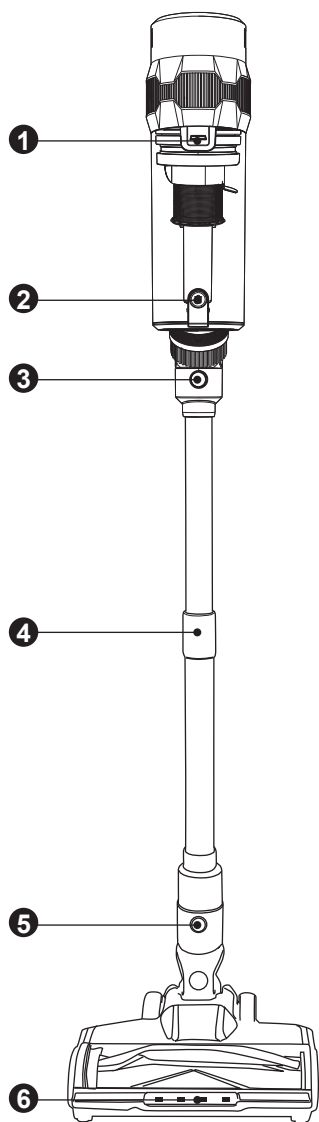

1. Dust Bin Locking Tab
2. Dust Bin Release Button
3. Extension Pole Release Button
4. Telescopic tube
5. Turbo Brush-head RELEASE Button
6. Motorized Turbo Brush-head with LED Lights
7. Brush Tool Release Button
8. Dust Bin Assembly Release Button
9. ON/OFF Power Trigger
10. Rechargeable/Replaceable Battery
11. Battery Release Button
12. HEPA Filter Assembly
13. LED Display
14. Speed Selection Button
15. Battery Charging Port
16. Spare Rechargeable/Replaceable Battery
17. AC Power Cable
18. Individual Battery Pack Wall Mount
19. Long Crevice Tool

## IN THE BOX

- 3-in-1 High-Powered Cordless Vacuum (Floor Vac, Hand Vac and Stairs Vac)
- TWO (2) Rechargeable Batteries
- Motorized Turbo Brush head
- Long Crevice Tool
- Mini Motorized Brush head
- Extension Hose
- Flexible Bending Adapter
- Wide Brush Tool
- HEPA Filter
- One (1) AC Power Cable
- Storage Solution Wall Mount (includes screws + anchors)
- Individual Battery Pack Wall Mount (includes screws + anchors)



# STORAGE INSTRUCTIONS

## The Cordless Vacuum System comes with 6 Bonus Accessory Tools and a convenient wall-mount storage solution.

- 1 Find a wall space location close to an electrical outlet without any obstructions such as windows or shelving.
- 2 With the vacuum connected to the Motorized Brush Roller and Extension Rod in the collapsed position the assembled vacuum against the wall where it will be stored and mark the holes of the wall mount bracket at the right height to store the vacuum in the upright position.
- 3 Use a Phillips screwdriver (not included) to install the wall mount bracket with the screws provided. Make sure to mark mounting holes using the wall mounting holes on bracket.
- 4 Use the vertical storage pipes to the left, right and bottom of wall mount bracket to snap in 5 accessory tools.
- 5 Set the assembled stick vacuum in the middle of the wall-mounted storage bracket and plug in charging adapter into the side with the battery charging port installed into a nearby power outlet.

**NOTE:** The detachable battery can also be charged on a flat surface near an outlet when removed from the vacuum.

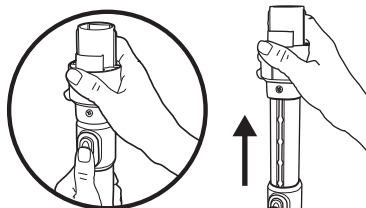

### Collapsible Extension Rod

Press the extension pole button to collapse the extension rod to its shortest position for better stability if storing below the Wall Mount Bracket.

The main battery holder can be used for the battery pack detached from the motor housing or a spare battery pack. An additional battery pack and separate wall-mountable holder are included

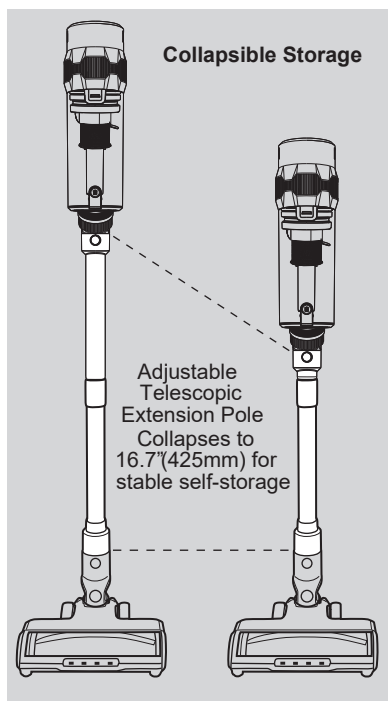

### Individual Battery Pack Wall Mount

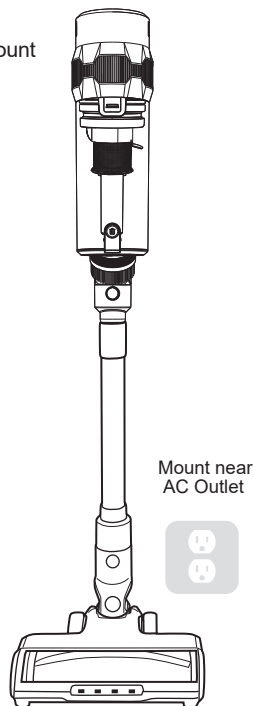
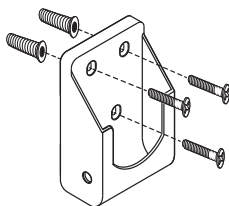

# BATTERY CHARGING

Before first use the detachable lithium-ion battery must be fully charged. It can be charged either installed or uninstalled by connecting the power cord to the recharging port and a standard electrical outlet.

## Direct Connection

If wall-mount is not used, place hand vacuum on a flat, stable surface. Connect the power cord directly to charging port located on the battery.

Hand Vacuum

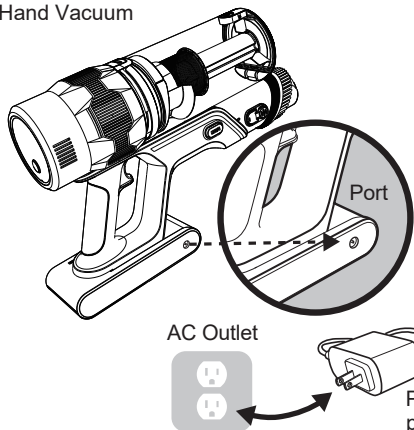

## Wall Mount Storage Station

If using the wall-mount bracket (or individual battery pack wall mount), follow instructions for installation. Plug in assembled product while stored in wall mount. Unplug when not in use for extended periods of time.

Individual  
Battery Pack  
Wall Mount

Port Access

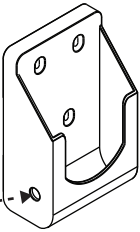

Plug AC adapter through  
port hole on wall mount

**\* AFTER INITIAL CHARGING, ALLOW BATTERY PACK UP TO 2.0 HOURS TO FULLY RECHARGE.**

**NOTE:** During first use, run the battery all the way down to properly condition it, then charge fully. It takes approximately 2.0 hours to charge battery completely. Fully charge and discharge the battery every 3 months when vacuum is not in use for a long period of time.

## Convenient Charging & Storage

The wall-mounted storage dock neatly holds the cord-free vacuum with interchangeable accessories and allows mounted plug-in charging in less than 2.0 hours installed or removed from the unit.

Removable/Rechargeable 8-Cell 2200mAh Li-Ion Battery Pack		
ECO Mode	Ideal for floors and carpeting Whole Room/Office	Up to 60 Minutes Run Time/Charge
NORMAL Mode	Ideal for small room, cushions, drapes, and car interiors	Up to 35 Minutes Run Time/Charge
TURBO Mode	Ideal for quick pick-ups and bursts of power for small messes	Up to 15 Minutes Run Time/Charge

**\* Run Times are estimates and can vary by accessory tool in use, filter cleanliness, and other factors.**

# ASSEMBLY

The main configuration for the Select Cordless Vacuum is for cleaning floor surfaces and higher vertical surfaces that are hard-to-reach.

Hand Vacuum  
Motor Housing

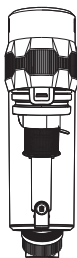

## Floor to Ceiling

Attach the wider Motorized Roller Brush with LED headlights for hard floors, area rugs and carpeting.

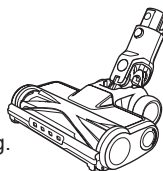

Attach the Long Crevice Nozzle for corners and tight spots.

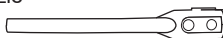

## Quick Pick Ups, Small Areas

Convert the stick vacuum to a handheld vacuum by removing the Extension Rod. Choose the right Accessory Tool for the job.

Attach the Long Crevice Nozzle for deep cleaning between car seats, sofa cushions, and highchair.

Use the BUILT-IN Brush Too for dressers, shelves, and keyboards.

Extension  
Rod

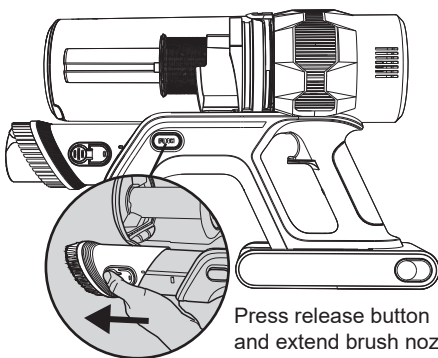
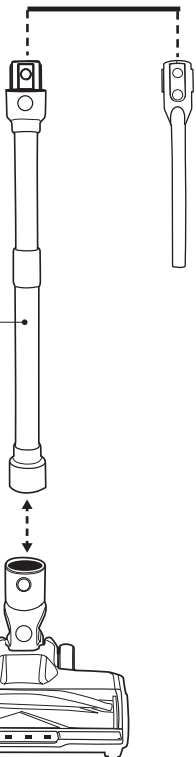

Press release button  
and extend brush nozzle

# CLEANING AND MAINTENANCE

## Emptying Dust Bin

1. Press dust bin assembly release button (A) and remove dust bin from motor housing (B).
2. Hold the hand vacuum over a trash container.
3. Then, press the bin release button (C) to open bin. Carefully empty contents into a trash container. (If necessary, clean multi-stage filter assembly).
4. To re-install dust bin on motor housing, align dust bin assembly tab (F) and press down towards handle until you hear a "click" to secure dust bin

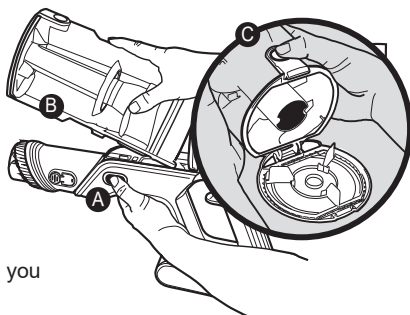

**NOTE:** If suction power seems to diminish, it may be time to empty the dust bin or clean or replace the HEPA filter.

## Cleaning the Dust Bin Filter Assembly

1. Press dust bin assembly release button (A) and remove dust bin assembly from motor housing (B).
2. Remove the hepa filter from the filter assembly by pulling the tab (D). Then remove the foam filter (E) (Clean the hepa filter, foam filter and assembly by rinsing with water-no soap or detergent).

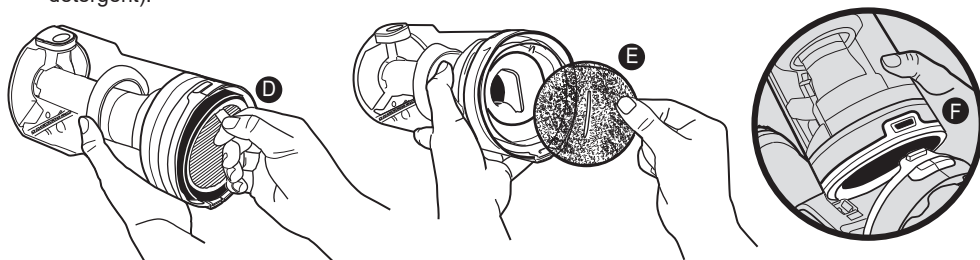

**IMPORTANT:** Make sure Multi-Stage Filter Assembly has the foam filter in place and HEPA filter is inserted securely before re-attaching assembly to motor housing.



**WARNING: DO NOT OPERATE VACUUM CLEANER WITH DAMP OR WET FILTERS OR WITHOUT FILTER IN PLACE.**

## Multi-Stage Filtration

The Cordless Vacuum comes with a Multi-Stage filtration system that sorts and isolates larger particles from fine dust, dirt, and sand.

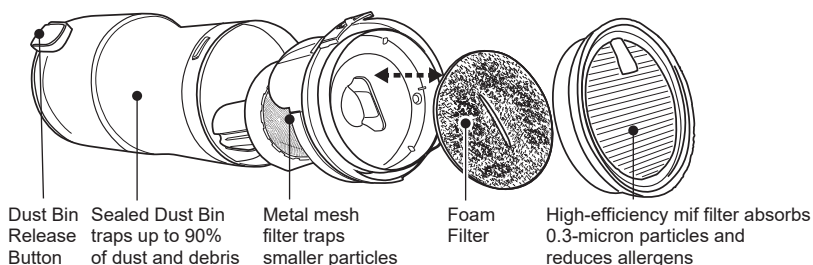

# MAINTENANCE & REPLACEMENT



## BATTERY PROTECTION FEATURES

Lithium-ion batteries deliver fade free power for their entire run time. Lithium-ion products will not gradually lose power due to decreasing battery charge. Instead, power from the battery pack will drop from full to zero once the full charge has been drained from the battery. Once this happens, recharging of the battery is required. It is not necessary to drain the battery pack completely before recharging.

Lithium-ion battery packs are designed with features that protect the lithium-ion cells and maximize battery life. If your vacuum stops during use, release the trigger to reset and resume operation. If the tool still does not work, the battery needs to be recharged.

For battery pack storage longer than 30 days:

- Store the battery pack where the temperature is below 80° F and away from moisture.
- Store battery packs in a 30%-50% charged condition.
- Every six months of storage, charge the pack as normal.

## DETACHABLE/ REPLACEABLE BATTERY

These batteries have been designed to provide maximum trouble-free life. However, like all batteries, they will eventually wear out.

### REMOVING/INSTALLING OF BATTERY:

- 1 Hold handle grip firmly and with your other hand Press the battery release button **(A)** to unlock battery.
- 2 While pressing button pull battery away **(B)** from motor housing to detach battery
- 3 To RE-INSTALL battery, align grooves **(C)** on battery with rails on handle. Push until you hear a "Click"

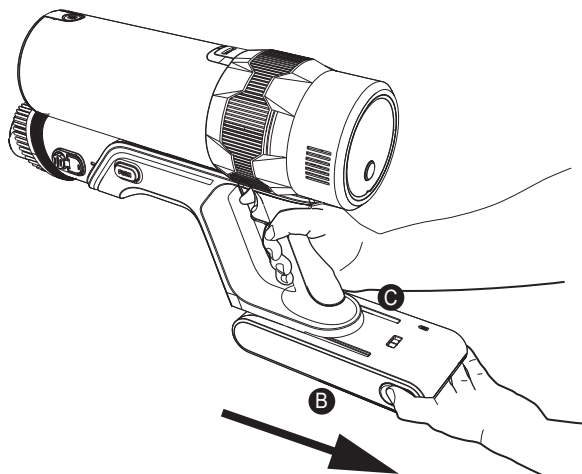
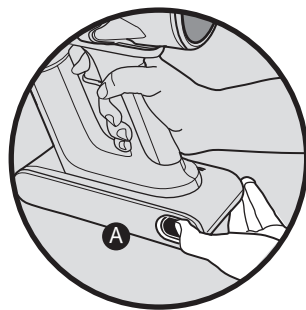

## BATTERY REMOVAL & DISPOSAL

This cordless rechargeable hand vacuum includes a Lithium-Ion battery. You can not dispose of this product with household waste. It must be disposed of safely at a hazardous waste collection site, recycling facility or an electronic retailer that recycles. Check your local or state laws for proper disposal procedures.

# MAINTENANCE & REPLACEMENT

Press the Power Trigger to start and stop cleaning. It automatically defaults to NORMAL suction. Use the SELECTION button to choose from 3 Suction Modes: ECO, NORMAL, TURBO.

- **ECO** for larger rooms and surface areas for up to 60 minutes run time.
- **NORMAL** for smaller rooms and surface areas or an entire vehicle interior for up to 35 minutes run time.
- **TURBO** for quick pick-ups or deep cleaning for up to 15 minutes run time.

During operational use, the digital display will indicate remaining battery charge percentage, **ECO / NORMAL / TURBO** Speed, and any motor blocking or roller brush tangles impacting performance.

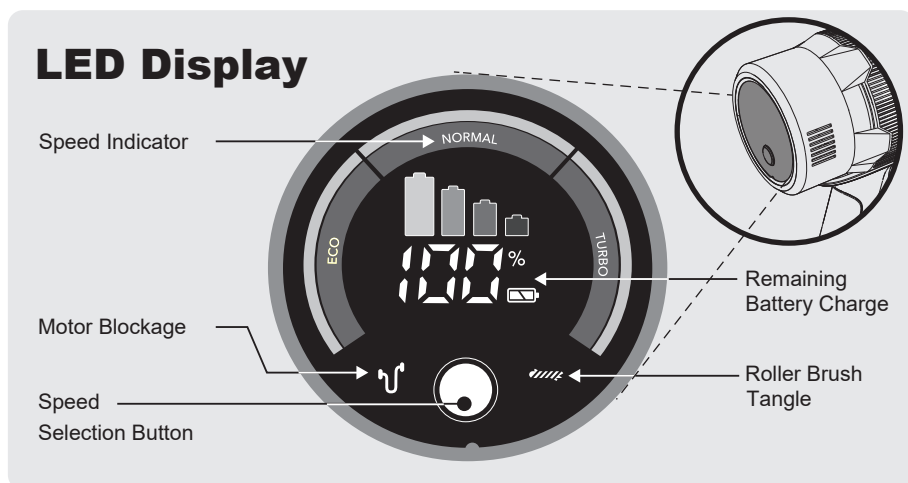

# TROUBLESHOOTING



OBSERVATION	POSSIBLE CAUSE	SOLUTION
No power or vacuum does not charge	<ul style="list-style-type: none"> <li>• Power adapter not plugged into wall outlet securely</li> <li>• Electric wall outlet does not have power</li> <li>• Unit not placed into stand correctly</li> </ul>	<ul style="list-style-type: none"> <li>• Make sure the unit's power cable is securely plugged into the wall outlet</li> <li>• Plug the unit into a different outlet</li> <li>• Make sure charging receptacles on unit touch charging receptacles on charging stand</li> </ul>
Hand Vacuum has diminished suction	<ul style="list-style-type: none"> <li>• Check if the dust bin is full</li> <li>• The air inflow may be blocked</li> <li>• Recharge Unit</li> </ul>	<ul style="list-style-type: none"> <li>• Turn unit off and unplug the appliance from the wall outlet and empty the dust bin</li> <li>• Unplug and remove the nozzle. Check the extension pipe, remove any blockage</li> <li>• Make sure unit is fully charged</li> </ul>
Dust is coming out of the vacuum cleaner	<ul style="list-style-type: none"> <li>• Check if the dust bin is full</li> <li>• Check that the dust bin is properly fitted to the main body</li> <li>• Check if the dust bin filter is in the dust bin</li> </ul>	<ul style="list-style-type: none"> <li>• Empty and clean dust bin</li> <li>• Refit the dust bin to the main body</li> <li>• Install the filter in the dust bin</li> </ul>
Battery no longer charges	<ul style="list-style-type: none"> <li>• The removable rechargeable battery has a long use life but will eventually lose its ability to recharge</li> </ul>	<ul style="list-style-type: none"> <li>• Contact <a href="mailto:support@vortisys.xyz">support@vortisys.xyz</a> to purchase a replacement battery pack</li> </ul>

# TECHNICAL SPECIFICATIONS



Model: V2  
 Voltage / Capacity: 29.6V / 2200mAh  
 Power: 500W  
 Input: 100-240V~, 50/60Hz  
 Motor Rated Voltage: DC 29.6V  
 Battery Type: Lithium-Ion battery  
 Dust Bin Capacity: Approx. 1.3L  
 Operating Time: Approx. 15-60 minutes  
 Suction Power: 45,000 Pa  
 Sound level: Approx. 60dBA  
 Charging Time: 2.0 hours

**ECO Speed Mode:** Operating time is 60 minutes when fully charged

**NORMAL Speed Mode:** Operating time is 35 minutes when fully charged

**TURBO Speed Mode:** Operating time is 15 minutes when fully charged

## PRODUCT DIMENSIONS

Hand Held Vacuum (WDH):  
 15.4" x 4.6" x 10.5"  
 (392 x 118 x 267mm)

Assembled Stick Vacuum  
 Pole NOT Extended (WDH):  
 10" x 10.5" x 42.5"  
 (255 x 267 x 1079mm)

Assembled Stick Vacuum  
 Pole Extended (WDH):  
 10.0" x 10.5" x 51"  
 (255 x 267 x 1294mm)



*Please contact us whenever you want,  
we will be happy to assist you!*



[support@vortisys.xyz](mailto:support@vortisys.xyz)



<https://vortisys.xyz/>



MADE IN CHINA