

## INSTRUCTIONS OF POSITIONING SYSTEM FOR SENSOR

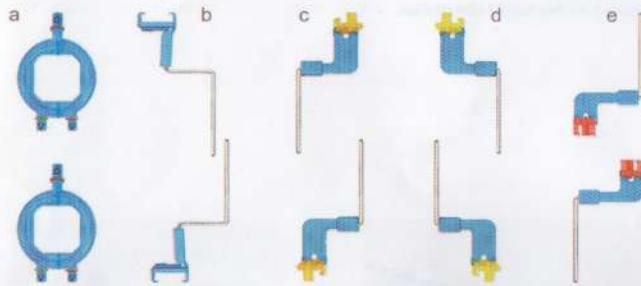

## Kit contains:

- a. Aiming Ring: 2 pcs, blue
- b. Anterior: 2 pcs, blue;
- c. Posterior: upper left and lower right, 2 pcs, orange;
- d. Posterior: lower left and upper right, 2 pcs, yellow;
- e. Bite wing: 2 pcs, red

## Assembly photos for different tooth positions



## Advantages

1. Utilizing the paralleling principal which is more accurate and professional.
2. Used to take images of anterior, posterior and bite wing.
3. Different color-coded bite blocks help distinguish different tooth positions for quick and convenient use.
4. Each intraoral bite block is equipped with a dedicated positioning bar, which is convenient to install and connect with the external aiming ring.
5. The holder on the bite block is compact and easy to hold the sensor. The rubber gaskets help hold the sensor firmly without damaging it.
6. The aiming ring is with three slots, marked with different color-coded rubber rings to distinguish left and right tooth positions for quick use.
7. Autoclavable (The locking block of the holder should be disassembled when being autoclaved).

## Assembling Instructions

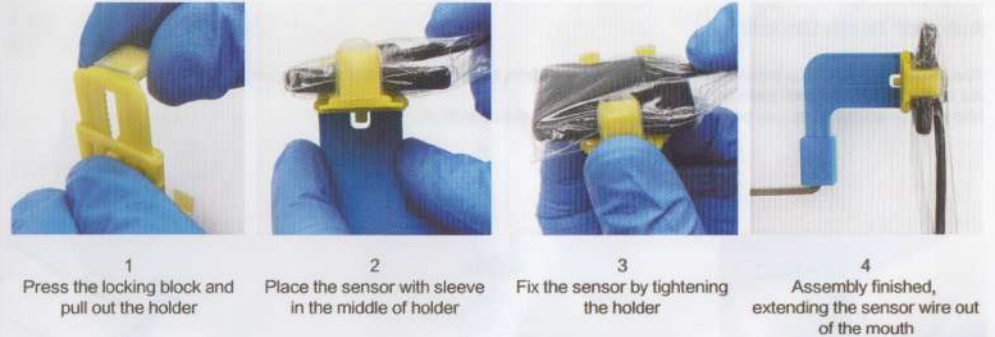

## Assembly photos with sensor

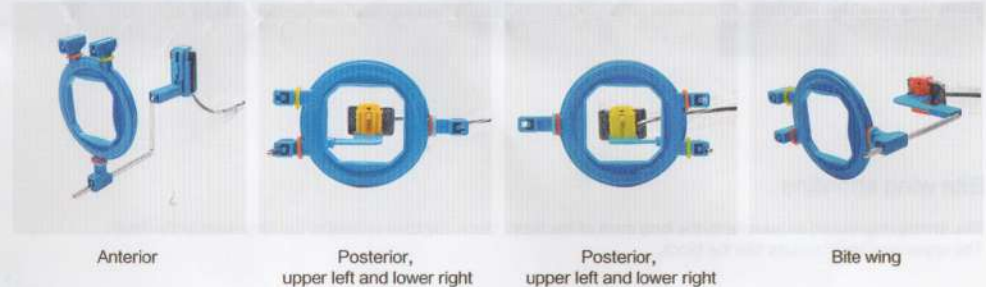

First place the intraoral holder and the sensor vertically, and put them in the mouth. Rotate the sensor to the corresponding tooth position. The upper jaw is near the middle of the palate; the mandibular tongue depressor extends to the posterior space

## Shooting instructions

### Anterior Teeth Shooting

The aiming ring should be parallel to the long axes of the teeth, the x-ray tube vertical to the long axes of the teeth, the incisal edge of anterior teeth on the end of bite block.  
Mild position adjustments can be conducted based on the actual dentition.

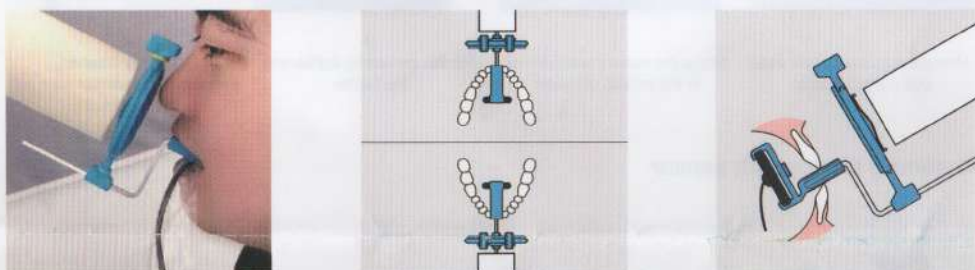

### Bite wing shooting

The aiming ring should be parallel to the long axes of the teeth, the x-ray tube vertical to the long axes of the teeth.  
The upper and lower molars bite the block.

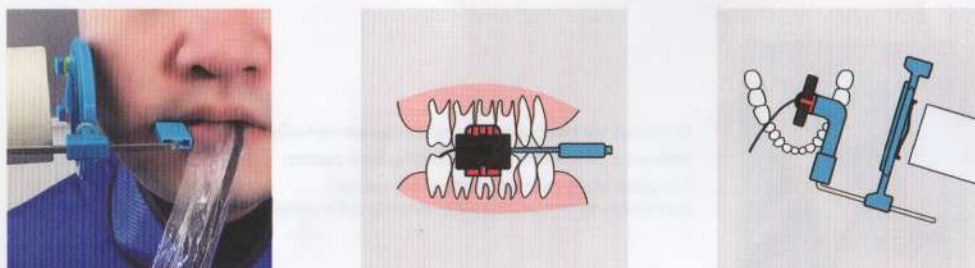

### Posterior Shooting

The aiming ring should be parallel to the long axes of the teeth, the x-ray tube vertical to the long axes of the teeth, incisal edge of maxillary posterior teeth on the end of bite block.  
Cotton roll can be added to increase the occlusal height.  
Mild position adjustments can be conducted based on the height of maxillae.

#### upper left and lower right

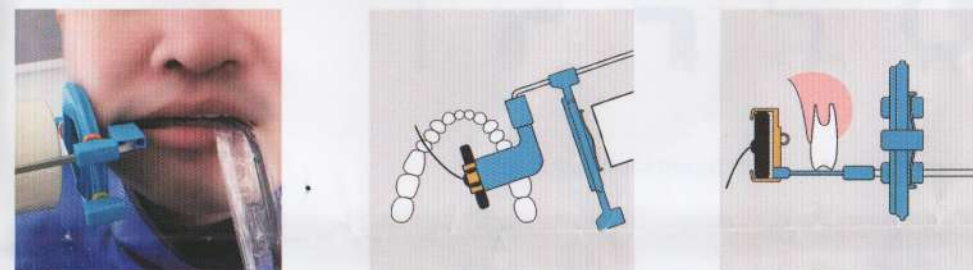

#### lower left and upper right

