

Installation guide

# Thermostatic expansion valves

## Type TU and TC

068R9543



068R9543

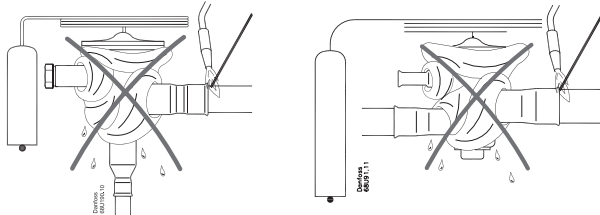

TUE / TCE

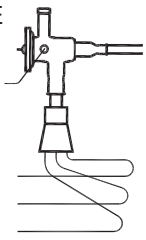

Danfoss  
68U302.10

TUE / TCE

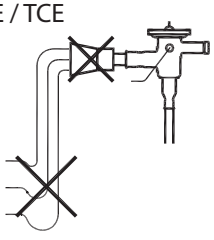

Danfoss  
68U303.10

TU / TC

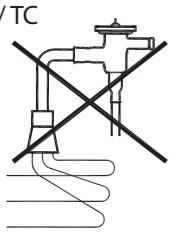

Danfoss  
68U304.10

1

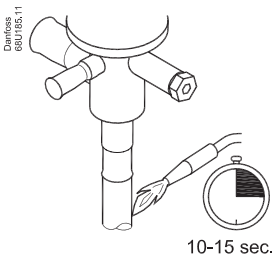

Danfoss  
68U185.11

2

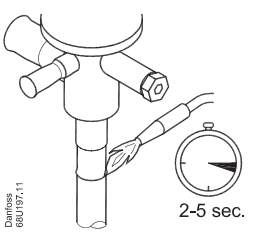

Danfoss  
68U187.11

3

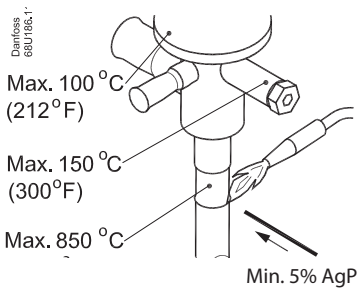

Danfoss  
68U185.11

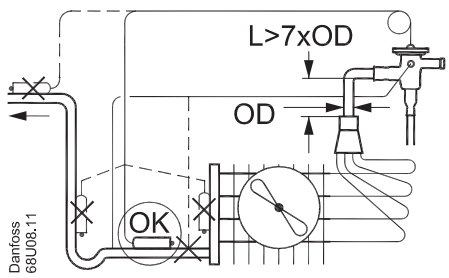

Danfoss  
68U08.11

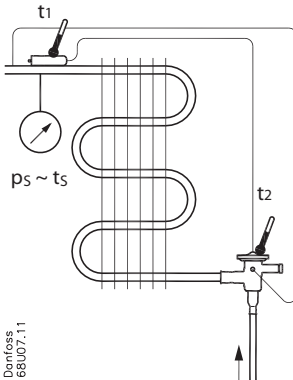
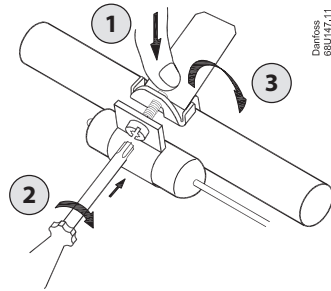
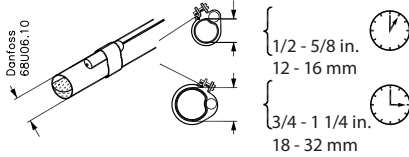

TU/TCMOP:  $t_2 > t_1$   
 Superheat SH =  $t_1 - t_2$

Factory setting  
 Static superheat:

N, B: 4 °C (7 °F)  
 NMOP, NM: 4 °C (7 °F)  
 BMOP: 4 °C (7 °F)

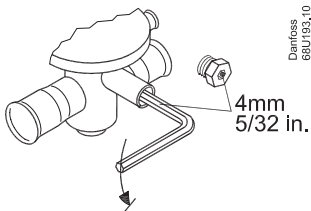

TU

R22 R407C	R134a R513A	R404A R507 R410A	$\Delta SS$ 1 ×
	N		2 °C (3.6 °F)
N	NM	N,B	2.5 °C (4.5 °F)
NM,B		NM	3 °C (5.4 °F)

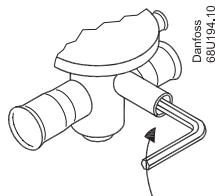

TC

R22 R407C	R134a R513A	R404A R507	R410A	$\Delta SS$ 1 ×
	N			1 °C (1.8 °F)
N	NM	N,B	N,B	1.5 °C (2.7 °F)
NM,B		NM	NM	2 °C (3.6 °F)

Temperature ranges:

N = -40 - 10 °C / -40 - 60 °F

NM = -40 - -5 °C / -40 - 25 °F

B = -60 - -25 °C / -75 - -15 °F