

Product Description**RBW101, RBW103, RBW106, RBW108****Room Control Modules RBW101, RBW103, RBW106, RBW108****Application**

Room control modules with room temperature sensors and manual setting of the room temperature setpoint for use with a technolon® room controller. A room control module can be connected to each technolon® room controller. The technolon® room controller can be identified on the LON network quickly and easily by entering the service PIN directly on the room control module.

To be used only with technolon® room controllers RCN092-L to RCN142-L.

The RBW103 room control module also includes operating buttons for switching the occupancy between “present” and “absent.”

The RBW106 room control module also includes operating buttons for switching between three fan levels as well as a button for automatic mode.

Like the RBW103, the RBW108 room control module also includes operating buttons for switching between three fan levels as well as a button for automatic mode.

**RBW101****RBW103****RBW106****RBW108**

Content	Page
Important Information Regarding Product Safety	2
Item	3
Technical Data	3
Accessories (not included in delivery)	3
Dimensions	4
Connection	4
Mounting	4
Network installation	6

Änderungen vorbehalten - Contents subject to change - Sous réserve de modifications - Reservado el derecho a modificación - Wijzigingen voorbehouden - Con riserva di modifiche - Innehåll som skall ändras - Změny vyhrazeny - Zmiany zastrzeżone - Возможны изменения - A változtatások jogát fenntartjuk - 保留未经通知而改动的权力

Important Information Regarding Product Safety

Safety Instructions

This data sheet contains information on installing and commissioning the product "RBW101, RBW103, RBW106, RBW108". Each person who carries out work on this product must have read and understood this data sheet. If you have any questions that are not resolved by this data sheet, you can obtain further information from the supplier or manufacturer.

If the product is not used in accordance with this data sheet, the protection provided will be impaired.

Applicable regulations must be observed when installing and using the device. Within the EU, these include regulations regarding occupational safety and accident prevention as well as those from the VDE (Association for Electrical, Electronic & Information Technologies). If the device is used in other countries, it is the responsibility of the system installer or operator to comply with local regulations.

Mounting, installation and commissioning work on the devices may only be carried out by qualified technicians. Qualified technicians are persons who are familiar with the described product and who can assess given tasks and recognize possible dangers due to technical training, knowledge and experience as well as knowledge of the appropriate regulations.

Legend



WARNING

Indicates a hazard of medium risk which can result in death or severe bodily injury if it is not avoided.



CAUTION

Indicates a hazard of low risk which can result in minor or medium bodily injury if it is not avoided.



CAUTION

Indicates a hazard of medium risk which can result in material damage or malfunctions if it is not avoided.



NOTE

Indicates additional information that can simplify the work with the product for you.















Notes on Disposal

For disposal, the product is considered waste from electrical and electronic equipment (electronic waste) and must not be disposed of as household waste. Special treatment for specific components may be legally binding or ecologically sensible. The local and currently applicable legislation must be observed.

Product Description**RBW101, RBW103, RBW106, RBW108****Item**

RBW101	Room control module with room temperature sensor and manual setting of the room temperature setpoint.
RBW103	Room control module with room temperature sensor and manual setting of the room temperature setpoint, with operating buttons for switching between “present” and “absent.”
RBW106	Room control module with room temperature sensor and manual setting of the room temperature setpoint, with operating buttons for switching between three fan levels as well as a button for automatic mode.
RBW108	Room control module with room temperature sensor and manual setting of the room temperature setpoint, with operating buttons for switching between “present” and “absent,” buttons for switching between three fan levels as well as a button for automatic mode.

Technical Data

Nominal voltage	DC 5 V ± 20%, 25 mA
Measured value	Room temperature of spaces in homes or offices
Measuring systems	Integrated digital room sensor
Setpoint adjuster	Digital, setting knob with trend arrows
Measuring range	0 °C to 45 °C
Operating buttons	Back-lit
	RBW103  Button to set occupancy to “present”
	 Button to set occupancy to “absent”
	RBW106      Buttons to switch between fan levels (off, level 1, level 2, level 3 and automatic mode)
	RBW108  Button to set occupancy to “present”
	 Button to set occupancy to “absent”
	     Buttons to switch between fan levels (off, level 1, level 2, level 3 and automatic mode)
Ambient temperature	0 °C to 45 °C
Ambient humidity	Non-condensing
Installation	Mounted on wall or on flush-mounted box
Interface for room control module	4-wire or RJ9 socket, for connecting to a technolon® RCNxxx-L room controller, max. cable length 20 m
Degree of protection	IP30
Dimensions	WxHxD mm 82.5 x 82.5 x 30
Weight	0.11 kg

Accessories (not included in delivery)

Z178	Connection line: room control module <> room controller (RJ plug on both sides, 10 m)
Z178/2	Adapter: RJ plug - terminal block, 4-pole (15 cm)
Z178-15M	Connection line: room control module <> room controller (RJ plug on both sides, 15 m)
Z178-CIAT V	Connection line: room control module <> room controller (RJ plug on both sides, 1,5 m)

Dimensions

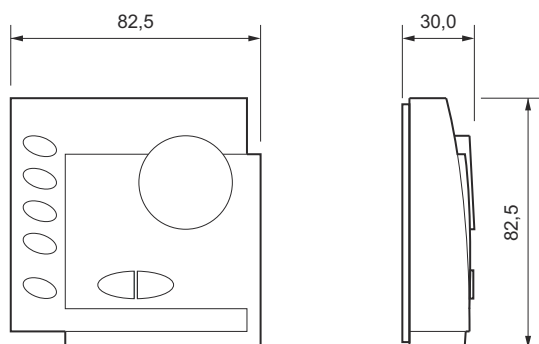

Connection

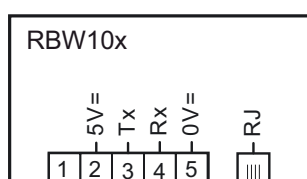

Mounting



WARNING

Contact with live parts of electrical domestic installation can cause death due to electric shock. Mounting/removal may only be carried out when power is switched off.

The room control module can be mounted on the wall or onto a flush-mounted box.

Choose an installation location that is subject to the air flow of the room to ensure that the room controller can quickly and accurately measure the room temperature.

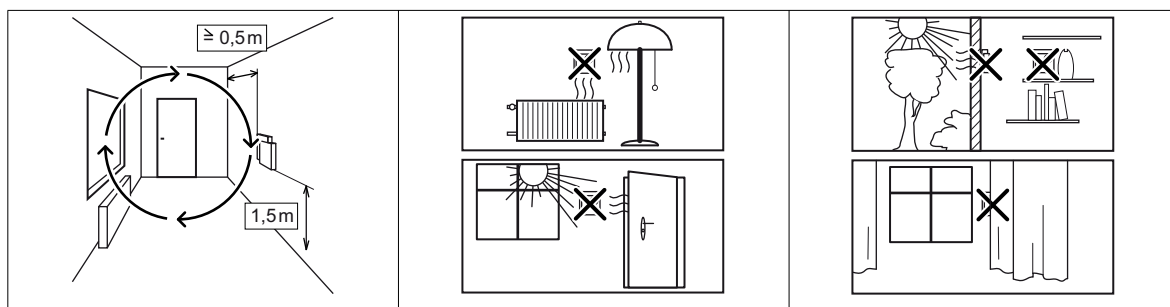

CAUTION

Lines for the power supply and Rx/Tx are to be laid together in one shielded cable that is a maximum of 20 m, cable type at least 0.8 mm in diameter, with the wires twisted together in pairs.

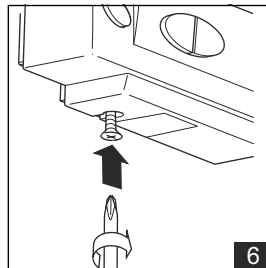
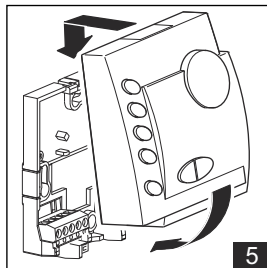
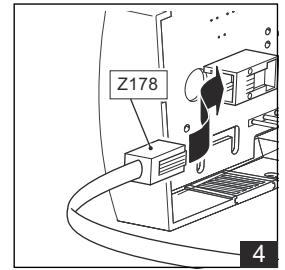
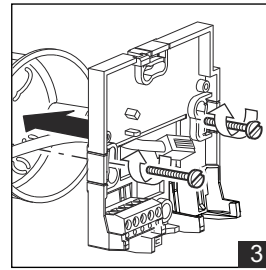
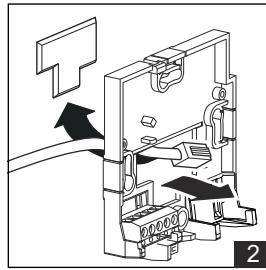
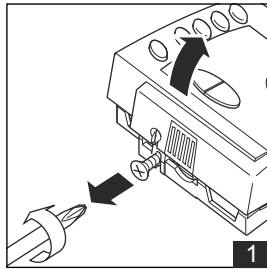
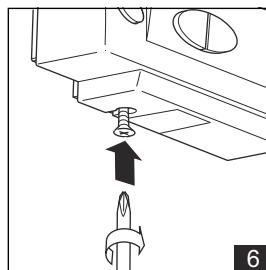
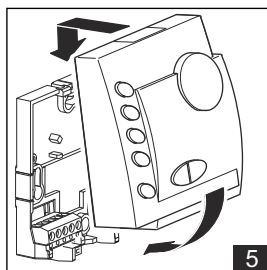
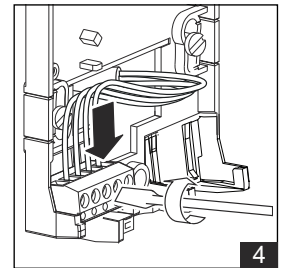
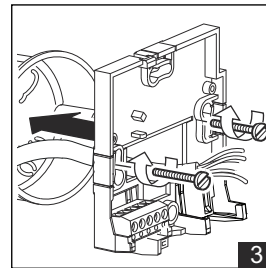
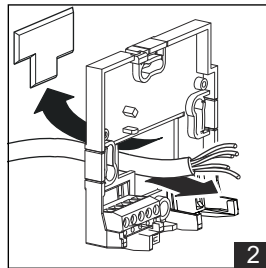
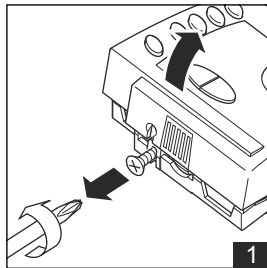
Product Description**RBW101, RBW103, RBW106, RBW108****- RJ9 socket (connection with pre-assembled cable)****4-wire (connection to terminals)**

Network installation

Network installation is performed using a network management tool based on LonWorks LNS3 network services.

Offline installation

The neuron ID of the technolon® room controller can be found on the included pull-off bar code label, which is used for system documentation.

A simple bar code reader can be used for reading in the neuron ID.

Online installation

- Online installation on the technolon® room controller RCNxxx-L:

The node is identified by manually inputting the neuron ID code or by activating the service PIN (1) on the technolon® room controller RCNxxx-L.

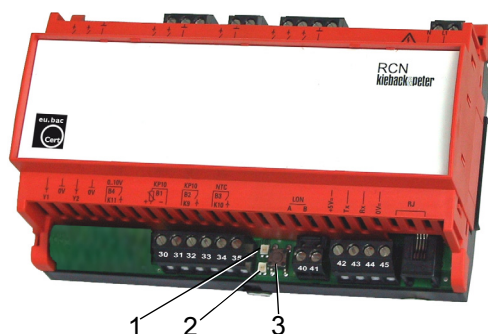

- (1) Operating voltage and service LED
- (2) Status LED
- (3) Service PIN

- Online installation on the RBW10x room control module:

The RCNxxx-L technolon® room controller can also be identified quickly and easily directly on the RBW10x room control module using a magnet (5). To do so, guide a magnet (5) along the right side of the RBW10x room control module.

Internally, this triggers the service PIN in the RCN room controller. This is indicated when the service LED (4) on the top part of the RBW10x housing lights up green.



RBW108