



Download  
Manual

Shenzhen Growatt New Energy Co., Ltd  
4-13/F, Building A, Sino-German (Europe) Industrial Park,  
Hangcheng Ave, Bao'an District, Shenzhen, China

T +86 755 2747 1942  
E [service@ginverter.com](mailto:service@ginverter.com)  
W [www.ginverter.com](http://www.ginverter.com)  
GR-UM-258-A1-00



Battery HUB User Manual

# Contents

## 1 Product Overview

- 1.1 Intended Use
- 1.2 Appearance
- 1.3 Working Principle and Function

## 2 Name plate

## 3 Installation

- 3.1 Installation environment
- 3.2 Basic Installation Requirements
- 3.3 Installation Required Tools
- 3.4 Installation Procedures
- 3.5 Cable Installation

## 4 Terminal Definition

# 1 Product Overview

## 1.1 Intended Use

The Battery HUB is designed to be applied to multiple batteries in parallel. Its main function is to enlarge the capacity of batteries in parallel. The following specifically introduces the content of Battery HUB.

## 1.2 Appearance

The appearance of Battery HUB is shown as below:

Dimension (unit: mm)

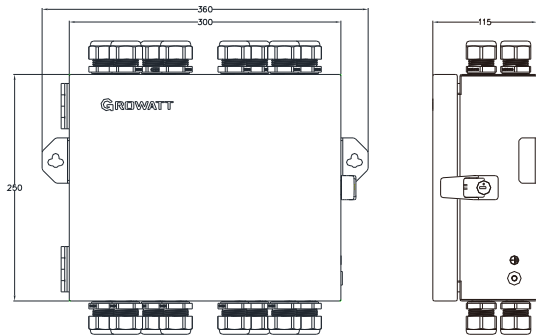

Fig 1.1: Dimension

## 1.3 Working Principle and Function

The Battery HUB is designed for multiple batteries in parallel. A maximum of 4 battery groups connected in parallel is allowed to increase the capacity and power of the battery system. Waterproof connectors are compatible with cables with diameters of 7mm, 10mm, and 12mm.

# Nameplate 2



GROWATT	
Model	Battery HUB
Nominal Voltage	40~800V
Max DC Current	700A
Ingress Protection	IP65
Operating Ambient Temperature	-10°C ~ +50°C
<div></div> <div>X<span style="float: right;">Made In China</span></div>	

Fig 2.1: Nameplate

# Installation 3

## 3.1 Installation environment

The ambient temperature for the installation of the battery system shall be above -10°C, below 50°C, and the humidity shall between 5% and 95%.



Fig 3.1: Installation environment requirements

### 3.2 Basic Installation Requirement

➤ The Battery HUB can be installed indoors and outdoors. The following conditions are allowed:

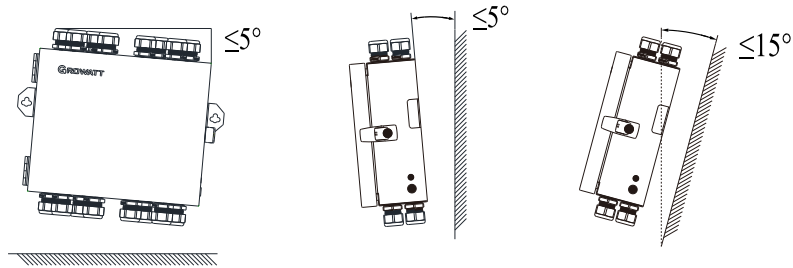









Fig 3.2: Acceptable wall mounted installation

### 3.3 Installation Required Tools

The following tools are required to install the Battery HUB:

			
Drill	Screw Driver	Wrench	Pencil
			
Tap Measure	Multimeter	5mm Allen key	

It is recommended to wear the following safety gear when dealing with the PACK.

		
Insulated Glove	Safety Goggle	Safety Shoes

### 3.4 Installation Procedures

#### Pre-installation Check

Check the package	Check the Battery HUB package before open it. If any abnormality is detected, do not open the Package and contact your distributor.
Check deliverable	Check the quantity of all parts inside according to the package list. If there is any part missing or damaged, please contact your distributor.

#### Check Packing List

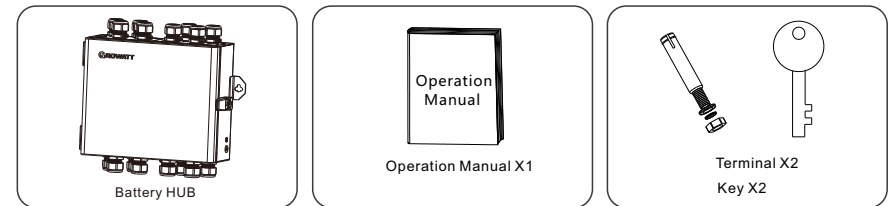

#### Installation

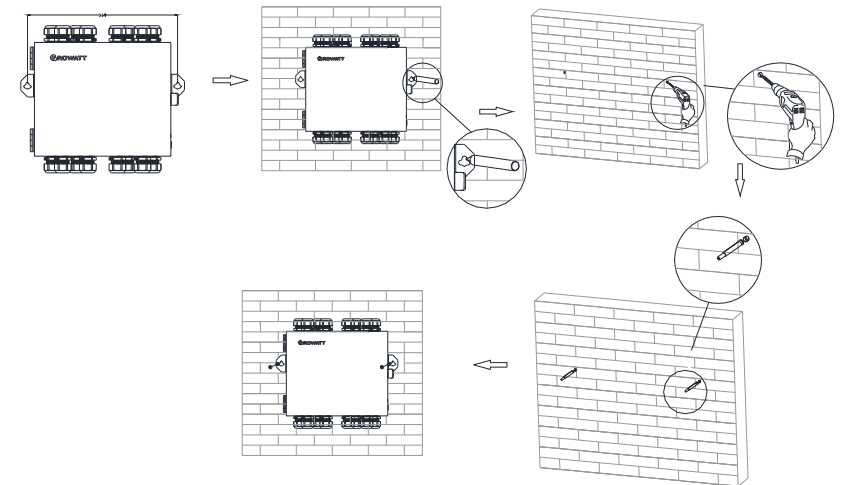
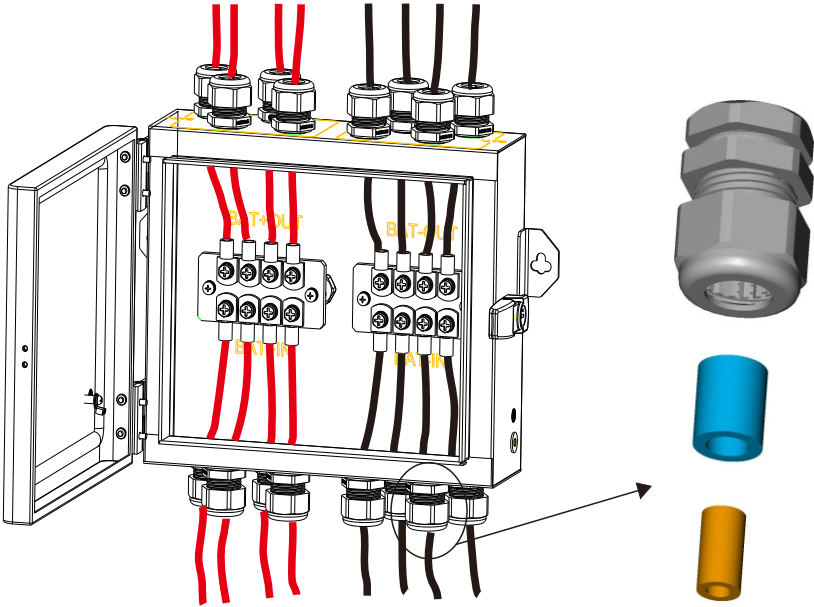
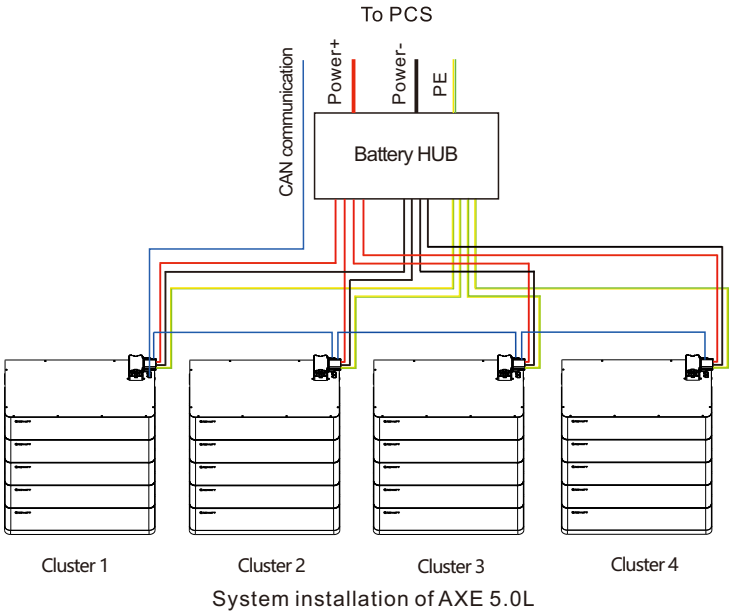

Fig 3.3: Multiple Battery HUB installation process

- Step 1: Please make sure that the thickness of the wall for Battery HUB installations is more than 120mm.  
 Step 2: Hold the Battery HUB against the wall and choose two suitable points for hole drilling, then mark the points.  
 Step 3: Drill a hole at the marked points with a depth of 55mm at the mark with a drill of  $\phi 8$ .  
 Step 4: Put the Battery HUB against the wall and install the safety screws on both sides of Battery HUB.

3.5 Cable Installation



Inside cable installation of Battery HUB

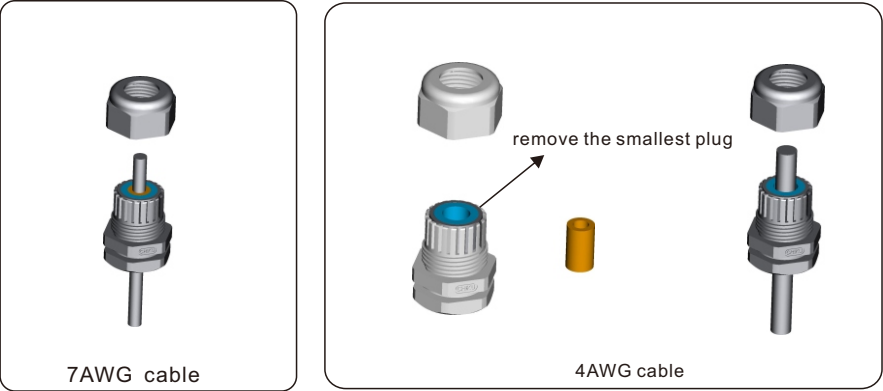
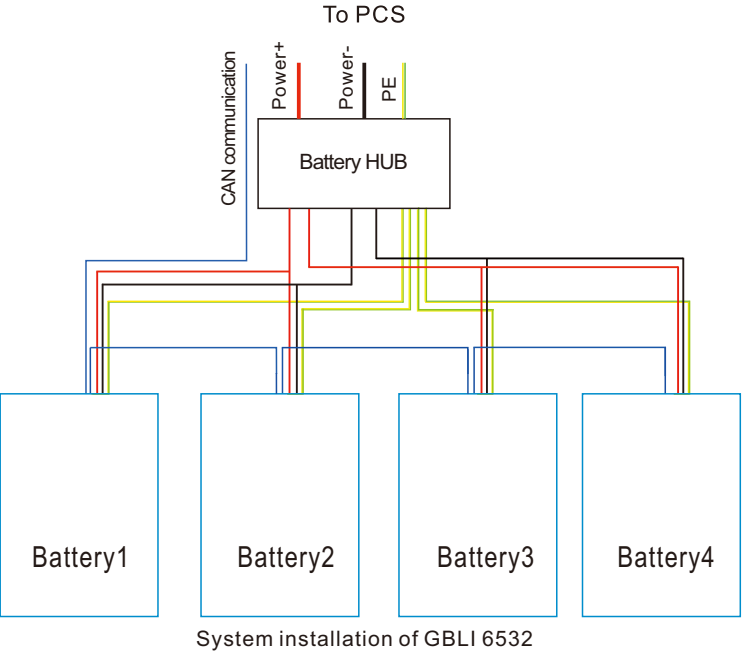

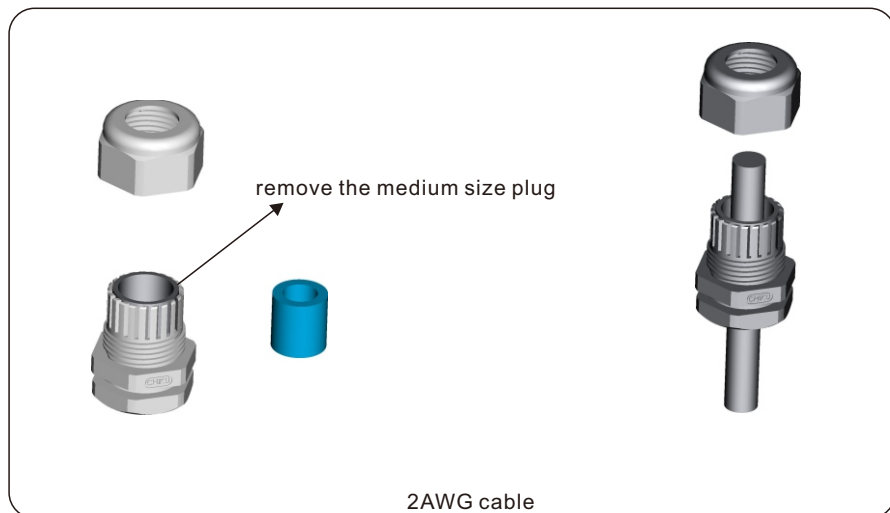

Installation process of different size cables

## 4 Terminal Definition

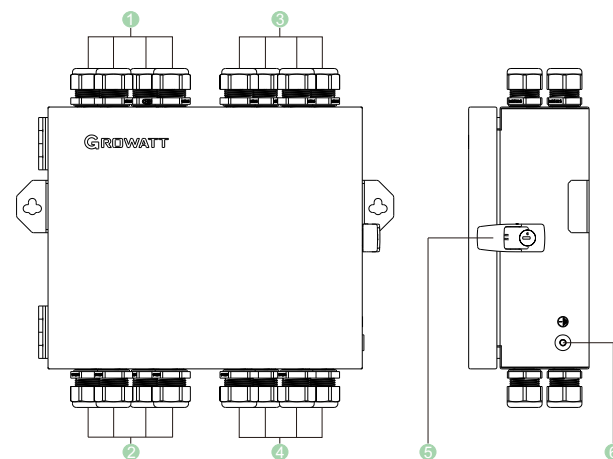

Fig 4.1: Terminal Definition

Serial number	Item	Specifications	Symbol
1	Positive terminal	IP67–Red connector	BAT+
2	Positive terminal	IP67–Red connector	BAT+
3	Negative terminal	IP67–Black connector	BAT-
4	Negative terminal	IP67–Black connector	BAT-
5	LOCK	TURN OFF	KEY
6	Grounding terminal	M6 screw	⊕

Shenzhen Growatt New Energy Co., Ltd  
 4-13/F,BuildingA,Sino-German(Europe)IndustrialPark,  
 HangchengAve,Bao'anDistrict,Shenzhen,China

T +86 755 2747 1942  
 E service@ginverter.com  
 W www.ginverter.com