

# ARGON 18



VALID FOR MY2023 VERSION 2.1 / 2023-03-20 - ARTWORK 360A/360B

# SUBITO

# ARGON 18



VALID FOR MY2023 VERSION 2.1 / 2023-03-20 - ARTWORK 360A/360B

# SUBITO

## TABLE OF CONTENTS

|   |       |
|---|-------|
| 1. Tools Needed & First Aid Kit                         | 4     |
| 2. Frameset Inspection                                  | 5     |
| 3. Troubleshooting / Tips / Specifications              | 6     |
| 4. Frameset SKUs and Descriptions                       | 7-9   |
| 5. MAHLE X35+ SKUs and Descriptions – North America     | 10-11 |
| 6. MAHLE X35+ SKUs and Descriptions – EU                | 12-13 |
| 7. Seat Post Collar Assembly                            | 14    |
| 8. Seat Post Assembly                                   | 15    |
| 9. Rear Derailleur Hanger Adjustment                    | 16    |
| 10. Front Derailleur Hanger Assembly                    | 17    |
| 11. MAHLE X35+ Components Assembly                      | 18-22 |
| 12. Cable and Housing Routing – Light                   | 23    |
| 13. Rear Light Installation                             | 24    |
| 14. 3D Headset Installation                             | 25    |
| 15. Cable and Housing Routing – Mechanical Shifting     | 26-29 |
| 16. Cable and Housing Routing – Mech. 1X Shifting       | 30-32 |
| 17. Cable and Housing Routing – Elec. Wire Routing      | 33-36 |
| 18. Cable and Housing Routing – Elec. Wireless Routing  | 37-39 |
| 19. Cable and Housing Routing – Dropper Seatpost        | 40    |
| 20. Front Light Installation                            | 41    |
| 21. Cable and Housing Routing – Front Grommet Selection | 42    |
| 22. Headset Installation                                | 43    |
| 23. Rear Wheel Installation                             | 44-46 |
| 24. BB Cover installation                               | 47    |
| 25. Chain Catcher                                       | 48    |
| 26. Rear Rack and Fender Installation                   | 49    |
| 27. Front Fender Installation                           | 50    |
| 28. Range Extender and Water Bottle Position            | 51    |
| 29. Seat Post Minimum and Maximum Insertion             | 52    |
| 30. Additionnal Documentation                           | 53    |

*To maintain the validity of the warranty, the bicycle must be fully assembled by an authorized Argon 18 dealer. High-end components, particularly carbon parts, require extra care during assembly.*

*These components must be installed using a torque wrench to ensure each bolt is at the specified torque setting to prevent damage.*

## AMP UP YOUR NEXT ADVENTURE



### MY SUBITO

Date of Purchase: \_\_\_\_\_

Retailer: \_\_\_\_\_

Size: \_\_\_\_\_

Serial Number: \_\_\_\_\_

Hub Serial Number: \_\_\_\_\_

# 1. TOOLS NEEDED & FIRST AID KIT

1. Bearing Cup Press

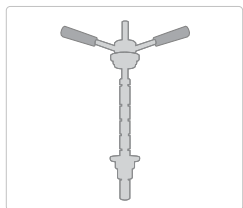

2. Allen Key Set

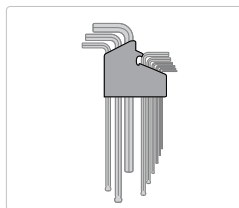

3. Torx T25 Key



4. Carbon Paste & Grease

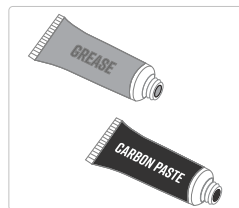

5. Utility Picks

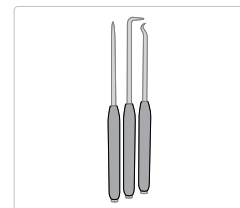

6. Clean Rag

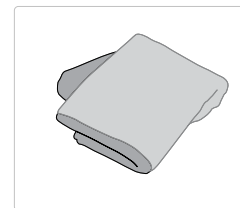

7. Derailleur Hanger Alignment Gauge

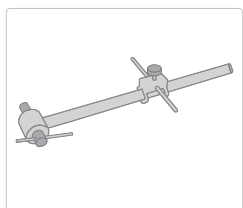

8. Cables and Housing Cutter

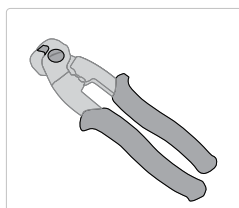

9. Thread Locker Medium strength



10. Isopropyl Alcohol

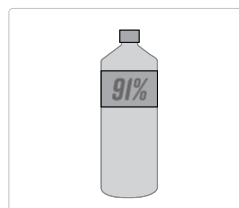

11. Torque Wrench

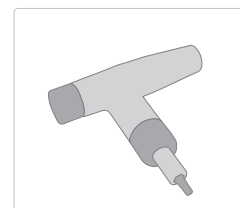

12. Cassette Lockring

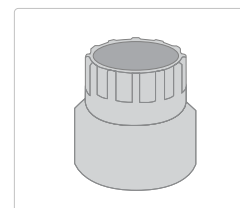

**IMPORTANT:**

First Aid Kit: Essential parts to always have on hand IN CASE OF EMERGENCY...THIS MIGHT SAVE YOUR RIDE!

1. Seat Post Clamp



2. Spare Rear Derailleur Hanger



## 2. FRAMESET INSPECTION

Before assembling your new Subito, please verify that you have all the following:

1. Frameset parts checklist (see p.7-9)
2. MAHLE X35+ parts checklist (see p.10-13)
3. Inspect the frame for cosmetic defects (scratches, bumps, cracks, paint defects, etc.)
4. For reference, record serial number on p.3
5. All the necessary bolts (refer to frameset parts, p.7-9)
6. For optimal shifting performance, use a derailleur alignment gauge to make sure that the derailleur hanger is straight



### IMPORTANT:

Some of the following parts are already assembled on the frame. When assembling the bike, you will need to adjust these parts according to their torque specifications and fastener conditions when necessary.

| NO. | AIB SKU#       | FUNCTION                | DESCRIPTION         | SCREW TYPE        | TORQUE       | THREAD CONDITION | QTY |
|-----|----------------|-------------------------|---------------------|-------------------|--------------|------------------|-----|
| 1   | 80806*         | Chain Catcher Screw     | M5 x 25mm Screw     | Socket Head       | 3Nm          | Nylock           | 1   |
| 2   | 81248          | FD Hanger Screw         | M5 x 16mm Screw     | Flat Head         | 3Nm          | Grease           | 2   |
| 3   | 81249          | Water Bottle Screw      | M5 x 14mm Screw     | Button Head       | 3Nm          | Grease           | 4   |
| 4   | 200898         | Battery Screw           | M5 x 8mm Screw      | Button Head       | 5Nm          | Dry              | 3   |
| 5   | 81251          | BB Cover Screw          | M4 x 10mm Screw     | Button Head       | Hand Tighten | Dry              | 2   |
| 7   | 81252          | Charger Connector Screw | M3 x 10mm Screw     | Flat Head         | Hand Tighten | Dry              | 2   |
| 8   | 81252          | One Remote Holder Screw | M3 x 10mm Screw     | Flat Head         | Hand Tighten | Dry              | 1   |
| 9   | 81252          | Cable Clip Screw        | M3 x 10mm Screw     | Flat Head         | Hand Tighten | Dry              | 1   |
| 10  | 81253          | RD Hanger Screw         | M3 x 8mm Screw      | Flat Head         | 2Nm          | Dry              | 2   |
| 11  | 81254          | PAS Sensor Screw        | M4 x 5mm Screw      | Set Screw         | Hand Tighten | Dry              | 1   |
| 12  | 81255          | Rear Disc Screw         | M5 x 8mm Torx Screw | Button Head       | 4Nm          | Thread-Locker    | 6   |
| 13  | 80801*         | Seat Post Collar Screw  | M5 x 22mm Screw     | Socket Head       | 4Nm          | Grease           | 1   |
| 14  | SP.KRYCS.273B* | Seat Post Rear Screw    | M6 x 28mm Screw     | -                 | 9.5Nm        | Grease           | 1   |
| 15  | 81052          | Front Thru Axle         | M12 x 1.5 Axle      | -                 | 12Nm         | Grease           | 1   |
| 16  | 81228          | Motor Lock Nut          | M12 x 1.5 Nut       | Rear Wheel Nut    | 35Nm         | Grease           | 2   |
| 17  | 81227          | Magnet Lock Nut         | -                   | Cassette Lockring | 40Nm         | Grease           | 1   |

\* Included with SKU

### 3. TROUBLESHOOTING / TIPS / SPECIFICATIONS

#### Brakes

Use only flat mount disc brakes. The frame is compatible with 160/180mm disc rotors. The rear caliper installation does not require an adapter for 160mm discs. Refer to 140mm disc rotor brake manufacturer's instructions. Rear mount thickness: 30mm.

The fork is compatible with 140/160mm disc rotors. An adapter might be required for front caliper installation. Consult brake manufacturer's instructions.

#### Tire Clearance

**700c** The largest tires that can be installed must be no wider than 40mm for the front and rear wheels. If fenders are installed, the tires must be no wider than 35mm.

**650c** The largest tires that can be installed must be no wider than 45mm for the front and rear wheels. If fenders are installed, the tires must be no wider than 40mm.

#### Seat Post

Ø 27.2mm

The saddle clamp is compatible with saddle rail up to 9 x 7mm.

#### Seat Post Collar

Ø 31.8mm

#### Bottom Bracket

BB86 (Press-fit)

#### Headset

Argon18 exclusive, FSA No 69 SRS + IST2 3D Press-fit (Bearing 1 1/2", 36° x 45° Top and Bottom + FSA TH-881-1 Compressor included)



#### IMPORTANT:

No more than 30mm of spacers can be placed between the stem and the top cap of the 3D system. The use of more than 5mm of spacers on top of the stem could affect the efficiency of the compressor. These practices will automatically void any warranty claim against the manufacturer.



#### IMPORTANT:

The MAHLE X35+ system is shipped to retailers in Demo mode. When the bike is sold, it must be taken out of Demo mode. Please see related documentation on our B2B portal. Demo mode will allow for a maximum of 50km of riding, after which the motor will stop working.

## 4.1 FRAMESET SKUS AND DESCRIPTIONS

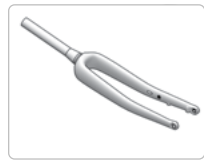

FK.SUBR.M-XL.360A  
FK.SUBR.XXS-S.360A  
FK.SUBG.M-XL.360B  
FK.SUBG.XXS-S.360B

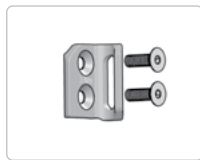

81238 &  
81248 (screws)



38446



80811



100312



81252



80801



81255



81234



81235 &  
81253 (screws)



80806

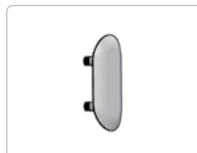

81240



80264



81254



81054

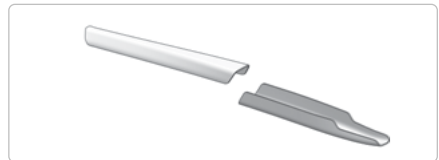

81045



SP.SUBI.273A.LIGHT



80808



200898



81242



80804

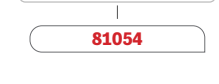

80805



100165



100163 &  
100164 (Bracket)



100166



100571 (360A)  
100572 (360B)



81249



80826



81239 &  
81252 (screw)



80805



100313



100314



100315



100316

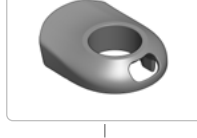

100569 (360A)  
100570 (360B)



80549



80550



81052



200829

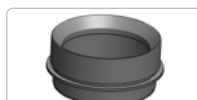

200845



81241 &  
81251 (screws)



80988



80551



80985

## 4.2 FRAMESET SKUS AND DESCRIPTIONS

| NO. | NAME   | A18 SKU#   | QTY |
|-----|--|--|-----|
| 1   | Subito Frame   | Not available as spare part.   | 1   |
| 2   | Subito Fork (XSS/XS/S)<br>-OR-<br>Subito Fork (M/L/XL) | FK.SUBR.XXS-S.360A<br>FK.SUBG.XXS-S.360B<br>FK.SUBR.M-XL.360A<br>FK.SUBG.M-XL.360B | 1   |
| 3   | Subito Seatpost With Hole                              | SP.SUBI.273A.LIGHT   | 1   |
| 4   | Seatpost Collar 31.8mm                                 | 80801  | 1   |
| 5   | Rear Derailleur Hanger                                 | 81235  | 1   |
| 6   | FD Hanger Removable                                    | 81238  | 1   |
| 7   | CS Wire Clip   | 81239  | 1   |
| 8   | FD Plug  | 81240  | 1   |
| 9   | BB Opening Cover                                       | 81241  | 1   |
| 10  | FD Cable Stopper                                       | 81242  | 1   |
| 11  | Oblong Plug  | 80549  | 1   |
| 12  | Cable Guide Oblong                                     | 80550  | 1   |
| 13  | Chain Catcher (Incl. Small/Large, Washer and Screw)    | 80806  | 1   |
| 14  | Plastic Plug M5  | 80264  | 9   |
| 15  | Long Grommet Mechanical                                | 80985  | 2   |
| 16  | Long Plug Grommet                                      | 80804  | 4   |
| 17  | Long Grommet Di2                                       | 80805  | 3   |
| 18  | Rear Brake Oblong Cable Guide                          | 80551  | 2   |
| 19  | Oblong Plug  | 80826  | 1   |
| 20  | Foam Liner   | 80811  | 3   |
| 21  | FSA Headset NO.69/SRS System                           | 100312   | 1   |
| 22  | A18 Front Thru Axle M12 x 1.5 x 119                    | 81052  | 1   |
| 23  | A18 Thru Axle Lever                                    | 81054  | 1   |
| 24  | Fender Bracket   | 80808  | 1   |
| 25  | Battery Holder   | 38446  | 1   |
| 26  | FD Hanger Screw  | 81248  | 2   |
| 27  | Water Bottle Screw                                     | 81249  | 4   |
| 28  | Battery Screw  | 200898   | 3   |
| 29  | BB Cover Screw   | 81251  | 2   |



### 4.3 FRAMESET SKUS AND DESCRIPTIONS

| <b>NO.</b> | <b>NAME</b>   | <b>AIB SKU#</b>                        | <b>QTY</b> |
|------------|---|--|------------|
| 30         | Charger Connector, One Remote Holder and Cable Clip Screw                     | 81252                                  | 4          |
| 31         | RD Hanger Screw   | 81253                                  | 2          |
| 32         | PAS Sensor Screw  | 81254                                  | 1          |
| 33         | Rear Disc Screw   | 81255                                  | 6          |
| 34         | IST2 SRS Custom Cap   | 100569 (360A)<br>-OR-<br>100570 (360B) | 1          |
| 35         | IST2 25mm Cap   | 100571 (360A)<br>-OR-<br>100572 (360B) | 1          |
| 36         | IST2 25mm Column  | 200845                                 | 1          |
| 37         | IST2 Sleeve   | 200829                                 | 1          |
| 38         | Dirt Guard Kit, Two Parts   | 80988                                  | 1          |
| 39         | CS Protector (Same as Dark Matter, Refer to Subito Installation Instructions) | 81045                                  | 1          |
| 40         | Chainsuck Guard   | 81234                                  | 1          |
| 41         | LiteMove Front Light + Cable 450mm  | 100163                                 | 1          |
| 42         | LiteMove Front Light Bracket  | 100164                                 | 1          |
| 43         | LiteMove Rear Light   | 100165                                 | 1          |
| 44         | LiteMove Cable Connector  | 100166                                 | 1          |
| 45         | Connector Housing FEMALE Socket, 2 pin, Rectangular, Waterproof               | 100313                                 | 1          |
| 46         | Connector Housing MALE Socket, 2 pin, Rectangular, Waterproof                 | 100314                                 | 1          |
| 47         | Connector Crimp PIN JWPF, 22-26 AWG   | 100315                                 | 2          |
| 48         | Connector Crimp SOCKET JWPF, 22-26 AWG  | 100316                                 | 2          |

## 5.1. MAHLE X35+ SKUS AND DESCRIPTIONS – NORTH AMERICA

### North American Version

81184 (314A) 700C  
81192 (314B) 650B



81183 (314A) 700C  
81185 (314B) 650B



### Available Separately

\*81233\*



### North American Version 81217



81227



81218



81229

### North American Version

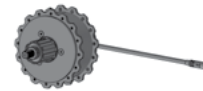

81225

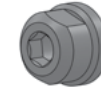

81228



81230



81226



81232



81231



81219



81223



81563



200753



81220

## 5.2. MAHLE X35+ SKUS AND DESCRIPTIONS – NORTH AMERICA

| NO.  | NAME   | AIB SKU#               | QTY |
|--|--|------------------------|-----|
| <b>PARTS INCLUDED IN THE FRAMESET</b>                |  |                        |     |
| 1  | Rear Wheel Road – North America (for 360A)<br>-OR-<br>Rear Wheel Gravel – North America (for 360B)   | 81184<br>-OR-<br>81192 | 1   |
| 2  | Front Wheel Road – North America (for 360A)<br>-OR-<br>Front Wheel Gravel – North America (for 360B) | 81183<br>-OR-<br>81185 | 1   |
| 3  | KIT X35 – C – One Flat – North America   | 81217                  | 1   |
| 3.1  | X35 B1-C Battery – 6.9A  | 81218                  | 1   |
| 3.2  | Drive Unit-M1-C – North America (*Already Included in the Rear Wheel)                                | 81225                  | 1   |
| 3.3  | Torque Washer Nut  | 81229                  | 2   |
| 3.4  | Motor Lock Nut   | 81228                  | 2   |
| 3.5  | Shield M1  | 81230                  | 1   |
| 3.6  | Freewheel Nut  | 81226                  | 1   |
| 3.7  | One Remote   | 81231                  | 1   |
| 3.8  | Charging Point – ROUND CONN.   | 81220                  | 1   |
| 3.9  | PAS Sensor B – ROUND CONN.   | 81232                  | 1   |
| 3.10   | Magnet Lock Nut  | 81227                  | 1   |
| 3.11   | Charger-C (Without Wire)   | 81219                  | 1   |
| 3.12   | Charger Wire for North America   | 81223                  | 1   |
| 4  | One Remote Curved Holder   | 200753                 | 1   |
| 5  | Light Wire – eBikeMotion X35   | 81563                  | 1   |
| <b>OPTIONAL PARTS THAT CAN BE ORDERED SEPARATELY</b> |  |                        |     |
| -  | External Battery SP1 + Holder  | 81233                  | 1   |
| -  | PCAN USB Adaptor   | 81282                  | 1   |
| -  | Diagnosis Wire   | 81283                  | 1   |

## 6.1. MAHLE X35+ SKUS AND DESCRIPTIONS - EU

### European Version

81187 (314A) 700C  
81189 (314B) 650B



81186(314A) 700C  
81188 (314B) 650B



### Available Separately

\*81233\*



### European Version 81216



81227



81218



81229

### European Version

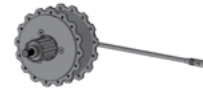

81224



81228



81230



81226



81232



81231



81219



200753



81563



81221



81222



81220

## 6.2. MAHLE X35+ PARTS AND DESCRIPTIONS – EU

| NO.  | NAME   | AIB SKU#               | QTY |
|--|--|------------------------|-----|
| <b>PARTS INCLUDED IN THE FRAMESET</b>                |  |                        |     |
| 1  | Rear Wheel Road – EU (for 314A)<br>-OR-<br>Rear Wheel Gravel – EU (for 314B)   | 81187<br>-OR-<br>81189 | 1   |
| 2  | Front Wheel Road – EU (for 314A)<br>-OR-<br>Front Wheel Gravel – EU (for 314B) | 81186<br>-OR-<br>81188 | 1   |
| 3  | KIT X35 – C – One Flat – EU  | 81216                  | 1   |
| 3.1  | X35 B1-C Battery - 6.9A  | 81218                  | 1   |
| 3.2  | Drive unit-M1-C – EU (*Already Included in the Rear Wheel)                     | 81224                  | 1   |
| 3.3  | Torque Washer Nut  | 81229                  | 2   |
| 3.4  | Motor Lock Nut   | 81228                  | 2   |
| 3.5  | Shield M1  | 81230                  | 1   |
| 3.6  | Freewheel Nut  | 81226                  | 1   |
| 3.7  | One Remote   | 81231                  | 1   |
| 3.8  | Charging Point – ROUND CONN.   | 81220                  | 1   |
| 3.9  | PAS Sensor B – ROUND CONN.   | 81232                  | 1   |
| 3.10   | Magnet Lock Nut  | 81227                  | 1   |
| 3.11   | Charger-C (Without Wire)   | 81219                  | 1   |
| 3.12   | Charger Wire for Europe  | 81221                  | 1   |
| 3.13   | Charger Wire for United Kingdom  | 81222                  | 1   |
| 4  | One Remote Curved Holder   | 200753                 | 1   |
| 5  | Light Wire – eBikeMotion X35   | 81563                  | 1   |
| <b>OPTIONAL PARTS THAT CAN BE ORDERED SEPARATELY</b> |  |                        |     |
| -  | External Battery SP1 + Holder  | 81233                  | 1   |
| -  | PCAN USB Adaptor   | 81282                  | 1   |
| -  | Diagnosis Wire   | 81283                  | 1   |

## 7. SEAT POST COLLAR ASSEMBLY

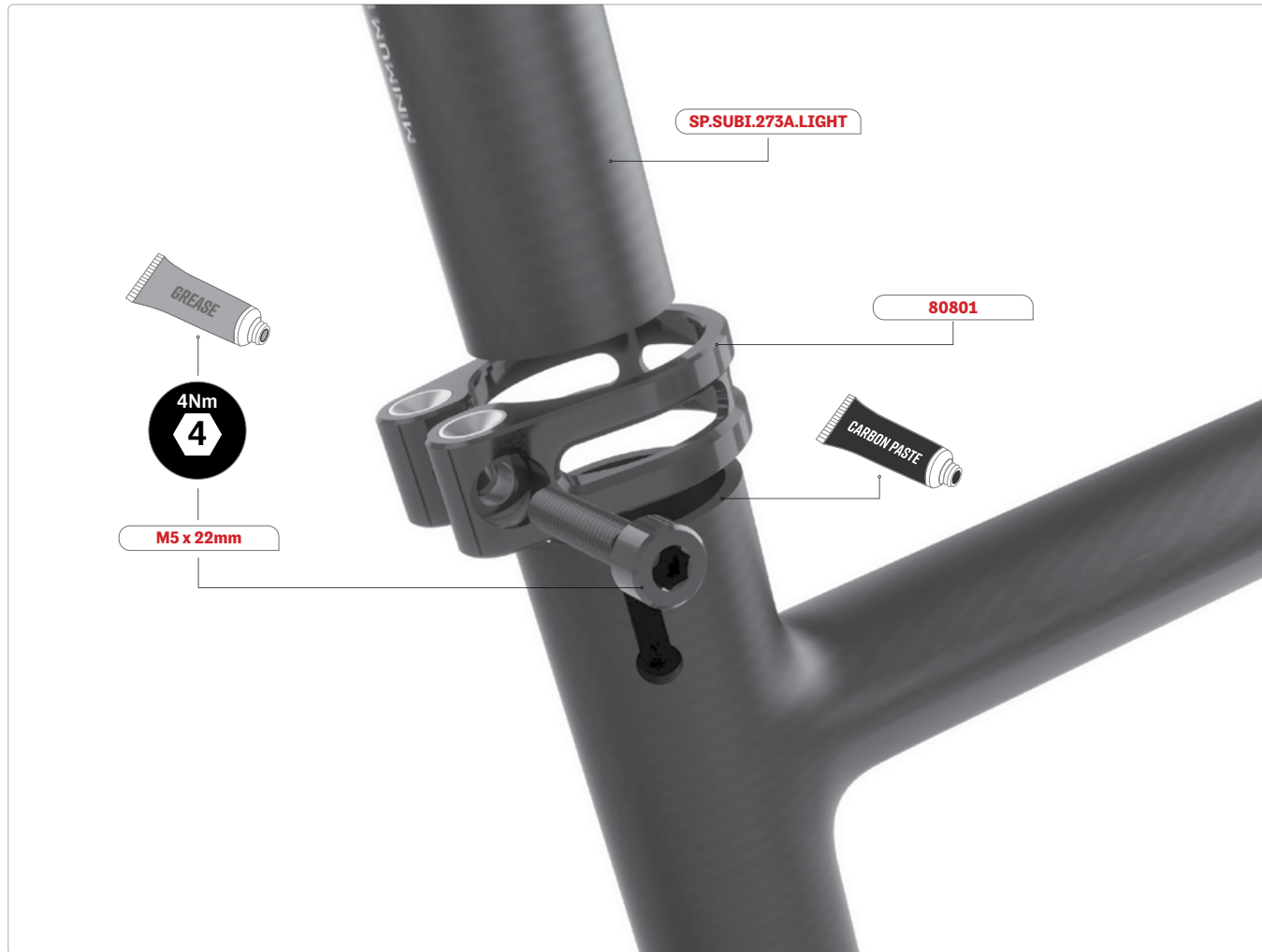

1. Assemble the seat post collar (SKU: 80801) on the frame.
2. Apply grease on the threads of the M5 x 22mm bolt.
3. Apply carbon paste on the inside of the frame (seat tube).
4. Insert the seat post (SKU: SP.KRYCS.273B) to the desired height.
5. Tighten the M5 x 22mm bolt to 4Nm.



### IMPORTANT:

Refer to p.52 for seat post MIN and MAX insertion limits.

## 8. SEAT POST ASSEMBLY



**The seat post is supplied fully assembled.**

1. Unscrew both bolts slightly until the top clamp (a) and the cradle (b) are separated enough to insert the saddle rail. Do not unscrew the bolts completely.
2. Apply grease on the threads of each bolt.
3. Tighten both bolts in order to adjust the angle of the saddle and clamp the rail.
4. Tighten the rear bolt to 9.5Nm.

## 9. REAR DERAILLEUR HANGER ADJUSTMENT

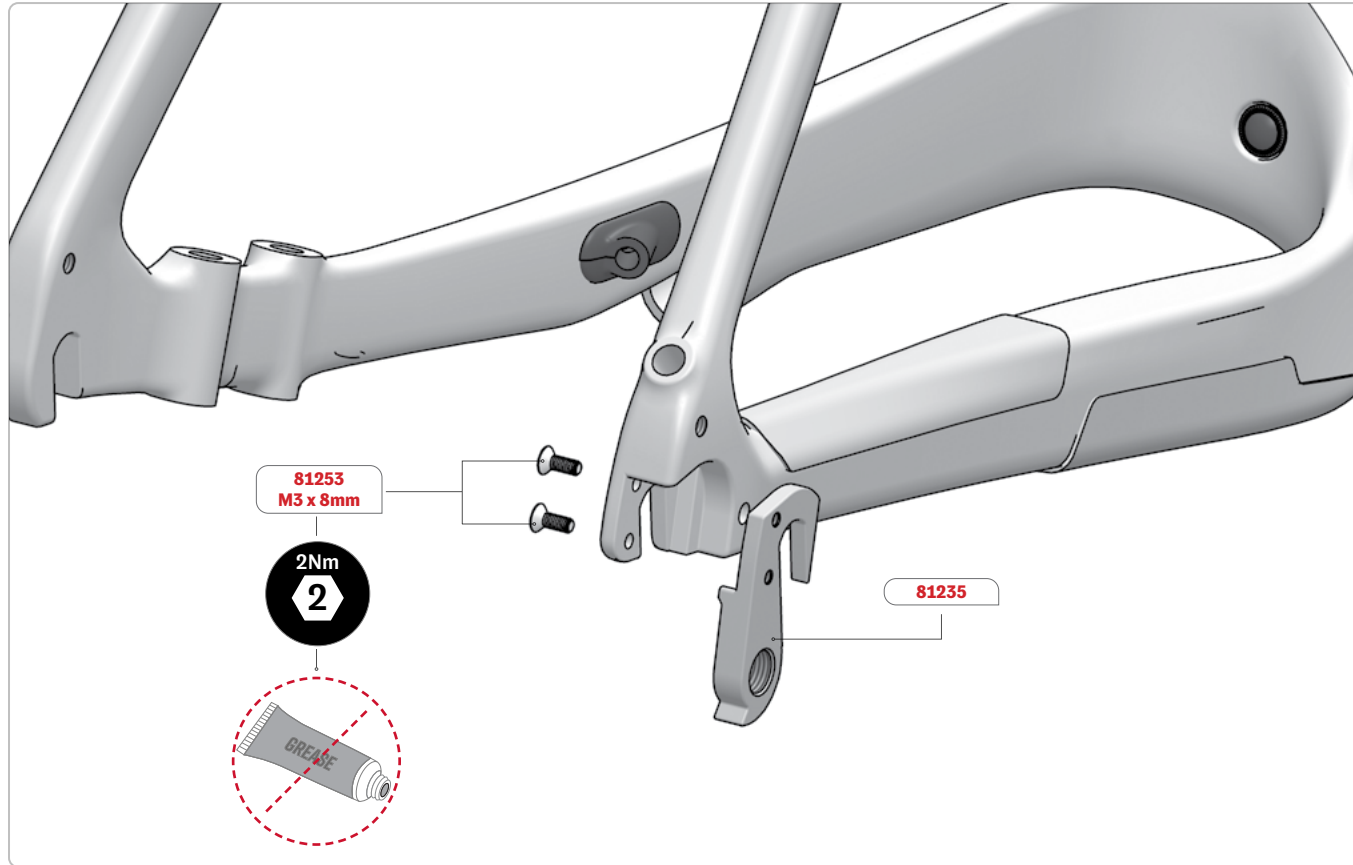

1. Assemble the rear derailleur hanger (SKU: 81235) on the frame with the two bolts (Flat head cap screw M3 x 8mm SKU: 81253).
2. Tighten bolts to 2Nm. Do not apply grease on the threads.
3. Use a rear derailleur hanger alignment gauge to align the rear derailleur hanger.

**For assistance, visit Park Tool's website at:**

<https://www.parktool.com/blog/repair-help/rear-derailleur-hanger-alignment>



## 10. FRONT DERAILLEUR HANGER ASSEMBLY

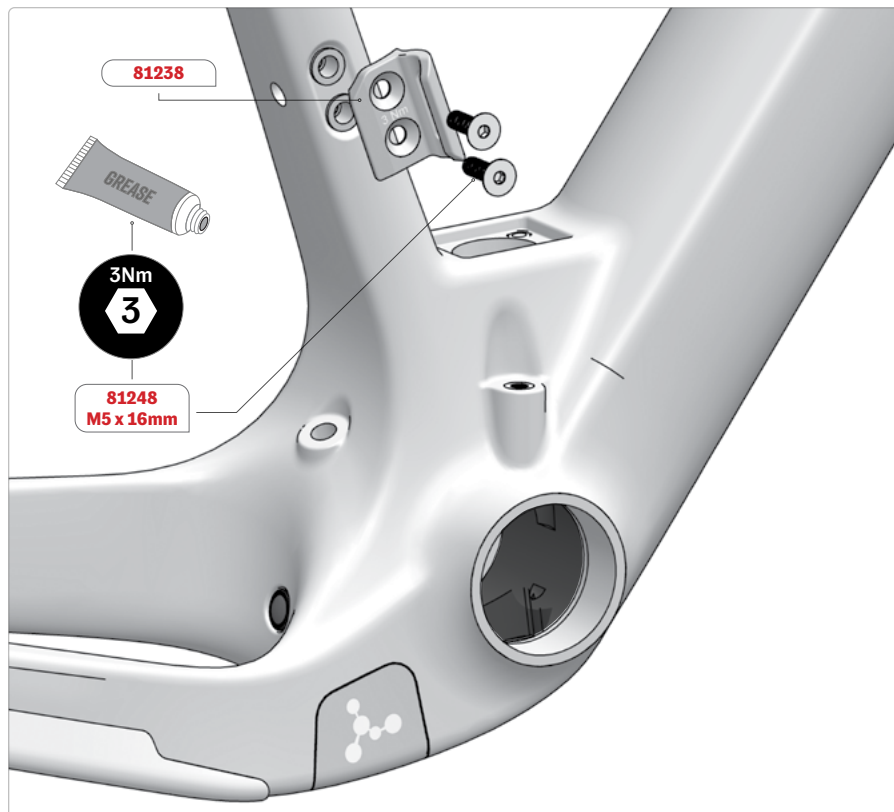

1. Apply grease on the thread of both M5 x 16mm bolts (SKU: 81248).
2. Assemble the front derailleur hanger (SKU: 81238) on the frame with the two bolts.
3. Tighten screws to 3Nm.

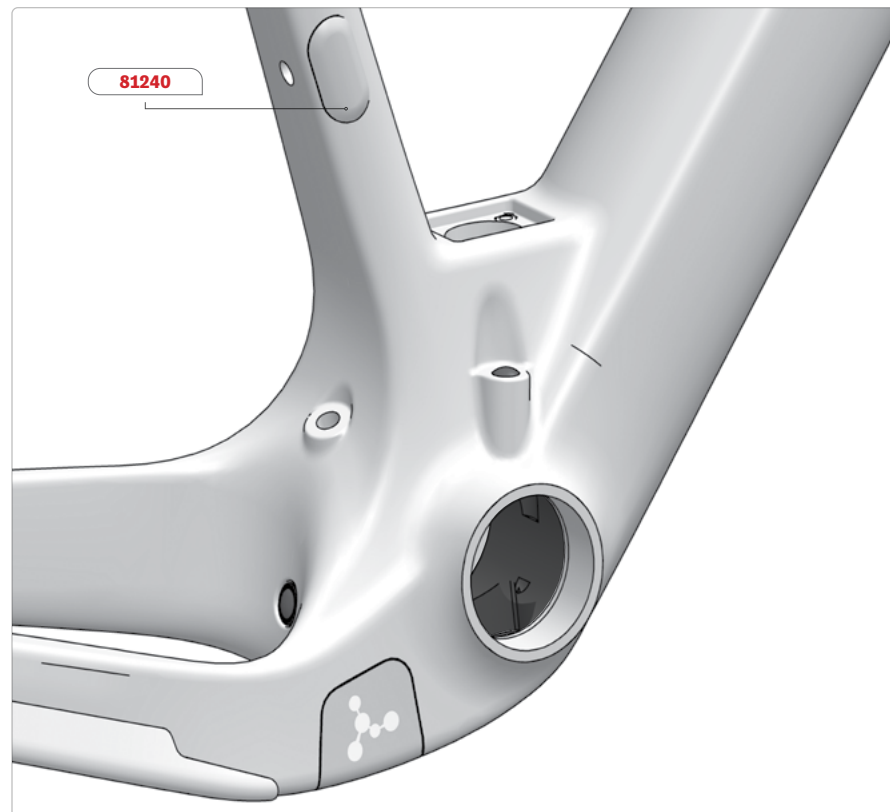

### Using a Single Chainring Set-Up:

1. Install the FD plug (SKU: 81240) to cover the hole.

## II.1 MAHLE CONNECTOR IDENTIFICATION

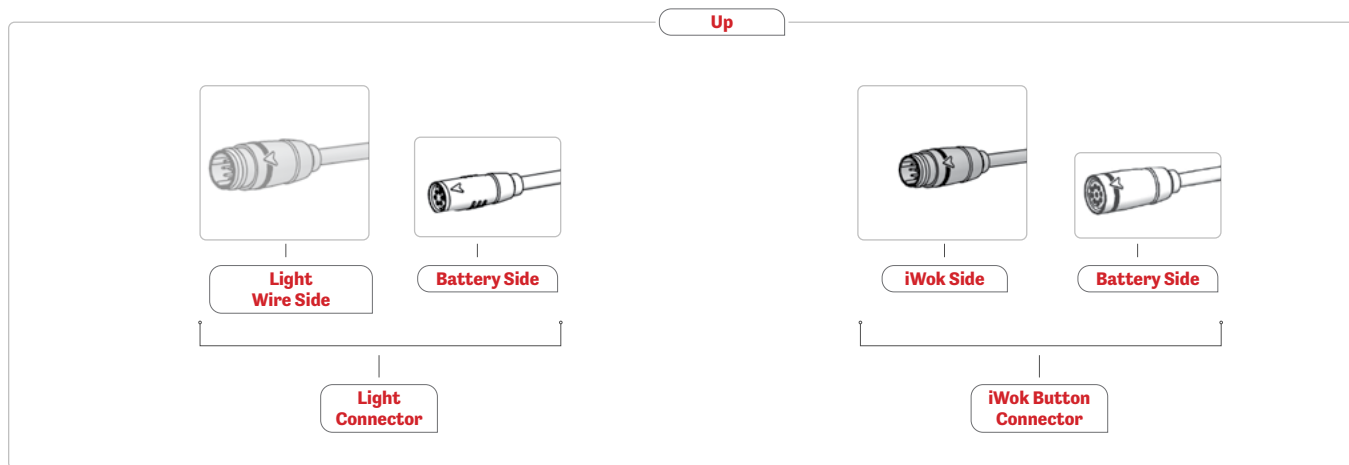
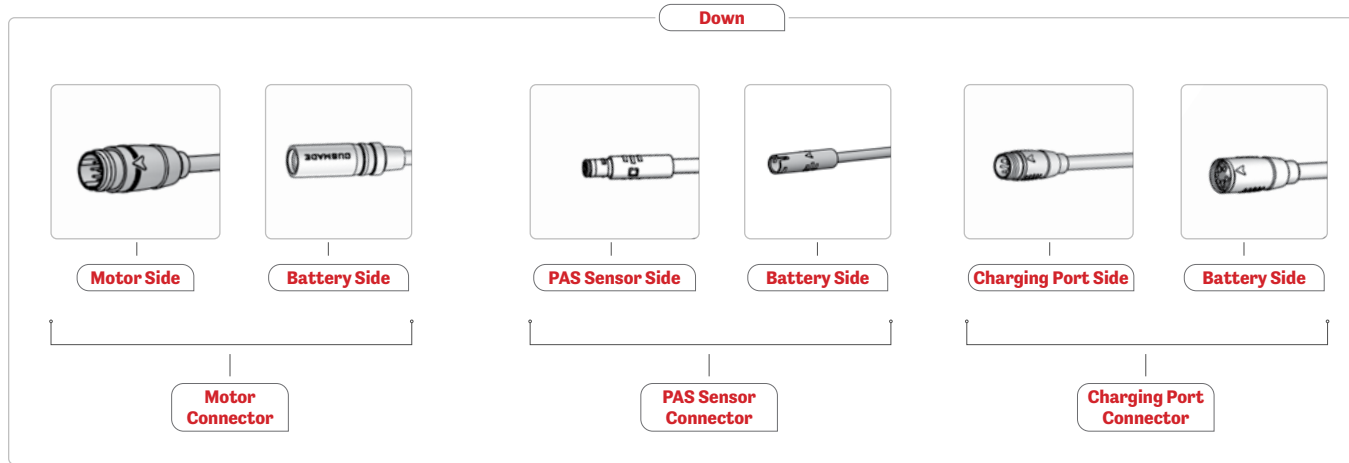

## 11.2 BATTERY INSTALLATION

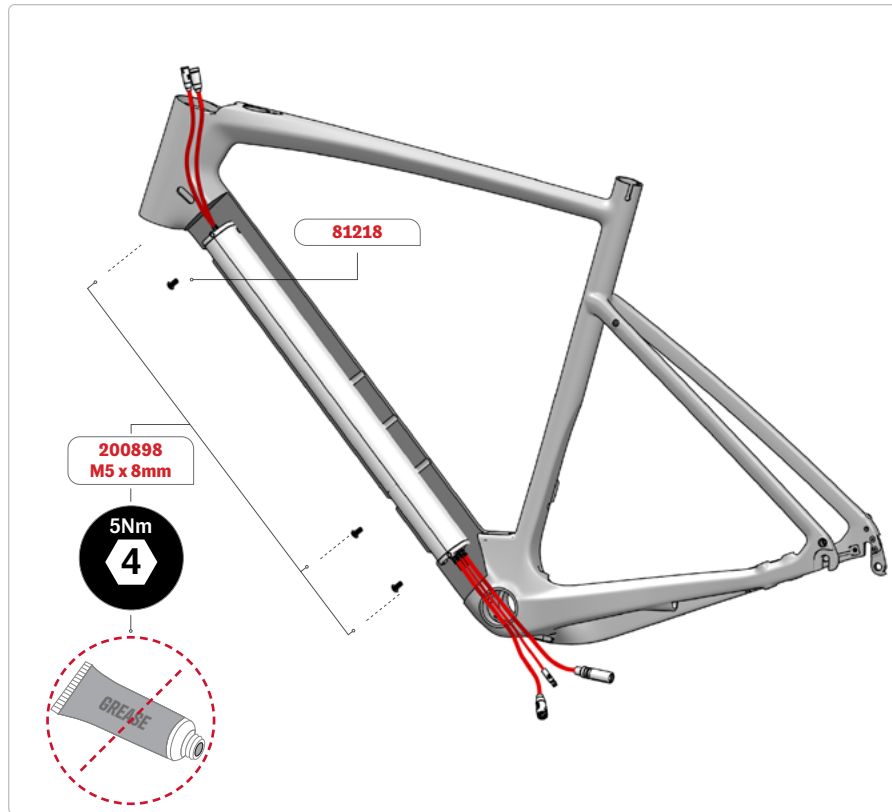

1. Always remove all Water Bottle Screws (81249) and Plastic Plug M5 (80264) from the frame's downtube before insertion or removal of the battery.
2. Insert the battery (SKU: 81218) through the hole under the bottom bracket. The three threaded mounting holes on the battery must face down. The side with the two connectors (iWok button connector and light connector) must be inserted first.
3. Guide the two connectors (iWok button connector and light connector) through the top of the head tube.
4. Install the three M5 x 8mm battery screws (SKU: 200898). Once the three screws are installed, tighten to 5Nm. Do not apply grease to the threads.
5. Guide the motor connector into the NDS chainstay and through the exit hole.

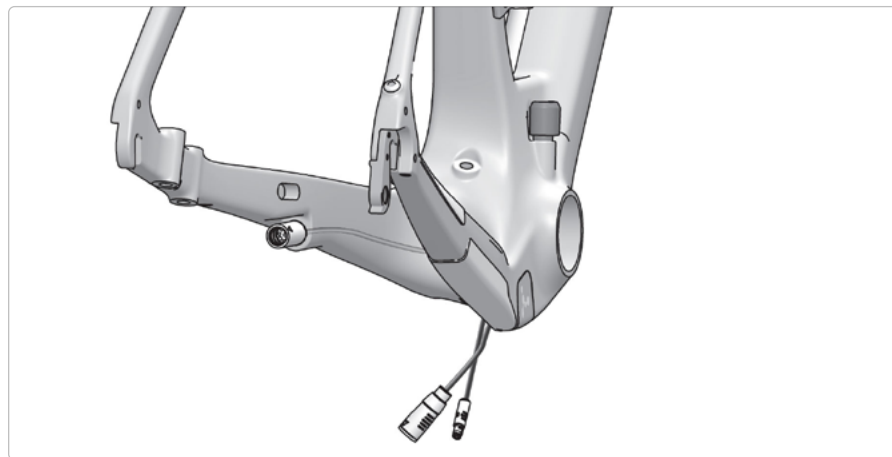

### **IMPORTANT**

Use only M5 x 8mm screws. Using longer screws will damage the battery and void the warranty.

## 11.3 CHARGING PORT INSTALLATION

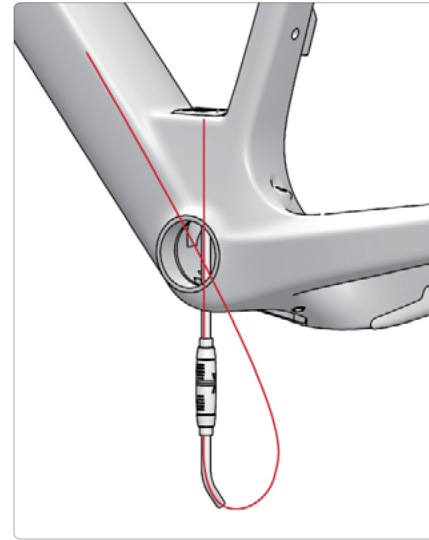
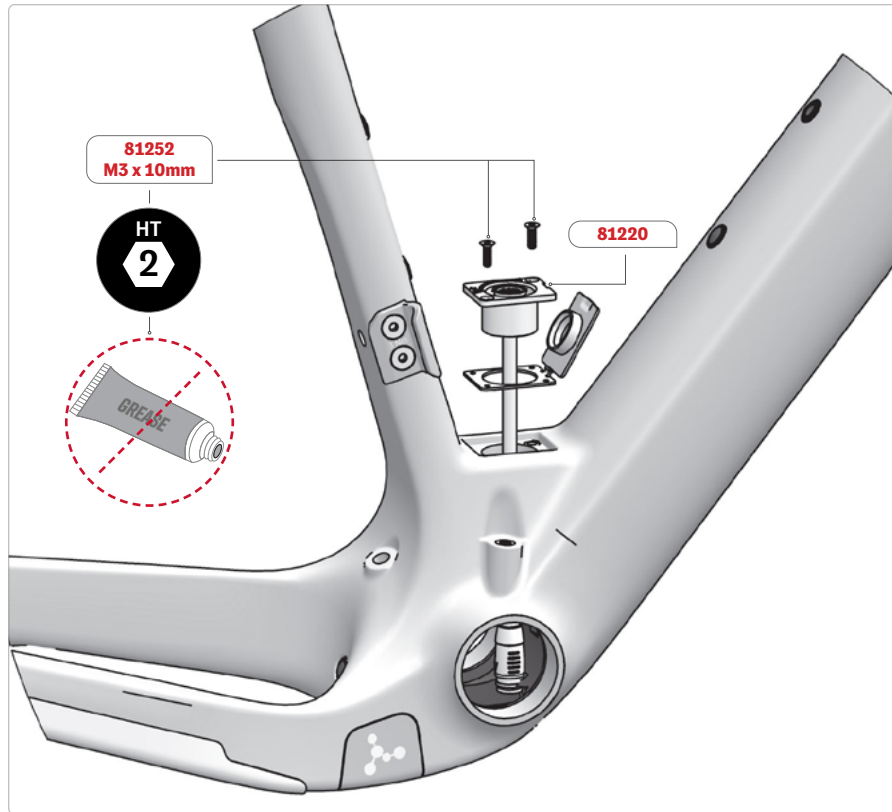

- 1.** Install the charging port with the arrow pointing to the rear of the bike, that way the cover will open facing the down tube.
- 2.** Allow the charging port connector to exit through the BB hole.
- 3.** Install and tighten both M3 x 10mm screw (SKU: 81252) only by hand, do not apply grease on the threads.
- 4.** Connect the charging port connector to the matching connector on the battery. Align both arrows on each connector.

## 11.4 PAS SENSOR INSTALLATION

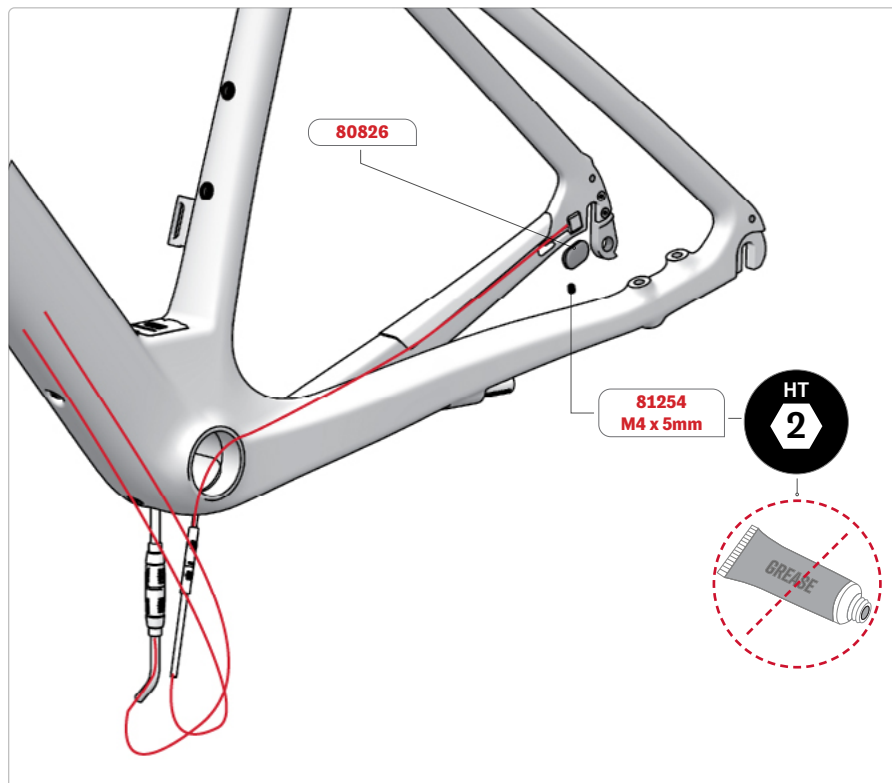
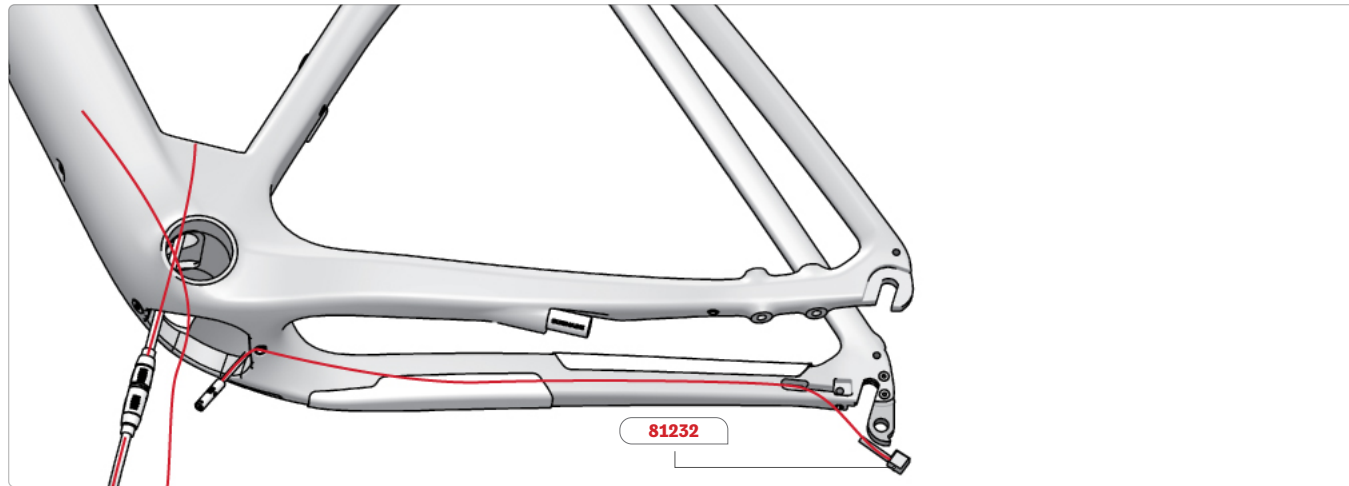

- 1.** Insert the cable of the PAS sensor (SKU: 81232) from the hole on the interior of the drive side chainstay.
- 2.** Exit the cable through the hole under the bottom bracket.
- 3.** Push the PAS sensor to the bottom of the PAS cavity.
- 4.** Handtighten the M4 x 5mm setscrew (SKU: 81254) to secure the PAS sensor. Do not apply grease on the threads.
- 5.** Insert the grommet (SKU: 80826) to cover the cable insertion hole.
- 6.** Connect the PAS sensor cable to the matching connector on the battery. You will hear a clicking sound.

## 11.6 IWOC ONE INSTALLATION

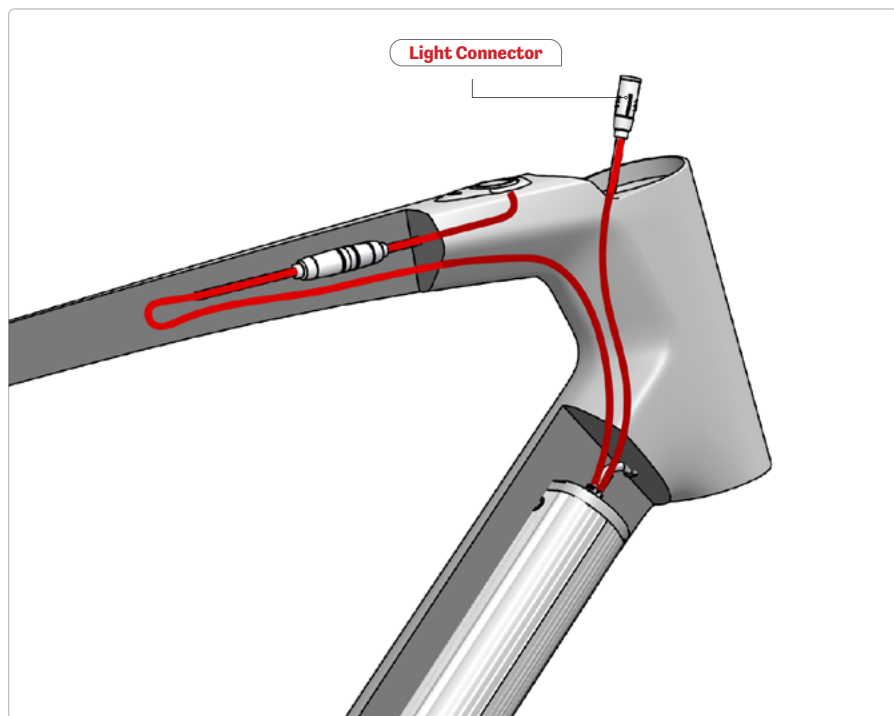
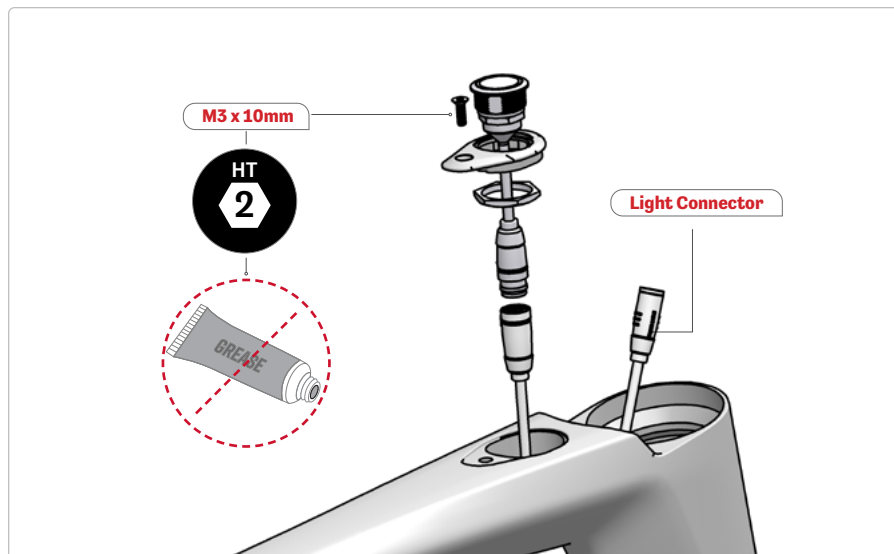

1. Guide the iWoc one remote connector from the battery through the top tube hole.
2. Assemble the iWoc one remote (SKU: 81231) on the iWoc one remote curved holder (SKU: 200753).
3. Install the iWoc one remote nut and turn clockwise approximately 3 turns.
4. Hold the iWoc one remote and turn the iWoc one remote curved holder (SKU: 200753) until the assembly is tight.
5. Connect the iWoc one remote connector to the matching connector on the battery.
6. Push the cable in the top tube toward the seat tube.
7. Insert the iWoc one remote and holder assembly in the top tube hole.
8. Align the hole with the rivet and hand tighten the M3x10mm screw. Do not apply any grease to the screw.
9. If light isn't installed, push the light connector in the top tube.

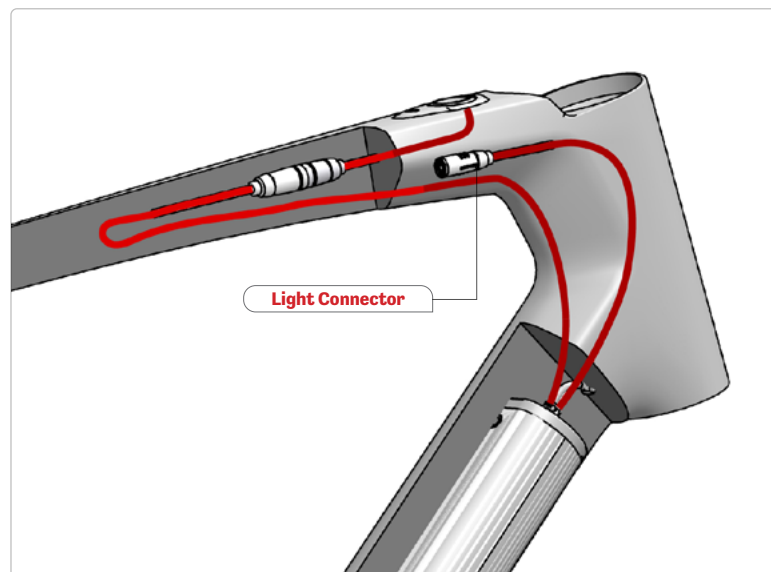

## 12. CABLE AND HOUSING ROUTING - LIGHT



1. All cables must be routed above the battery.
2. Connect the eBikemotion X35 Light Wire to the connector exiting the headtube.
3. Guide the rear light end in the downtube and seat tube until it exits at the top of the seat tube.
4. Install the female connector referring to a JWPF connector installation.
5. Guide the front light end through the hole in the side of the downtube.
6. Push the connector above the battery in the downtube. Make sure it will not interfere with the steer tube.

### 13. REAR LIGHT INSTALLATION

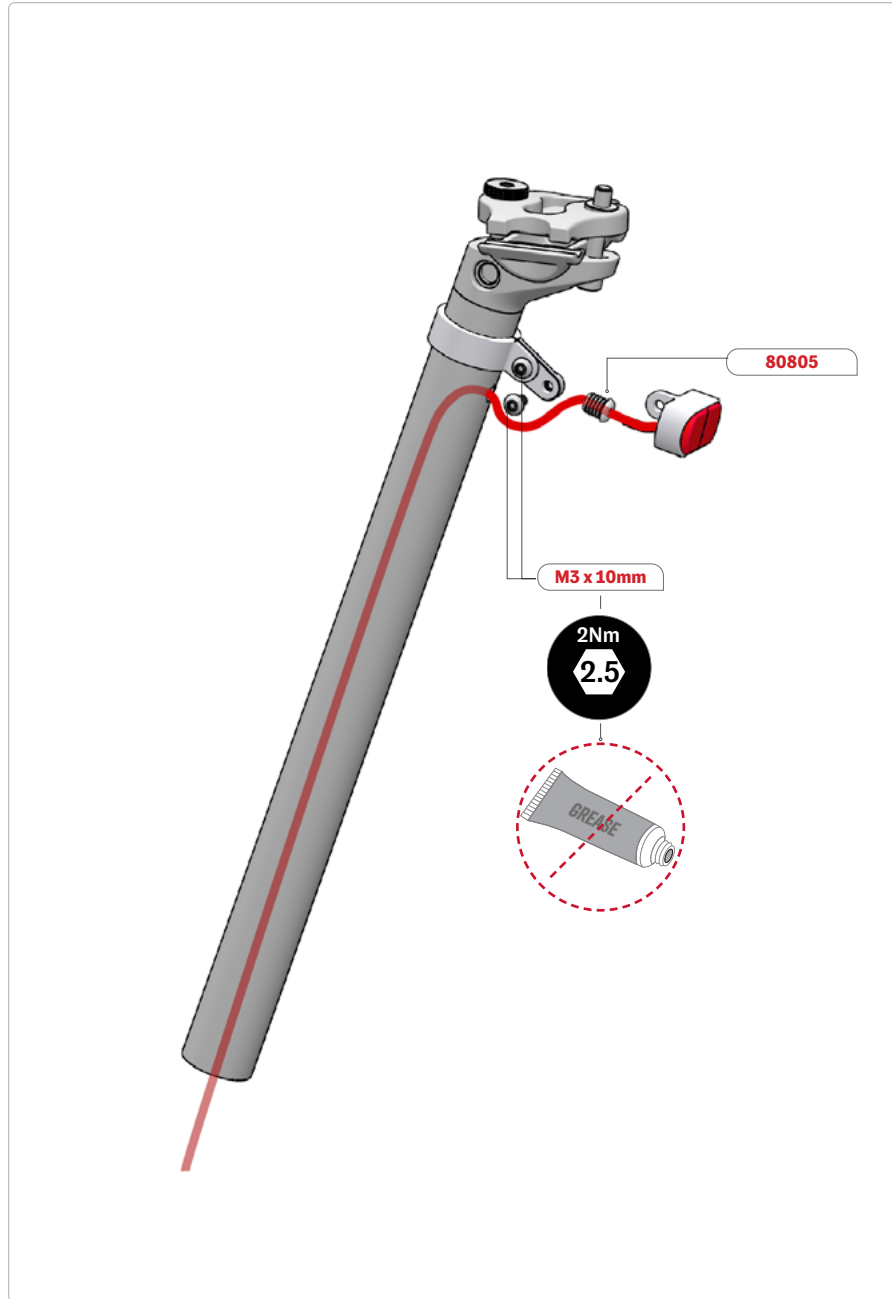

1. Install the rear light above the hole on the seatpost.
2. Tighten both M3x8mm screws to 2Nm.
3. Guide the cable in the seatpost through the hole.
4. Attach the rear light, using the M3x8mm screw.
5. Install the male connector referring to a JWPF connector installation.
6. Install the long Grommet Di2 (SKU: 80805) in the hole of the seatpost.
7. If not using the rear light, install the Long Plug Grommet (SKU: 80804) to cover the hole on the seat tube.



## 14. 3D HEADSET INSTALLATION

**AS WITH ALMOST ALL ARGON 18 BIKES, THE SUBITO PROVIDES YOU WITH THE BENEFIT OF THE 3D SYSTEM. THIS SYSTEM ALLOWS FOR 2 POSITIONS: 0MM AND 25MM.**

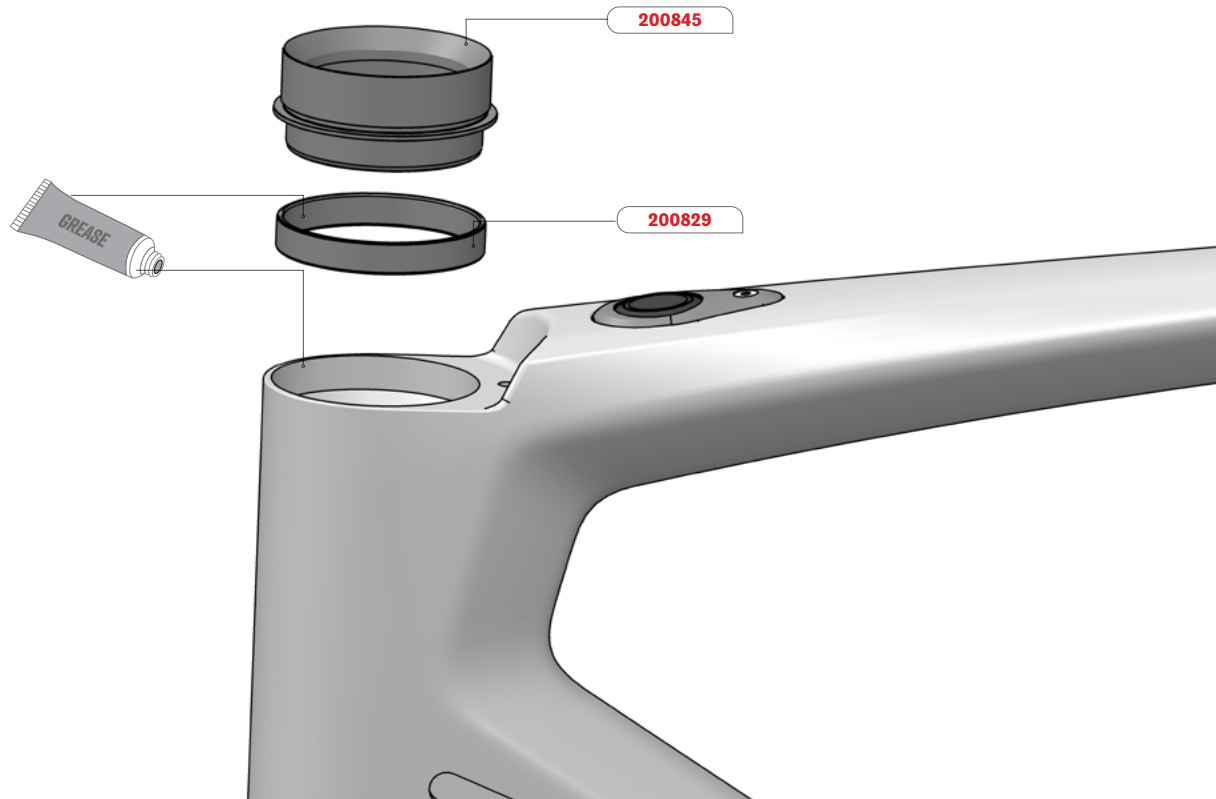

**If the 25mm 3D headset is wanted, follow the steps below, if no 3D headset is wanted, no action are required:**

- 1.** Install the 3D headset IST2 plastic sleeve (SKU: 200829) into the top of the head tube. (Apply grease on the sleeve)
- 2.** Insert the 3D headset IST2 25mm Column (SKU: 200845). (Apply grease)
- 3.** Secure the assembly using a headset press.

## 15.1 CABLE AND HOUSING ROUTING - MECHANICAL SHIFTING

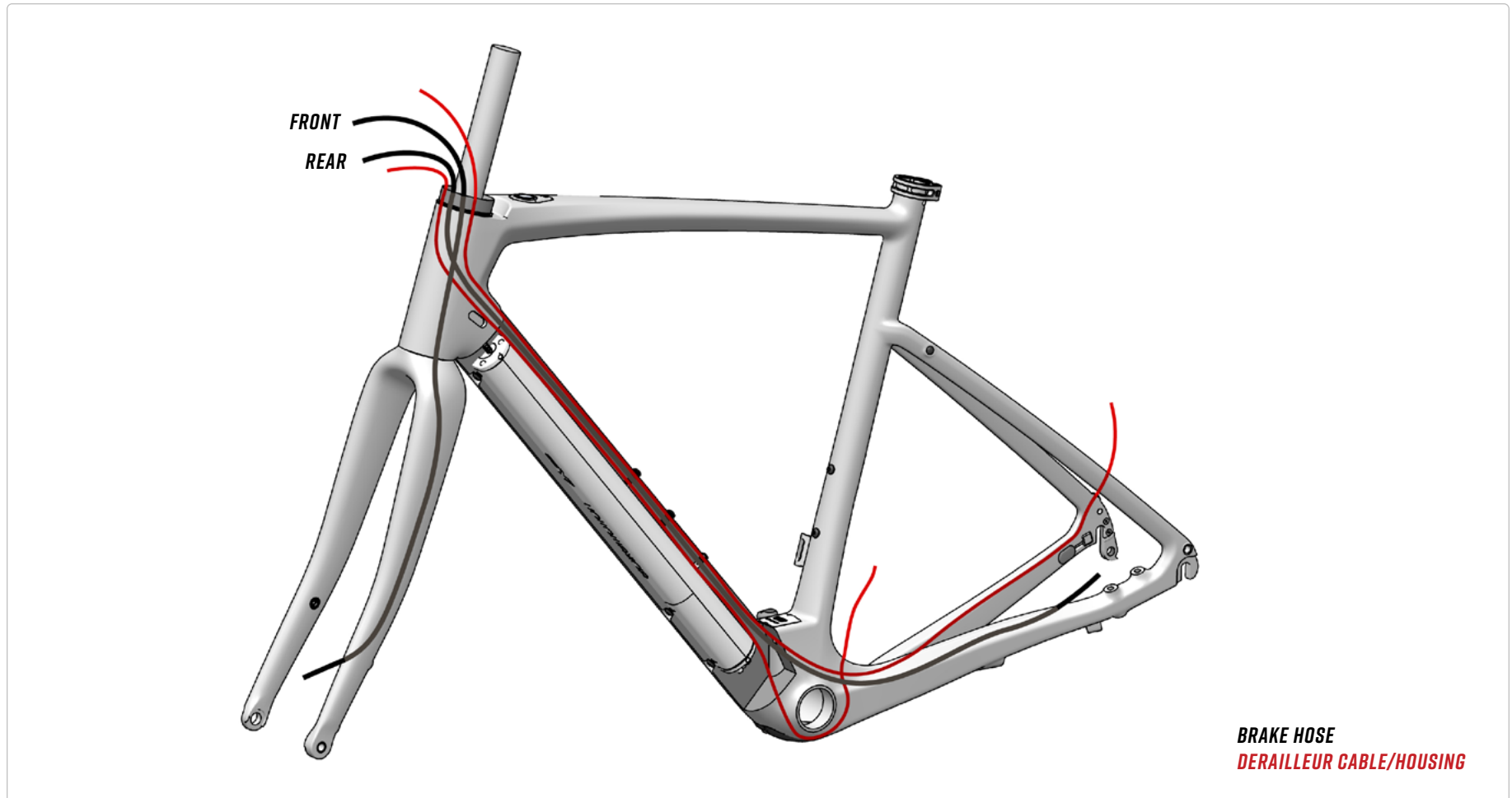

1. All cables must be routed above the battery.
2. The rear brake hose will be above the BB once installed.
3. Both derailleur housings will be under the BB once installed.
4. All housing can be covered by a foam liner (SKU: 80811).
5. Refer to the Internal Routing Guide on the website ([www.argon18.com/en-ca/support/downloads](http://www.argon18.com/en-ca/support/downloads)) for the cable configuration around the steerer tube, this depends on the choice of cockpit.

## 15.2 CABLE AND HOUSING ROUTING - MECHANICAL SHIFTING

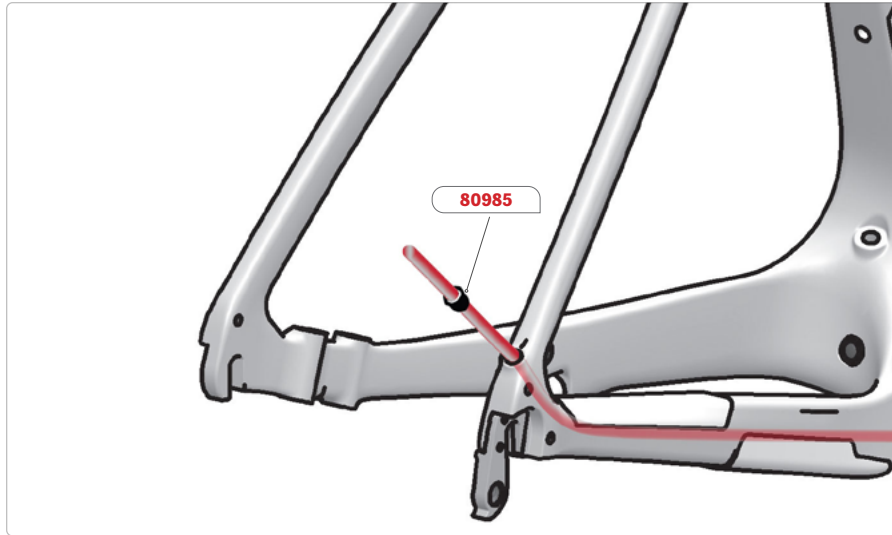

### Rear derailleur:

1. Insert housing from rear hole on the seat stay.
2. Guide the housing over the battery through the BB hole.
3. Exit the housing through the side guide hole.
4. Insert the mechanical grommet (SKU: 80985) on the seat stay hole.

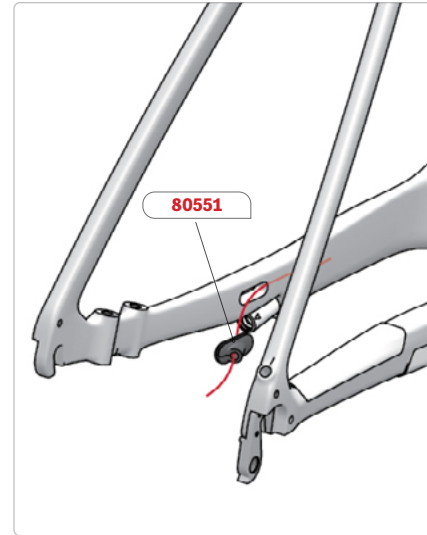

### Rear brake:

1. Insert hose from rear hole on the chainstay.
2. Guide the hose over the battery through the BB hole.
3. Exit the hose through the side guide hole.
4. Insert the rear brake oblong cable guide (SKU: 80551) into the chainstay hole.

## 15.3 CABLE AND HOUSING ROUTING - MECHANICAL SHIFTING

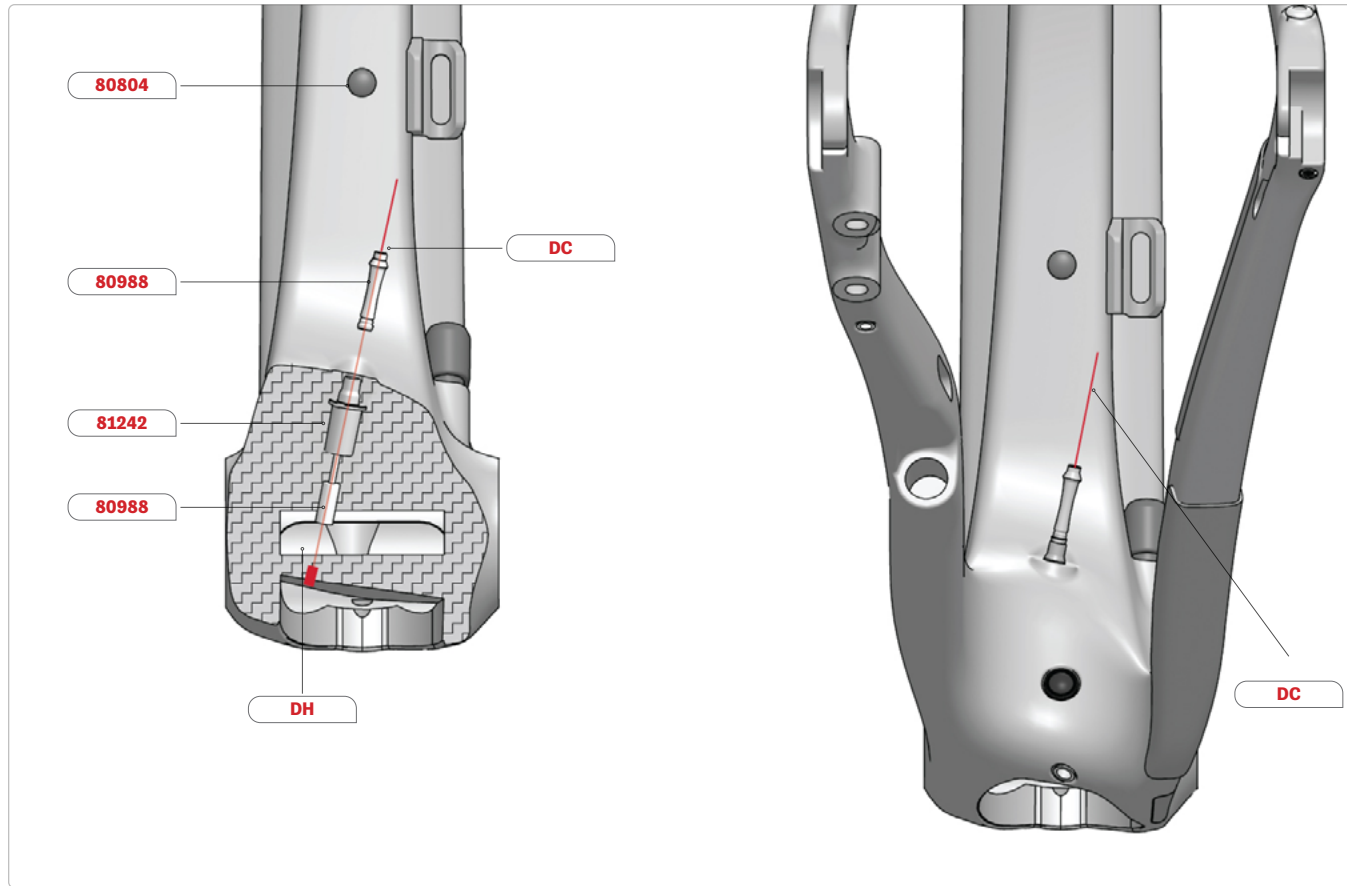

### Front derailleur with cable stop:

- 1.** Insert front derailleur housing from side guide hole.
- 2.** Once the housing exits from the BB hole, install the dirt guard kit (SKU: 80988).
- 3.** Install the FD cable stopper (SKU: 81242).
- 4.** Install the cable in the housing.
- 5.** Install the rubber dust seal (included in SKU: 80988).

- 6.** Guide the housing in the hole behind the BB.
- 7.** Install the plug grommet (SKU: 80804) into the Di2 seat tube hole.

## 15.4 CABLE AND HOUSING ROUTING - MECHANICAL SHIFTING

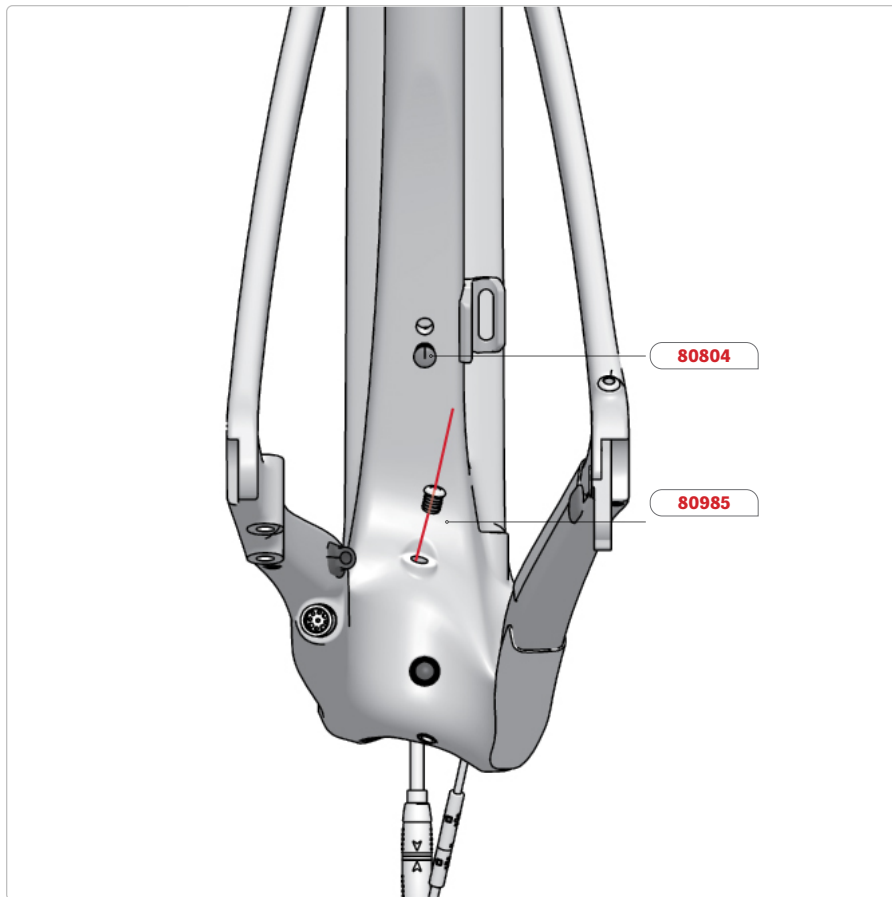

### Front derailleur with full housing:

1. Housing length will depend on the chainring.
2. Insert front derailleur housing from side guide hole.
3. Once the housing exits from the BB hole, guide the housing in the hole behind the BB.
4. Install the mechanical grommet (SKU: 80985).
5. Install the housing ferrule.
6. Install the plug grommet (SKU: 80804) into the Di2 seat tube hole.

## 16.1 CABLE AND HOUSING ROUTING - MECHANICAL IX SHIFTING



- 1.** All cables must be routed above the battery.
- 2.** The rear brake hose will run above the BB once installed.
- 3.** The rear derailer housing will be under the BB once installed.
- 4.** All housing can be covered by a foam liner (SKU: 80811).
- 5.** Refer to the Internal Routing Guide on the website ([www.argon18.com/en-ca/support/downloads](http://www.argon18.com/en-ca/support/downloads)) for the cable configuration around the steerer tube, this depends on the choice of cockpit.

## 16.2 CABLE AND HOUSING ROUTING - MECHANICAL IX SHIFTING

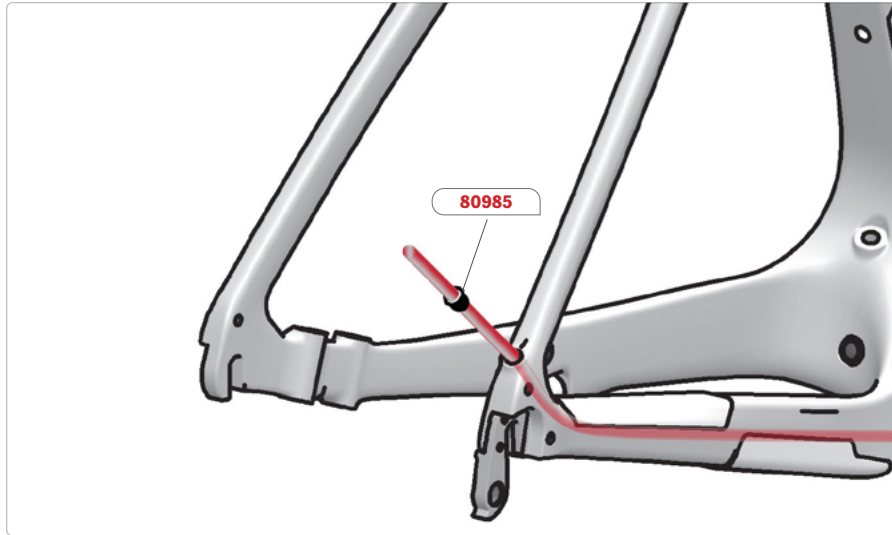

### Rear Derailleur:

1. Insert housing from rear hole on the seat stay.
2. Guide the housing over the battery through the BB hole.
3. Exit the housing through the side guide hole.
4. Insert the mechanical grommet (SKU: 80985) into the seat stay hole.

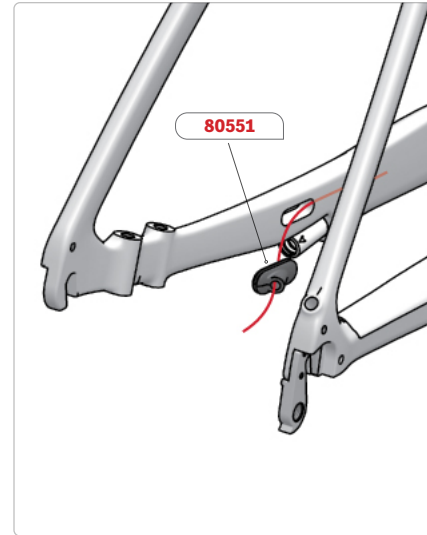

### Rear Brake:

1. Insert hose from rear hole on the chainstay.
2. Guide the hose over the battery through the BB hole.
3. Exit the hose through the side guide hole.
4. Insert the rear brake oblong cable guide (SKU: 80551) into the chainstay hole.

### 16.3 CABLE AND HOUSING ROUTING - MECHANICAL IX SHIFTING

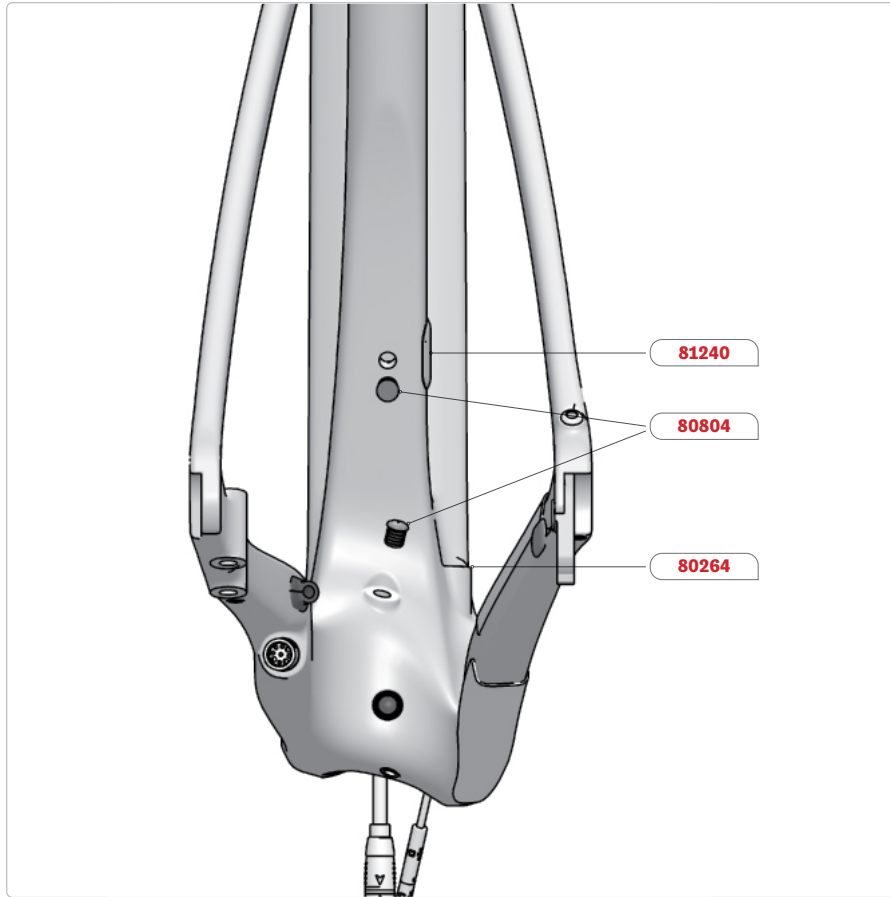

1. Install the FD plug (SKU: 81240) over the two FD hanger rivets. Refer to page 15.
2. Install the plug grommet (SKU: 80804) in the Di2 seat tube hole and FD housing exit hole.
3. Install a M5 plug (SKU: 80264) over the chain catcher hole.



## 17.1 CABLE AND HOUSING ROUTING - ELECTRONIC WIRE ROUTING

9200 - 8100 - 7100

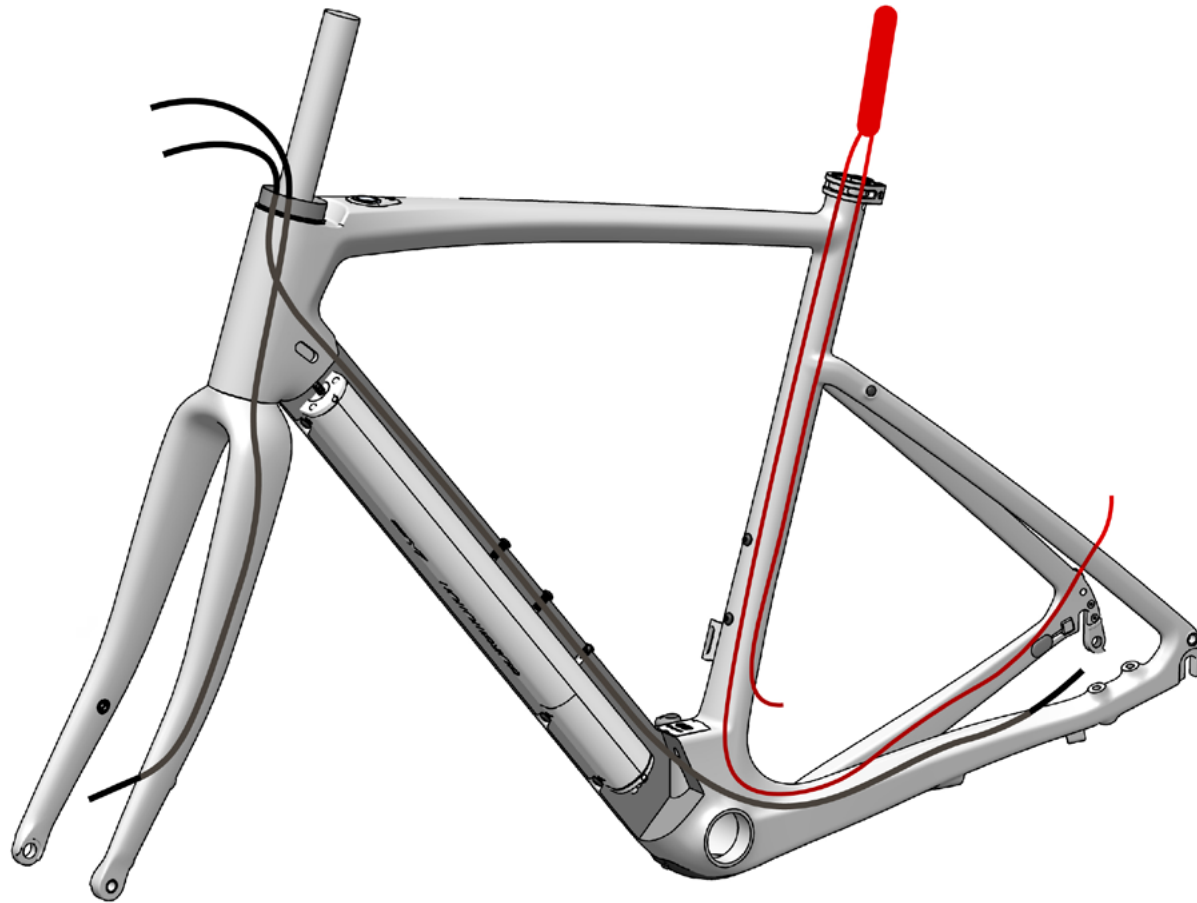

**BRAKE HOSE**  
**DERAILLEUR CABLE/HOUSING**

1. All cables must be routed above the battery.
2. The rear brake hose will be above the BB once installed.
3. Brake hose can be covered by a foam liner (SKU: 80811).
4. Refer to the Internal Routing Guide on the website ([www.argon18.com/en-ca/support/downloads](http://www.argon18.com/en-ca/support/downloads)) for the cable configuration around the steerer tube, this depends on the choice of cockpit.

## 17.2 CABLE AND HOUSING ROUTING - ELECTRONIC WIRE ROUTING

**OLDER DI2 WITH INTERNAL BATTERY**

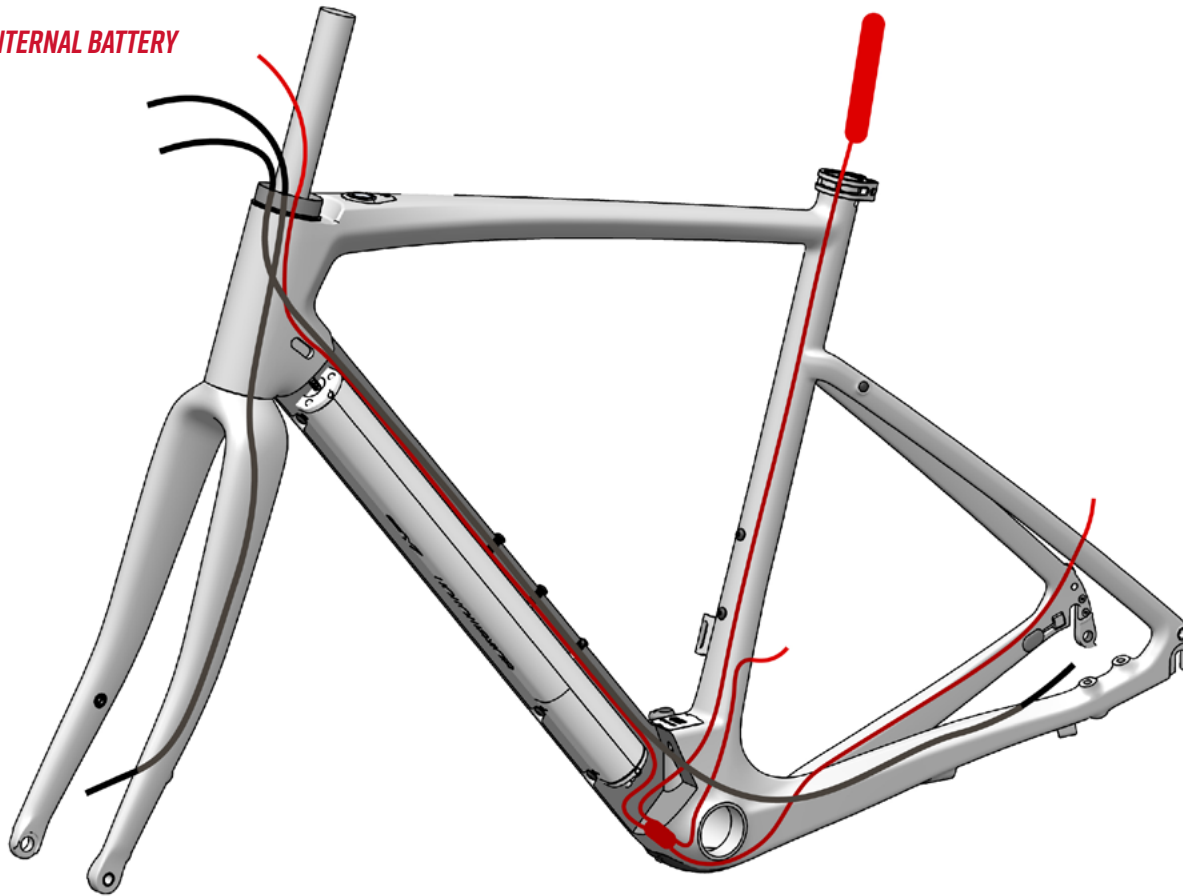

**BRAKE HOSE  
DERAILLEUR CABLE/HOUSING**

- 1.** All cables must be routed above the battery.
- 2.** The rear brake hose will be above the BB once installed.
- 3.** The rear derailleur cable will be under the BB once installed.
- 4.** Brake housing can be covered by a foam liner (SKU: 80811).
- 5.** Refer to the Internal Routing Guide on the website ([www.argon18.com/en-ca/support/downloads](http://www.argon18.com/en-ca/support/downloads)) for the cable configuration around the steerer tube, this depends on the choice of cockpit.

## 17.3 CABLE AND HOUSING ROUTING - ELECTRONIC WIRE ROUTING

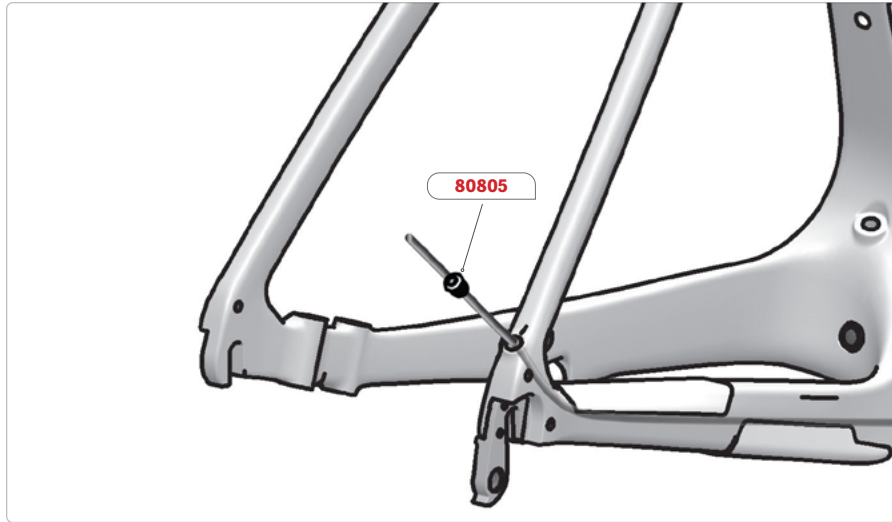

### Rear Derailleur:

1. Insert the Di2 rear derailleur cable from rear hole on the seat stay until it exits from the BB hole.
2. Insert the Di2 junction A cable from side guide hole until it exits from the BB hole.
3. Insert Di2 battery cable from the seat tube until it exits from the BB hole.
4. Plug the three cables into the junction box.
5. Insert the Di2 grommet (SKU: 80805) into the seat stay hole.

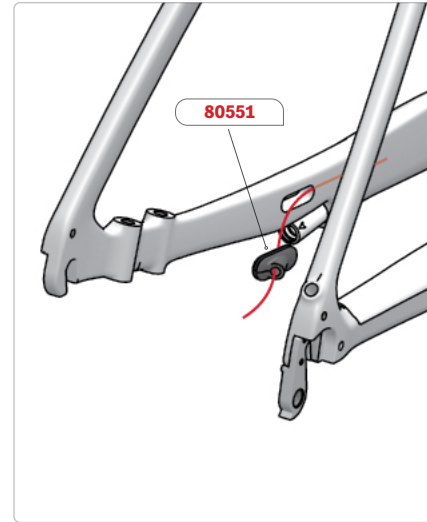

### Rear Brake:

1. Insert hose from rear hole on the chainstay.
2. Guide the hose over the battery through the BB hole.
3. Exit the hose through the side guide hole.
4. Insert the rear brake oblong cable guide (SKU: 80551) into the chainstay hole.

## 174 CABLE AND HOUSING ROUTING - ELECTRONIC WIRE ROUTING

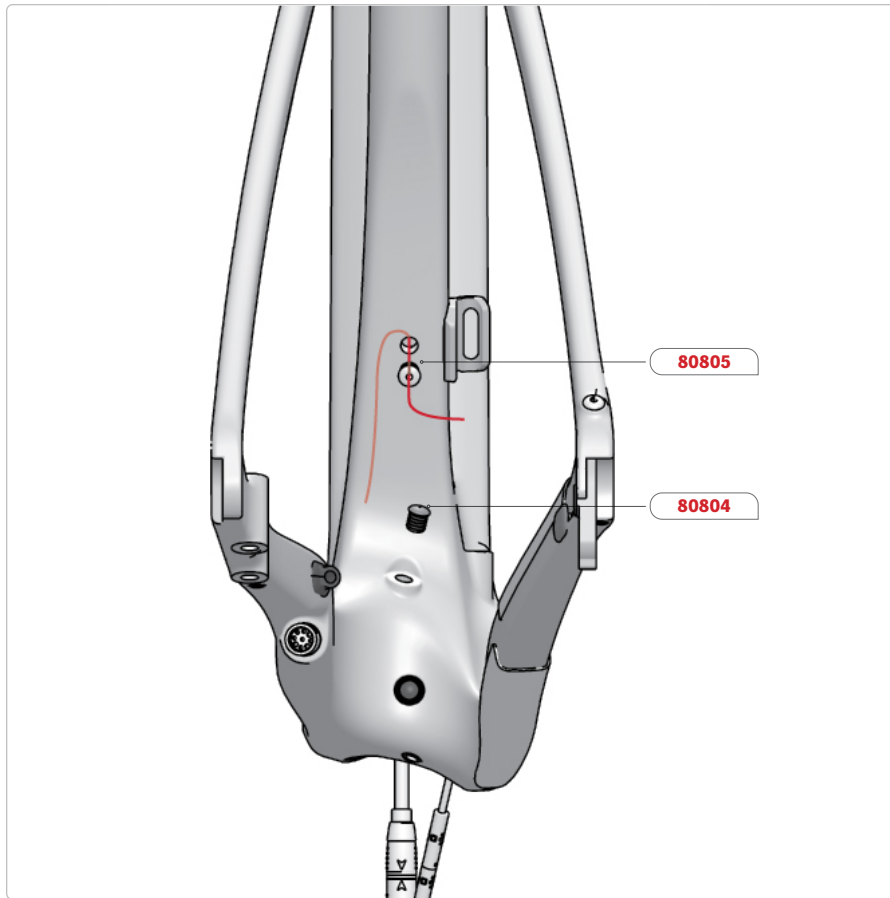

- 1.** Insert Di2 front derailleur cable from hole behind seat tube until it exits from the BB hole.
- 2.** Plug the cable into the junction box.
- 3.** Install the plug grommet (SKU: 80804) in the FD housing exit hole and the Di2 grommet (SKU: 80805) into the Di2 seat tube hole.

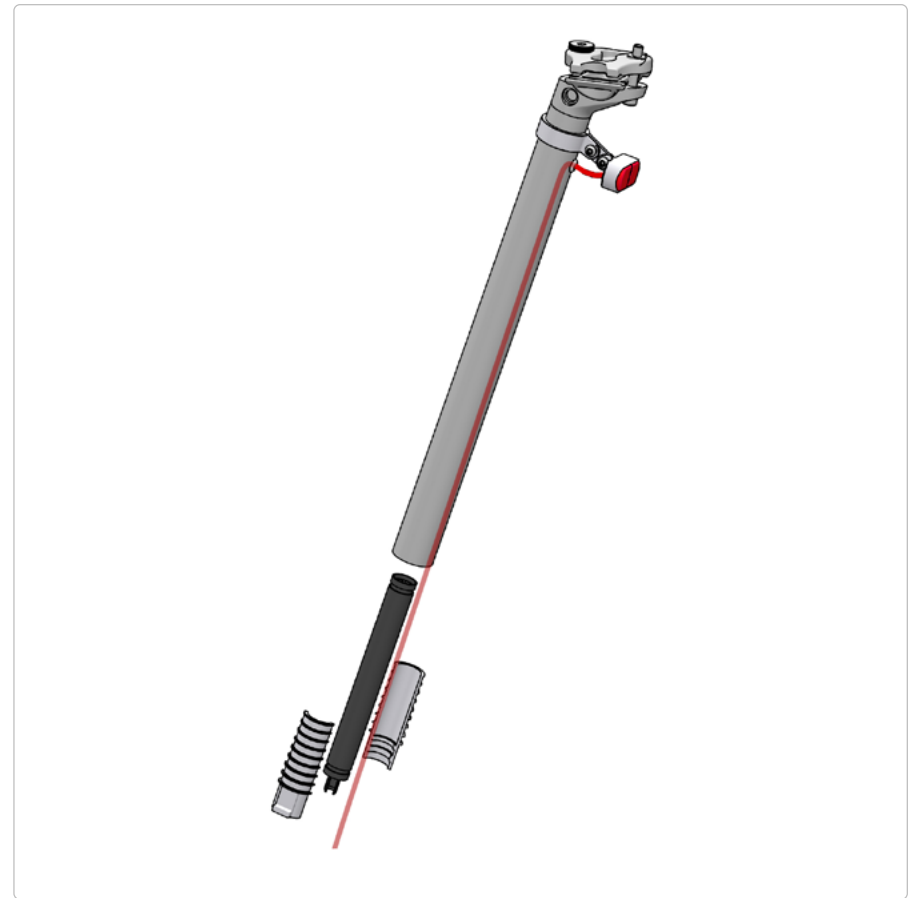

- 1.** Place the battery between the battery holders (SKU: 38446). Align the rib on the battery holders with the notch on the battery.
- 2.** Align the rear light cable in the gap between both battery holders.
- 3.** Slide the assembly into the seatpost until the tab rests at the edge of the seatpost.

## **18.1 CABLE AND HOUSING ROUTING - ELECTRONIC WIRELESS ROUTING**



- 1.** The rear brake hose must be routed above the battery and it will be above the BB once installed.
- 2.** The brake hose can be covered by a foam liner (SKU: 80811).
- 3.** Refer to the Internal Routing Guide on the website ([www.argon18.com/en-ca/support/downloads](http://www.argon18.com/en-ca/support/downloads)) for the cable configuration around the steerer tube, this depends on the choice of cockpit.

## 18.2 CABLE AND HOUSING ROUTING - ELECTRONIC WIRELESS ROUTING

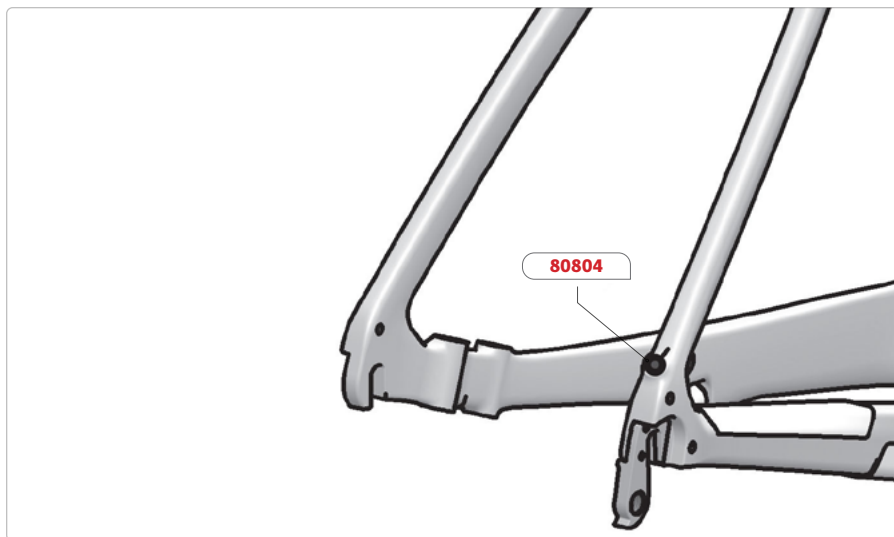

### Rear Derailleur:

1. Install the plug grommet (SKU: 80804) into the seat stay hole.

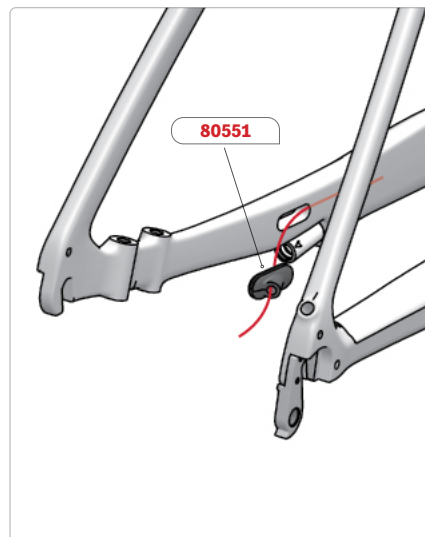

### Rear Brake:

1. Insert hose from rear hole on the chainstay.
2. Guide the hose over the battery through the BB hole.
3. Exit the hose through the side guide hole.
4. Insert the rear brake oblong cable guide (SKU: 80551) into the chainstay hole.

### **18.3 CABLE AND HOUSING ROUTING - ELECTRONIC WIRELESS ROUTING**



- I.** Install the plug grommet (SKU: 80804) into the Di2 seat tube hole and FD housing exit hole.

## 19. CABLE AND HOUSING ROUTING - DROPPER SEATPOST

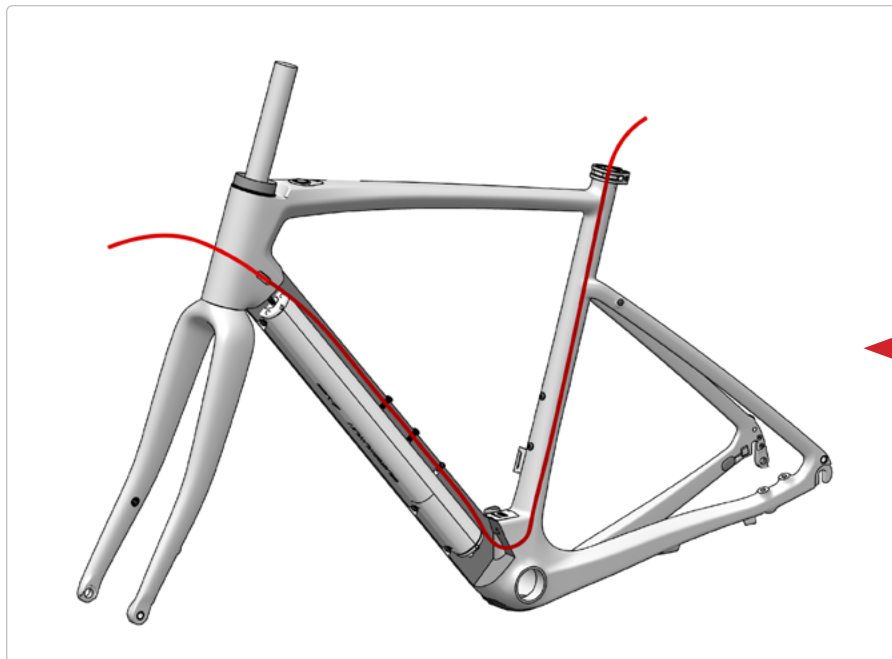

**THE SUBITO IS COMPATIBLE WITH A DROPPER POST IN MECHANICAL OR AXS BUILD. HOWEVER, THE REAR LIGHT WILL NEED TO BE REMOVED OR ROUTED EXTERNALLY FROM THE FRONT DERAILLEUR CABLE HOLE ON THE SEATTUBE.**

### With a mechanical 2X groupset:

1. All cables must be routed above the battery.
2. The dropper post housing will be above the BB once installed.
3. The dropper post housing can be covered by a foam liner (SKU: 80811).
4. Insert the housing into the hole on the side of the downtube, over the battery and through the seat tube.
5. Follow dropper seatpost manufacturer installation procedure.

### With a AXS groupset or mechanical 1X groupset with the front light wire exiting from the downtube hole:

1. All cables must be routed above the battery.
2. The dropper post housing will be above the BB once installed.
3. The dropper post can be covered by a foam liner (SKU: 80811).
4. Insert the housing into the headtube, over the battery and through the seat tube.
5. Follow dropper seatpost manufacturer installation procedure.



### IMPORTANT:

Only four cables can pass through the headset per headset manufacturer recommendation.



## 20. FRONT LIGHT INSTALLATION

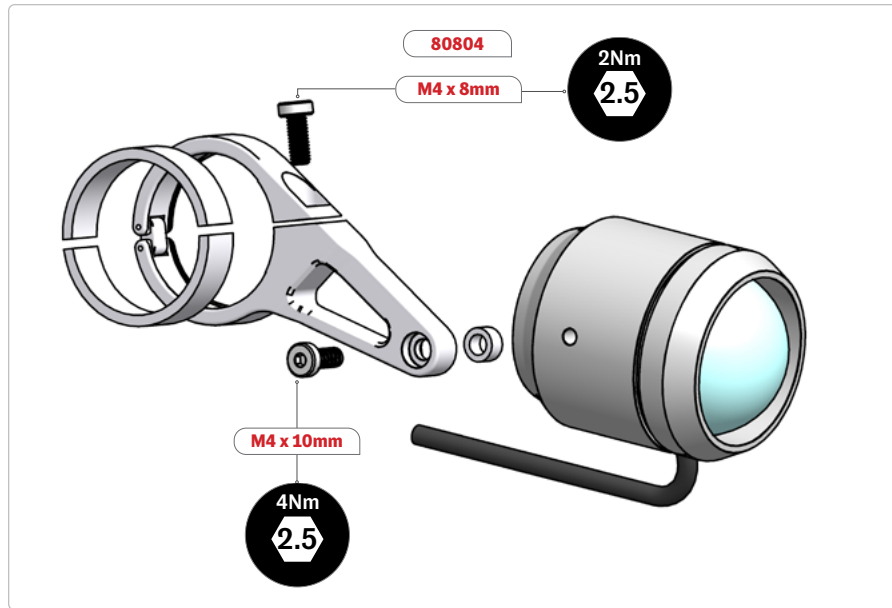

1. Install the front light on the handle bar as shown in the image at left.
2. Tighten the handlebar M4 screw to 2Nm, and the light screw to 4Nm.
3. If a routing through the headtube is desired, see possible configuration below. Guide the light cables through the headset until it exits from the hole on the downtube. Otherwise, skip this step.
4. Adjust the length of both cables with a flush cut plier.
5. Remove 12 mm of the outer casing on both cables.
6. Insert both cables from the light into the connector (SKU: 100166) in the upper moving part. Press the connector with pliers until it clicks.
7. Insert both cables from the battery into the connector (SKU: 100166) in the upper moving part. Make sure the black cable is aligned with the black cable from the light, and the blue cable with the red cable. Press the connector with pliers until it clicks.
8. Push the connector inside the frame.

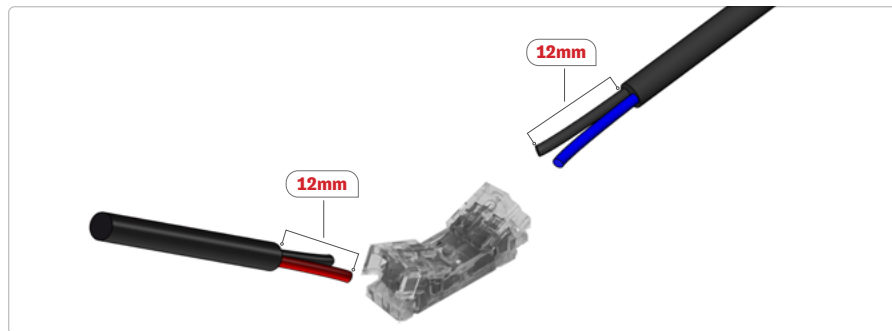

### Through Head Tube:

- Mechanical 1x without dropper post
- Mechanical 1x without dropper post at down tube hole
- AXS
- Di2

### Through downtube hole:

- Mechanical 2x
- Mechanical 1x with dropper post

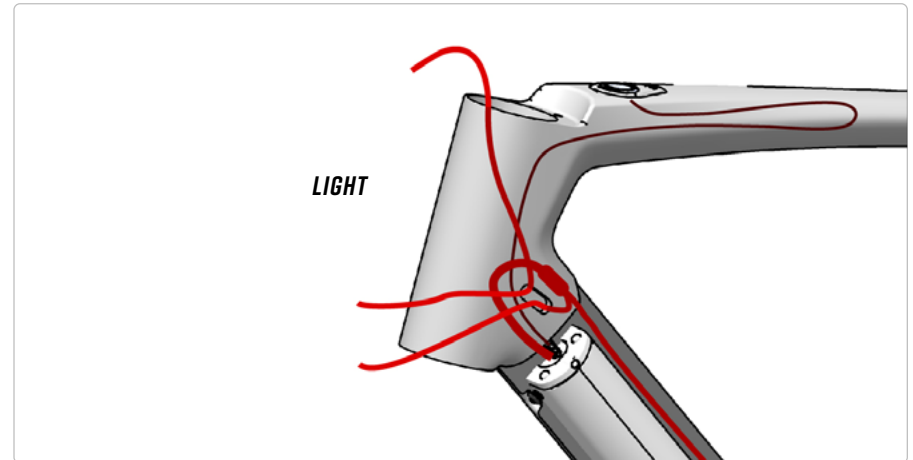

### IMPORTANT:

Only four cables can pass through the headset per headset manufacturer recommendation.

## 21. CABLE AND HOUSING ROUTING - FRONT GROMMET SELECTION

### Parts needed for installation:

- Oblong plug (SKU: 80549)
- Cable guide oblong (SKU: 80550)
- Rear brake oblong cable guide (SKU: 80551)

1. Choose the right grommet for the desired configuration.
2. Install the grommet on the frame.



### IMPORTANT:

Only four cables can pass through the headset per headset manufacturer recommendation.

No cable

80549

Light cable

80550

Dropper post  
and light

80551

## 22. HEADSET INSTALLATION

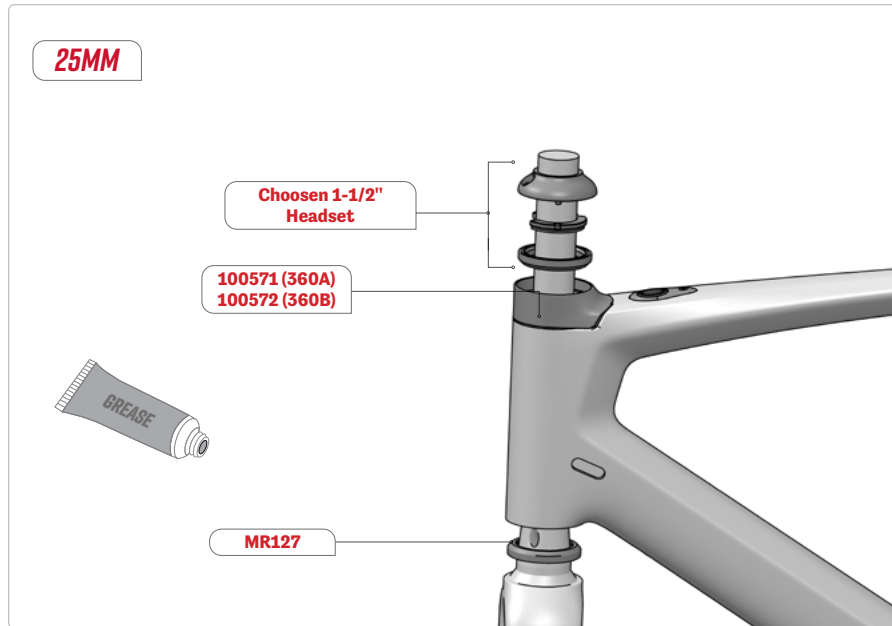

### 25mm assembly process:

1. Install the 3D headset cap (SKU: 100571 or 100572) over the 3D column. Align the pin in the frame hole and lower the cap.
2. Install the bottom (MR127) bearing on the fork. (Apply grease on both sides of the bearing)
3. Insert top bearing (supplied with the headset) into the headset column. (Apply grease on both sides of the bearing)
4. Slide the fork into the head tube while orienting all housing on the good side of the steerer tube (please see: [Internal routing compatibility](http://www.argon18.com/en-ca/support/downloads) on our website ([www.argon18.com/en-ca/support/downloads](http://www.argon18.com/en-ca/support/downloads))).
5. Install conical compressor ring with all cables in the right place.
7. Install headset top cover with all cables in the right place.
8. For more information on compatible systems and assembly suggestions, please see: [Internal routing compatibility](http://www.argon18.com/en-ca/support/downloads) on our website ([www.argon18.com/en-ca/support/downloads](http://www.argon18.com/en-ca/support/downloads)).

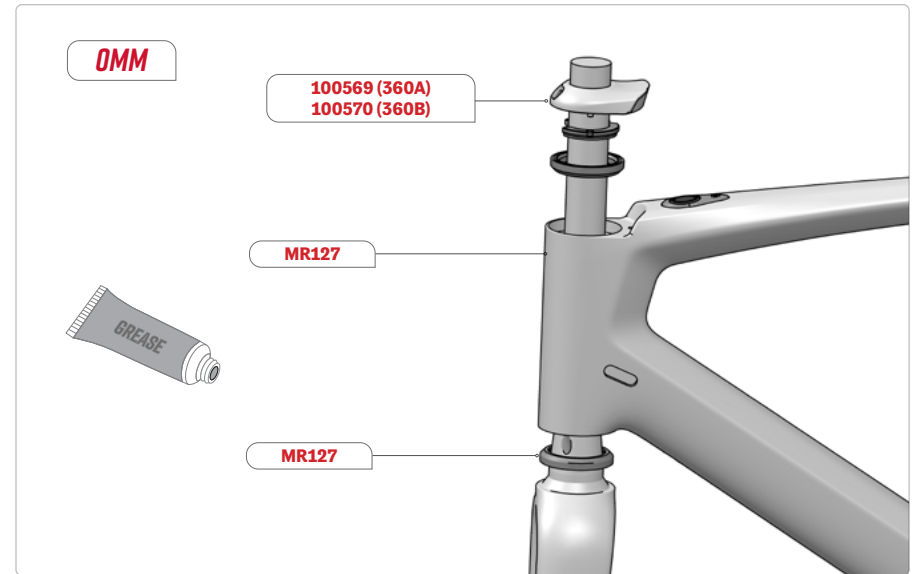

### 0mm assembly process:

Please note that this cap is designed to replace a SRS headset top cap.

1. Install the bottom (MR127) bearing on the fork. (Apply grease on both sides of the bearing)
2. Insert top bearing (MR127) in the headset column. (Apply grease on both sides of the bearing)
3. Slide the fork into the head tube while orienting all housing on the good side of the steerer tube. (please see: [Internal routing compatibility](http://www.argon18.com/en-ca/support/downloads) on our website ([www.argon18.com/en-ca/support/downloads](http://www.argon18.com/en-ca/support/downloads))). For SRS system, we suggest that all cables pass on the same side of the steerer as the lever they are going to.
4. Install conical FSA compressor ring with all cables in the right place.
5. Install headset top cover (SKU: 100569 or 100570) with all cables in the right place.



### IMPORTANT:

Only four cables can pass through the headset per headset manufacturer recommendation.

## 23.1 REAR WHEEL INSTALLATION (DISC INSTALLATION)

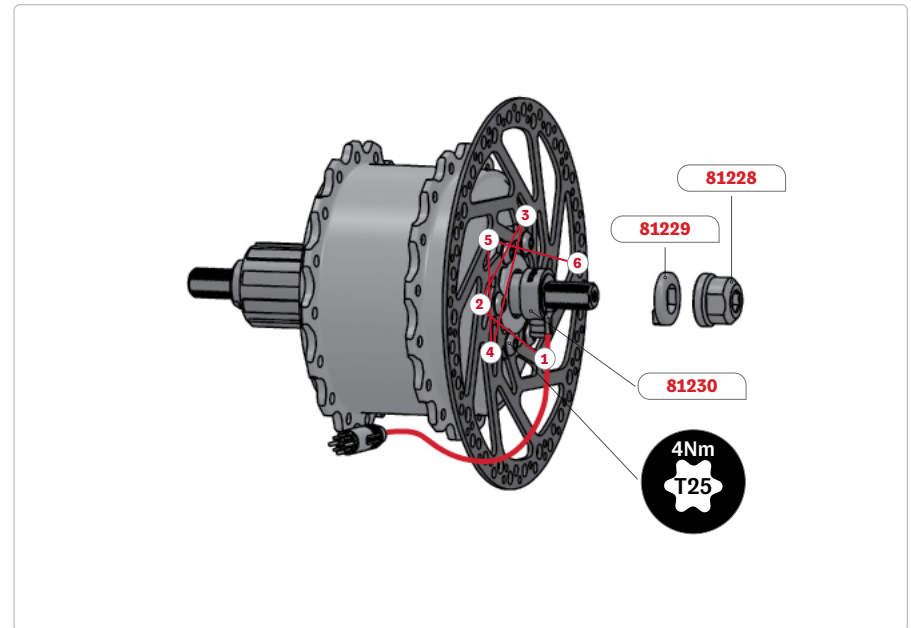
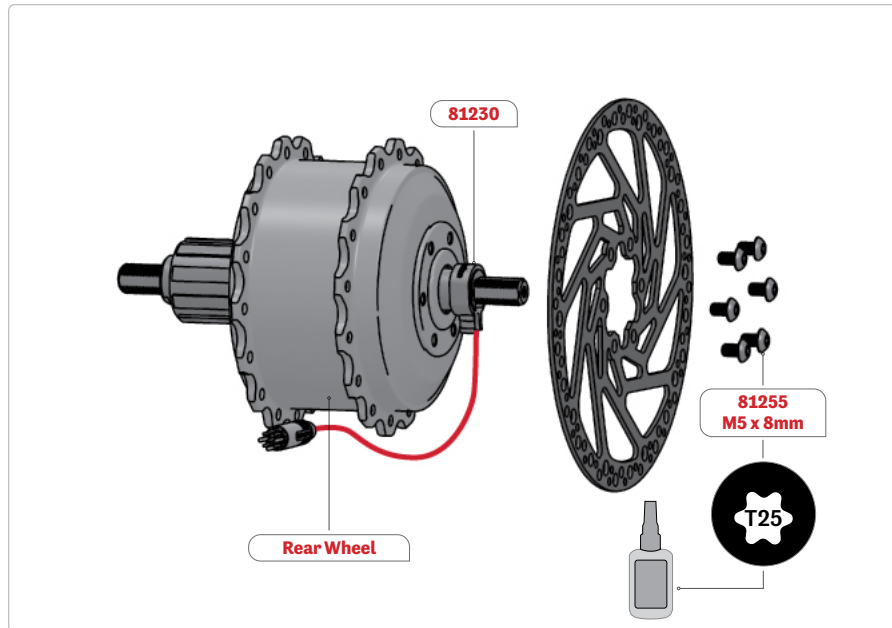

1. Use the M5 x 8mm torx screw (SKU: 81255) supplied with the frameset. A longer screw will damage the motor.
2. Apply thread locker before installing the bolt.
3. Once the bolts are hand tightened, turn the rotor clockwise to assure good contact between the rotor and the bolt.
4. Tighten to 4Nm in a star pattern.
5. Install the cable shield (SKU: 81230).
6. Install the torque washer nut (SKU: 81229), aligning the shoulder with the cable.
7. Install the motor lock nut (SKU: 81228).



### IMPORTANT

Use only M5 x 8mm screws. Using longer screws will lock the motor and void the warranty.

## 23.2 REAR WHEEL INSTALLATION (CASSETTE INSTALLATION)

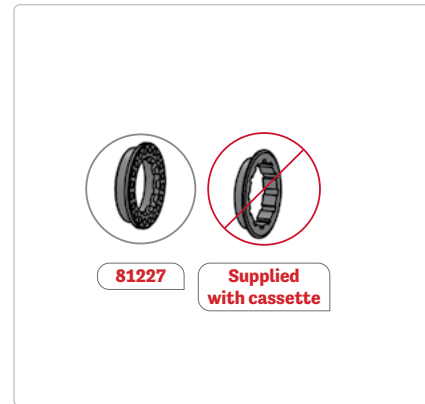
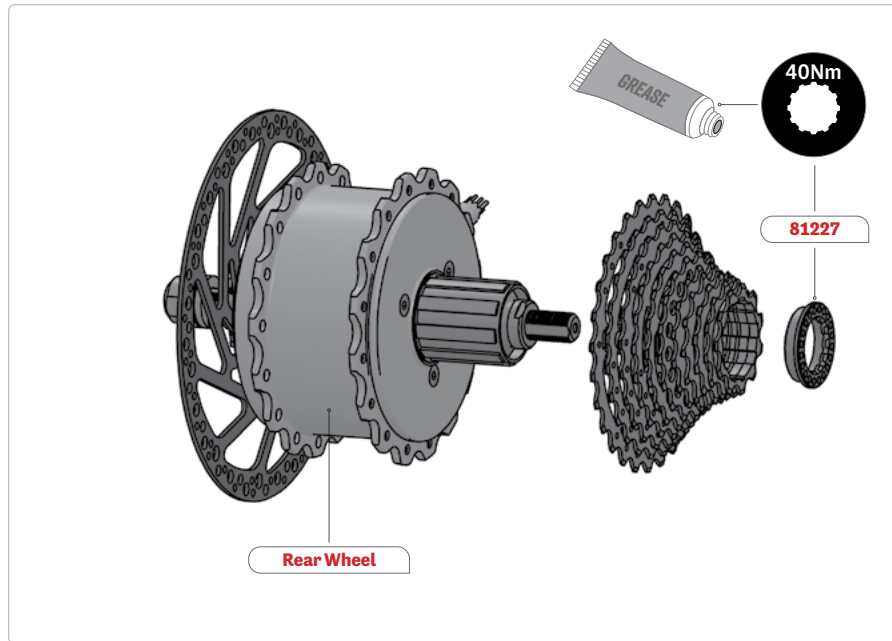

### IMPORTANT

Use the supplied cassette Magnet lock nut (SKU: 81227). Without it (SKU: 81227), the ebikemotion system will not recognize the pedaling movement and will not provide any assistance.

1. You will need to replace the the lockring supplied with the cassette and use the magnet locknut (SKU: 81227).
2. Place the cassette on the cassette body, aligning the spline.
3. Grease the threads of the magnet locknut.
4. Screw the magnet locknut in place.
5. Torque to 40Nm.

## 23.3 REAR WHEEL INSTALLATION

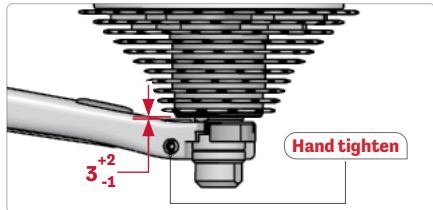
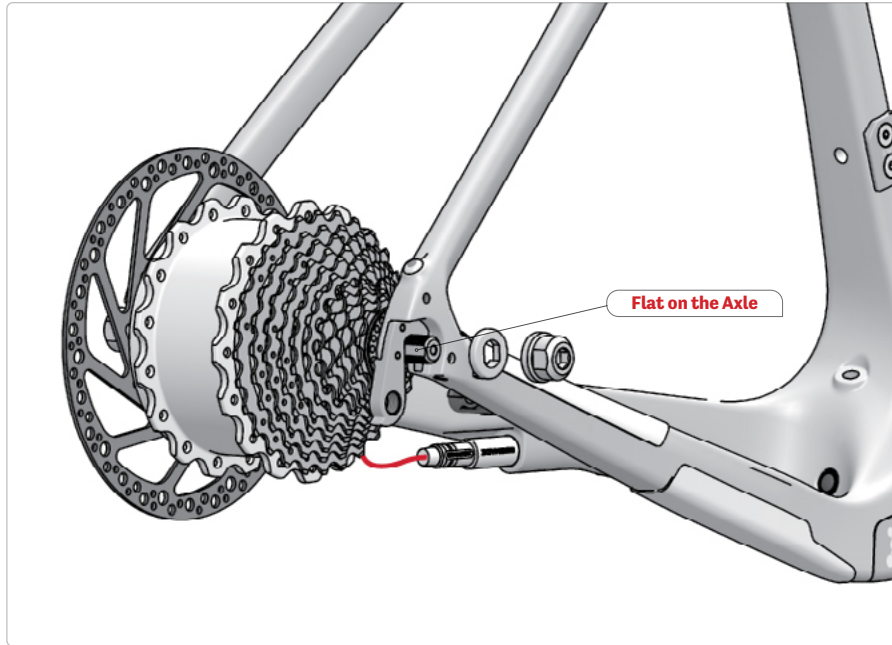

Adjust PAS sensor distance: Distance from PAS sensor to magnet must be between 2 and 5mm. Hand tighten the screw.

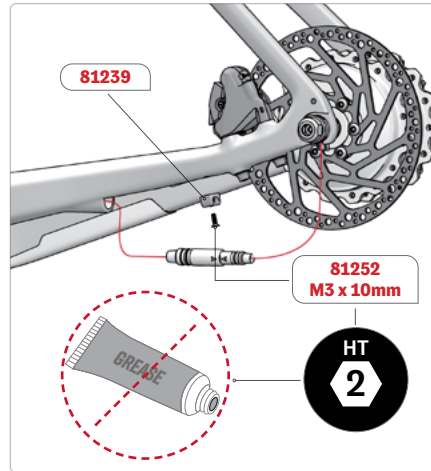

1. Align the face on the axle with the drop-out, the cable must exit downward.
2. Tighten NDS motor lock nut with an 8mm Allen key, torque to 35Nm.
3. Install the drive side torque washer nut (SKU: 81229), aligning the shoulder with the NDS washer.
4. Install the drive side motor lock nut (SKU: 81228) and tighten with an 8mm Allen key, torque to 35Nm.
5. Install the chainstay wire clip (SKU: 81239), using the M3 x 10mm flat head cap screw (SKU: 81252), hand tighten and do not apply grease.
6. Connect the motor cable to the battery, align both arrows on the connector.
7. Push the connector into the chainstay. You can pull from the BB hole to help.
8. Clip the cable in the cable clip contouring the brake bolts.

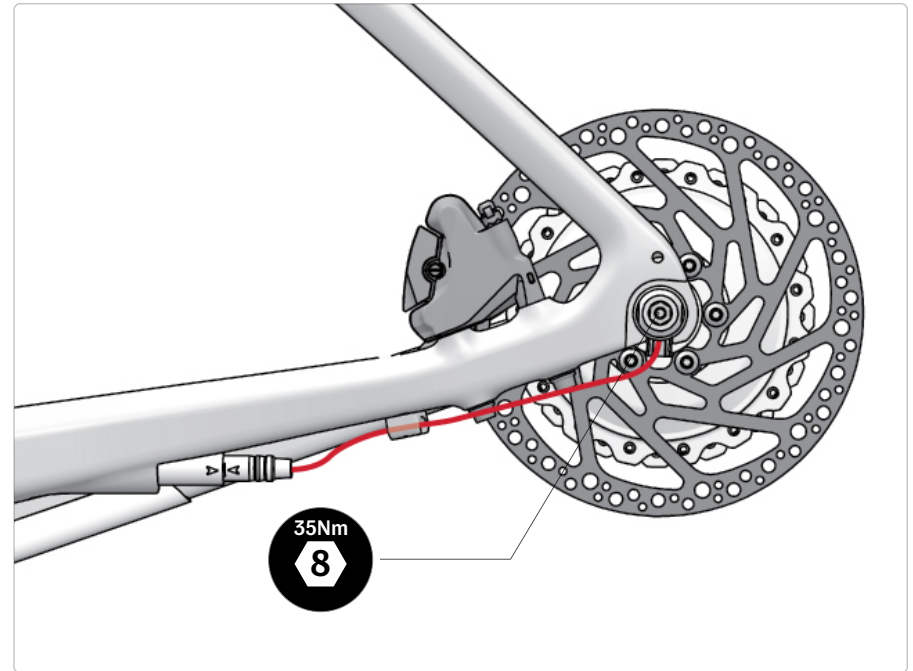

## 24. BB COVER INSTALLATION

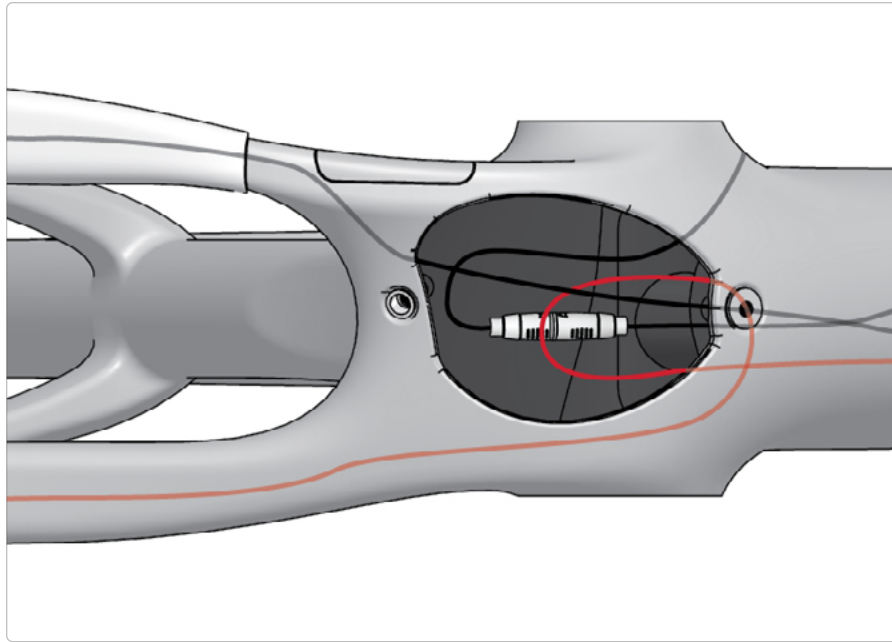

1. Install the bottom bracket using a bottom bracket press.
2. Push the cable into the opening. Make sure the motor cable has enough range of movement to be able to remove the wheel without removing the BB cap.
3. Install the BB cap (SKU: 81241). Hand-tighten the M4 x 10mm button head cap screw (SKU: 81251). Do not apply grease.

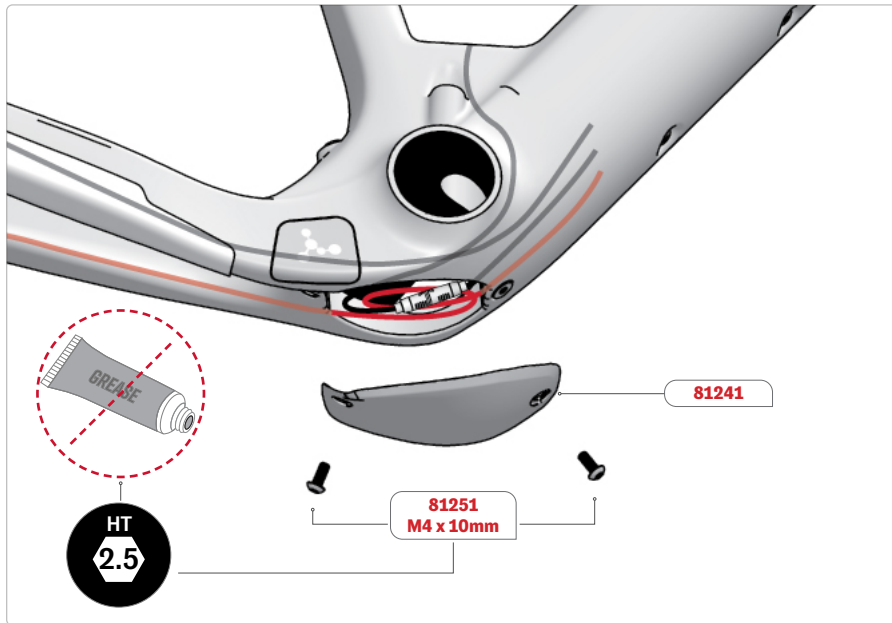

## 25. CHAIN CATCHER

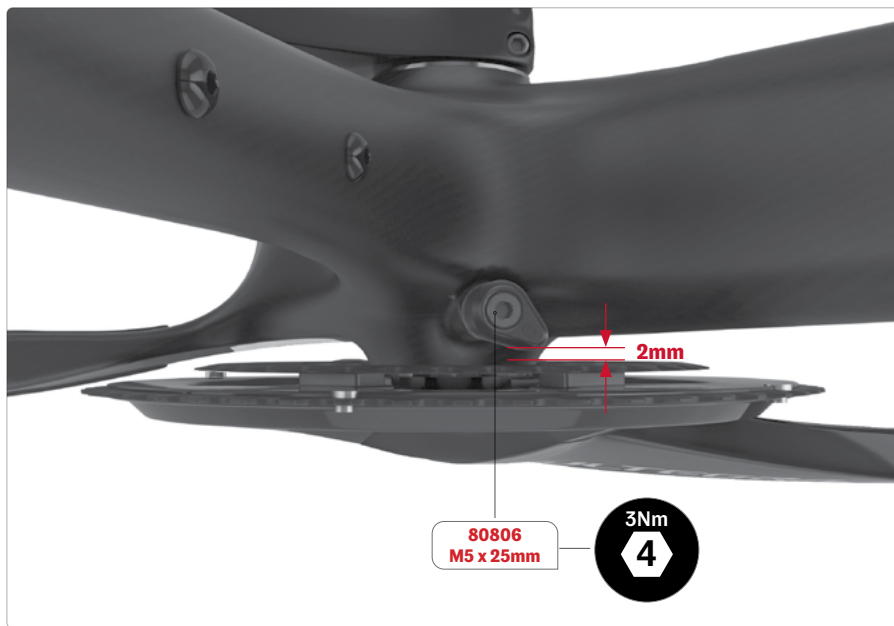
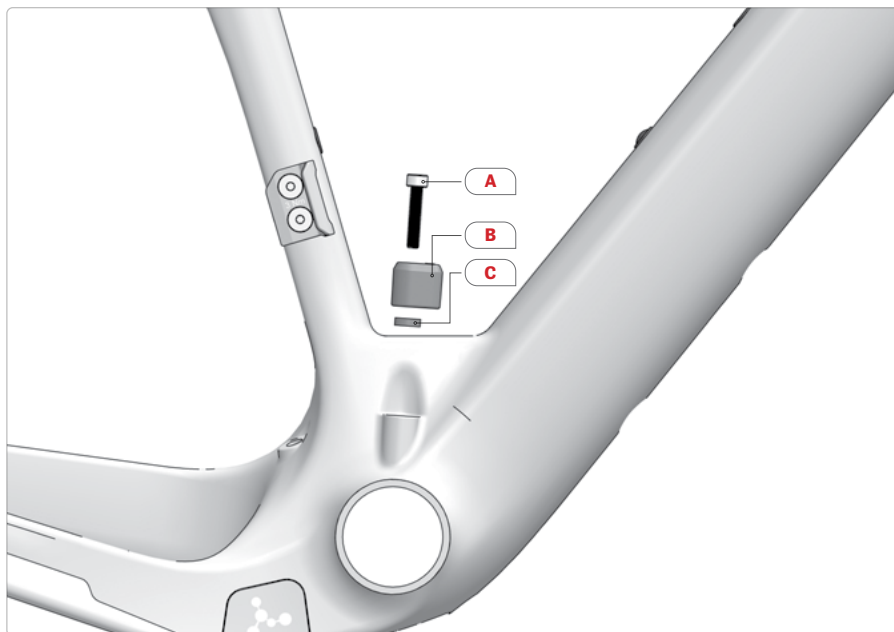

1. Select the appropriate chain catcher (SKU: 80806). The selection of the correct chain catcher is made according to the size of the small chainring.

| SMALL CHAIN RING SIZE | CHAIN CATCHER |
|-----------------------|---------------|
| 30-32                 | Small         |
| 34 and more           | Large         |

2. Insert the M5 x 25mm screw (a) in the chain catcher (b) and place the lock washer (c) between the frame and the piece. Secure the assembly pointing forward, loose enough to be able to adjust the parts.
3. Install the crank according to manufacturer's specifications.
4. Place the tip of the chain catcher at approximately 2mm to the inner side of the small chain ring and torque to 3Nm.

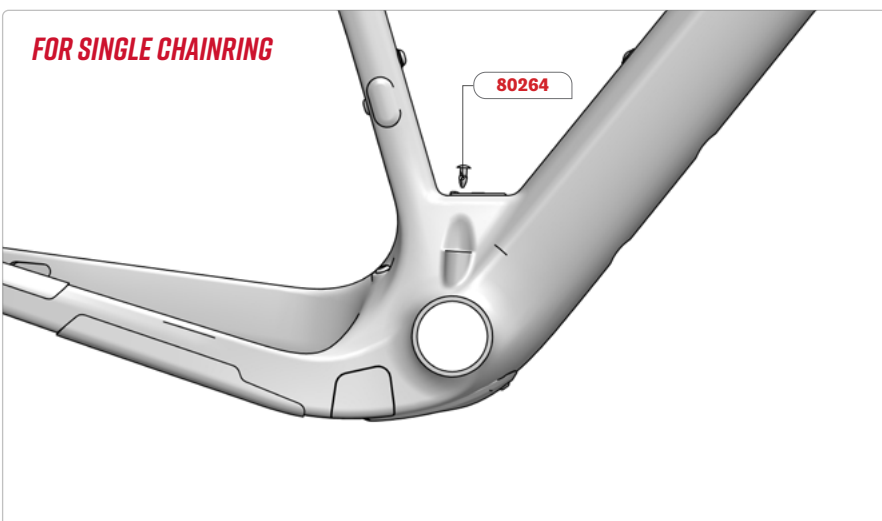

1. Install a M5 plug (SKU: 80264) over the chain catcher hole.



## 26. REAR RACK AND FENDER INSTALLATION

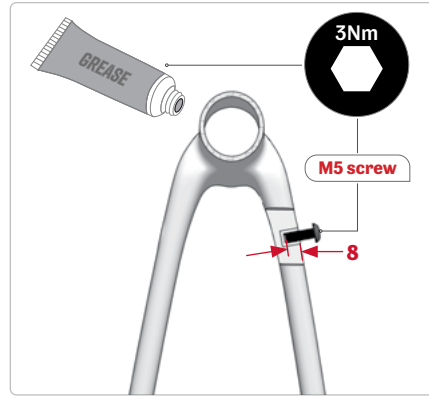

1. According to the model of fender used, place the fender bracket (SKU: 80808) at the correct height on the seat stay.
2. Secure the fender bracket with the two supplied rubber bands making sure that the 2 plastic parts overlap.
3. When securing the fender and/or the rear rack on the drop-out, make sure that the screw doesn't interfere with the chain. The maximum insertion of the screw is 15mm to avoid protrusion and possible chain interference. Make sure there's at least 10mm of screw insertion to support the load.
4. On the seat stay, the thread length is 8mm, make sure to have 8mm or less of thread insertion.

\* If a fender is used with a rear rack: if possible, screw the fender onto the rear rack. If not, place the rear rack between the frame and the fender on the screw. All screws must be torqued to a maximum of 3Nm. Apply grease on the threads.



## 27. FRONT FENDER INSTALLATION

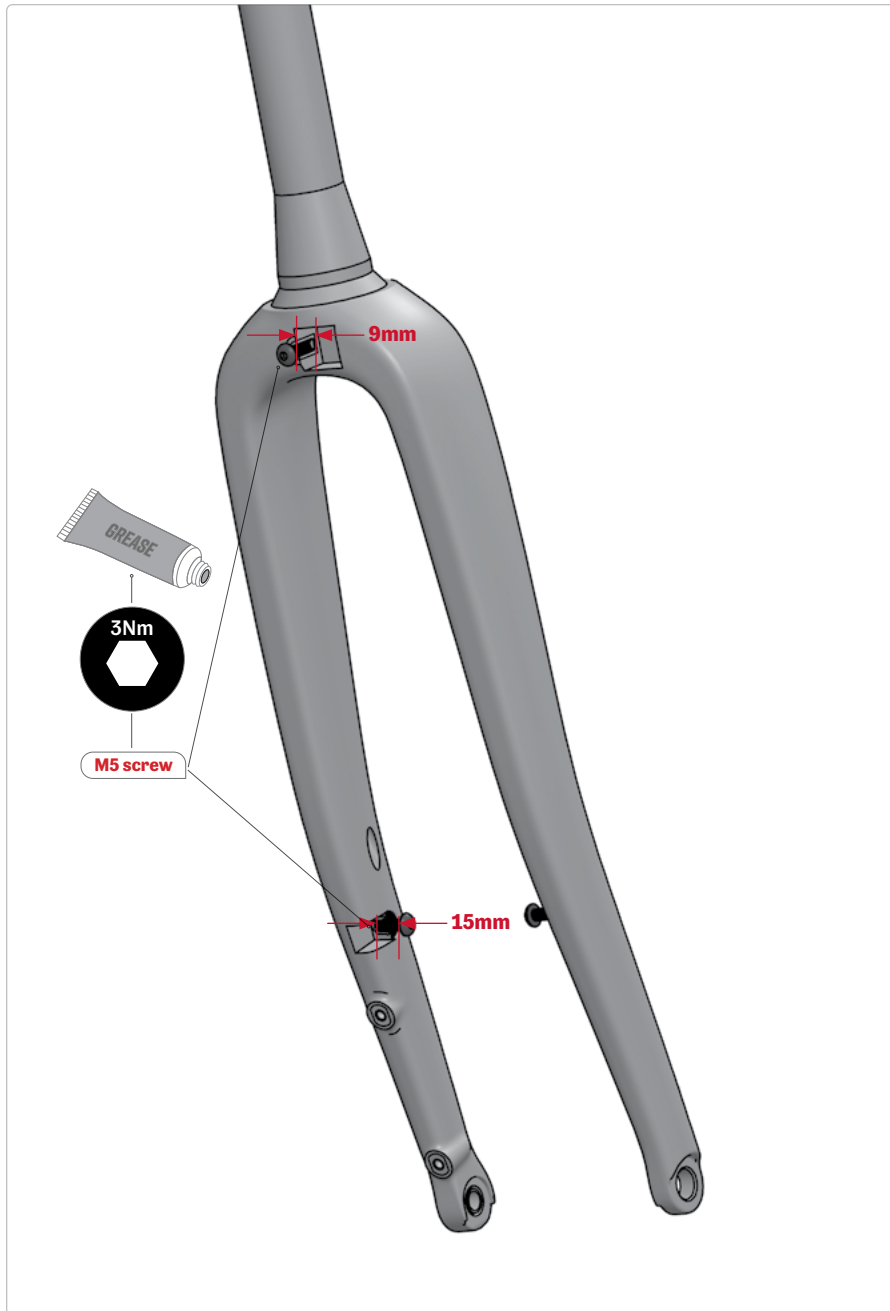

- On the upper screw, the thread length is 9mm. Make sure to have 9mm or less of thread insertion.
- On the lower screw, the thread insertion is 15mm. The thread starts 5mm above the surface of the fork. There must be between 10 and 15mm of visible thread once the fender is on the screw.
- All screws must be torqued to a maximum of 3Nm. Apply grease on the threads.

## 28. RANGE EXTENDER AND WATER BOTTLE POSITION

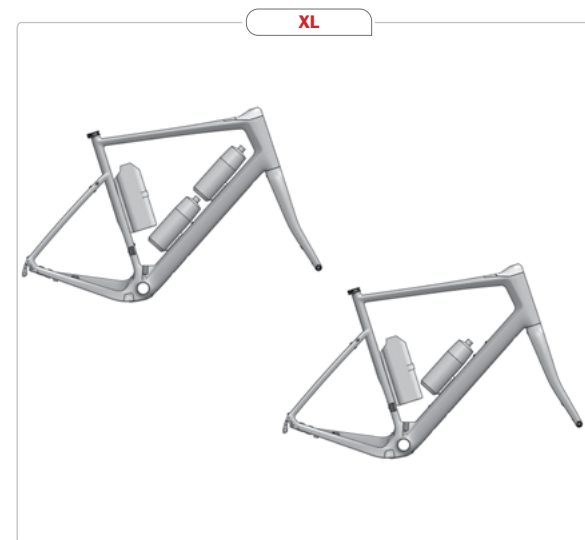
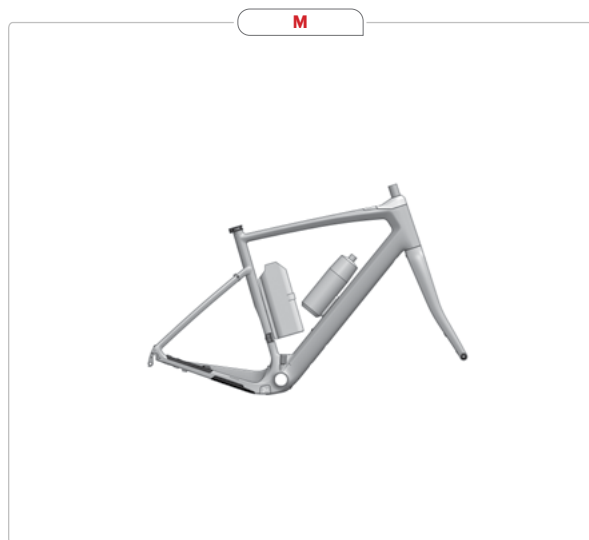
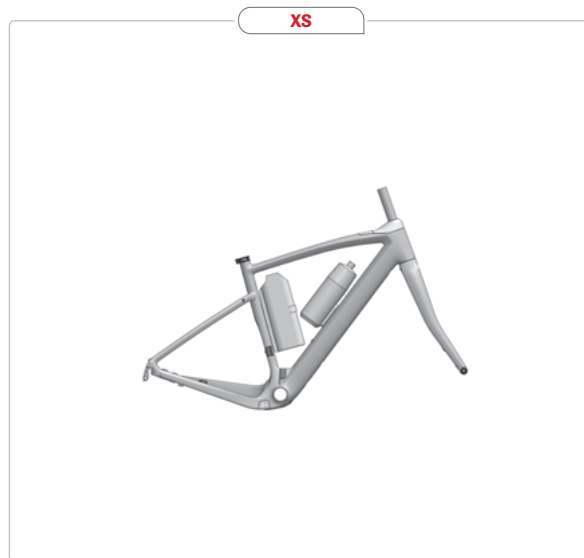

Here are some possible options of how to fit the battery range extender and waterbottle(s) onto the frame's water-bottle-cage mounts, depending on the frame size.

On frame size XXS, unfortunately the range extender cannot be installed with a bottle cage at the same time.

## 29. SEAT POST MIN AND MAX INSERTION

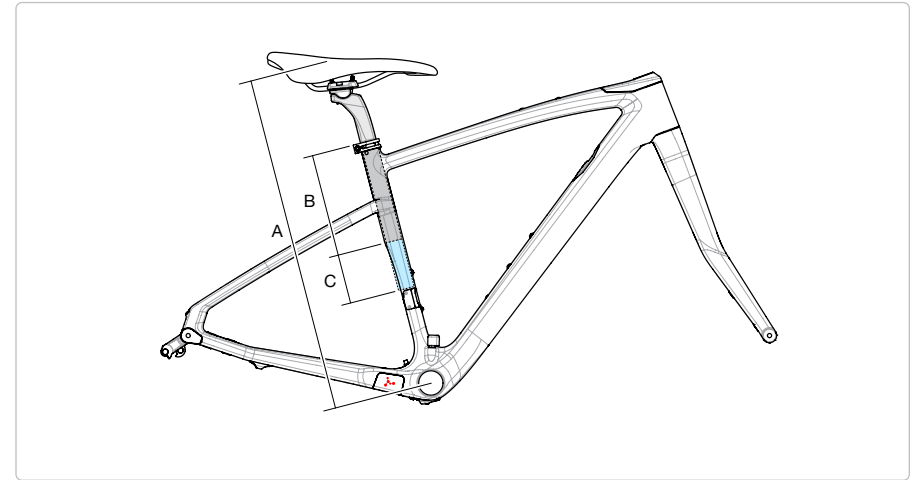
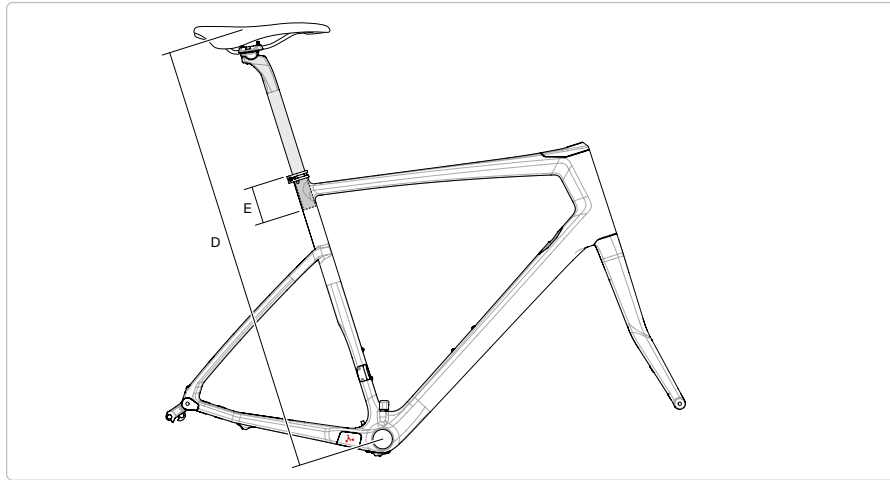

Refer to the table adjacent for details on saddle height and seatpost insertion limits:

- i. The correct frame size must be determined according to the saddle height limits.
  - A. Minimum Saddle Height.
  - D. Maximum Saddle Height.
- ii. Depending on the size of the frame and the desired saddle height, the seatpost might need to be cut.
  - B. Maximal insertion depth in the frame's seat tube.
  - C. Required seatpost cut length to be able to adjust the saddle height at the minimum position.
    - » Adjust the seatpost cut length in accordance with your desired saddle height.
    - » **Required Minimum Seatpost Cut Length = C - ("Desired Saddle Height" - A)**
    - » **Example:** For a desired saddle height of 600mm on a XX-Small Subito frame.
    - » The required minimum seatpost cut length is:  $135 - (600 - 520) = 55\text{mm}$ .
  - E. Minimal insertion depth in the frame's seat tube.

### SADDLE HEIGHT LIMIT

### SUBITO

| SIZE | SADDLE H MIN. | ST MAX INSERT | SP CUT | SADDLE H MAX. | SP MIN INSERT |
|------|---------------|---------------|--------|---------------|---------------|
| UNIT | mm            | mm            | mm     | mm            | mm            |
|      | A             | B             | C      | D             | E             |
| XXS  | 520           | 165           | 135    | 740           | 80            |
| XS   | 550           | 185           | 115    | 770           | 80            |
| S    | 585           | 215           | 85     | 805           | 80            |
| M    | 620           | 250           | 50     | 840           | 80            |
| L    | 655           | 245           | 55     | 875           | 80            |
| XL   | 690           | 285           | 15     | 910           | 80            |

## **30. ADDITIONNAL DOCUMENTATION**

### **Distributor**

- Subito Distributor Procedure
- Ebike\_Activation\_Guide\_v1.1\_28022019

### **Dealer**

- Dealer APP Manual (EN V1.0)

### **End user**

- Subito Quick Start Guide
- Subito Range Extender

Available at: <https://mahle-smartbike.com/downloads/>

- MAHLE - iWoc ONE - Quick User Guide (EN-ES-DE-FR-IT-PT-NL)
- MAHLE - X35-Care+Maintenance (EN-ES-DE-FR-IT-PT-NL)
- MAHLE - X35-Connection+Mount (EN-ES-DE-FR-IT-PT-NL)
- MAHLE - X35-Charger
- MAHLE - X35-Connection+Mount (EN-ES-DE-FR-IT-PT-NL)
- MAHLE - X20-X35-MAHLE-PulsarONE
- User Manual – APP (EN.V1.0)
- Web User DashBoard Manual (EN V1.0)