

ARGON 18



**GREY
MATTER**

TABLE OF CONTENTS

1. Tools Needed & Spare Parts Kit	3
2. Troubleshooting / Tips & Specifications	4
3. Frameset Inspection	5
4. Frameset Skus & Descriptions	6-7
5. SeatPost Installation	8
6. SeatPost Min. & Max. Insertion	9
7. Derailleur Hanger Assembly	10
8. 3D Headset Installation	11
10. Brake Routing	12
11. Front Brake Routing	13
12. Mechanical Groupset Routing	14-15
13. eTap Groupset Routing	16
14. Di2 8100-9200 Groupset Routing	17-18
15. Di2 Groupset Routing	19-20
16. Dropper Seatpost Installation	21
17. Bottom Bracket Cable Guide Installation	22
18. Fork Installation	23
19. Bottle Cage Position	24
20. Rear Rack And Fender Installation	25
21. Front Rack And Fender Installation	26

To maintain the validity of the warranty, the bicycle must be fully assembled by an authorized Argon 18 dealer. High-end components, particularly carbon parts, require extra care during assembly.

These components must be installed using a torque wrench to ensure each bolt is at the specified torque setting to prevent damage.



MY GREY MATTER

Date of Purchase: _____

Retailer: _____

Size: _____

Serial Number: _____

1. TOOLS NEEDED & SPARE PARTS KIT

Hydraulic Hose Cutter



Allen Key Set



Flush Cut Plier



Carbon Paste & Grease

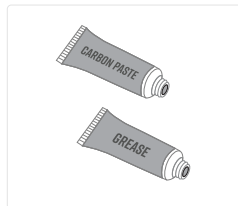

Utility Picks



Clean Rag

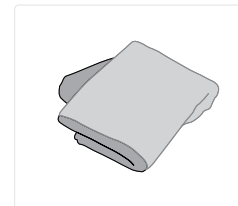

Derailler Hanger
Alignement Gauge

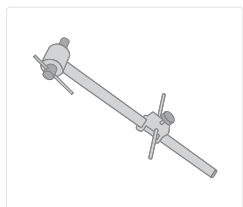

Cables And
Housing Cutter



Thread Locker
Medium Strength



Isopropyl Alcohol

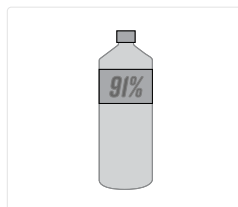

Torque Wrench



Cassette Lockring Tool

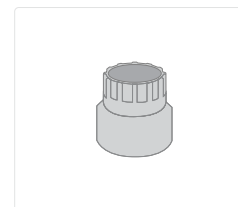

8mm Wrench

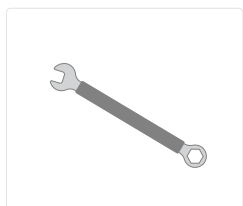

Bleed Kit



Torx Key Set

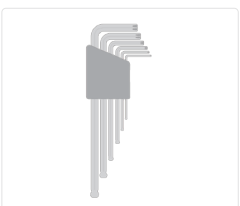

Mineral Oil



Headset Press

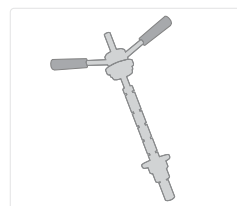

Seat Post Clamp



Rear Derailleur Hanger



SPARE PARTS KIT



IMPORTANT:

Spare Parts Kit: Essential parts to
always have on hand
IN CASE OF EMERGENCY...**THIS MIGHT
SAVE YOUR RIDE!**

80801

100279

2. TROUBLESHOOTING / TIPS & SPECIFICATIONS

Brakes

Front brake - 140/160mm disc rotors

Rear brake - 140/160mm disc rotors

Rear mount thickness: 20mm.

Tire Clearance

700c

Maximum clearance: 700x42c. Tires must be no wider than 43mm for both front and rear wheels. With fenders, tires must be no wider than 38mm.

650b

Maximum clearance: 650bx47. Tires must be no wider than 47mm for both front and rear wheels. With fenders, tires must be no wider than 42mm.

Seat Post

Ø 27.2mm

Bottom Bracket

BB86 (Press-fit)

Headset

A18 3D IST2

Bottom Bearing: MR127 - 1 1/2", 36° x 45° Stainless Steel

Top Bearing: MR127 - 1 1/2", 36° x 45° Stainless Steel

*Some systems may require a 1 1/2", 45° x 45° top bearing

For more information, please refer to: Argon 18 - Internal routing compatibility

Chainring

The Grey Matter can run a 50-34 chainring maximum. It has been optimized for a gravel crankset.

A chainring of 48T maximum can be installed in 1x configuration.

Seat Post Collar

Ø 31.8mm

Front Derailleur

The Grey Matter can be used with a 31.8mm clamp front derailleur, or with a front derailleur clamp band adapter.

Accessories

The Grey Matter is designed to take fenders, a rear rack up to 27kg and front rack up to 18kg.

Please contact customer service at info@argon18.com for any further inquiries.

3. FRAMESET INSPECTION

Before assembling your new Grey Matter, please verify that you have all the following:

1. Frameset parts checklist (see p.6-7)
2. Inspect the frame for cosmetic defects (scratches, bumps, cracks, paint defects, etc.)
3. For reference, record serial number on p.2

4. All the necessary bolts (refer to frameset parts, p.6-7)
5. For optimal shifting performance, use a derailleur alignment gauge to make sure that the derailleur hanger is straight.



Some of the following parts are already assembled on the frame. When assembling the bike, you will need to adjust these parts according to their torque specifications and fastener conditions when necessary.

No.	A18 SKU#	Function	Description	Screw Type	Torque	Detail	Qty
1	81052	Front Thru Axle	M12 x 1.5 x 119mm Axle	Thru Axle	12 Nm	Grease	1
2	81053	Rear Thru Axle	M12 x 1.5 x 161mm Axle	Thru Axle	12 Nm	Grease	1
3	100279*	Rear Derailleur Hanger Screw	M4 x 14mm Screw	Taper Head	2 Nm	Loctite	1
4	100280*	BB Cable Guide Screw	M5 x 16mm Screw	Flat Head	Hand Tighten	Loctite	1
5	80801*	Seatpost Collar Screw	M5 x 22mm Screw	Socket Head	4 Nm	Grease	1
6	81249	Water Bottle Screw	M5 x 14mm Screw	Button Head	3 Nm	Grease	10
7	100283*	Cable Cover Screw	M4 x 8mm Screw	Flat Head	Hand Tighten	Loctite	2
* Included with							

For troubleshooting and FAQ, please visit :

<https://www.parktool.com/en-us/blog/repair-help/rear-derailleur-hanger-alignment>



Torque Value
Allen key size



Apply **carbon paste** on the indicated surfaces.



IMPORTANT:

Indicates special precautions and important steps that must be taken to avoid damage and/or injury.



Apply **threadlocker** on the indicated surfaces.



Apply **grease** on the indicated surfaces.

4. FRAMESET SKUS AND DESCRIPTIONS



Grey Matter Frame
*Not available as a separate SKU



FK.GM.XXS-S.356A
FK.GM.M-XL.356A



100280



81249

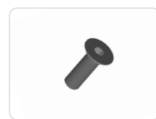

100283

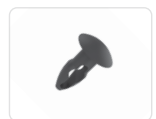

80264



100361



100156



80801



80811



100279



81054



81053

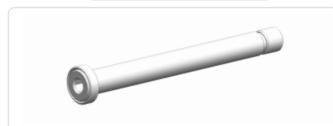

81052



100281



100282

Available Separately



38446



100362

Except for the frame itself, which is not sold separately as a spare part, all parts can be ordered by referring to their respective SKU number.

4. FRAMESET SKUS AND DESCRIPTIONS

NO.	NAME	A18 SKU#	QTY
1	Grey Matter Frame	-	1
2	Grey Matter Fork 54 mm (XXS-S) Grey Matter Fork 49 mm (M-XL)	FK.GM.XXS-S.356A FK.GM.M-XL.356A	1
3	Grey Matter Dropout Assembly	100279	1
4	Grey Matter BB Cable Guide Assembly	100280	1
5	Button Head Cap Screw For Water Bottle	81249	10
6	Grey Matter Cover For Mech	100281	2
7	Grey Matter Cable Cover	100282	2
8	Flat Head Cap Screw M4x8	100283	2
9	GW Front Thru Axle 12mm	81052	1
10	GW Rear Thru Axle 12mm	81053	1
11	Removable Lever For GW Thru Axle 12mm	81054	3
12	Plastic Plug For Water bottle Eyelet	80264	16
13	Foam Liner For Hydraulic Hose	80811	2
14	3D Headset Sleeve IST2	100156	1
15	3D Headset Column 25mm IST2	100361	1
16	Seatpost Collar	80801	1
OPTIONAL PARTS THAT CAN BE ORDERED SEPARATELY			
-	External Battery SP1 + Holder	38446	1
-	3D Headset Column 15mm IST2	100362	1

5 SEATPOST INSTALLATION



1. Apply grease on the thread of the M5 x 22mm socket head screw.
2. Assemble the seat post collar (80801) as shown.
3. Adjust the seatpost at the desired height. Make sure to follow the seatpost min and max insertion limits. (p. 9)
4. Tighten the M5 x 22mm socket head screw on the seatpost clamp to 4Nm.



IMPORTANT:

Refer to p.9 for seatpost **MIN** and **MAX** insertion limits.

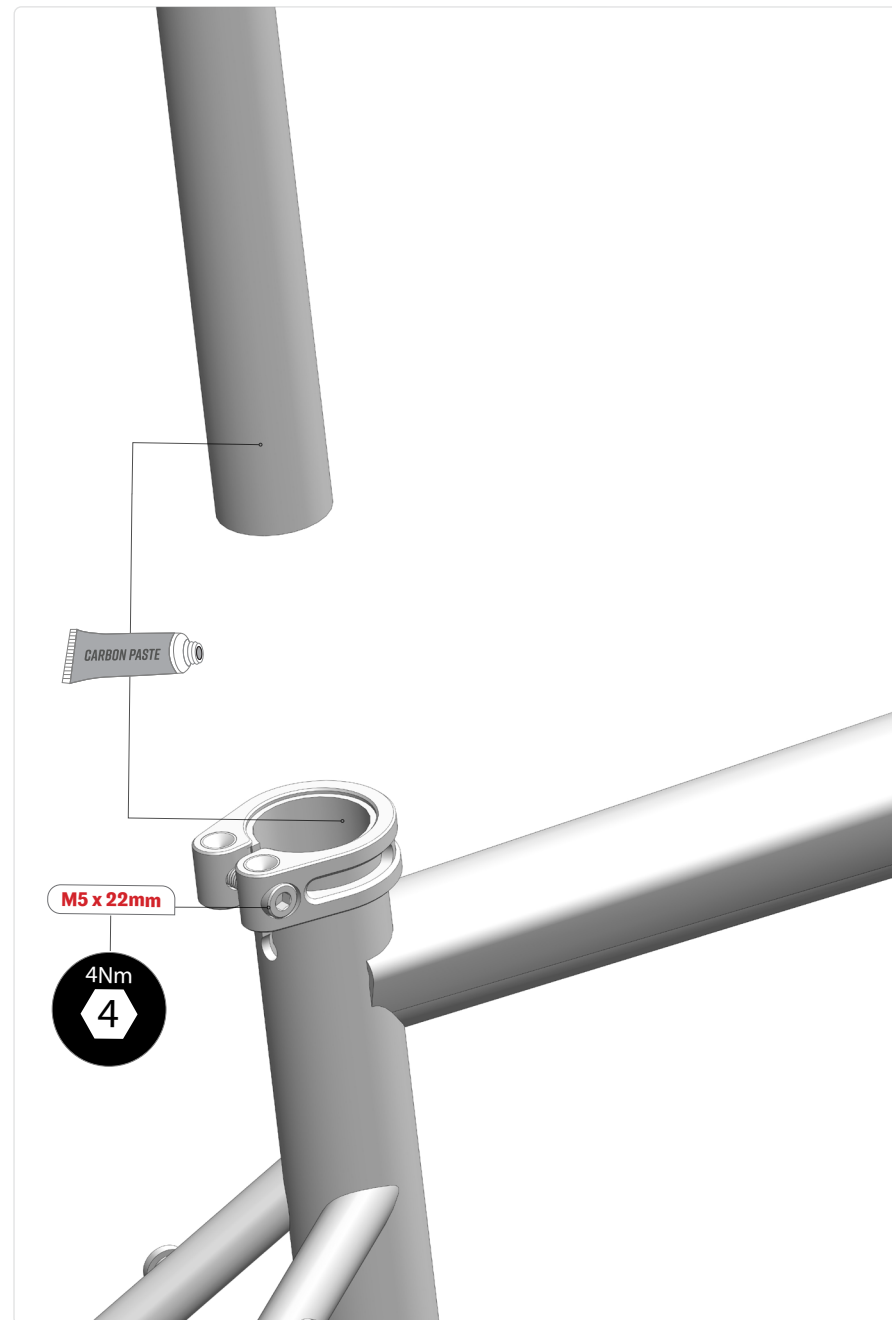

6. SEATPOST MIN. & MAX. INSERTION

Depending on the size of the frame, the desired height and the chosen seatpost, the seatpost might need to be cut.

SEATPOST INSERTION LIMITS (MM)		
SIZE	Max. Insertion	Min. Insertion
	A	B
XX-SMALL	180	80
X-SMALL	210	80
SMALL	245	80
MEDIUM	215	80
LARGE	250	80
X-LARGE	285	80

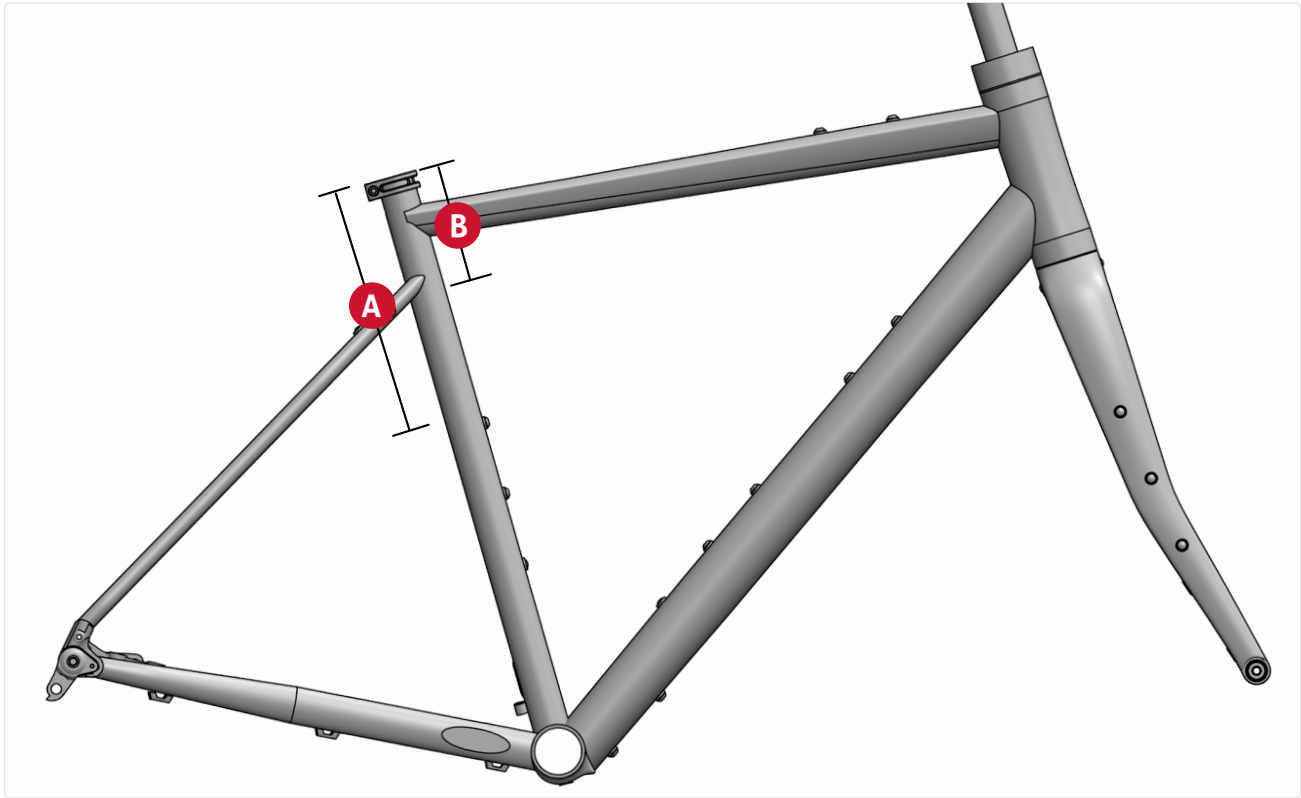

7. DERAILLEUR HANGER ASSEMBLY

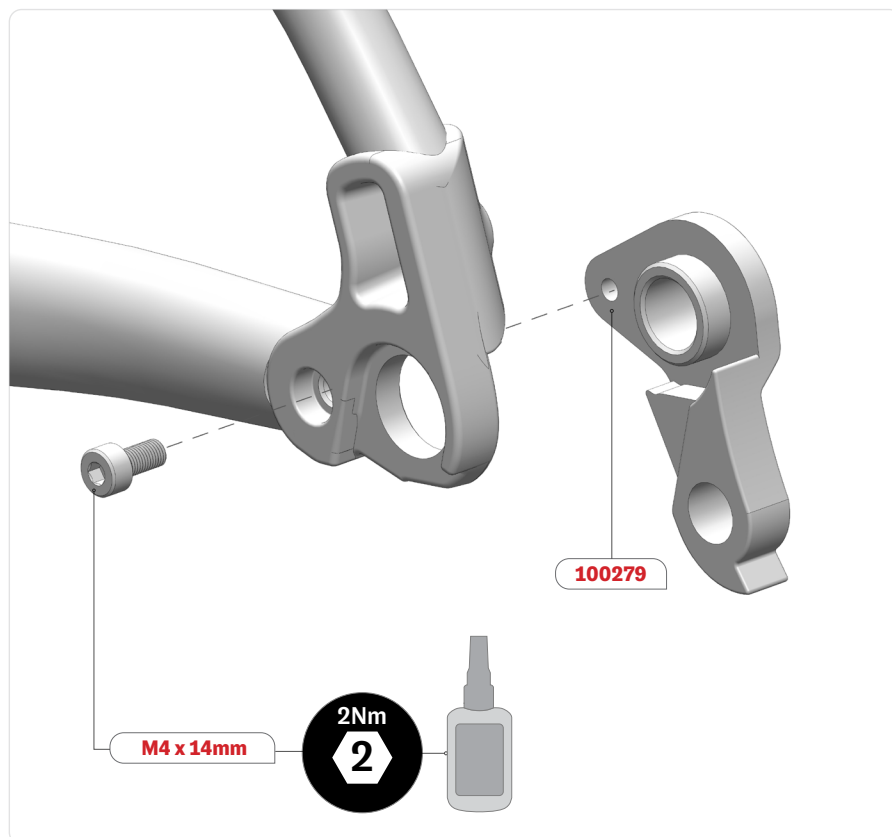

Assembling the rear derailleur hanger:

1. Assemble the rear derailleur hanger (100279) on the frame.
2. Apply a drop of blue Threadlocker (n. 242) on the M4x14mm screw threads and tighten to 2Nm.
3. Use a rear derailleur hanger alignment gauge to align the rear derailleur hanger. (If necessary)

For assistance, visit Park Tool's website at:

<https://www.parktool.com/blog/repair-help/rear-derailleur-hanger-alignment>

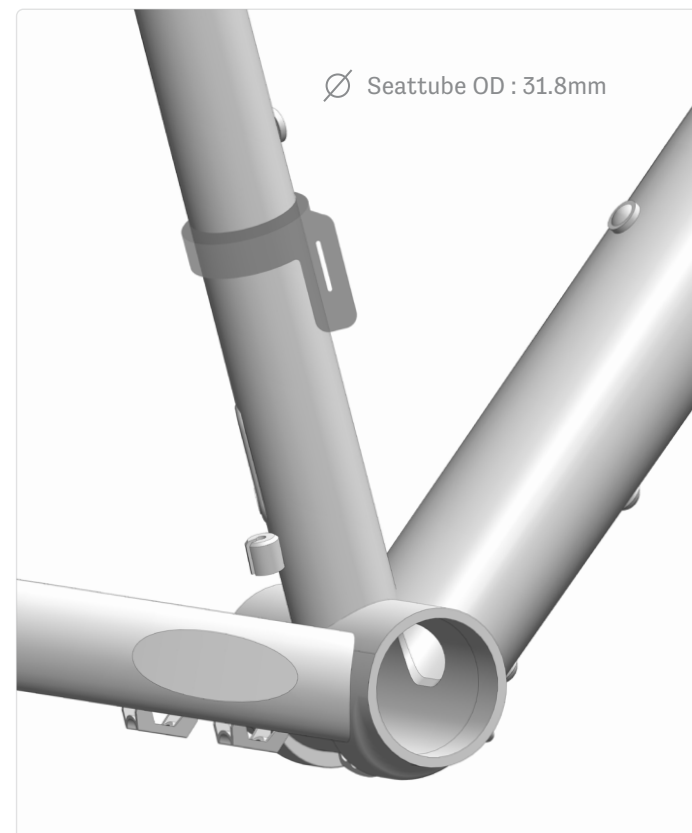

Using a front derailleur :

1. The Grey Matter seattube is 31.8mm in diameter. A front derailleur can be used with a band clamp adapter, or a clamp band front derailleur.

8. 3D HEADSET INSTALLATION

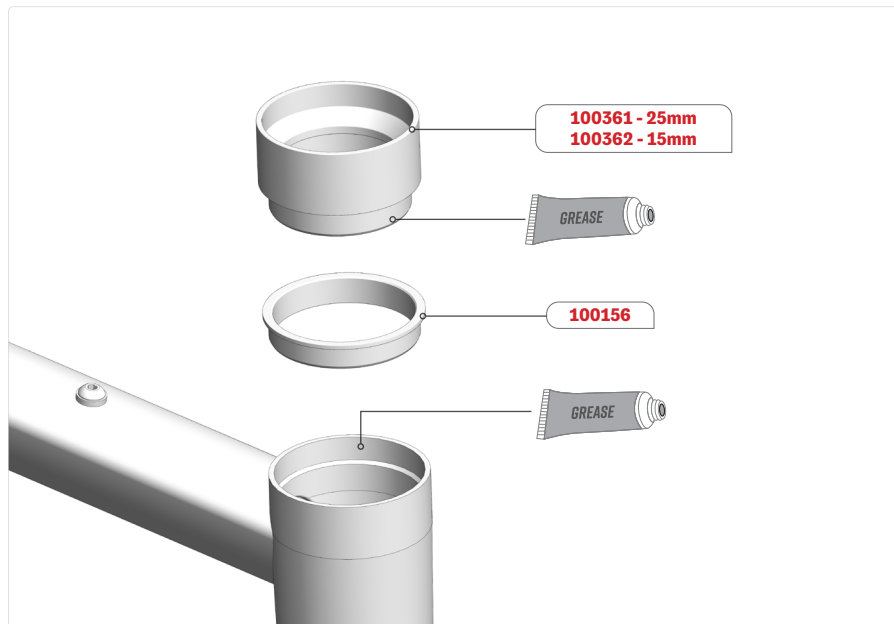

Assembling the 3D headset (0mm)

1. If the 0mm configuration is chosen, the bearing goes directly in the headtube.

Assembling the 3D headset (+15 / +25mm)

1. Apply grease to the inside of the headtube.
2. Insert the plastic sleeve (100156) into the headtube.
3. Apply grease on the plastic sleeve (100156).
4. Position the 3D column (100361 or 100362) perfectly straight on the headtube opening.
5. Slowly press the cups into the frame using a **headset press + adaptor** until it sits flush with the frame.

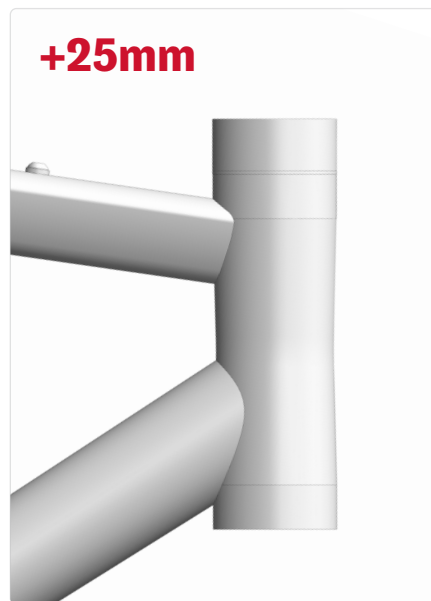

10. BRAKE ROUTING



Brake Housing

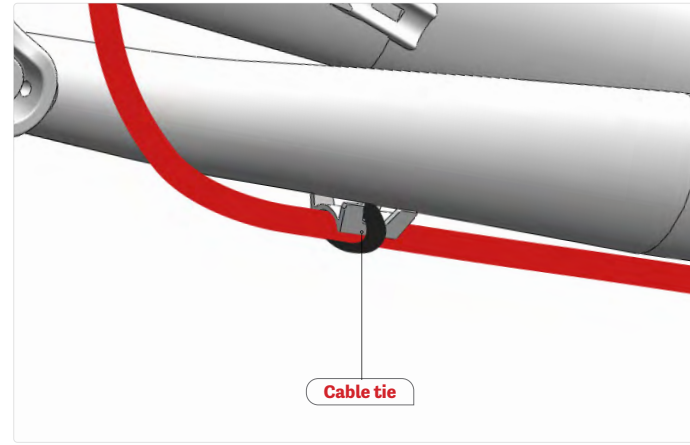

1. Guide the rear brake housing into the down tube starting at the bottom bracket until it exits at the head tube.
2. If desired, slide a foam liners (80811) onto the brake housing until it reaches the bottom bracket shell.
3. Attach the brake hose to the guide on the non-drive side chainstay with cable ties.

II. FRONT BRAKE ROUTING

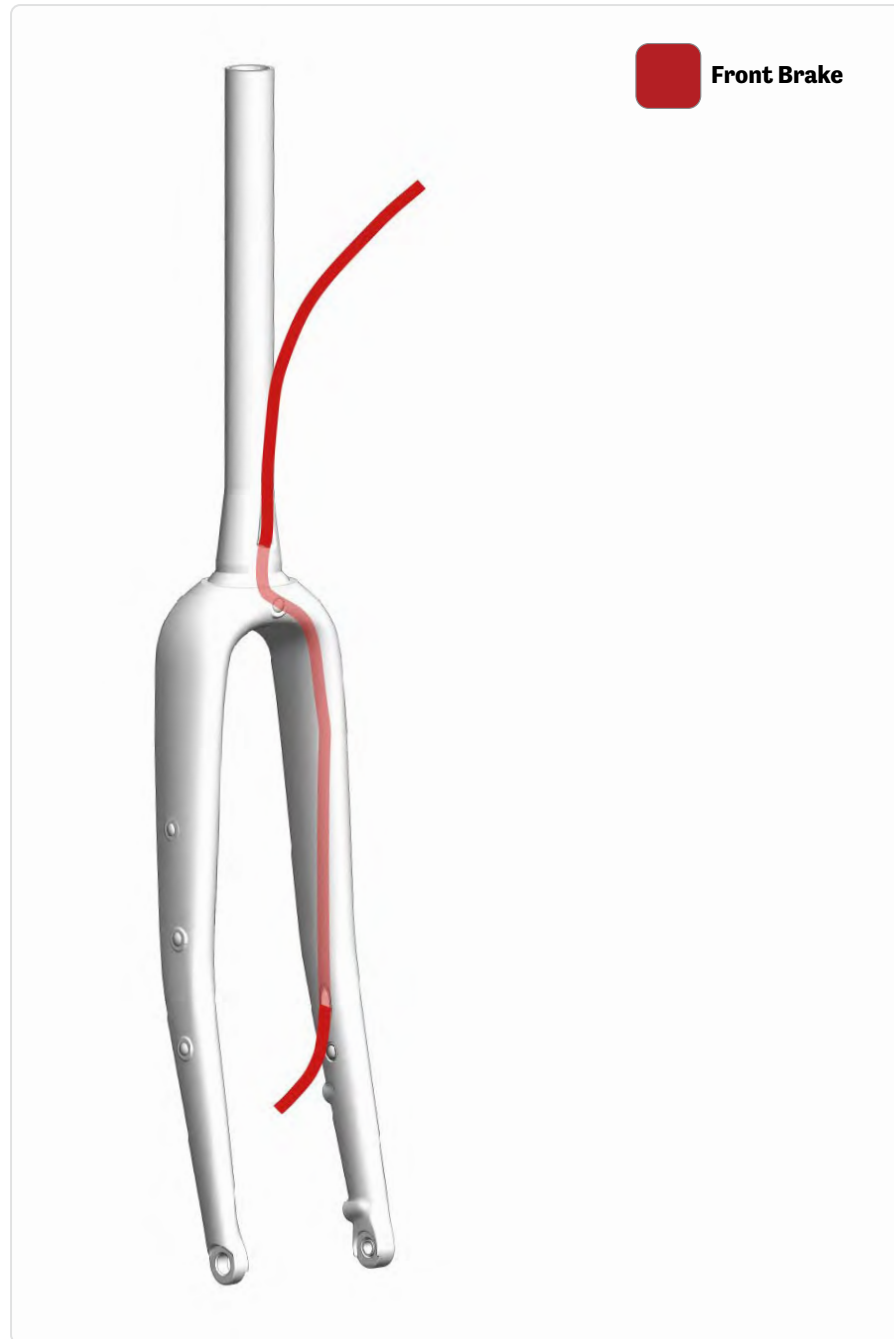

- I.** Guide the hydraulic housing through the hole in the fork leg until it exits from the bottom hole on the steerer.

12. MECHANICAL GROUPSET ROUTING



1. Guide the rear gear housing into the downtube starting at the bottom bracket until it exits at the headtube.
2. Guide the front gear housing into the downtube starting at the bottom bracket until it exits at the headtube.
3. If desired, slide a foam liners (80811) onto the gear housing until it reaches the bottom bracket shell.

4. Attach the rear gear housing to the guide on the drive side chainstay with cable ties.
5. Respect the order of the housing shown (image on right), to avoid crossing the housing while installing the bottom bracket cable guide.

12.1 MECHANICAL GROUPSET ROUTING

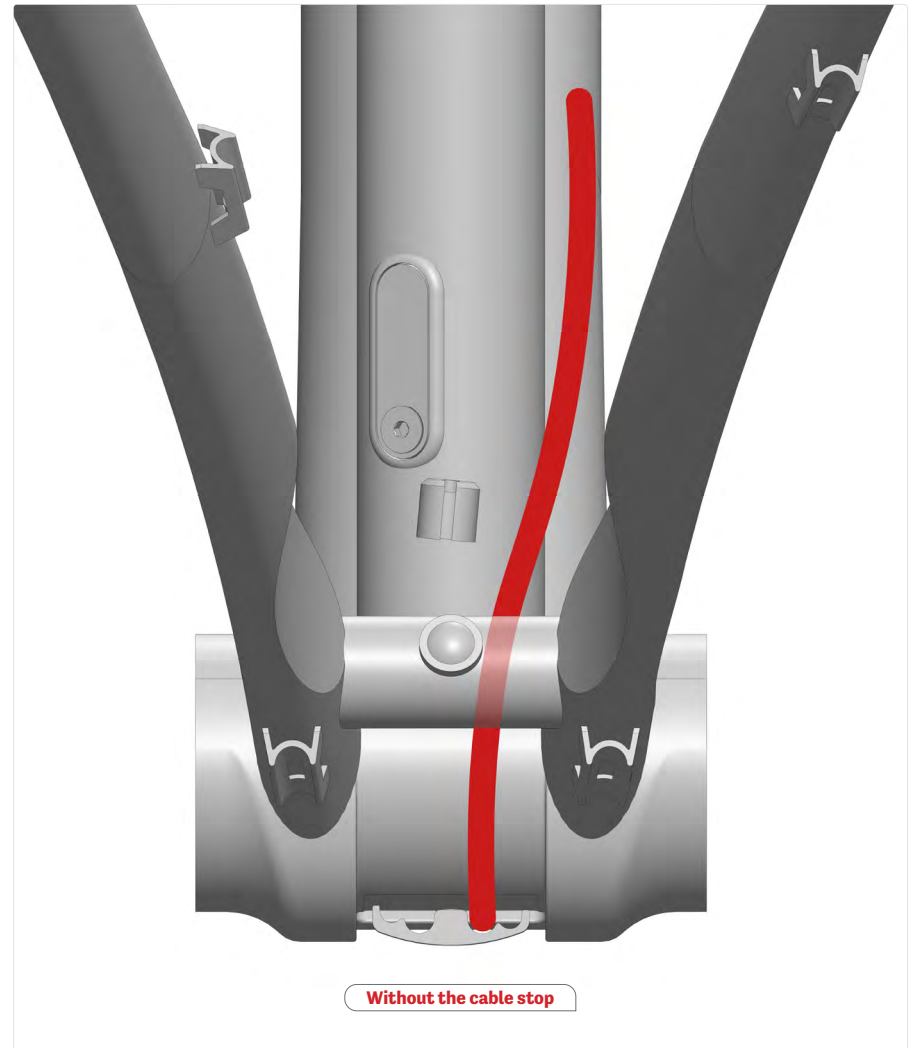
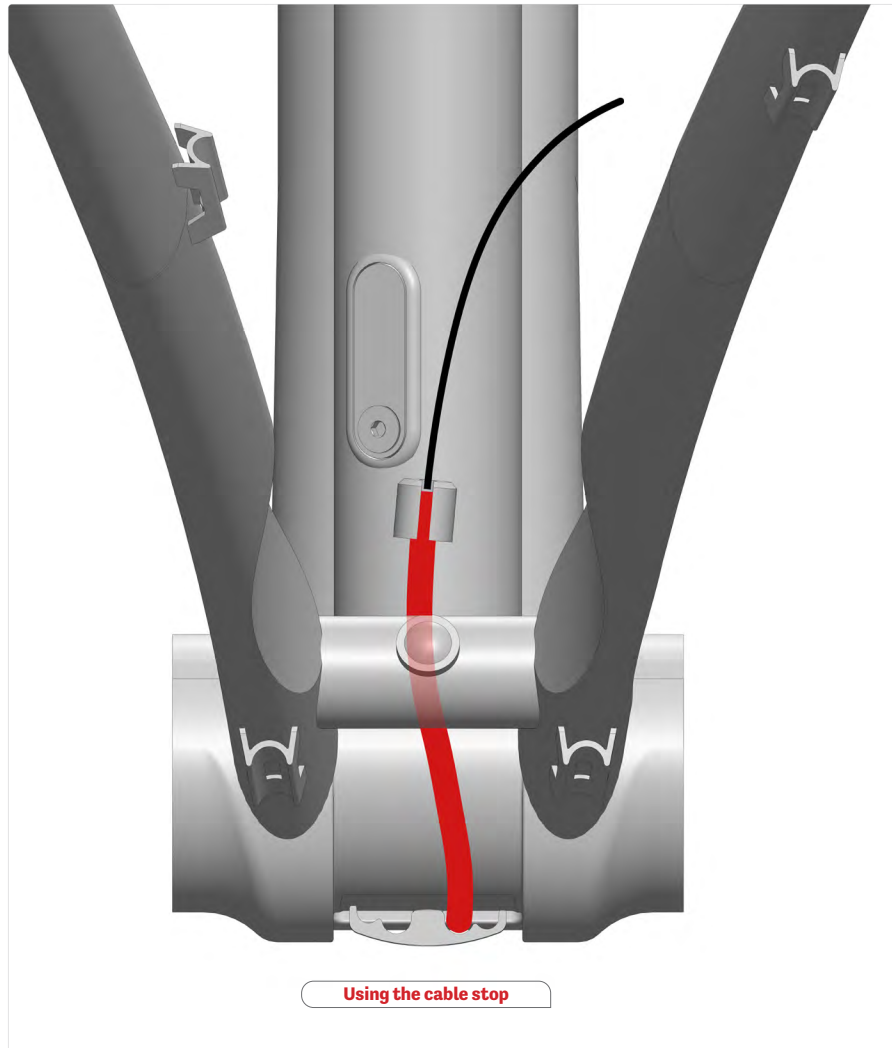

1. If using SRAM or an older Shimano front derailleur, use the frame cable stop configuration.
2. Install a housing end cap on the gear housing prior to the cable stop.
3. If using a newer Shimano front derailleur, you can bypass the frame cable stop and use the one on the front derailleur.

13. ETAP GROUPSET ROUTING



1. Install both derailleur, no routing required.

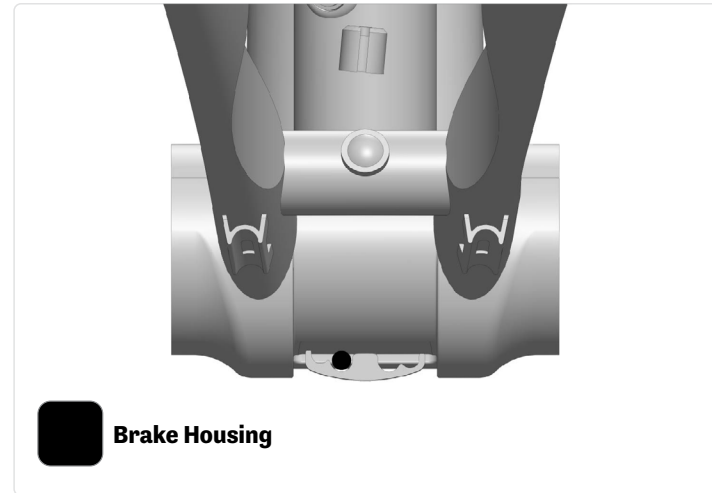

14. DI2 8100-9200 GROUPSET ROUTING



Di2 Wires

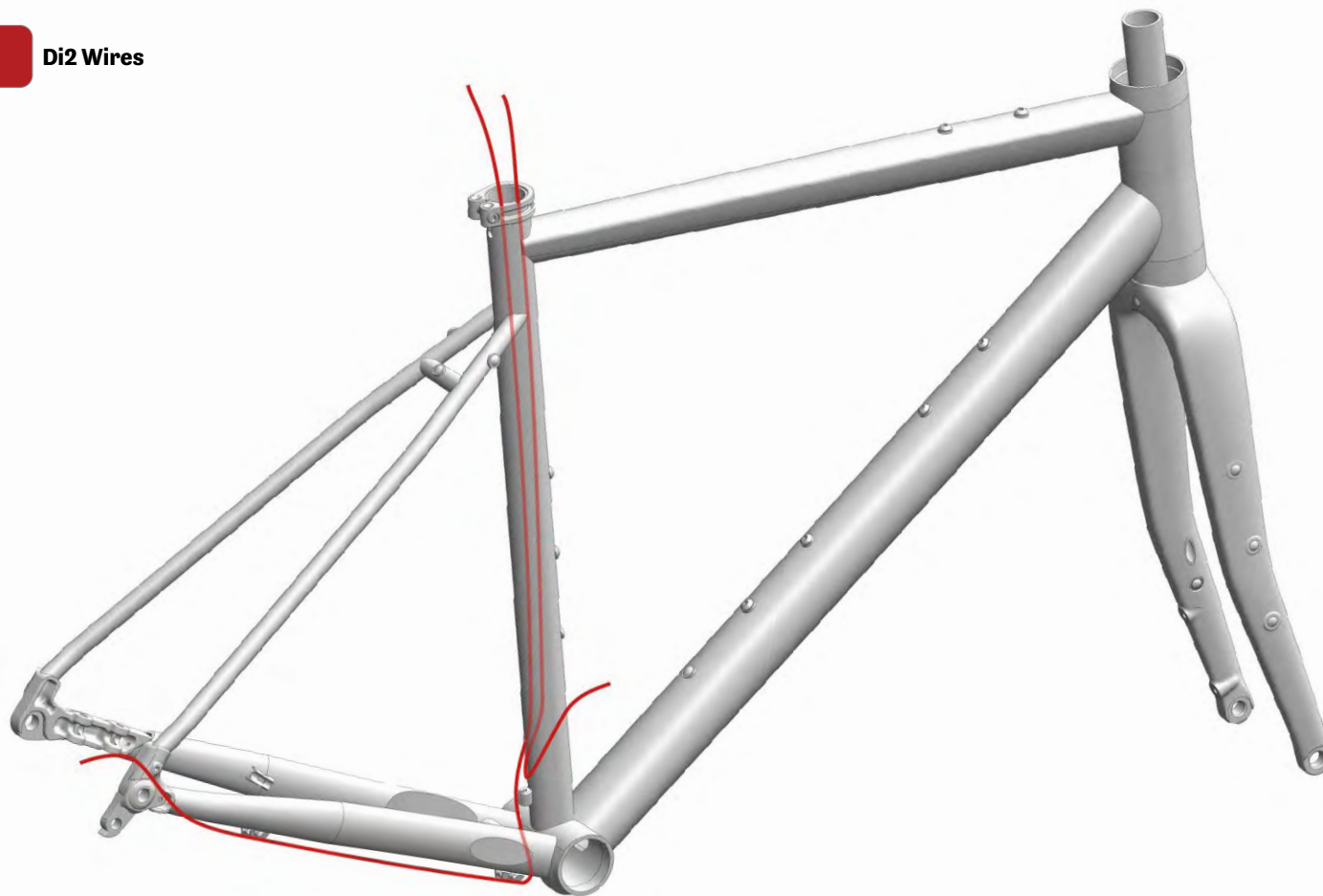

The Grey Matter is compatible with Di2 groupset, however, it is not optimized for them:

- 1.** Guide both derailleur cables through the hole at the bottom of the seattube until they exit at the top of the seattube.
- 2.** Connect both cables in the battery.

14.1 DI2 8100-9200 GROUPSET ROUTING

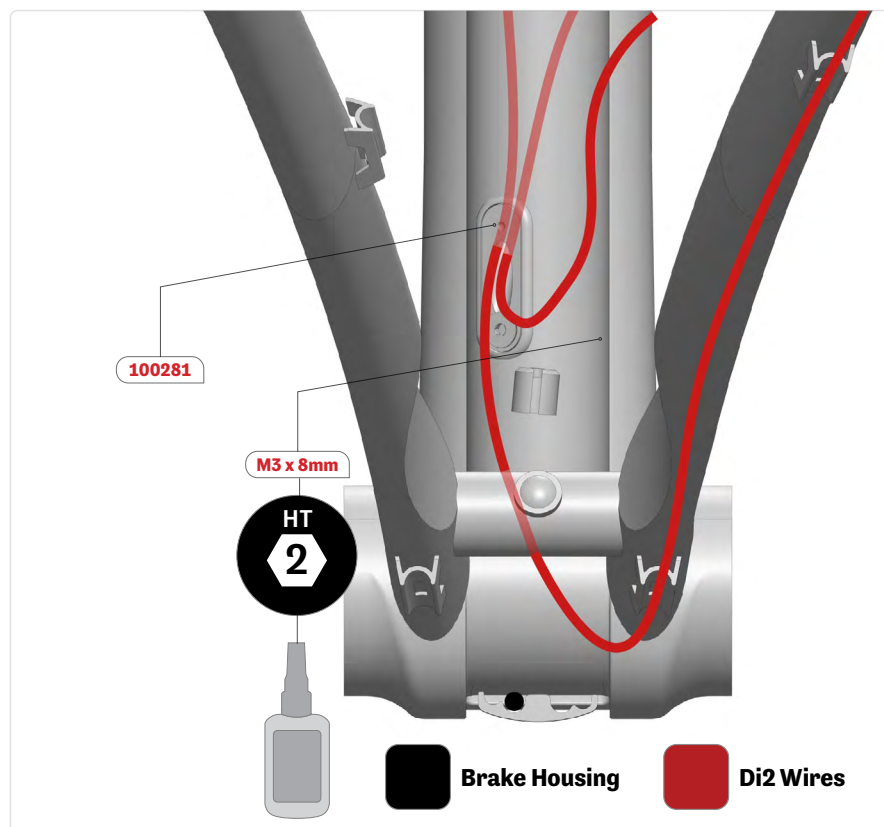
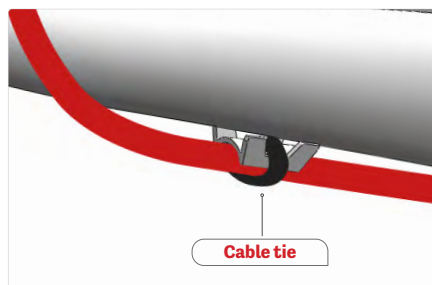
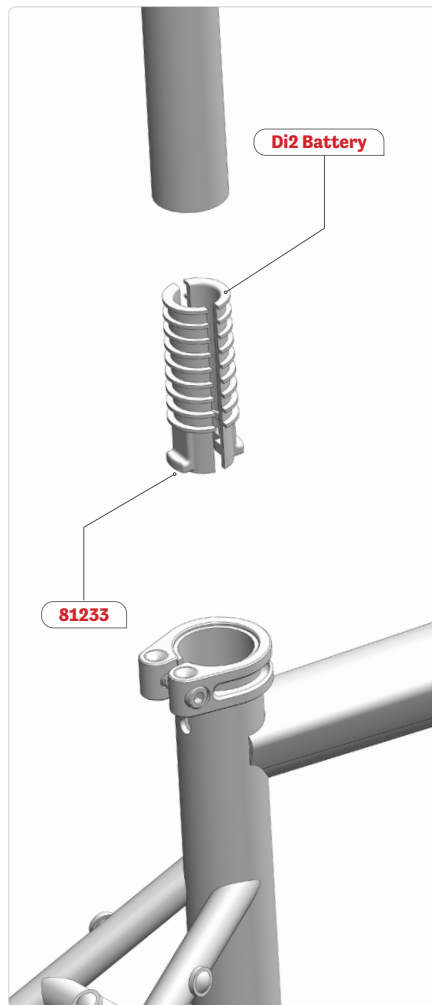

1. Wrap the battery holder (81233) around the Di2 battery.
2. Connect the battery to the system.
3. Insert the battery into the seatpost shaft until it sits at the bottom of the shaft.
4. Install the cover for mechanical (100281) through the cable.
5. Apply Loctite to the threads of the M3 x 8mm screw and hand tighten the screw.
6. Attach the rear derailleur cable to the guide on the drive side chainstay with cable ties.

15. DI2 GROUPSET ROUTING



Di2 Wires



The Grey Matter is compatible with Di2 groupset, however, it is not optimized for them:

1. Connect all wires to the JC-41 junction box and slide the box into the downtube from the headtube.
2. Using as fishing cable*, guide battery, rear derailleur and front derailleur cables to exit through the hole under the bottom bracket.



TIPS:

Use a gear cable and a metal cable end to fix and pull the Di2 wires through the frame.

15.1 DI2 GROUPSET ROUTING

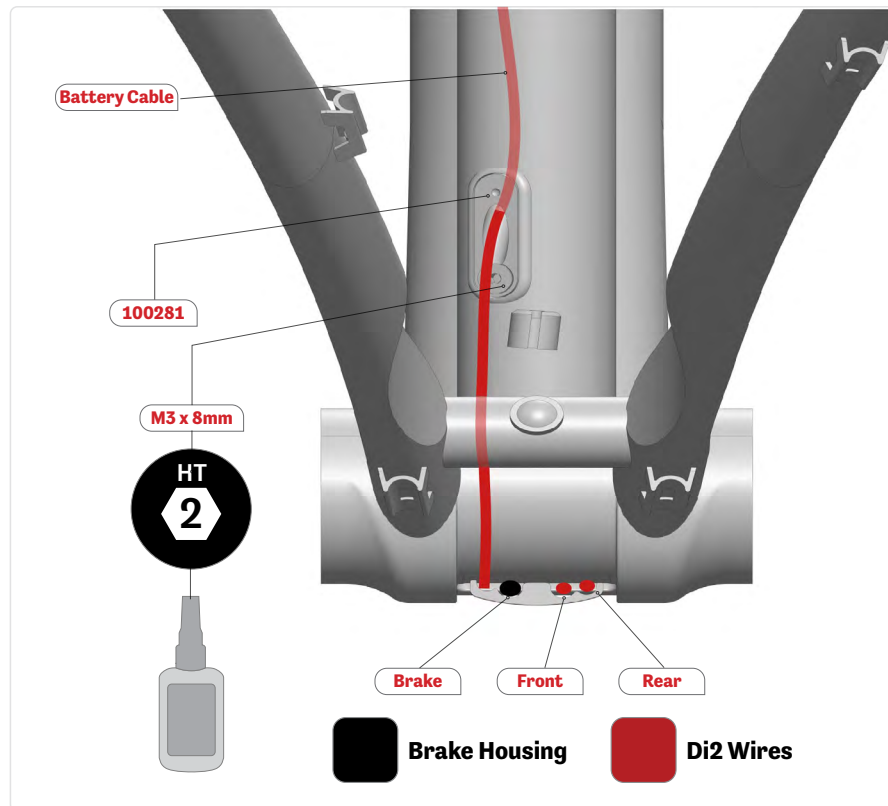
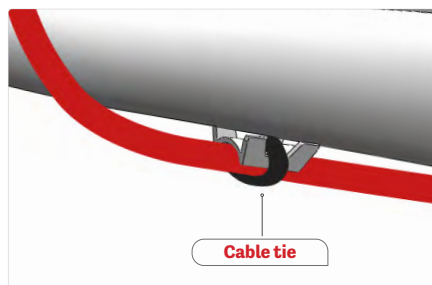
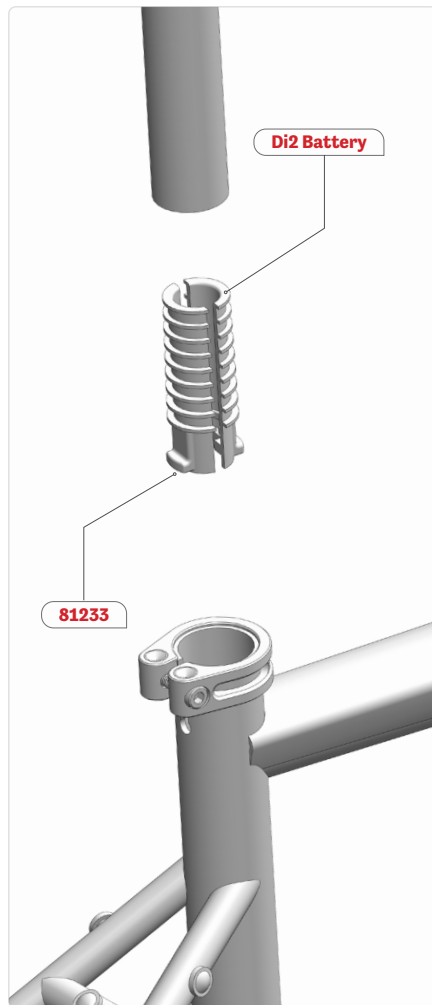

1. Install the cover for mechanical (100281) on the seatpost hole.
2. Apply Loctite to the threads of the M3 x 8mm screw and hand tighten the screw.
3. Insert the battery cable through the cover for mechanical until it exits from the seatpost.
4. Wrap the battery holder around the Di2 battery and connect the battery to the system.
5. Insert the battery into the seatpost until it sits at the bottom of the shaft.
6. Attach the rear derailleur cable to the guide on the drive side chainstay with cable ties.
7. Respect the order of the housing shown (image above), to avoid crossing the housing while installing the bottom bracket cable guide.

16. DROPPER SEATPOST INSTALLATION

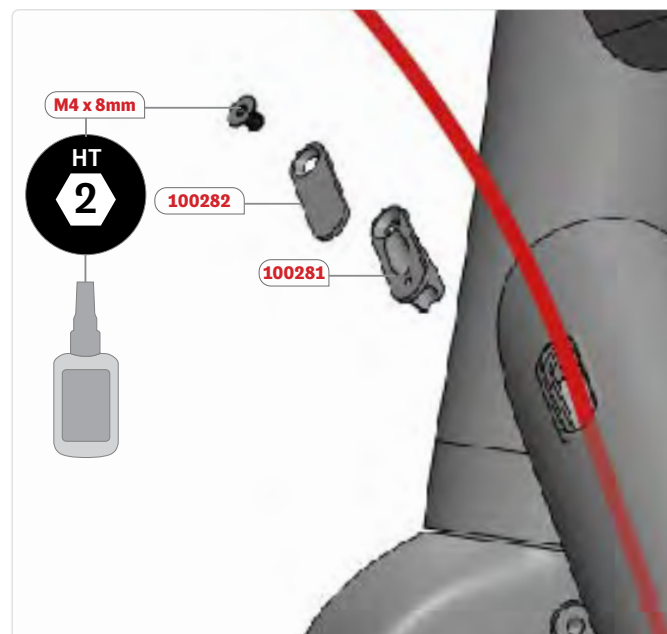

The Grey Matter is compatible with a dropper post, except for Di2 configurations :

- 1.** If you are not using a dropper post, install the cable cover (100282) on the seat tube bottom hole and on the down tube hole. Apply Loctite to the threads of each M3 x 8mm screw and hand tighten each screw.
- 2.** If using a dropper post, guide the dropper post housing into the down tube starting at the bottom bracket until it exits from the hole on the down tube. Respect the position shown in image at right.
- 3.** Install the cover for mechanical (100281) on the down tube hole and seat tube hole.
- 4.** Apply loctite to the threads of each M3 x 8mm screw and hand tighten each screw.
- 5.** Guide the dropper post housing through the cable cover for mechanical on the seat tube until it exits at the top of the seat tube.
- 6.** Follow the dropper post installation procedure.

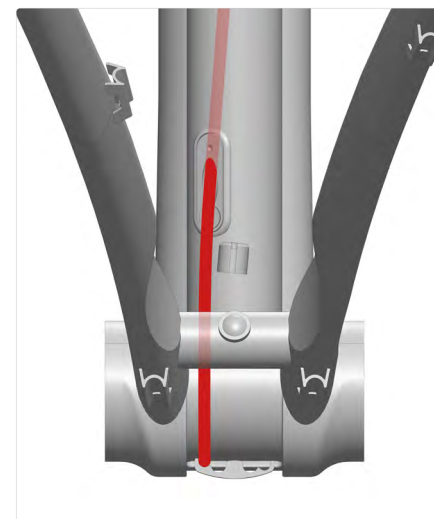

17. BOTTOM BRACKET CABLE GUIDE INSTALLATION

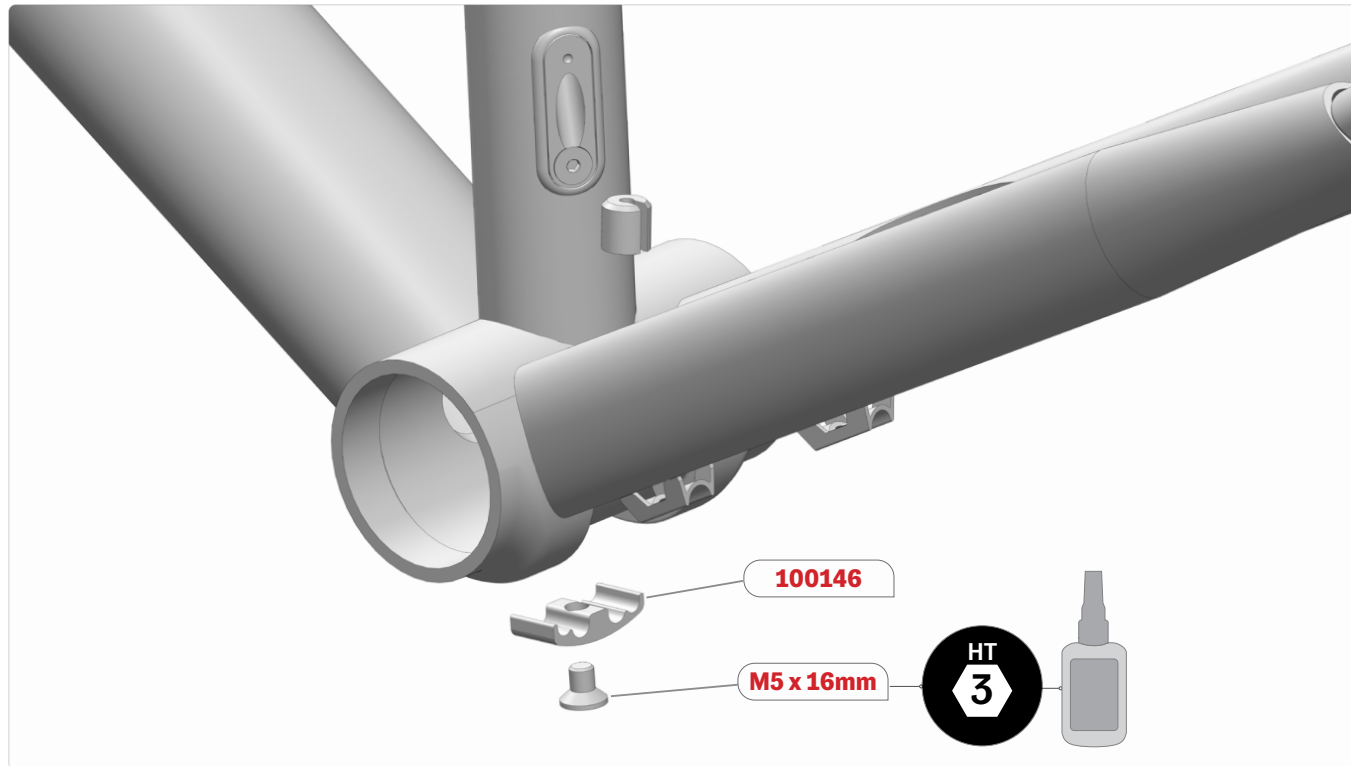

1. After installing all the cables, install the bottom bracket cable guide.
2. Ensure each cable is placed in the order shown in image below for the chosen configuration.
3. Apply Loctite to the threads of the M5 x 16mm screw and hand tighten the screw.

Speed Wires
 Brake Housing
 Dropper Post Housing

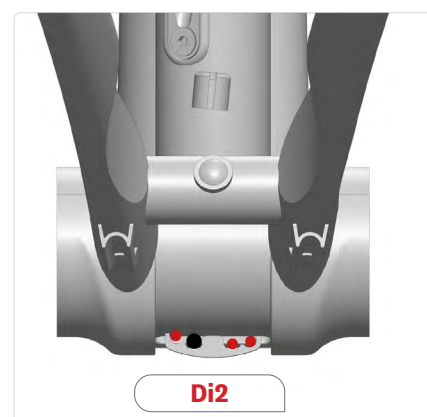
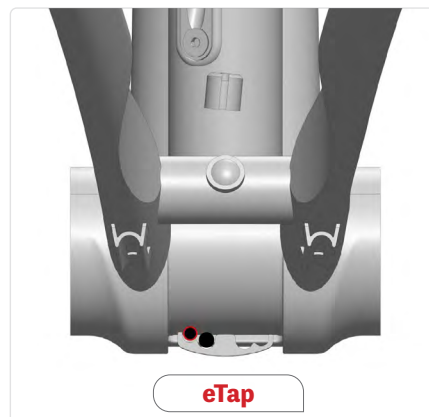
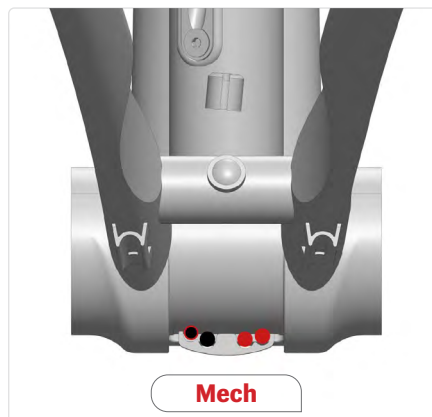

21. FORK INSTALLATION

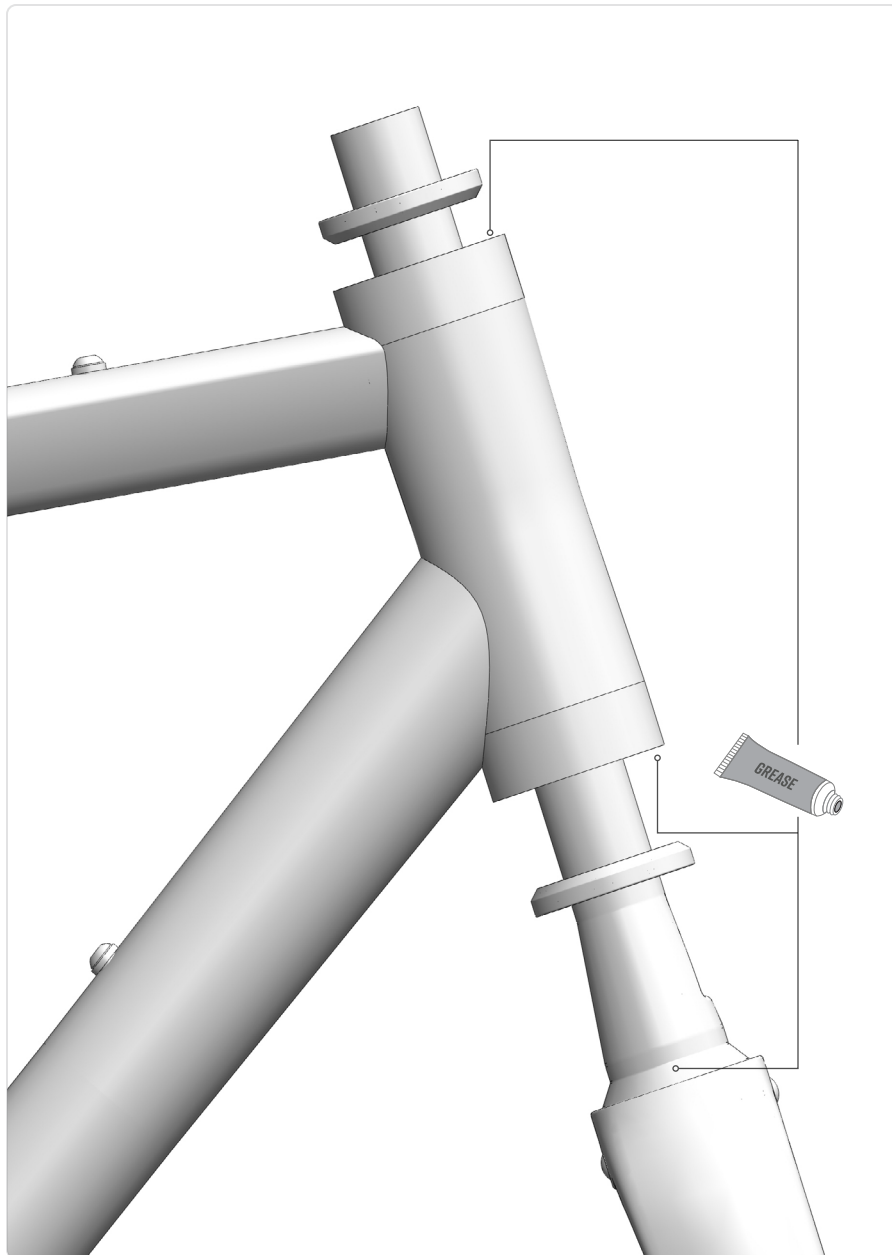

2x MR127

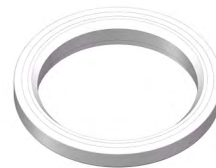

1. Apply grease onto all surfaces where the bearing sits (frame & fork)
2. Insert the fork steerer and front brake housing through the bottom bearing. (MR127)
3. Slide the fork steerer into the frame headtube.
4. Insert the top bearing (MR127) onto the steerer and into the frame.
5. Pass the wires and/or housing through the top bearing.



IMPORTANT:

For more information on the cockpit installation and compatibility, please refer to : Argon 18 - Internal routing compatibility

19. BOTTLE CAGE POSITION

XXS

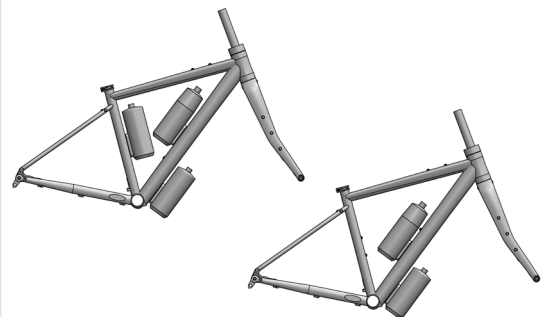

XS

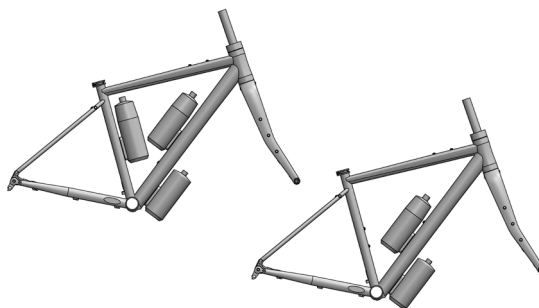

S

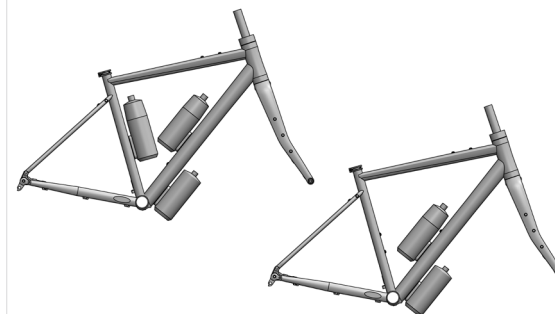

M

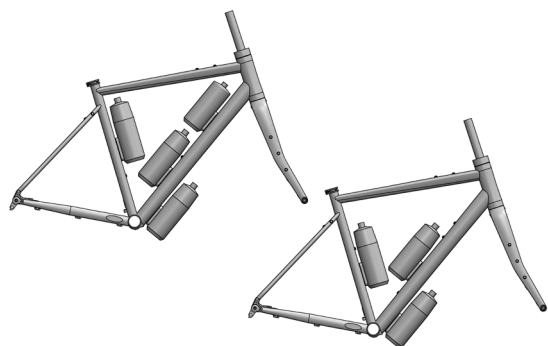

L

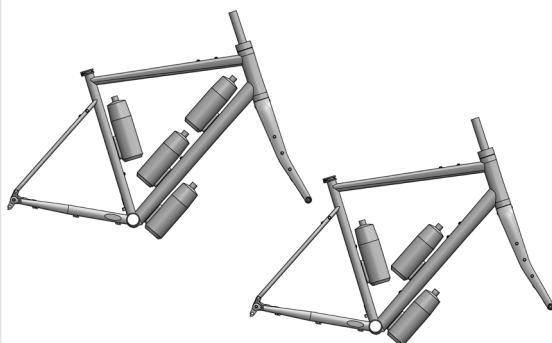

XL

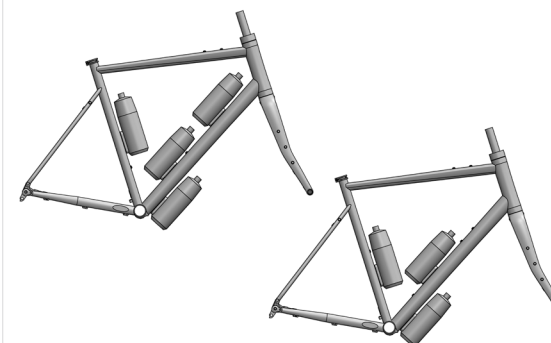

Here are some possible options of how to fit the waterbottle(s) onto the frame's water-bottle-cage mounts, depending on the frame size.



IMPORTANT:

If using a road groupset, interference between the chain and the lower bottle may occur.

20. REAR RACK AND FENDER INSTALLATION

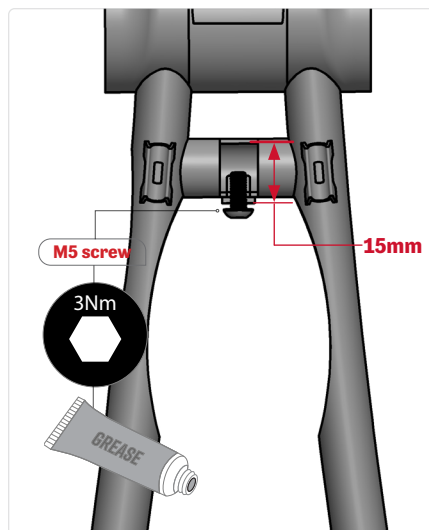
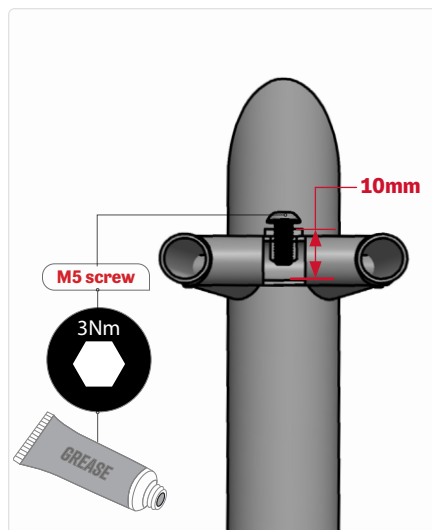

- 1.** When securing the fender and/or the rear rack on the dropout, make sure that the screw doesn't interfere with the chain. The maximum insertion of the screw is 15mm to avoid protrusion and possible chain interference. Make sure there is at least 10mm of screw insertion to support the load.
 - 2.** On the seatstay and seatstay bridge, the thread length is 10mm. Ensure 10mm or less of thread insertion.
 - 3.** On the chainstay bridge, the thread length is 15mm. Ensure 15mm or less of thread insertion.
- * If a fender is used with a rear rack: if possible, screw the fender onto the rear rack. If not possible, position the rear rack between the frame and the fender on the screw.
 - * All screws must be torqued to a maximum of 3Nm. Apply grease to the threads.

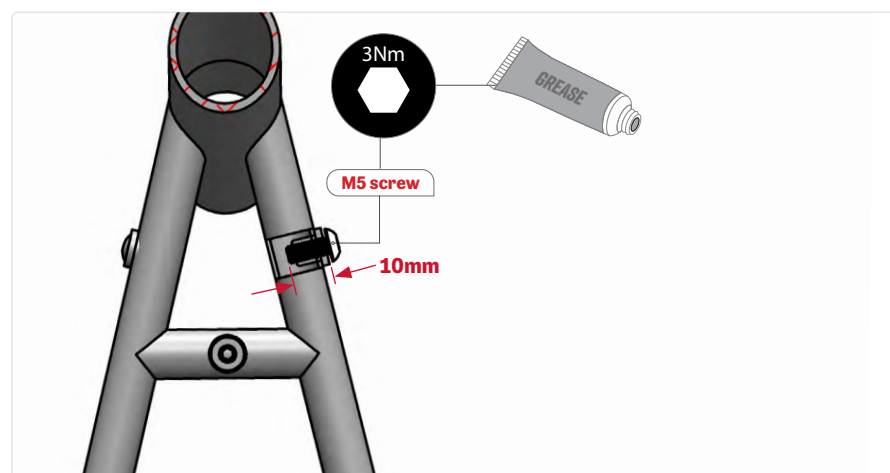
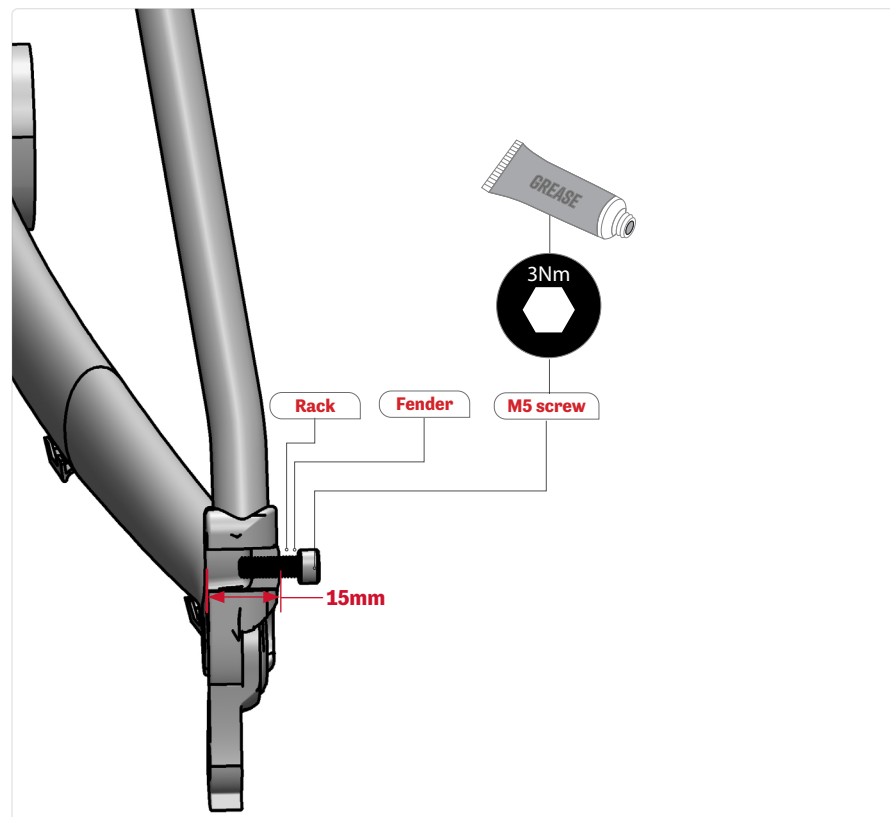

21. FRONT RACK AND FENDER INSTALLATION

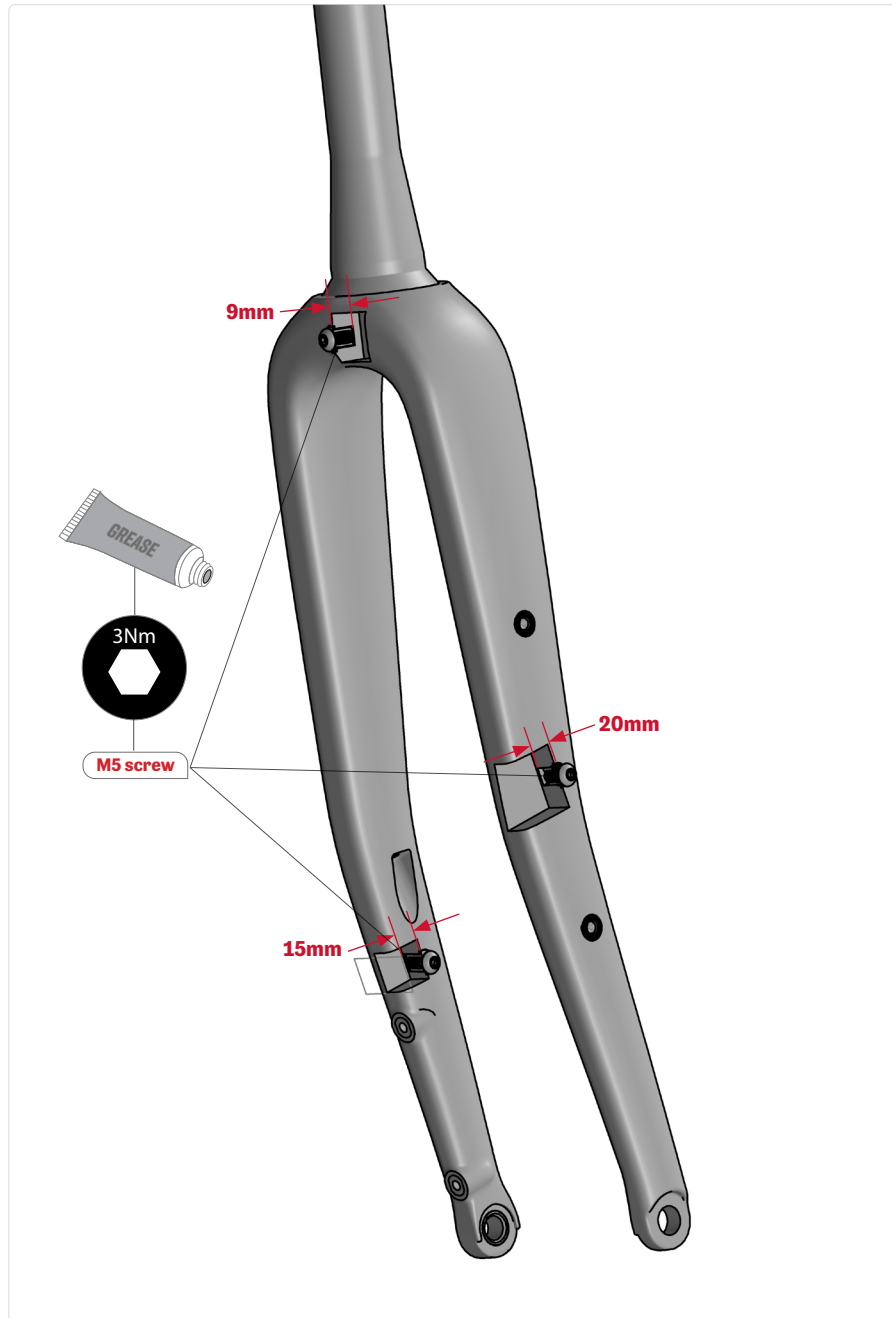

- The thread length on the upper screw is 9mm. Ensure 9mm or less of thread insertion.
- The thread insertion on the interior hole for fenders is 15mm. Ensure 15mm or less of visible threads once the fender is screwed on.
- The thread insertion on the exterior hole for the rack is 20mm. Ensure 20mm or less of visible threads once the rack is screwed on.
- All screws must be torqued to a maximum of 3Nm. Apply grease to the threads.