





|  |    |
|--|----|
| 1. Tools Needed & First Aid Kit .....                    | 3  |
| 2. Sizing Chart .....                                    | 4  |
| 3. Frameset Inspection .....                             | 6  |
| 4. Troubleshooting / Tip / Specification .....           | 7  |
| 5. Seat Post Collar Assembly .....                       | 8  |
| 6. Seat Post Assembly .....                              | 9  |
| 7. Rear Derailleur Hanger Adjustment .....               | 10 |
| 8. Headset Installation .....                            | 11 |
| 9. Console / A. Di2 internal junction box groupset ..... | 12 |
| 9. Console / B. Di2 external junction box groupset ..... | 13 |
| 9. Console / C. Wireless groupset .....                  | 14 |
| 9. Console / D. Mechanical groupset .....                | 15 |
| 9. Console / E. Mechanical Single chainring .....        | 16 |
| 10. Hydraulic & mechanical shifter routing .....         | 17 |
| 10. Electronic wire routing .....                        | 20 |
| 10. Wireless routing .....                               | 23 |
| 11. Chain Catcher .....                                  | 25 |
| 12. Fender bracket .....                                 | 26 |
| 13. Silver 47: Parts' SKU and Description .....          | 27 |

**My Silver 47**

Date of purchase: \_\_\_\_\_

Retailer: \_\_\_\_\_

Size: \_\_\_\_\_

Serial Number: \_\_\_\_\_

**For the warranty to be valid, the bicycle must be fully assembled by an authorized Argon 18 dealer. High-end components, particularly carbon parts, need extra care when assembled. These components must be installed using a torque wrench to make sure every bolt is at the right torque setting to prevent damage.**



### Tools needed for assembly

1. Bearing Cup Press (Park Tool HHP-2)
2. Allen Key Set
3. Grease
4. Utility Pick Set (Park Tool Item #UP-SET)
5. Clean Rags
6. Derailleur Hanger Alignment Gauge (Park Tool Item #DAG-2)
7. Cables and Housing Cutter
8. Carbon Paste
9. Loctite #242
10. Torque Wrench

**First Aid Kit: Essential parts to always have on hand**  
IN CASE OF EMERGENCY...THIS MIGHT SAVE YOUR RIDE!

1. Spare rear derailleur hanger:

Regular  
hanger



SKU: 80802

Direct mount



SKU: 80832

2. Seat clamp



SKU: 81010

## 2. Sizing Chart

**ARGON 18**

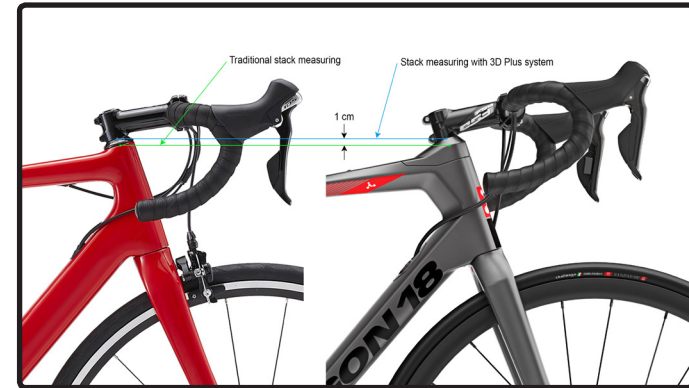
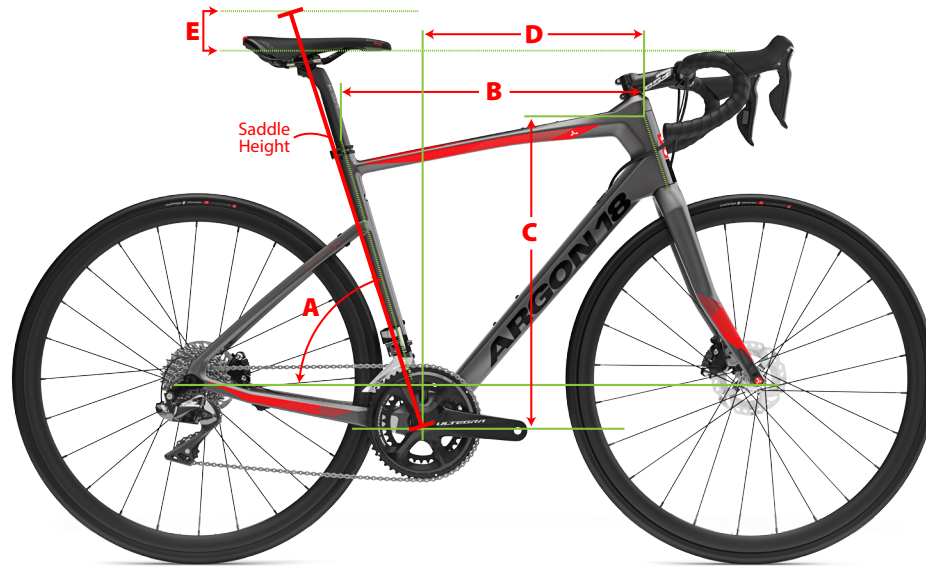

| Sizing Chart: Silver 47 |                |                          |                    | With 0 mm Headset |                 | With 15 mm Headset |                 | With 30 mm Headset |                 |                         |                   |
|-------------------------|----------------|--------------------------|--------------------|-------------------|-----------------|--------------------|-----------------|--------------------|-----------------|-------------------------|-------------------|
| Saddle Height (cm)      | Suggested Size | A<br>Seat Tube Angle (°) | B<br>Top Tube (cm) | C<br>Stack (cm)   | D<br>Reach (cm) | C<br>Stack (cm)    | D<br>Reach (cm) | C<br>Stack (cm)    | D<br>Reach (cm) | E*<br>Minimum Drop (cm) | Maximum Drop (cm) |
| 61                      | XXS            | 75.5                     | 49.6               | 51.9              | 35.9            | 53.3               | 35.3            | 54.7               | 34.8            | 4                       | -1.5              |
| 62                      | XXS            | 75.5                     | 49.6               | 51.9              | 35.9            | 53.3               | 35.3            | 54.7               | 34.8            | 3                       | -2.5              |
| 63                      | XXS            | 75.5                     | 49.6               | 51.9              | 35.9            | 53.3               | 35.3            | 54.7               | 34.8            | 2                       | -3.5              |
| 64                      | XXS/XS         | 75.5 / 74.9              | 49.6 / 51.6        | 51.9 / 53.9       | 35.9 / 36.9     | 53.3 / 55.3        | 35.3 / 36.4     | 54.7 / 56.7        | 34.8 / 35.9     | 1 / 3.5                 | -4.5 / -2.5       |
| 65                      | XXS/XS         | 75.5 / 74.9              | 49.6 / 51.6        | 51.9 / 53.9       | 35.9 / 36.9     | 53.3 / 55.3        | 35.3 / 36.4     | 54.7 / 56.7        | 34.8 / 35.9     | 0 / 2.5                 | -5.5 / -3.5       |
| 66                      | XS             | 74.9                     | 51.6               | 53.9              | 36.9            | 55.3               | 36.4            | 56.7               | 35.9            | 1.5                     | -4.5              |
| 67                      | XS             | 74.9                     | 51.6               | 53.9              | 36.9            | 55.3               | 36.4            | 56.7               | 35.9            | 0.5                     | -5.5              |
| 68                      | XS/S           | 74.9 / 74.3              | 51.6 / 53.7        | 53.9 / 55.9       | 36.9 / 37.9     | 55.3 / 57.3        | 36.4 / 37.4     | 56.7 / 58.8        | 35.9 / 37.0     | -0.5 / 2                | -6.5 / -4         |
| 69                      | XS/S           | 74.9 / 74.3              | 51.6 / 53.7        | 53.9 / 55.9       | 36.9 / 37.9     | 55.3 / 57.3        | 36.4 / 37.4     | 56.7 / 58.8        | 35.9 / 37.0     | -1.5 / 1                | -7.5 / -5         |
| 70                      | S              | 74.3                     | 53.7               | 55.9              | 37.9            | 57.3               | 37.4            | 58.8               | 37.0            | 0                       | -6                |
| 71                      | S              | 74.3                     | 53.7               | 55.9              | 37.9            | 57.3               | 37.4            | 58.8               | 37.0            | -1                      | -7                |
| 72                      | S/M            | 74.3 / 73.7              | 53.7 / 55.8        | 55.9 / 58.0       | 37.9 / 38.8     | 57.3 / 59.4        | 37.4 / 38.3     | 58.8 / 60.8        | 37.0 / 37.9     | -2 / 0.5                | -8 / -5           |
| 73                      | S/M            | 74.3 / 73.7              | 53.7 / 55.8        | 55.9 / 58.0       | 37.9 / 38.8     | 57.3 / 59.4        | 37.4 / 38.3     | 58.8 / 60.8        | 37.0 / 37.9     | -3 / -0.5               | -9 / -6           |
| 74                      | M              | 73.7                     | 55.8               | 58.0              | 38.8            | 59.4               | 38.3            | 60.8               | 37.9            | -1.5                    | -7                |
| 75                      | M              | 73.7                     | 55.8               | 58.0              | 38.8            | 59.4               | 38.3            | 60.8               | 37.9            | -2.5                    | -8                |
| 76                      | M              | 73.7                     | 55.8               | 58.0              | 38.8            | 59.4               | 38.3            | 60.8               | 37.9            | -3.5                    | -9                |
| 77                      | M/L            | 73.7 / 73.1              | 55.8 / 58.0        | 58.0 / 60.1       | 38.8 / 39.7     | 59.4 / 61.5        | 38.3 / 39.2     | 60.8 / 62.9        | 37.9 / 38.8     | -4.5 / -2               | -10 / -7.5        |
| 78                      | M/L            | 73.7 / 73.1              | 55.8 / 58.0        | 58.0 / 60.1       | 38.8 / 39.7     | 59.4 / 61.5        | 38.3 / 39.2     | 60.8 / 62.9        | 37.9 / 38.8     | -5.5 / -3               | -11 / -8.5        |
| 79                      | L              | 73.1                     | 58.0               | 60.1              | 39.7            | 61.5               | 39.2            | 62.9               | 38.8            | -4                      | -9.5              |
| 80                      | L              | 73.1                     | 58.0               | 60.1              | 39.7            | 61.5               | 39.2            | 62.9               | 38.8            | -4.5                    | -10.5             |
| 81                      | L/XL           | 73.1 / 72.5              | 58.0 / 60.4        | 60.1 / 62.4       | 39.7 / 40.7     | 61.5 / 63.9        | 39.2 / 40.2     | 62.9 / 65.3        | 38.8 / 39.8     | -5.5 / -3               | -11.5 / -8.5      |
| 82                      | L/XL           | 73.1 / 72.5              | 58.0 / 60.4        | 60.1 / 62.4       | 39.7 / 40.7     | 61.5 / 63.9        | 39.2 / 40.2     | 62.9 / 65.3        | 38.8 / 39.8     | -6.5 / -4               | -12.5 / -9.5      |
| 83                      | XL             | 72.5                     | 60.4               | 62.4              | 40.7            | 63.9               | 40.2            | 65.3               | 39.8            | -5                      | -10.5             |
| 84                      | XL             | 72.5                     | 60.4               | 62.4              | 40.7            | 63.9               | 40.2            | 65.3               | 39.8            | -6                      | -11.5             |
| 85                      | XL             | 72.5                     | 60.4               | 62.4              | 40.7            | 63.9               | 40.2            | 65.3               | 39.8            | -7                      | -12.5             |

Stack and Reach are measured on top of the headset cap.  
Subtract 1cm to stack value to compare to a traditional frame.  
Add 0,3cm to reach value to compare to a traditional frame.

\*Drops are measured with size specific -6° stem

## 2. Sizing Chart

**ARGON 18**

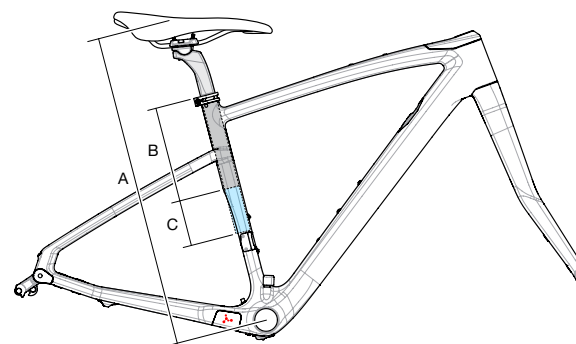
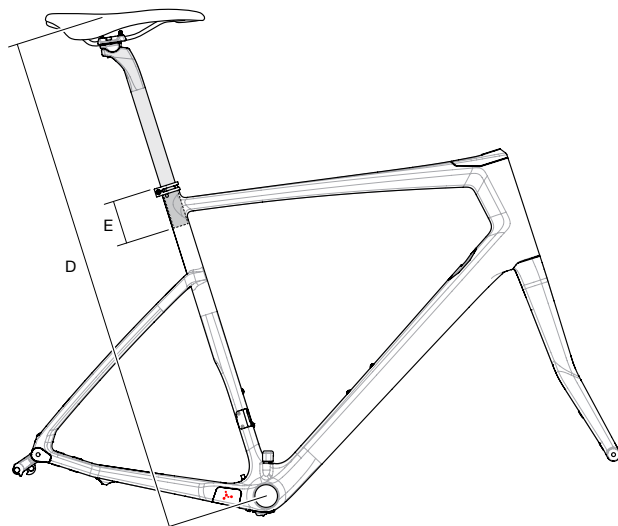

Refer to the tables below for details on Saddle Height and SeatPost insertion limits.

- i. The correct frame size must be determined according to the saddle height limits.
  - A. Minimum Saddle Height
  - D. Maximum Saddle Height
- ii. Depending on the size of the frame and the desired saddle height, the SeatPost might need to be cut.
  - B. Maximal insertion depth in the Frame's SeatTube.
  - C. Required SeatPost cut length to be able to adjust the Saddle Height at the Minimum position.
    - Adjust the SeatPost cut length in accordance with your desired Saddle Height.

**Required minimum SeatPost Cut length = C - ("desired Saddle Height" - A)**

- Example: - For a desired Saddle Height of 600mm on a XX-Small Silver 47 Frame

- The required minimum SeatPost Cut length is: 90 - (600-560) = 50mm

E. Minimal insertion depth in the Frame's SeatTube.

### Saddle Height Limits

| Size     | Saddle H Min | ST Max Insert | SP Cut | Saddle H Max | SP Min Insert |
|----------|--------------|---------------|--------|--------------|---------------|
|          | mm           | mm            | mm     | mm           | mm            |
|          | A            | B             | C      | D            | E             |
| XX-Small | 560          | 170           | 90     | 740          | 80            |
| X-Small  | 590          | 200           | 60     | 770          | 80            |
| Small    | 625          | 235           | 25     | 805          | 80            |
| Medium   | 660          | 260           | 0      | 840          | 80            |
| Large    | 695          | 300           | 0      | 875          | 80            |
| X-Large  | 730          | 315           | 0      | 910          | 80            |



**BEFORE ASSEMBLING YOUR NEW SILVER 47, MAKE SURE THAT YOU HAVE ALL THE FOLLOWING:**

1. Frameset parts checklist (see p.29-30)
2. Inspect the frame for cosmetic aspect (scratches, bumps, cracks, paint defect, etc.)
3. For reference, check serial number and write it on p.2
4. All the necessary bolts (refer to Frameset Parts, p.29-30)
5. For optimal shifting performance, use a dropout alignment gauge to make sure that the drive-side dropout is straight

**IMPORTANT:**

The following parts are assembled on the frame. When assembling the bike, you will need to adjust these parts according to their torque specifications when necessary.

|    | Parts installed on frame   | Description    | Screw type  | Torque Nm  | Detail  |
|----|----------------------------|----------------|-------------|------------|---------|
| 1  | Front derailleur hanger    | Riveted        | -           | -          | -       |
| 2  | Chain suck guard           | Glued          | -           | -          | -       |
| 3  | Seatpost Collar            | M5 Screw (1x)  | Socket head | 4Nm        | Grease  |
| 4  | Seatpost head              | M5 Screws (2x) | Socket head | 4.5Nm      | Grease  |
| 5  | Water bottle cage screws   | M5 Screws (4x) | Socket head | 3Nm        | Grease  |
| 6  | Removable CS cable stopper | M3 Screws (2x) | Flat head   | 1.0 -1.5Nm | Grease  |
| 7  | Rear derailleur hanger     | M4 Screw (1x)  | Flat head   | 2Nm        | Loctite |
| 8  | Small chain catcher        | M5 Screw (1x)  | Socket head | 3Nm        | Nylok   |
| 9  | Headset cap screw          | M4 Screw (1x)  | Flat head   | 0.5-1.0Nm  | Dry     |
| 10 | Console cap screw          | M4 Screws (2x) | Flat head   | 0.5-1.0Nm  | Dry     |



### Brakes

Use only flat mount hydraulic disc brakes. The frame and fork are compatible with either 140mm or 160mm disc rotors. Adapters might be required, consult brake manufacturer.

- Rear mount thickness: 25mm

### Tire Clearance

The biggest tires that can be installed must be no wider than 32mm for the rear and front wheel. *If fenders are installed, the tires must be no wider than 28mm*

### Seat Post

27.2mm

### Seat Post Clamp

31.8mm

### Bottom Bracket

BB86 (Press-fit)

### Headset

FSA No 30 + 3D Press-fit (Bearing 1 1/8", 36°x45° top and 1 1/2", 36°x45° bottom + FSA TH-881-1 Compressor included)

***No more than 30mm of spacer can be place between the stem and the top cap of the 3D system. And the use of more than 5mm spacer on top of the stem could void the efficiency of the compressor. These practices will automatically cancel any warranty claim against the manufacturer.***

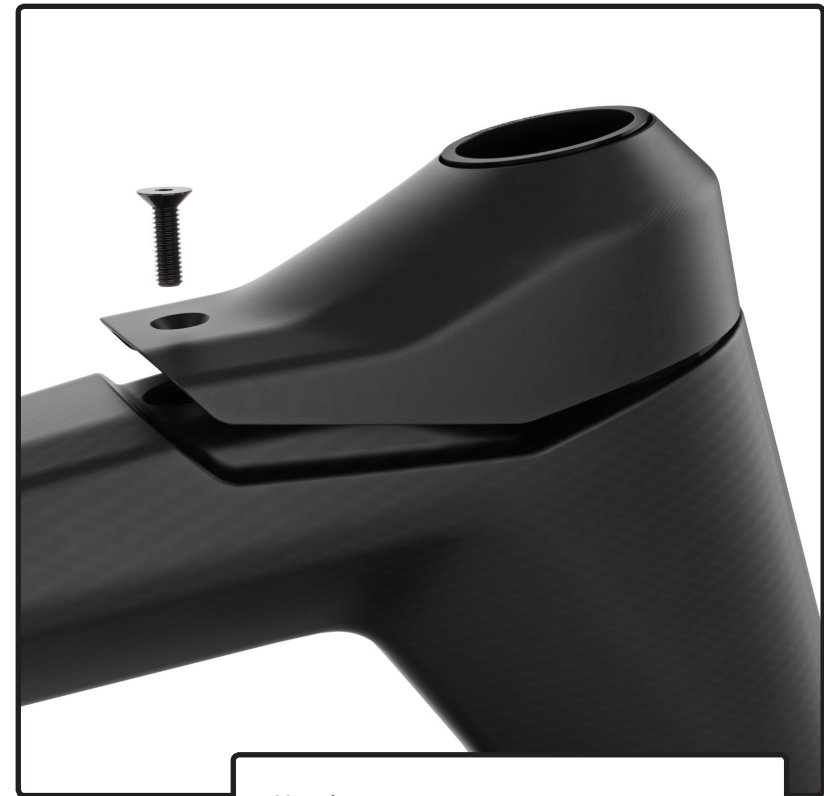

#### Headset cap:

When uninstalling the headset cap, you need to first loosen the headset cap, remove the HS cap screw and remove the fork from the frame. Then you need to pinch the rear section the headset cap and lift the rear section upward. This will release the headset cap from the frame.



Assemble the seat post collar with the seat post. Apply carbon paste on the seat post where it inserts inside the frame. Tighten the bolt at 4 Nm.





The seat post is supplied fully assembled. It's equipped with a spring-loaded head for easy installation of the saddle.

- Unscrew both bolts slightly until the top clamp (b) and the cradle (c) are separated enough to insert the saddle rail. Do not unscrew the bolts completely.
- Screw both bolts in order to adjust the angle of the saddle and clamp the rail.
- Tighten the bolt at 4.5 Nm.

The top clamp (b) and the cradle (c) can be flipped to change the saddle offset between 25 or 15mm.



25mm offset.



15mm offset.

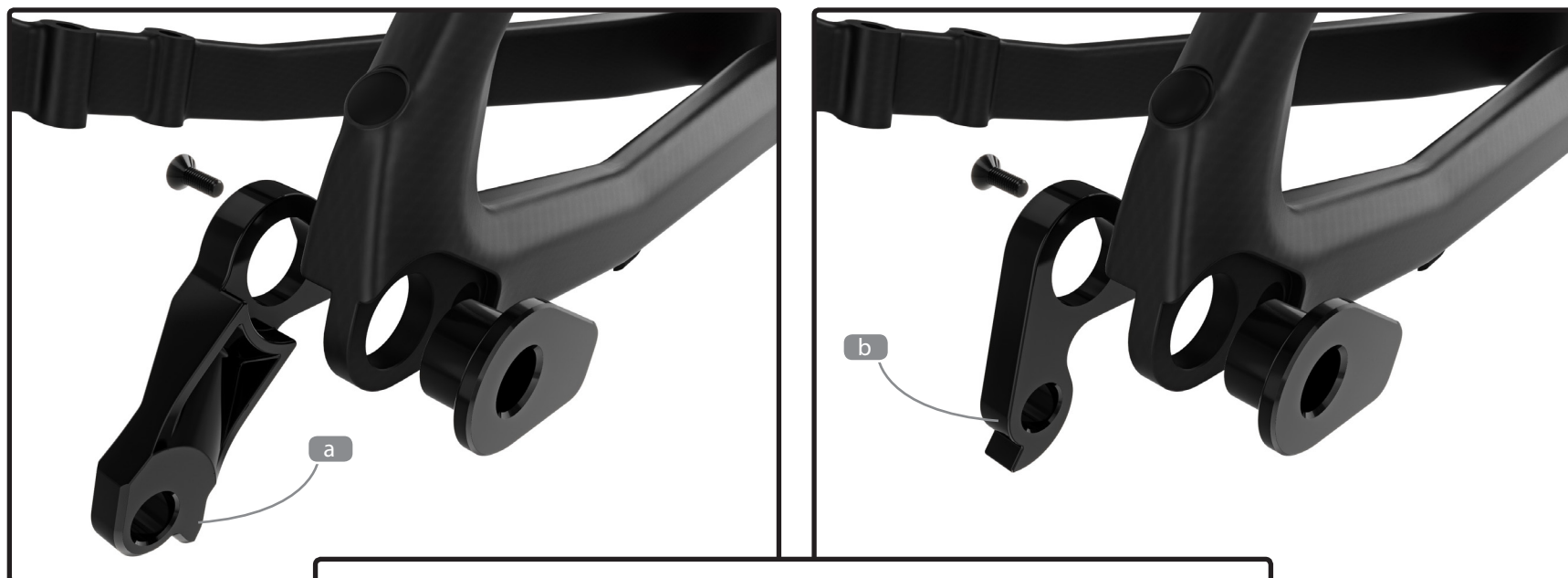

1. Select the correct rear derailleur hanger depending on the type of derailleur that you have.

- a. Direct mount
- b. Regular mount

2. Make sure to align the rear derailleur hanger.

3. Use Derailleur Hanger Alignment Gauge like Park Tool Item #DAG-2.

For any assistance, visit Park Tool's website:

[www.parktool.com/product/derailleur-hanger-alignment-gauge-dag-2](http://www.parktool.com/product/derailleur-hanger-alignment-gauge-dag-2)

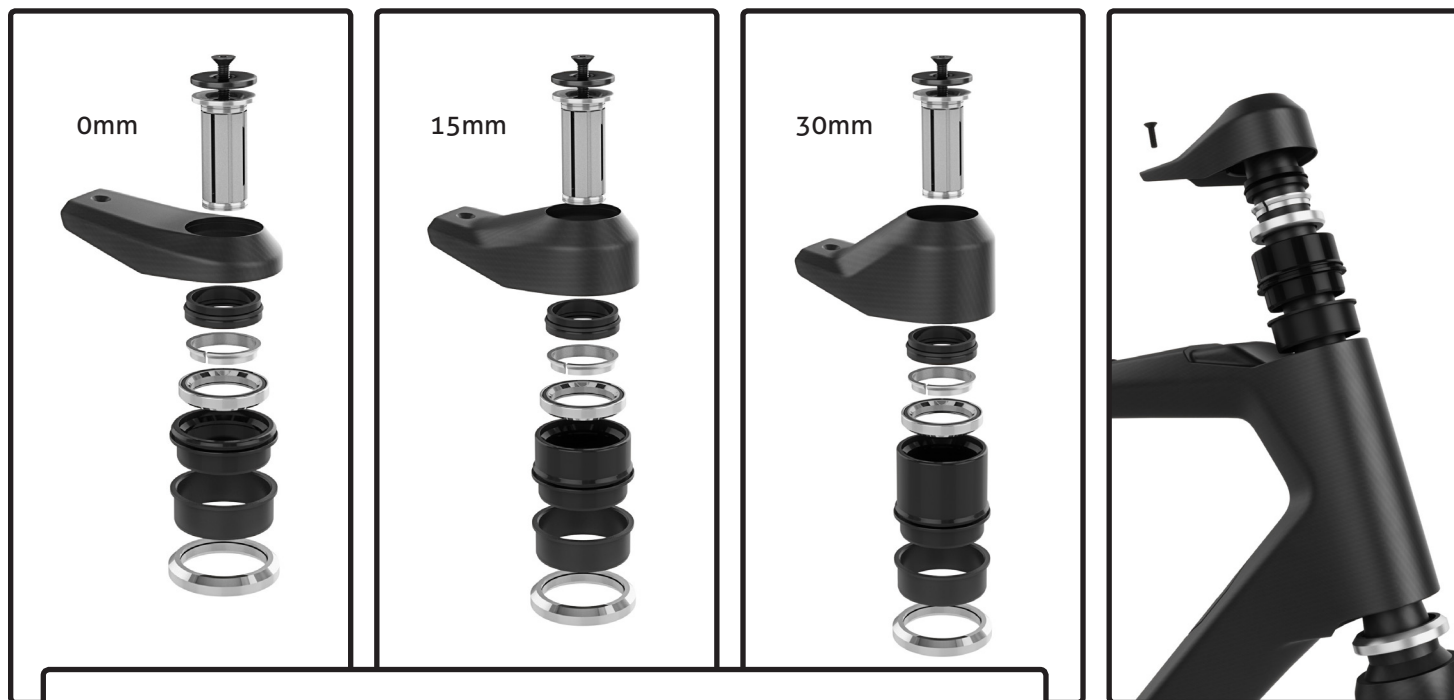

### Step of assembly

1. Insert the headset plastic sleeve into the top on the headtube. (apply grease)
2. Insert the required headset column, 0, 15 or 30mm, in the headset plastic sleeve. (apply grease)
3. Insert bottom bearing on the fork.
4. Slide the fork in the head tube of the frame.
5. Install top bearing in the headset column. (apply grease)
6. Install conical compressor ring.
7. Install stack compressor.
8. Apply grease on the headset seal to avoid any noise.
9. Install the corresponding headset cap to complete the assembly.
10. Fix the cap with the M4 flat head screw.

Like on almost all Argon 18 you will benefit of the 3D system, on the Silver 47 you can benefit of 3 positions, 0mm, 15mm and 30mm



The console is the central point of the cable and housing routing. Depending of the type of assembly you will have to select the correct assembly.

**Tip: No mater the type of assembly you will choose, always pass the brake housing first starting from the back of the bike to the front.**

1. With the rear brake housing coming from the back of the bike, guide the end of the housing through the right side of the rectangular opening of the Di2 console cap (3).
2. Use the brake housing to insert the foam line into the downtube.
3. Guide the Di2 cable coming from the shifters through the grommet (4) and into the rectangular opening of the console.
4. Guide the bake housing to the bigger hole of the grommet (4).
5. Guide the Di2 cable coming from the shifters through the grommet (4) and into the rectangular opening of the console.
6. Fix the grommet on the console.
7. Place the Di2 O-Ring (5) around the Shimano EW-RS910 junction box.
8. Connect the front and rear Di2 cable to the Shimano EW-RS910 junction box.
9. Clip the Shimano EW-RS910 junction box on the console cap (3).
10. Fix the console cap to the downtube of the frame with the screws.





1. With the rear brake housing coming from the back of the bike, guide the end of the housing through the opening of the console.
2. Use the brake housing to insert the foam liner around the brake housing.
3. Insert the Di2 wire from the external junction box A through the hole in the mechanical console cap.
4. Secure the Di2 wire into the Di2 external insert.
5. Secure the brake housing into the Di2 external insert.
6. Secure the Di2 external insert into the console cap.
7. Fix with the provided screws the console cap on the frame.

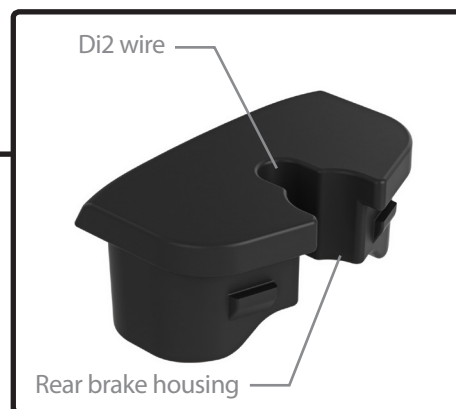



1. With the rear brake housing coming from the back of the bike, guide the end of the housing through the opening of the mechanical console cap. (1)

2. Use the brake housing to insert the foam liner around the brake housing in the downtube.

3. Guide the brake housing in the e Di2 external insert.

4. Secure the Wireless insert (2) on the console cap (1) by pressing firmly on the insert.

5. Fix with the provided screws the console cap on the frame.



Rear brake housing



1. With the rear brake housing coming from the back of the bike, guide the end of the housing through the opening of the console.
2. Use the brake housing to insert the foam liner around the brake housing.
3. Insert the Di2 wire from the external junction box A through the hole in the mechanical console cap (1).
4. Secure the Di2 wire into the Di2 external insert (2).
5. Secure the brake housing into the Di2 external insert.
6. Secure the Di2 external insert into the console cap.
7. Fix with the provided screws the console cap on the frame.







1. With the rear brake housing coming from the back of the bike, guide the end of the housing through the opening of the mechanical console cap. (1)
2. With the rear derailleur cable coming from the front of the bike and on the right side of the bike, guide the end of the cable through the opening of the mechanical console cap. (1)
3. Cut the necessary length of shifter housing to cover the distance between the hood of the shifter to the console.
4. Install housing cap on the end of the housing that connect into the console.
3. Insert the housing into the insert (2) according to Figure 2.
4. Secure the mechanical insert (2) on the console cap (1) by pressing firmly on the insert.
5. Fix with the provided screws the console cap on the frame.

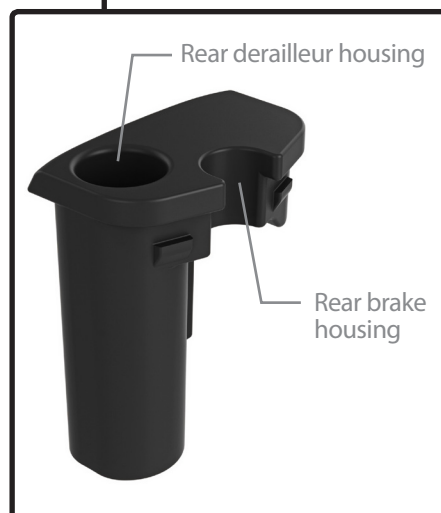





Rear derailleur cable and rear brake housing must be routed on the right side in the inside of the downtube.

Rear brake housing need to routed above the bb carbon sleeve.

*Red line: brake cable/housing / Blue line: derailleur cable/housing*

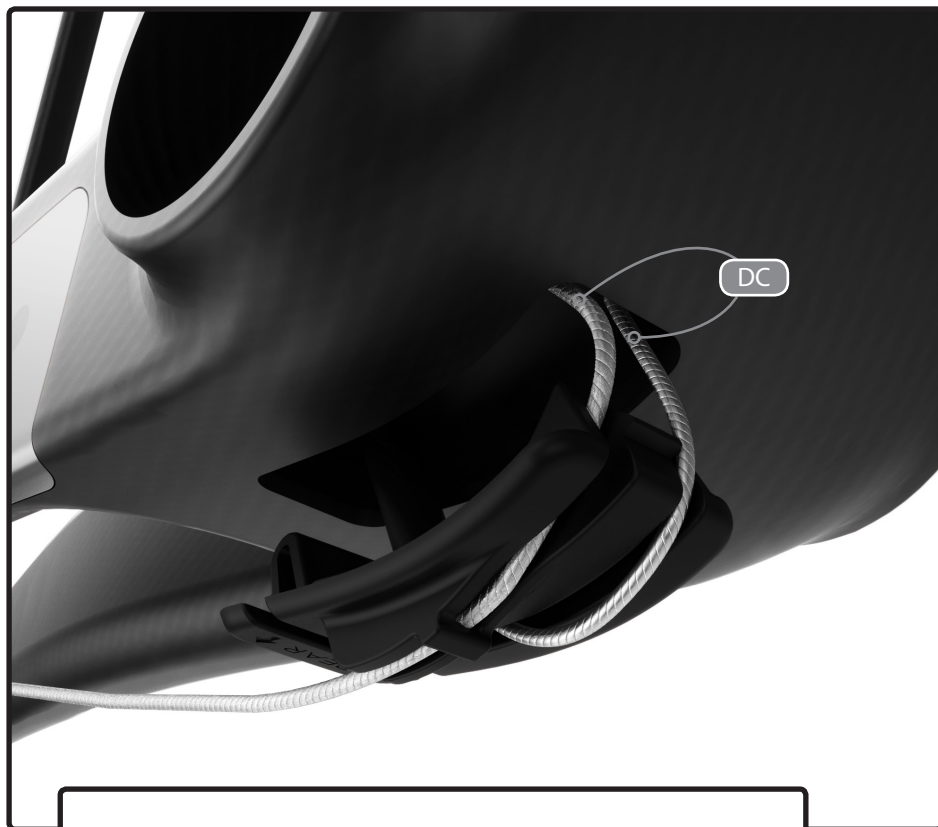

Exit derailleur cables through bottom bracket (BB) hole.

Insert in the appropriate slots in the BB guide.

Making sure the pipe is aligned with the top hole, insert BB guide in the square hole until it clicks.



DC = Derailleur Cable (mech.)



BR = Brake Hose  
DC = Derailleur Cable (mech.)  
DH = Derailleur Housing (mech.)

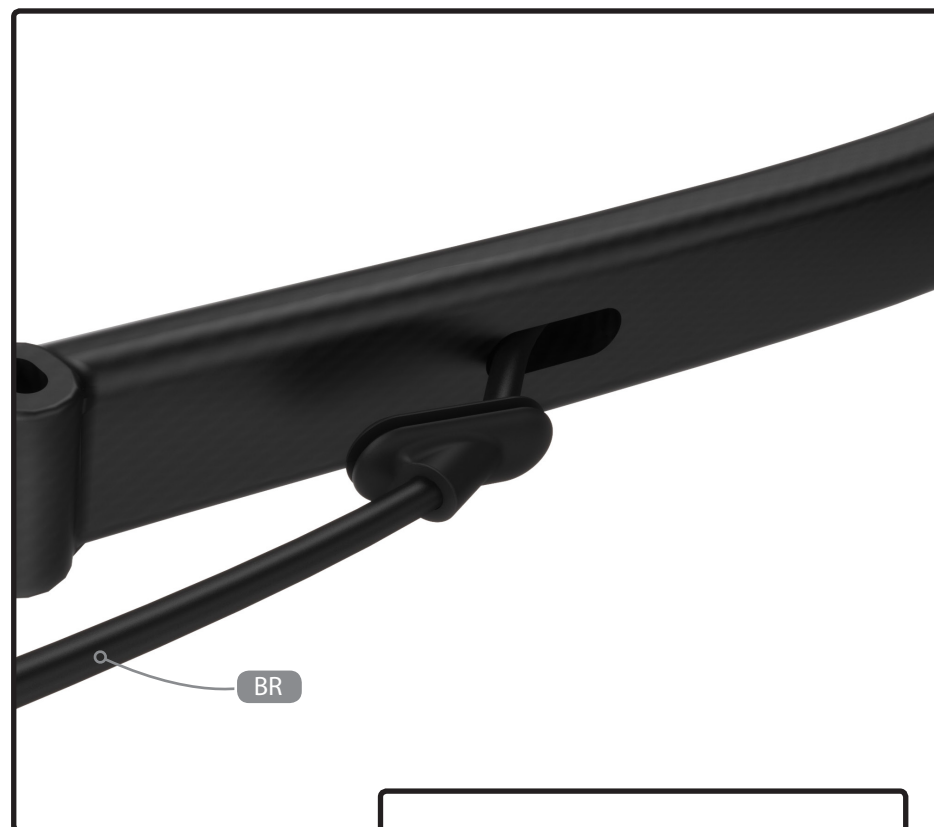

Exit the hydraulic brake hose through the hole on the chain stay.



Rear derailleur cable and rear brake housing must be routed on the right side in the inside of the downtube.

Rear brake housing need to routed above the bb carbon sleeve.

*Red line: brake cable/housing / Yellow line: derailleur cable/housing*

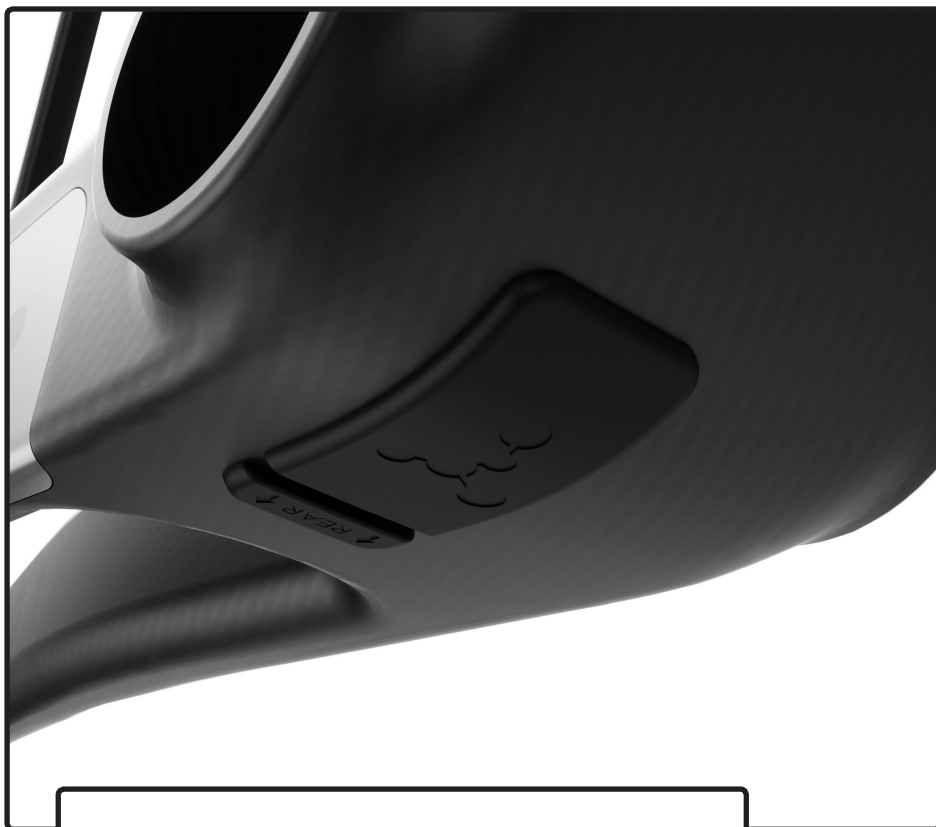

Use the square hole to connect all the wires to the junction box.

Insert the junction box in the hole.

Insert the BB cover in the square hole until it clicks.

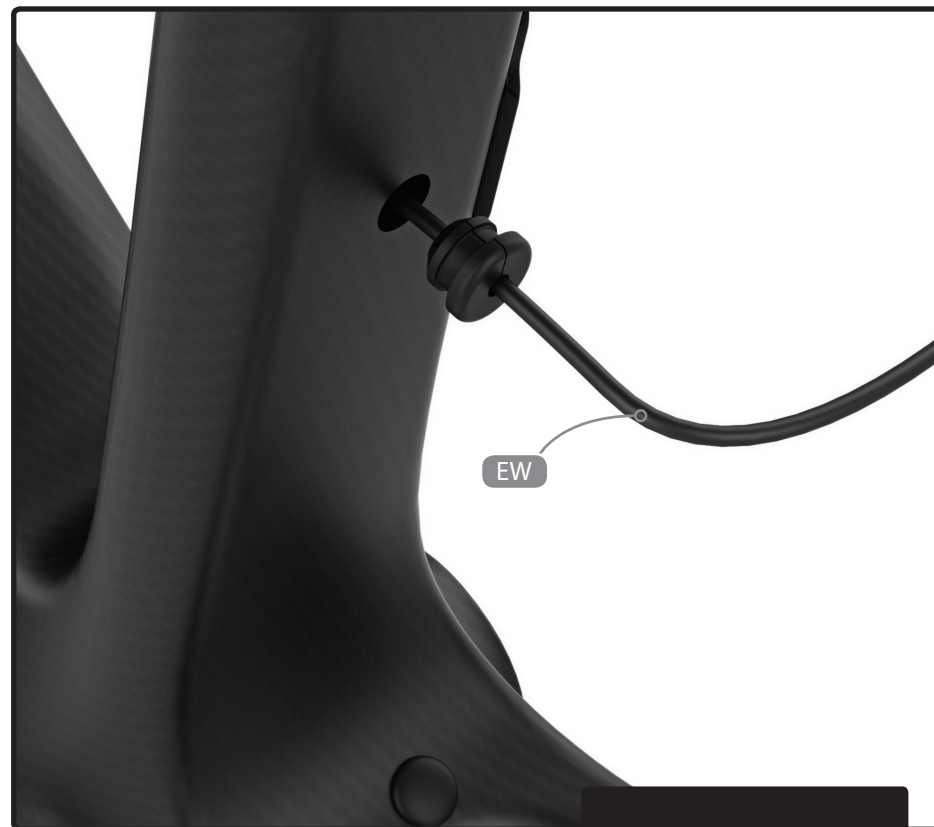

EW = Electronic Wire



BR = Brake Hose  
EW = Electronic Wire

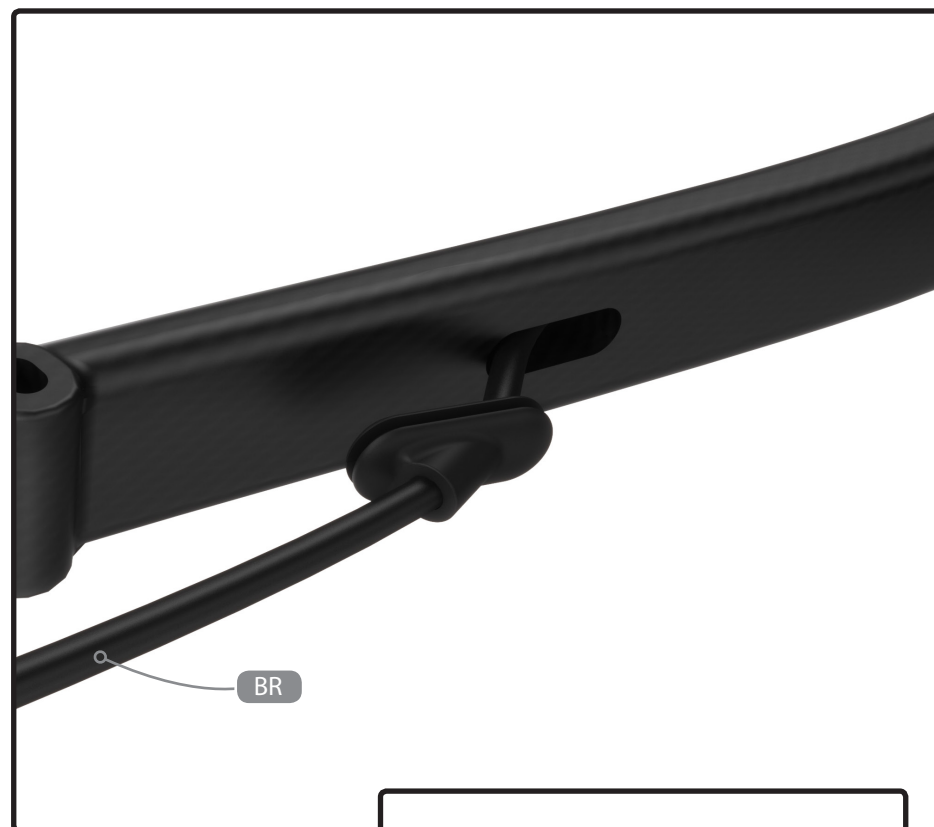

Exit the hydraulic brake hose through the hole on the chain stay.

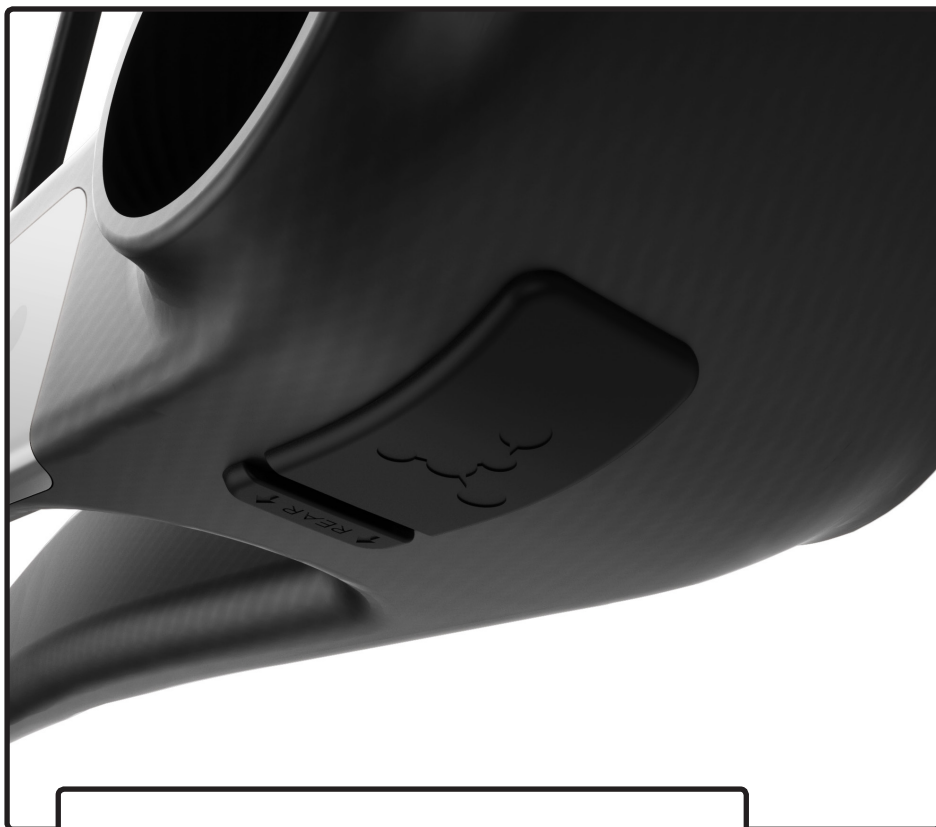

Use the square hole to connect all the wires to the junction box.

Insert the junction box in the hole.

Insert the BB cover in the square hole until it clicks.

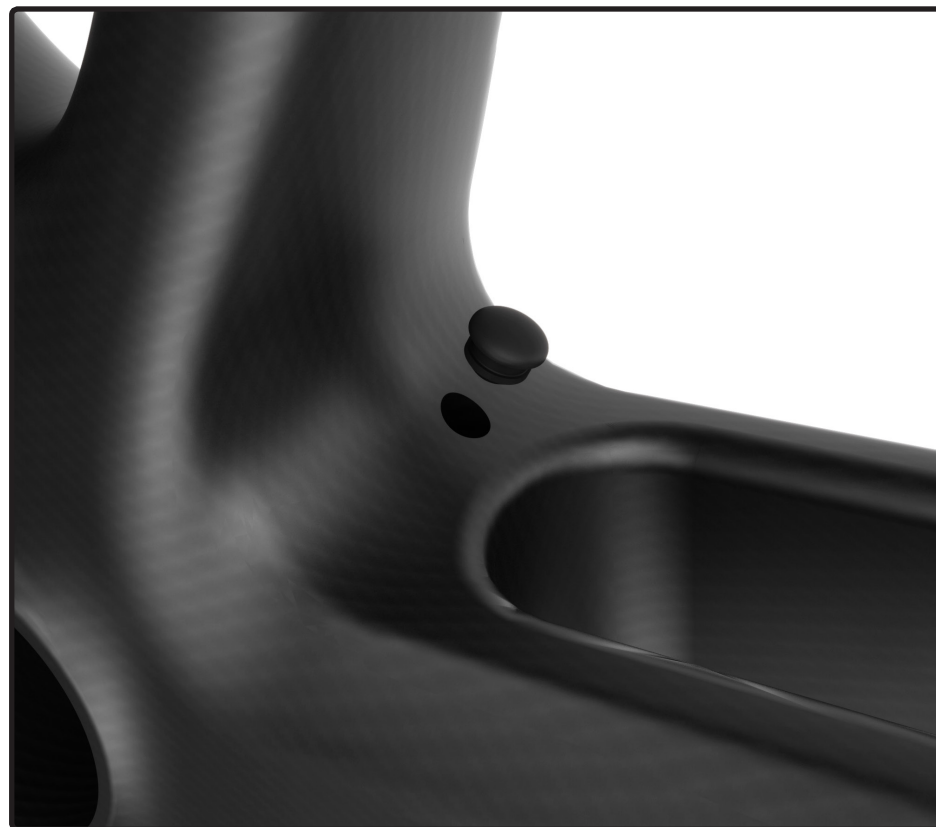



BR = Brake Hose

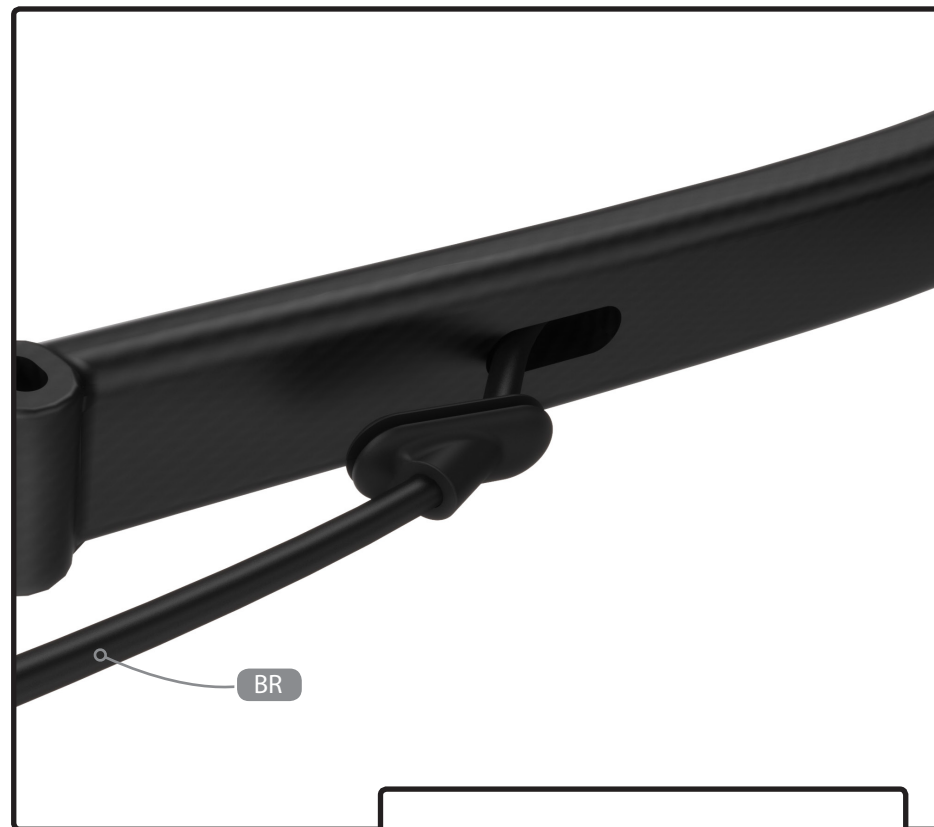

Exit the hydraulic brake hose through the hole on the chain stay.





1. Select the corresponding chain catcher. The selection of the correct chain catcher is made in function of the size of the small chaining.

| Small Chain Ring Size | Chain Catcher |
|-----------------------|---------------|
| 34-36                 | Small         |
| 38-42                 | Large         |

2. Insert the screw in the chain catcher and place the lock washer between the frame and the piece. Secure the assembly loosely to be able to adjust the parts.
3. Place the tip of the chain catcher at approximately 2mm to the inner side of the small chain ring. And torque at 3Nm.

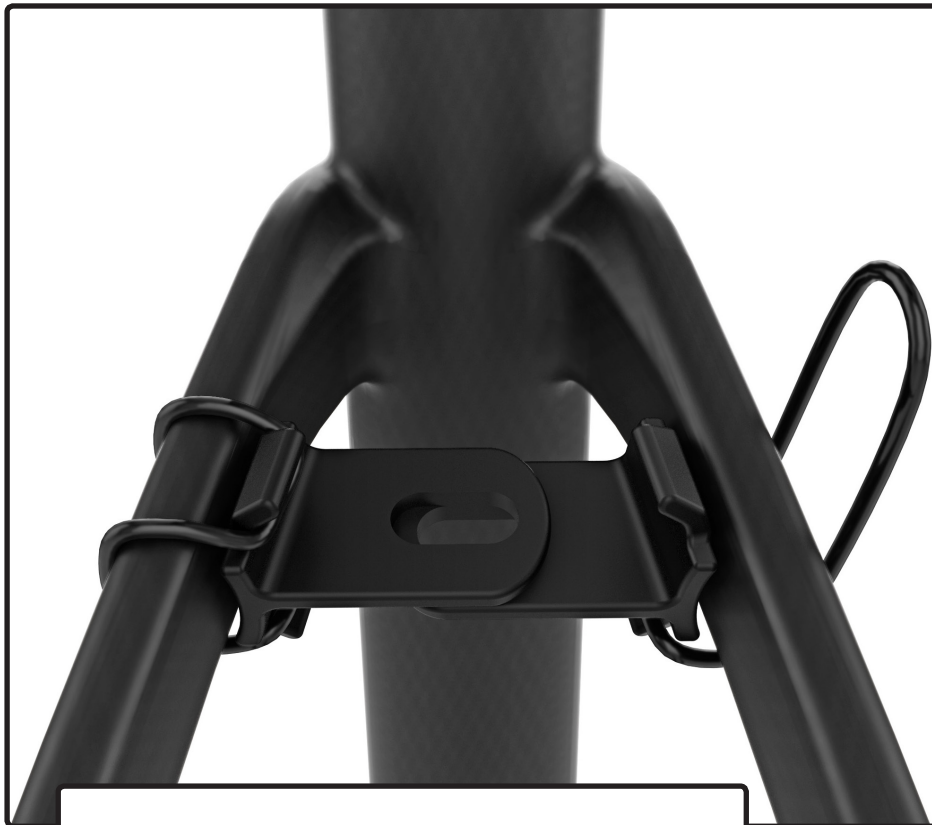

- i. According to the model of fender using place the bracket at the correct height on the seatstay.
- ii. Secure the fender bracket with the 2 attached rubber band making sure that the 2 plastic parts are well overlapping.
- iii. When securing the fender on your seatstay, make sure that the screw is not longer than 12mm.

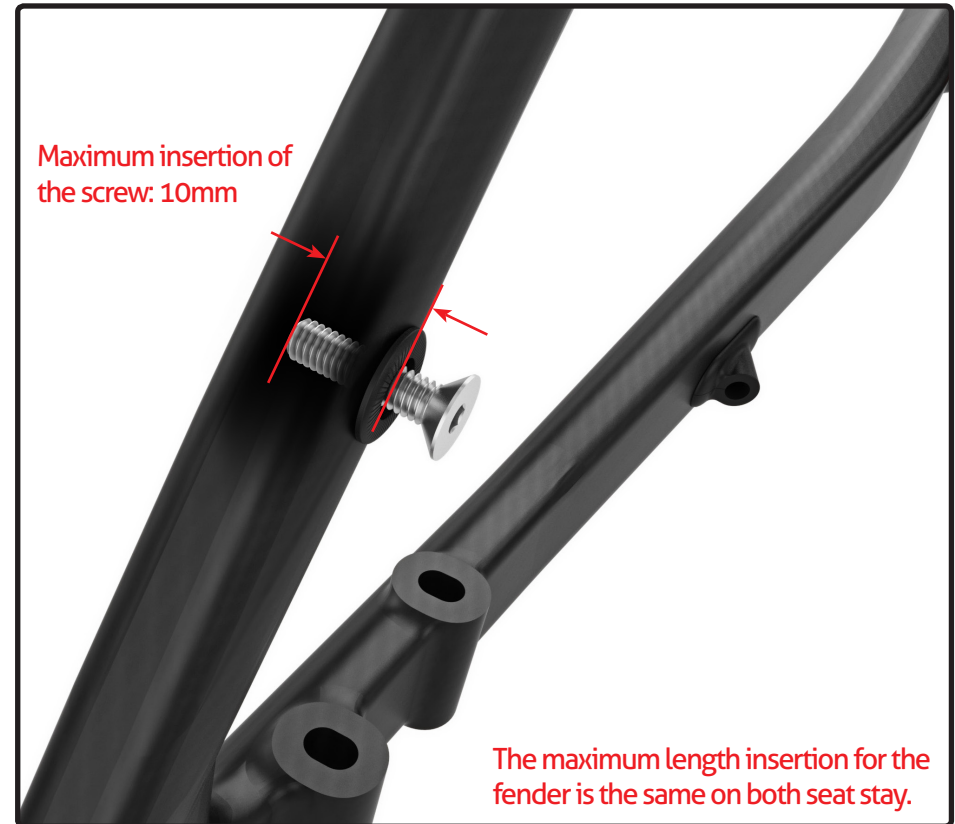

# 13. Silver 47: Parts' SKU and Description

**ARGON 18**

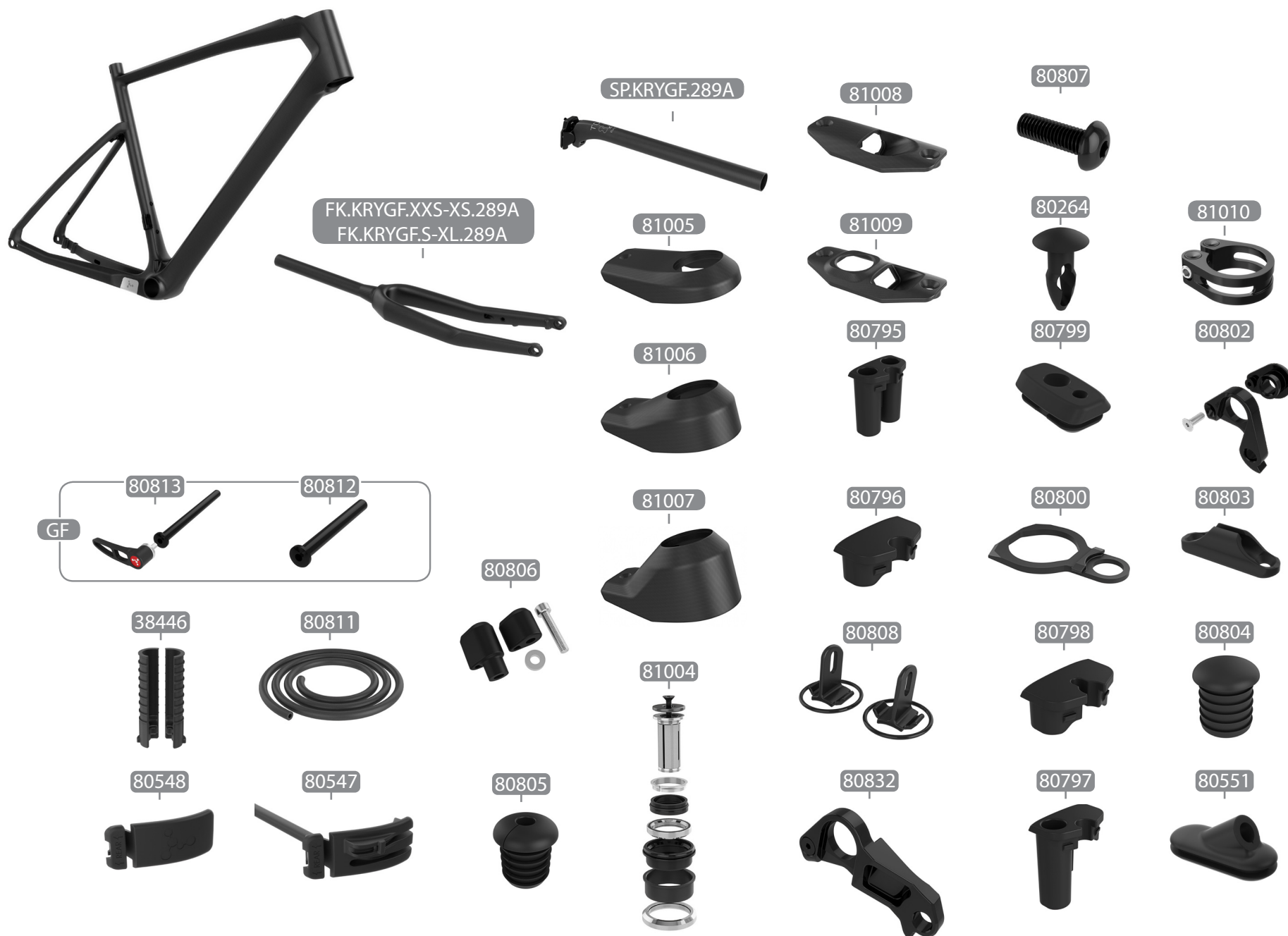

### 13. Silver 47: Parts' SKU and Description

**ARGON 18**



| No. | Name                           | Assembled on | A18 SKU#             | Qty |
|-----|--------------------------------|--------------|----------------------|-----|
| #   | <b>Parts already assembled</b> |              |                      |     |
|     | Front derailleur hanger        | Frame        | -                    | 1   |
|     | Chain suck guard               | Frame        | -                    | 1   |
|     | Seatpost collar                | Frame        | 81010                | 1   |
|     | Rear derailleur hanger         | Frame        | 80802                | 1   |
|     | Removable cable stopper        | Frame        | 80803                | 1   |
|     | Long plug                      | Frame        | 80804                | 1   |
|     | Small chain catcher            | Frame        | 80806                | 1   |
|     | Water bottle screws            | Frame        | 80807                | 4   |
|     | M5 plastic plug                | Frame        | 80264                | 8   |
| #   | <b>Parts</b>                   |              |                      |     |
|     | Silver 47 frame                | -            | -                    | -   |
|     | Silver 47 fork XXS-XS          | -            | FK.KRYGF.XXS-XS.289A | 1   |
|     | Silver 47 fork S-XL            | -            | FK.KRYGF.S-XL.289A   | 1   |
|     | Silver 47 seatpost             | Seatpost     | SP.KRYGF.289A        | 1   |
|     | Silver 47 headset cap – 0mm    | Frame        | 81005                | 1   |
|     | Silver 47 headset cap – 15mm   | Frame        | 81006                | 1   |
|     | Silver 47 headset cap – 30mm   | Frame        | 81007                | 1   |
|     |                                |              |                      |     |
|     |                                |              |                      |     |
|     |                                |              |                      |     |
|     |                                |              |                      |     |

*\*Except for the frame itself, which is not sold as a spare part, all parts can be ordered by referring to their respective SKU number.*

## 13. Silver 47: Parts' SKU and Description

**ARGON 18**



| No. | Name  | Assembled on | A18 SKU# | Qty |
|-----|---|--------------|----------|-----|
| #   | Parts   |              |          |     |
|     | No. 30 + 3D with TH-881-1 headset assembly            | Frame        | 81004    | 1   |
|     | Silver 47 Console cover mechanical system             | Frame        | 81008    | 1   |
|     | Silver 47 Console cover DI2 system                    | Frame        | 81009    | 1   |
|     | Console insert for mechanical drivetrain              | Frame        | 80795    | 1   |
|     | Console insert for internal junction A box            | Frame        | 80799    | 1   |
|     | Console Ring for internal junction A box              | Frame        | 80800    | 1   |
|     | Console insert for wireless drivetrain                | Frame        | 80796    | 1   |
|     | Console insert for 1x11 groupset                      | Frame        | 80797    | 1   |
|     | Console insert for external junction A box            | Frame        | 80798    | 1   |
|     | Long Di2 grommet                                      | Frame        | 80805    | 2   |
|     | Rear derailleur hanger direct mount                   | Frame        | 80832    | 1   |
|     | Chain catcher (incl. small / large, washer and screw) | Frame        | 80806    | 1   |
|     | BB cable guide  | Frame        | 80547    | 1   |
|     | BB cable cover  | Frame        | 80548    | 1   |
|     | Oblong cable guide                                    | Frame        | 80551    | 1   |
|     | Fender bracket  | Frame        | 80808    | 1   |
|     | Silver 47 Rear thru axle with removable handlebar     | Frame        | 80813    | 1   |
|     | Silver 47 Front thru axle                             | Fork         | 80812    | 1   |
|     | Seatpost battery holder                               | Seatpost     | 38446    | 1   |
|     | Foam liner  | Frame        | 80811    | 1   |
|     |   |              |          |     |
|     |   |              |          |     |
|     |   |              |          |     |