





Assembly overview .....	2-4
1. Frame inspection .....	5
2. Fork installation .....	6-7
3. Handlebar installation .....	8-12
4. Handlebar assembly .....	13-14
5. Cable housing installation .....	15-16
6. Electronic drive-train specification .....	17-20
7. Front brake installation .....	21-23
8. Rear brake installation .....	24-25
9. Armrest assembly .....	26
10. Seatpost installation .....	27
11. Saddle adjustment .....	28-29
12. Derailleur hanger adjustment .....	30
13. Parts' SKUs and Descriptions .....	31-34

*For the warranty to be valid, the bicycle must be fully assembled by an authorized Argon 18 dealer. High end components, particularly carbon parts, need extra care when assembled. Those components must be installed using a calibrated torque wrench to make sure every bolt is at the right torque setting to prevent damage.*



**1. Frame inspection**



**2. Fork installation**



**3. Handlebar installation**



**4. Handlebar assembly**



**5. Cable housing installation**

IMPORTANT NOTICE: It is easier to install the cables and cable housings before the bearings.



**6. Electronic drive-train specification**



**7. Front brake installation**



**8. Rear brake installation**



**9. Armrest assembly**



**10. Seatpost installation**



**11. Saddle adjustment**



**12. Derailleur hanger adjustment**

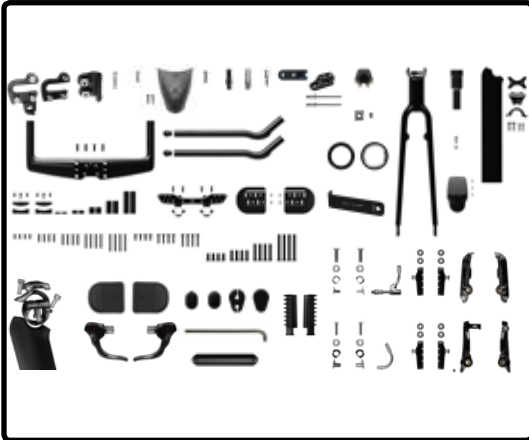

13. Parts listing



When assembling a new frame, be sure to check if the following parts are assembled correctly.

Parts installed on the frame Description			Screw type	Torque Nm	Detail
1	Front derailleur hanger	Screw (2)	3mm	4Nm	Loctite
2	Rear derailleur hanger	Screw (2)	3mm	4Nm	Loctite
3	Bottle cage	Screw (4)	4mm	3Nm	Grease
4	Bottom bracket cover	Screw (2)	5mm	2Nm	Grease





2.3 Slightly unscrew the steering column set screw (4c) located on the fork.

2.4 Screw in the compression column (4b) (specific to the size of your frame) inside the head tube. The threads must be lightly greased until the compression column can be inserted smoothly and tightly.

2.5 Screw in the safety screw (4c) at 6Nm.





3.1 Choose the desired position of the handlebar: high (+ 2.5cm) or low (- 2.5cm).

3.2 Apply grease on the 4 screws (6) (M6x22mm) and tighten them at 6Nm in an alternate way.

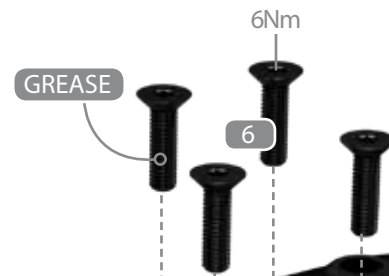



3.3 Install vertical spacers (17) and two sleeve nuts (15).

See next page for stack configuration options.

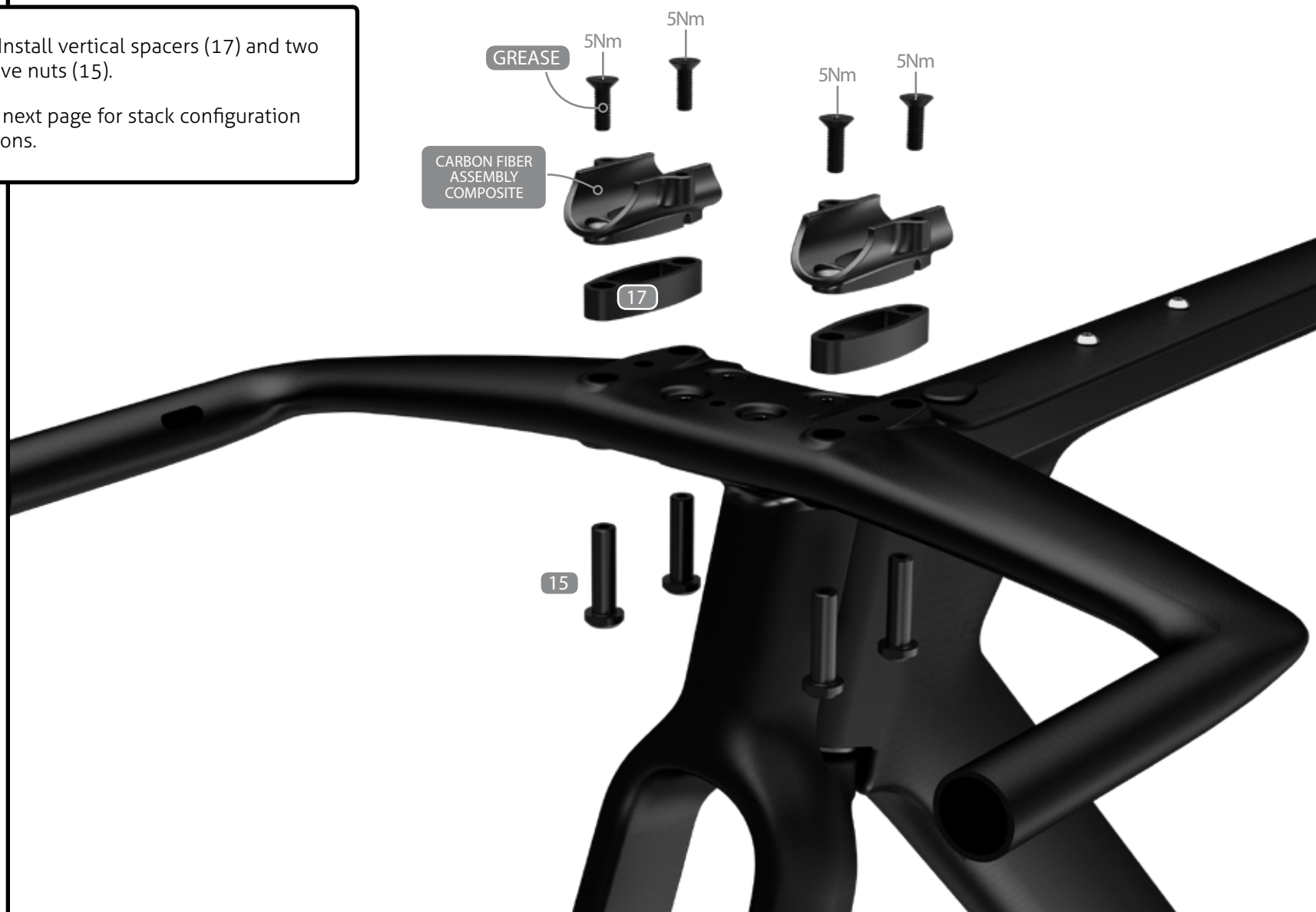



### Parts needed to adjust pads stack's height

Total stack height (mm)    0                    5                    10                    15                    20                    25                    30

#### WITH SWIVEL

Required spacer	X	X	X	X	None	5	10
Sleeve nut					20mm	20mm	30mm
Screw (flat head)					15mm	15mm	15mm

#### WITHOUT SWIVEL

Required spacer	None	5	10	5 + 10	20	5 + 20	10 + 20
Sleeve nut	20mm	20mm	30mm	30mm	30mm	30mm	50mm
Screw (flat head)	15mm	15mm	15mm	15mm	25mm	25mm	15mm

Total stack height (mm)    35                    40                    45                    50                    55                    60                    65

#### WITH SWIVEL

Required spacer	5 + 10	20	5 + 20	10 + 20	5 + 10 + 20	40	5 + 40
Sleeve nut	30mm	30mm	30mm	50mm	50mm	50mm	50mm
Screw (flat head)	15mm	25mm	25mm	15mm	15mm	25mm	25mm

#### WITHOUT SWIVEL

Required spacer	5 + 10 + 20	40	5 + 40	10 + 40	5 + 10 + 40	20 + 40	5 + 20 + 40
Sleeve nut	50mm	50mm	50mm	50mm	50mm	80mm	80mm
Screw (flat head)	15mm	25mm	25mm	35mm	35mm	15mm	15mm

Total stack height (mm)    70                    75                    80                    85                    90                    95                    100

#### WITH SWIVEL

Required spacer	10 + 40	5 + 10 + 40	20 + 40	5 + 20 + 40	70	5 + 70	10 + 70
Sleeve nut	50mm	50mm	80mm	80mm	80mm	80mm	80mm
Screw (flat head)	35mm	35mm	15mm	15mm	25mm	25mm	35mm

#### WITHOUT SWIVEL

Required spacer	70	5 + 70	10 + 70	5 + 10 + 70	20 + 70	5 + 20 + 70	10 + 20 + 70
Sleeve nut	80mm	80mm	80mm	80mm	80mm	80mm	80mm
Screw (flat head)	25mm	25mm	35mm	35mm	45mm	45mm	55mm

#### Notes:

- Always place the smaller spacers underneath
- Make sure you have at least 6 full threads on each screw
- Every spacer screw must be tightened to 5Nm
- The M6 screw (5mm allen key) that enables the swivel adjustment must be tightened to 8Nm
- The screws linking the extension connectors to the swivel are 12mm long (M5 flat head)



3.4 For an inclined position, use the swivel assembly (14).

#### STEP 1 : Swivel assembly content:

- 1- Connector base (8)
- 2- Swivel spacer (14a + 14b)
- 3- Swivel screw (14c)
- 4- Swivel square nut (14e)

Assemble the unit and leave it unscrewed, just enough to allow adjustment and also allow to turn the swivel 90 degrees to have access to the bottom hole to fix the flat head screw at 6Nm. Once the proper angle is set, use a marker to obtain a reference and adjust both spacers with same angle. Use the Di2 hole as a starting point.

Fix the 6mm flat head of the swivel screw (silver) to 8Nm.

#### STEP 2 :

The connector base must be fixed to the top of the swivel assembly, not on the sleeve nuts. The sleeve nuts will be used to fix the spacers later.

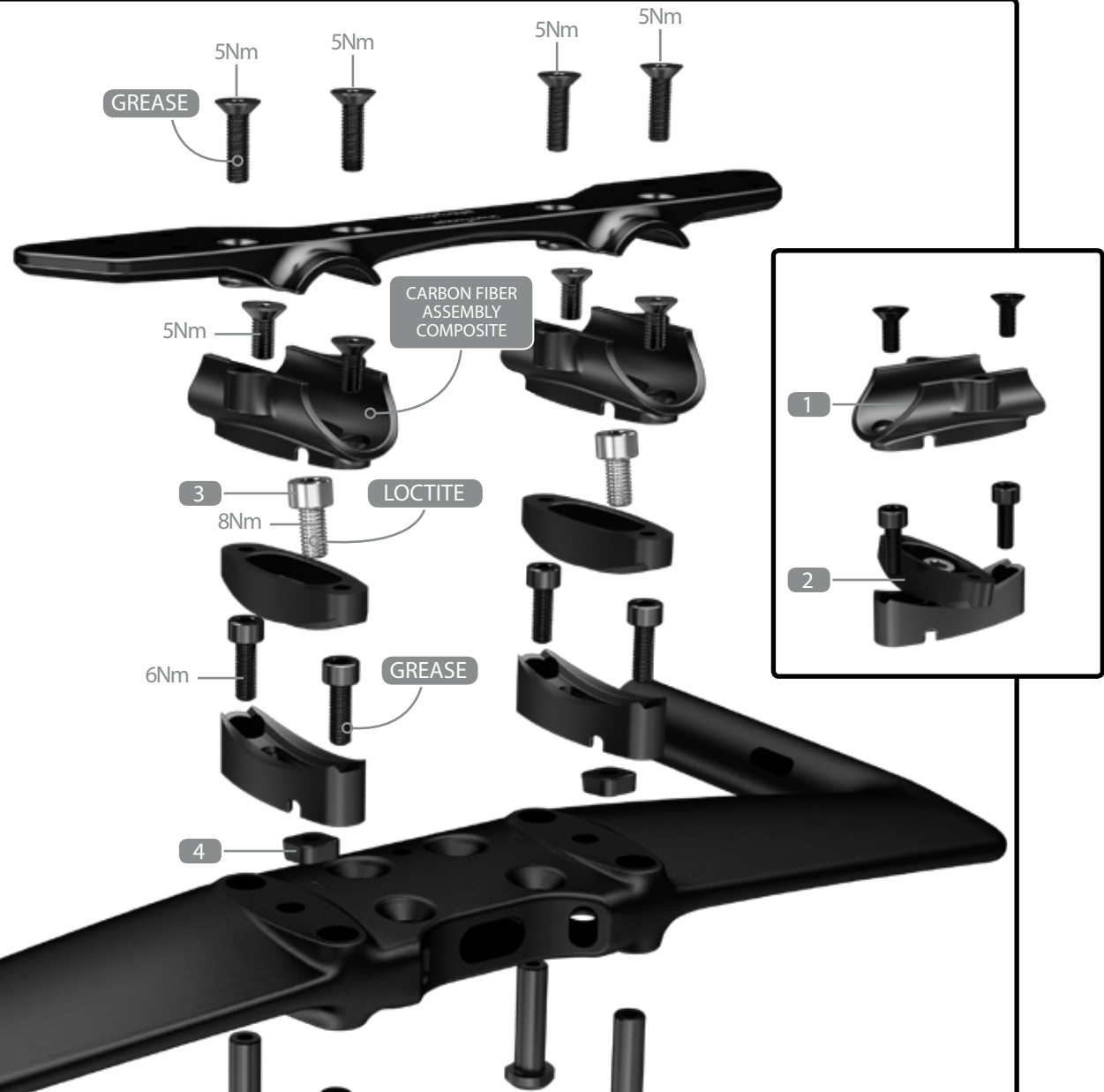

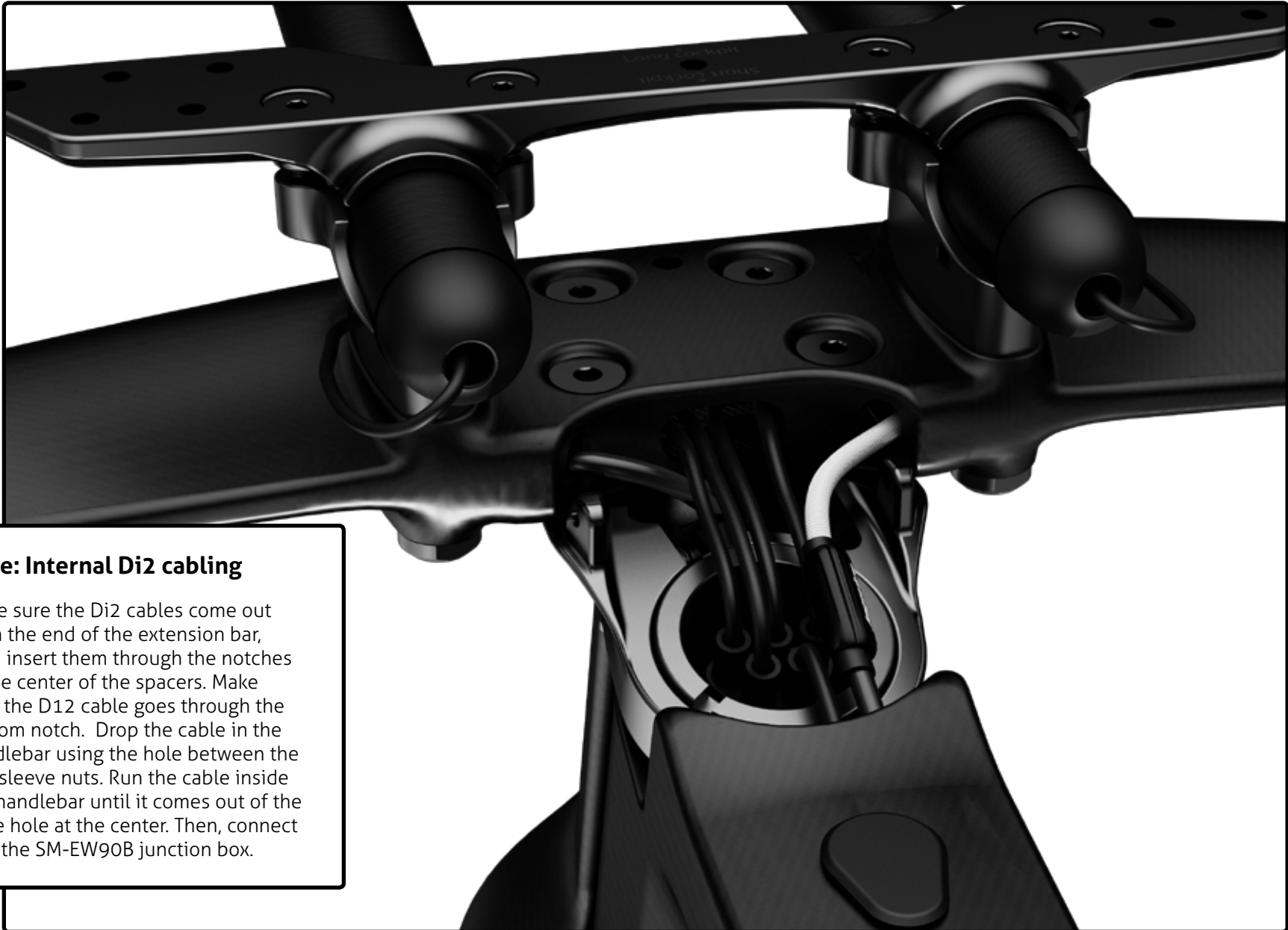
**Note: Internal Di2 cabling**

Make sure the Di2 cables come out from the end of the extension bar, then insert them through the notches at the center of the spacers. Make sure the D12 cable goes through the bottom notch. Drop the cable in the handlebar using the hole between the two sleeve nuts. Run the cable inside the handlebar until it comes out of the large hole at the center. Then, connect it to the SM-EW90B junction box.



4.1 Cut the extension bars (7) at the desired length to obtain a straight post\*. The bars must not exceed 285mm in length. **The cut must be made on the elbow side.** The other end of the bar is used exclusively to install the shifter. Apply some carbon fiber assembly gel in the clamping area.

**\*Warning: If using a ski bent section, no more than 40mm can be cut out.**

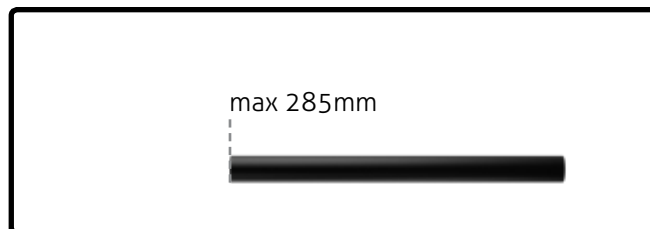
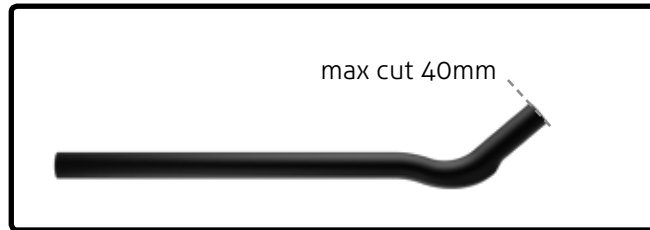
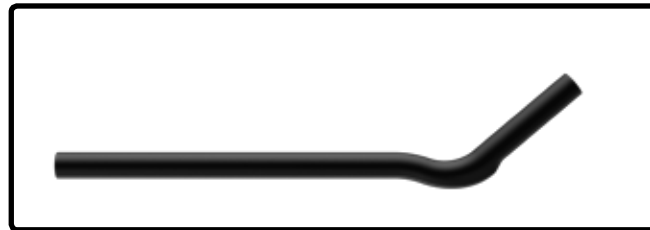

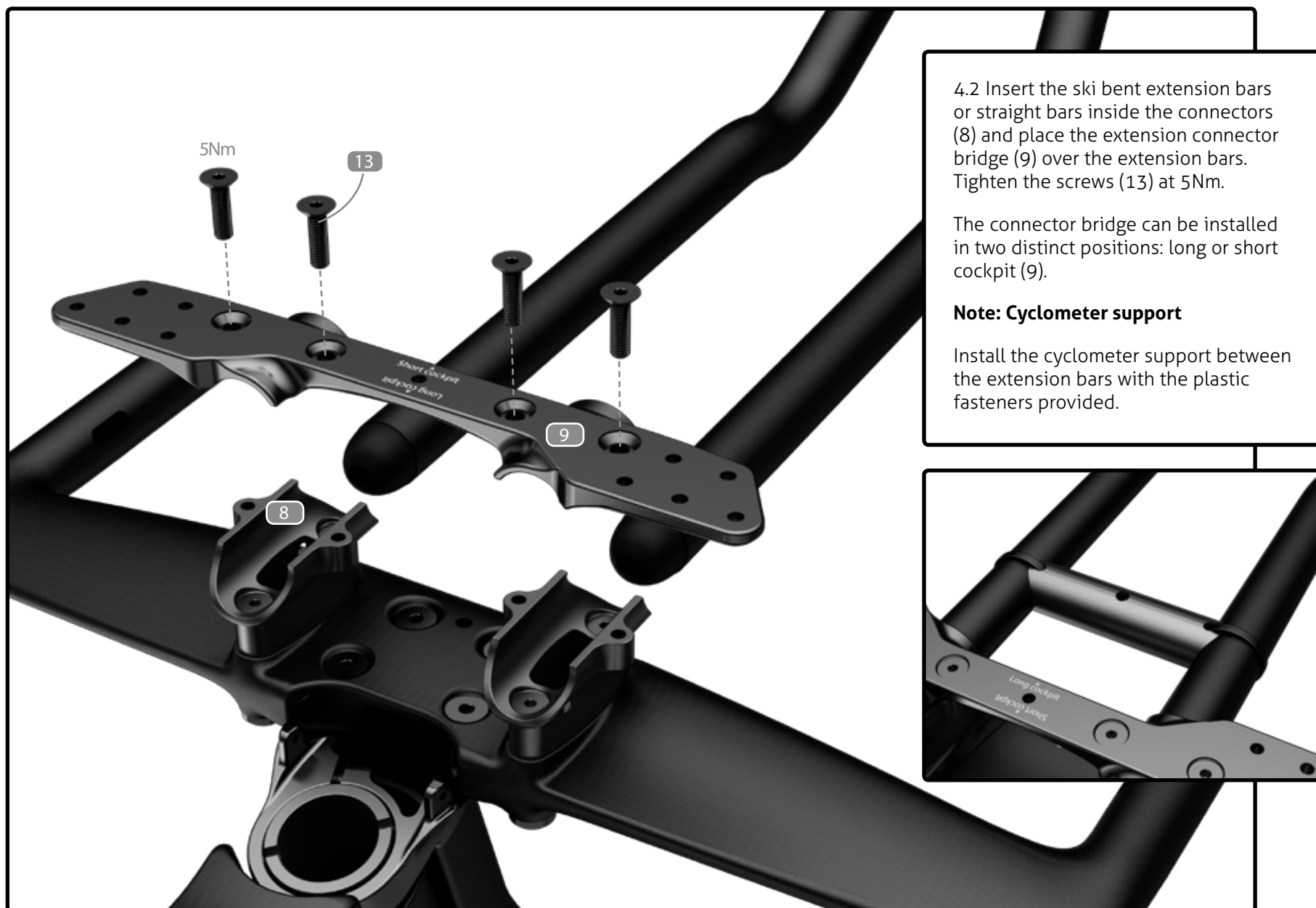



5.1 Install the rear derailleur cable housing starting at the drive side's drop-out.

5.2 Install the front derailleur cable housing starting under the bottom bracket shell.

5.3 Install the front brake cable housing starting at the center of the handlebar. Make sure that the cable housing does not go through the compression column, but through the space in front of the compression column (see image A, page 16).

5.4 Install the rear brake cable housing starting under the bottom bracket shell.

See the table below for the cable housing length suggested.

### Suggested lengths of the cable housing\*

(the medium frame is used as a reference)

Cable housing/length	XS	S	M	L
FRONT brakes (KEB leftover)	40cm	41cm	43cm	45.5cm
REAR brakes (Gray EZ-Bend housing)	106.5cm	108cm	110cm	112.5cm
FRONT derailleur	140cm	142cm	144cm	150cm
REAR derailleur	198cm	200cm	202cm	204cm

\* For guidance purposes only. Can vary according to the shifters used.





Note: To make the brake cable housing go inside the handlebar more easily, use a brake cable as a guide and insert it head first (from the middle of the handlebar towards the brake lever) using one of the two side holes. Follow the curves of the handlebar. Once the cable is out, slide the cable housing along.

*IMPORTANT : You must cut the metal ferrule located at the end of the rear brake EZ-Bend cable housing prior to install it correctly on the rear brake barrel adjuster.*

A



Mechanical drive-train configuration

B



Electronic drive-train configuration

C

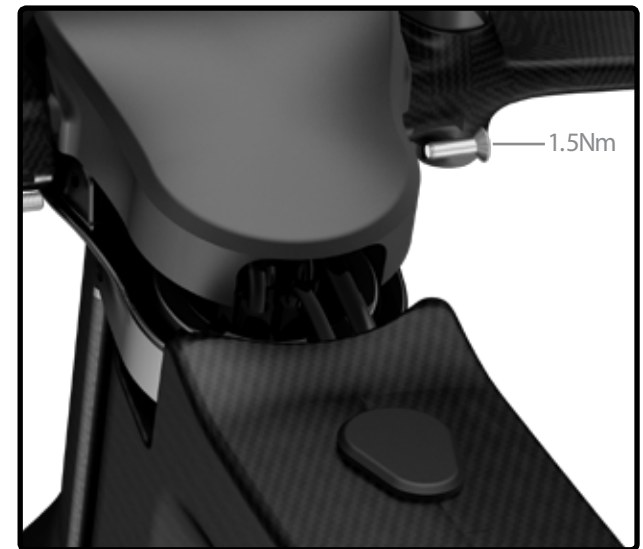

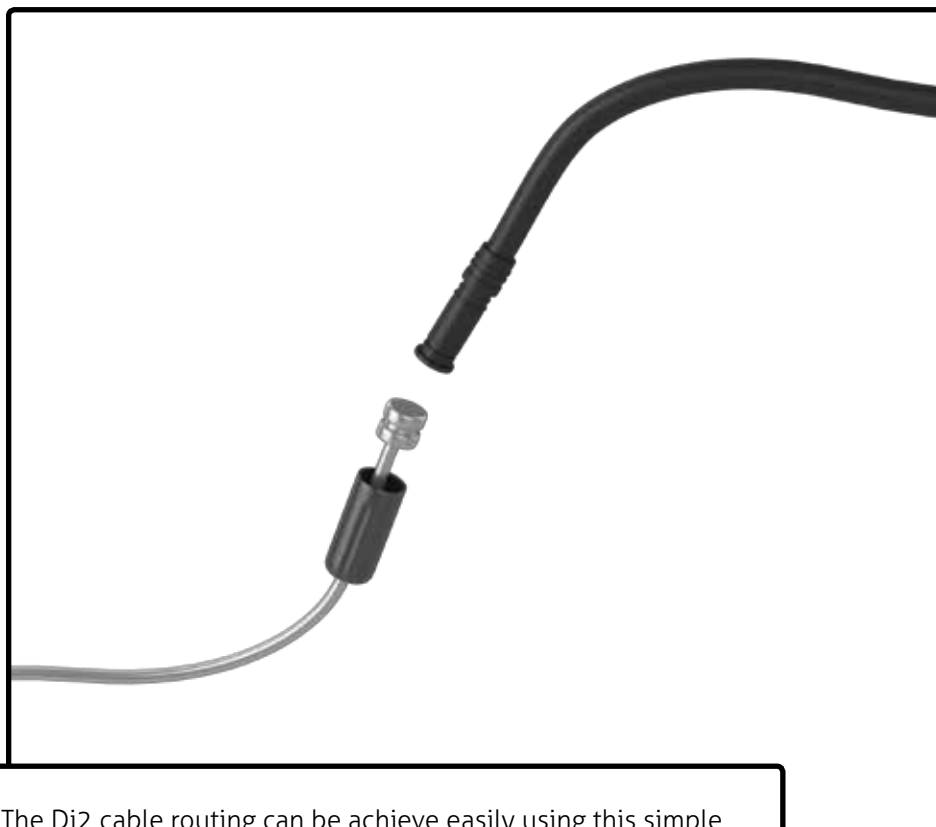

The Di2 cable routing can be achieved easily using this simple trick: use a brake cable and a metal cable end to fix the Di2 cable. For more information on Shimano Di2 electronic system installation, go to : <http://si.shimano.com>.





Use the proper grommet on the top tube to fix the cable correctly (depending if you use electronic shifting or mechanical drive train).





The Di2 battery can go either under the left chainstay (Shimano SM-BTR1) or inside the seatpost (Shimano SM-BTR2) by using the Di2 battery older (30). For this configuration, apply a slight amount of grease on both parts.





Use the proper grommet for the front derailleur cable depending if you use mechanical (19b) or electronic drive train (19a).

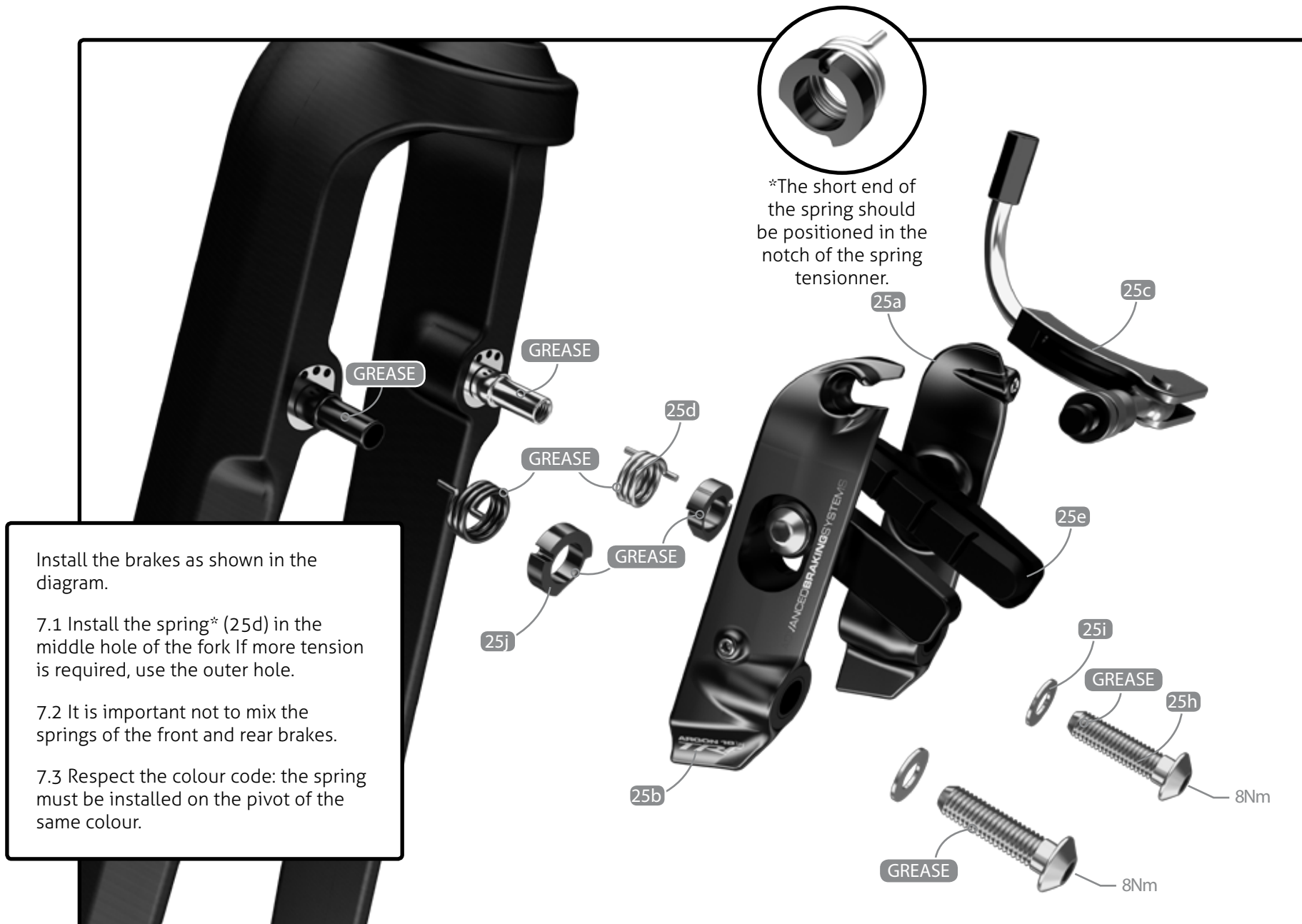



7.4 Adjust brake pads according to the width of your rims:

To install the cable/cable housing inside the head tube, the cable and cable housing must go through the front part of the frame

Pass the cable through the curved straw and then in the appropriate guide. Make sure that the length of the cable housing is sufficient for the guide to remain horizontal.

Fix the cable to the caliper with the 3mm screw and tighten it to 4Nm.





Adjust brake pads according to the width of your rims:

- You can configure the brake pad spacing with 1mm (25f), 2mm (25g) or no spacers behind the brake pads depending of the rim width you are using.

### Spacers required according to the rim width

Rim width	Spacer combinaison
19mm (ex.: Shimano C50)	2mm spacer
24mm (ex.: 808 clincher/Enve)	1mm spacer
26 to 27mm max (ex.: 808 TU/303 TU)	NO spacer



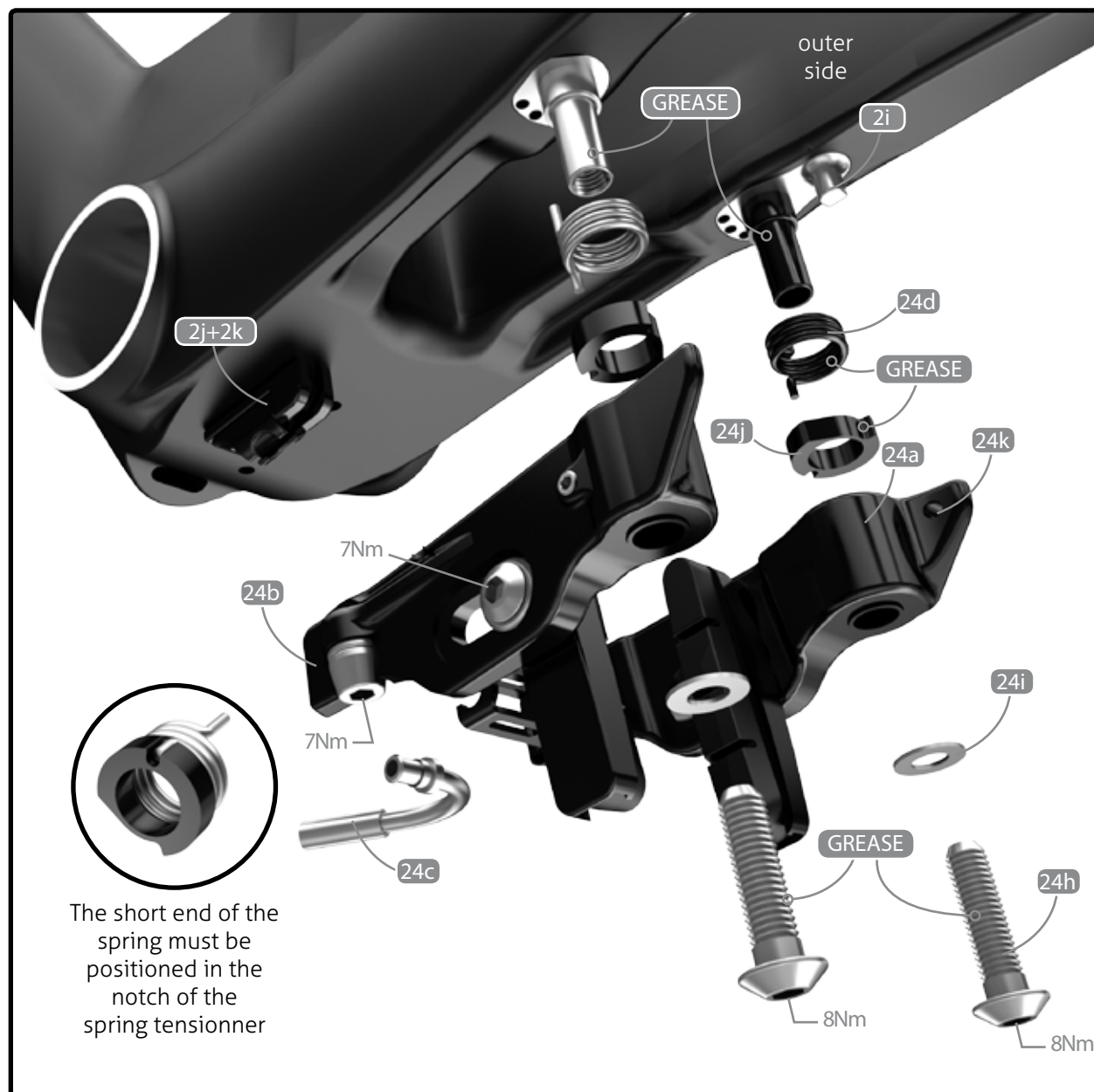

8.1 Remove the brake arm stopper (2i).

8.2 Install the brakes\* as shown in the diagram.

- Install the spring (24d) in the middle hole of the frame. To get more tension, use the outer hole.

\*Please note that it is easier to install the drive side brake arm if you do it before installing the crankset.

8.3 Install the brake arm stopper (2i) and adjust the set screw (24k) after the wheel is put in place to avoid any contact between the brake arm stopper and the crankset.

- It is important not to mix the springs of the front and rear brakes.

- Respect the colour code: the spring must be installed on the pivot of the same colour.





9.1 Install the adhesive Velcro on the armrests (10&11).

9.2 Screw the armrests (10&11) into the extension bar connector bridge (13) at 5Nm in the position desired. Reverse the left and the right armrests to obtain a more forward or backward setup.

9.3 Finish the assembly by installing the armrest pads (22).

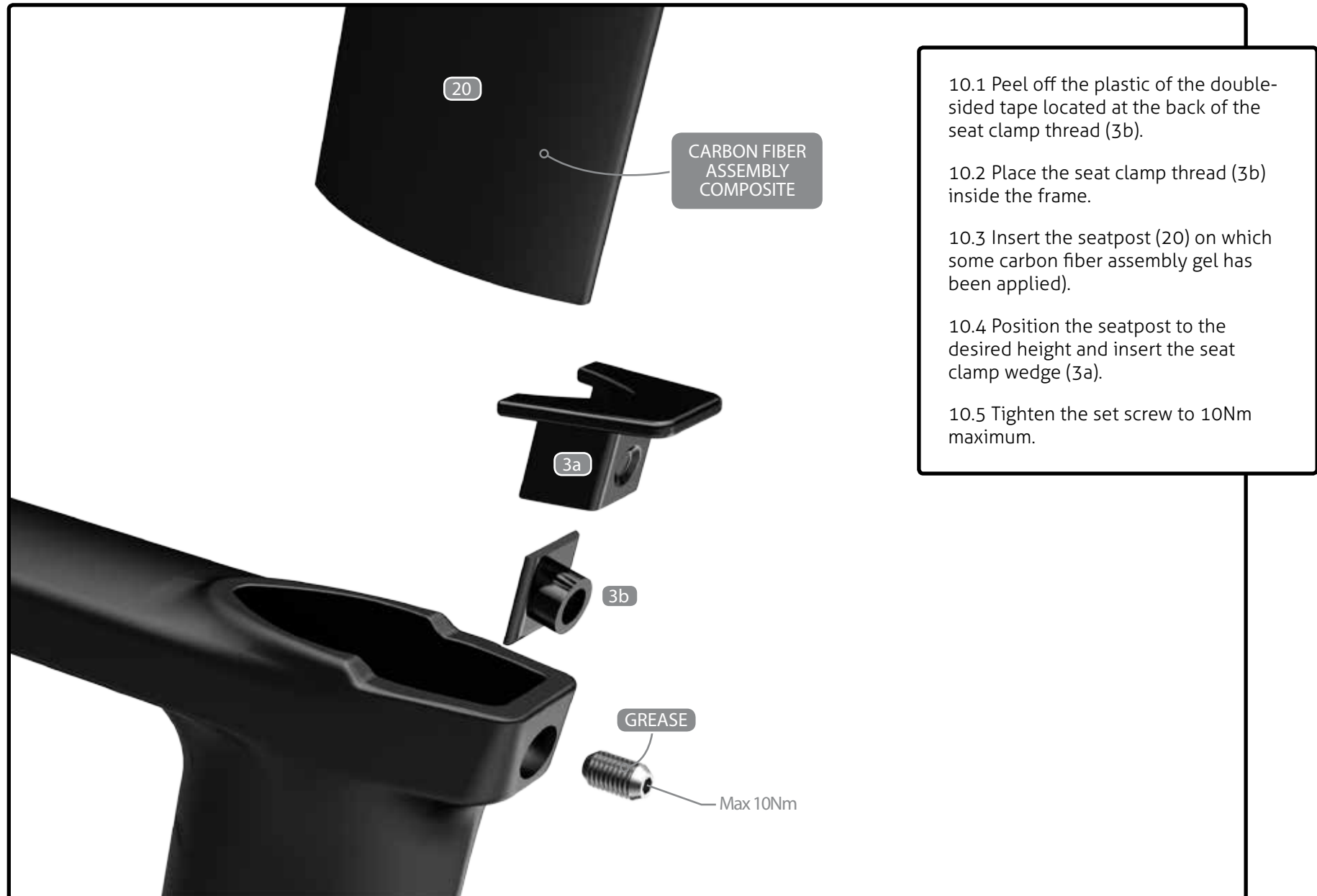



11.1 Install the saddle on the rocker (20f) and slightly tighten the rail clamp using a ball end hex key.

11.2 Tighten the upper screw of the rocker clamp (20a) by keeping a space of 2 to 3 mm between the aluminum and carbon parts.

11.3 Adjust the angle of the saddle and tighten the lower screw of the rocker clamp (20b).

11.4 Adjust the saddle offset and finish tightening of the rail clamp (20c).



The 2waypost ASP-7500 can be flipped to achieve a triathlon or a road position (75°/78°).

The seat clamp offset can be set by flipping the rail clamp (20d) and the rocker (20f).

Road : -10mm to -15mm

Tri : +10mm to 15mm



The front derailleur hanger can be adjusted according to the front derailleur angle to get an equal curve between the derailleur and the big chain ring. Once at the right angle, use blue 242 Loctite and screw in at 6Nm.

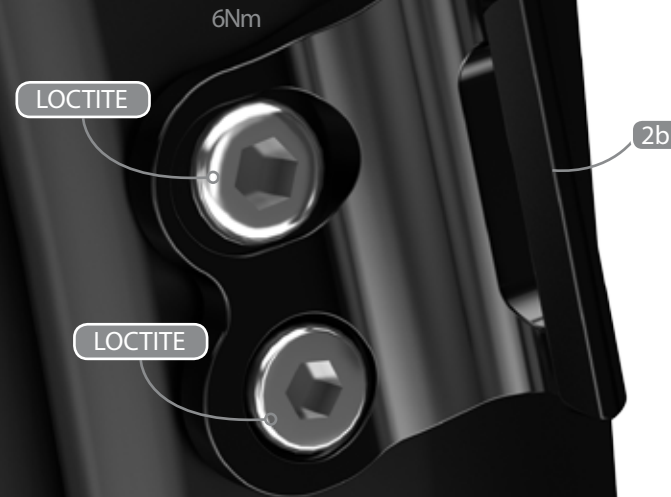

# ARGON 18

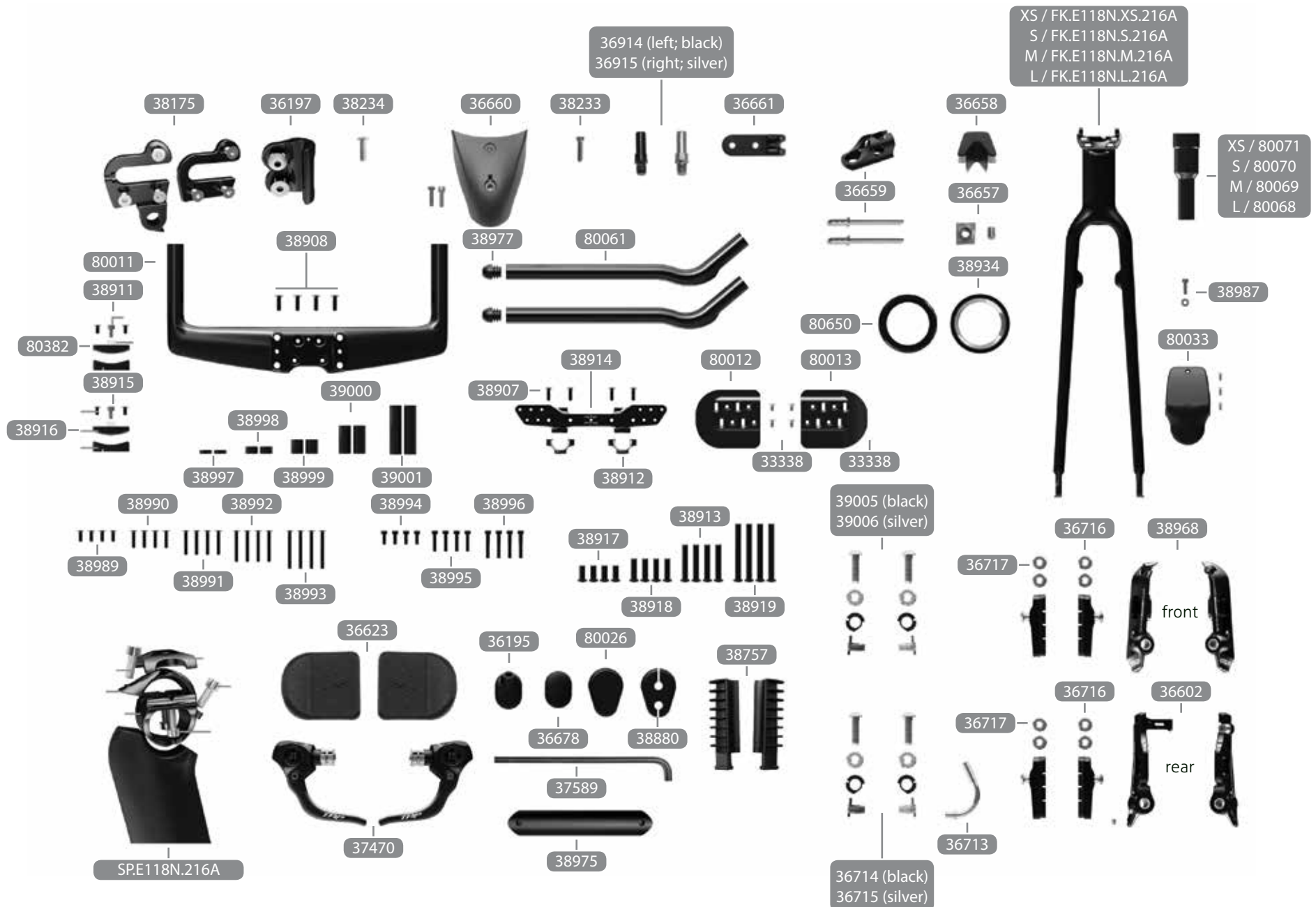

31





No.	Name	Assembled on	A18 SKU#	Qty
<b>Parts already assembled</b>				
2a	Rear Derailleur Hanger Assembly	Frame	38175	1
2b	Front Derailleur Hanger Assembly	Frame	36197	1
2d	Bottle Cage Screws	Frame	38234	5
2e	Bottom Bracket Cover (incl. screws)	Frame	36660	1
2f	Di2 Battery Mount Screw	Frame	38233	2
2g	Front Brake Pivot	Fork	36914 (left; black)	1
			36915 (right; silver)	1
2h	Rear Brake Pivot	Frame	36914 (left; black)	1
			36915 (right; silver)	1
2j	Front Derailleur Cable Guide Base	Frame	36661	1
2k	Front Derailleur Cable Guide (incl. rivets)	Frame	36659	1
<b>Parts</b>				
1	E-118 NEXT Frame	-	-	1
4a	E-118 NEXT Fork	-	(XS) FK.E118N.XS.216A (S) FK.E118N.S.216A (M) FK.E118N.M.216A (L) FK.E118N.L.216A	1
4b	E-118 NEXT Steerer	-	(XS) 80071	1
		-	(S) 80071	
		-	(M) 80069	
		-	(L) 80068	
20	E-118 NEXT Seatpost Assembly	-	SPE118N.216A	1
3a	Seat Post Clamp Wedge	Frame	36658	1
3b	Seat Post Clamp Nut and Screw	Frame	36659	1
4c	Stem Clamp Screw (incl. washer)	Fork	38987	1

\*Except for the frame itself, which is not sold as a spare part, all parts can be ordered by referring to their respective SKU number.



No.	Name	Assembled on	A18 SKU#	Qty
<b>Parts</b>				
4d	Stem Cap (incl. screw)	Fork	80033	1
5	Handle Bar	Fork	80011	1
6	Handle Bar Fixing Screws	Fork	38908	4
7	Bottom Bracket Cover (incl. screws)	Handle Bar	80061	2
8	Extension Bar Connector Base	Handle Bar	38912	2
9	Extension Bar Connector Bridge	Handle Bar	38914	1
10	Right Armrest	Handle Bar	80013	1
11	Left Armrest	Handle Bar	80012	1
12	Armrest Screws (M5x10mm)	Handle Bar	33338	4
13	Extension Bar Connector Bridge Screws (M5x18mm)	Handle Bar	38907	4
14a	Swivel Top Bracket	Handle Bar	38915	2
14b	Swivel Lower Bracket	Handle Bar	38916	2
14c	Swivel Screw (M6x12mm)	Handle Bar	38911	2
14e	Swivel Square Nut	Handle Bar	80382	2
15a	20mm Sleeve Nut	Handle Bar	38917	4
15b	30mm Sleeve Nut	Handle Bar	38918	4
15c	50mm Sleeve Nut	Handle Bar	38913	4
15d	80mm Sleeve Nut	Handle Bar	38919	4
16a	Extension Bar Connector Screw (M5x15mm)	Handle Bar	38989	4
16b	Extension Bar Connector Screw (M5x25mm)	Handle Bar	38990	4
16c	Extension Bar Connector Screw (M5x35mm)	Handle Bar	38991	4
16d	Extension Bar Connector Screw (M5x45mm)	Handle Bar	38992	4
16e	Extension Bar Connector Screw (M5x55mm)	Handle Bar	38993	4
16f	M5x15mm Screw	Handle Bar	38994	4
16g	M5x25mm Screw	Handle Bar	38995	4
16h	M5x35mm Screw	Handle Bar	38996	4
17a	5mm Spacer	Handle Bar	38997	2
17b	10mm Spacer	Handle Bar	38998	2
17c	20mm Spacer	Handle Bar	38999	2
17d	40mm Spacer	Handle Bar	39000	2



No.	Name	Assembled on	A18 SKU#	Qty
<b>Parts</b>				
17e	70mm Spacer	Handle Bar	39001	2
18	Swivel Connector Screw	Handle Bar	39002	4
19a	Front Derailleur Di2 Grommet	Frame	36195	2
19b	Plug	Frame	36678	2
19c	Top Tube Di2 Grommet	Frame	80026	1
19d	Top Tube Cable Grommet	Frame	38880	1
21	4mm Allen Key	-	37589	1
22	Armrest Pads	Handle Bar	36623	1 set
23	Tektro RL977 Brake levers	Handle Bar	37470	1 set
24	Rear Brake (TKB77) (incl. all hardware)	Frame	36602	1 set
24c	Rear Brake Noodle (125 degrees)	-	36713	1
24d	Springs	-	36714 (black)	1
			36715 (silver)	1
24f	2mm Pad Spacer	-	36717	2
24g	1mm Pad Spacer	-	36716	2
25	Front Brake (TKB150) (incl. all hardware)	Fork	38968	1 set
25c	Front Brake Noodle (97 degrees)	-	39004	1
25d	Springs	-	39005 (black)	1
			39006 (silver)	1
26	Headset Lower Bearing	Fork	38934	1
27	Headset Top Bearing	Fork	80650	1
28	3D Headset Tool	-	36165	1
29	Computer Mount	Handle Bar	38975	1
30	Internal Di2 Battery Support	Seatpost	38757	1 set