



Assembly overview.....	2-4
1. Frame inspection.....	5
2. Fork installation.....	6-7
3. Handlebar installation.....	8-12
4. Handlebar assembly.....	13-14
5. Cable housing installation.....	15-16
6. Electronic drive-train specification.....	17-20
7. Front brake installation.....	21-23
8. Rear brake installation.....	24-25
9. Armrest assembly.....	26
10. Seatpost installation.....	27
11. Saddle adjustment.....	28-29
12. Derailleur hanger adjustment.....	30
13. Parts listing.....	31-40

For the warranty to be valid, the bicycle must be fully assembled by an authorized Argon 18 dealer. High end components, particularly carbon parts, need extra care when assembled. Those components must be installed using a calibrated torque wrench to make sure every bolt is at the right torque setting to prevent damage.



1. Frame inspection



2. Fork installation



3. Handlebar installation



4. Handlebar assembly



5. Cable housing installation

IMPORTANT NOTICE: It is easier to install the cables and cable housings before the bearings.



6. Electronic drive-train specification



7. Front brake installation



8. Rear brake installation



9. Armrest assembly



10. Seatpost installation



11. Saddle adjustment



12. Derailleur hanger adjustment

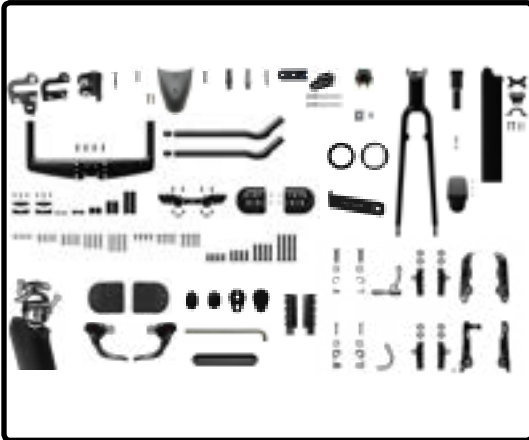

13. Parts listing



When assembling a new frame, be sure to check if the following parts are assembled correctly.

Parts installed on the frame Description			Screw type	Tork Nm	Detail
1	Front derailleur hanger	Screw (2)	3mm	4Nm	Loctite
2	Rear derailleur hanger	Screw (2)	3mm	4Nm	Loctite
3	Bottle cage	Screw (4)	4mm	3Nm	Grease
4	Bottom bracket cover	Screw (2)	5mm	2Nm	Grease





2.3 Slightly unscrew the steering column set screw (4c) located on the fork.

2.4 Screw in the compression column (4b) (specific to the size of your frame) inside the head tube. The threads must be lightly greased until the compression column can be inserted smoothly and tightly.

2.5 Screw in the safety screw (4c) at 6Nm.



3.1 Choose the desired position of the handlebar: high (+ 2.5cm) or low (- 2.5cm).

3.2 Apply grease on the 4 screws (6) (M6x22mm) and tighten them at 6Nm in an alternate way.

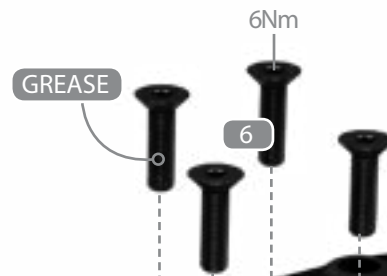



3.3 Install vertical spacers (17) and two sleeve nuts (15).

See next page for stack configuration options.





Parts needed to adjust pads stack's height

Total stack height (mm)	0	5	10	15	20	25	30
WITH SWIVEL							
Required spacer	X	X	X	X	None	5	10
Sleeve nut					20mm	20mm	30mm
Screw (flat head)					15mm	15mm	15mm

WITHOUT SWIVEL

Required spacer	None	5	10	5 + 10	20	5 + 20	10 + 20
Sleeve nut	20mm	20mm	30mm	30mm	30mm	30mm	50mm
Screw (flat head)	15mm	15mm	15mm	15mm	25mm	25mm	15mm

Total stack height (mm)	35	40	45	50	55	60	65
WITH SWIVEL							
Required spacer	5 + 10	20	5 + 20	10 + 20	5 + 10 + 20	40	5 + 40
Sleeve nut	30mm	30mm	30mm	50mm	50mm	50mm	50mm
Screw (flat head)	15mm	25mm	25mm	15mm	15mm	25mm	25mm

WITHOUT SWIVEL

Required spacer	5 + 10 + 20	40	5 + 40	10 + 40	5 + 10 + 40	20 + 40	5 + 20 + 40
Sleeve nut	50mm	50mm	50mm	50mm	50mm	80mm	80mm
Screw (flat head)	15mm	25mm	25mm	35mm	35mm	15mm	15mm

Total stack height (mm)	70	75	80	85	90	95	100
WITH SWIVEL							
Required spacer	10 + 40	5 + 10 + 40	20 + 40	5 + 20 + 40	70	5 + 70	10 + 70
Sleeve nut	50mm	50mm	80mm	80mm	80mm	80mm	80mm
Screw (flat head)	35mm	35mm	15mm	15mm	25mm	25mm	35mm

WITHOUT SWIVEL

Required spacer	70	5 + 70	10 + 70	5 + 10 + 70	20 + 70	5 + 20 + 70	10 + 20 + 70
Sleeve nut	80mm	80mm	80mm	80mm	80mm	80mm	80mm
Screw (flat head)	25mm	25mm	35mm	35mm	45mm	45mm	55mm

Notes:

- Always place the smaller spacers underneath
- Make sure you have at least 6 full threads on each screw
- Every spacer screw must be tightened to 5Nm
- The M6 screw (5mm allen key) that enables the swivel adjustment must be tightened to 8Nm
- The screws linking the extension connectors to the swivel are 12mm long (M5 flat head)



3.4 For an inclined position, use the swivel assembly (14).

STEP 1 : Swivel assembly content:

- 1- Connector base (8)
- 2- Swivel spacer (14a + 14b)
- 3- Swivel screw (14c)
- 4- Swivel square nut (14e)

Assemble the unit and leave it unscrewed, just enough to allow adjustment and also allow to turn the swivel 90 degrees to have access to the bottom hole to fix the flat head screw at 6Nm. Once the proper angle is set, use a marker to obtain a reference and adjust both spacers with same angle. Use the Di2 hole as a starting point.

Fix the 6mm flat head of the swivel screw (silver) to 8Nm.

STEP 2 :

The connector base must be fixed to the top of the swivel assembly, not on the sleeve nuts. The sleeve nuts will be used to fix the spacers later.

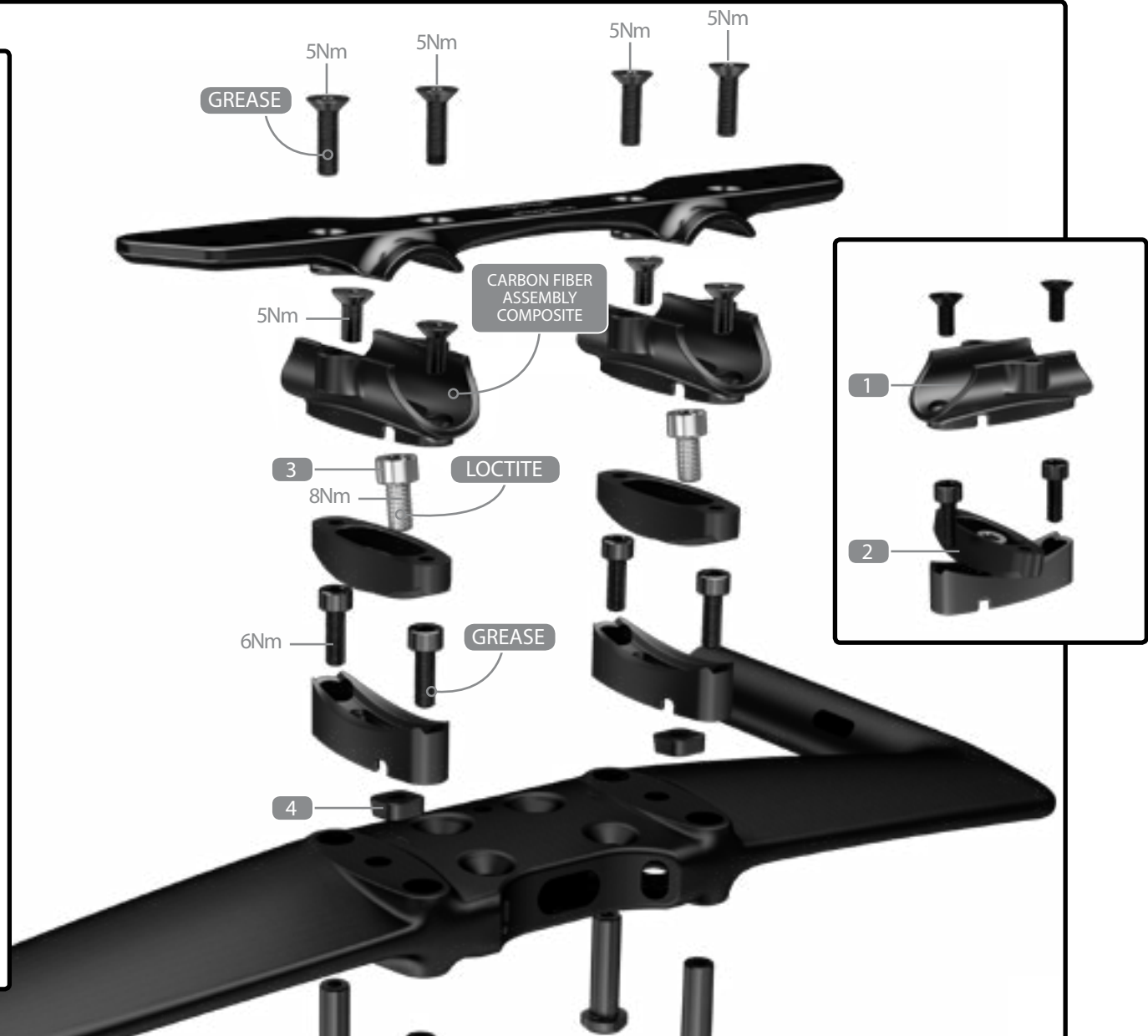

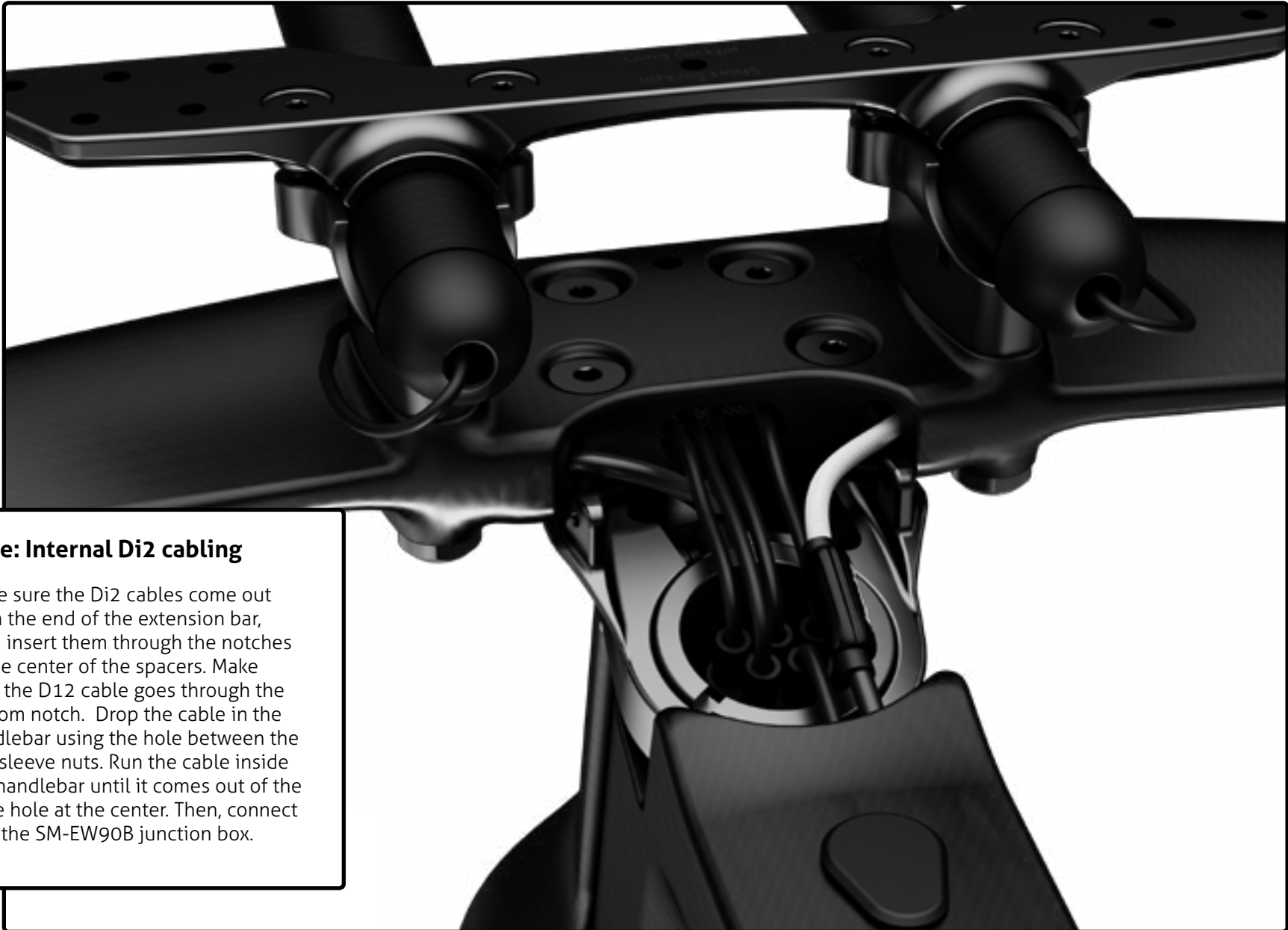
**Note: Internal Di2 cabling**

Make sure the Di2 cables come out from the end of the extension bar, then insert them through the notches at the center of the spacers. Make sure the D12 cable goes through the bottom notch. Drop the cable in the handlebar using the hole between the two sleeve nuts. Run the cable inside the handlebar until it comes out of the large hole at the center. Then, connect it to the SM-EW90B junction box.



4.1 Cut the extension bars (7) at the desired length to obtain a straight post*. The bars must not exceed 285mm in length. **The cut must be made on the elbow side.** The other end of the bar is used exclusively to install the shifter. Apply some carbon fiber assembly gel in the clamping area.

***Warning: If using a ski bent section, no more than 40mm can be cut out.**

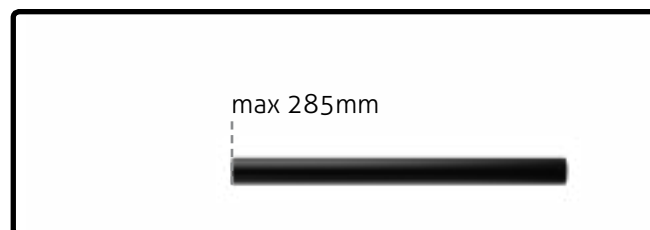
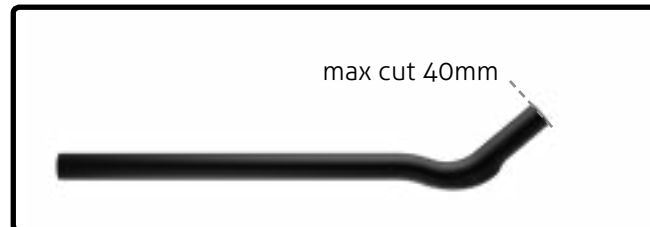

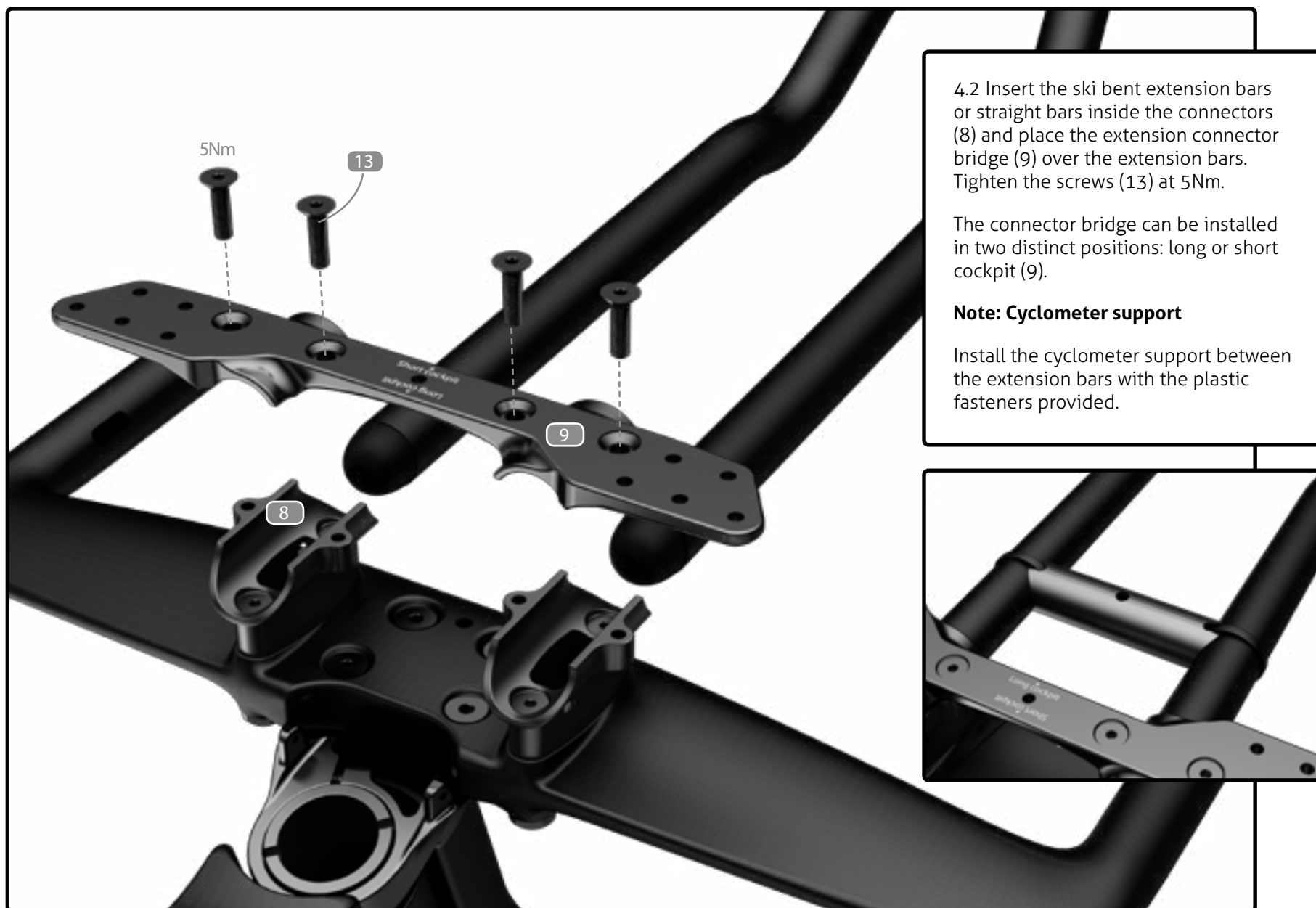

4.2 Insert the ski bent extension bars or straight bars inside the connectors (8) and place the extension connector bridge (9) over the extension bars. Tighten the screws (13) at 5Nm.

The connector bridge can be installed in two distinct positions: long or short cockpit (9).

Note: Cyclometer support

Install the cyclometer support between the extension bars with the plastic fasteners provided.

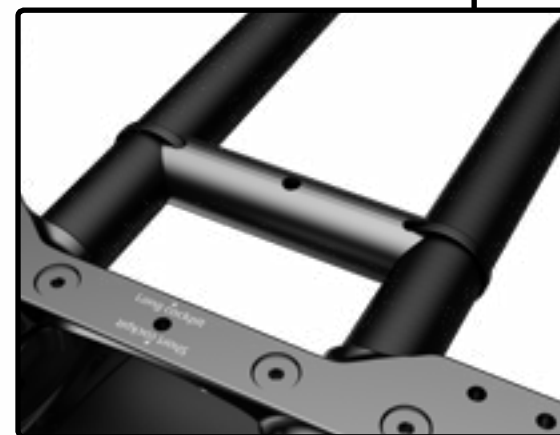

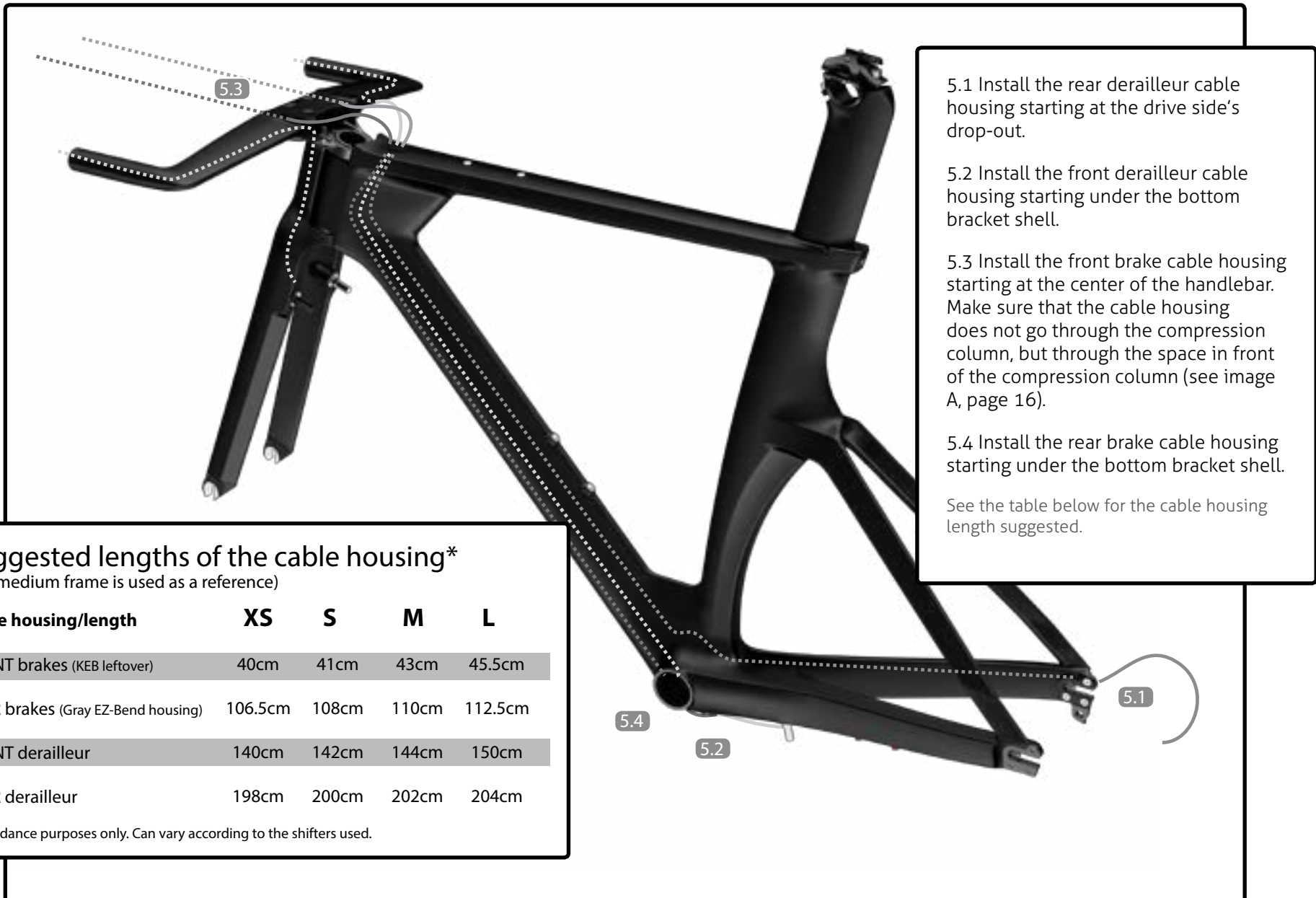

5.1 Install the rear derailleur cable housing starting at the drive side's drop-out.

5.2 Install the front derailleur cable housing starting under the bottom bracket shell.

5.3 Install the front brake cable housing starting at the center of the handlebar. Make sure that the cable housing does not go through the compression column, but through the space in front of the compression column (see image A, page 16).

5.4 Install the rear brake cable housing starting under the bottom bracket shell.

See the table below for the cable housing length suggested.

Suggested lengths of the cable housing*

(the medium frame is used as a reference)

Cable housing/length	XS	S	M	L
FRONT brakes (KEB leftover)	40cm	41cm	43cm	45.5cm
REAR brakes (Gray EZ-Bend housing)	106.5cm	108cm	110cm	112.5cm
FRONT derailleur	140cm	142cm	144cm	150cm
REAR derailleur	198cm	200cm	202cm	204cm

* For guidance purposes only. Can vary according to the shifters used.



Note: To make the brake cable housing go inside the handlebar more easily, use a brake cable as a guide and insert it head first (from the middle of the handlebar towards the brake lever) using one of the two side holes. Follow the curves of the handlebar. Once the cable is out, slide the cable housing along.

IMPORTANT : You must cut the metal ferrule located at the end of the rear brake EZ-Bend cable housing prior to install it correctly on the rear brake barrel adjuster.

A



Mechanical drive-train configuration

B



Electronic drive-train configuration

C

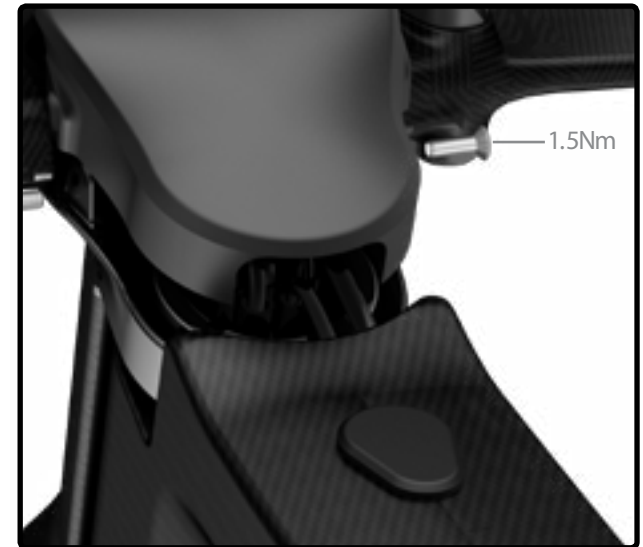

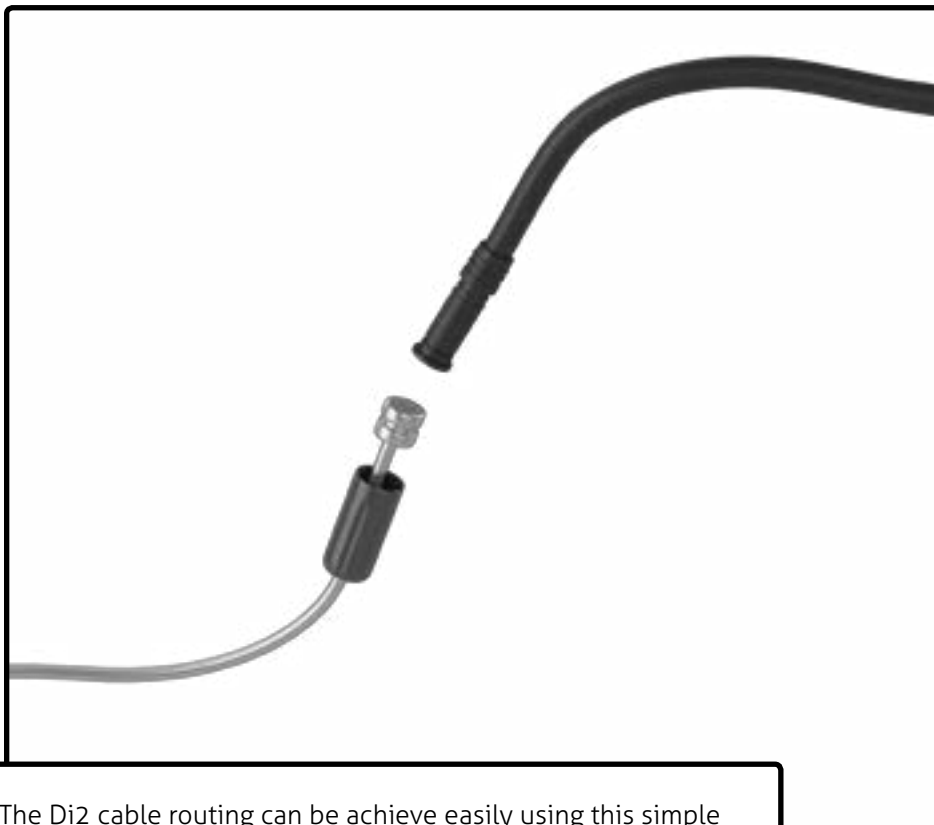

The Di2 cable routing can be achieved easily using this simple trick: use a brake cable and a metal cable end to fix the Di2 cable. For more information on Shimano Di2 electronic system installation, go to : <http://si.shimano.com>.



Use the proper grommet on the top tube to fix the cable correctly (depending if you use electronic shifting or mechanical drive train).





The Di2 battery can go either under the left chainstay (Shimano SM-BTR1) or inside the seatpost (Shimano SM-BTR2) by using the Di2 battery older (30). For this configuration, apply a slight amount of grease on both parts.

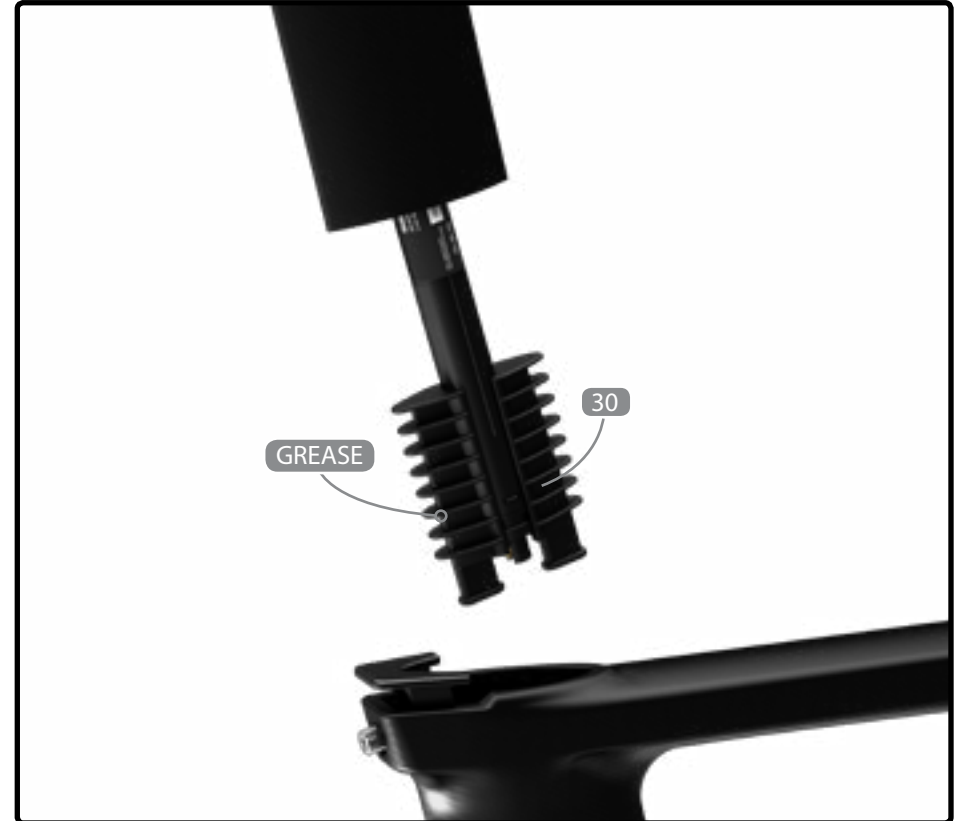



Use the proper grommet for the front derailleur cable depending if you use mechanical (19b) or electronic drive train (19a).

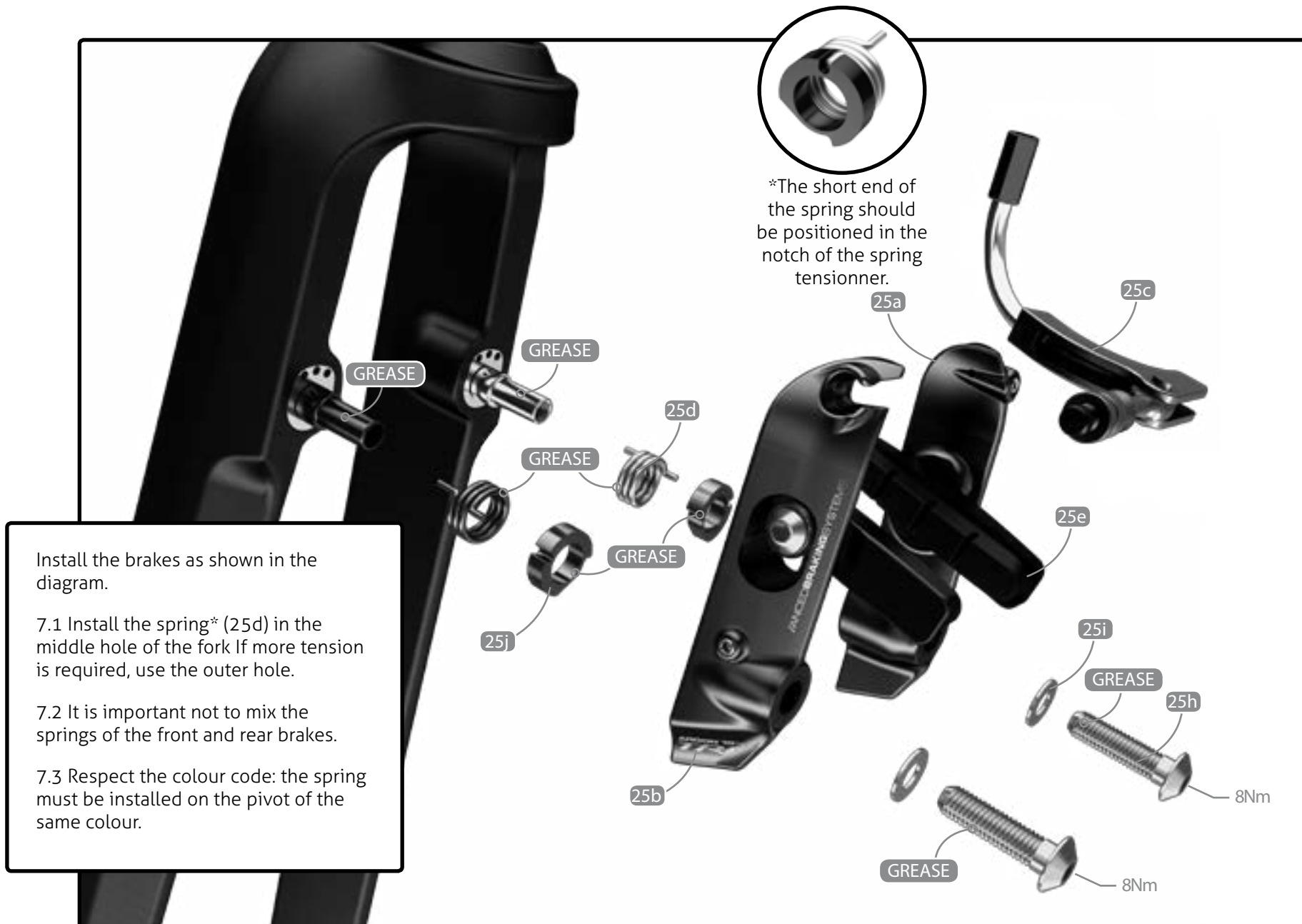



7.4 Adjust brake pads according to the width of your rims:

To install the cable/cable housing inside the head tube, the cable and cable housing must go through the front part of the frame

Pass the cable through the curved straw and then in the appropriate guide. Make sure that the length of the cable housing is sufficient for the guide to remain horizontal.

Fix the cable to the caliper with the 3mm screw and tighten it to 4Nm.





Adjust brake pads according to the width of your rims:

- You can configure the brake pad spacing with 1mm (25f), 2mm (25g) or no spacers behind the brake pads depending of the rim width you are using.

Spacers required according to the rim width

Rim width	Spacer combinaison
19mm (ex.: Shimano C50)	2mm spacer
24mm (ex.: 808 clincher/Enve)	1mm spacer
26 to 27mm max (ex.: 808 TU/303 TU)	NO spacer

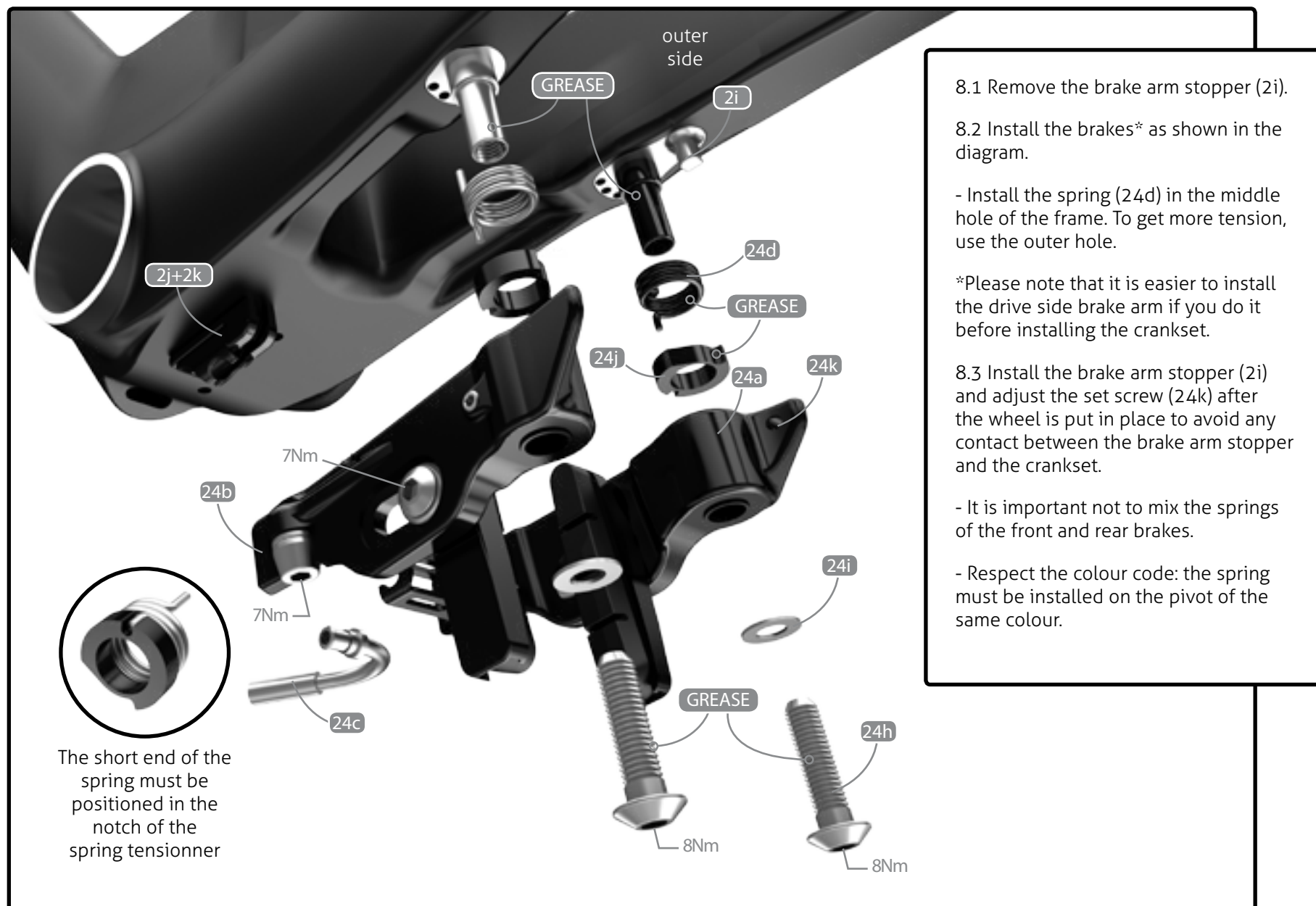





9.1 Install the adhesive Velcro on the armrests (10&11).

9.2 Screw the armrests (10&11) into the extension bar connector bridge (13) at 5Nm in the position desired. Reverse the left and the right armrests to obtain a more forward or backward setup.

9.3 Finish the assembly by installing the armrest pads (22).

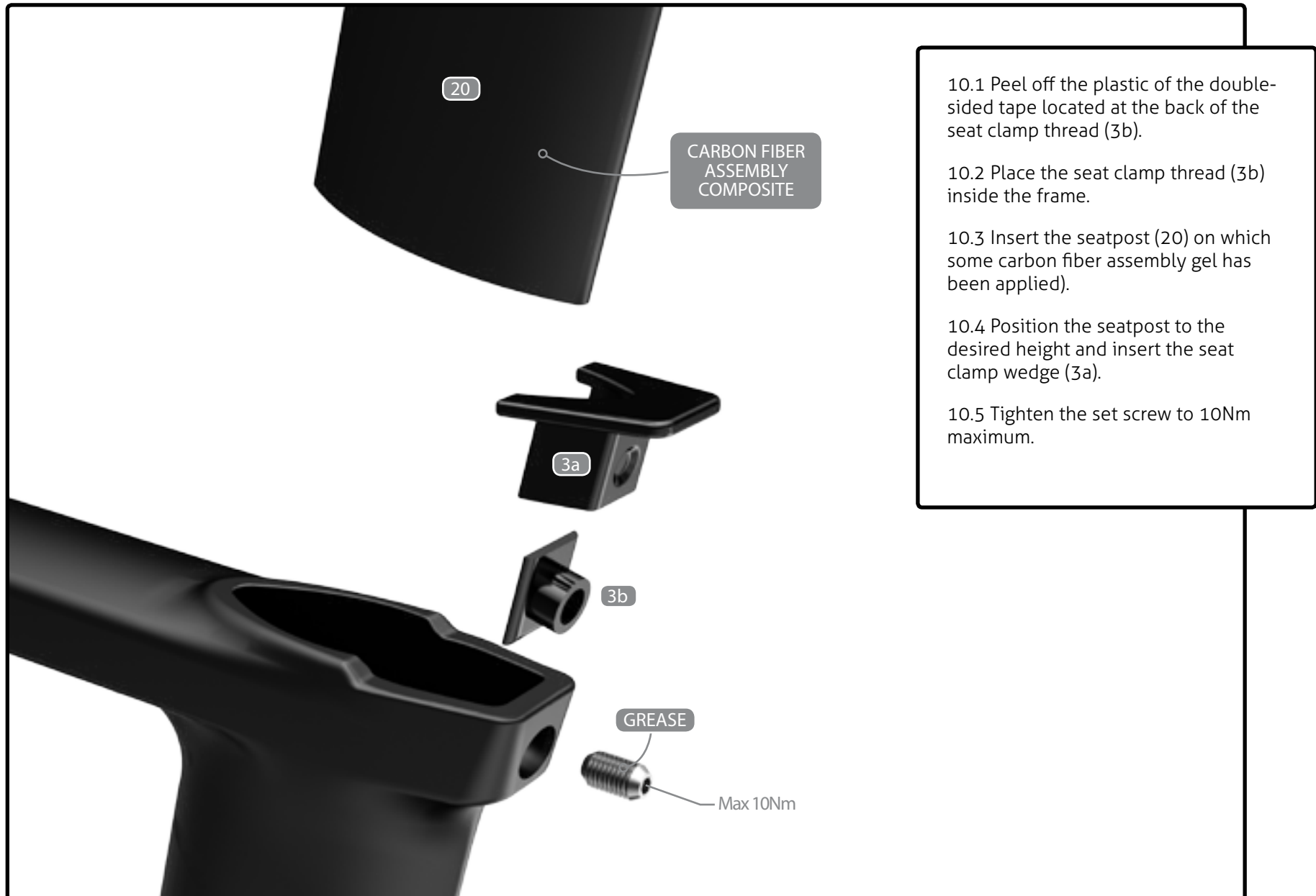



11.1 Install the saddle on the rocker (20f) and slightly tighten the rail clamp using a ball end hex key.

11.2 Tighten the upper screw of the rocker clamp (20a) by keeping a space of 2 to 3 mm between the aluminum and carbon parts.

11.3 Adjust the angle of the saddle and tighten the lower screw of the rocker clamp (20b).

11.4 Adjust the saddle offset and finish tightening of the rail clamp (20c).



The 2waypost ASP-7500 can be flipped to achieve a triathlon or a road position (75°/78°).

The seat clamp offset can be set by flipping the rail clamp (20d) and the rocker (20f).

Road : -10mm to -15mm

Tri : +10mm to 15mm





The front derailleur hanger can be adjusted according to the front derailleur angle to get an equal curve between the derailleur and the big chain ring. Once at the right angle, use blue 242 Loctite and screw in at 6Nm.

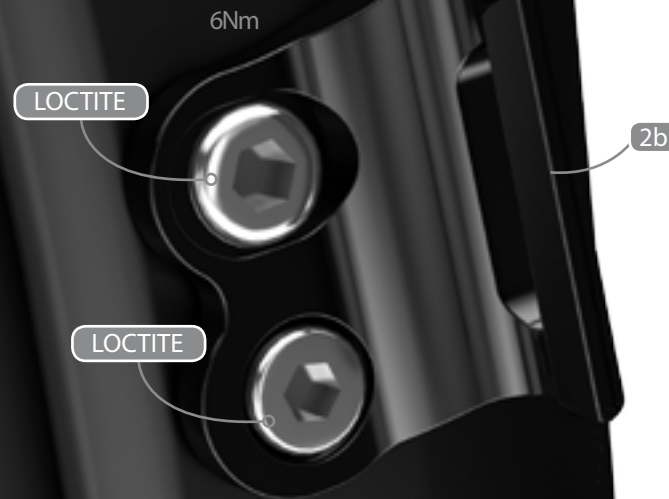

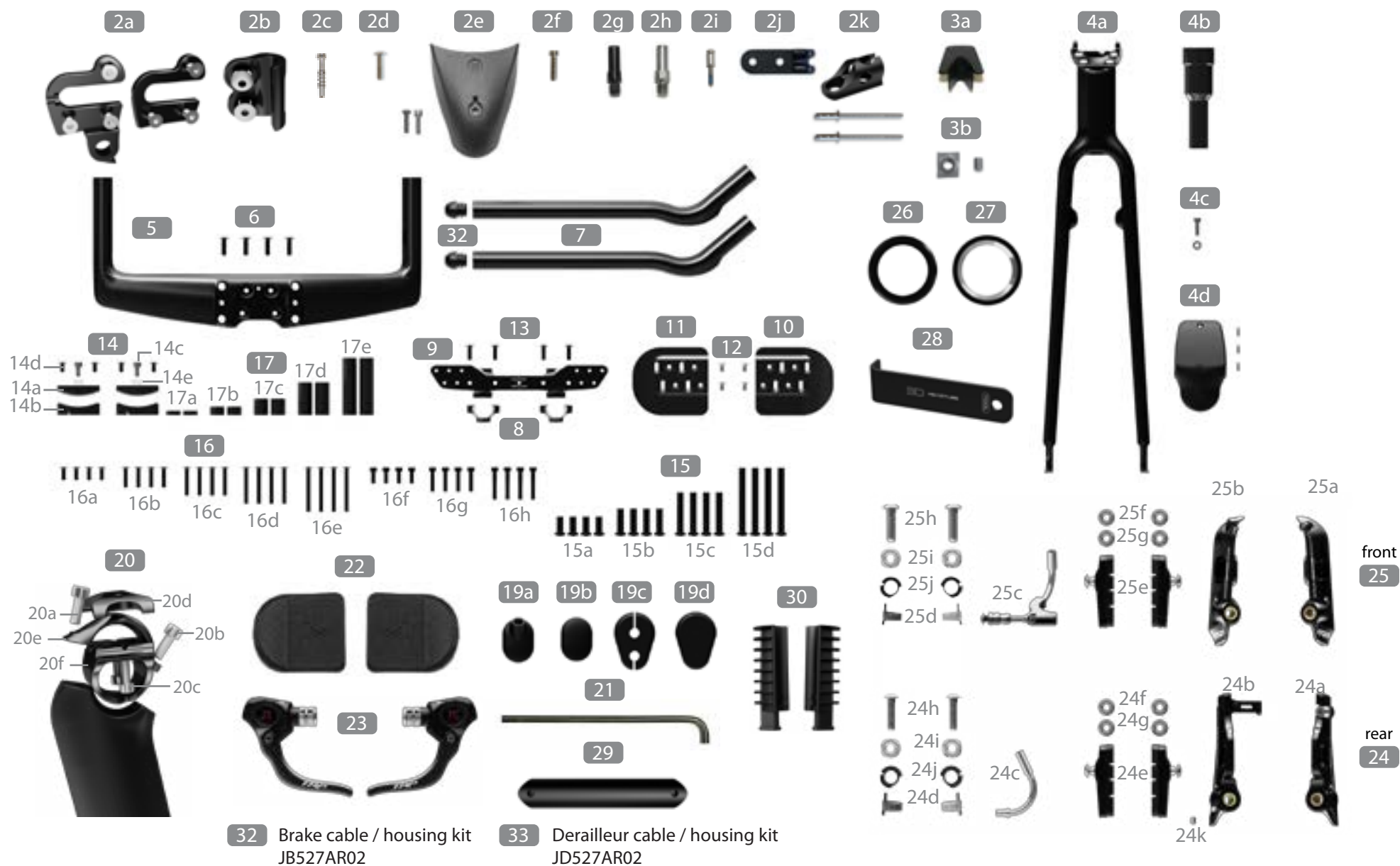



No #	Name Frameset parts	Supplier Description	Qty	SKU Comp	SKU Acc
1	E-118 frame	AR-TT05-UDG, artwork 216A, Black/red,matte/gloss			
# Parts installed on the frame					
2a	Rear derailleur hanger & rear drop out insert with screws	RD-127 & OS-203, rear derailleur hanger and rear drop out insert for AR-TT-03 & AR-TT-04, color: black, with flat head HexSocket screws (M4*7mm F)	1 set		38175
2b	Front derailleur hanger with screws - Model D	M-FD03 + flat head HexSocket screw (M5*16mm F)	1		36197
2c	Rear axle adjustment screws and springs	Round head Phillips screws (M3*20mm (+)) and springs (3.2*4.2*8mm)	2		
2d	Screw for water bottle cage	Stainless ButtonHead HexSocket screw (M5*16mm B) for bottle cages, M001E905038	5		38234
2e	Plastic BB cap with screws	OS-217 for TT05 & TT04 -BB plastic cap with ButtonHead HexSocket screw (M5*20mm B) and HexSocket screw (M5*16mm S)	1		36660
2f	Di2 battery mount screw	Lowhead HexSocket screw (M4*16mm S), M001E90408	2		38233
2g	Font brake pivot	BAP108-A (brake pivot for ARTT03-04), black BAP108-B (brake pivot for ARTT03-04), silver	1 black+silver		36914 (left; black) 36915 (right; silver)
2h	Rear brake pivot	BAP108-A (brake pivot for ARTT03-04), black BAP108-B (brake pivot for ARTT03-04), silver	1 black+silver		36914 (left; black) 36915 (right; silver)
2i	Brake arm stopper (M3 screw + Aluminium sleeve)	WSR-121 with round head Phillips screw (M3*20mm B(+))	1		
2j	Base of FD cable guide	OS-205, TT03 & TT04 -Base of FD cable guide	1		36661
2k	FD cable guide with rivets	611-105C-095HY, FD cable guide with rivets (3,2*12,5mm) for TT03 & TT04	1		36659



No #	Name Frameset parts	Supplier Description	Qty	SKU Comp	SKU Acc
------	---------------------	----------------------	-----	----------	---------

#	Seat clamp kit
---	----------------

3a	Seat clamp wedge	WD109 for TT03 & TT04 -Seat clamp wedge	1		36658
3b	Seat clamp thread with screw	OS-206 for TT03 & TT04 -Seat clamp thread with screw (M8*10mm) sku 33342	1		36657

#	Fork kit
---	----------

4a	E-118 Fork				1
	XS	AR-TT05FKF-UD-43-XS,artwork 216A-FK, Black/red, matte	38620	38742	*
	S	"AR-TT05FKF-UD-43-S,artwork 216A-FK, Black/red, matte"	38621	38743	*
	M	"AR-TT05FKF-UD-43-M,artwork 216A-FK, Black/red, matte"	38622	38744	*
	L	AR-TT05FKF-UD-43-L,artwork 216A-FK, Black/red, matte	38623	38745	*
4b	Steerer	This part is size specific, included when you buy a fork as component, Only 1 size per frameset			
	Steerer – XS	Steerer – XS		38896	
	Steerer – S	Steerer – S		38898	
	Steerer – M	Steerer – M		38900	
	Steerer – L	Steerer – L		38902	
4c	Stem clamp screw and washer	Socket Head screw (M5 x 15mm) + 8.5mm OD x 5mm ID		38987	1
4d	Stem cap with screw	HC-113 with Flat Head HexSocket screw (M3 x 10mm)	38903	38904	1



No #	Name Frameset parts	Supplier Description	Qty	SKU Comp	SKU Acc
# Handlebar kit					
5	TT05 Handle Bar		38905	38906	1
6	HB Screws	Flat head HexSocket screws(M6x22mm), grade 10.9 for handlebar		38908	4
7	TT05 extension bar	AR-TT05EB1-UD, carbon extension bar, black matte	38909	38910	2
8	TT05 extension conector base	OS-523, Extension connector base		38912	2
9	TT05 extension conector bridge	EC-103, Extension connector bridge		38914	1
10	E-118 armrest-Right	AR-TT03HS1-UD, Right Armrest for E-118	36540	36635	1
11	E-118 armrest-Left	AR-TT03HS2-UD, Left Armrest for E-118	36539	36634	1
12	Armrest screws	Flat head HexSocket screw (M5x10mm) for armrest		33338	4
13	Extension connector screw (bridge)	Flat head HexSocket screw (M5x18mm), grade 10.9 for extension connector screw (bridge)		38907	4
14	Swivel spacer				
14a	Swivel top bracket	OS-493, Swivel top bracket		38915	2
14b	Swivel bottom bracket	OS-494, Swivel bottom bracket		38916	2
14c	Swivel screw	Socket head screw (M6 x 12)		38911	2
14d	Extension connectors screw for swivel				
14e	Swivel square nut	NUT-137 swivel square nut for swivel brackets			
15	Sleeve Nut				
15a	Sleeve nut 20mm	NUT – 139 -20mm, Sleeve nut 20mm		38917	4
15b	Sleeve nut 30mm	NUT – 139 -30mm, Sleeve nut 30mm		38918	4
15c	Sleeve nut 50mm	NUT – 139 -50mm, sleeve nut 50mm		38913	4
15d	Sleeve nut 80mm	NUT – 139 -80mm, sleeve nut 80mm		38919	4



No #	Name Frameset parts	Supplier Description	Qty	SKU Comp	SKU Acc
#	Handlebar kit (continued)				
16	Extension connectors screws	grade 10.9 for extension connectors			
16a	M5x15mm	Flat head hex screw (M5x15mm)		38989	4
16b	M5x25mm	Flat head hex screw (M5x15mm)		38990	4
16c	M5x35mm	Flat head hex screw (M5x15mm)		38991	4
16d	M5x45mm	Flat head hex screw (M5x15mm)		38992	4
16e	M5x55mm	Flat head hex screw (M5x15mm)		38993	4
16f	M5x15mm	Socket head screw (M5x15mm)		38994	4
16g	M5x25mm	Socket head screw (M5x25mm)		38995	4
16h	M5x35mm	Socket head screw (M5x35mm)		38996	4
17					
17a	Extension spacer 5mm	WSR150-A, extension spacer 5mm		38997	2
17b	Extension spacer 10mm	WSR150-B, extension spacer 10mm		38998	2
17c	Extension spacer 20mm	WSR150-C, extension spacer 20mm		38999	2
17d	Extension spacer 40mm	WSR150-D, extension spacer 40mm		39000	2
17e	Extension spacer 70mm	WSR150-E, extension spacer 70mm		39001	2
18	Extension connectors screw for swivel	Flat head hex screw (M5x12mm) grade 10.9 for extension connectors screw for swivel		39002	4



No #	Name Frameset parts	Supplier Description	Qty	SKU Comp	SKU Acc
---------	------------------------	----------------------	-----	-------------	------------

Di2 configuration specific parts

19a	FD cable Di2 grommet	OS-106, grommet for AR-TT01 Di2 & AR-R02-Di2	2		36195
19b	Grommet plug for Di2 hole filler (non Di2)	OS-249, grommet plug for Di2 hole filler	2		36678
19c	HB Di2 holes cover	CCN009, TT05 HB Di2 holes cover	2		38980
19d	Top tube cable grommet (non Di2)	309030008, TT05	1		38979

Seat post with the following parts assembled

20	E-118 seatpost (ASP-7500)	AR-TT03-SP-UD-300, artwork 216ASP, Black,matte	1	38624	38746
20a	Upper HexSocket screw (M6*20mm S) for rocker clamp	M6*20 S	1		
20b	Lower HexSocket screw (M6*20mm S) for rocker clamp	M6*20 S	1		
20c	HexSocket screws (M5*20mm S)	M5*20 S	2		
20d	Top rail clamp	TT01-SP-top rail clamp	1		
20e	Rocker clamp	TT01-SP-rocker clamp (arc)	1		
20f	Rocker	TT01-SP-rocker	1		

Additional parts

21	4mm allen key for brake adjustment	AR-TT03 L wrench, CR-V, ball point hex key long metric, 4mm (M4*106mm)	1		37589
----	---------------------------------------	---	---	--	-------



No #	Name Frameset parts	Supplier Description	Qty	SKU Comp	SKU Acc
#	Also included with the frameset - shipped separately				
22	Armrest foam pads	Armrest pads, FC59-1 with molecule embossed logo 2012 MY new armrest pads for E-118	1 set (left+right)	36623	36641
23	RL977 brake levers	RL977 alloy lever for triathlon & time trial bikes, black finish, stainless steel hardware	1 pair	37470	37580
24	TKB77 rear brake			36602	36630
	<i>including the following parts</i>				
24a	Brake Arm right	TKB78	1		
24b	Brake Arm left	TKB78	1		
24c	Tektro rear brake noodle (125 degrees)	Tektro rear brake noodle for TKB77 & TKB78 brakes, 0062TB33491B1	1		36713
24d	• Springs	Insert spring black, 0054TB0117U for TKB77 & TKB78 brakes			36714 (black)
		Insert spring silver, 0054TV0117U for TKB77 & TKB78 brakes	1 black+silver		36715 (silver)
24e	• Brake pad – P963.12 for alloy rim			2	
24f	• 2mm spacer for TKB77 & TKB78 brakes	2mm spacer for TKB77 & TKB78 brakes	2		36717
24g	• 1mm spacer for TKB77 & TKB78 brakes	1mm spacer for TKB77 & TKB78 brakes	2		36716
24h	• Pivot bolts		2		
24i	• Pivot washer		2		
24j	• Spring tensionner		2		
24k	adjustments set screw				



No #	Name Frameset parts	Supplier Description	Qty	SKU Comp	SKU Acc
#	Also included with the frameset - shipped separately				
25	TKB150 front brake			38968	38981
	<i>including the following parts</i>				
25a	Brake Arm right	TKB78	1		
25b	Brake Arm left	TKB150	1		
25c	Tektro front brake noodle assembly (97 degree)				
		Tektro front brake noodle for TKB150, 0062B1500S	1		39004
25d	Springs				
		Insert spring black, 0054TV0517U for TKB150	1		39005
		Insert spring silver, 0054TV0526B, for TKB 150	1		39006
25e	Brake pad P961.11 for alloy rim		2		
25f	1mm spacer for TKB150 brake	1mm spacer for TKB150 brake	2		39007
25g	2mm spacer for TKB150 brake	2mm spacer for TKB150 brake	2		39008
25h	Pivot Bolt		2		
25i	Pivot Bolt washer		2		
25j	Spring tensionner		2		



No #	Name Frameset parts	Supplier Description	Qty	SKU Comp	SKU Acc
---------	------------------------	----------------------	-----	-------------	------------

#	Also included with the frameset - shipped separately				
---	--	--	--	--	--

26	Headset bottom bearing	MR122, TT05 headset bottom bearing, 1 1/8"	1	38966	38967
27	Headset top bearing	MR136, TT05 headset top bearing, 1 1/4"	1	38964	38965
28	3D headset tool	3D head tube tool, 2012 w/3D head tube logo, with hole, width 33.5mm	1		36718
29	Computer mount	E0424, glass fiber with UD layer on top w/2 zip ties matte, clearcoated w/o logo & decal		38975	38976
30	Di2 battery holder for Aero SP	407100005, Di2 battery holder for Aero SP	2	38757	38758
31	Bar end plug		2		



No #	Name Frameset parts	Supplier Description	Qty	SKU Comp	SKU Acc
---------	------------------------	----------------------	-----	-------------	------------

#	Also Included with the frameset - shipped separately				
---	--	--	--	--	--

32	Brake cable / housing kit <i>including the following parts</i>	JB527AR02			
32a	Housing 5mmKEB-SL	black #07, 1.20m for rear brake	1		
32b	Housing 5mmCGX-SL	EZ Bend black #07, 0.70m for front brake			
32c	End caps	CC715BJ, alloy black anodized for front and rear brake lever	2		
32d	End caps	CM029BJ, POP open end cap black	1		
32e	End caps	CC715BJ, alloy black anodized for rear brake housing	2		
32f	Cable	STS (slick-stainless) / 1,5mm	2		
32g	Barrel adjuster	CM265BJ, for front and rear brake	2		
32h	EZ Bend Housing	CM063-1, for rear brake	1		
33	Derailleur cable / housing kit <i>including the following parts</i>	JD527AR02			
33a	Housing LEX40-SL	Black #07, 3.5m	1		
33b	End caps	CC464BJ, alloy ferrule, black, for derailleur housing lever end	2		
33c	End caps	CC464BJ, alloy ferrule, black, for derailleur housing bottom section	2		
33d	Cable	STS (slick-stainless) / 1.1mm			
33e	Barrel adjuster	CM233-1BJ, for front and rear derailleur	2		