





Assembly overview.....	2
1. Frame inspection.....	3
2. Cable housing installation.....	4-7
3. Brakes installation.....	8-9
4. Seatpost installation.....	10
5. Saddle adjustment.....	11-12
6. Parts listing.....	13-15

For the warranty to be valid, the bicycle must be fully assembled by an authorized Argon 18 dealer. High-end components, particularly carbon parts, need extra care when assembled. Those components must be installed using a calibrated torque wrench to make sure every bolt is at the right torque setting to prevent damage.



1. Frame inspection



2. Cable housing installation

IMPORTANT NOTICE: It is easier to install the cables and cable housings before the bearings.



3. Brake installation



4. Seatpost installation



5. Saddle adjustment







6. Parts listing

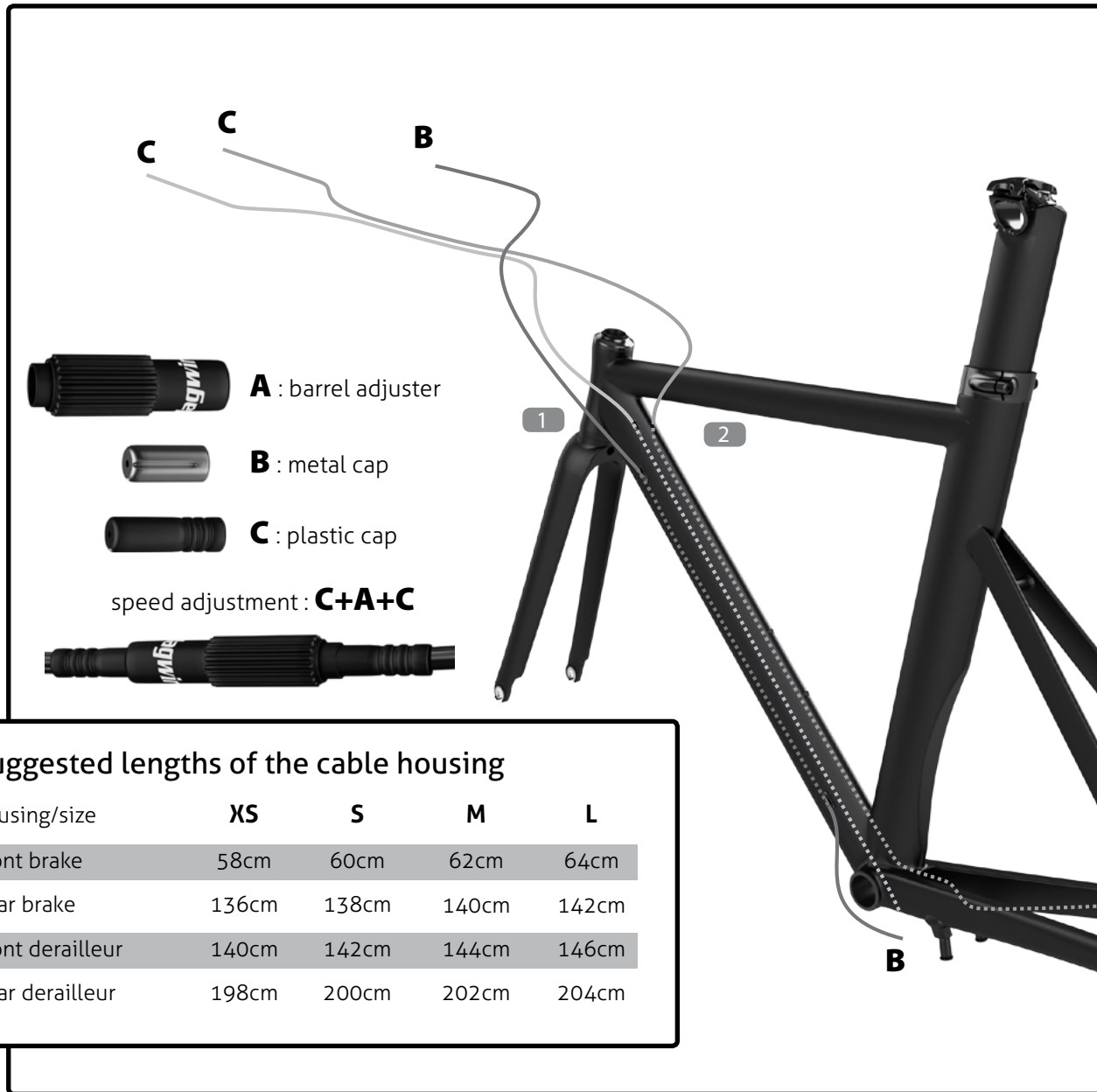

When assembling a new frame, be sure to check if the following parts are assembled correctly.

Parts installed on the frame		Description	Screw type	Torque Nm	Detail
1	Front derailleur hanger	Screw (2)	3mm	4Nm	Loctite
2	Rear derailleur hanger	Screw (4)	3mm	4Nm	Loctite
3	Bottle cage	Screw (2)	4mm	3Nm	Grease
4	Bottom bracket cable guide	Screw (2)	5mm	2Nm	Grease



-  **A** : barrel adjuster
-  **B** : metal cap
-  **C** : plastic cap
- speed adjustment : **C+A+C**
- 

1. Install the front derailleur and the rear brake housing starting at the top of the downtube (left side).

2. Install the rear derailleur housing starting at the top of the downtube (right side).

For the derailleur and brake housing, measure a sufficient length of housing to be able to turn the handlebar both ways correctly.

See the table below for the cable housing suggested length.

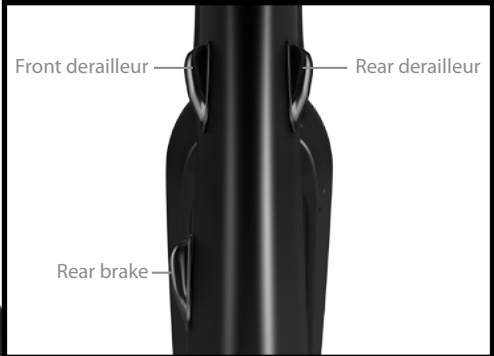

housing/size	XS	S	M	L
Front brake	58cm	60cm	62cm	64cm
Rear brake	136cm	138cm	140cm	142cm
Front derailleur	140cm	142cm	144cm	146cm
Rear derailleur	198cm	200cm	202cm	204cm



Remove the cable guide (3f) and add a plastic cap on the front derailleur housing. Insert the plastic cap and the rear derailleur housing into the cable with the M5 screw.

IMPORTANT NOTICE: It is easier to install the cable housings before the crank.

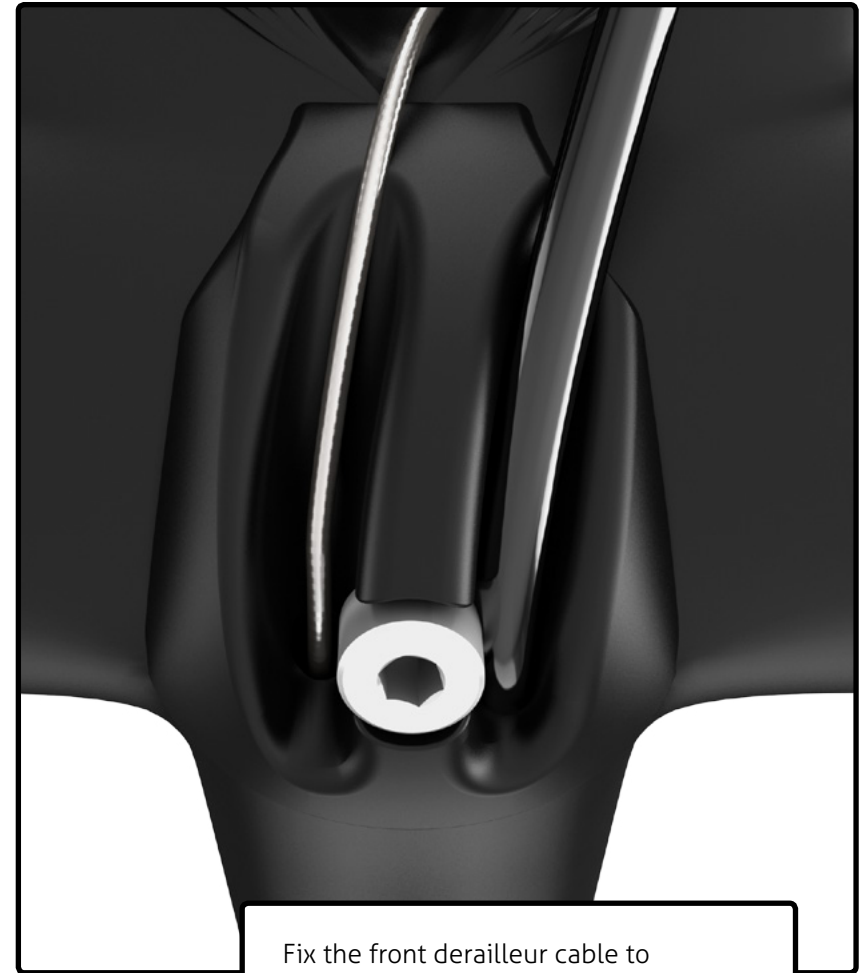

Fix the front derailleur cable to the front derailleur. Insert the rear derailleur housing into the hole near the bottom bracket until it comes out next to the right side drop out.



For each cable housing, measure a sufficient length to be able to turn the handlebar both ways correctly. This will also ensure the grommets stay in place correctly.

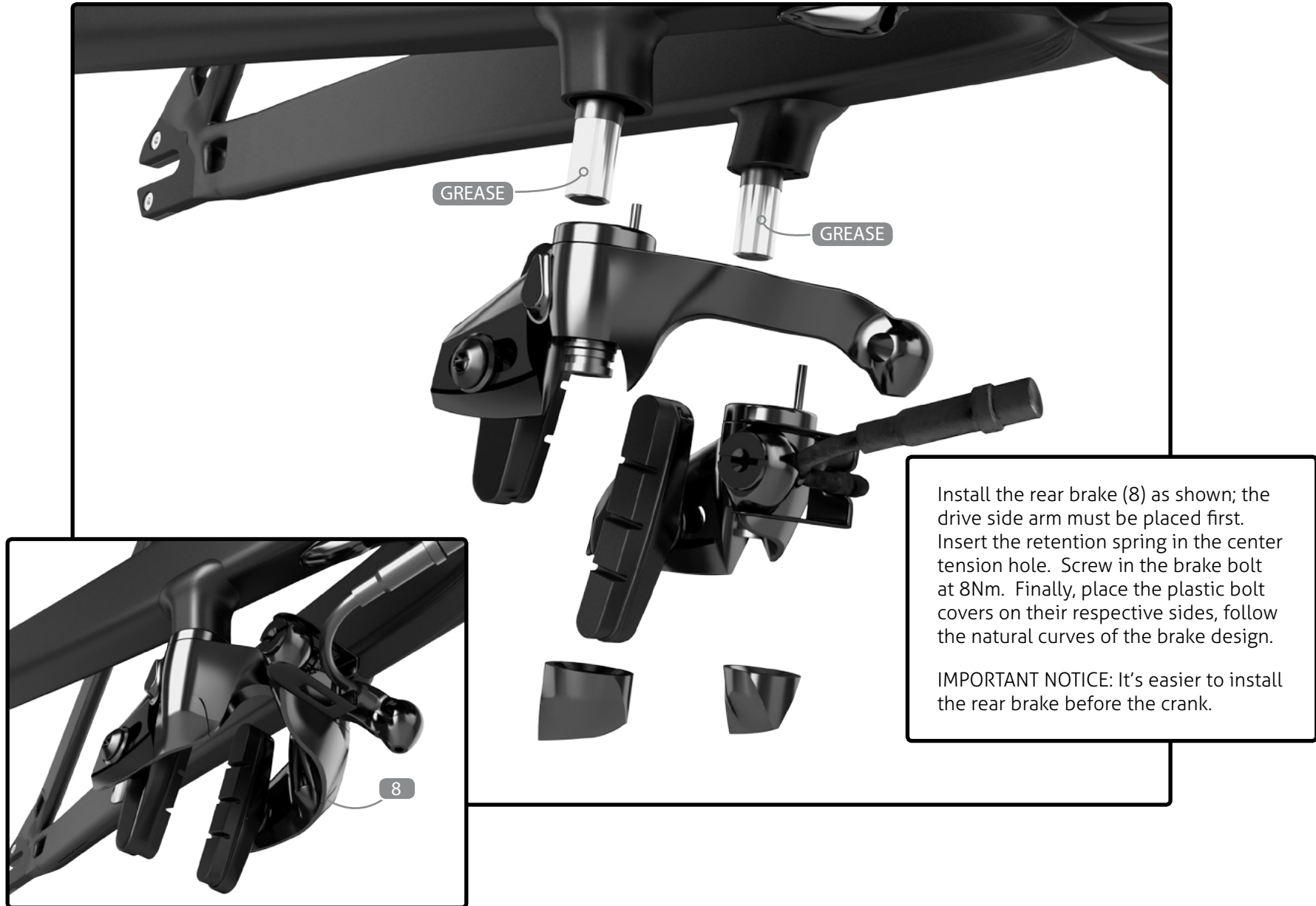



The front brake is installed behind the fork. Use the provided sunken nut to fix the brake caliper to the fork; tighten it to 8 Nm.

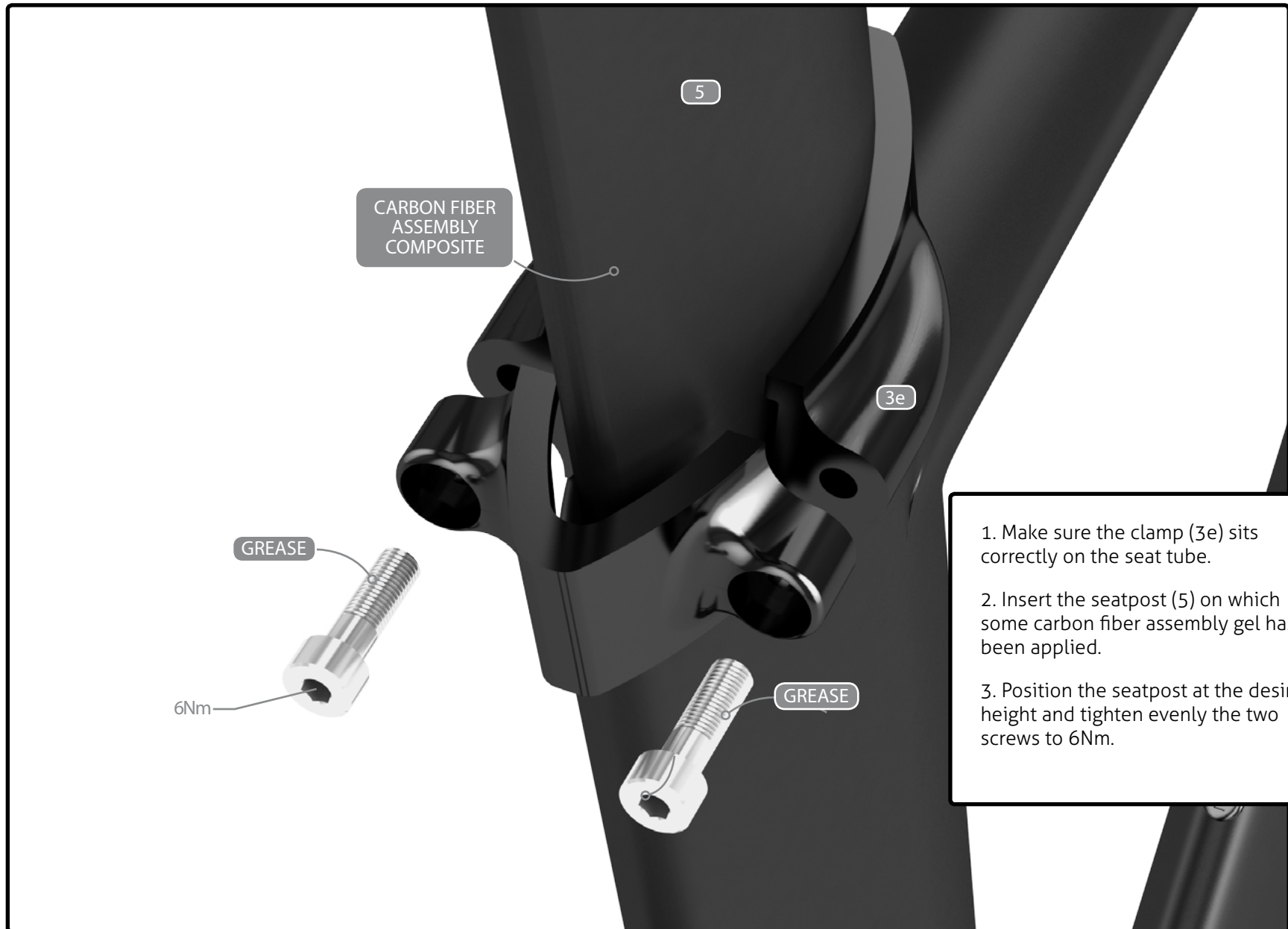

1. Make sure the clamp (3e) sits correctly on the seat tube.
2. Insert the seatpost (5) on which some carbon fiber assembly gel has been applied.
3. Position the seatpost at the desired height and tighten evenly the two screws to 6Nm.

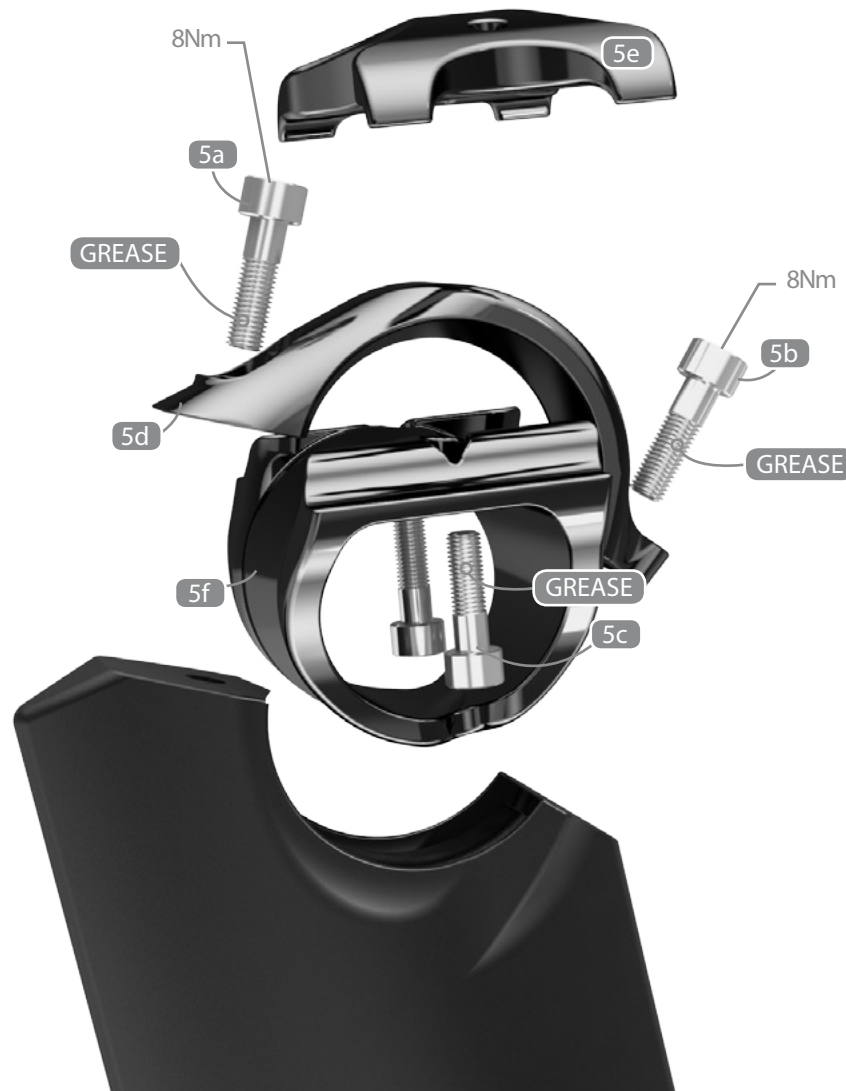

1. Install the saddle on the rocker (5f) and slightly tighten the rail clamp (5e) using a ball end hex key.
2. Tighten the upper screw of the rocker clamp (5a) by keeping a space of 2 to 3mm between the aluminum and carbon parts.
3. Adjust the angle of the saddle and tighten the lower bolt of the rocker clamp (5b).
4. Adjust the saddle offset and finalize the tightening of the rail clamp (5c).





The 2waypost ASP-4000 can be flipped to achieve a triathlon or a road position (75°/78°).

The seat clamp offset can be set by flipping the rail clamp (5d) and the rocker (5f).

Road : -10mm to -15mm

Tri : +10mm to 15mm

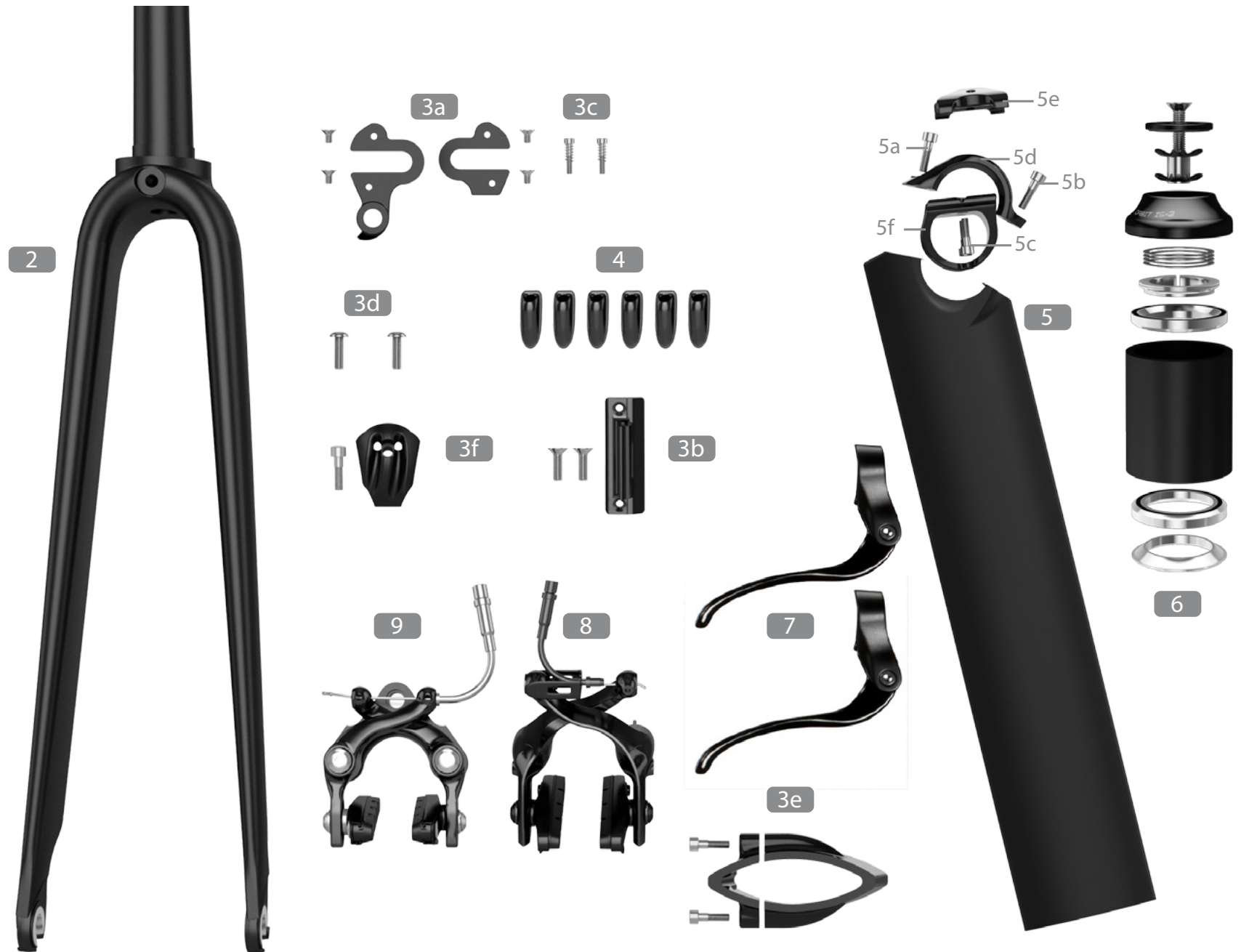



No.	Name	A18 SKU#	Qty
# Frameset Parts			
1	E-80 frame		1
2	E-80 fork	FK.E80.219A	1
# Parts installed on the frame			
3a	Rear derailleur hanger with screws M4x7mmF - Model F	37831	1 set
3b	Front derailleur hanger with screws M4x8mmF - Model E	35900	1
3c	Rear axel adjustment round head Phillips screws M3x20mm and springs		2
3d	Screws for water bottle cage M5x16mmB		2
3e	Seat clamp alloy polish black with screws M5x20mmS	37834	1
3f	Nylon BB cable guide with button head screw M3x7mm Phillips	36853	1
4	Grommet	36618	6
5	E-80 seat post (ASP-4000) with the following parts assembled	SP.E80.219A	1
5a	Upper HexSocket screw (M6*20mm S) for rocker clamp		1
5b	Lower HexSocket screw (M6*20mm S) for rocker clamp		1
5c	HexSocket screws (M5*20mm S)		2
5d	Top rail clamp		1
5e	Rocker clamp		1
5f	Rocker		1



No.	Name	A18 SKU#	Qty
#	Also included with the frameset - shipped separately		
6	Headset No. IS-2 15mm with compressor TH-874-1	32580	1
7	RX 4.1 brake levers	32593	1 left + 1 right
8	T822-1 rear brake	36404	1
9	R725 front brake	36458	1