

ELECTRON 



KNOCKOUT POWER FOR PURSUIT RIDERS

Photos are for illustrative purposes only. Product not necessarily sold as shown.

***WITH REVOLUTIONARY
AERODYNAMICS, MASSIVE
STIFFNESS, AND PRECISION
POSITIONING THROUGH
A REMODELLED COCKPIT,
THE ELECTRON PRO TKO
PURSUIT DELIVERS
KNOCKOUT POWER TO
THE TRACK'S MOST
POWERFUL RIDERS.***

Designed for the Tokyo Olympics, the new Electron Pro TKO is the result of over 4500 hours of engineering - design, modelling and testing - in a development partnership between Argon 18, Cycling Australia, Zipp, Monash University and the University of Adelaide. Designed to optimize every possible advantage and grab every fraction of a second, the Electron Pro TKO sets its sights on track victory.

ULTIMATE AERO: All areas of the frame were optimised with extensive lab and wind tunnel tests. Major improvements were achieved through the slender front profile including fork design, and the triangle at the TT/ST junction to reduce drag around the rider's legs.

DOWN TO THE DETAILS: All design details are laser-focused on aero gains: Integration of the timing chip on the fork leg resulted in measurable aero gains compared to an exposed chip strapped to the fork (as is standard in most track competition). Replacing standard bolts with thru-axles also produced measurable drag reduction, as well as adding stiffness.

POWER POSITIONING: Significant aero gains were made by working closely with athletes, coaches and aerodynamicists to achieve precise rider position, optimising both the lowest drag and highest power output.

NOTE LIMITED WHEELSET COMPATIBILITY (100MM X 12MM THRU-AXLE): CAMPAGNOLO (FULL DISC), CORIMA (SPOKE) OR FSA 3 SPOKES (ONLY AVAILABLE THROUGH ARGON 18)

A 40MM O.L.D. (OVER-LOCK-NUT DIMENSION) X 15MM THRU-AXLE NARROW FORK CAN BE PURCHASED SEPARATELY. CONTACT US FOR MORE DETAILS.

NEW AERO EXTENSIONS CAN BE PURCHASED SEPARATELY. (AVAILABLE IN 4 SIZES)
CONTACT US FOR MORE DETAILS.

ELECTRON

Ideal for pursuit and endurance track racers looking for the most advanced engineering to match their performance output.



FEATURES:

Max Rim Size	24mm
BB Standard	BSA
Max Chainring	70T
Increased Stiffness	2% stiffness increase at BB and 9% torsional stiffness increase compared to Electron Pro Rio Pursuit
Anti-Rotation Saddle Rail Clamp	Keeps the saddle stable under the most extreme power output
Wheel Compatibility	100mm x 12mm thru-axle Campagnolo (full disc), Corima (spoke) or FSA 3 spokes (only available through Argon 18)

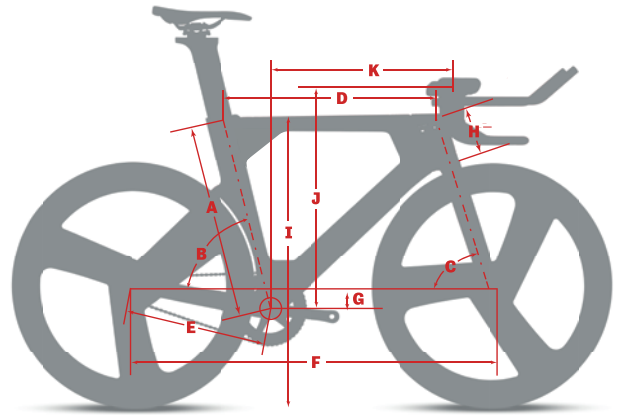

GEOMETRY

SIZE CLASSIC		XS 47-50	S 51-53	M 54-56	L 57-59	
A	SEAT TUBE HEIGHT	cm	43.0	51.5	53.0	54.0
B	SEAT TUBE ANGLE	deg	76.0	76.0	76.0	76.0
C	HEAD TUBE ANGLE	deg	72.7	72.7	72.7	72.7
D	TOP TUBE LENGTH*	cm	51.5	54.0	56.3	59.1
E	CHAINSTAY LENGTH	cm	37.5	37.5	37.5	37.5
F	WHEELBASE	cm	94.7	96.9	99.1	102.0
G	BB DROP	cm	3.7	5.0	5.5	5.5
H	HEADTUBE LENGTH	cm	10.2	12.9	13.9	15.5
I	STANDOVER HEIGHT ¹	cm	73.2	79.4	80.4	81.5

* HORIZONTAL TOP TUBE LENGTH
¹ MEASURED WITH 700X23C TIRES

FIT (STACK AND REACH)

J*	STACK MIN.	cm	49.7	53.6	55.1	56.6
	STACK MAX.	cm	59.7	63.6	65.1	66.6
K*	REACH MIN.	cm	44.8	46.3	48.3	50.7
	REACH MAX.	cm <td>49.3</td> <td>50.8</td> <td>52.8</td> <td>55.2</td>	49.3	50.8	52.8	55.2
J**	STACK (DROP BAR)	cm	46.1	50.0	51.5	53.0
K**	REACH (DROP BAR)	cm	39.7	41.2	43.2	45.6

* STACK AND REACH MEASURED AT CENTER OF ELBOW PAD

** NOMINAL STACK AND REACH IN DROP BAR CONFIGURATION. MAXIMAL OF 20MM OF SPACER UNDER THE STEM MEASURED AT THE BASE OF THE STEERER MODULE

SOLD AS FRAMESET ONLY (INCLUDES SEAT POST, BASEBAR, EXTENSIONS, STEERING MODULE AND HEADSET)

A 40MM O.L.D. (OVER-LOCK-NUT DIMENSION) X 15MM THRU-AXLE NARROW FORK CAN BE PURCHASED SEPARATELY. CONTACT US FOR MORE DETAILS.

NEW AERO EXTENSIONS CAN BE PURCHASED SEPARATELY.

- AVAILABLE IN 4 SIZES
- COMPATIBLE WITH THE ELECTRON PRO RIO

CONTACT US FOR MORE DETAILS.

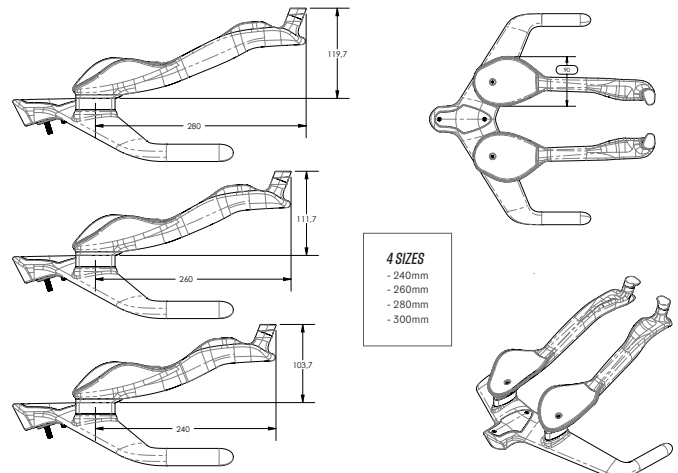

ARGON 18

