

3D Headtube Installation Instructions

Congratulations on your Argon 18 bicycle. Please read these instructions and follow them for correct use. Failure to follow the warnings and instructions could result in damage to product which is not covered under warranty, damage to bicycle; or cause an accident resulting in injury or death. Since specific tools and experience are necessary for proper installation, it is recommended that the product be installed by a qualified bicycle technician.

fig. 1

Description	No 62 + 3D	No 53-1 + 3D	IS2 + 3D
	Gallium Pro/Gallium	Krypton	E-112/Electron Pro
1 Bearing Cover	X	X	X
2 Upper Race	X	X	X
3 Top Bearing	X	X	X
4 Adjustment Sleeve	X	X	X
5 10mm 3D Spacer	X	X	X
6 20mm 3D Spacer	X	X	X
7 Lower bearing	X	X	X
8 Rubber Seal	X		
9 Crown Race		X	X

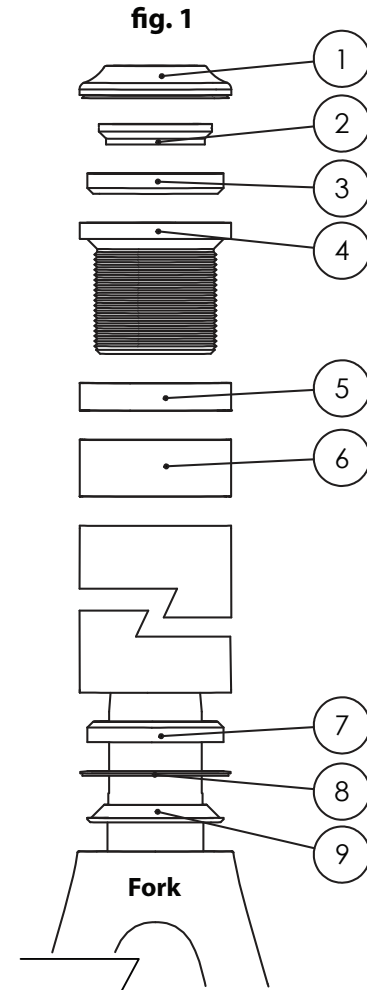

Warranty

Argon 18 warrants the 3D Headtube to be free from defects in materials or workmanship for a period of two years after original purchase unless otherwise stated in the full warranty policy. The warranty is nontransferable and valid to the original purchaser of the product only.

Note: Description of numbered parts is comprehensive and for reference only. Headset models vary and may not include all parts listed above.



3D Headtube installation

The 3D Headtube includes the following components:

- 10 and 20mm 3D spacers **fig. 2**
 - Frames are delivered with the 20mm 3D spacer already mounted; this is easily removed.
- Threaded adjustment sleeve
 - The adjustment sleeve preloads the 3D spacers and its conically machined top surface serves as a cup for the headset top cartridge bearing.

Installing/replacing a 3D spacer

To install or replace a 3D spacer, simply unscrew the threaded sleeve by inserting the specially supplied tool's **fig. 3** corner edges into the notches machined in the sleeve's inner circumference.

Lubrication: apply Teflon tape to sleeve thread to avoid any corrosion or possible galling on disassembly.

The sleeve has a conventional thread; it tightens in a clockwise motion. The tool offers just enough leverage to properly tighten the sleeve or to unscrew it without excessive force; avoid over-tightening. Recommended torque: 30 Nm.

The 3D headset offers three choices of adjustment. Choose one of the following three options and screw the sleeve into the frame

WARNING: do not mount more than one spacer at a time

- 0mm, (no spacer, top cartridge bearing installed directly atop the headtube, no sleeve needed)
- 10mm spacer
- 20mm spacer

