



Field Installation and Usage Instructions

Part No. TMA04-15

O2 Tank Holder

For All Non-X TMM3, TMM4, and TMM5 Models

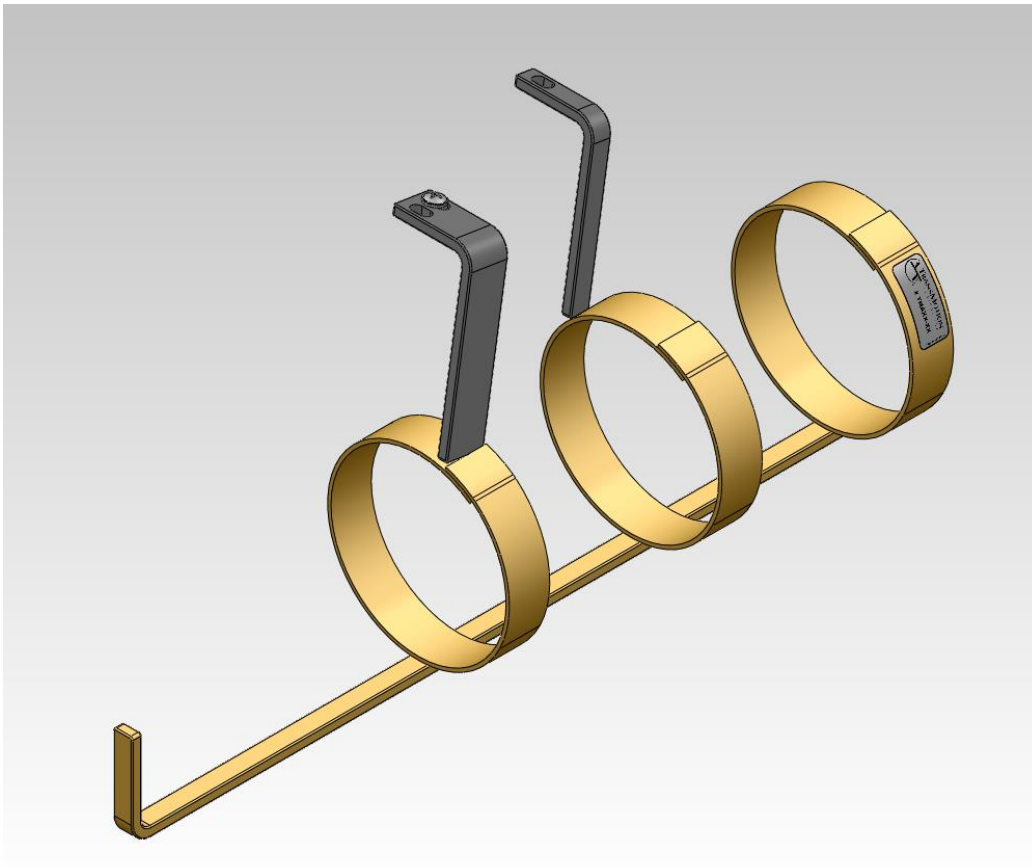

5516 S.W. 1st Lane – Ocala, FL 34474-9307
Phone: 1-800-237-3377 - Fax: 1-352-854-9544
www.transmotionmedical.com

Document No.: IM TMA04-15
Revision: E

TABLE OF CONTENTS

TABLE OF CONTENTS.....	2
IMPORTANT NOTES ABOUT THIS MANUAL.....	3
SPECIAL NOTES - SIGNAL WORDS.....	3
TOOLS REQUIRED.....	4
PARTS INCLUDED FOR TMA04-15.....	4
PREPARING CHAIR FOR INSTALLATION.....	5
INSTALLING O2 TANK HOLDER.....	6
CAUTIONARY USAGE INSTRUCTIONS.....	9
PREVENTIVE MAINTENANCE.....	9
CLEANING INSTRUCTIONS.....	10
SERVICE INFORMATION.....	12

IMPORTANT NOTES ABOUT THIS MANUAL

This Field Installation and Usage Instruction document is designed to assist you with installation of the TransMotion Medical Product. Carefully read this document thoroughly before using the equipment or doing service/maintenance on it. If you are unable to understand the WARNINGS and CAUTIONS and instructions, contact TransMotion Medical customer service before attempting to operate or service the equipment otherwise injury or damage may result.

To assure safe operation of this device, it is essential that methods and procedures be established for educating and training staff on the safe and effective operation of the product.

TransMotion Medical reserves the right to change specifications without notice.

The information contained in this document is subject to change without notice.

Specifications listed are nominal and may vary slightly from unit to unit due to tolerance variations.

Photographs and illustrations contained within this document may not depict exactly the model you have. This document can cover many closely related models.

SPECIAL NOTES - SIGNAL WORDS

Signal words are used in this manual and apply to hazards which could result in injury or property damage. The following is a definition of those signal words as used in this document:

DANGER

Indicates an imminently hazardous situation which, if not avoided, will result in death or serious injury.

WARNING

Indicates a potentially hazardous situation which, if not avoided, could result in death or serious injury.

CAUTION

Indicates a potentially hazardous situation which, if not avoided, may result in minor or moderate injury. It may also be used to alert against unsafe practices or potential property damage hazards.

NOTICE

Provides important information, makes special instructions clearer, or provides service personnel information to make maintenance easier.

TOOLS REQUIRED

The tools needed to install a new O2 tank holder are as follows:

- Socket Wrench
- 3/8" Hex Socket



PARTS INCLUDED FOR TMA04-15

O2 Tank Holder is shipped (as shown here) and does not require added assembly.

If any features seem damaged due to shipping, contact TMM Service Department toll-free at 1-800-237-3377.

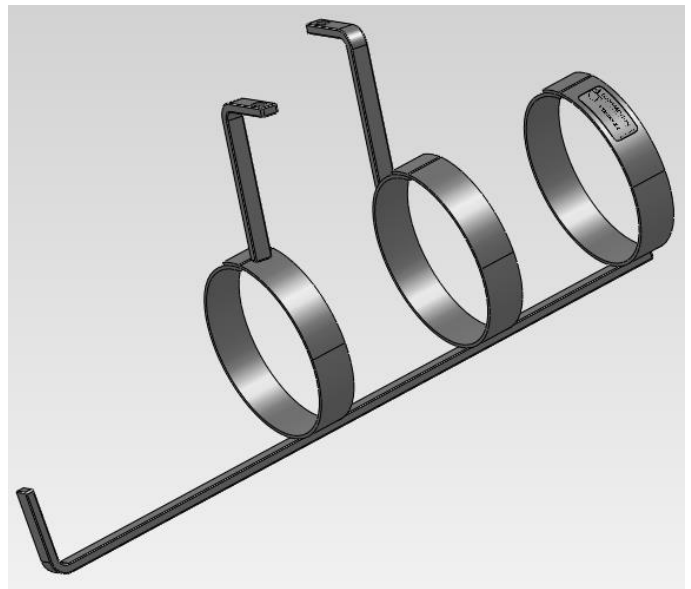

PREPARING CHAIR FOR INSTALLATION

- 1) Position chair into stretcher configuration.
- 2) Raise seat to maximum height.

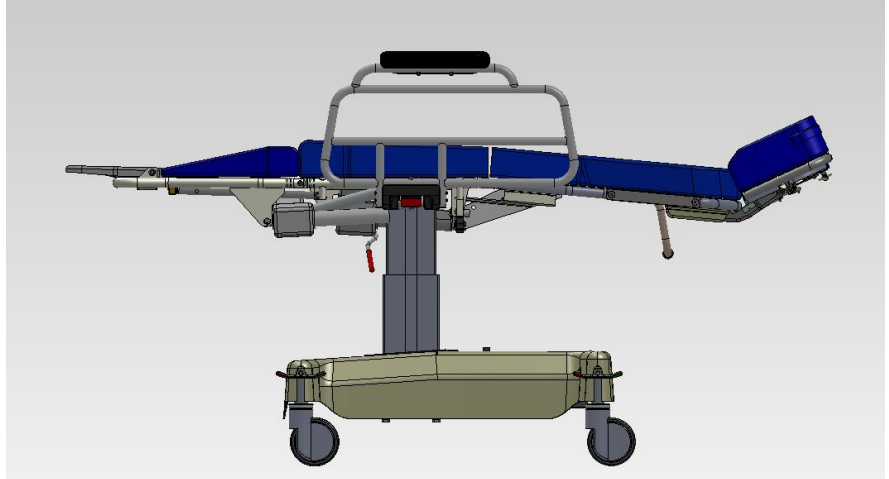

- 3) Remove (2) bolts originally provided with chair.



These bolts will be used to mount O2 tank holder.

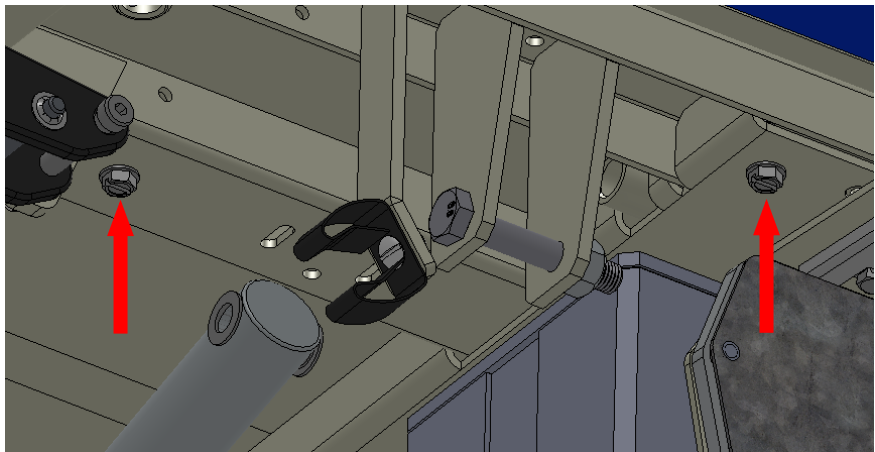
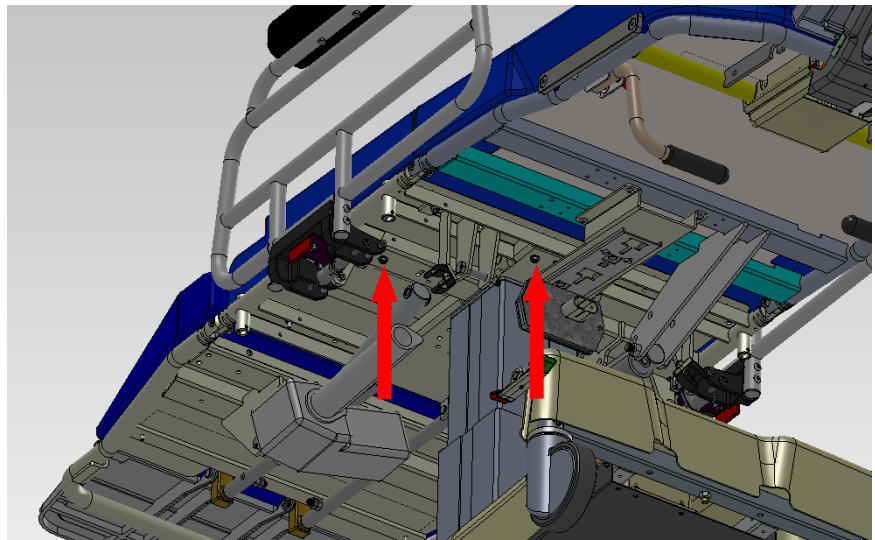

INSTALLING O2 TANK HOLDER



Note orientation of O2 tank holder. (TMM label towards back of chair.)

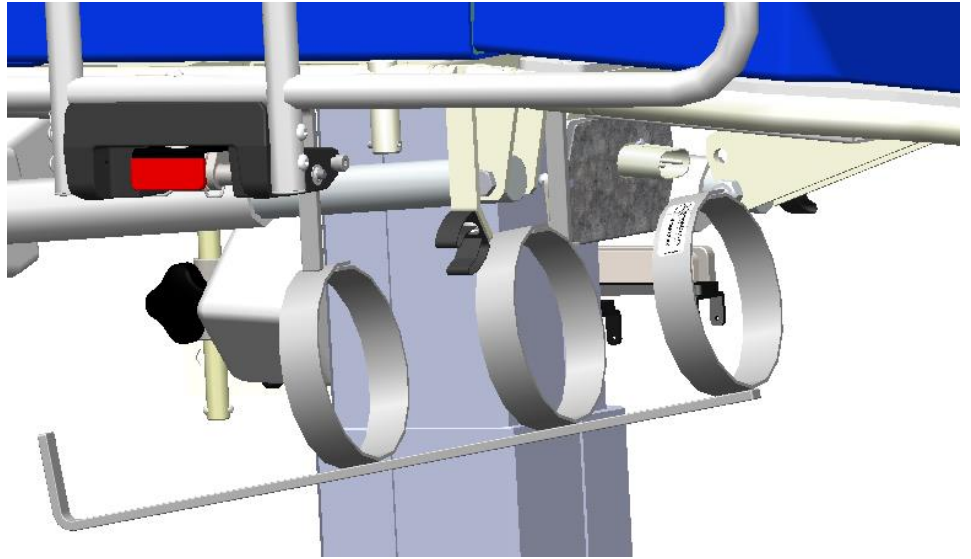

- 1) Align rear bolt hole in holder with rear bolt hole in chair frame.

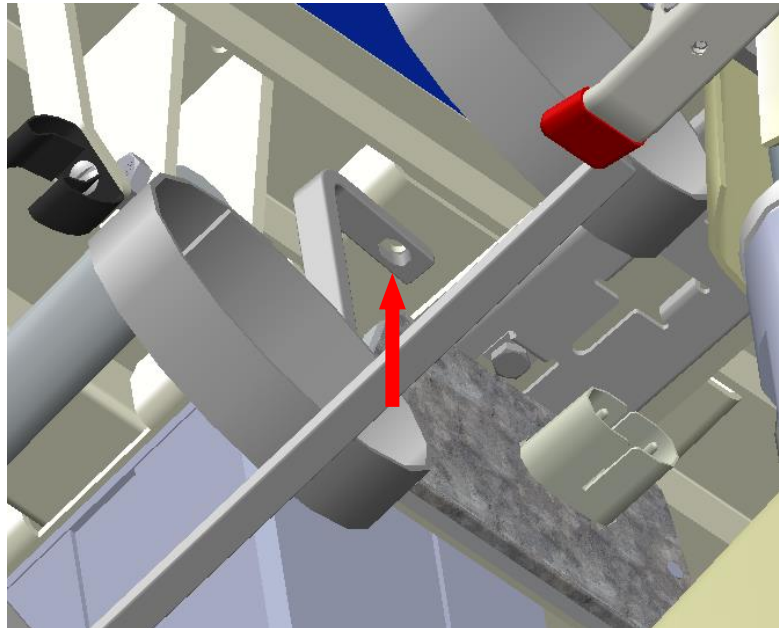

- 2) Install bolt into hole and tighten, but allow for rotation of holder.

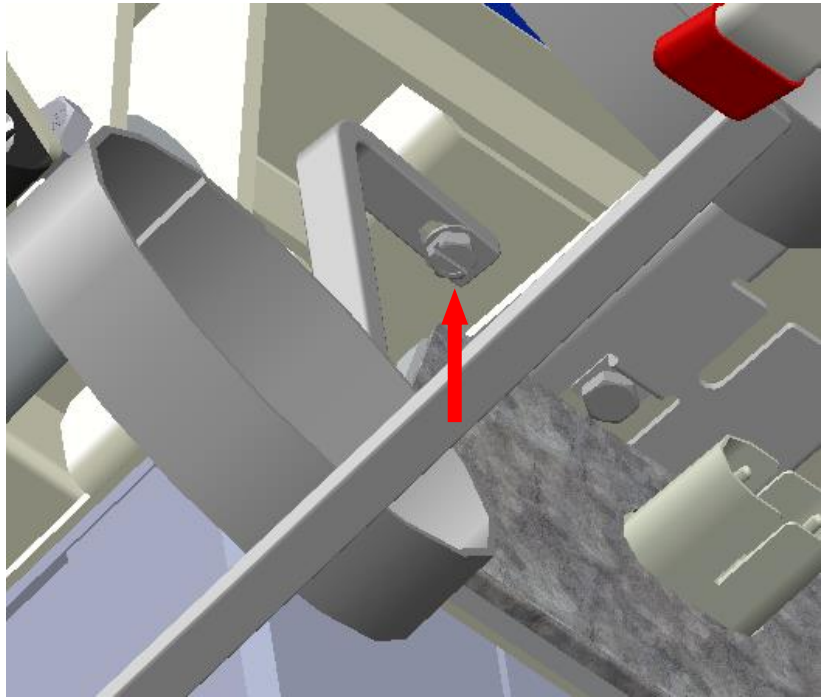

- 3) Align front bolt hole in holder with front bolt hole in chair frame.

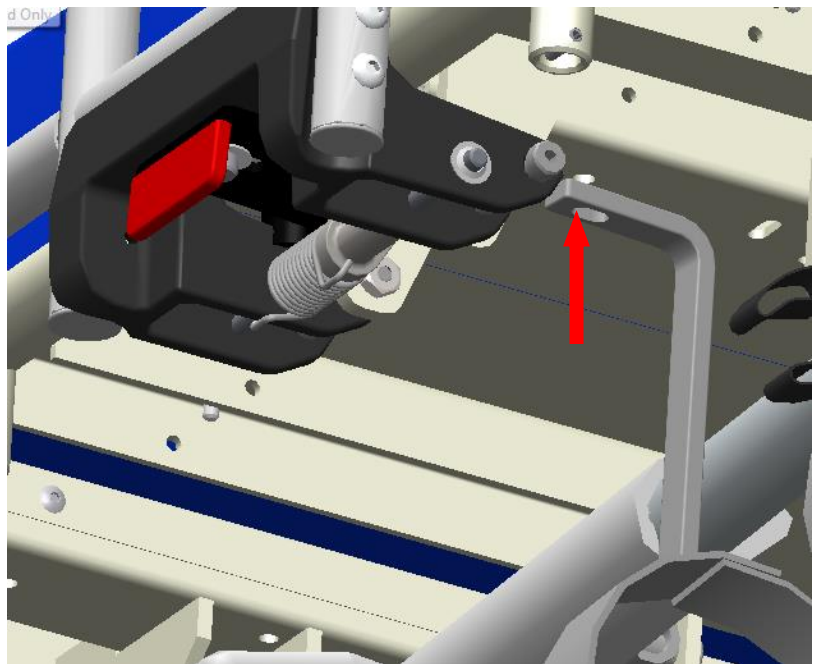

- 4) Install bolt into hole and tighten, but allow for adjustment of holder.

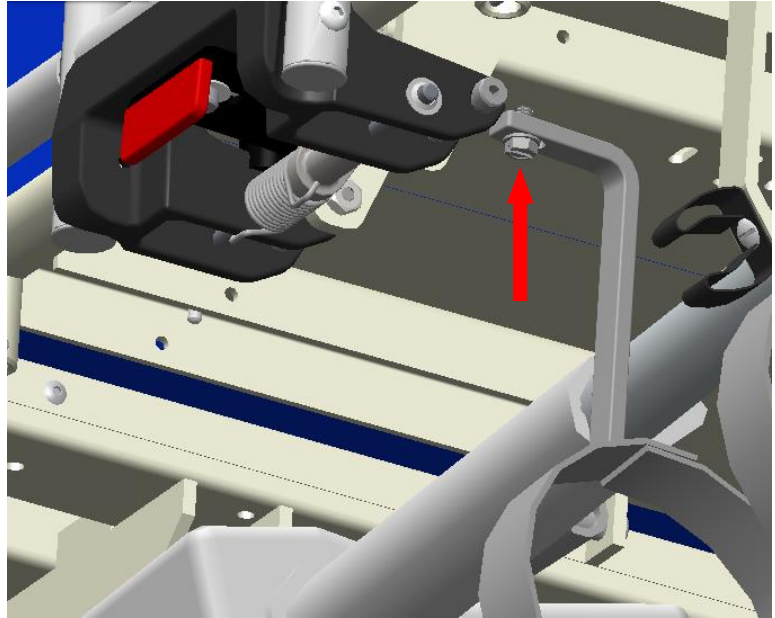

- 5) Adjust holder to ensure clearance of all moving parts and use 3/8" socket to tighten bolts completely and secure holder.

CAUTION

Failure to ensure that O2 tank holder is clear of moving parts could result in minor injury and/or damage to this accessory.

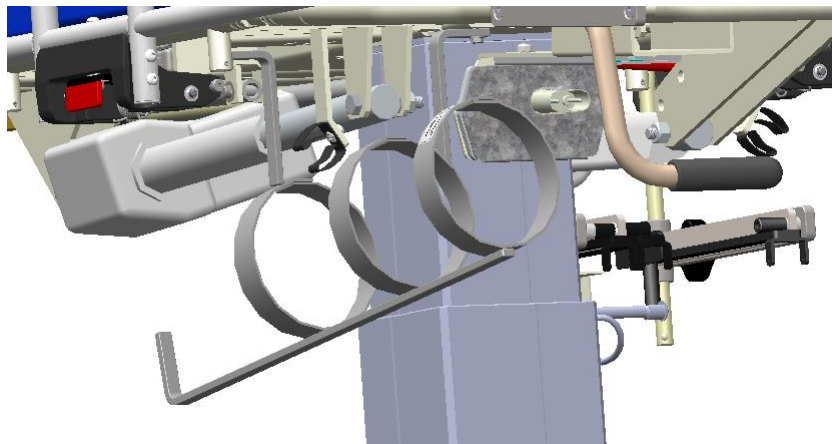

CAUTIONARY USAGE INSTRUCTIONS

When using this accessory, please follow these cautionary usage instructions:

⚠ CAUTION BE SURE TO FOLLOW YOUR MEDICAL FACILITY'S PROPER HANDLING PROCEDURES FOR COMPRESSED GAS EQUIPMENT.

PREVENTIVE MAINTENANCE

To ensure proper operation, this accessory should be inspected and maintained as described below.

COMPONENT	FREQUENCY	PROCEDURE	TOOL	COMMENT
Bolted Joint	Every three months	Ensure joints have not loosened. Tighten if needed.	Wrench	-
Welded Joints	Every three months	Inspect welds at all joints.	-	If welds are broken, replace accessory.

CLEANING INSTRUCTIONS



STEAM AND/OR PRESSURE CLEANING CHAIR WILL VOID WARRANTY

COMPONENT	FREQUENCY	PROCEDURE	CLEANING AGENT *	COMMENT
All Rails and Painted Metal	As required/in accordance with facility policies	Wipe with damp cloth and allow to air dry	Facility approved detergents, disinfectants & water	Check for chipped paint/chrome
Base Cover	As required/in accordance with facility policies	Wipe with damp cloth and allow to air dry	Facility approved detergents, disinfectants & water	Check for peeling or missing labels
Actuators and Battery Pack	As required/in accordance with facility policies	Wipe with damp cloth and allow to air dry	Facility approved detergents, disinfectants & water	Clean exterior surfaces only with minimal water
Pendants	As required/in accordance with facility policies	Wipe with damp cloth and allow to air dry	Facility approved detergents, disinfectants & water	Clean exterior surfaces only with minimal water
All Other Surfaces	As required/in accordance with facility policies	Wipe with damp cloth and allow to air dry	Facility approved detergents, disinfectants & water	Check for damage
TransMotion Medical Accessories	As required/in accordance with facility policies	Wipe with damp cloth and allow to air dry	Facility approved detergents, disinfectants & water	Check for damage
3rd Party Accessories	As required/in accordance with facility policies	Consult manual provided by accessory manufacturer.		

* Use of Facility approved detergents and disinfectants must comply with the instructions provided by the manufacturer(s) of those products.

Upholstery Care & Cleaning Instructions

Proper care is essential in ensuring the durability and reliability of TransMotion Medical upholstery. In general, all products should be:

1. Cleaned
2. Disinfected (in accordance with facility policy)
3. Rinsed
4. Allowed to air dry

It is important to note that the terms “disinfecting” and “cleaning” should not be used interchangeably. Disinfectants alone will not provide adequate cleaning since they do not have the appropriate properties to cut grease or oil and remove grime, hair or skin oils. The appearance, feel and performance of your upholstery may diminish if not cleaned properly.

Cleaning:

Remove hair, grime and body oils. Your upholstery should be cleaned on a regular basis with a damp cloth soaked in a mild soap and water solution. Avoid harsh detergents or chemicals that could damage the finish of your product. If disinfecting with manufacturer approved chemicals or bleach, the upholstery MUST be wiped off using clean water on a damp cloth and allowed to air-dry as a final step. Failure to rinse upholstery with clean water can result in a build-up of residues that, over time, may lead to drying, cracking or other undesirable changes to appearance, feel and performance.

Retain all instructional tags for future use.

Contact the manufacturer of the fabric used in your upholstery for a current list of approved disinfectants. TransMotion Medical Customer Care can assist with identifying which upholstery was used with your Stretcher-Chair.

For customer supplied and non-standard materials, please refer to the individual manufacturer’s cleaning instructions.

SERVICE INFORMATION

Customer service and support are important aspects of each TransMotion Medical product.

Prior to contacting TransMotion Medical for assistance with your accessory, please **HAVE YOUR CHAIR'S SERIAL NUMBER HANDY.**

Contact TransMotion Medical Service at:

TransMotion Medical
ATTN: Customer Service
5516 S.W. 1st Lane
Ocala, FL 34474-9307
United States of America

Phone: 1-800-237-3377
1-352-854-2929

Fax: 1-352-854-9544



Manufacturer of Device:
TransMotion Medical
5516 S.W. 1st Lane
Ocala, FL 34474-9307
United States of America



Authorized Representative in Europe:
Emergo Europe
Molenstraat 15
2513 BH, The Hague
The Netherlands

