



Engineers of Flow



Quality since 1981



ENGINEERS OF FLOW

COMPANY BROCHURE



INTRALOGISTICS

FOR A BETTER FUTURE

**Intralogistics – THE term that best describes us. But people still keep asking us: What is intralogistics?
Because not everyone can be an expert in this field. And then we need to answer promptly, well and simply.**

And this is how we do it, Dear Reader:

Intralogistics is an important consideration as part of the supply chain, because if the internal flow of materials does not work, production does not run smoothly either. This in turn means that the relevant goods cannot be delivered on time.

This can affect every one of us in a wide variety of situations: the new car, fresh fruit, or essential medicines. And this is where LTW comes into play: for more than 40 years, we have been on hand, ready to assist our partners and customers in all matters relating to intralogistics.

40 years of LTW – and counting

But do you know what makes me especially proud? As long-standing LTW employees, we have been able to actively shape this growth in a variety of roles. The market for intralogistics is not all that has changed significantly during this time. We have also steadily developed as a company. Originally just a supplier of stacker cranes, we can now rightly describe ourselves as a full-service provider. And as such, we develop individual solutions for our customers.

A look into the crystal ball suggests that the importance of intralogistics will increase, day by day. E-commerce, climate protection, and goods transport are areas where we are developing innovative projects. The combined transport of passengers and goods in gondolas, as well as intermodal transportation, will play an increasingly important role. Because one thing is clear: when people put down roots, the transport of goods is essential.

LTW and Doppelmayr

Doppelmayr Holding not only gives us a solid background, it also allows us to keep developing novel solutions. And as a reliable full-service provider in the intralogistics sector, it is solutions and products like this that we represent.

With this in mind: happy reading!

We look forward to future joint discussions.



Bernhard Peter
CEO, LTW Intralogistics GmbH



Konrad Eberle
CEO, LTW Intralogistics GmbH

1 FULL-SERVICE PROVIDER FOR INTRALOGISTICS	8
Industry expertise	11
The Process.....	12
LTW products, made by Doppelmayr	17
Software, powered by LTW.....	19
Individual solutions.....	20
Our service, to your benefit	23
2 LTW-PRODUCT PORTFOLIO	28
Stacker cranes	31
Hybrid stacker crane.....	35
Belt	36
Shuttle-System	37
Switch technology.....	38
Order picking doors	41
Conveyor system	42
Vertical lift	45
Transfer car	46
Rail system Carry.....	47
3 SOFTWARE – THE RIGHT TOOL FOR YOUR LOGISTICS	50
LIOS – LTW Intralogistics Operating System.....	53
Mobile Operator	54
Why should you choose LIOS?.....	56
4 SERVICE – IF YOUR SYSTEM ISN'T WORKING, WE ARE HERE FOR YOU	60
LTWcare – investment in the future	63
Customer Care Center	66
Personal support & hotline.....	67
Maintenance & spare parts	68
Trainings	69
Retrofit.....	70
Replacement software	74
5 COMPANY – WE ARE LTW	82
Solutions by LTW.....	84
Trust breeds loyalty	86
Operating on a global scale	89
Our developments.....	90
Doppelmayr – Strong support in the background.....	92
The benefits for you.....	97
An exceptional joint project	100
Sustainable behavior	105
VISION – The future of intralogistics.....	106
VISION – Multimodal flow of goods	107
Imprint	96

1

LTW – YOUR FULL-SERVICE PROVIDER FOR INTRALOGISTICS

WHY? BECAUSE WE DELIVER
A TURNKEY SYSTEM THAT IS
PERFECTLY TAILORED TO OUR
CUSTOMERS' NEEDS, INCLUDING
ALL ADDITIONAL SERVICES.

Which makes us [THE expert](#) for all requirements relating to [intralogistics systems](#) – anywhere in the world.

What does that mean for you? That we are your go-to contact, for whatever it is you need. Starting with advice, when we get together to work out the perfect solution for your needs and requirements.

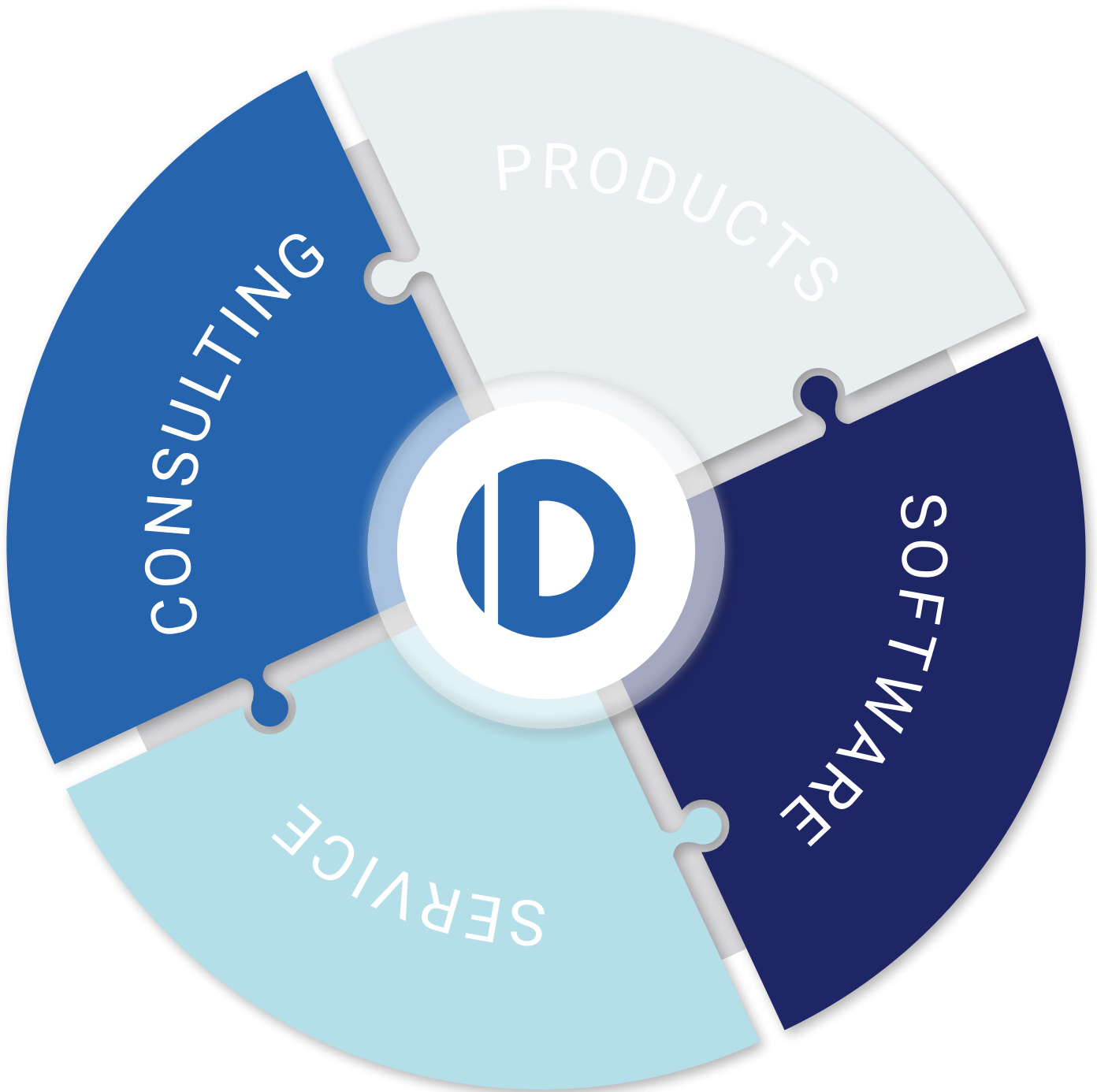



INDUSTRY EXPERTISE

Considerable expertise for every requirement

From large to small, from heavy to light – as a full-service provider for intralogistics, we are capable of meeting nearly any requirement. What makes this possible? First, an in-depth understanding of the customer's specific processes, technologies, and market needs in their respective industries. Second, a production process that allows for a high degree of design flexibility when it comes to custom solutions.

For over 40 years, we have successfully executed projects in more than 36 countries and are active in nearly every industry. Whether in food, the sensitive pharmaceutical sector, or transport logistics, our solutions are found across a wide range of sectors. The best part? Thanks to our affiliation with the Doppelmayr Group, we enjoy a level of creative freedom that few others can match when it comes to realizing projects.



THE PROCESS

Smooth material flow

We keep an eye on the flow of goods and work with you to design the optimal material flow. Thanks to our decades of experience in the field of intralogistics, we can ideally connect all your systems and interfaces. Whether it's stacker cranes or conveyor system elements such as vertical conveyors, transfer cars or Carry – not only our high-quality products are available to ensure the perfect flow of materials, but also our in-house developed intralogistics software. Our software ensures that you end up with a turnkey system that is perfectly tailored to your needs.

From goods receiving to shipping

The processes within an intralogistics system start with the digital recording of incoming goods, before they are transported to the high-bay warehouse and stored. If necessary, the corresponding goods are then picked and finally prepared for shipping. Regardless of whether it is used for the storage of finished goods or for the supply of goods for production, an automatic high-bay warehouse can also be optimally used as part of the production chain.

What do all stations have in common? The flow of goods can only run smoothly if a perfectly coordinated software program coordinates all processes – no problem for our LTW LIOS.





Thanks to the complete solution from LTW, our processes run more smoothly than ever. We have been able to satisfy our space requirements and increase efficiency due to the new intralogistics. LTW understood our wishes and designed a future-proof solution for us, meaning that nothing stands in the way of further growth.

HABERKORN GMBH

CHRISTOPH WINDER, MANAGEMENT BOARD





Facts

HABERKORN GMBH HIGH-BAY WAREHOUSE FOR PALLETS

- 6 aisle-bound stacker cranes
- 11,300 slots
- 1,000 kg payload
- conveyor systems on several levels

HIGH-BAY WAREHOUSE FOR BINS

- 10 aisle-bound stacker cranes
- 64,000 slots
- 30 kg payload
- conveyor systems on several levels

STANDARD PALLET WAREHOUSE





LTW products, made by Doppelmayr

To realize your project, we provide the necessary products. Our portfolio ranges from stacker cranes to the entire intralogistics infrastructure for automated intralogistics systems.

And because we are a member of the **Doppelmayr Group**, our products such as stacker cranes, Carry, transfer cars, or vertical conveyors, comply with ropeway standards. Guaranteed.

SOFTWARE POWERED BY LTW



Tailored to our customers

To ensure that your system runs perfectly and does what it is supposed to do, we implement our specially developed software. It is efficient, user-friendly, and customised to the requirements of our customers perfectly encapsulating

the essence of our software, our systems, and our tools. This means we can guarantee a harmonized, optimal, and transparent material flow, with perfectly matched interfaces.



Individual solutions

We will be happy to advise you about your individual requirements and solutions. Because custom-made products are not a challenge, they are one of our strengths. But you will also get your money's worth from us when it comes to systems for standardized load carriers. Thanks to our wide-ranging knowledge of the industry, we can find the answer to almost every requirement.

Because the advantages of an LTW turnkey solution are not just relevant to major logistics centers with more than 100,000 storage spaces. They are also evident in completed SME projects.

So, let's get talking. This is the only way to reach viable, efficient, functional, and sustainable solutions.





Facts

Heavy-duty stacker crane with push/pull device for 31 m wide and 13.5 t heavy goods. Including the payload of 13.5 t, the total weight of the stacker crane is 80 t.



Our service, to your benefit

You can rely on us for a professional service offering, no matter whether it is for an extension, modernization project, or maintenance. Your feedback is all we need to take the necessary action.





"The motto we live by is 'Intralogistics from a single source'. Our project managers are responsible for coordinating the internal departments involved, the external suppliers, maintaining open and solution-oriented communication, as well as managing interface coordination on site. You have a partner who takes care of everything for you."

CHRISTOPH LEOPOLD, COO



**"Our stacker cranes and
components are made of
certified materials and
as those used in the g
ropeway construction
components, used in
systems, apply the s
found in ropeway co**

BERNHARD PETER, CEO

**and conveyor system
de from the same
d with the same care
global market leader's
n standards. These
n our intralogistics
ame high standards
nstruction."**

2

LTW PRODUCT PORTFOLIO

MOVING WITH THE TIMES IS
A COMPANY CHARACTERISTIC.

Which is why, over the years, we have evolved from a **component supplier** into a **full-service provider**. What has stayed the same? The guaranteed quality of our products. What's new? Our experience helps us go higher, faster, longer, and heavier.



We focus on integrated turnkey solutions. We implement individual requests and requirements for our customers, whatever the sector. Being a member of the Doppelmayr Group gives us complete flexibility, as manufacturing is a crucial advantage at LTW. While almost all the moving parts are manufactured in Doppelmayr workshops, we

can concentrate fully on planning, programming, installing, and commissioning, as well as closely supervising our customers during the implementation phase. We have long-standing partners we can rely on for products that we do not create ourselves. This guarantees our customers top quality.



INDIVIDUAL SOLUTIONS



Stacker cranes

Planning and constructing stacker cranes have been our core competence for more than 40 years, and we have 2,500 of them to our name. They are used anywhere from small parts warehouses to gigantic storage facilities. And do you know the best part? Thanks to ropeway quality

production, there are no limits to our creativity, be it stacker cranes for 31 m long stored goods, for containers weighing 18,000 kg, or for boats. Of course, it goes without saying that our stacker cranes are also ideal for standardized load carriers (pallet warehouses).

HEAVY-DUTY

"Their performance also qualifies LTW for tasks in the top weight category. That's why LTW is our logical partner when looking for a partner to supply the new heavy-duty stacker crane."

EGGER HOLZWERKSTOFFE WISMAR GMBH & CO. KG
DONALD ZAHM, MAINTENANCE MANAGER

Facts

EGGER HOLZWERKSTOFFE
WISMAR GMBH & CO. KG

- aisle-bound stacker crane
- payload: 7,700 kg
- approx. 950 slots
- single-deep storage





SUPERCAPS



HYBRID



Hybrid stacker crane – for the sake of the environment

LTW stacker cranes can now also be fitted with energy storage units (supercaps). Braking energy is stored, and can be completely re-used, which ensures **energy savings** of up to one third, and a **reduction in the connected load** of up to 80%. Not only does this save energy resources, it also evens out fluctuations in the power supply.

Facts

HYBRID STACKER CRANE

- recovery and storage of braking energy (supercaps)
- approx. one-third energy recovery
- compensation for power failures
- approx. 80% lower connected load (stacker crane power supply cable)

BELT

Guaranteed durability

Long service life, quick positioning times, and maximum performance – our patented belt technology offers several remarkable advantages. With over 10 years of experience, we are well-equipped to advise you on the most suitable applications for using our belt as a lifting medium to replace traditional rope.

And it's not just for small parts – our belt remains highly effective even at extreme temperatures, from -30°C to +60°C.

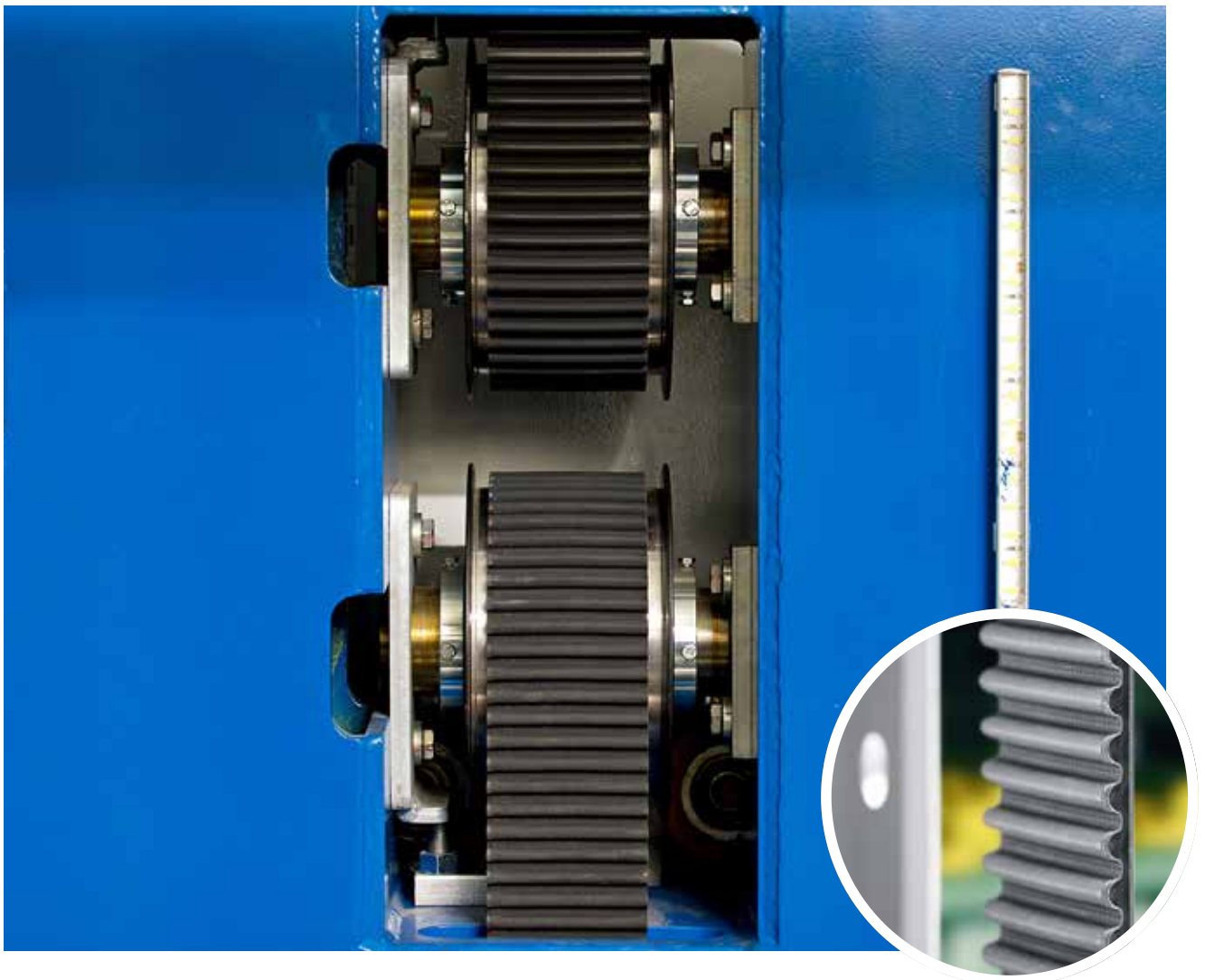



SHUTTLE-SYSTEM

High Performance

Looking for a high-performance solution? We have just what you need! Our shuttle system uses multiple vehicles stacked one above the other within an aisle. The key to its efficiency lies in the seamless interaction between the vertical conveyors and the vehicles. The transport units are moved by vertical conveyors to and from the vehicles, while the vehicles themselves primarily move laterally. This design allows the intralogistics system to achieve exceptionally high throughput.

AISLE-CHANGING SWITCH TECHNOLOGY

Switch technology – redundancy takes top priority

Stacker cranes are available in different versions. We can provide cranes with one, two or four poles, aisle-bound or aisle-changing stacker cranes, as required. Thanks to our aisle-changing mechanism developed in-house, we can cover vast areas of the warehouse with just a few stacker cranes. If several devices are used, it is even possible to ensure redundancy in system operation. Other highlights include the ability to change aisles without transfer devices, monitoring equipment, or even extensive maintenance, and there is no risk of derailment.









ORDER PICKING DOORS

Safety first

We have also created a safe and trouble-free option for carrying out order picking within the high-bay warehouse, right next to the lane. So how does that work? Our patented picking doors keep the stacker crane lane and the picking area separate from each another, and only open when goods from the shelf area move to the picking area.

Picking capacity can also be increased without using cost-intensive conveyor systems. Additional features of the solution include a low maintenance requirement, as the opening and closing mechanism for the doors is merely installed on the stacker crane.

CONVEYOR SYSTEM

Our turnkey solutions are an attractive option, as everything runs smoothly, from receipt of goods to dispatch. With LTW conveyor systems, you get an integrated intralogistics system that includes automation technology to incorporate the stacker cranes in the material flow.

We implement individual turnkey solutions for our customers, from continuous conveyor technology, to transfer cars and vertical conveyors, to rail systems. We have steadily improved and expanded our systems over the years.





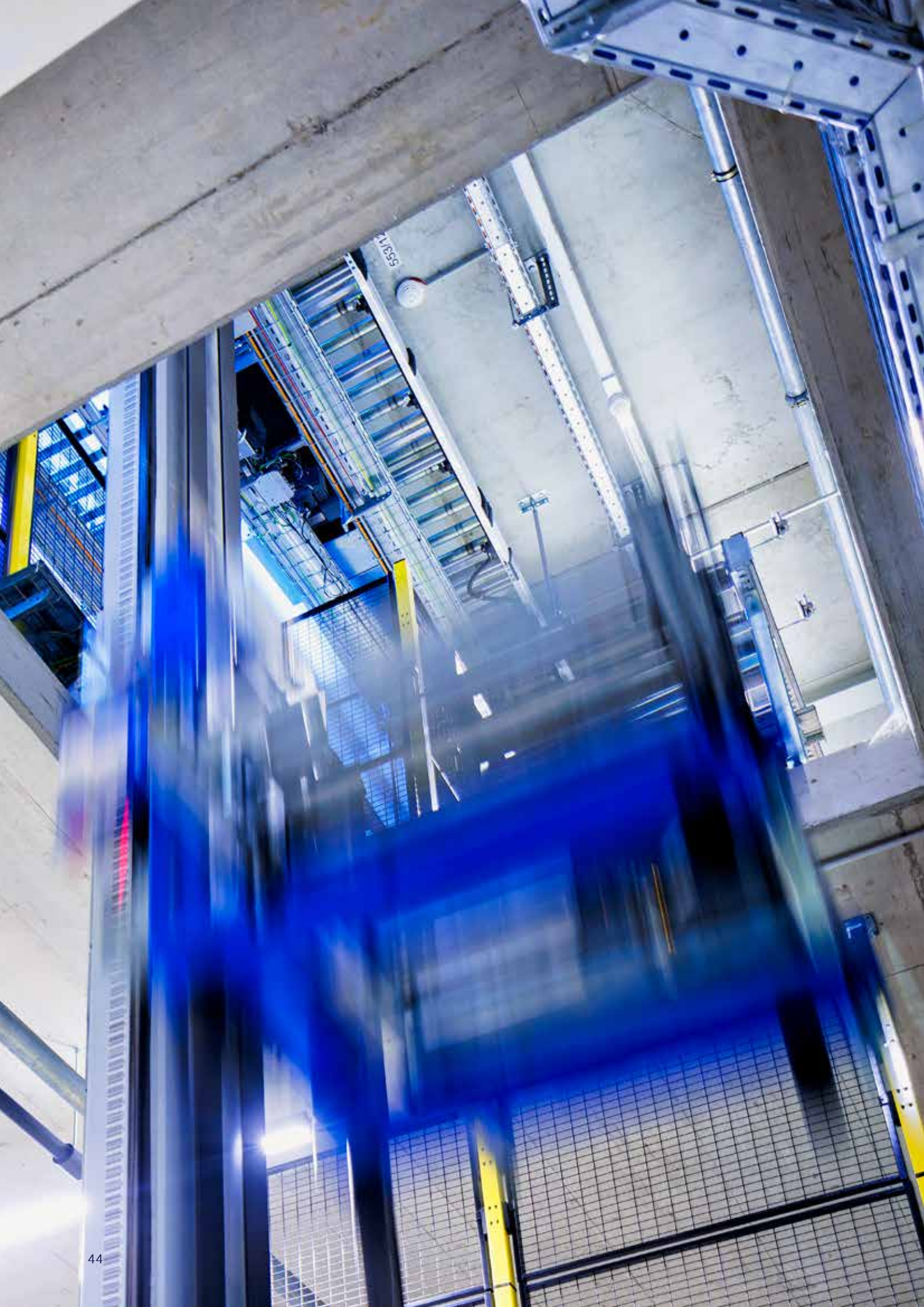

VERTICAL LIFT

The vertical lift is a genuine all-rounder. Not only can it be combined with a variety of different load handling devices, its height is virtually unlimited. It also saves a lot of space, and is highly robust – even deep-freeze temperatures are not a problem.

The installed LTW belt technology ensures maximum positioning accuracy without delay, and reduces the maintenance requirement at the same time. The most important components can be reached for servicing without needing a ladder and platform.

TRANSFER CAR

Our transfer car is as varied and flexible as the requirements of our customers, regardless of whether friction-driven or belt-driven, whether at warm temperatures or for frozen food. Its modular structure allows us to offer the right

solution for every requirement. It goes without saying that all the devices have modern operating and diagnostic options, as well as the highest safety standards.





RAIL SYSTEM CARRY

The single-track rail system is a special alternative to continuous conveyor technology. Two equipment variants are available: the basic and the premium model. The premium model has an integrated energy storage unit, allowing a variable route layout with switches, and the option of an empty vehicle buffer and a maintenance station.

What do the two have in common? They have the same mechanical design with tried and tested LTW components, which means they are low-maintenance, and service-friendly. There is no risk of derailment or collision with the Carry, while the use of several vehicles creates a redundant system.

**"Thanks to our newly
intralogistics software
components intercom
ensuring a seamless
for our customers. T
us apart as a full-ser**

CHRISTIAN BALDAUF, DIRECTOR SALES & MARKETING

y developed
re, all system
nnect perfectly,
s flow of materials
this is what sets
ervice provider."

SOFTWARE – THE RIGHT TOOL FOR YOUR LOGISTICS

SOFTWARE IS REGARDED
AS THE HEART OF EVERY
INTRALOGISTICS SYSTEM.

With perfectly coordinated software, a smooth flow of materials becomes possible.



Our software products impress with their high quality and flexibility. We combine sophisticated standard logistics software with modules that are individually tailored to the customer's needs. We collaborate closely with our customers to realize this, starting with a warehouse

management system with comprehensive order picking, a forklift management system, and material flow control systems for automated warehouses. Our software is suitable for every industry.

LTW LIOS WMS

LTW LIOS MFS

PLC-level

automatic warehouse

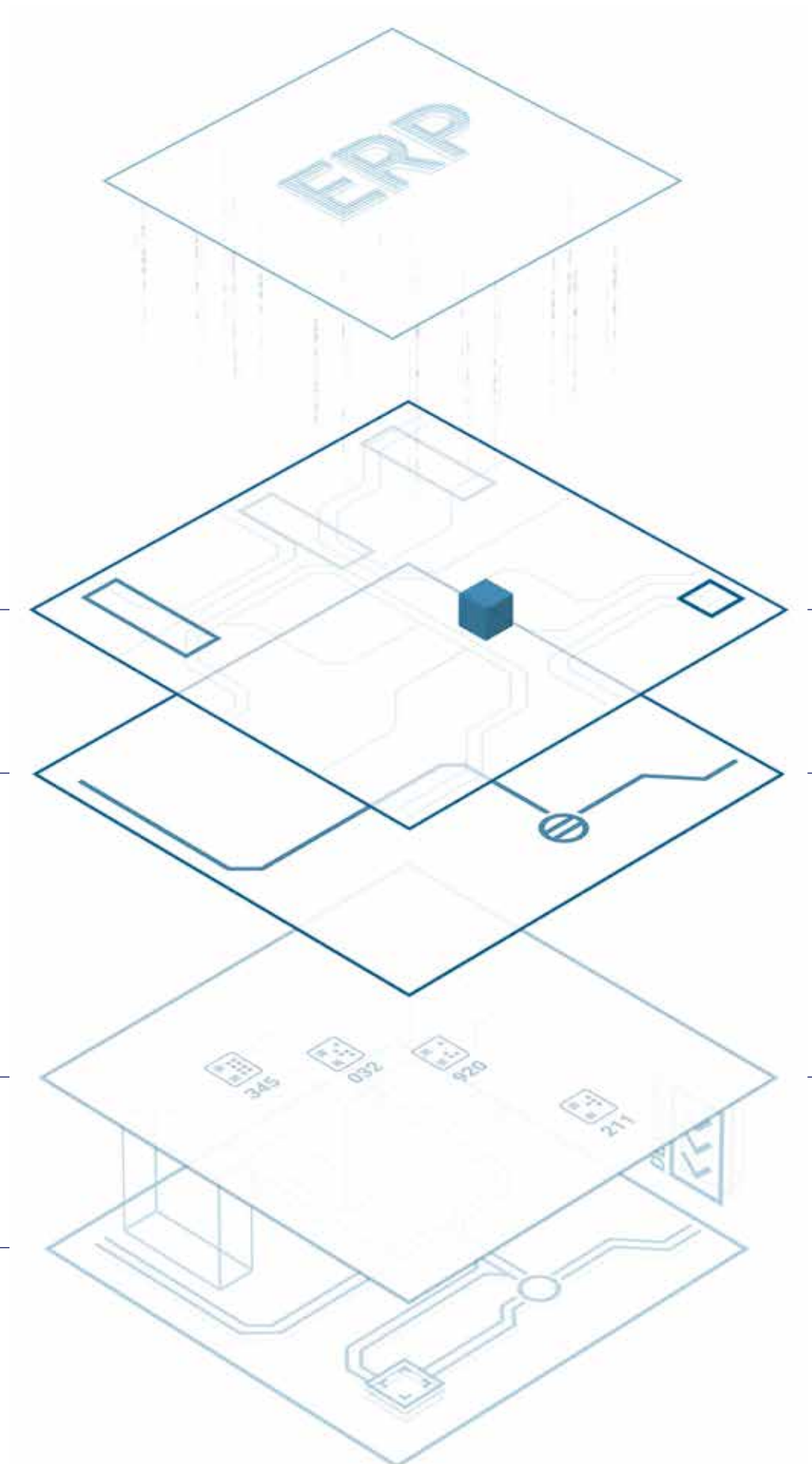

LIOS

LTW INTRALOGISTICS OPERATING SYSTEM

LTW LIOS as key component

Our new LTW LIOS software is an in-house product that was written by our developers. Efficient, user-friendly, and individually tailored to the requirements of our customers – this is how we would describe LTW LIOS. This means we can guarantee a harmonized, optimal, and transparent material flow, entirely free from interfaces – whatever the industry. LIOS features a range of modules and extensions. The core elements are the [LTW LIOS Warehouse Management System \(WMS\)](#) and the [LTW LIOS Material Flow System \(MFS\)](#).

LTW LIOS Cockpit

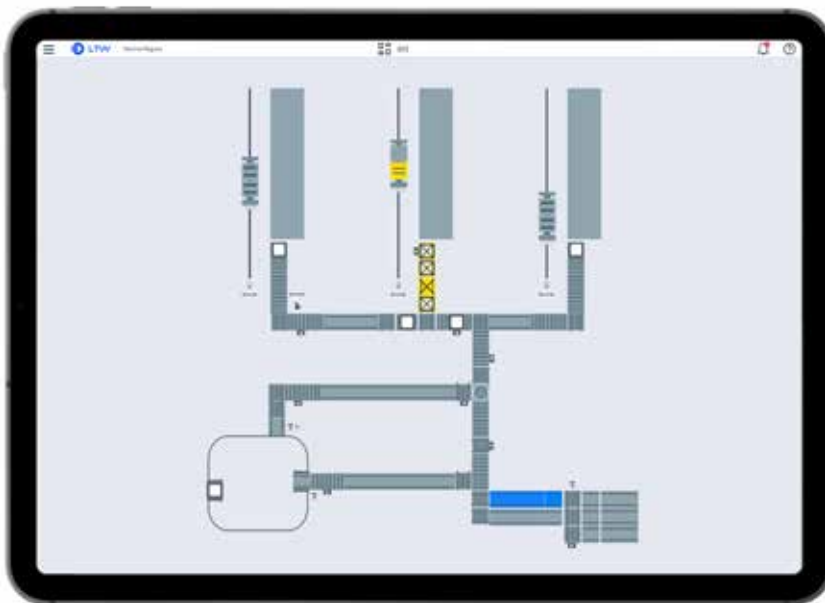

Thanks to its modular design, LTW LIOS can be easily adapted to your individual requirements.

[LTW LIOS Cockpit](#) provides the optimum overview of your system. Thus, the visualization is particularly customer-friendly thanks to the intuitive operation.

[LTW LIOS MFS](#) is responsible for material flow control. This tool allows material flows to be optimized and the efficiency of the entire system to be increased.

[LTW LIOS WMS](#) allows you to exploit the full potential of your intralogistics system. This enables complete warehouse management and comprehensive inventory control. This allows logistics processes to be designed more optimally and efficiently.



MOBILE OPERATOR

Innovation meets operation

Even easier, more user-friendly, and clearer – our systems can now be conveniently controlled via tablet. With the LIOS Mobile Operator, we've elevated manual machine control to a new level. How? Through flexible docking at any operator station, the manual operation interface opens in the familiar LIOS Cockpit, allowing you to get started immediately.

The benefit is that operators can move freely around the warehouse, clearly seeing any faults in the user-friendly LIOS Cockpit interface. In many cases, the infrastructure for this application isn't yet in place during installation, but that's not a problem. Until then, LTW employees can easily and safely operate the stacker cranes using their smartphones.

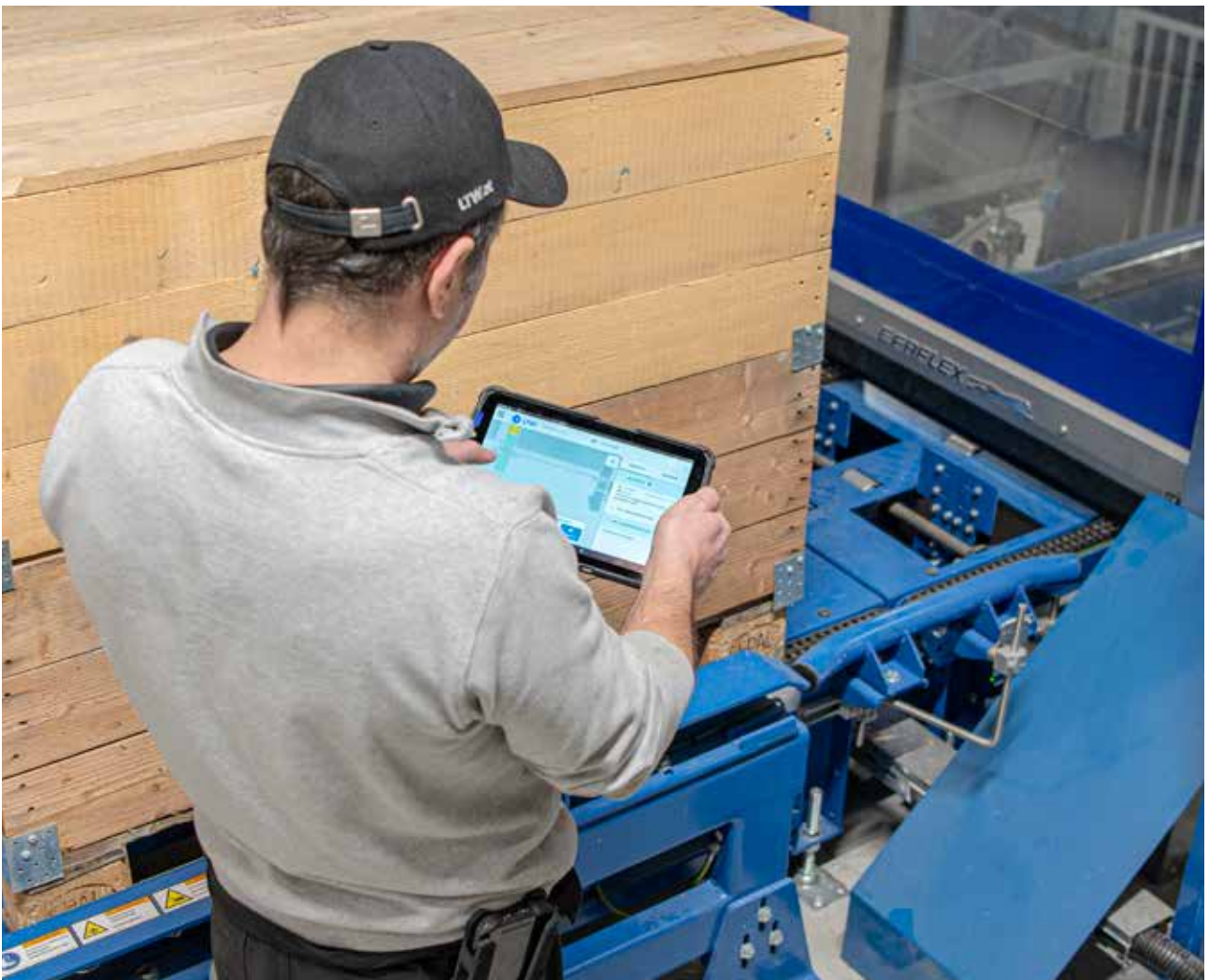

Everything in view

Thanks to the intuitive user interface, LIOS Cockpit, operators always have a complete system visualization at their fingertips, allowing them to address issues as efficiently as possible. If the operator is unable to resolve the problem, they can easily switch to LTWcare and submit a service request directly. This integration makes maintenance, troubleshooting, and commissioning even more straightforward.



**BUT WHY
SHOULD YOU
CHOOSE
LTW LIOS?**



With our new software, you can keep an eye on everything. The **WMS** and the **MFS** are in the background, keeping your warehouse fully under control. The two core modules cleverly work away unseen, solving all problems relating to the flow of goods; regardless of whether this is to increase productivity or minimize error rates. LTW LIOS knows the location of your goods at any time, as well as how to proceed to save time and distance in the flow of

goods. All that you see in the foreground is the new and intuitive **LTW LIOS Cockpit**. The new graphical user interface leaves nothing to be desired: it offers the user a full overview of all components at a glance, allowing them to concentrate fully on the system. But what makes the new interface so special? Because the user interface is intuitive, your employees need no training – operation is simple and self-explanatory.

"As a responsible, full-service partner, LTW will still be there when the project is completed, at any time, as your contact for all your needs, as system renewal, training, and the support of your system."

THOMAS NARBESHUBER, BUSINESS UNIT MANAGER SERVICE

**Full-service provider,
we when your order
time of day. We are
your needs, such
troubleshooting,
supply of spare parts."**

VICE

4

**IF YOUR
SYSTEM ISN'T
WORKING,
WE ARE HERE
FOR YOU.**

**OUR SERVICE TEAM IS YOUR
PERSONAL CONTACT FOR ALL
CASES.**



In terms of **service** you can rely on us. We have made it our mission not just to hand over the finished system, but also to explain the system to your employees on site, and support them during the startup phase. We offer individual training packages for this purpose. The benefits for you? Ideally, you can resolve the problem yourself.

But if you are not able to do this, our new **LTWcare service platform** offers the best support. Together we get to the root of the problem, and guide you through the resolution process. And should you ever need on-site help, our field service engineers are happy to drop by. With LTW, you are in good hands.

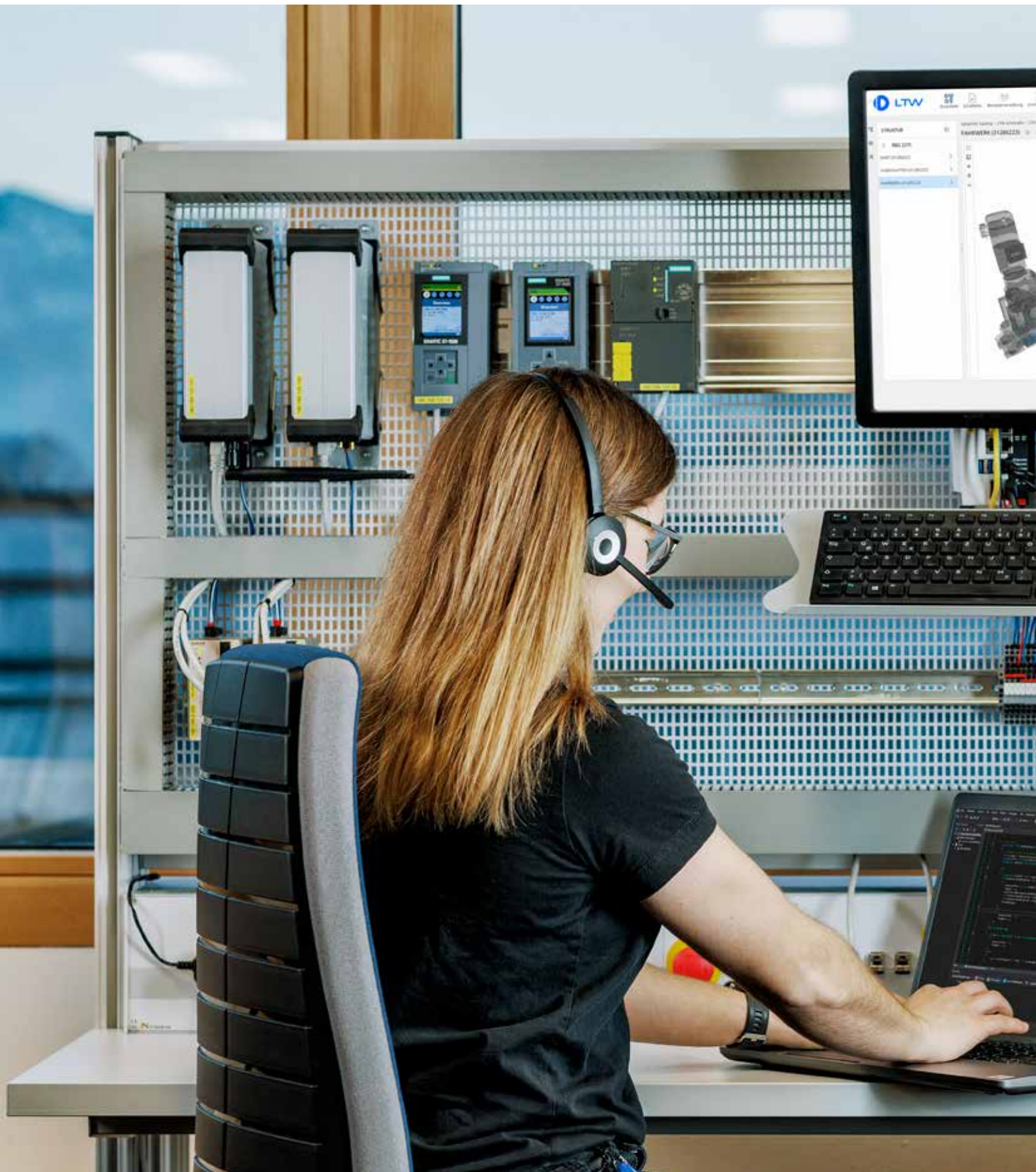



LTWcare – investment in the future

May we introduce: **LTWcare** – our new service platform.

It makes fault reporting, troubleshooting, and fault documentation even easier. LTWcare is a bespoke service offering, catering to customer requirements in terms of digital services.

The platform enables straightforward and efficient maintenance, and allows users to rectify any malfunctions they may encounter. IT security, data processing, and proactive system maintenance have top priority. The extensive product portfolio provides a full overview of the current condition of the system at all times, and from anywhere.

"With LTWcare, it is now possible to obtain a clear overview of system performance. The parameters are constantly monitored, which means we can operate the system efficiently."

MOHRENBRAUEREI VERTRIEBS KG
GÜNTER BRUNNER, HEAD OF SALES



READ MORE
ABOUT LTWcare:



The **LTWcare** product portfolio comprises nine different modules. These modules have been specifically tailored to suit the needs of our customers and are constantly being further developed. Troubleshooting is now even easier and more efficient thanks to these modules – everyone involved knows what needs to be done and when.

LTWcare Diagnostics afford the technician an excellent overview of the system and the defined KPIs are always in sight. Should a malfunction occur, the maintenance team can access the system documentation via tablet or cell phone and endeavor to find a solution, all thanks to

LTWcare Content. If this does not rectify the issue, a service request can be sent quickly via the **LTWcare App** using the **LTWcare Console**. Once our service team has been informed, connection to the system only takes place with your express consent.

Communication takes place via the **LTWcare Conference Center** – and transparency is a top priority here. Every step is logged. Once a fault has been rectified, the connection is disconnected and the full service case history is stored in the knowledge base.



CUSTOMER CARE CENTER

Welcome to the Customer Care Center

Where every need is met with dedication. As a full-service provider, we ensure that our support continues even after the system is completed, offering a comprehensive range of services. At the Customer Care Center, your needs always come first. Whether it's a classic service call, phone support, a maintenance visit, or spare parts procurement, we're here to assist. Additionally, our service team is ready to support you in system modernization and provide training courses tailored to your specific requirements.

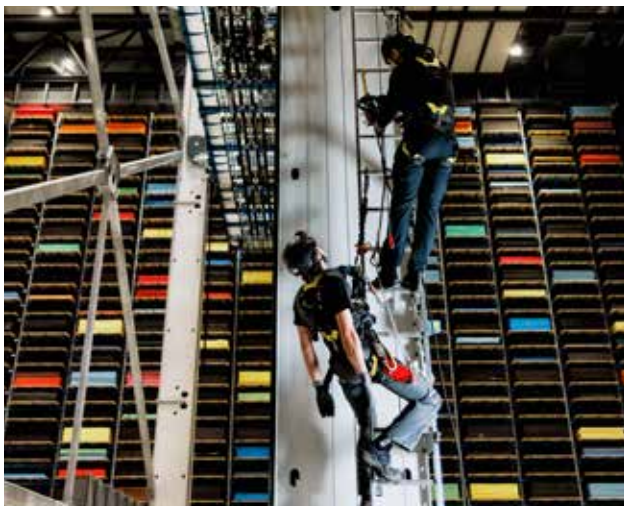



PERSONAL SUPPORT & HOTLINE

We help you in the right place

Our service team is always here for you. Whether you need a dedicated point of contact to assist with all your concerns and ensure you receive prompt help, or if it's a matter for our hotline, our experienced team is ready to provide fast and expert support over the phone.

MAINTENANCE & SPARE PARTS

After-sales is very important to us

Regular maintenance is essential for ensuring the longevity and efficiency of your system. Through scheduled maintenance visits, we help keep your system in optimal condition and minimize downtime. We also offer a comprehensive selection of spare parts. To give you added peace of mind, we can assemble system-specific spare parts packages for you, or you can place individual orders online via our digital spare parts catalog.



TRAININGS

Know-how transfer

To ensure the smooth operation of your automated systems, LTW provides the necessary expertise through tailored training. We offer on-site training or sessions at our head-quarters in Wolfurt. Topics such as system operation, safety protocols, and height rescue are just a few examples of the areas covered in our training programs. After all, while our support is always quick, being able to troubleshoot and resolve issues independently will always save you time.



READ MORE
ABOUT OUR
TRAININGS HERE:



RETROFIT BY LTW

Minimum intervention, maximum effect

Is your system no longer state-of-the-art? Failures are accumulating, or spare parts are no longer readily available? Then you urgently need to contact us.

Every system part has its own life cycle. Electronic components in particular – unlike steel components – have far shorter lifetimes. Which is why, eventually, the system starts to be less reliable – there are more disruptions, maintenance costs increase, and longer, unplanned downtimes become reality.

LTW – indispensable

And this is where we come into play. As the intralogistics system is a central interface between production and dispatch in many companies, the availability of intralogistics is a top priority. To maintain this availability, we whip your system back into shape.

Here at LTW, thanks to the experience gained from more than 550 retrofit projects, we can cover the entire range of services: from consulting, to engineering, to conversion, recommissioning, and after-sales support. In many cases, customized system modernization restores performance to the level of a new installation.



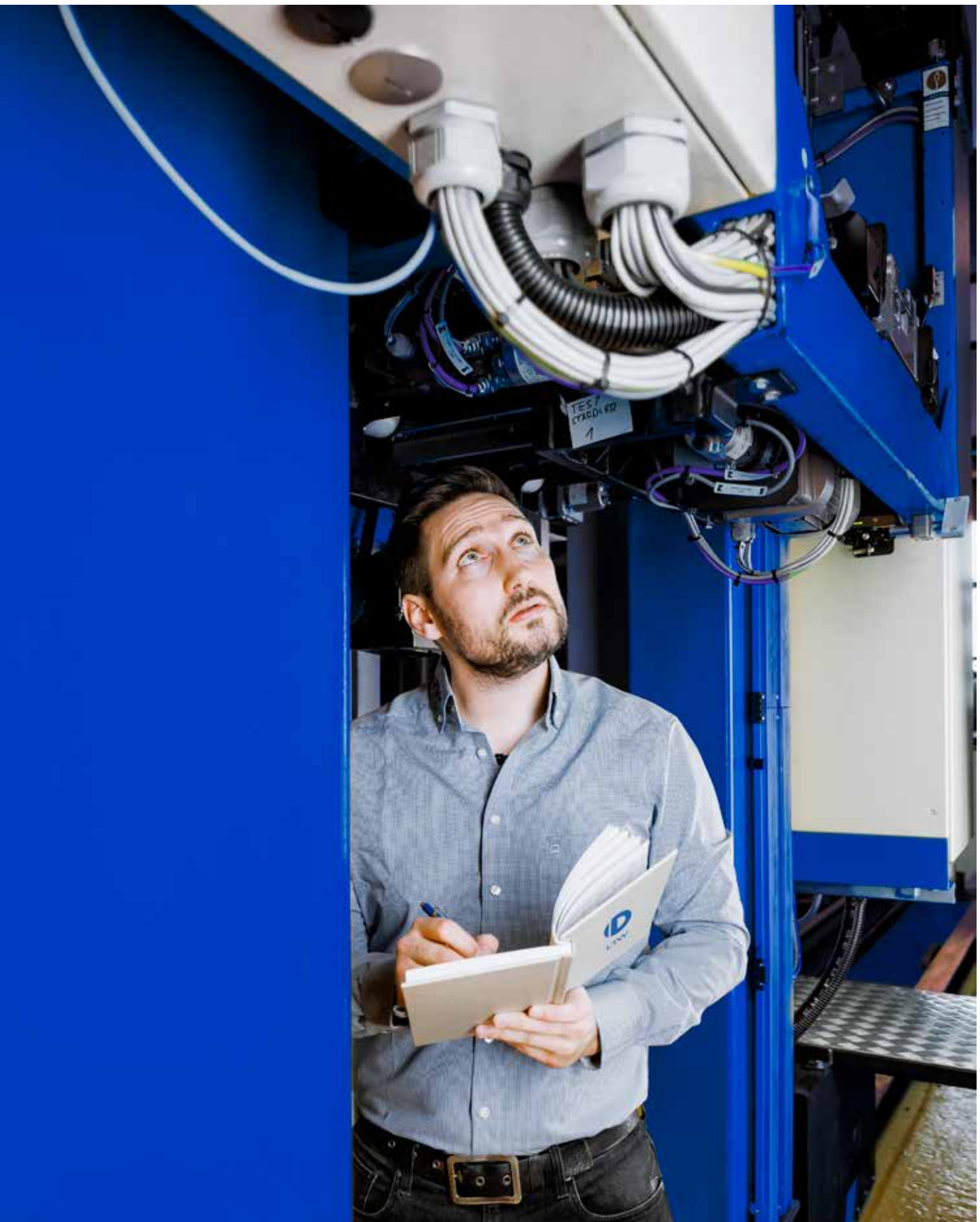

LTW, the problem solver

But how do we go about it? We support you from start to finish. Our **retrofit team** takes stock on site, and gets to the root of the weaknesses in your system. Always keeping an eye on the **cost/benefit factor**, of course. To minimize downtimes, the implementation either runs while operation is ongoing, or in stages.

Performance at the level of a new installation

Not only do we replace components, we also offer complete system refurbishment if desired – regardless of whether third-party installations or LTW systems are involved. The aim is to restore performance to the level of a new installation through customized system modernization, with minimal interruption to business operations.

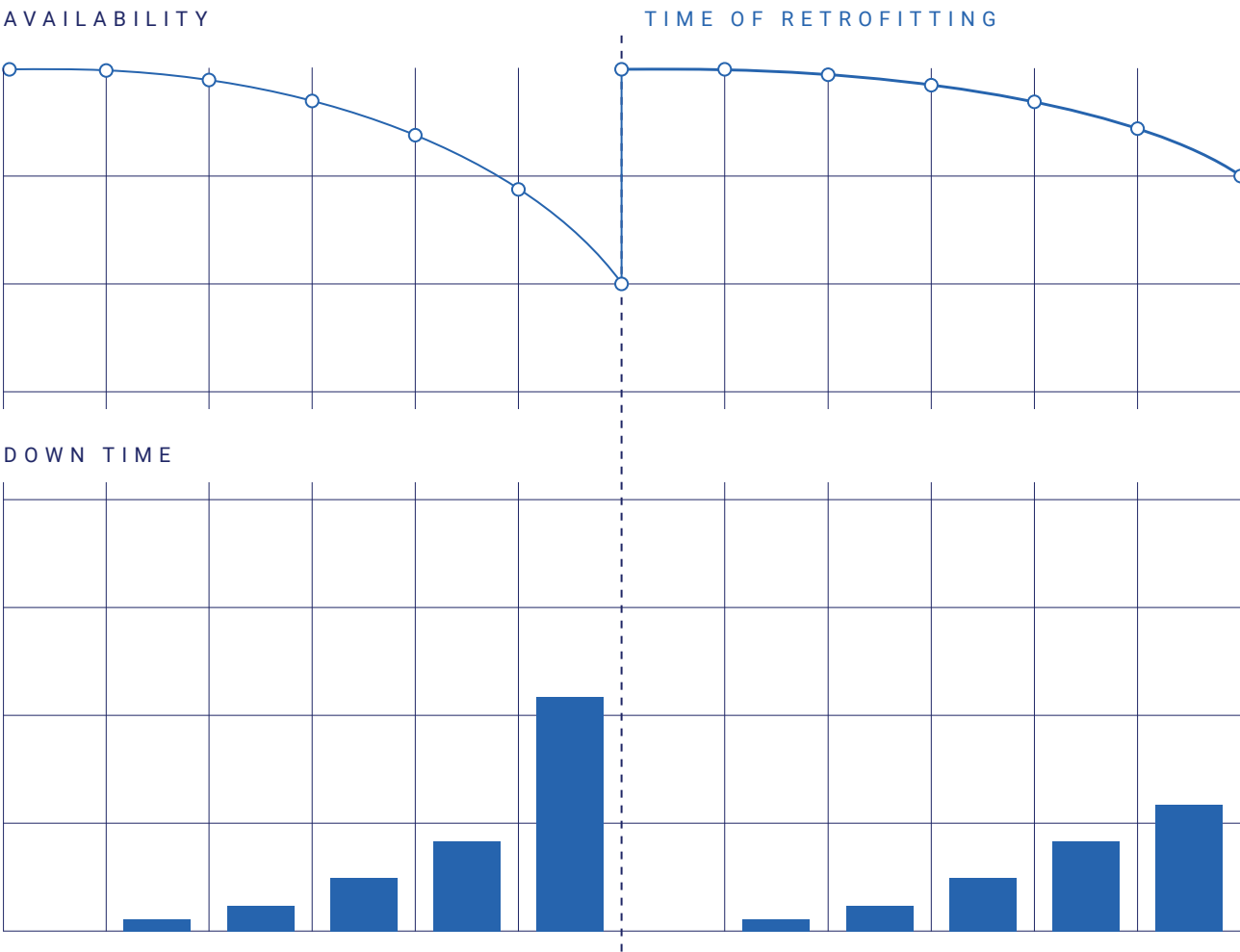

REPLACEMENT SOFTWARE

With system modernization, replacing the software is usually the biggest headache for our customers. Upgrading the old logistics IT to the current state-of-the-art initially feels like open heart surgery. But we would like to reassure you here too: our years of experience are the ideal basis for implementing new software. You benefit from a partner with top-notch expertise, and modern

software that significantly boosts functionality. Thanks to our newly developed system simulation, we can first test the changeover on a specially created digital twin, before the system goes live. This way, we can avoid unpleasant surprises.

Let's get talking.

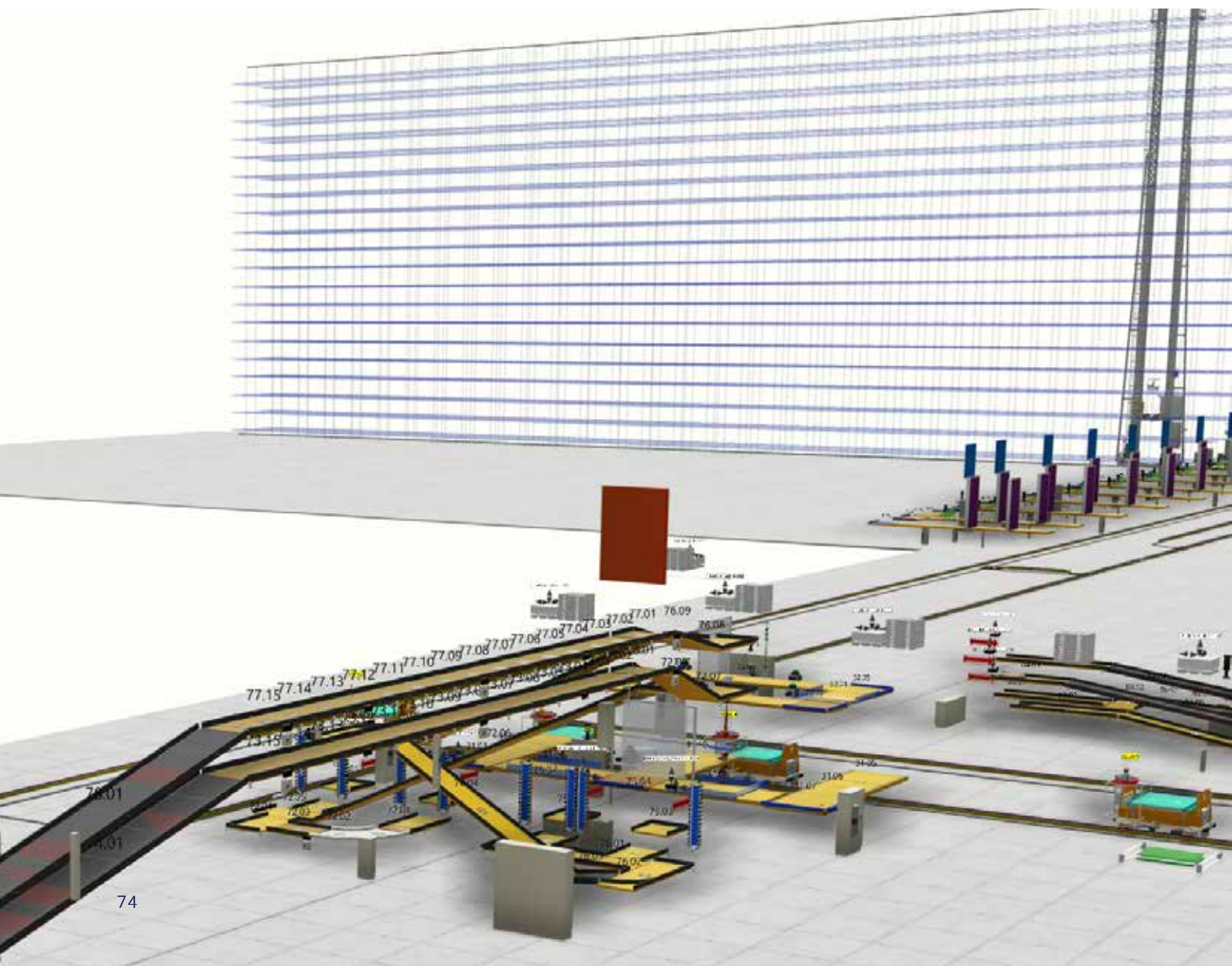

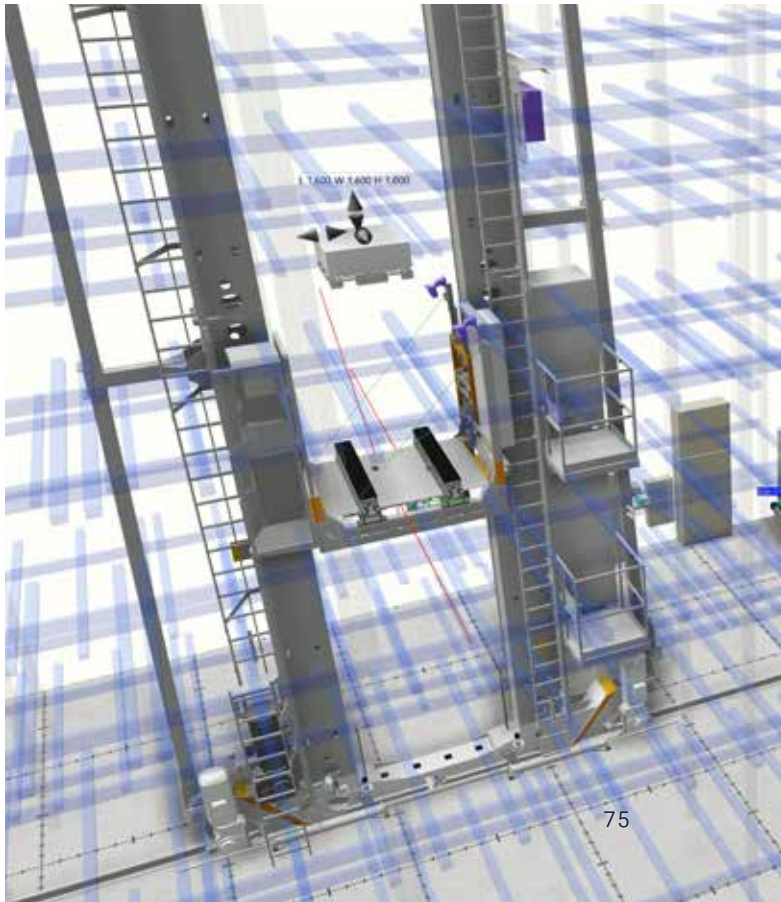
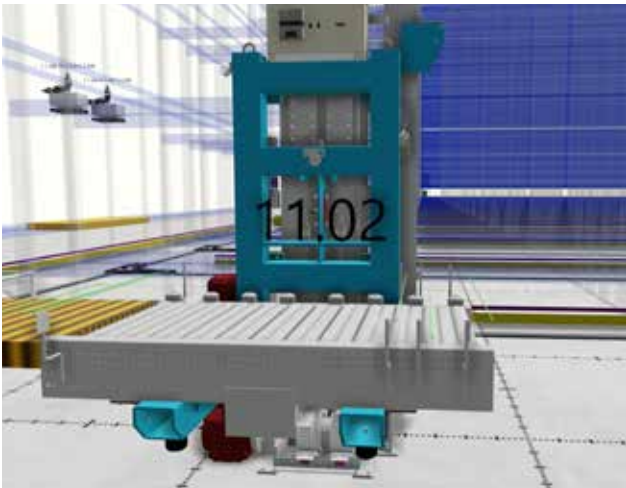
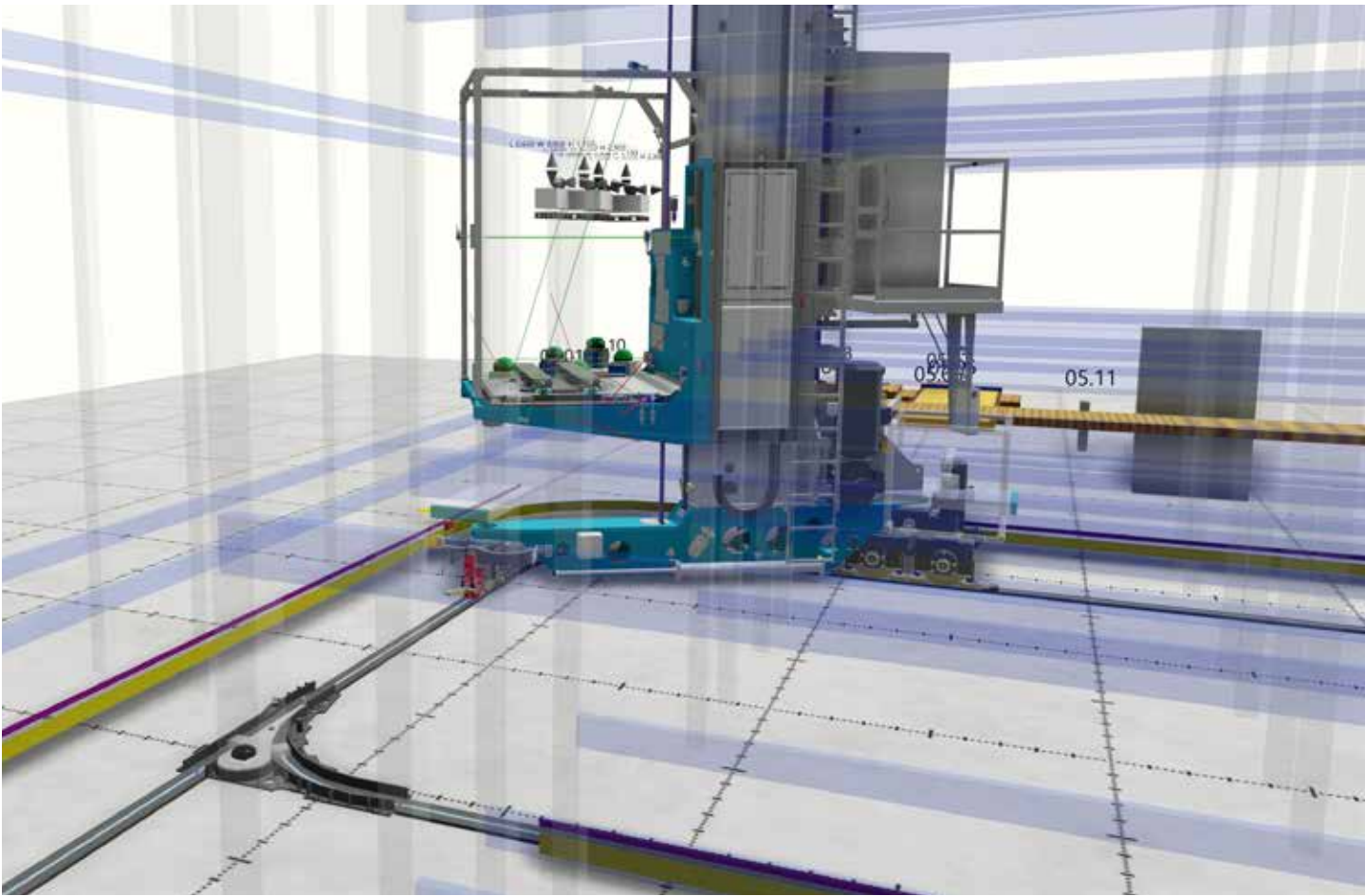



11er Nahrungsmittel GmbH

After more than a decade of operating a third-party intralogistics system, frozen food specialist 11er in the Austrian town of Frastanz was encountering frequent disruptions and interface problems. To make things worse, the individual components were being delivered by different suppliers, meaning that the responsibilities were unclear.

Thanks to the retrofit of the third-party system by our technicians, the system availability has been restored to peak performance. By modernizing the stacker cranes, the conveyor systems, and the software, it was even possible to increase the handling capacity by 15%.

1991: installation of a third-party system

2005: modernization of the system,
modernization of stacker cranes,
conveyor systems and software,
deep-freeze warehouse (-28° C)

2022: extension by a new deep-freeze high-bay
warehouse with three stacker cranes,
modernization of 3 stacker cranes
in the old warehouse,
extension of the conveyor system,
extension of the software

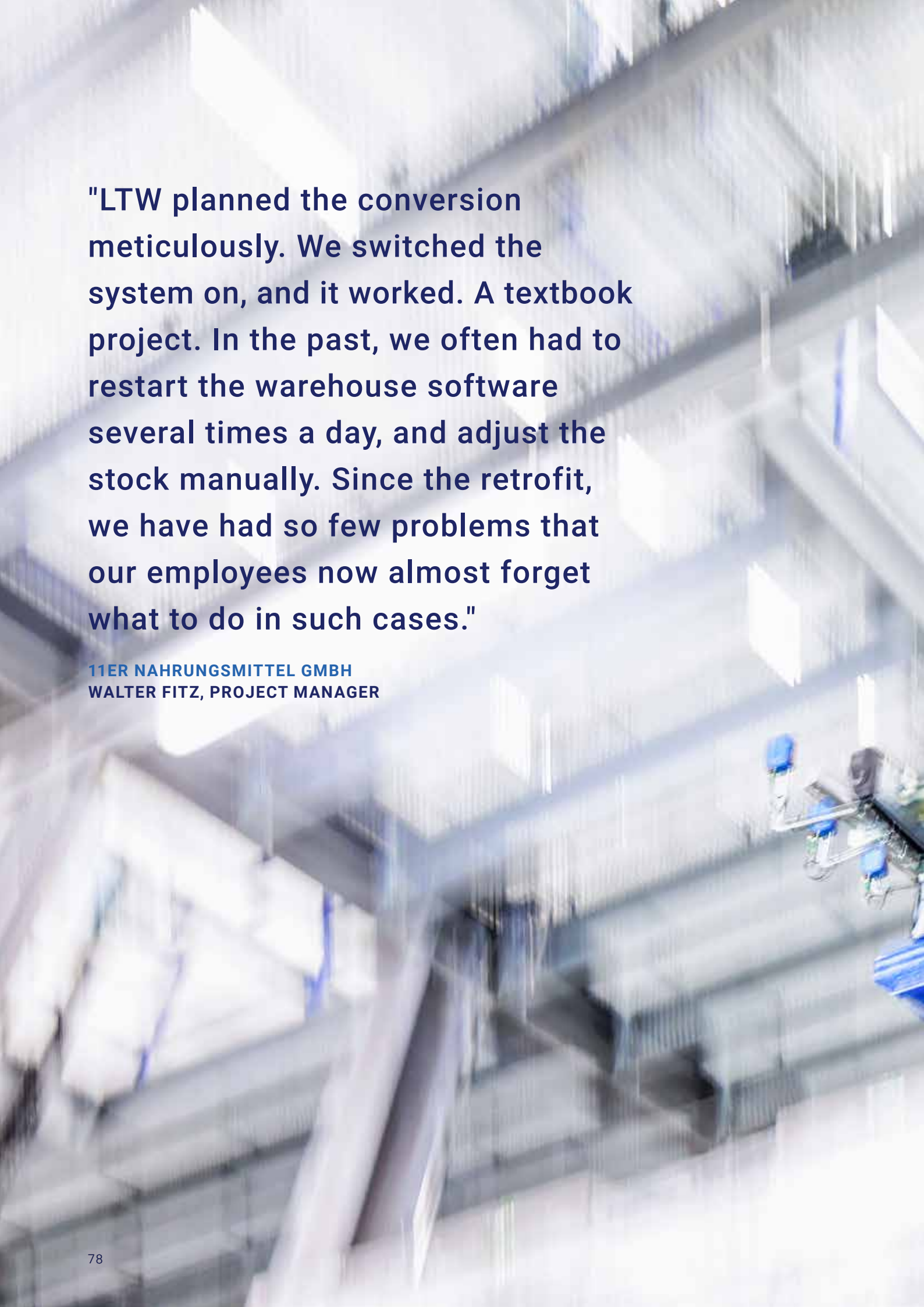

"LTW planned the conversion meticulously. We switched the system on, and it worked. A textbook project. In the past, we often had to restart the warehouse software several times a day, and adjust the stock manually. Since the retrofit, we have had so few problems that our employees now almost forget what to do in such cases."

11ER NAHRUNGSMITTEL GMBH
WALTER FITZ, PROJECT MANAGER



**"Our unwavering spirit and
the ability to get a feel for
elementary requirements are
instrumental in turning
those who started out as
customers, often in fact as
Thanks to our wide-
of the industry, we have
almost every requirement**

KONRAD EBERLE, CEO

**spirit of innovation and
level for our customers'
ments have been
g many parties – even
t being critical – into
ce-to-face meetings.
ranging knowledge
ave the answer to
ement."**

WE ARE LTW

LTW INTRALOGISTICS – THE EXPERTS FOR DEVELOPING AND IMPLEMENTING TURNKEY INTRALOGISTICS SYSTEMS

We meet your requirements with regard to organization, control, implementation, and optimization of your internal goods and material flows.

Here at LTW Intralogistics, we are engineers of flow. There is no such thing as standing still for us. For more than 40 years, our name stands for top quality and maximum precision. We have shown productive continuity in more than 1000 successfully completed projects – in over 35 different countries. Always on time, always on point.







SOLUTIONS BY LTW



Our turnkey solutions stand for maximum system availability, optimum use of space, and safe storage of a variety of different products. Custom solutions are no problem for us; in fact, they are one of our specialties. Our customers

benefit from our industry-neutral approach. Regardless of whether it involves the food industry, industrial goods, the automotive industry, or the pharmaceutical industry.

TRUST BREEDS LOYALTY

We work continuously with partners to develop innovations for our customers and have experience all over the world. As a company steeped in tradition, a handshake still means something to us. We keep our word. Two-thirds of our customers feel the same way: they are repeat customers, which confirms the quality of our services, and our adherence to deadlines and budgets.



Facts

CONTINENTAL BARUM S.R.O

- 41 projects in 8 countries
- 84 stacker cranes
- awarded A-Supplier status every year since 2010
- "Best Supplier in the Category High Bay Storages & Automation" award



„We have known LTW at our Continental plant for more than 10 years as a very reliable supplier. We specify the key data and requirements and LTW provides suggestions for implementation.“

**CONTINENTAL BARUM S.R.O
MICHAEL ŠTEFKA, HEAD OF MTE**



OVER
600
SYSTEM MODERNIZATIONS/RETROFITS

OVER
330 EMPLOYEES
WORLDWIDE

5 LOCATIONS

WOLFURT (AT)
WIEN (AT)
GLEISDORF (AT)
ILLERKIRCHBERG (DE)
DENVER (USA)

OVER
2,400
INSTALLED STACKER CRANES



OVER
1,000 PROJECTS
MORE THAN 35 COUNTRIES

OVER
500
INSTALLED SOFTWARE
SOLUTIONS

OPERATING ON A GLOBAL SCALE

Our systems can be found in more than 35 countries throughout the world. Our customers include multinational companies as well as small and medium-sized enterprises. The European and global markets are covered by the head

office in Wolfurt (AT) and our office in Illerkirchberg (DE). Our Vienna branch supports us in all software matters. A sales and service team is available in Emigsville (USA) to offer our American customers help and advice.

OUR DEVELOPMENTS

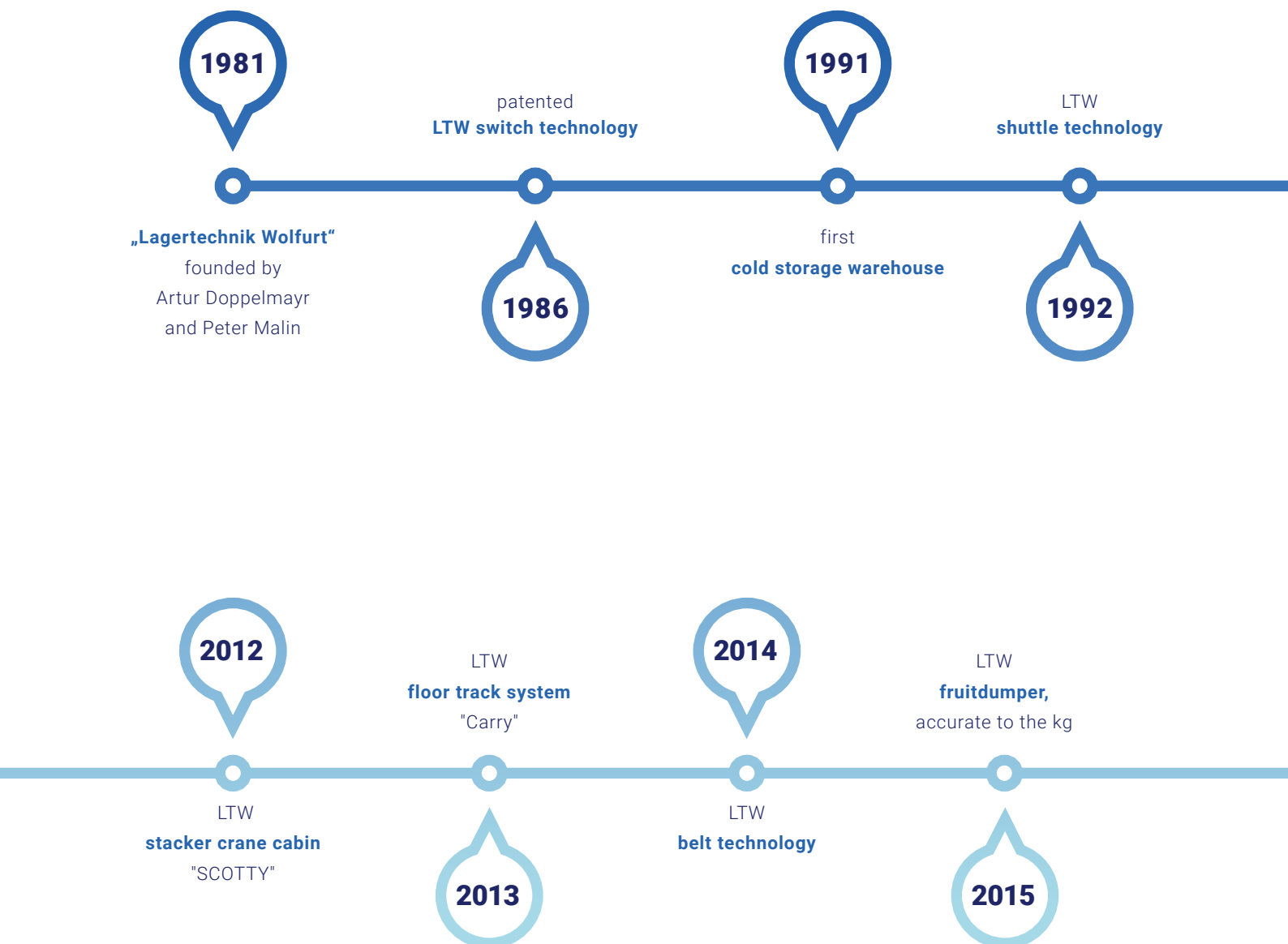

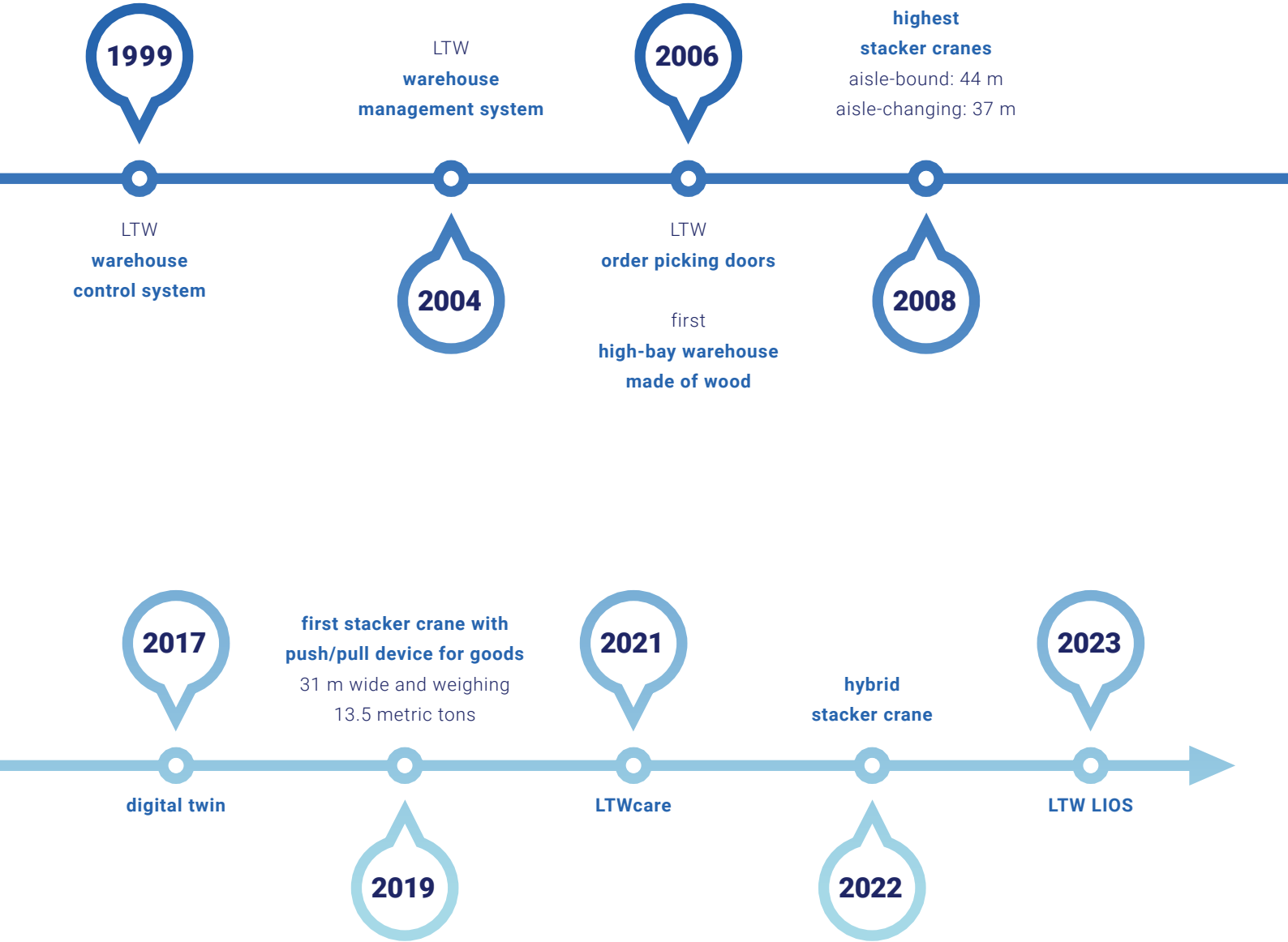

DOPPELMAYR, STRONG SUPPORT IN THE BACKGROUND

LTW and Doppelmayr – the perfect match. As part of the Doppelmayr Group, we enjoy advantages that benefit you. Because production according to ropeway standards is one of our most outstanding quality features.

Did you know we are part of the [Doppelmayr Group](#)? This giant in the ropeway construction industry wanted to compensate for seasonal fluctuations in production, so entered intralogistics in 1981. Now we are a mainstay of the Doppelmayr Group.









"Since the company was founded more than 40 years ago, LTW has become established as a full-service provider for intralogistics. We are proud to have a company with innovative intralogistics solutions in the Doppelmayr Group. I am certain that we will be hearing much more about LTW outside the traditional intralogistics sector as well – especially where goods logistics solutions in cities are concerned. Together with ropeways, we can create powerful logistics solutions for the future."

DOPPELMAYR HOLDING SE
THOMAS PICHLER, EXECUTIVE DIRECTOR

Facts

DOPPELMAYR

Doppelmayr was founded in 1893 by Konrad Doppelmayr as a family business. It started with tool manufacturing, and it was 1937 before an interest in the lift business developed. Today, Doppelmayr is the global market leader for ropeway systems and has successfully completed more than 15,100 installations worldwide. Doppelmayr ropeways can be found in over 95 countries. The group of companies is represented in 50 countries throughout the world.





THE BENEFITS FOR YOU

This connection is good for everyone. Doppelmayr and LTW benefit from mutual expertise and from the good reputation we enjoy in the industry. Manufacturing quality is another important factor, as Doppelmayr makes our components, such as stacker cranes, vertical conveyors, rail systems and many more. What does that mean for you? Not only security and stability, but keeping to our major

quality commitment – guaranteed. Ingenious designs and extremely narrow production tolerances ensure precise material handling from our stacker cranes, even at a height of 40 meters or more. This allows us here at LTW to concentrate fully on planning and designing unique solutions for our customers, while we use Doppelmayr's expertise to produce our components.



"Our production plants are the ideal platform for all the production requirements of the Doppelmayr Group. Everything we produce is of the highest quality, our employees always have the latest information. Be it in terms of ropeways, cable liners, stacker cranes, or know-how: we are always up to date."

DOPPELMAYR SEILBAHNEN GMBH
KARL-HEINZ ZÜNDEL, HEAD OF PRODUCTION



Facts

PRODUCTION IN WOLFURT

- production: Werk Hohe Brücke Wolfurt
- assembly: Werk Güterbahnhof Wolfurt
- over 350 employees
- over 20,000 tons of steel processed annually

AN EXCEPTIONAL JOINT PROJECT

Together with Doppelmayr Seilbahnen GmbH, we successfully installed a unique system for the combined transport of passengers and goods – all at an altitude of up to 3,454 meters: a specially developed loading robot takes the goods up and down the mountain in special cargo gondolas in the Eiger Express (CH). What's more, the first fully automatic rail car loading and unloading station was installed at Jungfrauoch (CH).

SCAN HERE TO
READ MORE:









"We are very proud of this system. It not only leads the way for the automated goods transport of the future, it also hugely simplifies the daily work carried out by our employees. Supplying goods to Europe's highest railway station is now even faster and much easier."

JUNGFRAUBAHNEN AG
URS KESSLER, CEO



SUSTAINABLE BEHAVIOR

The Doppelmayr Group

From ropeways to automated high-bay warehouses, all companies within the Doppelmayr Group are committed to creating a better future. Whether it's urban mobility in cities or intralogistics solutions, our focus is on sustainability. The key advantages are clear: low emissions and zero harmful exhaust gases, which significantly reduce our ecological footprint. Additionally, the space saved by implementing cable cars and high-bay warehouses frees up areas for more green spaces and public squares, contributing to a more sustainable and less soil sealing.

Intralogistics and sustainability

Our intralogistics solutions play a key role in promoting sustainability.

How?

Primarily through the space-saving design of high-bay warehouses, the use of energy-efficient technologies such as hybrid stacker cranes, and the integration of renewable energy sources. For example, we power the hybrid stacker crane in our own high-bay warehouse with energy generated from our photovoltaic (PV) system, demonstrating our commitment to sustainability in every aspect of our operations.

VISION

THE FUTURE OF INTRALOGISTICS

Looking ahead

The worldwide increase in demand for consumer and industrial goods requires efficient warehousing and logistics concepts to quickly and with the least possible effort to manage the logistics of transporting goods in the future. To address these growing demands, automated and space-efficient solutions will be essential for maintaining the flow of both passengers and goods. As the Doppelmayr Group, we are

already working on pioneering projects today to meet these needs. How? By combining our expertise. In the cities of the future, both goods transport and passenger traffic will need to be integrated and optimized. To keep up with this development, expertise in both material and passenger transport is crucial. And who could combine these areas of expertise better than the companies of the Doppelmayr Group?



VISION

MULTIMODAL FLOW OF GOODS

Focused, effective, efficient

The worldwide increase in demand for consumer and industrial goods requires efficient warehousing and logistics concepts to quickly and with the least possible effort to manage the logistics of transporting goods in the future. This is why the cities of the future will require innovative solutions for handling goods both in and out of urban centers. Thanks to our advanced technologies, we can

make a significant contribution to this vision. Multimodal or intermodal transshipment facilities not only save space but are also completely silent and produce no light emissions, thanks to their design. In particular, in urban environments with existing infrastructures, such integrative solutions are real game changers that are widely accepted.



IMPRINT

Media owner and publisher:

LTW Intralogistics GmbH · Achstrasse 53 · 6922 Wolfurt · Österreich

+43 (0) 5574 6829-0 · office@LTW.at · www.LTW.at

Concept: LTW Intralogistics GmbH

Editorial: Lukas Moosmann (LTW Marketing)

Text: Christine Längle (LTW Marketing)

Graphics/Design: Benedikt Sabato (LTW Marketing)

Text support: Klaus Feldkircher (Tria Log Kommunikation GmbH)

Photos: Markus & Karin Gmeiner (Matak Studios Fotografie & Film OG)

LTW Intralogistics GmbH (p.10, 22-23, 32-33, 36, 40-41, 54-55, 67, 74-75, 83)

Doppelmayr Seilbahnen GmbH (p.29, 84-85, 92-93, 94-95, 96-97, 98-99, 104)

Garaventa AG (p.100-101, 102-103, 107) · Haberkorn GmbH (p.14-15) · Michael Gunz (p. 61)

Robert Keller (Schwarzach Packaging GmbH, p.84-85, 106) · Kern Studer AG (p.11)

Renderings: Florian Hofmann (tannen:bach Filmproduktion, p.12-13, 64-66, 56-57, 66)

Animations and More (3D Communications, p.37)

Printing: MRS Digitaldruck OG

2nd edition 03/2025: 100 pieces

For reasons of better readability we refrain
from gender-specific formulations.

Typesetting and printing errors excepted.



LTW.AT

Your Intralogistics Provider