



TOGETHER  
WE  
BUILD  
SUCCESS

---

# POWERHOUSE of creative industrial service solutions for a Better Tomorrow

2025 08 22



# STRUCTURE

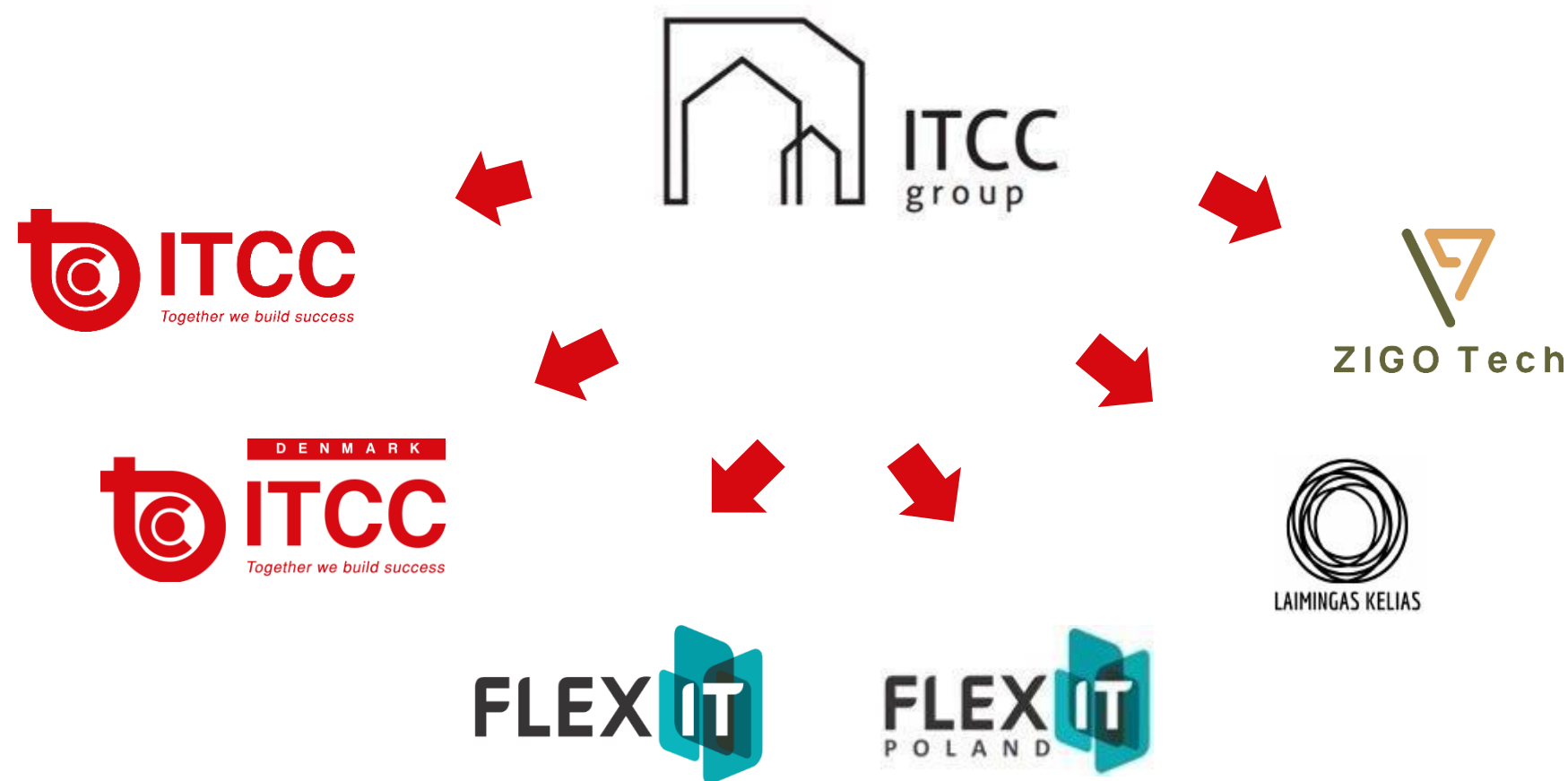

# ITCC VISION

To be responsible and innovative company, which is the first choice for engineering project management.

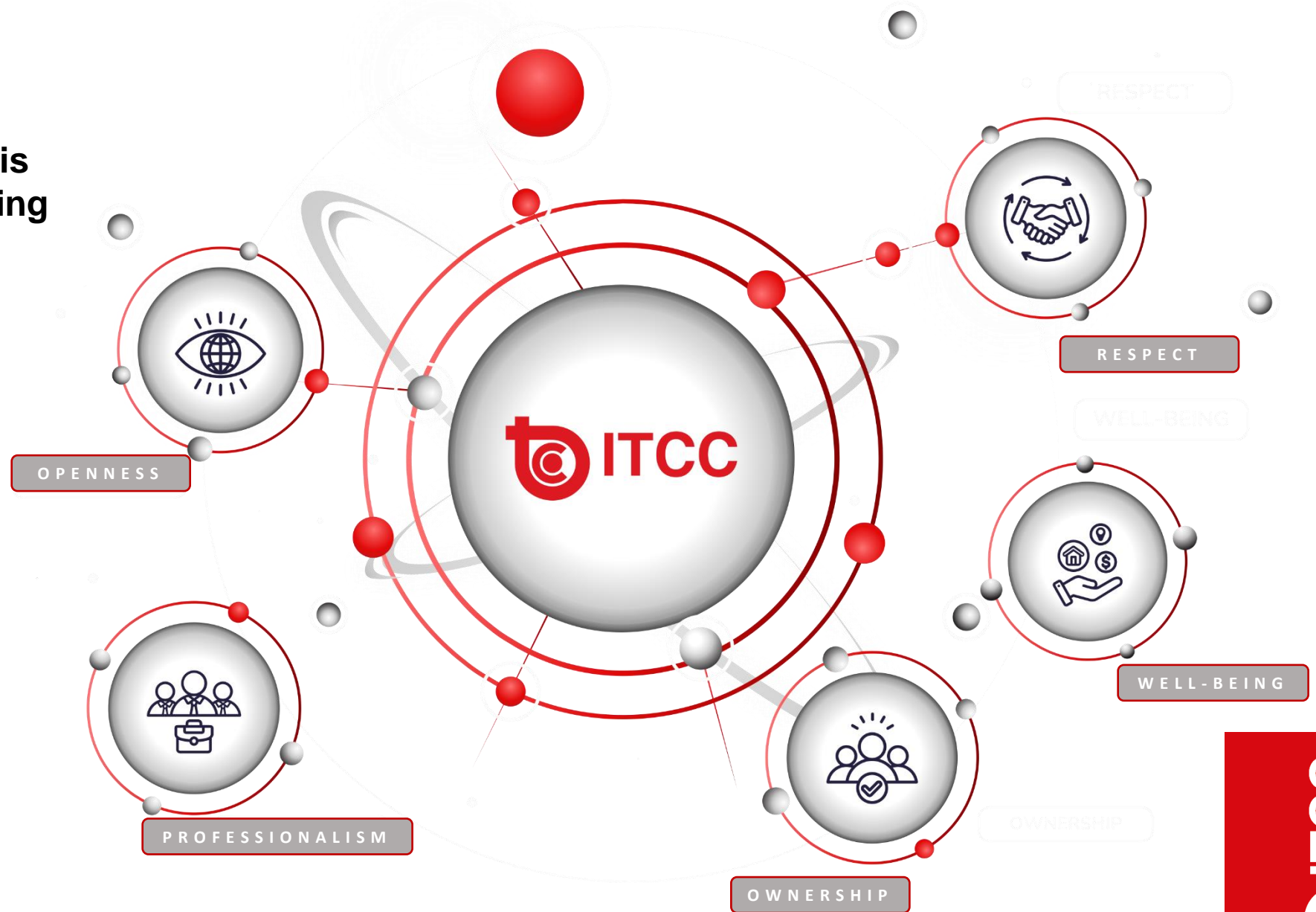

# SUSTAINABLE GROWTH. QUALITY AND SAFETY

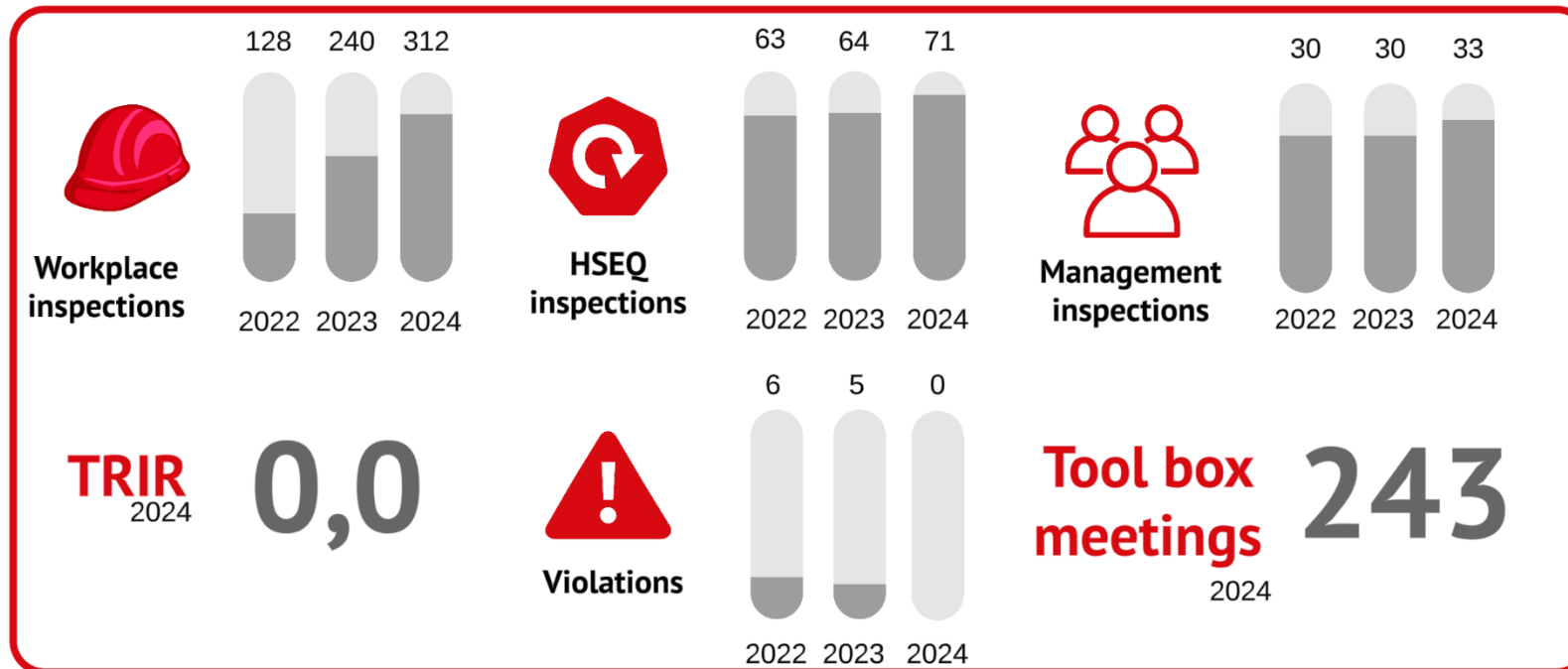

# SUSTAINABLE GROWTH. PEOPLE.

Total number of employees

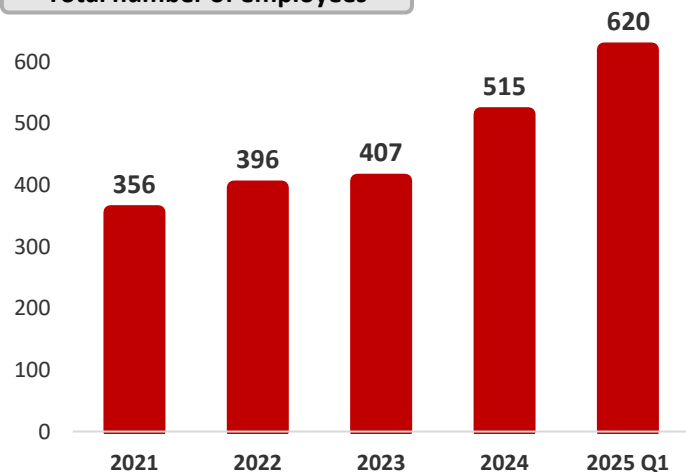

Nationalities TOP5 (%)

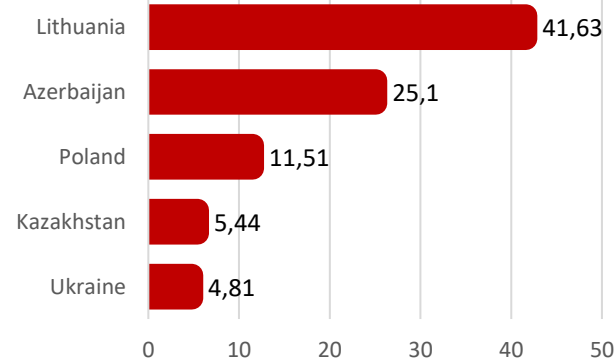

**Attractive work benefits and valuing of each worker makes ITCC a well-desired Employer and allows us to grow.**

Nationalities (%)

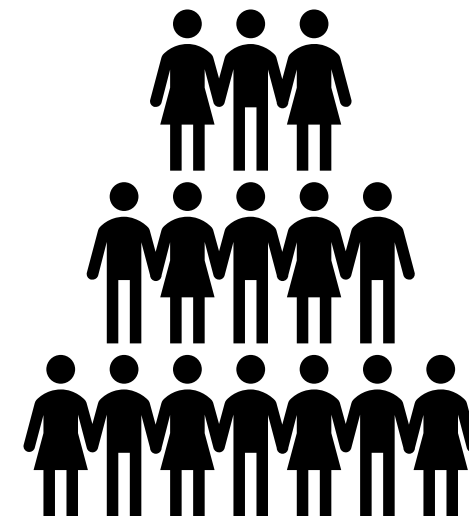
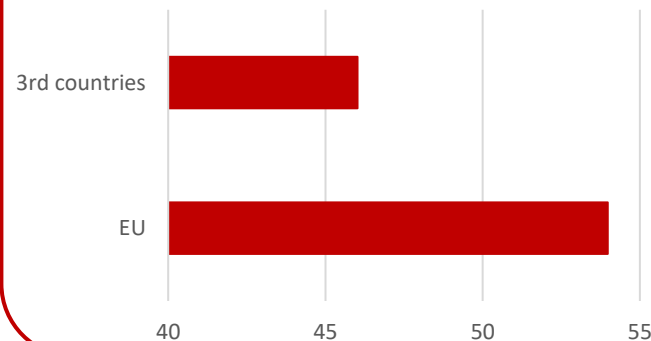

# **SUSTAINABLE GROWTH. BEST KNOW-HOW.**

## **ITCC COMPETENCE CENTER**

### **CERTIFICATE COURSES**

#### **SCAFFOLDING COURSES®**

Dutch Richtlijn Steigers

#### **INSULATION COURSES®**

CINI Manual

#### **VCA COURSES**

B-VCA

VOL-VCA

VIL-VCU

### **ITCC ACADEMY**

#### **CONTINUOUS EDUCATION**

15 courses for Insulators  
and Scaffolders

Foreman program

Courses for office team

### **COMPETENCE CENTER**

#### **QUALIFICATION TESTS FOR:**

Scaffolders

Insulators

Prefabrication  
Specialists



# ITCC SERVICES

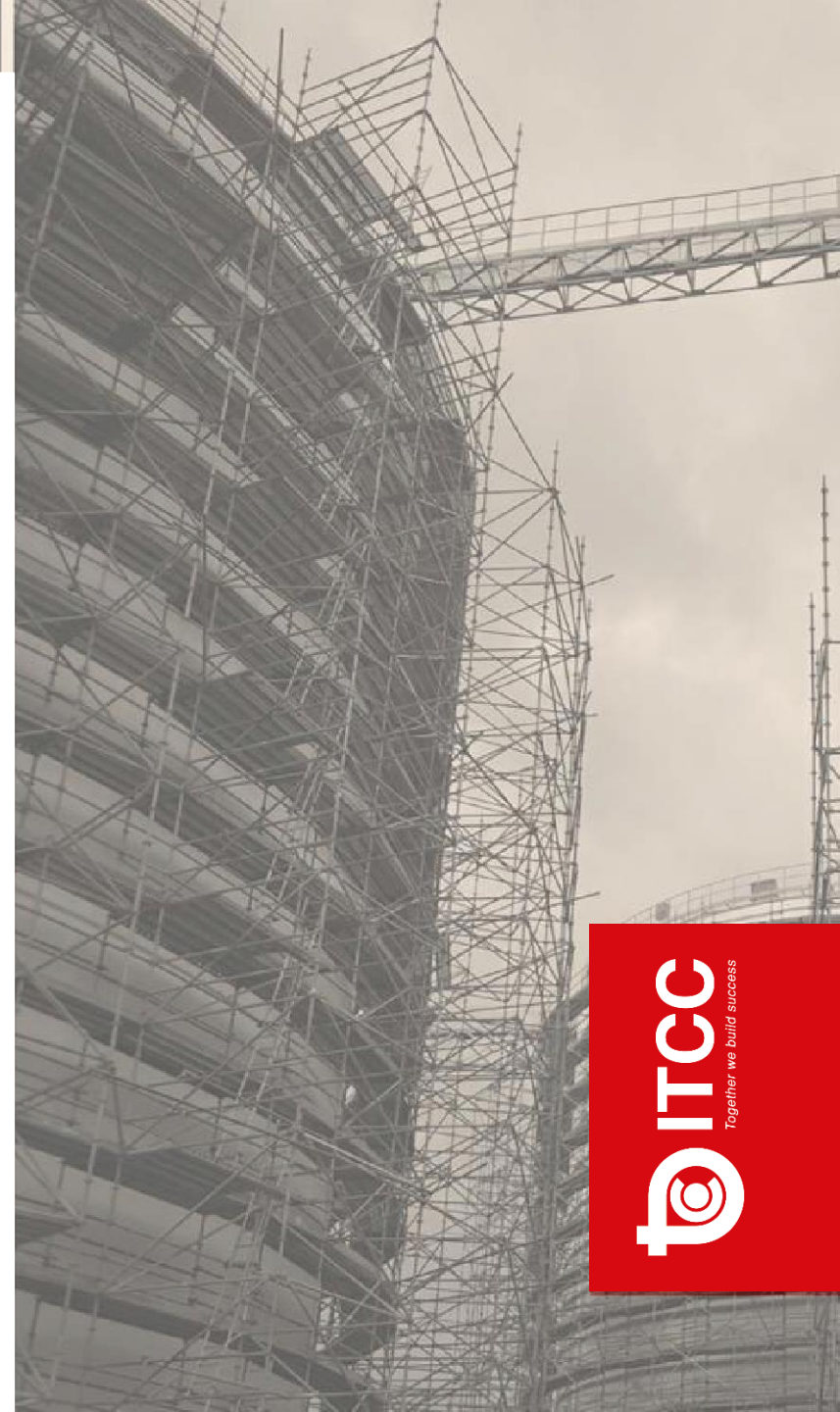



# SCAFFOLDING

LAYHER scaffolding system

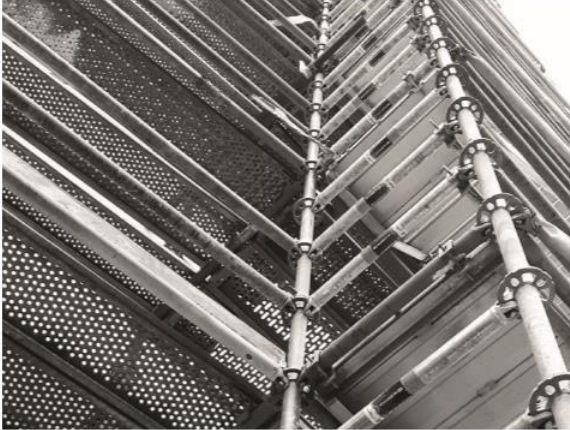

We specialize in:

**SCAFFOLDING ERECTION**  
**SCAFFOLDING DISMANTLING**

3D Scaffolding designs according to  
**EC 3 standards:** modelling, linear  
analysis, results, reports, made with  
**Scia Engineer 20** software.

Owned by ITCC:  
1040 t

 X 42

Capacity with partners:  
10 000 t

 X 500

**ITCC**  
Together we build success



# SCAFFOLDING 3D ENGINEERING



3D Model BASF Ludwigshafen  
(Germany)

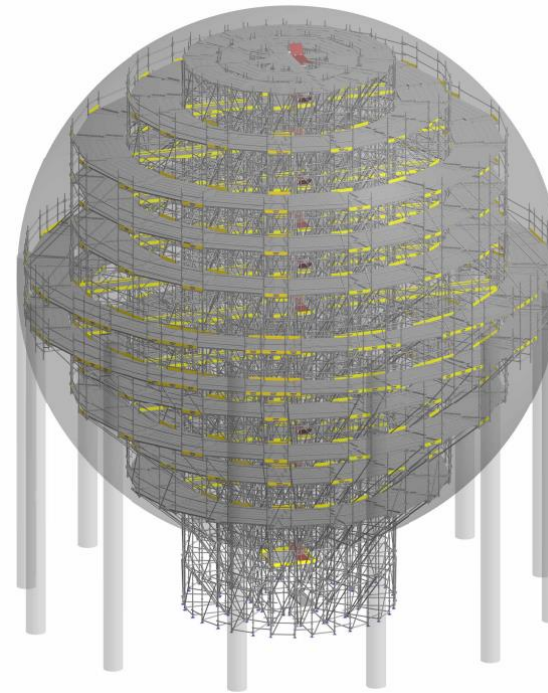

3D Design of 4 Spheres – 7,000 m<sup>3</sup> Each | Liquid  
CO<sub>2</sub> Storage Project | Port of Antwerp

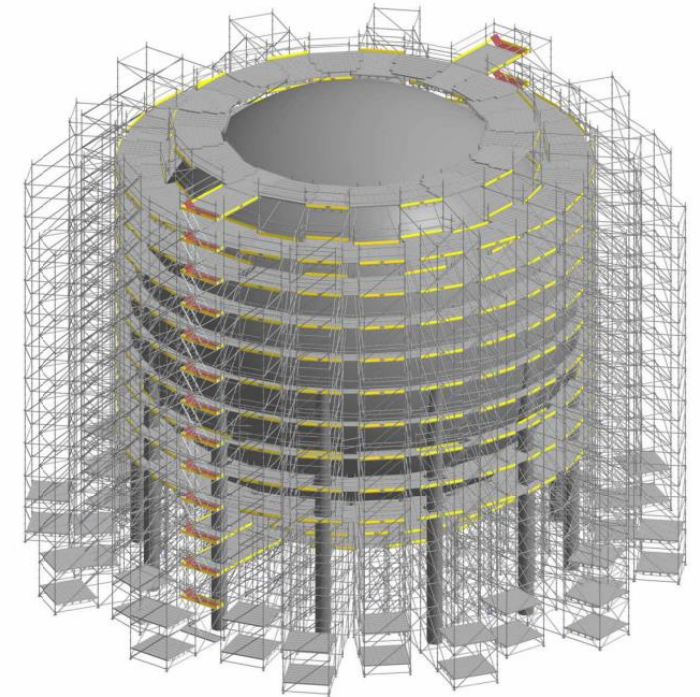



## Finished project Location – Rotterdam.

- Project includes 22 different size tanks.
- Biggest tank 34 meter wide and 19meter high, without roof.
- ITCC works of scope.: Inside and outside scaffolding (including protective film) installation and dismantling.
- Supply of materials.: Scaffolding for all project period.

### OUTSIDE TANK SCAFFOLDING PROJECT

WIDE - 30meter

HEIGHT - 15meter

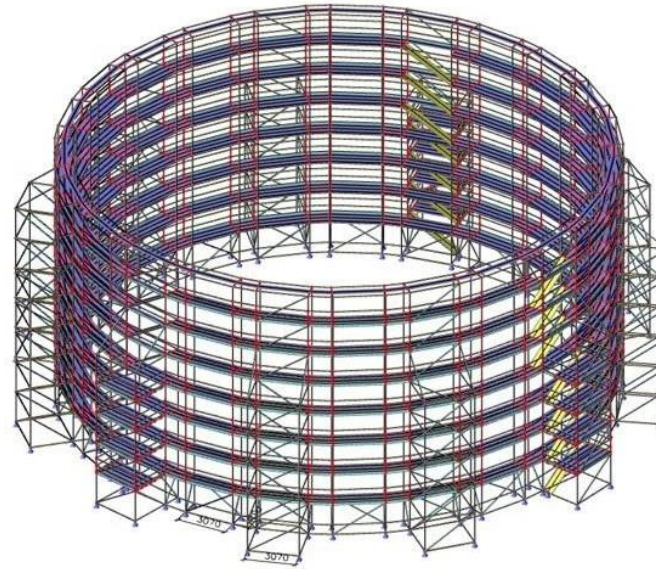

### INSIDE TANK SCAFFOLDING PROJECT

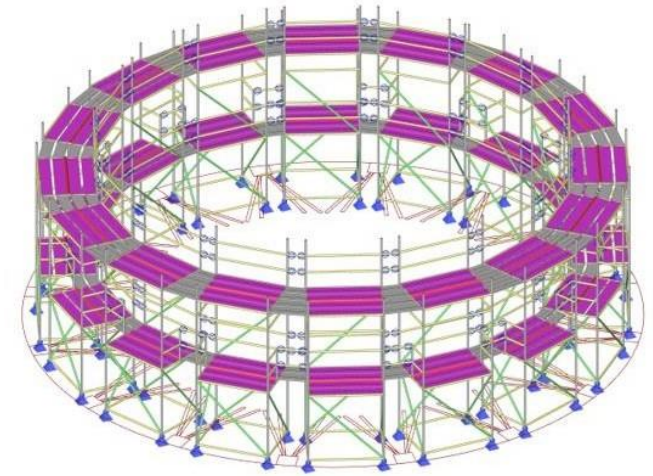

# INSULATION

We work according  
to standards:  
**CINI, SFS, DIN.**

- Fire proofing.
- Thermal insulation.
- Cryogenic insulation.
- Insulation mattresses.
- Noise protection & acoustics.

Total number of insulations works m<sup>2</sup>

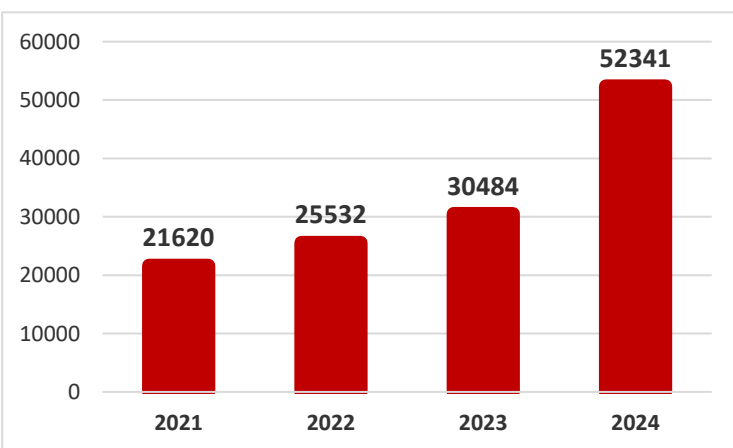



# WASTE/HEAT TO ENERGY - EXPERIENCE

Completed:



Scope of works.:  
Equipment, flue gas  
ducts and piping hot  
insulation 15160m<sup>2</sup>  
(sections and wired mat  
insulation)



Scope of works.:  
Ethanol columns, piping hot and cold  
insulation  
7500m<sup>2</sup>



Scope of works.:  
Equipment, boiler, bag  
filter, fibergalss, piping  
insulation hot and cold  
insulation 8000 m<sup>2</sup>



Scope of works.: 38MW  
biomass boiler, Equipment,  
flue gas  
ducts and piping hot  
insulation 4503m<sup>2</sup>



## STORAGE TANK (TERMINALS) - EXPERIENCE

- Project includes 22 different size tanks.
- Biggest tank 55 meter wide and 19meter high.
- ITCC works of scope.: Full tanks insulation and scaffolding construction
- Supply of materials.: Insulation wool, metal for insulation (prefabrication in our workshops).

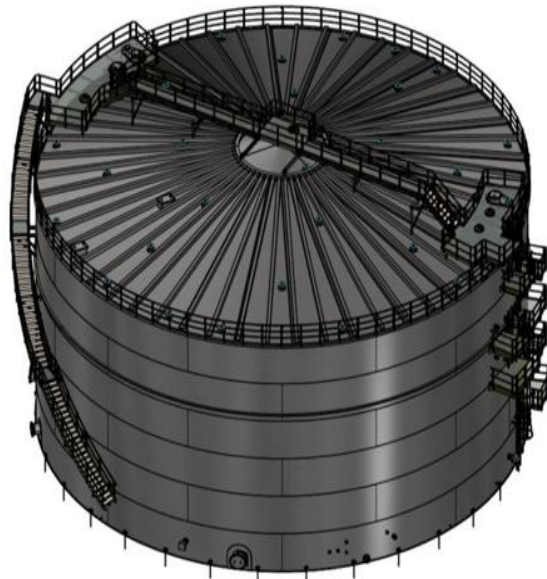

## PROJECTS OF OIL REFINERY AND PHARMA FACILITY - EXPERIENCE

- Project includes shutdown phase
- Column insulation and scaffolding
- MVR buildings
- Pipeline insulation
- Utility Buildings
- Supply of materials.: Insulation wool, metal for insulation (prefabrication in our workshops).



# Cold insulation

---



# Component cooling





# Insulating pillows (mattresses)

---





# Primary / secondary air ducts

---





# District heating

---





# Ash hoppers

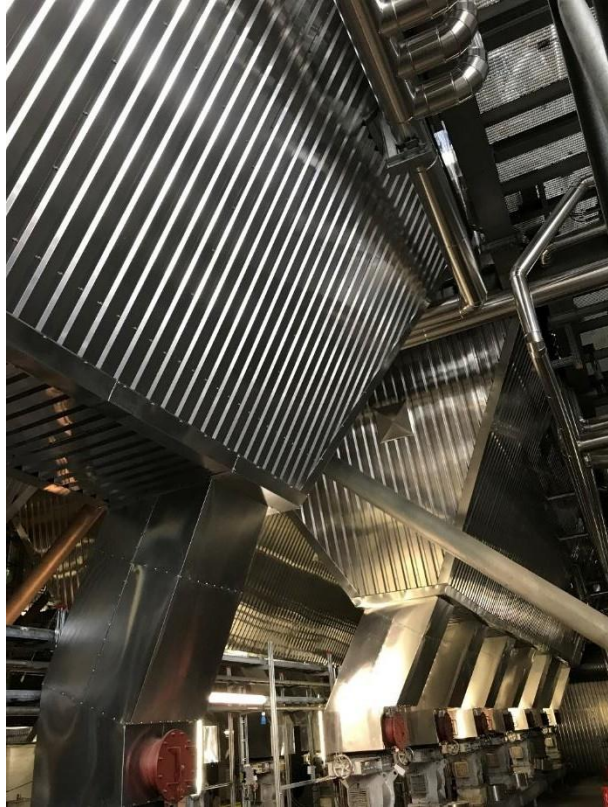

## FGD



# Turbine pipes





# Sound Insulation

---

Double wall system

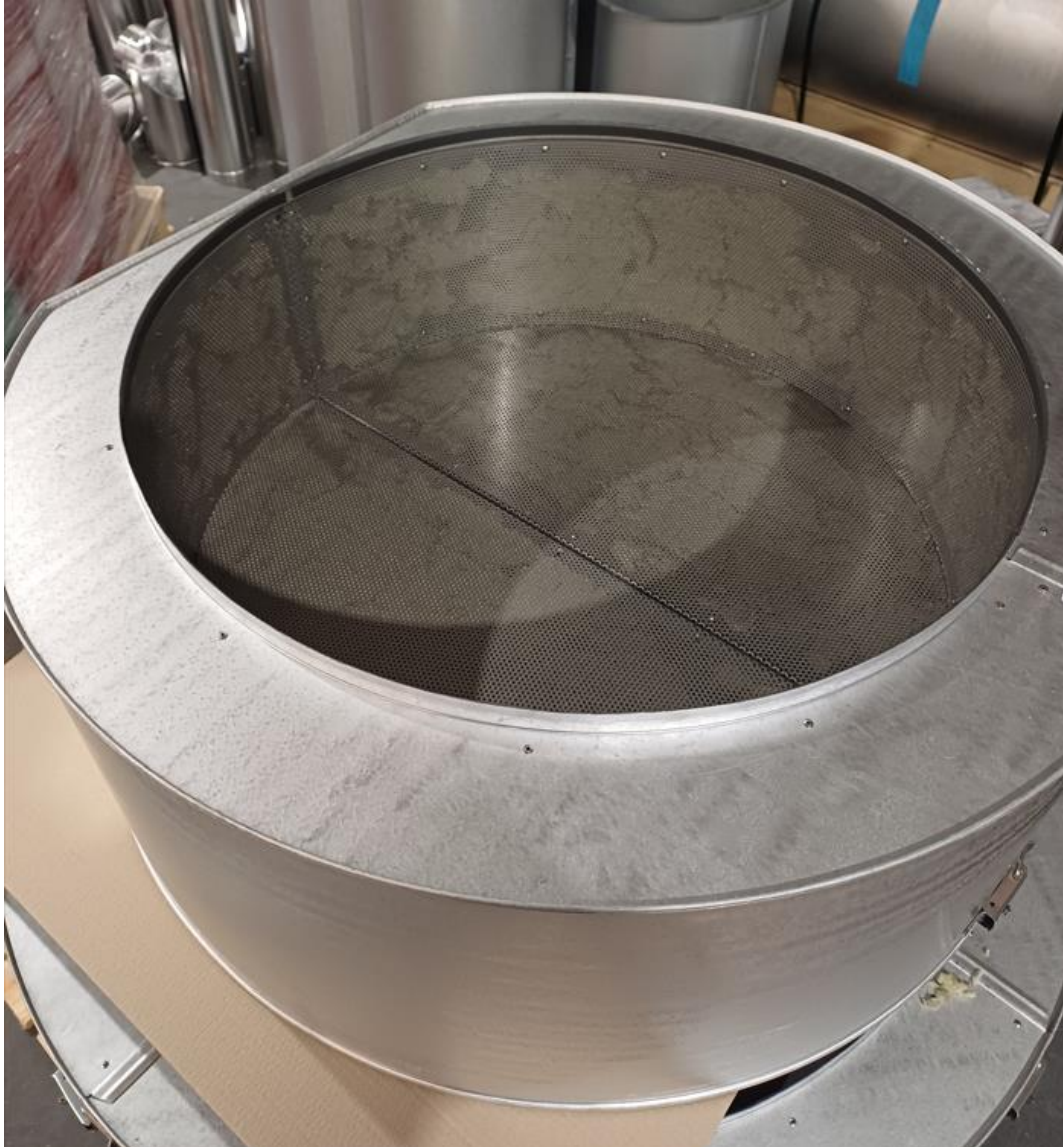

With Idikell material



# Part of the main customers

## Working directly



## Indirectly





# References



To whom it may concern

Kalundborg, 1 June 2021

## Letter of recommendation

With the assistance of JSC ITCC, Lithuania, we have successfully completed our project 'Phoenix' – the construction of our new used oil re-refinery in Kalundborg, Denmark. ITCC was responsible for the major part of the technical equipment and storage tanks insulation work and scaffolding constructions.

The ITCC part of the project was completed according to the planned time schedule, and the contract was fulfilled with high flexibility of workforce and responsible planning. We are very satisfied with the quality of the technical insulation provided.

We look forward to co-operating with ITCC in future projects and recommend this supplier for companies that seek a highly responsible technical insulation and scaffolding supplier for their projects.

Yours faithfully,  
AVISTA Green

  
Peter Jonsson  
Technical Director



Søren Borup

Project Director

Kanadevia Inova Denmark A/S  
Energivej 16

6670 Holsted | Denmark

Main phone: +45 72 40 74 65

Mobile: +45 29 49 78 91

[Soren.Borup@kanadevia-inova.com](mailto:Soren.Borup@kanadevia-inova.com)

To Whom It May Concern,

We hereby confirm that UAB ITCC was contracted by Kanadevia Inova Denmark A/S to perform industrial insulation works as part of our Biomass Plant project - **202083 DIN Forsyning**, Esbjerg. Their scope included the insulation of boilers, various process equipment, ducting, and associated piping systems throughout the facility. The work was conducted under strict safety and quality standards, and we are pleased to state that ITCC demonstrated a high level of professionalism and technical competence throughout the project.

UAB ITCC successfully executed all assigned tasks within the agreed timeline and adhered fully to our project requirements and safety protocols. Their team maintained a proactive and cooperative approach during planning, execution, and site coordination, which contributed positively to the overall workflow of the construction site.

The total insulation work performed by UAB ITCC covered approximately 8450 square meters. A team of up to 30 skilled professionals were engaged on-site during peak phases of the project. ITCC showed excellent flexibility and responsiveness, particularly when handling project modifications and urgent additional works. Their ability to quickly mobilize resources and adjust to evolving project demands greatly contributed to maintaining the overall project schedule.

Based on our experience, we consider UAB ITCC to be a reliable and competent contractor for industrial insulation services. We would not hesitate to recommend them for similar future projects and collaborations.

Sincerely,

Kanadevia Inova Denmark A/S  
Project Director



Søren Borup

# References



ANDRITZ TEP d.o.o.  
Ulica 108. brigade ZNG 84  
35000 Slavonski Brod / Croatia

To Whom It May Concern,

UAB ITCC successfully completed insulation works as part of the Boiler Island No. 3 construction at the SMDO power plant located in Villers Saint Paul, approximately 70 km north of Paris. This project was carried out under the leadership of ANDRITZ and involved high-performance biomass and waste-to-energy solutions.

ITCC's scope included procurement of materials, delivery logistics for thermal installation work of scope. The insulation of boiler surfaces, pipelines, ducts, and other equipment was performed in full compliance with French and EU regulations. ITCC also ensured that all deliverables and documentation were provided bilingually in English and French, as contractually required.

What stood out most was ITCC's consistency in delivering high-quality results while maintaining adherence to health, safety, and technical standards. The materials used—including rock wool and aluminum cladding—were properly selected and installed according to temperature and diameter specifications. Their professional approach was evident both in preparation and on-site execution.

These projects also involved complex ducting and equipment insulation under demanding timeframes. ITCC was quick to respond to design changes and additional requests, often reacting within hours and minimizing delays. Their ability to adapt without compromising quality or safety has proven to be a significant asset on large-scale jobs.

In summary, we consider UAB ITCC a dependable partner for insulation and scaffolding services. Their team is well-organized, technically proficient, and capable of delivering under pressure. We are pleased with their performance and would recommend them for similar assignments in the energy and industrial sectors.

Sincerely,

ROBERT MEC

Project manager

m: +385 992674288 (VPN 215)

[robert.mec@andritz.com](mailto:robert.mec@andritz.com)

**ANDRITZ TEP d.o.o.**  
Ul. 108. brigade ZNG 84  
35000 Slavonski Brod 8

A handwritten signature in blue ink, appearing to read "Robert Mec", written over a light blue circular stamp.

TOGETHER WE BUILD SUCCESS

More information about us.:

ITCC flyer.:

[https://www.flipsnack.com/itccclt/itcc\\_bukletas\\_2023/full-view.html](https://www.flipsnack.com/itccclt/itcc_bukletas_2023/full-view.html)

ZIGO video.:

<https://www.youtube.com/watch?v=-pibU2PVS0g>

LITHUANIA

BELGIUM  
POLAND  
DENMARK

## CONTACTS

JSC ITCC

Company code: 301851754

VAT code: LT100004302212

Luminor Bank AB

Acc./c.: LT024010051003595180

T: +370 663 71774

E-mail: [info@itcc.lt](mailto:info@itcc.lt)

[www.itcc.lt](http://www.itcc.lt)



OFFICES:

**KLAIPEDA  
MAZEIKIAI**

**ANTWERP  
WARSAW  
COPENHAGEN**



[itcc.lt](http://itcc.lt)



[/itcc](https://www.facebook.com/itcc)



[/itcc.lt](https://www.instagram.com/itcc)