

## Master plan of the Industrial Park

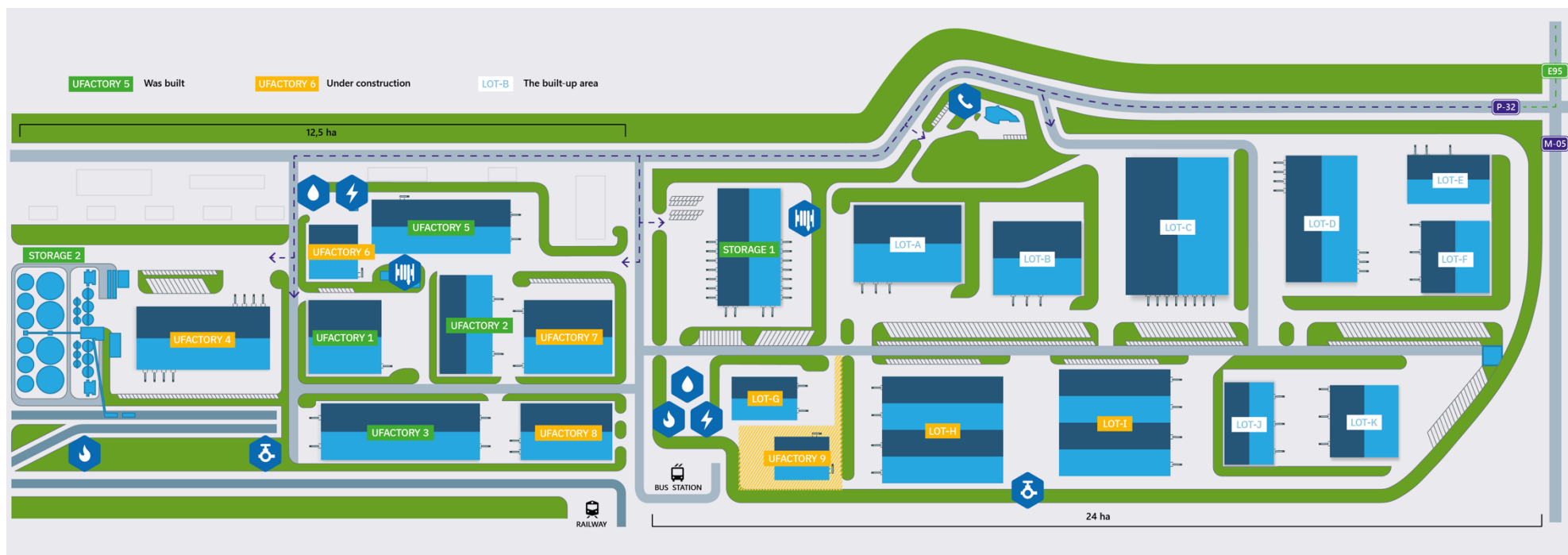

### Electricity

Available capacity: 7,5 MW;  
Voltage: 10 kV;  
Distance: 0 m;  
Extra capacity: 10 MW (to be available by YE2024).



### Gas

Available capacity:  
6 400 m<sup>3</sup>/h;  
Distance: 0 m;  
Pipe diameter: 310 mm.



### Water supply

Available capacity:  
1 300 m<sup>3</sup> /24h;  
Distance: 0 m;  
Pipe diameter: 2x160 mm.



### Sewage

Available capacity:  
1 300 m<sup>3</sup> /24h;  
Distance: 0 m;  
Pipe diameter: 2x110 mm.

## Appendix B

## The Master plan of Target Land Plot location within the Industrial Park

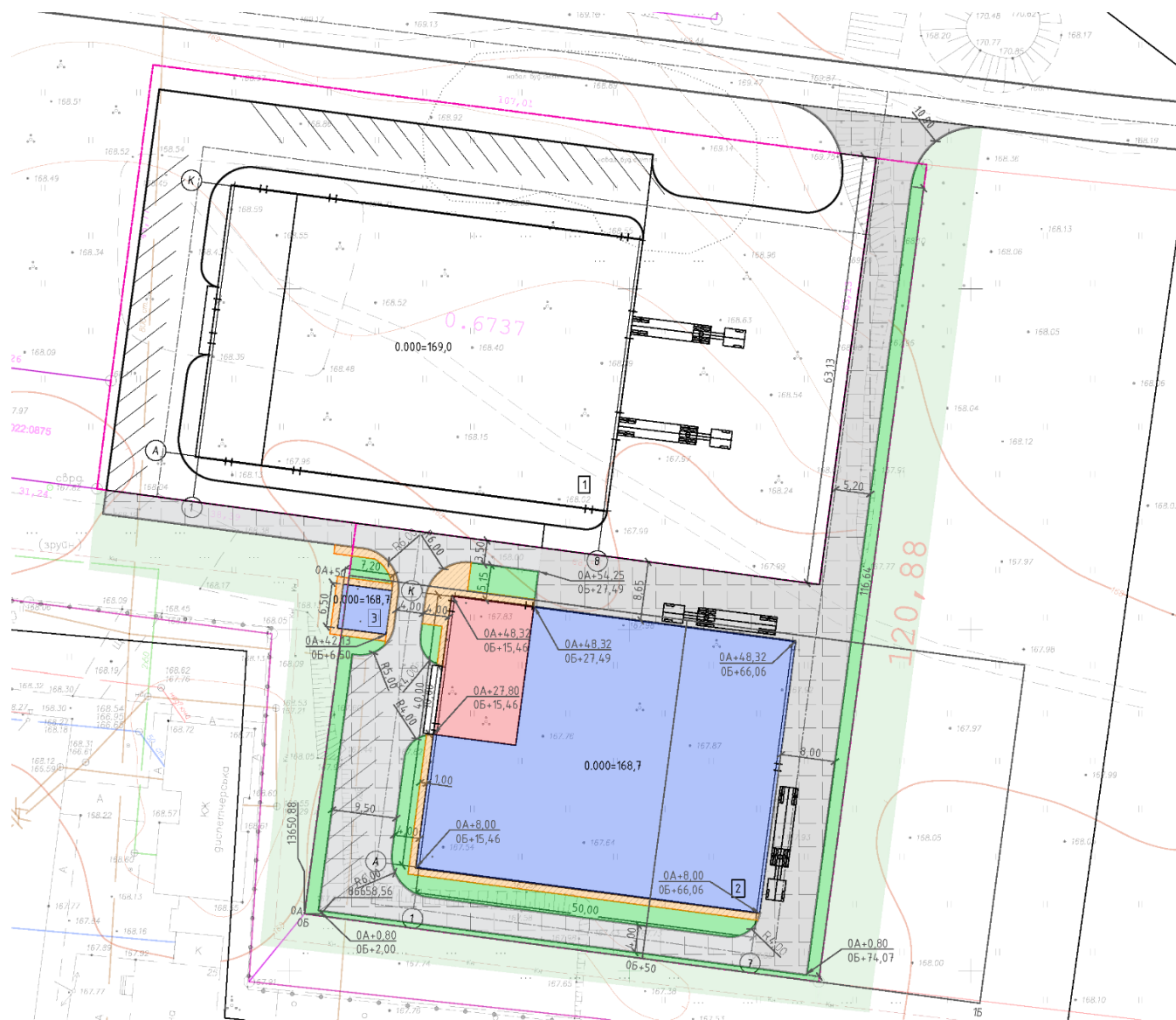

Explanation of buildings and structures

Number	Name	Floor	Facility area	Notes
1	Production and warehouse building 60x40 m with a built-in administrative and household complex	1	2455,80	Projected
2	Production and warehouse building 50x40 m with a built-in administrative and household complex	1	2052,90	Projected
3	Transformer substation	1	48,96	Projected

Legend

Existing	Projected	Name
		Plot boundary
		Buildings and structures
		Road
		Sidewalks and paving
		Landscaping

Technical and economic indicators

No	Name	Units	Indicators
1	Land plot area	ha	0,4869
2	Built-up area	m <sup>2</sup>	2101,86
3	Plot coverage ratio	%	43,2
4	Area of driveways, sidewalks and paths within the land plot	m <sup>2</sup>	2112,3
5	Area of driveways, sidewalks and paths outside the land plot	m <sup>2</sup>	234,32
6	Landscaped area	m <sup>2</sup>	655,00
7	Landscaping ratio	%	13,4