

BAYRAMOĞLU
ENDÜSTRİ HOLDİNG

**We shape
the future.**



- **Welded Production**
- **Nuclear**
- **Defense, Aviation & Space**



- **Wind Energy**



- **Construction Works**

400+
EMPLOYEES

6000+
TONNES/YEAR
STEEL
PROCESSING
CAPACITY

1000+
PIECES
WIND TURBINES
INTERNALS PRODUCTION

Mission, Vision, Our Purpose Of Existence



Our Mission

In line with customer satisfaction, employee well-being and principles of social benefit and without making concessions on universal values and environmental considerations, generating most qualitative solutions for metal production and assembly needs of any industry.



Our Vision

As a pioneering company, who works out efficient and sustainable solutions based on innovative technologies for customers, becoming a globally leading brand, contributing with economic, social, and environmental values to the world of tomorrow.



Our Purpose Of Existence

The journey, which we started by shaping the steel; has determined our purpose of existence upon the principle of sustainability, which we developed under the light of the experience we gained during the course of time, the know-how and technological investments realised: "Shaping the Future"

Industries



Wind Energy

Wind Tower Platform Production
Onshore Tower Mechanical Internals
Offshore Tower Mechanical Internals
Wind Tower Engine Assembly
Wind Tower Generator Assembly
Wind Tower Blade Transport Tool Production
Cutting, Bending, Assembly, Kitting and
Packaging Services



Nuclear Energy

Pressure Vessels and Silos
Manufacturing of Embedded
Elements and Anchors
Manufacturing of Service Crane Parts
Pipelines, Pipe Spool Production



Defence, Aviation and Space

Metal Forming
Welded Manufacturing
Production of Qualitative Elements
Machining
Fixture Manufacturing
Provision of Competent Welder Personnel
CMM Measuring Service



Welded Production & Steel Construction

Manufacturing of Bunkers, Silos and Tanks
Pressure Moulds and Heat Exchangers
Gantry Crane and Accessories
Aluminium and Stainless Manufacturing
Machine Chassis
Platform and Ladder Production
Gas Channels, Pipelines
Belt Conveyor Manufacturing
Turnkey steel construction production
Turnkey factory construction projects

Our Firsts

As Bayramoğlu Industry Holding, we are proud of the firsts we have achieved in Turkey and in the world, and we are working with excitement to add new ones to our achievements.

- 🔗 The first domestic company to produce in the energy sector in accordance with EN 1090 EXC-4 standards.
- 🔗 One of the first domestic companies making technological production accredited in the nuclear industry.
- 🔗 One of local companies making internals for onshore wind towers.
- 🔗 The first and only domestic company manufacturing internals for offshore wind towers.
- 🔗 The first company in the world, which can carry out mechanical and electrical accessory works together in the wind energy industry in the world.
- 🔗 One of the accredited domestic company that can produce safety class III equipment



Our Strong & Pioneering Sides



THE ADDED VALUES, WE GENERATED

While we as Bayramoğlu Endüstri Holding are taking firm steps towards the goal of announcing our brand and country to all over the world, we are carrying out import substitution, high local content rate and export-based studies to provide economic added value to our country.

Import Substitution: We localise products and services, which Türkiye purchases from abroad and thus result with the significant outflow of foreign currency. We manufacture such products and services.

High Local Content Rate: With reference to our activities, we give priority to use skills and sources of Türkiye. Thus, we are able to manufacture our products and services with a high local content rate.

Exports: In all projects we realise, we target high quality; and in all fields we are active, we aim to create competition and to leave a mark. We know that our achievements will enable us to become a preferred producer at international level and will increase our export rate.



Our Joint Ventures

- With our partner companies **B&B Renewable Energy** and **BGO Endüstriyel İnovasyon** we boost our work force, our skills and localisation.
- We have a strategic cooperation with a Spanish company (ENSA), known world-wide for the production of nuclear power plant equipment.
- Our **Basteel** company is listed in the list of suppliers of the European Nuclear Research Center, **CERN (Conseil Européen pour la Recherche Nucléaire)**
- We bring together **global manufacturers, who intend to invest in nuclear energy industry**, in Türkiye and continue our works related to issues of localisation, technology and information transfer.
- We develop strategic Cooperations with our R&D Works



The background of the slide is a photograph of a mountainous landscape at sunset. A winding road curves through green hills in the foreground. In the middle ground, a wind turbine stands prominently. The background features layers of mountains under a sky with soft, colorful clouds from the setting sun. On the left side, there is a teal-colored graphic element consisting of a large circle with the number '2' inside, and a teal shape extending from the top left corner towards the circle.

2

Our Membership in Following Organisations

Our Rotating Presidencies
in following companies



We are founders
of following companies



Our memberships
in following institutions





The power that directs the industry...

About

As Bayramoğlu Endüstriyel Çelik, ranking among major suppliers in its field in Türkiye and in the world, we have been directing the sector for 65 years based on our experience, expertise, and technological infrastructure.

We offer high quality, scalable, customisable, projected metal production solutions with materials such as carbon steel, stainless steel, and aluminium, which we shape with welding operations and steel construction production, engineering expertise and production quality at world standards.



100+
EMPLOYEES

6000+
TONNES/YEAR

**STEEL PROCESSING
CAPACITY**

3000+
PIECES

**PROJECT
SOLUTIONS**

Basteel Production and Delivery Location

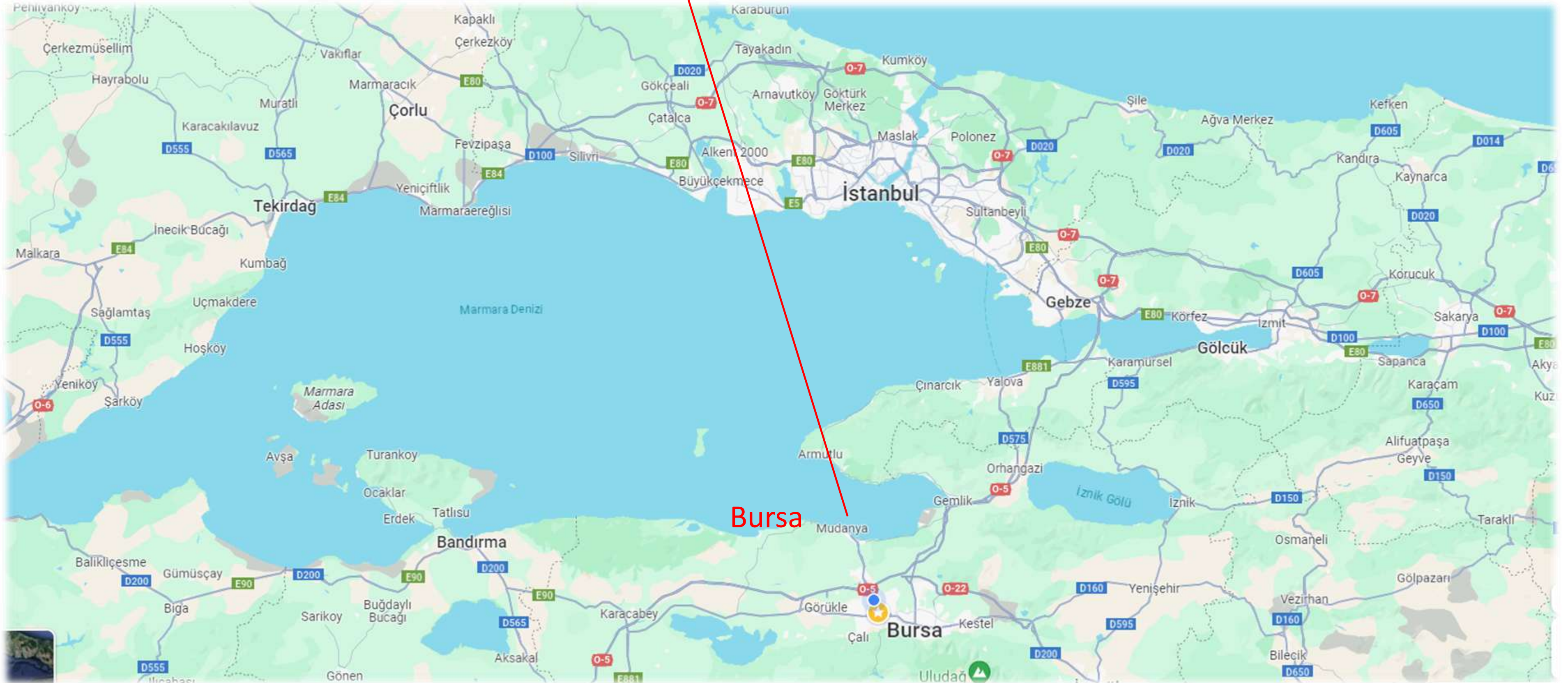

Layout –Main Factory

Total Surface: 4.700 sqm

Workshop Area: 2.700 sqm

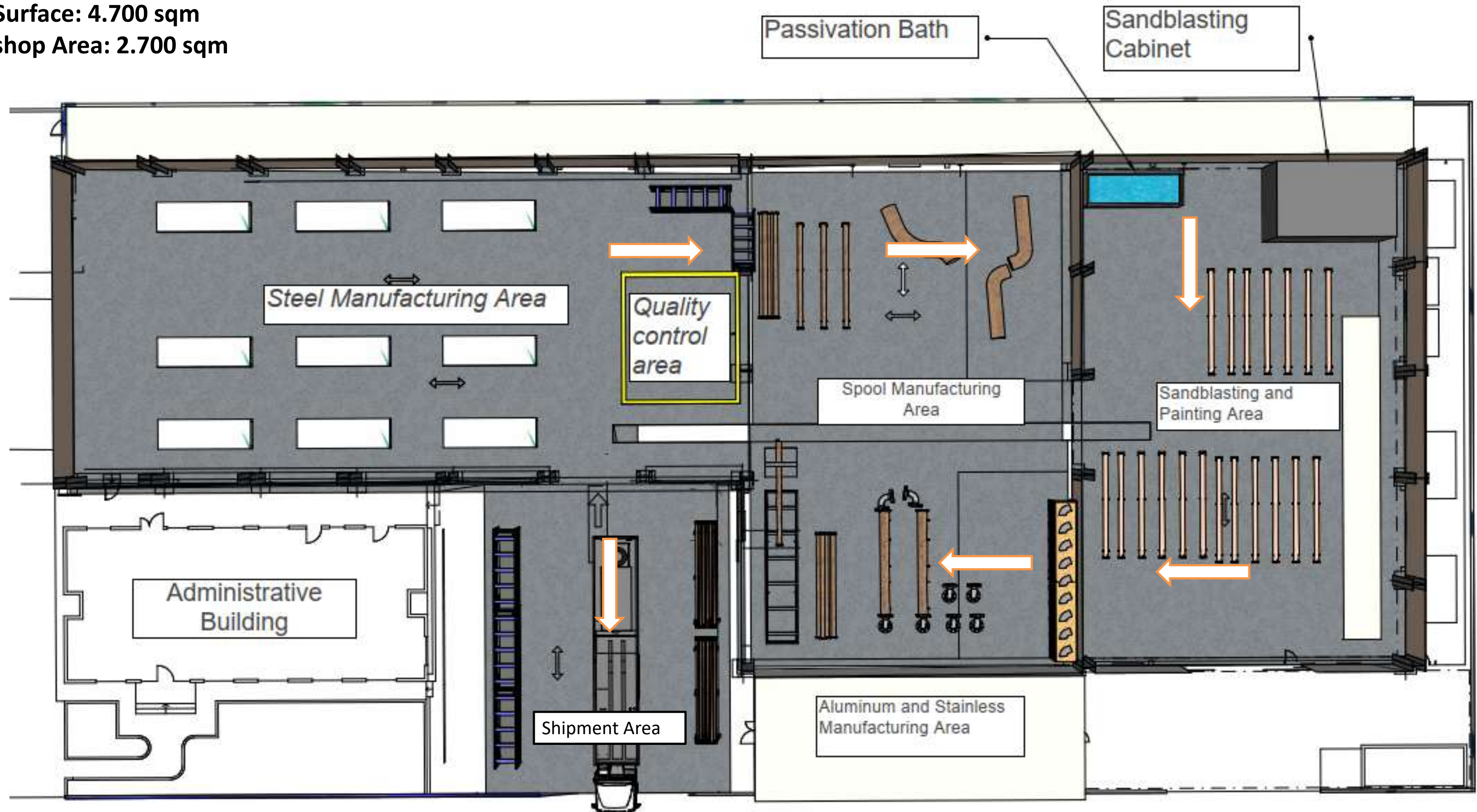

Critical Equipments

Machine, Crane

Over Head Cranes

25ton / 15ton - Hook: 8 mt
20ton / 6,3ton – Hook: 8 mt
20ton / 16ton – Hook: 8 mt
5 ton – Hook: 8 mt
2 ton – Hook: 4 mt



Portal Cranes

5 ton x 1 – Hook: 4 mt
2 ton x 2 – Hook: 4 mt



Vehicles

Hi-Up 30 ton
Truck x 1
Trailer x 2



Machines ve Equipments

12kw Fiber Lazer – 2 mt x 6 mt



CNC Plasma/Oxygen – 2 mt x 6 mt



Machines ve Equipments

Bending Press – 3 meters, 220 tons



Bending Press – 6mt, 400 tons, CNC



Bending Press – 4mt, 320 tons, CNC



Machines ve Equipments

Bending Press – 2,5 meters, 100 tons



Rolling Machine – 3mt, max 12mm thickness



Machines ve Equipments

Welding Capabilities and Experiences

- Carbon Steel
- Stainless Steel
- Aluminium
- Alloy Steel

TIG/MIG/MAG Welding Machines



Submerged Arc Welding Machines – 2 pcs



Hydrostatic Test Machine – 500 Bar



Machines ve Equipments

Saw Cutting – up to 800mm



Saw Cutting – up to 350mm and angle cutting



Drill and Threading

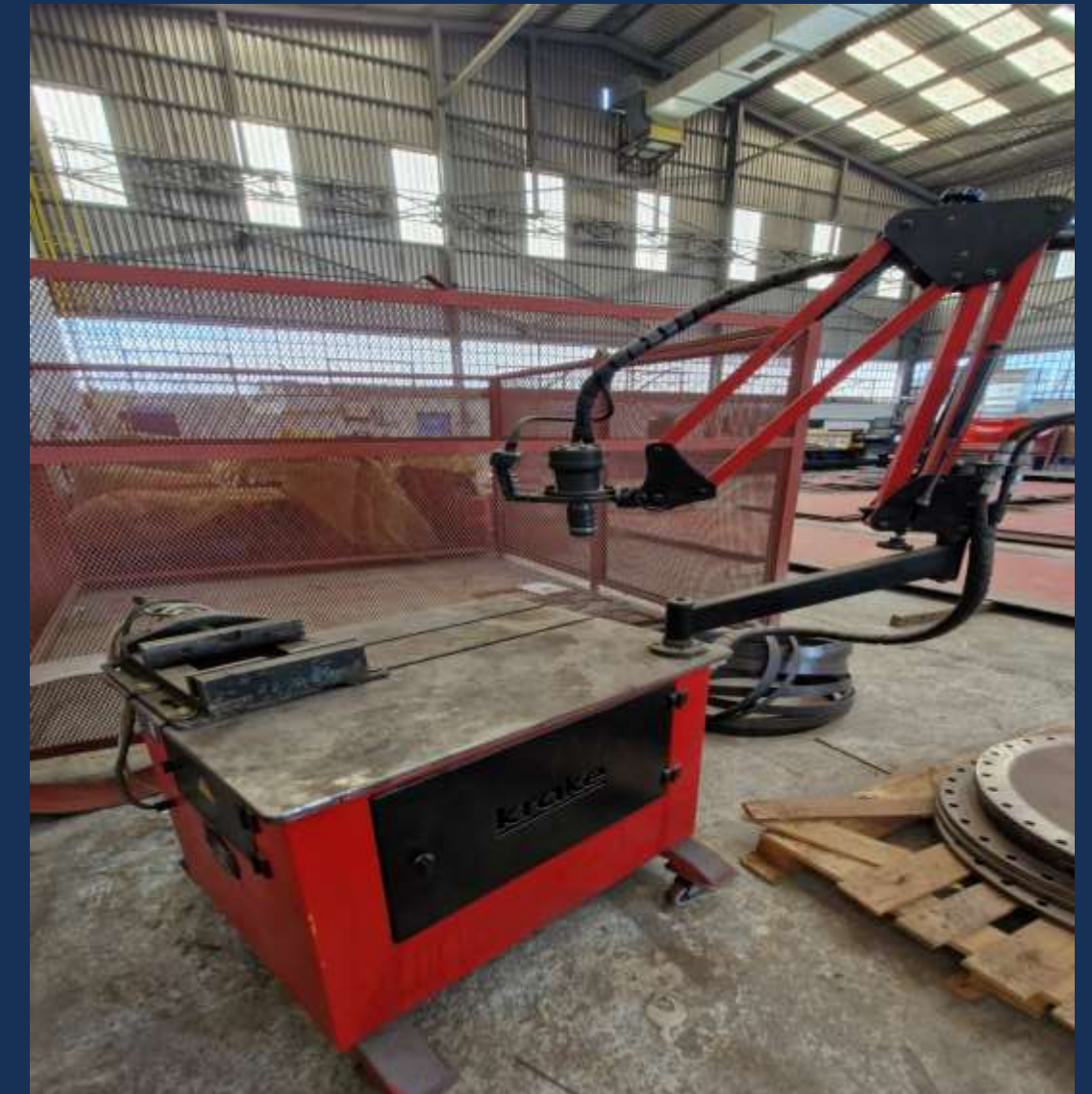

Machines ve Equipments

Radial Drilling – up to Ø36 mm



100 ton Press Brake



Automatic Sandblasting Machines

1,5mt x 0,5mt x 12 mt

Airless wet painting



Our Certificates

- EN 1090-1 EXC4 STRUCTURAL COMPONENTS AND KITS FOR ALUMINIUM STRUCTURES EXC4
- EN 1090-1 EXC4 STRUCTURAL COMPONENTS AND KITS FOR STEEL CONSTRUCTIONS EXC4
- EN 1090-2:2018 EXC4 COMPLIANCE CERTIFICATE FOR FACTORY MANUFACTURING CONTROL
- EN 1090-3:2019 EXC4 COMPLIANCE CERTIFICATE FOR FACTORY MANUFACTURING CONTROL
- ISO 14001:2015 ENVIRONMENTAL MANAGEMENT SYSTEM
- ISO 9001:2015 QUALITY MANAGEMENT SYSTEM
- ISO 27001:2017 INFORMATION SECURITY MANAGEMENT SYSTEM
- ISO 45001-2018 OCCUPATIONAL HEALTH AND SAFETY MANAGEMENT SYSTEM
- TS EN ISO 3834-2 QUALITY STANDARDS FOR MELTING WELDING OF METALIC MATERIAL
- ES-101 B LEVEL EYDEP, EVALUATION AND SUPPORT OF INDUSTRIAL COMPETENCY
- NUCLEAR REGULATORY AUTHORITY, MANUFACTURER APPROVAL FOR NUCLEAR FACILITY
- GENERAL ELECTRIC PRODUCER CLASSIFICATION AND APPROVAL



Project and Our References



MANUFACTURER APPROVAL FOR
NUCLEAR FACILITY «NDK»
SAFETY CLASS II & III

GE PRODUCER CLASSIFICATION



STEAM PIPING
SPOOL FABRICATION
HI AND LOW PRESSURE



Manufacturing and Supply
BOP Pipelines, Support
Plate

Live Steam Piping
Low Pressure Piping
Hi Pressure Piping

Working in the Tender
Process

- El-dabaa NPP
- Akkuyu NPP

Project and Our References



STEAM PIPING
SPOOL FABRICATION
HI AND LOW PRESSURE



Proje ve Referanslarımız



AKKUYU NÜKLEER
ROSATOM



STEAM PIPING
SPOOL FABRICATION
HI AND LOW PRESSURE



Project and Our References



STEAM PIPING
SPOOL FABRICATION
HI AND LOW PRESSURE



Proje ve Referanslarımız

subsea 7

REEL GRILLAGE FABRICATION



Proje ve Referanslarımız

WENDT

Noise Control

**AKKUYU NGS
GENERATOR ENCLOSURE
SECONDARY STEEL
MANUFACTURING & ALUMINIUM**



Project and Our References



WARM SKIN PLATES
WELDED CONSTRUCTION



**AKKUYU NGS, PRODUCTION
OF EMBEDDED ELEMENTS**
PRODUCTION OF EMBEDDED
ELEMENTS (700 Tons)



EXHAUST VENTILATION SYSTEM
TKSE – PIPES



Project and Our References



**STEEL WORKS OF THE TOGG
PAINTSHOP BUILDING
INSTALLATION
(300 Tons)**



**PRODUCTION OF 70 m³
BITUMEN TANK
STEEL PRODUCTION
(300+ Tank / 3000+ Tons)**



**PRODUCTION OF PANEL
ALUMINIUM WELDING
& MACHINING**



Project and Our References



STRUCTURE HOLDER BODY
WELDED STRUCTURE



WELDING FIXTURE



ASSEMBLY BENCH
ALUMINUM MANUFACTURING AND ASSEMBLY
WORKS



Project and Our References



ROBERT BOSCH FACTORY
STEEL CONSTRUCTION
(400 Tons)



BEŞİKTAŞ VODAFONE ARENA STADIUM
STEEL CONSTRUCTION ROOF
(500 Tons)



TRANSPORT TOOLS
WELDED STRUCTURE
(275 Sets)



Project and Our References

MAVITEC

**PRODUCTION OF STAINLESS-
STEEL CONVEYOR
EQUIPMENT MANUFACTURING**



BURSA BETON

**STORAGE SILOS
SILO PRODUCTION
(1000 Tons)**



GeneralElectric

**WIND TOWER MECHANICAL
INTERNALS
(50+ tower sets)**



Project and Our References

burçelik

**BUNKER AND EQUIPMENT
MANUFACTURING**
(1400 Tons)



Gesbey

**PLATFORM
AND BRACKET
STEEL
MANUFACTURING**



BURSA ÇİMENTO

**BURSA CONCRETE STEEL
WORKS**
SILO PRODUCTION



BORUSAN

**CRANE RAIL PRODUCTION
WELDED CONSTRUCTION**
(1400 Tons)



Project and Our References



CS WIND

WIND TOWER MECHANICAL INTERNALS



Project and Our References



WIND TOWER MECHANICAL INTERNALS



Our References





We have got the wind behind us...

About

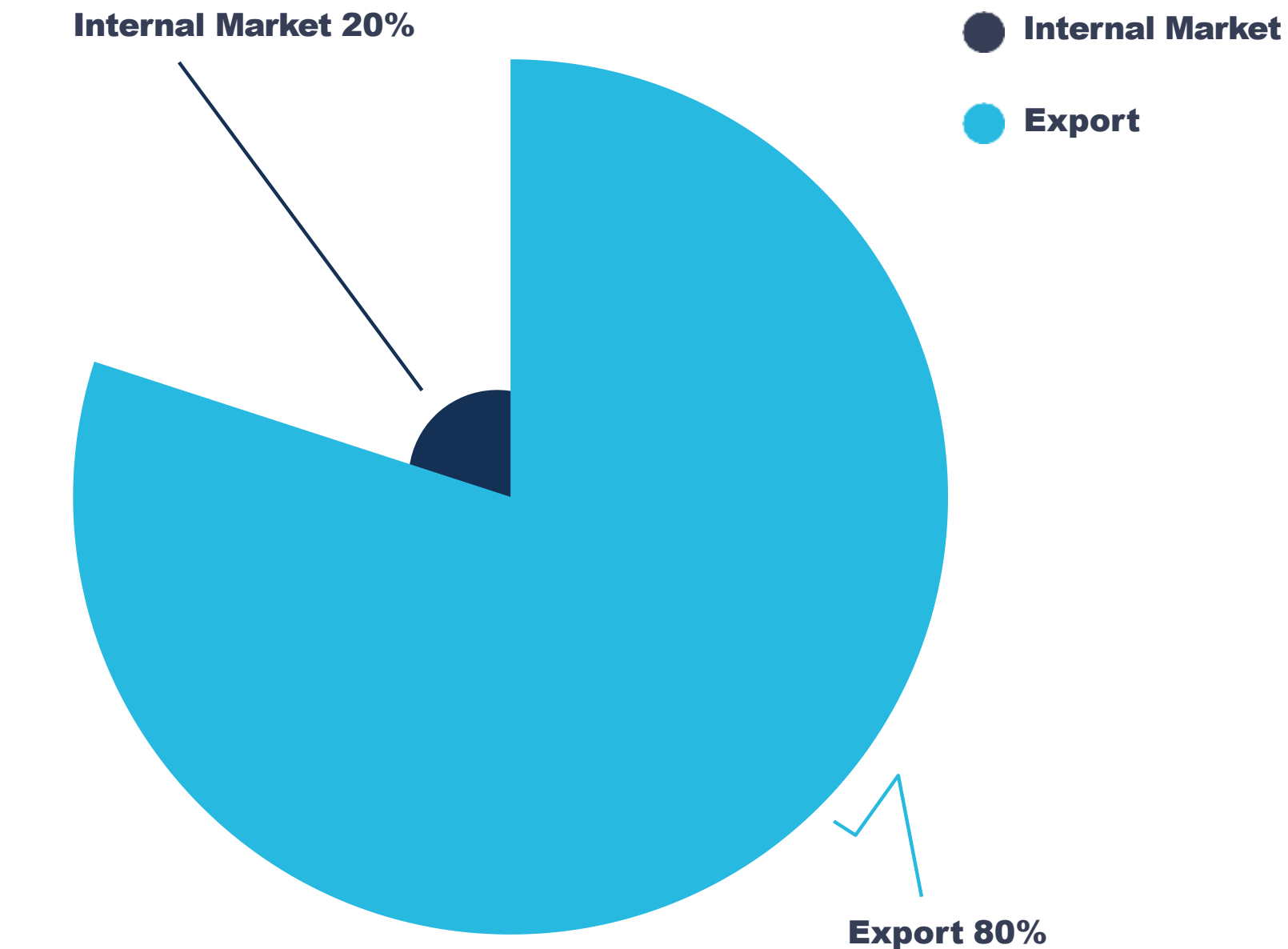

70%
Local Content
Rate

As B&B Renewable Energy, established in 2018 with the experience and expertise of Bayramoğlu Endüstri Holding, we produce wind turbine components for the wind energy sector.

We are the first and only local company of the offshore industry with more than 1100 projects signed in a quite short period of 5 years under the brand B&B Renewable Energy and export rates of 80%. In this field, we rank among top 3 European suppliers.

150
EMPLOYEES

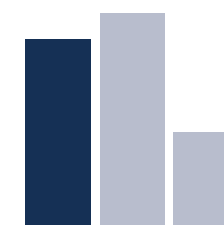

10000+
PIECES

**COMPLETED
TOWER**

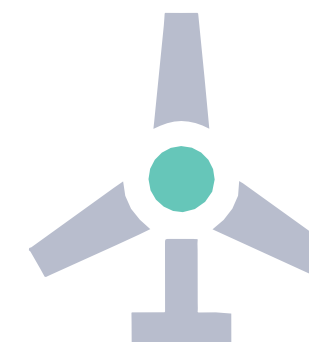

30000+
PIECES

**COMPLETED
PROJECT**



Layout

Total Surface: 15.000 sqm
Workshop Area: 10.000 sqm



Our Certificates

- TSE COVID-19 SAFE PRODUCTION CERTIFICATE
- ISO 9001:2015
- ISO 45001:2018
- ISO 14001:2015
- EN 1090-1 EXC4
- EN 1090-2 EXC4
- EN 1090-3 EXC4
- DIN EN ISO 3834-2
- GE Approval



OUR SIGNATURES ON THE NORTHSEA

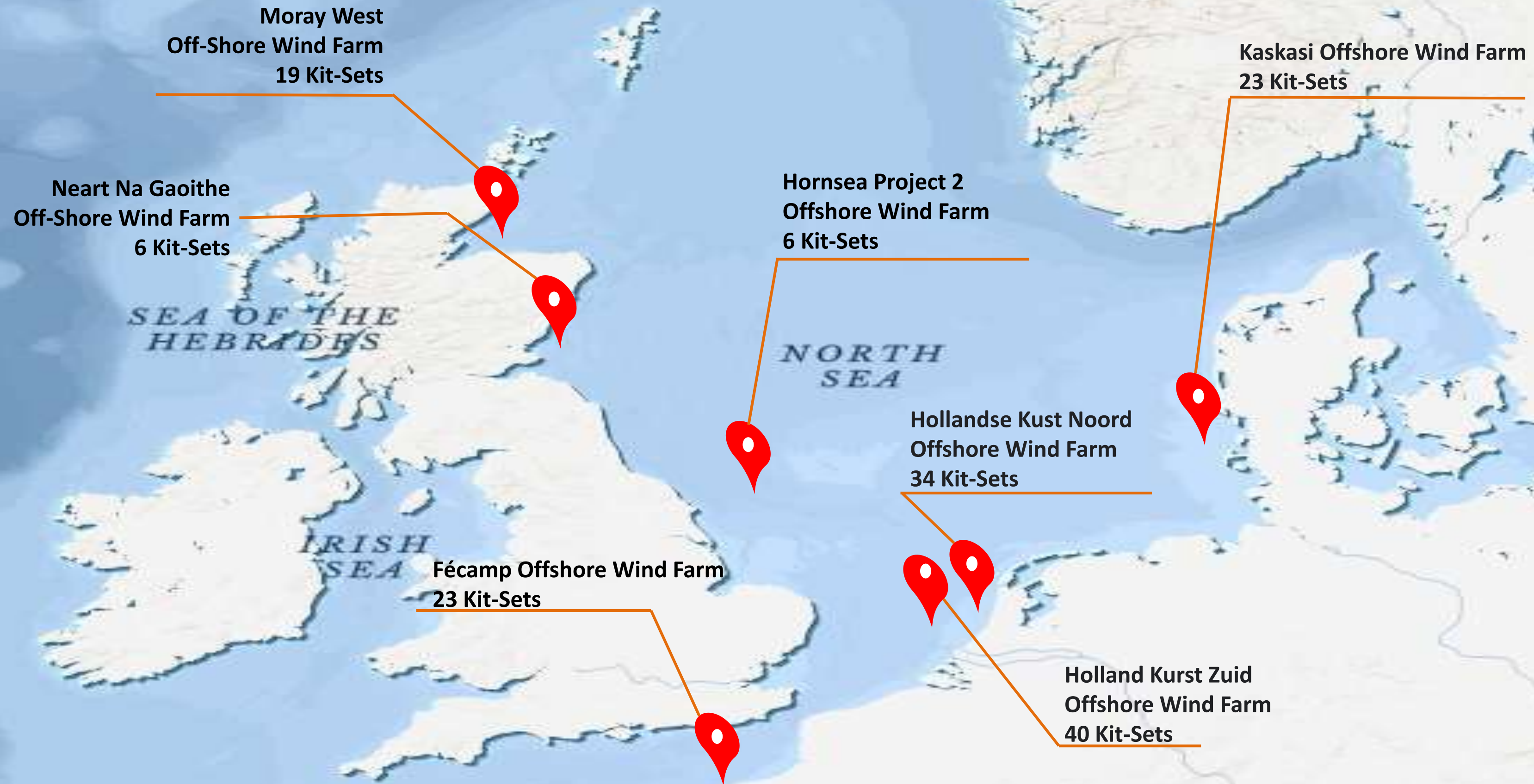

Project and Our References

SIEMENS Gamesa
RENEWABLE ENERGY

OFFSHORE TOWER INTERNAL PRODUCTION

(+155 Kit-Sets)

Produced for Welcon, GRI, Haizea Wind, Valmont Industries and CS Wind's Projects.



Project and Our References



GeneralElectric

ONSHORE TOWER INTERNAL PRODUCTION

(+135 Kit-Sets)

Produced for GRI, CS Wind 's
Projects.



Vestas

WIND TOWER BLADE TRANSPORT EQUIPMENTS

(+275 Sets)

Produced for TPI's Projects.



Project and Our References



ONSHORE TOWER INTERNAL PRODUCTION

(25 Kit-Sets)

Produced for Ateş Çelik and
GRI 's Projects.



ONSHORE TOWER INTERNAL PRODUCTION

(+350 Kit-Sets)

Produced for GRI, Çimtaş and CS
Wind's Projects.



ONSHORE TOWER INTERNAL PRODUCTION

(+250 Kit-Sets)

Produced for CS Wind, Arcosa Wind,
Broadwind, WRS Towers, SGRE TR
Projects.



OEM Based References

SIEMENS Gamesa
RENEWABLE ENERGY



Vestas®



Wind Tower Manufacturer Based References



CSWIND



ARCOSA



cimtas

BGO

ENDÜSTRİYEL İNOVASYON A.Ş.

The expertise shaping the production

About

BGO Endüstriyel İnovasyon, which provides contracting, implementation, and general construction services to the industrial construction sector, has taken part in many production facility projects since 2020, when it was established with the partnership of Bayramoğlu Industry Holding and Gazioğlu Group.

As BGO Endüstriyel İnovasyon, within the scope of the contract signed with the technology giant Robert Bosch GMBH, operating in 185 countries worldwide, we are still actively carrying out projects in five different locations belonging to Bosch in the Bursa Organized Industrial Zone.

25
EMPLOYEES



480+
PIECES
COMPLETED
PROJECTS



Our Fields of Activity

- Reinforced Concrete Structures
- Manufacturing of Steel Constructions
- Office Revision
- Aluminium joinery and Composite Coating Works
- Wet Volume Revisions and Insulation Processes
- Mobile Lifelines, Trapezoidal Roof, and Façade Cladding Works
- General Maintenance, Repair, and Improvement Works

Advantages We Offer

- With our expert staff and with the support of about 80 subcontractors, the competence for “always doing better”.
- Supporting the industrial construction industry with technology and innovation activities.
- Contribution to the development of our teams with continuous company-internal trainings.
- An understanding of low-impact organization and production
- Strong partnership structure and strong references.

Project and Our References



**Bosch Rexroth
Recreation Area Project**



**Bosch Packaging
Area Revision**



**Bosch Construction of
a flowmeter room**



**Bosch Installation
Area Revision**



**Bosch Frame Construction
Contracting Project**



Engineering and R&D Capabilities

2023-2024

PATENTS

	Application No.	Application Date	Invention Title	Protection Type
1	2024/004954	25.04.2024	Safety Equipment	Patent
2	2023/017533	18.12.2023	Modular Transport Frame	Patent
3	2023/016765	8.12.2023	Loading Platform System	Patent
4	2022/006309	20.04.2022	Modular Transport Frame	Patent
5	2024/004952	25.04.2024	Climbing System	Patent

PUBLICATIONS



İZMİR DEMOKRASİ UNIVERSITY
IES'23 INTERNATIONAL ENGINEERING SYMPOSIUM
CIVIL ENGINEERING SESSIONS
November 15, 2023

7. ULUSLARARASI MÜHENDİSLİK BİLİMLERİ VE MULTİDİSİPLİNER YAKLAŞIMLAR KONGRESİ

7th INTERNATIONAL CONGRESS ON ENGINEERING
SCIENCES AND MULTIDISCIPLINARY APPROACHES

Katlanabilir ve Tekrar Kullanılabilir Yüksek Dayanımlı Modüler Çelik Kasa Projesi

DİDEM ÖZKAN¹, İBRAHİM GÜL²

¹ Bayramoğlu Endüstriyel Çelik, OSB A.O.Sönmez Blv 3. Sk. BURSA, d.ozkan@bayramogluholding.com

² Bayramoğlu Endüstriyel Çelik, OSB A.O.Sönmez Blv 3. Sk. BURSA, i.gul@basteel.com.tr

ÖZET

Dünya genelinde, endüstriyel ve ticari faaliyetlerin artmasıyla birlikte taşıma ve depolama çözümlerine olan ihtiyaç da giderek artmaktadır. Özellikle büyük ölçekli ekipmanların taşınması ve depolanması, lojistik sektöründe önemli bir alanı kapsamaktadır. Geleneksel taşıma

Engineering and R&D Capabilities

2023-2024

SPECIAL PROJECTS,
ORIGINAL BASTEEL DESIGNS

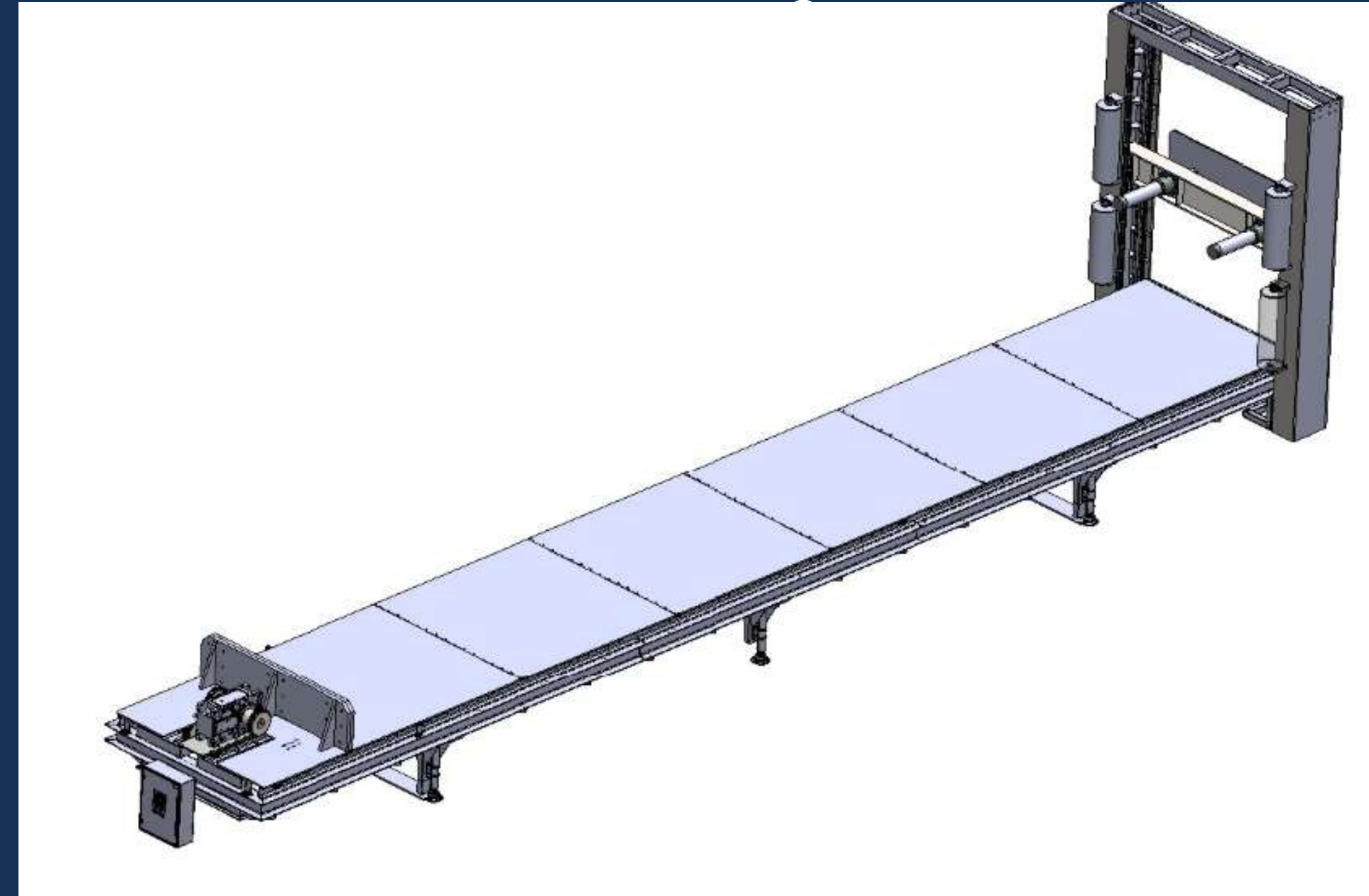
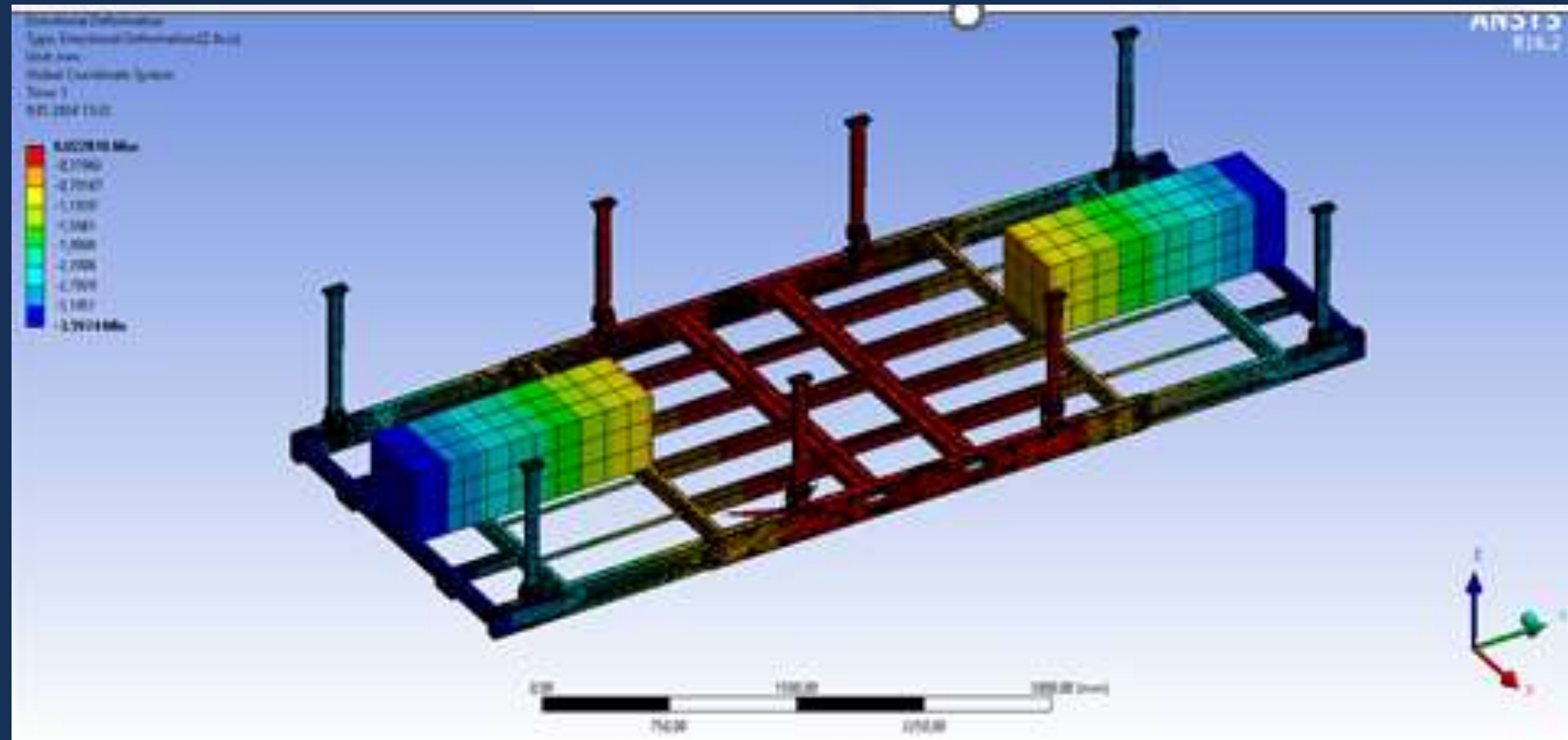

Investment Plan

We have a plan to invest in machinery, equipment and factory area expansion for pipe spool and defense industry.

We have an Investment Incentive Certificate

Document ID: 1075248

Certificate number: 563135

Dated 29.12.2023

