

Automation

Intralogistic

Engineering

Special Machines

Metalworking

Outsourcing

GIPO® EU

UNLIMITED INNOVATION



Vision

Global Innovation and Process Optimization

Mision

We provide high quality customized solutions for individual customer orders

BUSINESS PROFILE

- Dedicated transport solutions for factories and warehouses
- Conveyors and transport lines
- Production of special machines and equipment including wiring, connection and commissioning
- Metalworking services
- Industrial Outsourcing

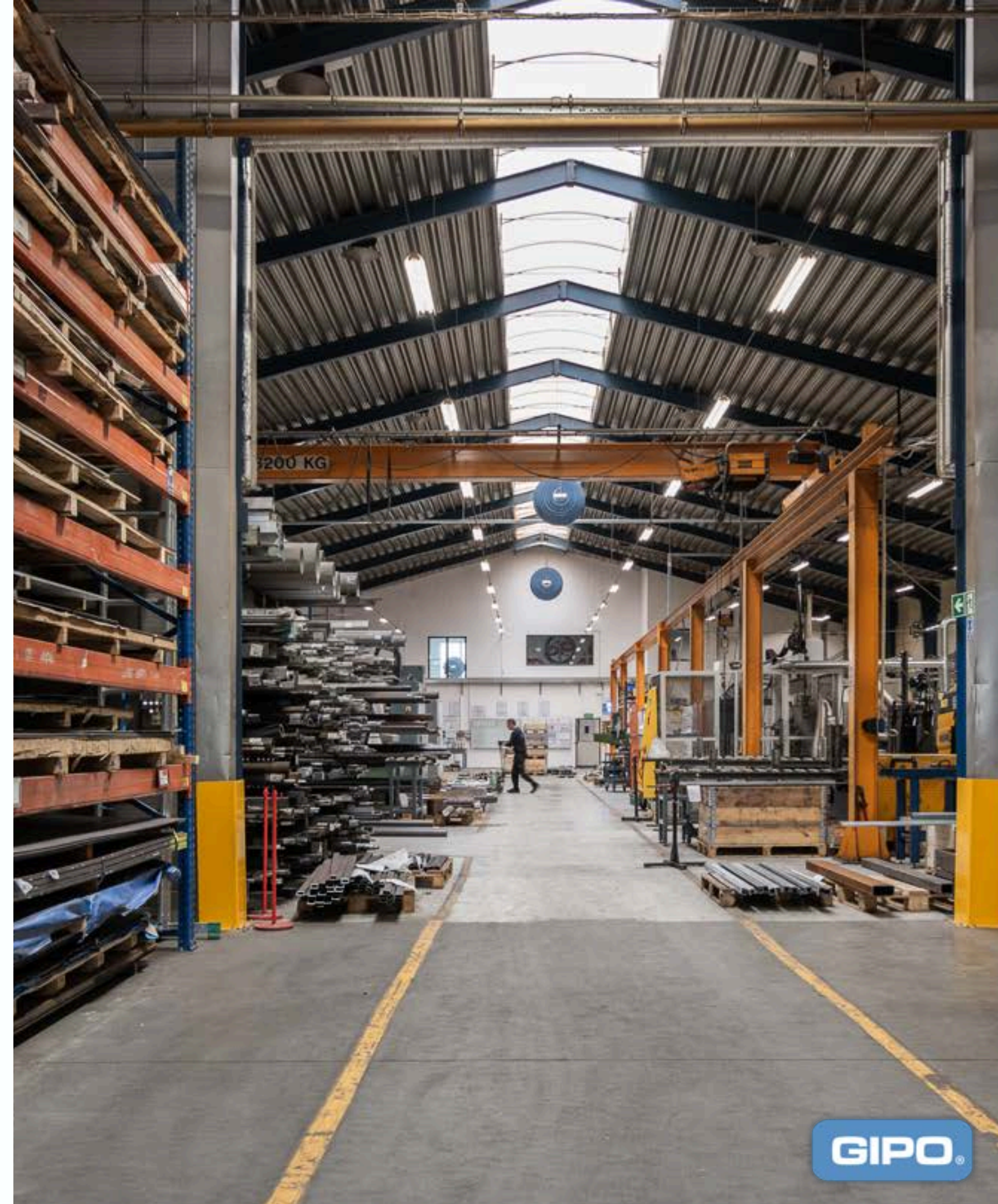

OUR HISTORY

Gipo Sp z o. o. was founded in 2006 and from the very beginning we seized the opportunity of producing parts for the Danish machinery and agricultural industries.

We began the cooperation (contract supplier) with major Scandinavian companies as well as worldwide corporations.

In 2011 we decided to extend our facilities and to purchase innovative machines. One year later we won the prize of "Best Investment of 2012 in our region."



OUR HISTORY

In 2015 we received a distinction from the Minister of Economy for activity in the Republic of Poland and commitment and contribution to the development of the Polish economy.

INTERNATIONAL EXPERIENCE

Gipo has experience in handling international projects. You can find our products all over the world: Europe, Asia, North America.





TEAM

Our greatest potential is an experienced and qualified team of engineers and specialists with many years of seniority in automation and metal industry.

In one location we implement ideas, projects, supervise production processes and test quality.



ORGANIZATIONAL CHART

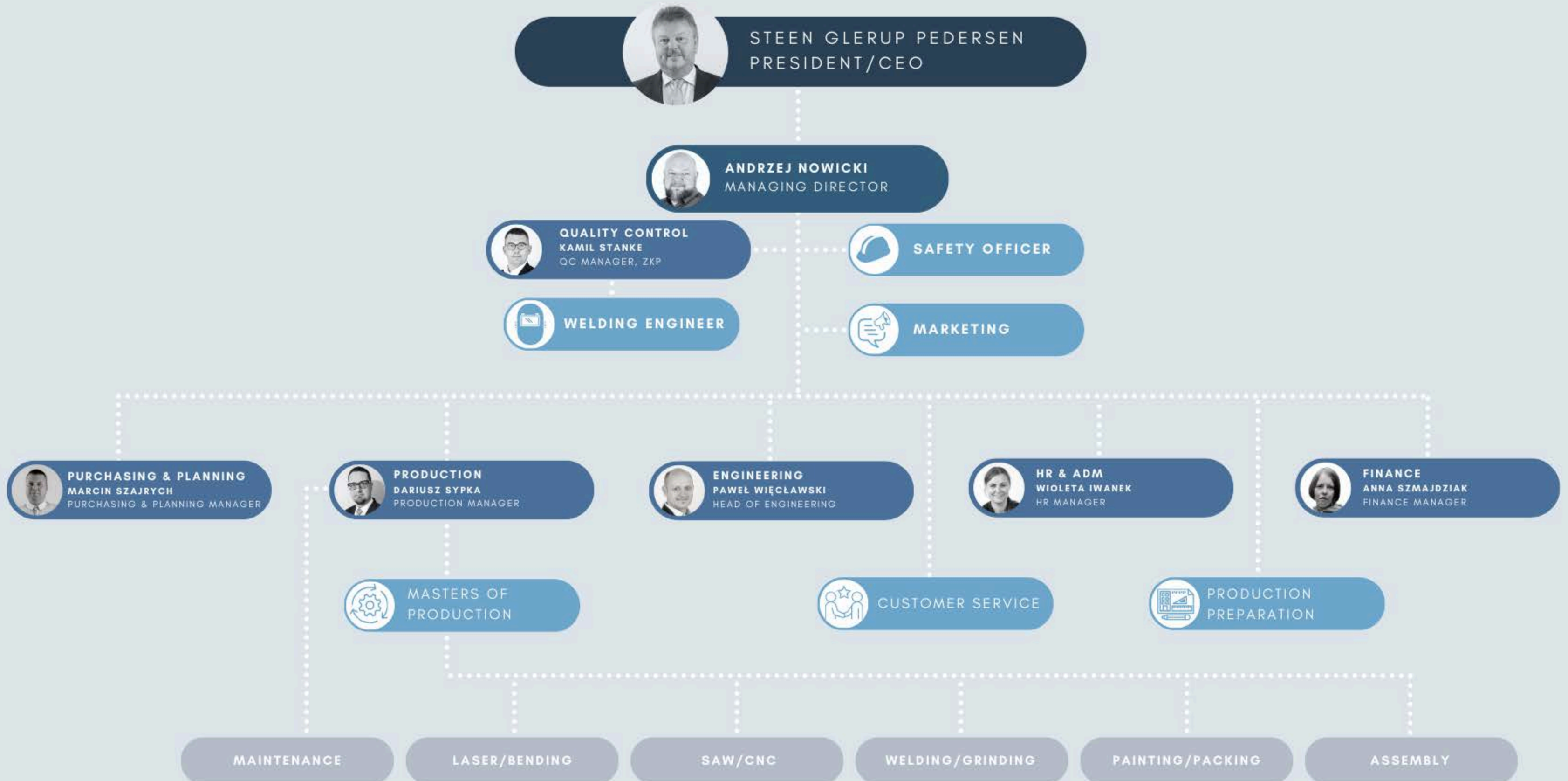

RELIABLE SUPPLIERS

When implementing our projects, we must be sure that we cooperate with the best suppliers who ensure high quality of the solutions offered. For us, quality and timely deliveries are the key parameters assessed by suppliers. Audits of suppliers carried out by Gipo ensure their continuous development, at the same time giving us certainty of the services provided. Right now we have a very good network of suppliers and steel at competitive rates. We are used to working with conveyor components and key suppliers like Rulmeca.



FINANCIAL STABILIZATION

We have a strong financial capacity to invest in structure or capacity levels. That makes us a reliable partner and supplier.

METALWORKING SERVICES AND INDUSTRIAL OUTSOURCING

- Design
- Engineering
- Turning/CNC Turning
- Milling
- Threading
- Drilling
- CNC Bending
- CNC Cutting
- Manual and Robot Welding
- Shot blasting
- Powder coating
- Spray painting
- CE Marking
- Installation



METALWORKING SERVICES AND INDUSTRIAL OUTSOURCING

- Parts manufacturing
- Special machines for all industries. Machine and equipment manufacturing including wiring, connection and commissioning.



MACHINING

We work on modern
CNC machine tools
and conventional
machine tools



Automatic CNC
turning center
Aero Turn BT 300
Machining of
elements \varnothing 410
mm, length 500
mm



CNC milling
machine Correa
Norma L 60
Machining of
elements with
dimensions
6000x1250x1500 mm

MACHINING



THANKS TO THE 5-AXIS MILLING MACHINE WE CAN PROCESS VARIOUS DETAILS IN ONE FASTENER

BENDING



Bending press CNC, including press for bending metal sheet up to 4200 mm length pressure force 2900 kN

BENDING



Bending press
integrated with a robot

Through the use of advanced software and automated machinery, we offer accuracy, efficiency and repeatability. Achieving perfection in metalworking requires a combination of technical expertise, meticulous planning and attention to detail.

LASER CUTTING

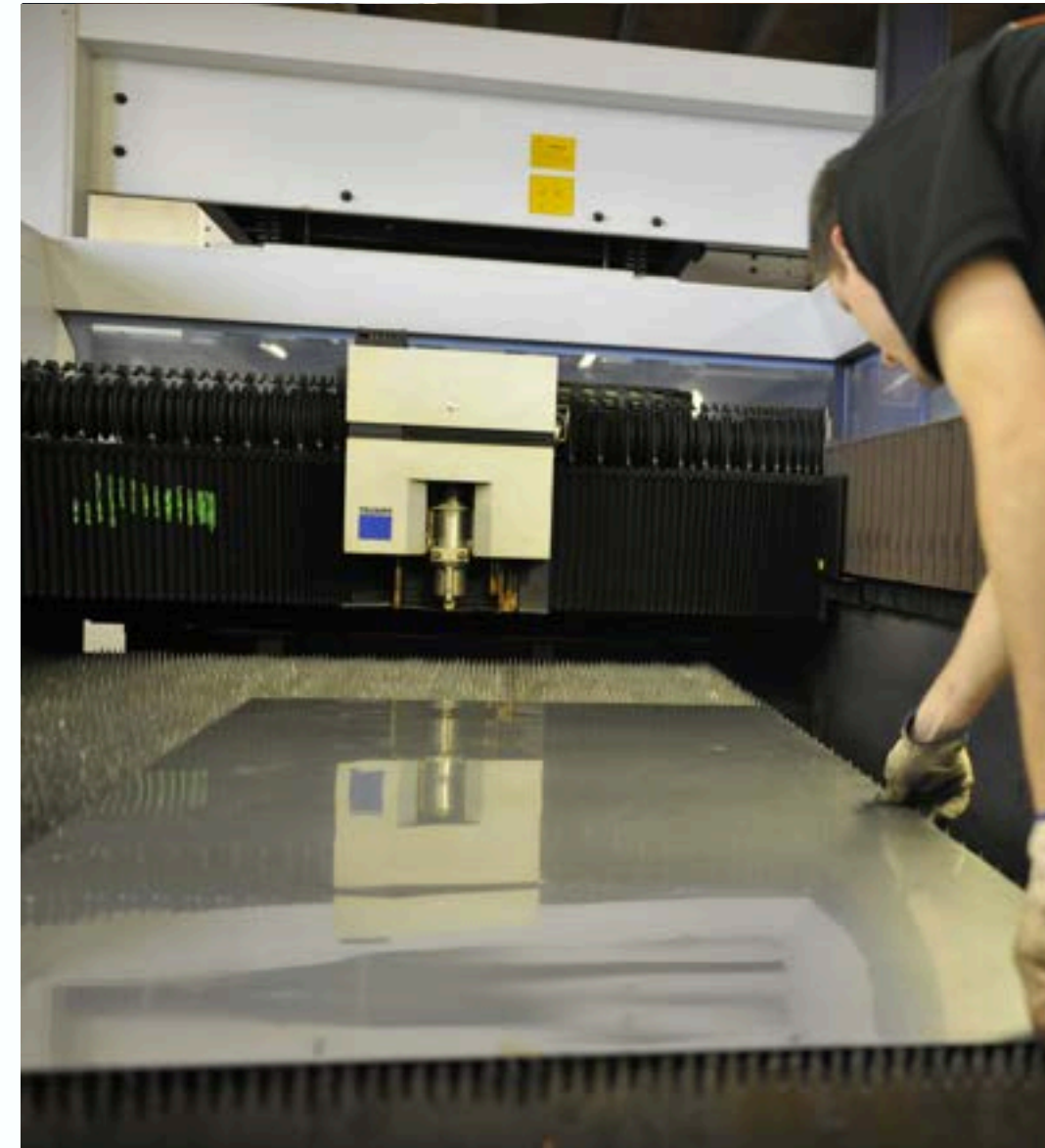
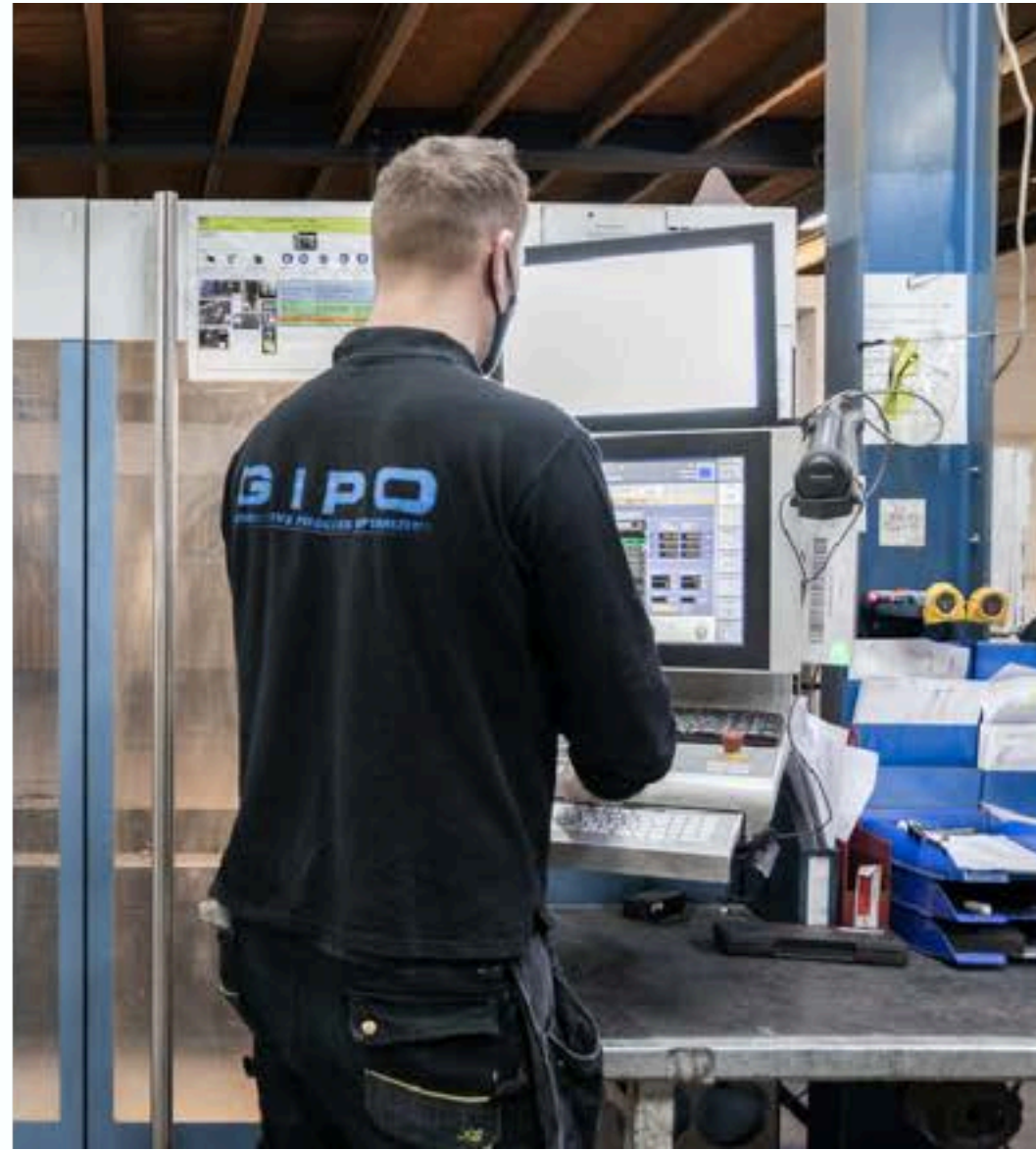

LASER TRUMPF

4 kW with 1500 x 3000 x 25 mm working area
with automatic material loading and unloading

LASER FAVOR

25 kW with 1500 x 3000 x 20 mm working area

WELDING

MANUAL WELDING WITH
MIGATRONIC MIG AND TIG
WELDING MACHINES, WELDING
ROBOTS AND PLASMA WELDING
MACHINES

POWDER COATING

At Gipo's headquarters, we operate two precision powder coating lines.

Manual line for big parts, max dimensions of the painted item 2500x2500x6500mm

Automatic line with pretreatment (shot blasting) and phosphatizing max dimensions of the painted item 1000x2000x3000mm



SPRAY PAINTING

At Gipo's headquarters, we operate one precision spray painting line.

The spray painting setup comprises an enclosed booth for both application and drying, painting units, and a paint storage facility with environmental monitoring. The booth's dimensions measure 7.5 meters in length, 4.0 meters in width, and 2.8 meters in height.



SPRAY PAINTING

To enhance sustainability, the painting booth is fitted with a warm air recuperation system, enabling the reclamation of up to 80% of warm air. This innovative solution notably minimizes gas emissions into the atmosphere, among other benefits.



PROJECTS

Intralogistic

We design comprehensive solutions for factories and warehouses as well as single, individual solutions to modernize existing material handling lines.

We operate comprehensively and in one place. From concept, through design and implementation.



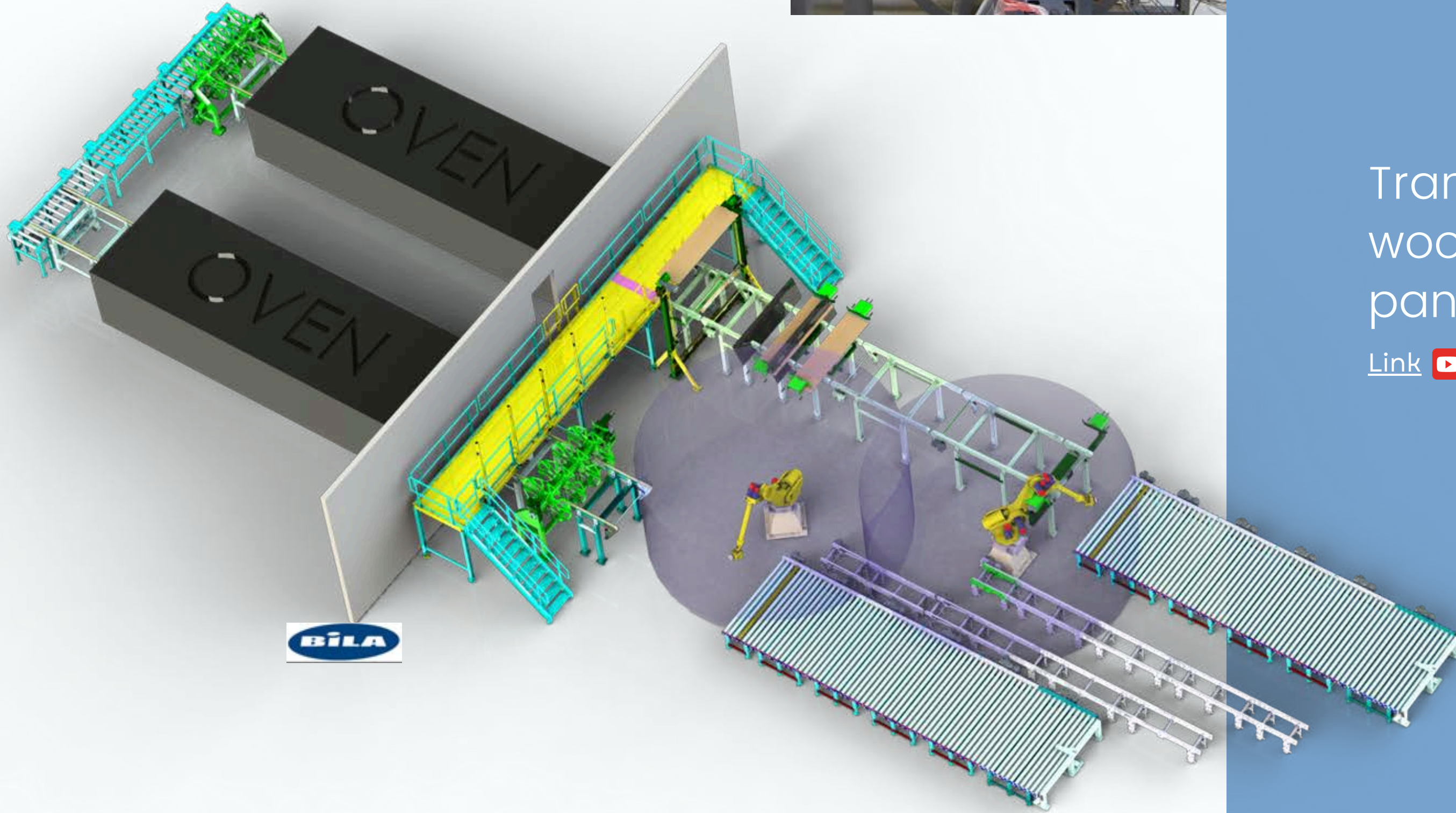

Transport line for
wooden acoustic
panels

[Link](#) 

Window assembly line

Transporting windows
in vertical position,
turntable and
automated rail cart.

idealcombi
APPROVED INSTALLER



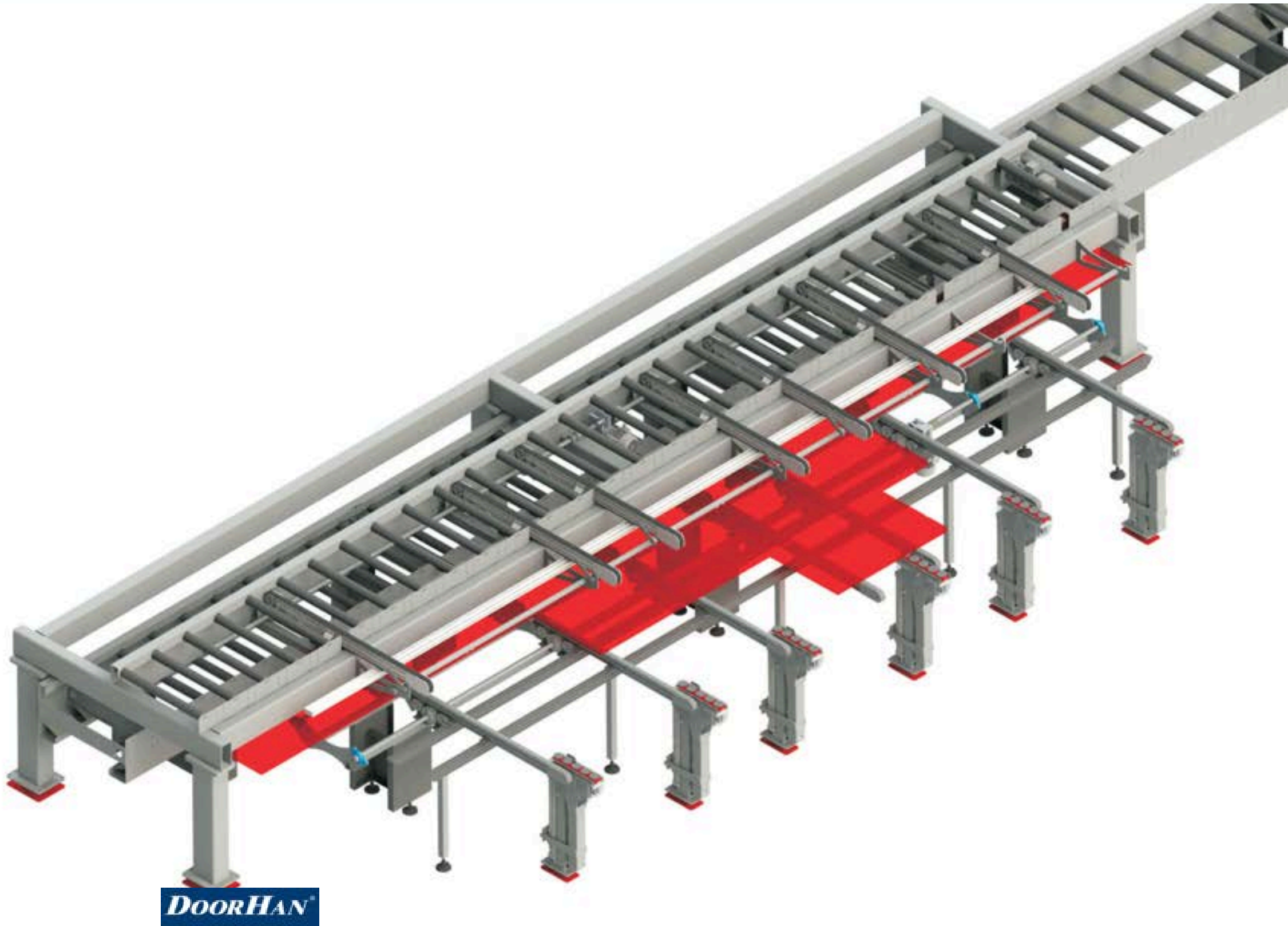

Transport line for the production of industrial gates. Roller conveyors, belt conveyors, cross transfer.

[Link](#) 

Transport line with automatic sorting system for construction industry.

[Link](#) 

Projects for Swisspearl Group a lider in construction industry produce high-quality, sustainable, products made of natural fiber cement for facades, interiors and gardens.

We have been part of the factory project in Hungary. Our scope of work includes design, production, transport and installation at the customer's site.

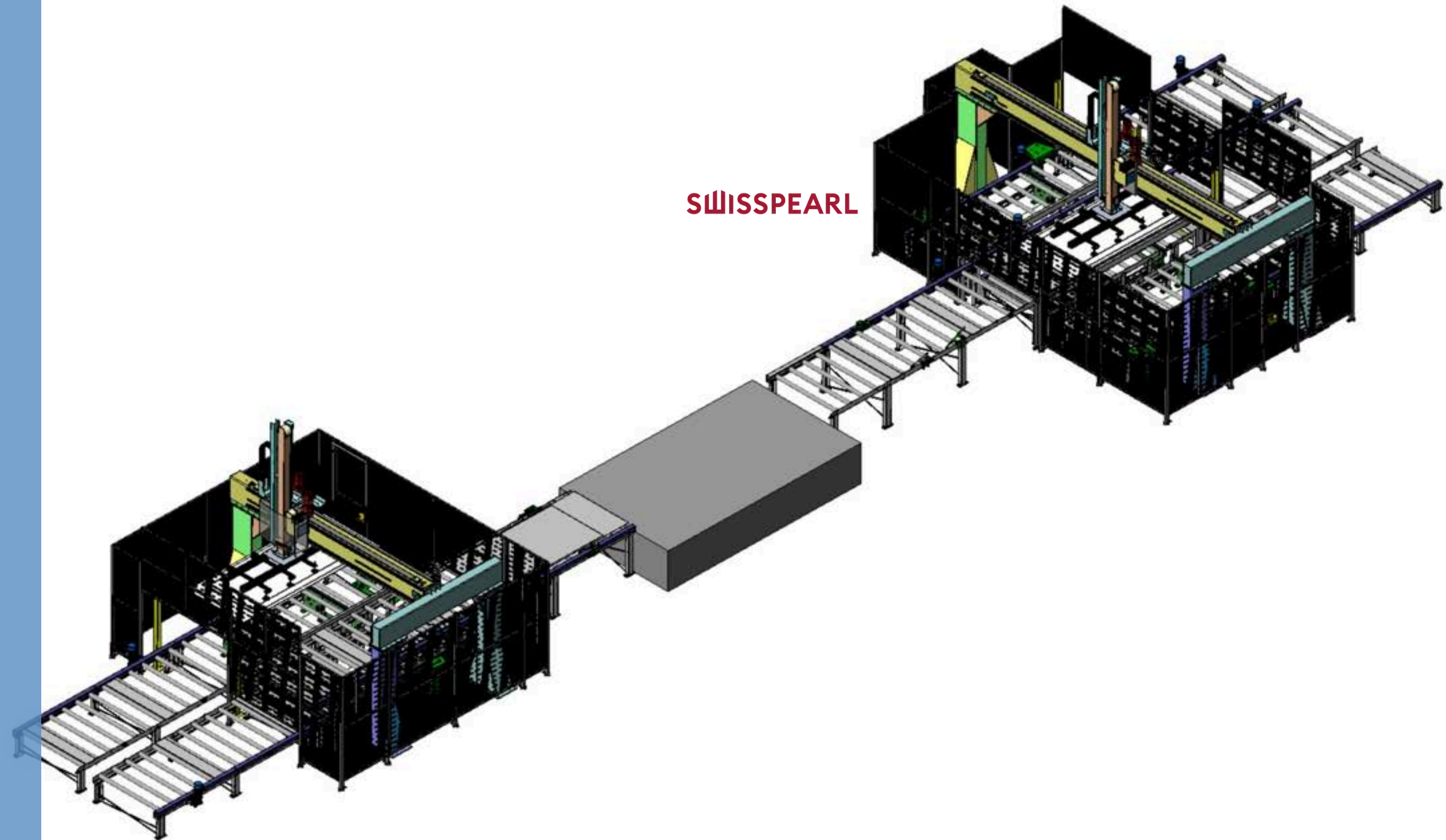

SWISSPEARL

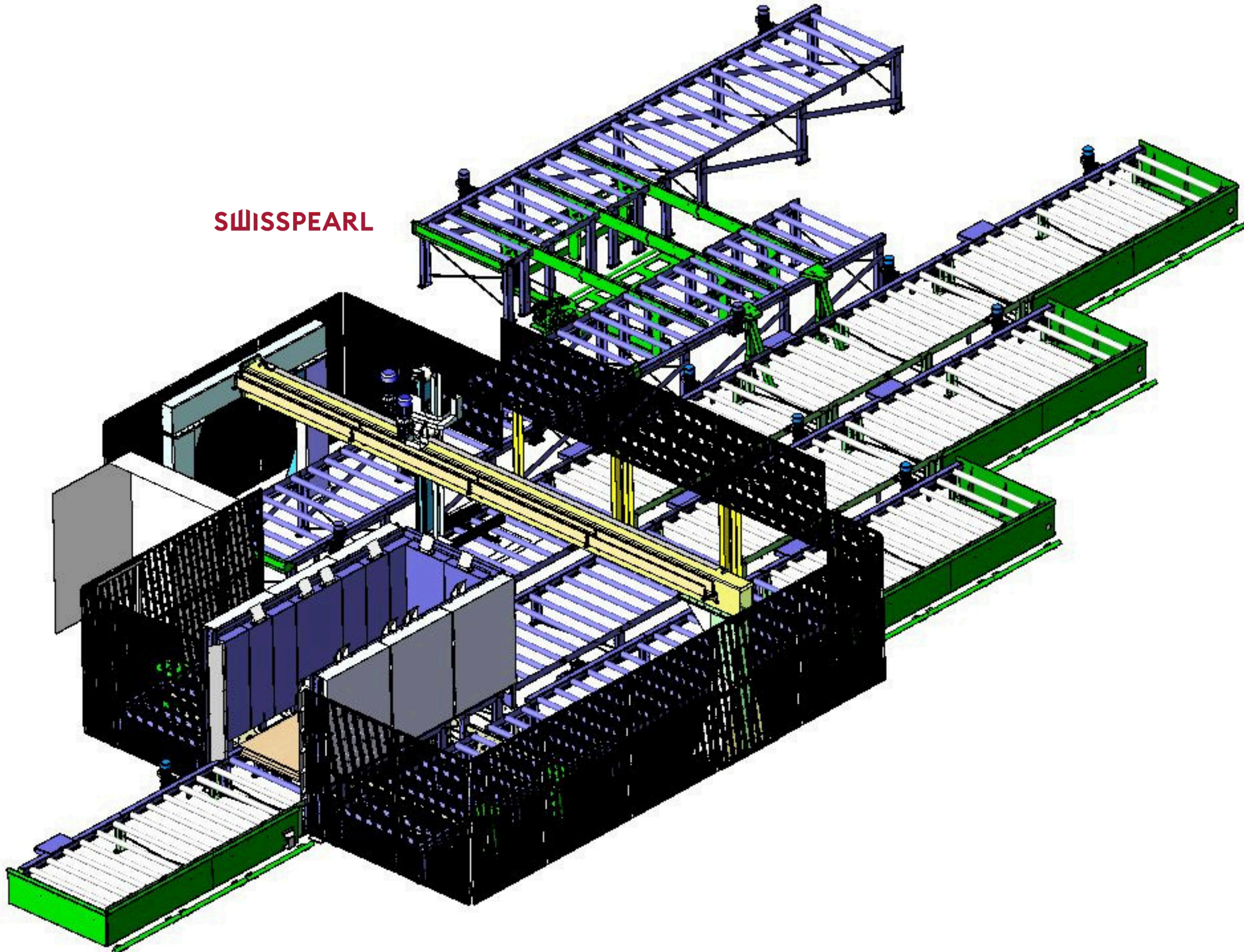

Transport line with automatic sorting system for construction industry.

Gipo project includes:

- Transport line with gantry and measuring thickness system for grinding machine
- Transport line with an automatic sorting system
- Buffer line with automatic cart
- Depalletizer on the sorting line

[Link](#) 

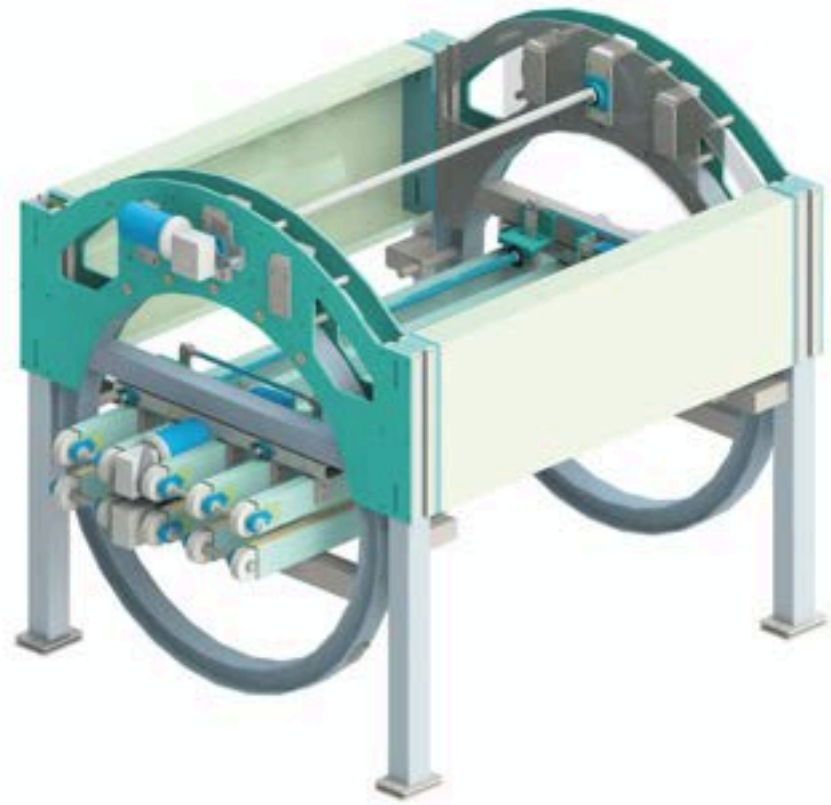

Automatic turning device
for fibercement

[Link](#) 

Implementation of projects included production of a transport line with a total length of over 390 m, consisting of roller conveyors, chain conveyors and portals for changing the position of transported loads.



SWISSPEARL

Automation for warehouse in freezing houses

[Link](#) 

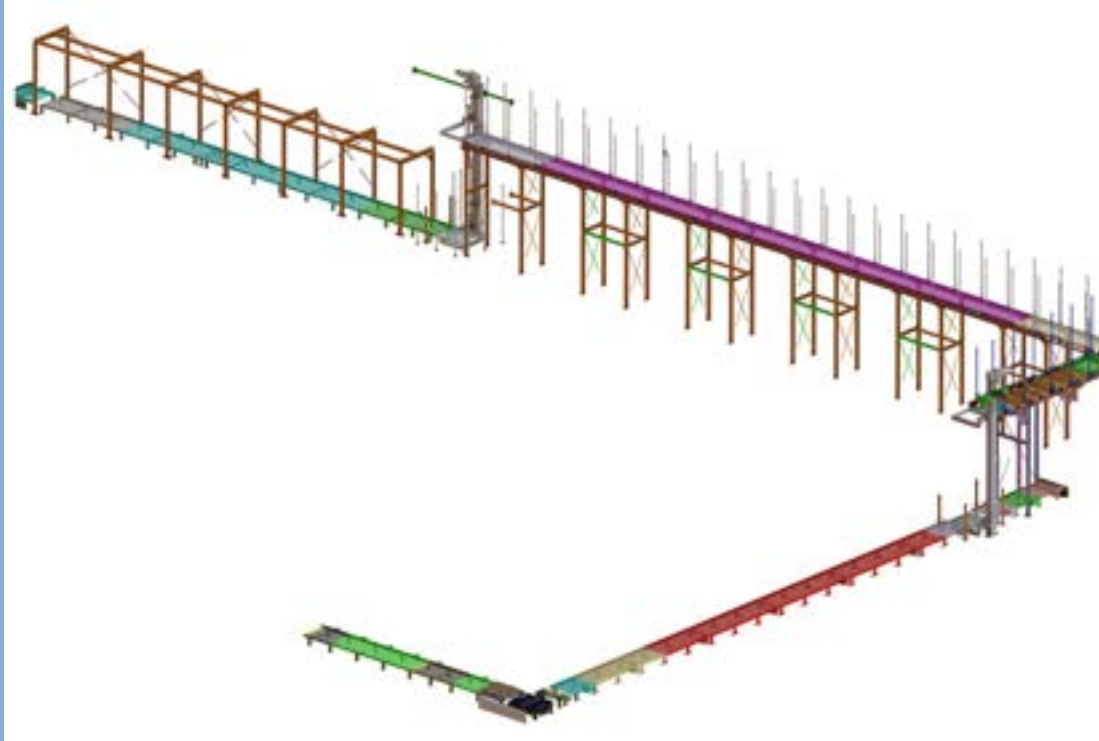

Project included over 100 m of transport line, consisting of roller conveyors for which 700 pieces of rollers, turntables and two lifting lifts. Automatic line (43 pieces of gearmotors) is equipped with control and safety systems.



CONVEYORS

Our conveyors are tailor-made for each customer, offering an ideal solution for efficient transport.

The conveyors can exist as stand-alone units or be part of transport line. Gipo roller conveyors are suitable for any type of pallets, they also have the ability to be set up in different configurations. In the case of modernization of an existing transport line, we can easily fit additional conveyors and equipment.



Automated trolley with roller conveyor

Roller conveyor
with rotation

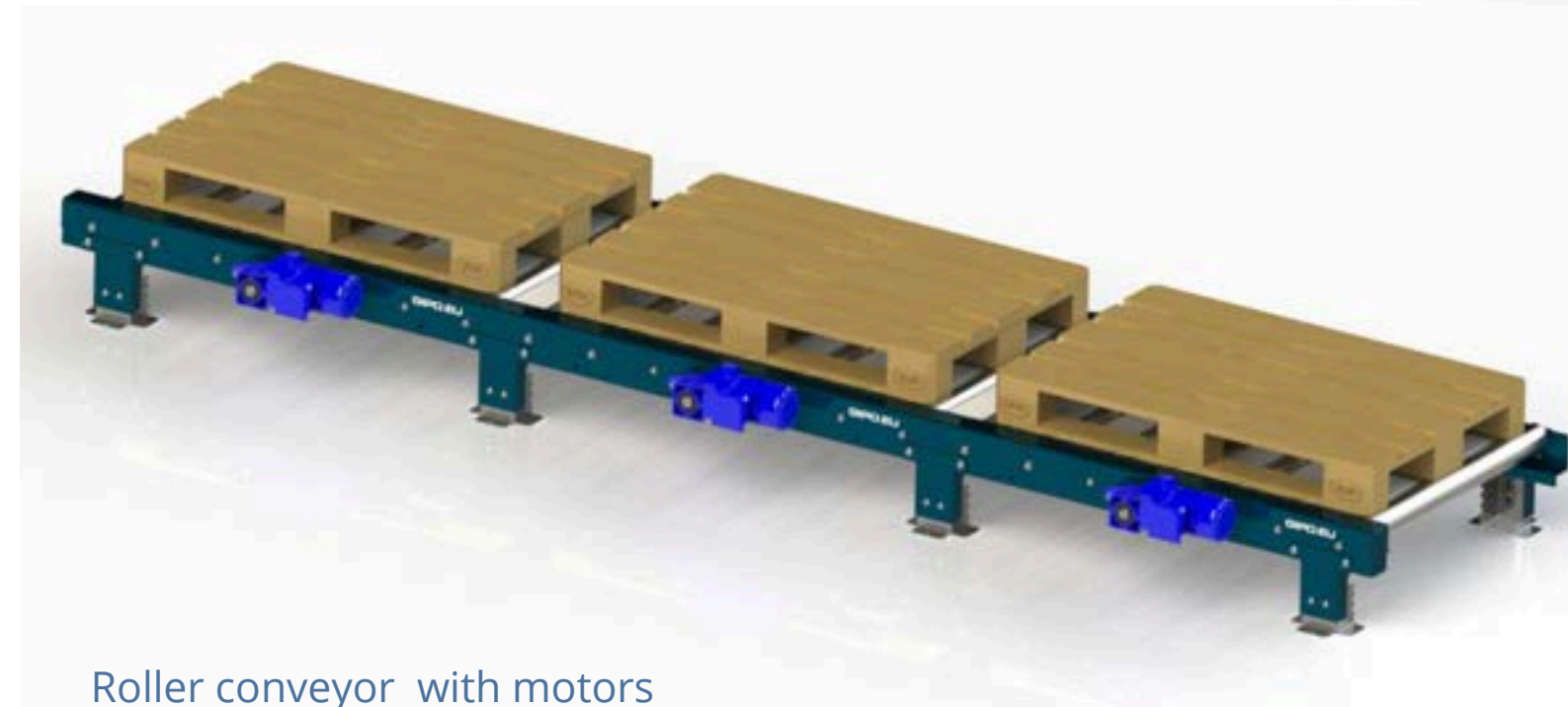

Roller conveyor with motors



ironospaam

THE BULK CONVEYOR

GIPO®

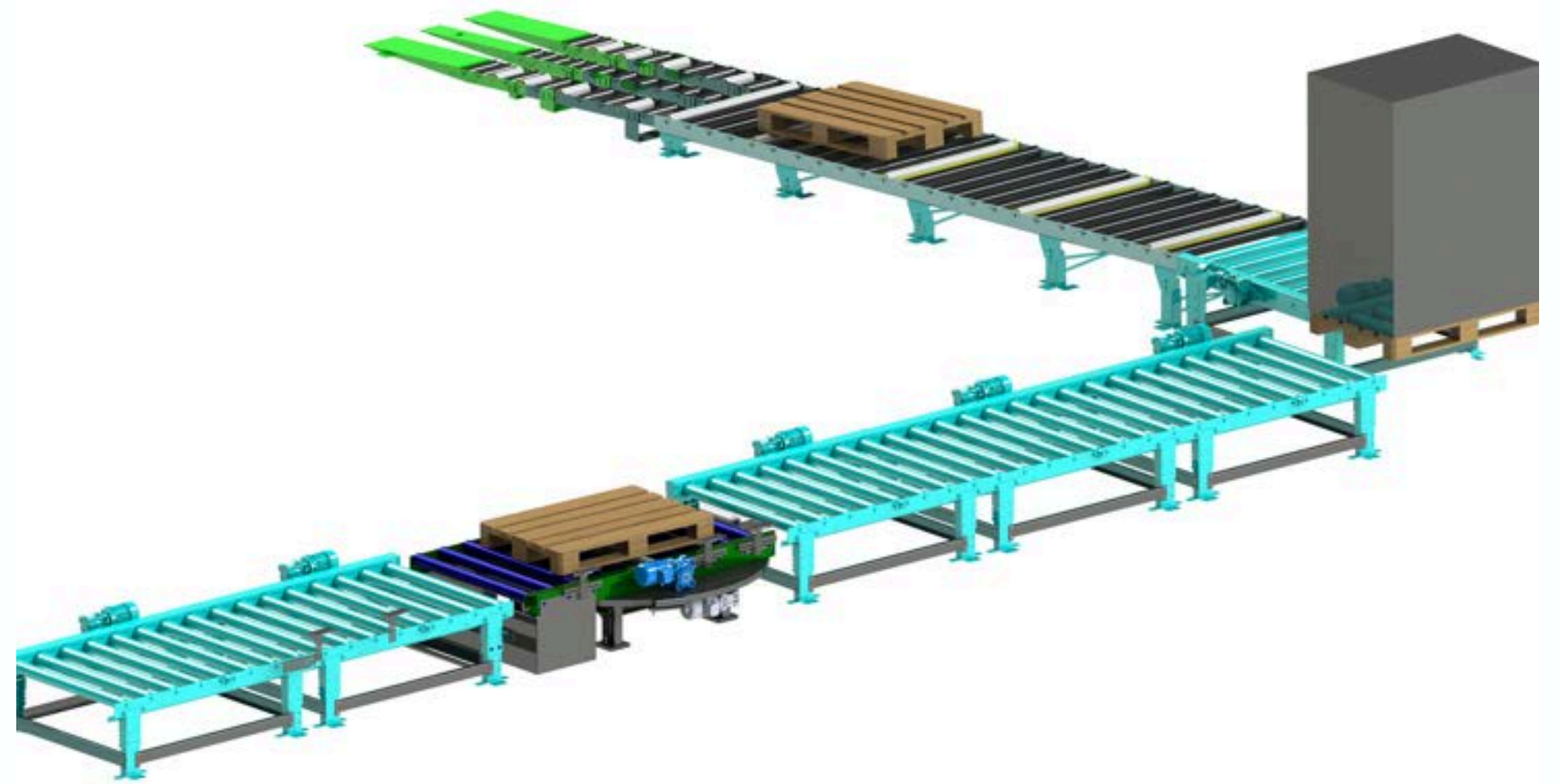

TURNTABLE - CHANGE OF DIRECTION
OF TRANSPORTED LOAD

We adhere to stringent quality management systems, including ISO 9001:2015, ISO 14001:2015, ISO 45001:2018, EN 3834-2, EN 1090-1, EN 1090-2 (EXC3), and EN 1090-3 (EXC3).

Our Quality Control Department employs cutting-edge methods and precision measurement techniques to oversee every stage of production.

We supervises production at every stage using advanced methods and measurement techniques. We use NDT methods to detect any defects or irregularities in critical components such as welds, castings and forged parts.



We Cooperate With



GIPO Sp. z o.o.

ul. Bohaterów Warszawy 35

75-211 Koszalin

Poland

VAT: PL 669 24 27 455

E-mail: contact@gipo.eu

Phone: +48 94 340 09 09



UNLIMITED INNOVATION