

# ATLAS22

## Ground Test Release Actuators

Get faster in the new space race.

Development of space mechanisms with space qualified release actuators can be long and expensive process. Some of the units still need to be sent abroad for refurbishment after each release. **ATLAS** ground test actuators make the development **affordable, fast** and **representative**.

The unit envelopes a broad range of commercially available space-rated non-explosive release actuators, with the representative mechanical interface and release times.



ATLAS is especially efficient in the development of **reusable multi-actuator mechanisms** with precise synchronization. **Initiation Control Unit (ICU)** allows for control of multiple actuators at the same time. Release scenarios can be easily prepared in the control software by a few mouse clicks. The actuators are rapidly resettable by replacing the cartridge with **redundant initiators** and are reusable.

**Space rated model ATLAS ORBITAL is coming in 2027.**

### ATLAS22 features

|                             |   |
|-----------------------------|---|
| <b>Mechanical interface</b> | User customizable (to match NEA, Glenair, Eaton, Arquimea...)     |
| <b>Release bolt thread</b>  | User customizable up to M8  |
| <b>Max. release preload</b> | <b>22 kN</b>  |
| <b>Design limit load</b>    | 33 kN   |
| <b>Mass</b>                 | 270 g (without harness and connector)                             |
| <b>Actuation</b>            | PC controlled current pulse (multiple actuators)                  |
| <b>Release time</b>         | <b>&lt; 50 ms @ 7A</b> with ATLAS control electronics (ICU)       |
| <b>Reset</b>                | Release Initiation Unit replacement in minutes with supplied tool |
| <b>Life</b>                 | 50 releases according to ECSS-E-ST-33-01C (>200 tested)           |
| <b>Temperature range</b>    | Laboratory conditions   |

Alumni of:



BUSINESS  
INCUBATION  
CENTRE

Czech  
Republic

## ATLAS22 INTERFACES

### BOTTOM VIEW:

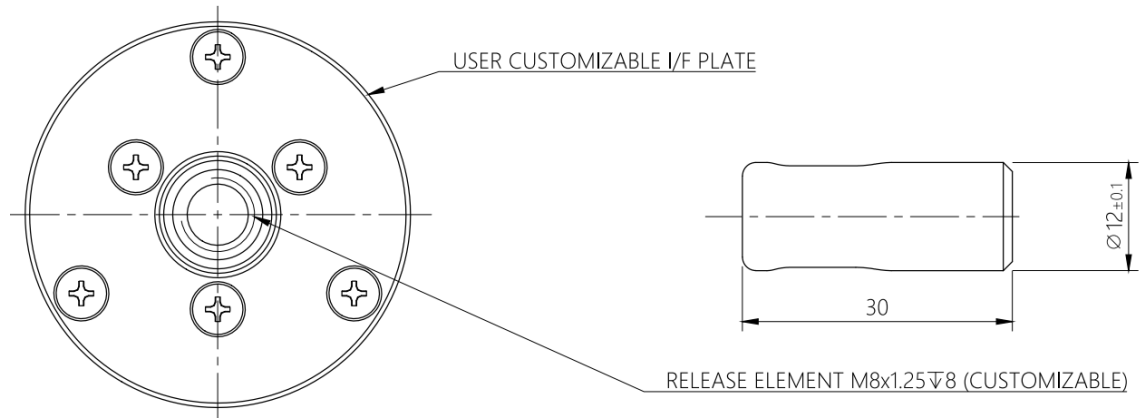

### SIDE VIEW:

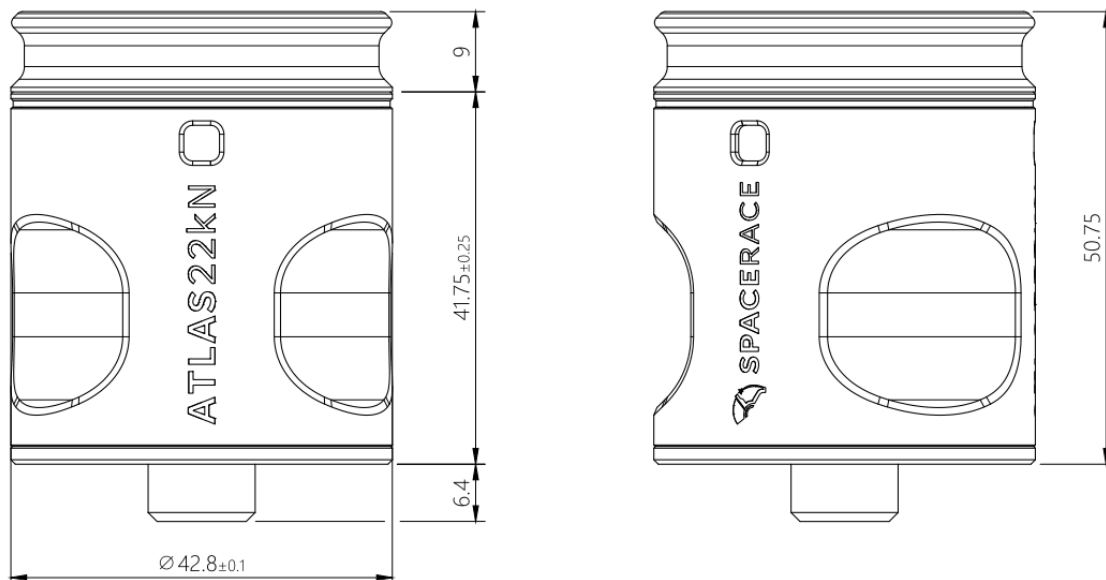

**SPACERACE s.r.o.** ID: 17589991  
Purkynova 649/127 ESA STAR: 1000040783  
Brno 612 00, Czech Republic [www.SPACERACE.cz](http://www.SPACERACE.cz)