

CBG SeaPan WP 25/15

TDS No. 7802

Fire-resistant composite sandwich panel based on basalt and ceramic.

CBG SeaPan WP 25/15 offers completely new solutions to the manufacture of partition walls in shipbuilding or in dry construction. The use of lightweight composite materials (e.g. with only approx. 7,8 kg/m² for a wall panel of **fire class A-30**), makes it possible to significantly reduce the total weight of a construction).

- ✓ 100% natural
- ✓ non-combustible
- ✓ no smouldering
- ✓ no smoke in case of fire
- ✓ heat-insulating
- ✓ sound-insulating
- ✓ mechanically loadable
- ✓ moisture-resistant
- ✓ vibration-absorbing
- ✓ corrosion-resistant
- ✓ chemically neutral
- ✓ recyclable

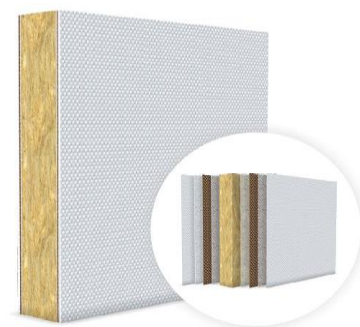

Properties	Data
Description	Wall panel
Application area	e.g. production of cabin walls for shipbuilding, residential and office containers etc.
Surface density, [kg/m ²]	7,8 ± 10% with moisture content – max. 4 %
Gross thickness, [mm]	25 ± 1
Material	ceramic basalt fibre and glass fibre laminate, specific mineral wool (basalt fibres), inorganic fire protection adhesive
Core material density [kg/m ³]	170 ± 15%
Non-combustibility	non-combustible (classification in acc. with IMO 2010 FTPC Part 1)
Fire classification	A-30 (classification in acc. with IMO 2010 FTPC3)
Inorganic content [%]	approx. 99
Thermal stability, °C	up to 1.300
Connection within construction	e.g. tongue and groove, mounting rails, screws and other mounting materials
Surface area *	Front side: ceramic reinforcement (option: coated with HPL/CPL decorative foil in various colours, flame retardant according to IMO 2010 FTP Code) Back side: ceramic basalt glass fibre plate
Width * / Length *	up to 1200 ± 1 mm / up to 2980 ± 2 mm

* - Various sizes and surfaces are possible upon request

Delivery

- ✓ Delivery on pallets wrapped with stretch film
- ✓ Connecting strips and adhesives are available upon request



Certification

- ✓ CBG Composites GmbH CBG lets certify its products manufactured for the use in shipbuilding in accordance with valid IMO MED guidelines. We provide you further relevant information upon request

Processing and storage

- ✓ Processing with standard cutting tools is possible
- ✓ The usual protective measures must be taken during processing. Gloves, respiratory protection and safety glasses are recommended. Please note the instructions for use "Handling mineral wool and insulation materials (glass wool, rock wool)" from BG Bau or local legal regulations
- ✓ Horizontal storage, e.g. on pallets, on a level surface, secure against slipping

Subject to modifications

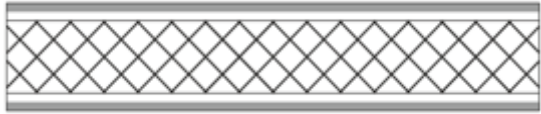
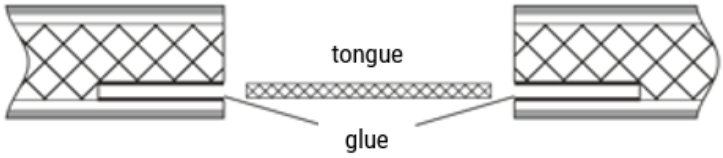

Product structure	
Description	Layout drawing
Outer layers: Basalt glass ceramic plates in combination with inorganic non-flammable adhesive mass "LR Ceramatrix 01-50"	
Calibrated mineral wool core	
"Tongue and groove" - for panels with a ceramic glass-basalt laminate surface (connecting strip: basalt ceramic composite)	

Fire protection tests

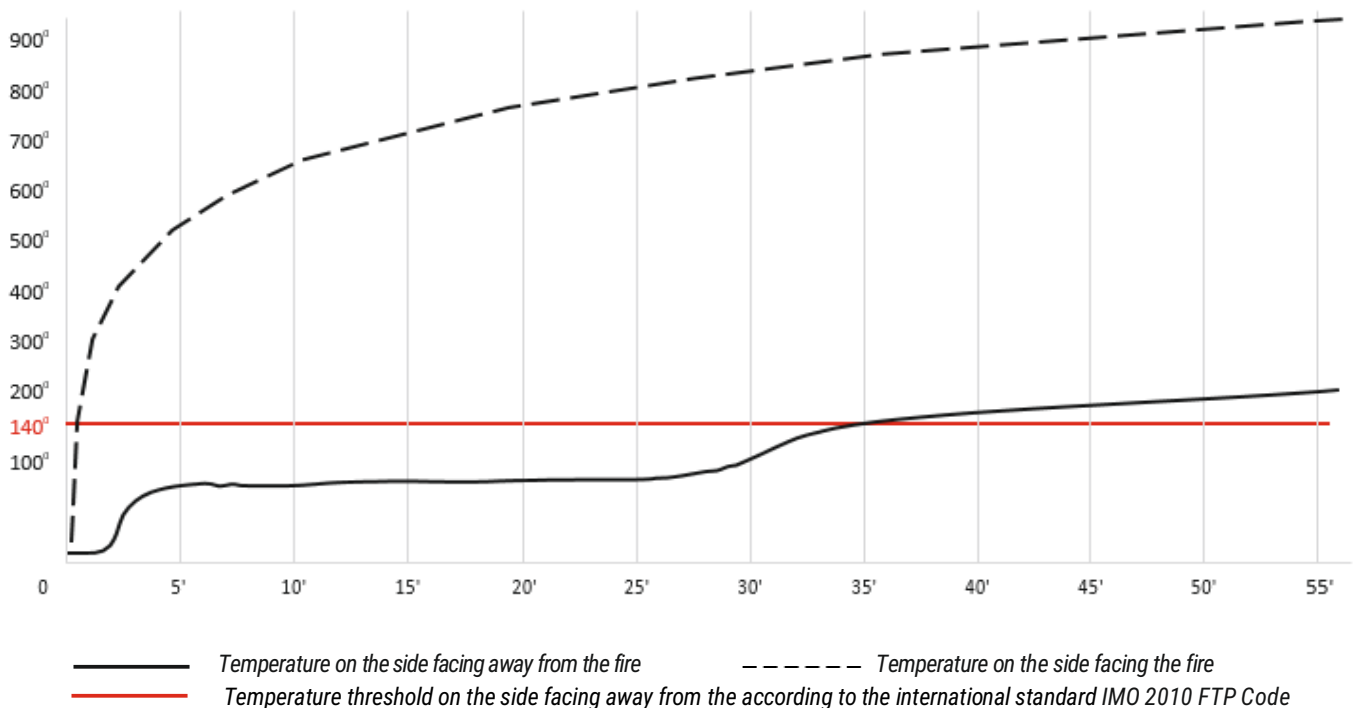



The essence of CBG-SeaPan is that the sandwich panel has a surface layer of multi-layer non-combustible basalt glass ceramic laminate on both sides. The core material consists of specially prepared mineral wool. All layers of this sandwich structure are bonded together by means of an inorganic non-flammable adhesive "LR Ceramatrix 01-50" with endothermic effect.

The use of light, durable, non-flammable materials makes it possible to halve the weight of the panel compared to conventional panels where sheet metal is used as an outer layer. The considered fire resistance class is not affected by the weight reduction.

Subject to modifications



 CBG Composites GmbH Egerpohl 2 D-51688 Wipperfuerth / Germany
 Tel: +49 2267-67-0, Fax: +49 2267-67-222

 www.cbg-composites.de
 info@cbg-composites.de

Technical information on our products reflects our knowledge state at the time of printing. As our experience and knowledge are constantly evolving, the latest edition of the data sheet should always be used. In case of doubt please contact us. The presented pictures are intended as references. Original products may deviate. The listed applications are only exemplary, may vary in individual cases and are therefore not relevant for liability. Our general terms and conditions apply and can be downloaded from our homepage.