



# Stages

**CONSTRUCTION PROJECT  
MANAGEMENT PLATFORM**



POWERED BY





# BUILDING HISTORY TIMELINE & ISSUE MANAGEMENT TOOLKIT





# WHY STAGES?

---

**STAGES** is a professional platform for construction progress monitoring and cross-sector communication, providing easy access to facility digital documentation.

Most important features:

- Facility Digital Twin Timeline & split-screen
- Cross-sector communication toolkit & reports
- Advanced collaboration & sharing options

# FOR WHOM?

---

**STAGES** is dedicated for:

- building owners
- construction companies & subcontractors
- facility managers
- architects & interior designers
- insurance companies & banks

POWERED BY  
 **Matterport™**

 **Stages**







## CHALLENGES

### MARKET DIVERSITY

---

Lack of up-to-date digital facility documentation, compounded by the presence of diverse formats without centralizing file management.

### PRODUCT PRICE

---

Expensive engineering software is a barrier. There's a need for affordable facility management tools accessible to a broader user base.

### FACILITY MANAGEMENT

---

Managing or verifying pre-loss conditions in comparison to current ones proves challenging in the realm of property loss.



# SOLUTION

## VERSATILITY

---

A unified platform for hosting diverse building representations (scan, CAD, and BIM) to facilitate seamless and transparent comparisons at any given moment.

## DIGITALIZATION

---

Harvest digital representations of facilities during construction, renovation, or usage stages, accessible to a broad community of professionals.

## SAFETY

---

Enable seamless and accurate property loss verification, simplifying insurance claims.







 **Stages**

POWERED BY

 **Matterport™**

issue communication

Matterport Timeline

**OVER TIME CONSTRUCTION MONITORING SOLUTION  
AND CROSS-SECTOR COMMUNICATION PLATFORM**



# COORDINATION COMMUNICATION COLLABORATION



STAGES empowers users with the ability to annotate, post issues, and collaboratively resolve them. This entire process is archived within STAGES, creating a comprehensive historical log of property documentation.

building history

reported problem



watch video





# MULTIPLATFORM



STAGES web app functions on smartphones, tablets, and laptops, supporting Windows, Android, macOS, and iOS operating systems. Additionally, the standalone platform operates on both Windows and macOS environments.

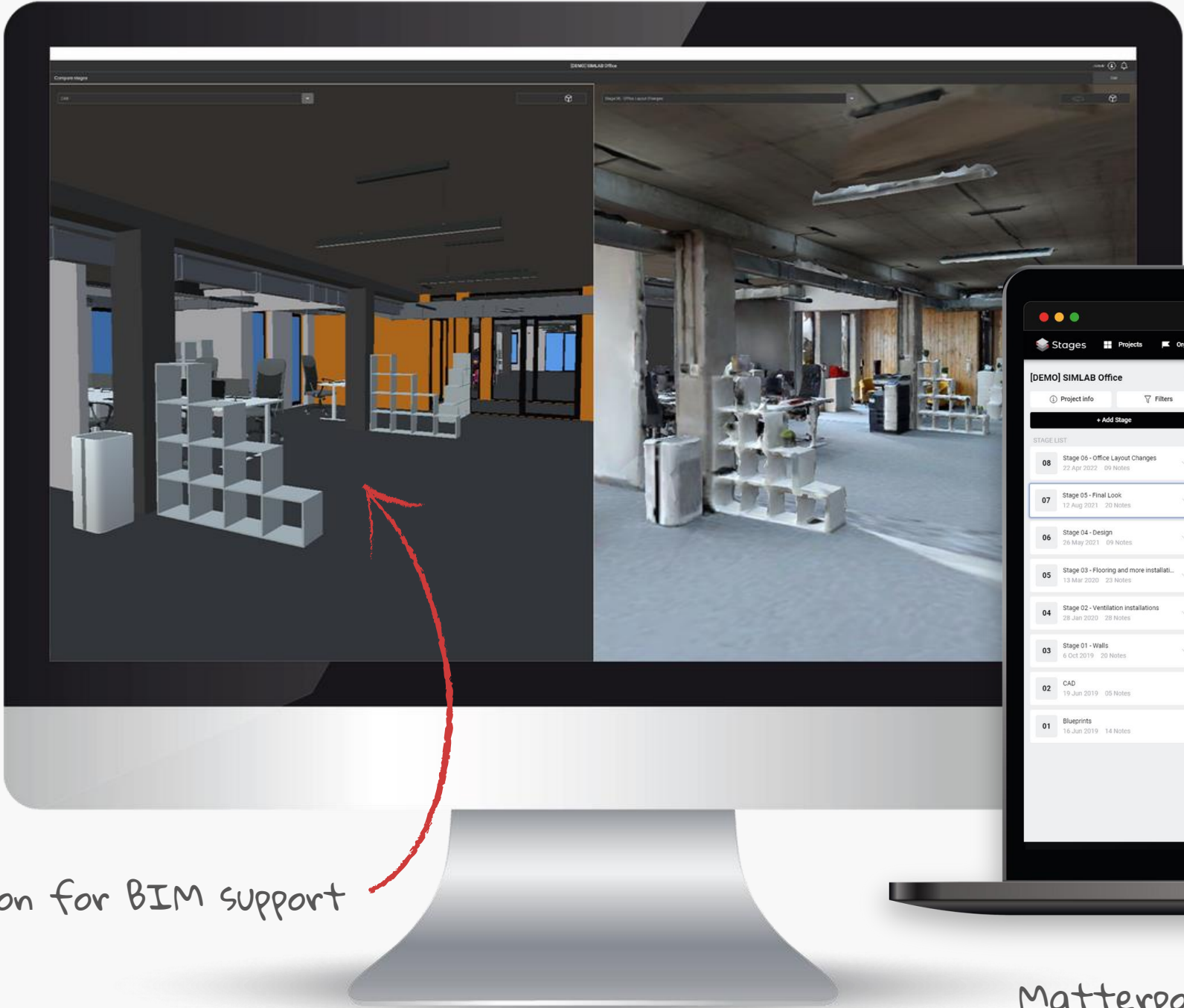

desktop version for BIM support

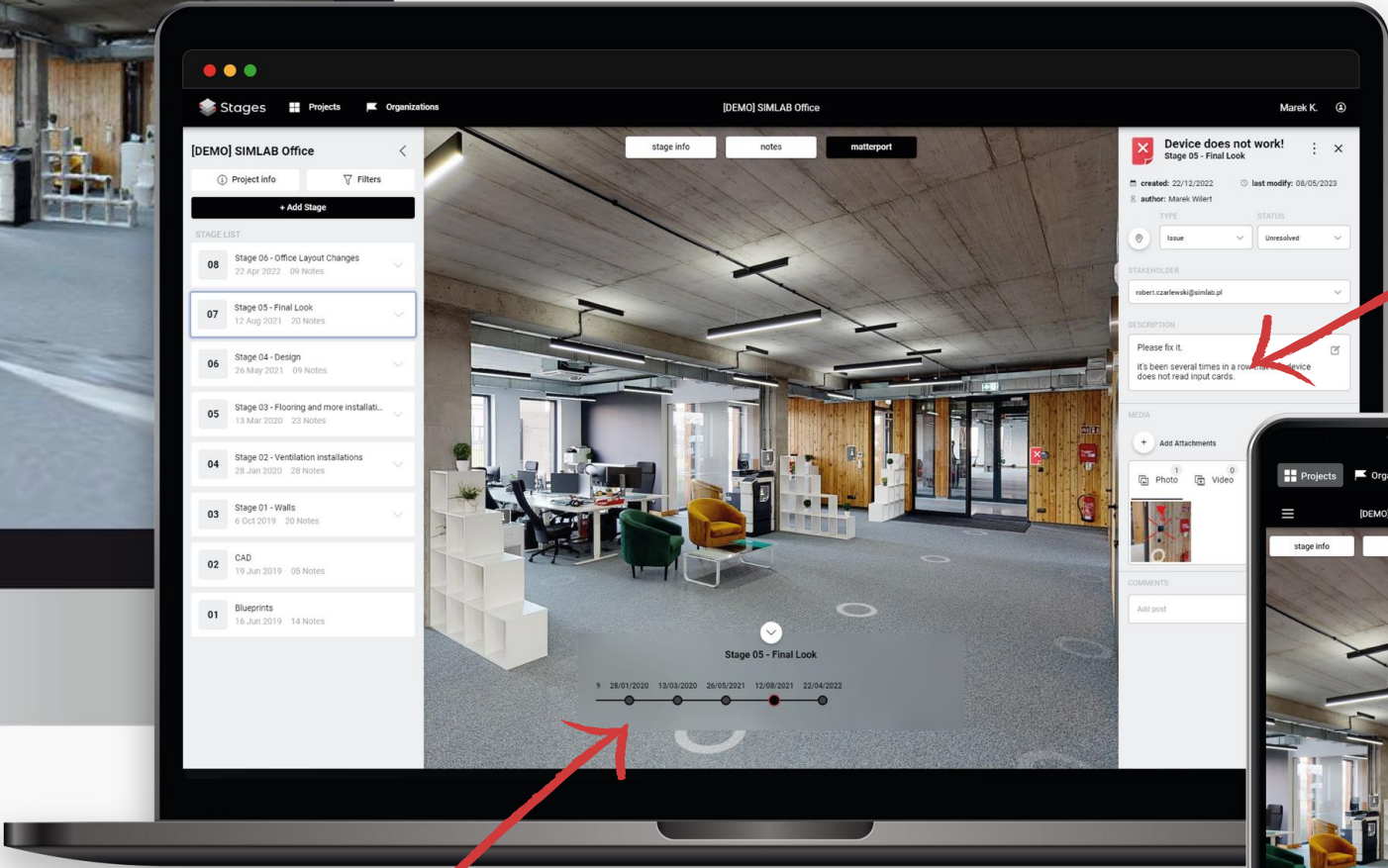

Matterport Time-Line

issue collaboration





# FEATURES OVERVIEW 1



## WEB

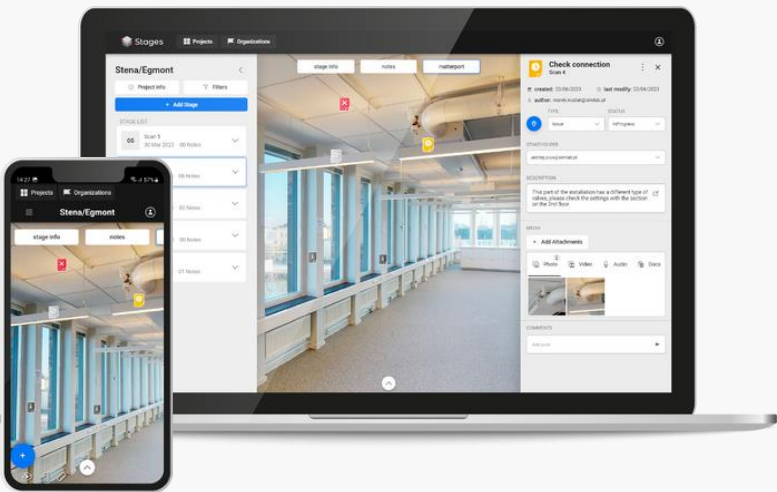

## DESKTOP

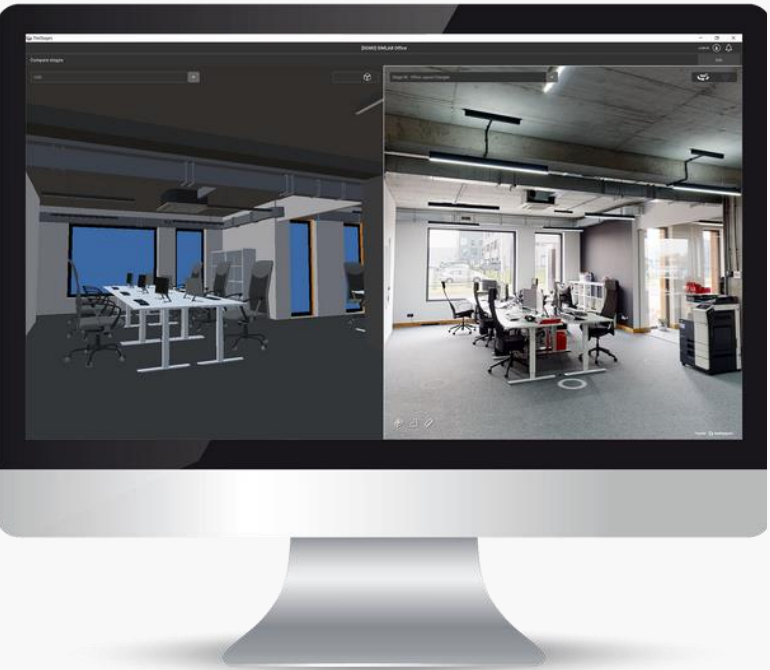

### Specification

- Handy tool for communication and easy access for facility documentation
- Dedicated to laptops and mobile devices
- For remote, on-site use
- Low hardware requirements
- Split screen effect for Matterport 3D walk

- Professional platform for construction management
- Dedicated to desktop computers
- For home & office standalone use
- Higher hardware requirements for full spectrum of advanced features
- Split screen effect between Matterport 3D walk, BIM model
- Textures changing in Matterport 3D models

### User

Homeowners, investors, construction teams and subcontractors, insurance companies, banks

AEC professionals: architects, interior designers, engineers, construction managers, facility managers

### Components

Matterport 360 showcase

- Matterport 360 showcase
- Blueprint (.JPG, .PDF)
- 3D geometry (.OBJ, .IFC, .FBX, .XYZ)

### Data storage

Cloud

Cloud



# FEATURES OVERVIEW 2



## WEB

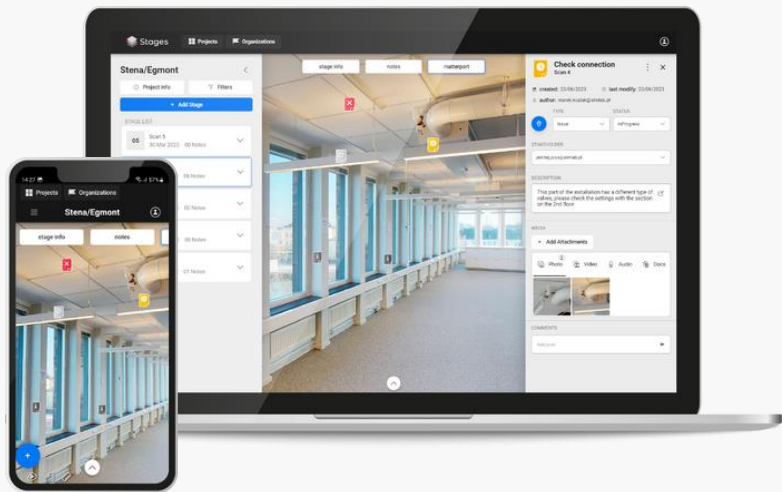

### Communication features

- Voice messages
- Photo
- Video
- Comments
- Documents
- Matteredtag importer
- Screenshot
- Screenshot sketch
- Notes transfer
- E-mail notifications

### Organizations

- User roles
- Teams settings
- Collaboration invitations
- Project location on Google maps

### Timeline synchronization

- Matterport 360 showcases

### Components synchronizations

- Alignment

## DESKTOP

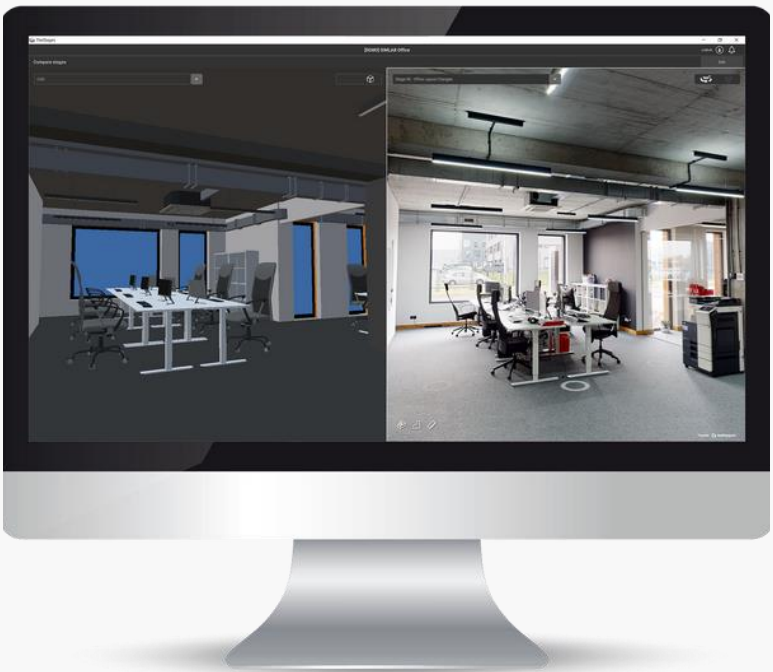

- Voice messages
- Photo
- Video
- 3D brush
- Comments
- Documents
- Matteredtag importer
- Measurement
- Screenshot
- Screenshot sketch
- Notes transfer
- E-mail notifications

- User roles
- Teams settings
- Collaboration invitations
- Project location on Google maps





- Matterport 360 showcases
- 3D objects

- Alignment
- Transformation tools



# SUBSCRIPTION PLANS



<div><div>Stages</div><div>Price List &amp; Subscription Plans*</div></div>	TEST PLAN	PRIVATE PLAN	COMMERCIAL PLAN	
	<div>FREE</div> <div></div> <div>0,00 USD</div>	<div>SINGLE</div> <div></div> <div>10,00 USD monthly</div>	<div>TEAM</div> <div></div> <div>45,00 USD monthly (per seat)</div>	<div>ENTERPRISE**</div> <div></div> <div>CUSTOM PRICES (min. 3k USD for property/year)</div>
Maximum number of active projects	1	5	10	Agreed individually
Maximum number of stages	2	Unlimited	Unlimited	Unlimited
Maximum number of notes	5	Unlimited	Unlimited	Unlimited
Maximum number of seats	1	1***	20***	Agreed individually
Possibility to invite co-operators	No	Yes	Yes	Yes
Access to advanced features in the Desktop version and BIM integration	No	Yes	Yes	Yes
Supported area (square meters)	Up to 500 m2	Up to 1500 m2	Up to 1500 m2	Up to 5000m2
Advertisement display	Yes	No	No	No
<div>* The price does not include additional taxes, fees, and surcharges</div> <div>**Possibility to archive the project upon completion and transition to a "Private use" plan for preservation of complete project documentation.</div> <div>***As view only do not deduct seat license from the total count</div>				



# VIEW THROUGH STAGES



STAGES facilitates effortless viewing and comparison of sequential property scans, regardless of the frequency or interval. It enables remote progress monitoring from any location. Stored views remain perpetually accessible for reference, whether it's a new construction or a renovation project.

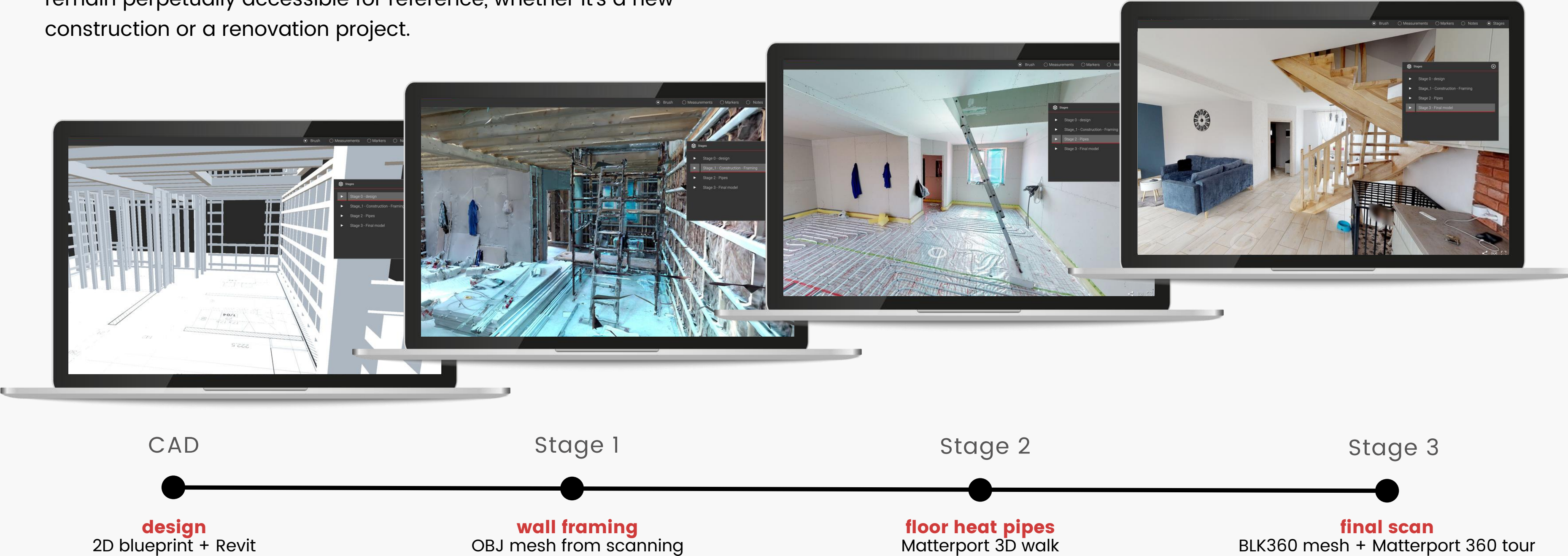



# COMBINES SCANS & MODELS



STAGES desktop version enables simultaneous viewing of 2D PDF plans, 2D CAD plans, and/or 3D BIM models alongside the scan stage. This feature empowers the control, tracking, and resolution of discrepancies between plans and actual field conditions.

Supported formats:

- .IFC BIM models
- .PDF blueprints
- .OBJ Matterport scans
- .FBX 3D models
- .XYZ point cloud
- Matterport 360

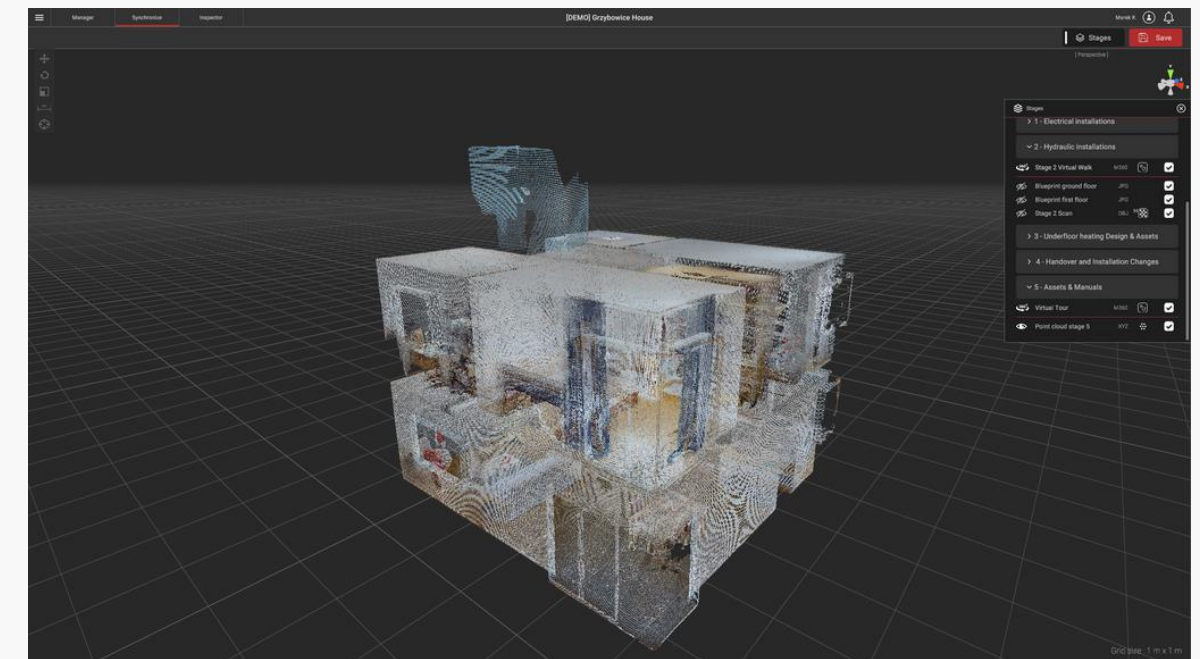
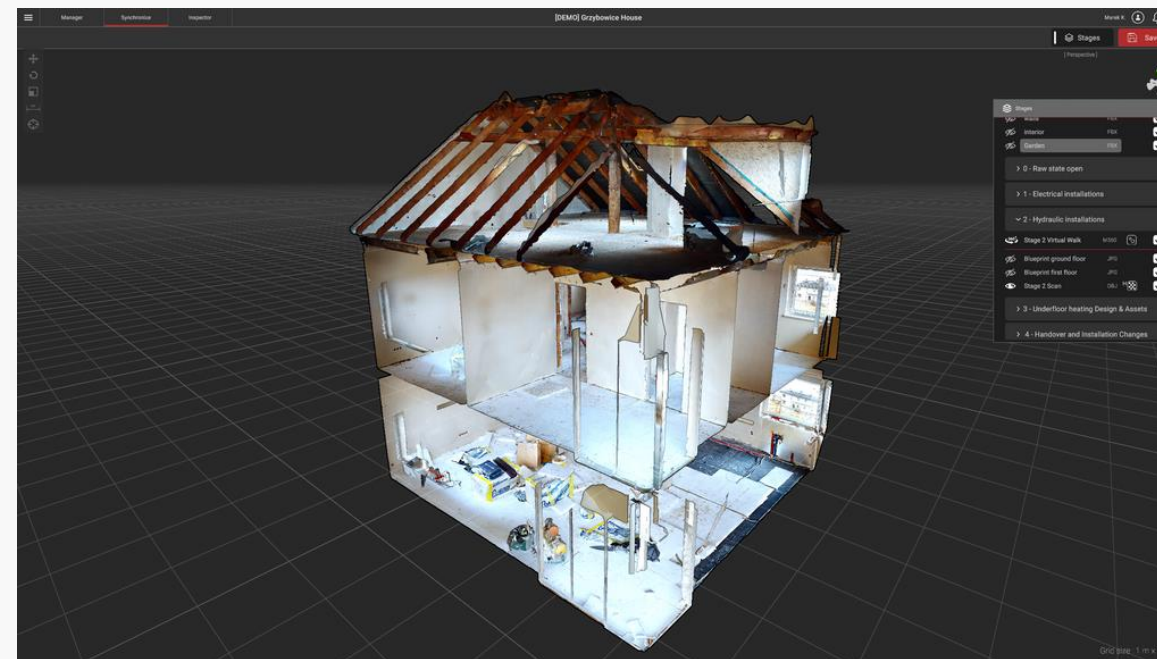







# POWERFUL TOOLKIT



## Audio Notes

Record your voice comments for contractors, or building inspector



## Brush Notes

Apply your comments on the walls or within spaces to provide clear directions.

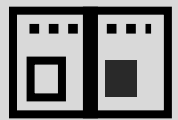

## Split Screen

Side-by-side direct compare of Matterport and BIM 3D models



## Report Toolkit

Compile your notes into an externally generated PDF or share them online



POWERED BY  Matterport™



# COMPARE VIEW

---

Introducing an innovative side-by-side split view that revolutionizes comparisons:

- seamlessly align as-built Matterport scans with as-designed BIM data using groundbreaking spatial navigation
- align 2D plans, 3D files, and Matterport models with the project timeline for comprehensive analysis



Compare View





# SINGLE SOURCE OF DATA COMMON USE INTERFACE

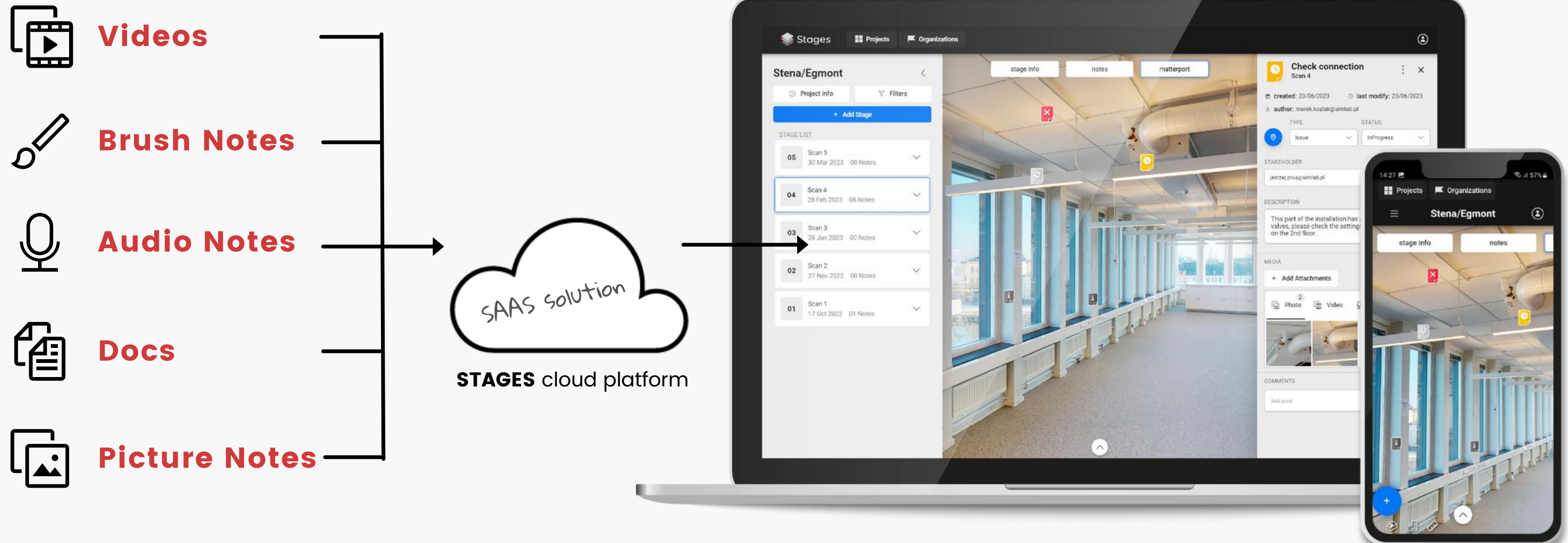



# REAL ESTATE & CONSTRUCTION TECH MARKET MAP

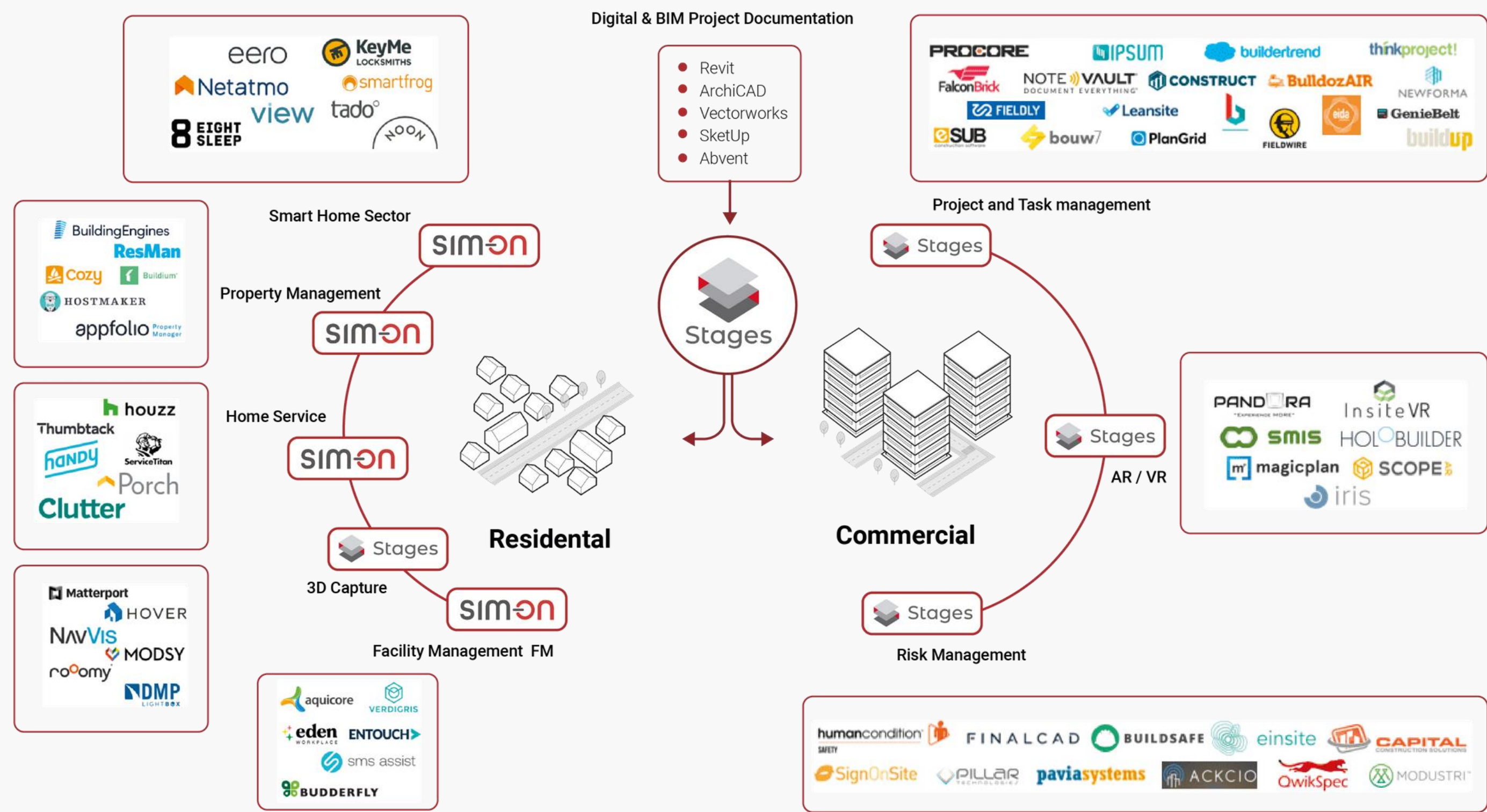



# BUILDING LIFE-CYCLE SUPPORT



Tracking changes via Matterport 3D scans. Intuitive issue management & collaboration system.

Issue markers:

-  Information
-  Pending issue
-  In progress
-  Unresolved issue
-  Resolved issue

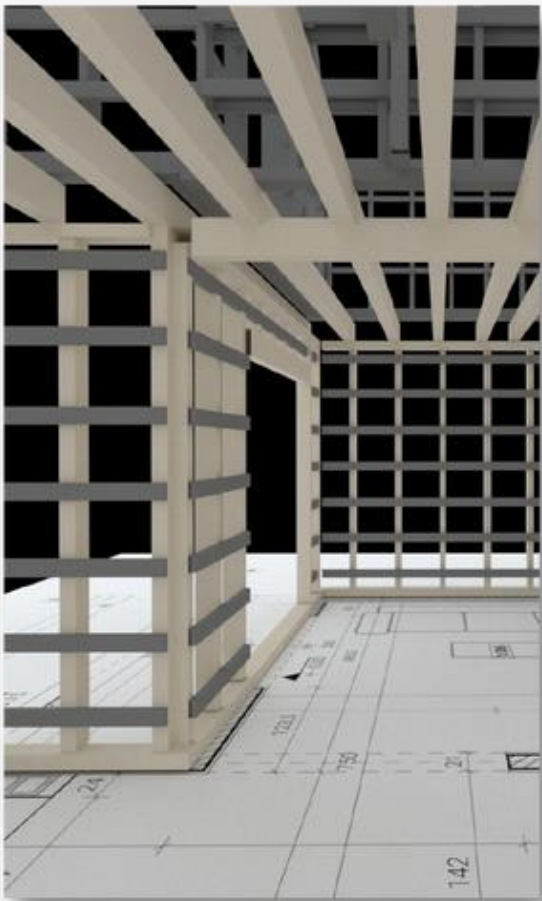

CAD



Stage 1

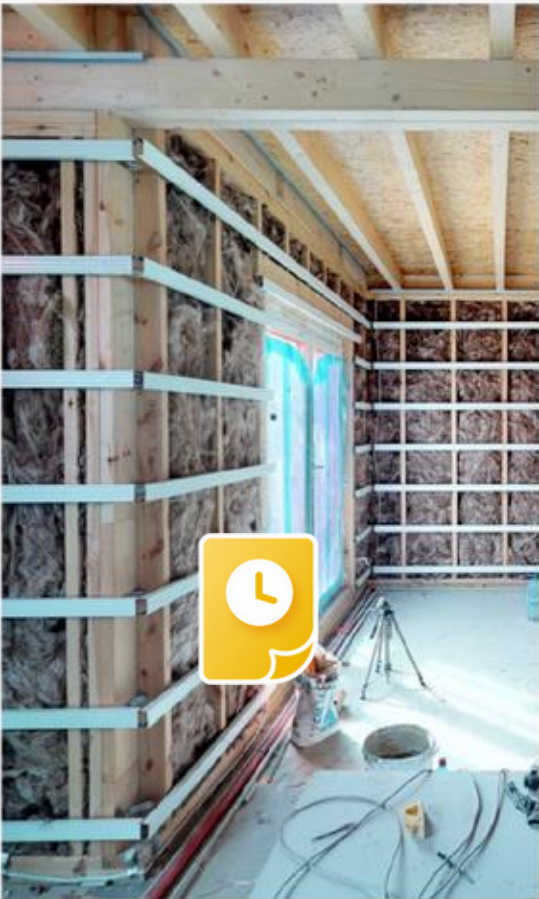

Stage 2

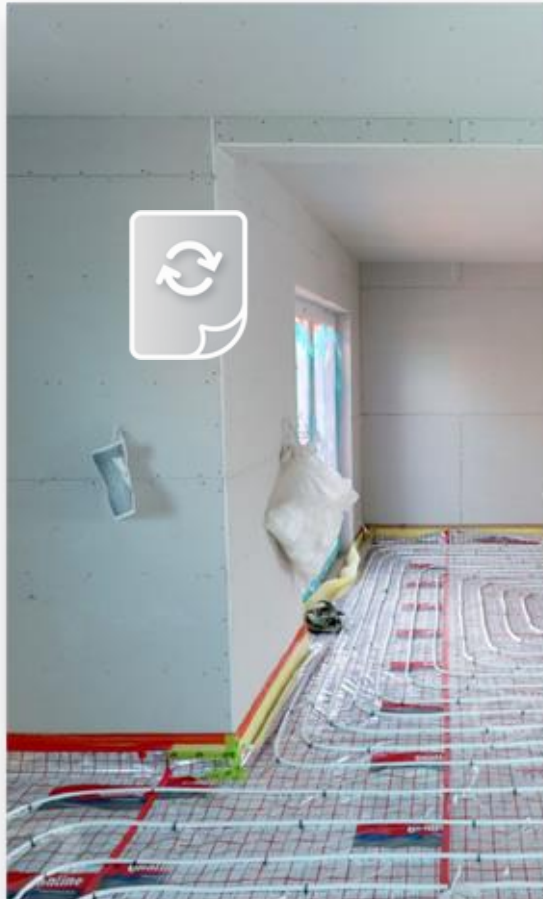

Stage 3



Stage 4

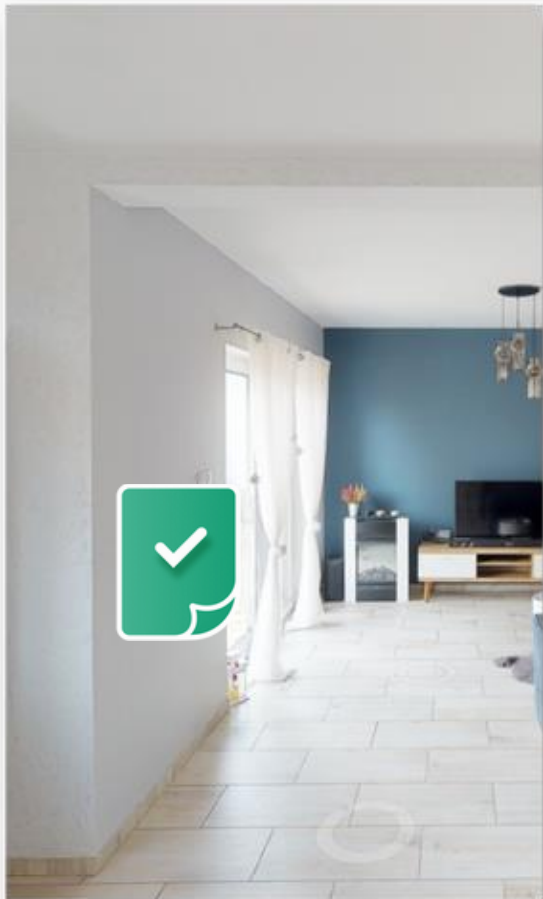

Stage 5

Architect design

week\_4  
construction walls

week\_9  
electric installation

week\_12  
floor heating

week\_14  
floor tiles,  
ready for paint

week\_17  
ready for moving in





Outsource  
tasks

Manage  
remotely

Save  
modifications

Collect  
documents

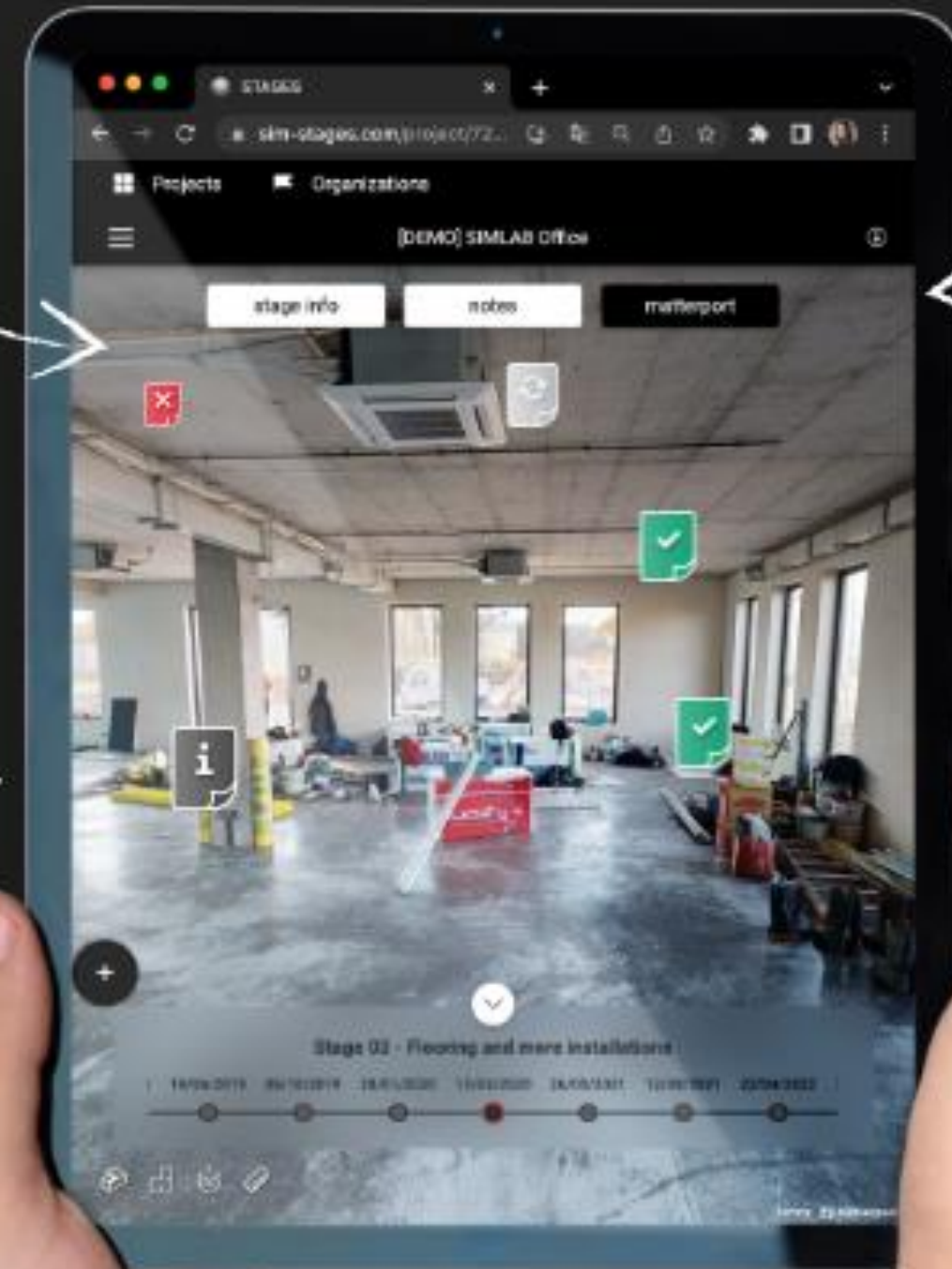



# DIGITAL TWIN TECHNOLOGY



POWERED BY



Matterport is the world leader in immersive 3D technology, offering a platform for prosumers and professionals to easily capture, edit and share 3D models of physical spaces. These navigable virtual tours are presented in Matterport's proprietary photo-realistic digital media format.

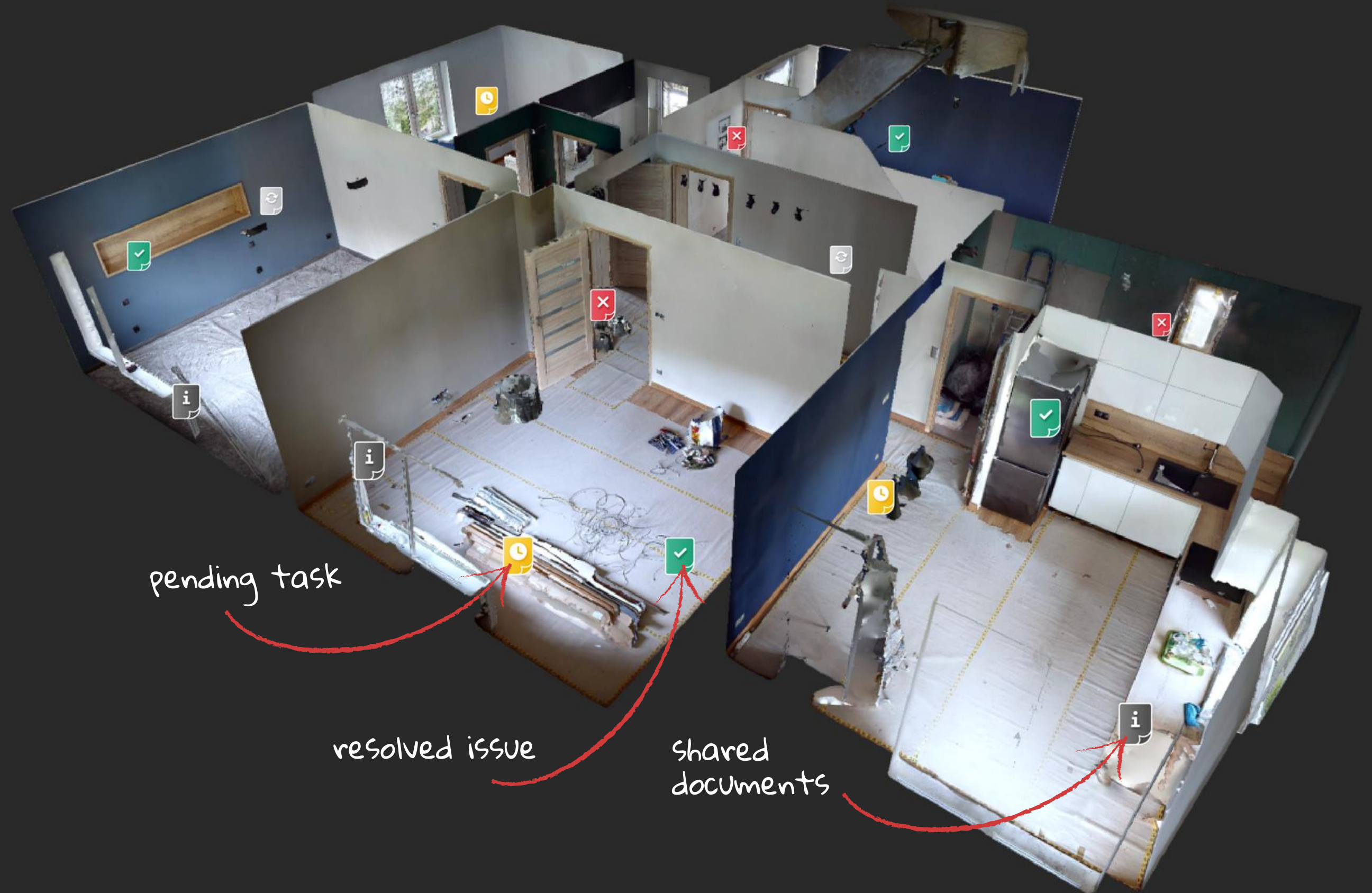



# SPATIAL INNOVATION



Using the highest quality digital twin technology lifts our product to a whole new level. Implementation of Matterport 3D scans is the key to an innovative concept that integrates timeline and communication features with spatial visualization.

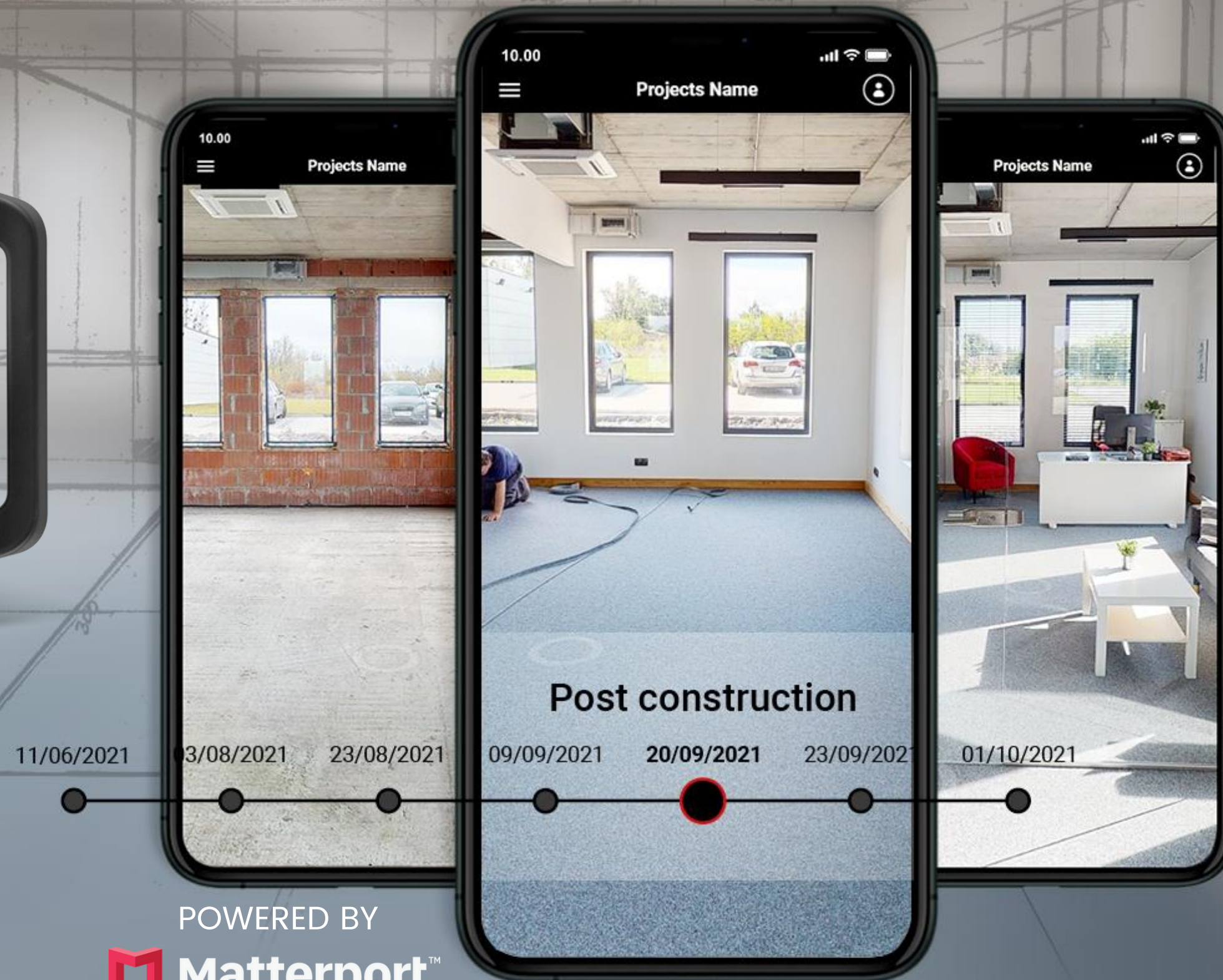

POWERED BY  
 **Matterport™**



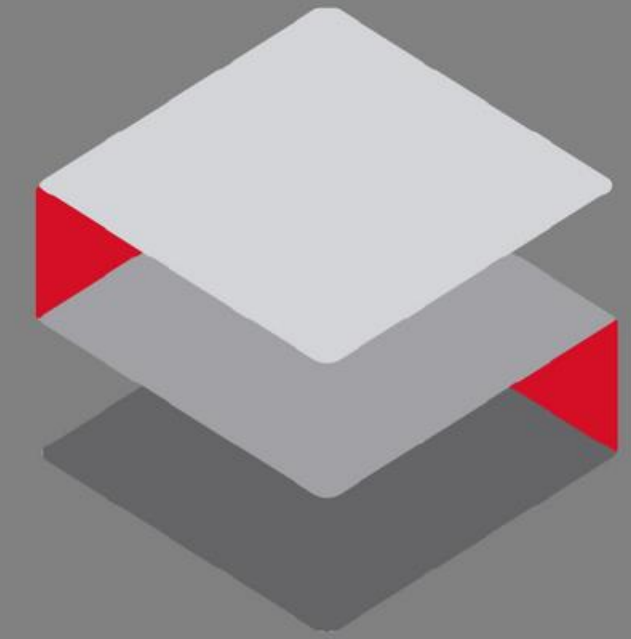

# Stages

**IMLAE**

**Matterport™**

## Learn all about your property

[SIM-STAGES.COM](https://sim-stages.com)



# PEOPLE BEHIND STAGES



**Marek Kozlak**

CEO & FOUNDER  
SIMLAB

---

"Our aim is for STAGES to become the premier toolkit of choice for homeowners and builders alike, offering seamless daily construction progress inspection and comprehensive property condition monitoring throughout the entire building lifecycle."



**Robert Czarlewski**

PRODUCT OWNER  
STAGES

---

"I am truly delighted by the remarkable capabilities of this product. It holds the promise of a revolutionary impact on the AEC sector, opening the doors of digitization to a wider audience beyond just engineers."







The SIMLAB logo is located in the bottom right corner. It features the word "SIMLAB" in a bold, black, sans-serif font, with a red square above the letter "I". Below the word "SIMLAB" is the website address "simlabinc.com" in a smaller, black, sans-serif font.

# Helping you feel more comfortable with your property

# Digital Twin, Construction Management, IoT, FM, Assets, Maintenance