

# Chei cu ghiara

255/2







## Profile



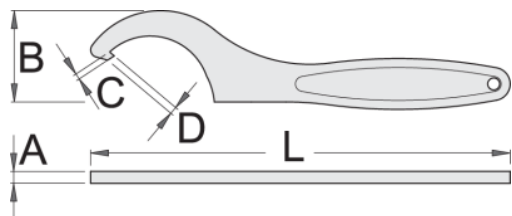

## Caracteristicile produsului

- material:crome vanadium
- capul cheii este tratat in intregime
- acoperire cromare conform ISO 1456:2009
- conform cu standardul DIN 1810



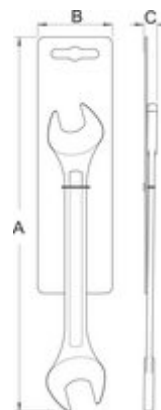

		L	C	D	A	B	
613050	12 - 14	109	1.2	1.5	3	12	27
613051	16 - 20	109	1.5	2	3	12	28
613052	25 - 28	136	2	2.5	4	21	56
613053	30 - 32	136	2	2.5	4	21	55
613054	34 - 36	171	2.5	3	5	28.5	114
613055	40 - 42	171	2.5	3	5	28.5	111
613056	45 - 50	207	3	3.5	6	37	206
613057	52 - 55	207	3	3.5	6	37	209
613058	58 - 62	242	3.5	4	7	46	320

		L	C	D	A	B	
613059	68 - 75	242	3.5	4	7	46	303
613060	80 - 90	281	4	5	8	61	472
613061	95 - 100	281	4	5	8	61	436
613062	110 - 115	334	4	5	10	81	805
613063	120 - 130	334	4	5	10	81	829



## Ambalaj pentru retail

	MA	MB	MC	
613050	155	44	4,5	34
613051	155	44	4,5	35
613052	180	44	5,5	63
613053	180	44	5,5	62
613054	220	44	6,6	121
613055	220	58	6,5	124
613056	260	58	7,8	219
613057	260	58	7,9	222
613058	290	58	8,8	333
613059	290	58	8,8	316
613060	330	66	9,5	485
613061	330	66	9,5	449
613062	435	80	10	805
613063	435	80	10	829



## Ambalaj pentru transport

Barcode	Hand icon	TA	TB	TC	Weight icon
613050	4	55	177	27	211
613051	4	55	177	27	215
613052	4	62	192	33	327
613053	4	62	192	33	323
613054	4	65	211	38	559
613055	4	71	243	42	571
613056	4	75	278	54	951
613057	4	75	278	54	963
613058	4	75	308	60	1407
613059	4	75	308	60	1339
613060	4	85	337	68	2015
613061	4	85	337	68	1871
613062	1				
613063	1				