

Capete chei tubulare cu profil hexagonal exterior de 3/8", izolate la 1000 V, dublu strat

236/2HXVDEDP



Profile



Caracteristicile produsului

- material: capete chei tubulare: crom-vanadiu, acoperire cromare
- bit: otel special de scule
- capul cheii este tratat in intregime
- in concordanta cu standardul EN 60900:2004

Avantaje:

- dublu strat-dubla protectie, doua straturi de culori diferite
- 100% control - fiecare piesa este testata

Important

- daca al doilea strat devine vizibil inlocuiti scula VDE cu una noua

Standarde

EN60900:2005

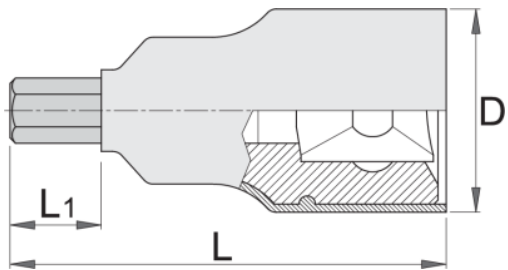

Barcode	Hexagon	L	L1	D	Weight
619171	4	67	8	23.6	46
619172	5	67	8	24.4	49
619173	6	67	8	23.4	48
619174	8	67	8	24	54
619175	10	67	8	23.4	70

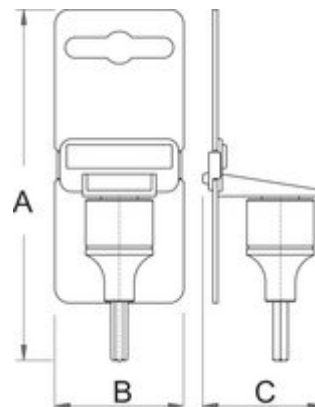

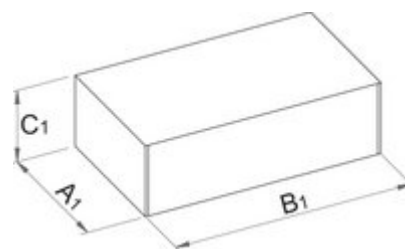

Ambalaj pentru retail

Barcode	MA	MB	MC	Weight
619171	140	44	33	51
619172	140	44	33	55
619173	140	44	33	55
619174	140	44	33	60
619175	140	44	33	71



Ambalaj pentru transport

Barcode	Hand	TA	TB	TC	Weight
619171	4	104	168	61	260
619172	4	104	168	61	275
619173	4	104	168	61	275

		TA	TB	TC	
619174	4	104	168	61	295
619175	4	104	168	61	340