

Cap cheie tubulara cu cap hexagonal 1/2" izolata la 1000 V

192/2HXVDEDP



Profile



Caracteristicile produsului

- material: capete chei tubulare: crom-vanadiu, acoperire cromare
- bit: otel special de scule
- capul cheii este tratat in intregime

Avantaje:

- dublu strat-dubla protectie, doua straturi de culori diferite
- 100% control - fiecare piesa este testata

Important

- daca al doilea strat devine vizibil inlocuiti scula VDE cu una noua

Standarde

EN60900:2005

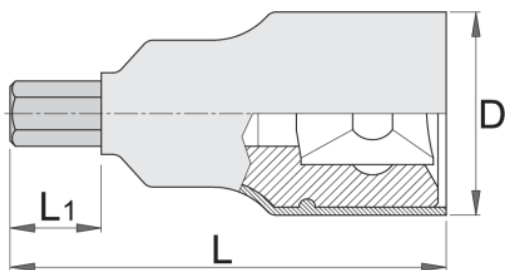

Barcode	Hex	L	L1	D	Weight
615173	4	76	8	27	76
615174	5	76	8	27	73
615175	6	76	8	27	80
615176	8	76	8	27	96
615177	10	76	8	27	110

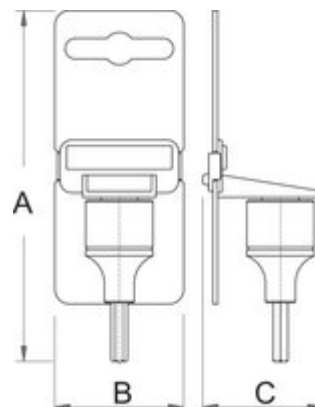

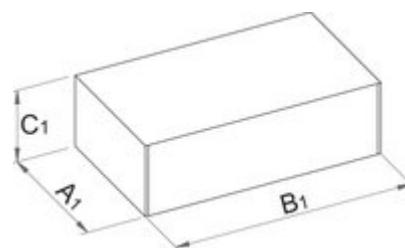

Ambalaj pentru retail

Barcode	MA	MB	MC	Weight
615173	150	44	42	85
615174	150	44	42	85
615175	150	44	42	95
615176	150	44	42	105
615177	150	44	42	117



Ambalaj pentru transport

Barcode	Hand	TA	TB	TC	Weight
615173	4	65	288	55	395
615174	4	65	288	55	395
615175	4	65	288	55	435

		TA	TB	TC	
615176	4	65	288	55	475
615177	4	65	288	55	521