

## Adaptor 3/4"

197.7/1



### Profile



### Caracteristicile produsului

- material:crome vanadium
- forjata, calire si revenire totala
- acoperire cromare conform ISO 1456:2009
- capete polizate
- conform cu standardul ISO 3316

### Standarde

ISO 3316

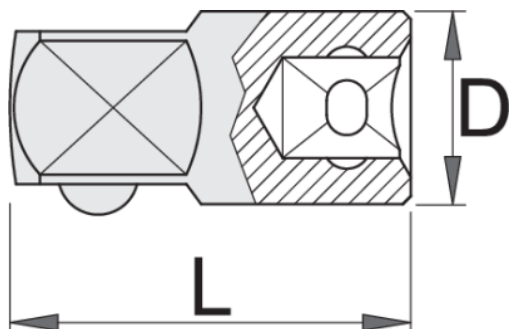

L

D



Barcode	Size	L	D	Icon
602741	3/4" - 1/2"	54	34	181
610695	3/4" - 1"	62	38	364

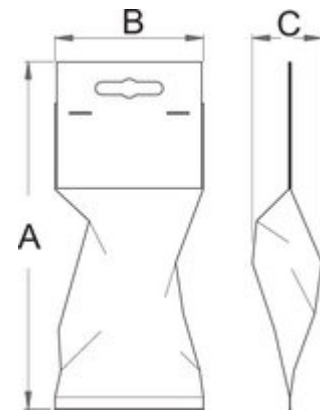

### Ambalaj pentru retail

Barcode	MA	MB	MC	Icon
602741	167	58	34	195
610695	173	58	38	375

### Ambalaj pentru transport

Barcode	Hand	TA	TB	TC	Icon
602741	1	65	185	46	245
610695	1	70	240	48	445