

# Capete chei tubulare de IMPACT 3/8"

230/4 6p



## Profile



## Caracteristicile produsului

- material:crom molibden
- forjata, calire si revenire totala
- acoperire prin brunare dupa standardul ISO 9717
- in conformitate cu standardul ISO 2725-2(numai dimensiunile in mm)

## Standarde

DIN 3129, ISO 2725 - 2

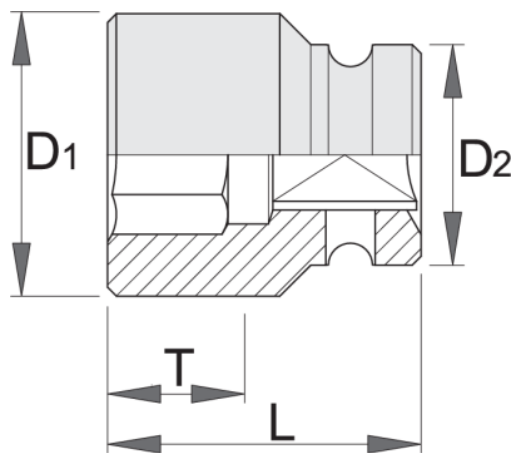

Barcode	mm	D2	D1	L	T	Icon
612060	8	19	13.8	30	8	45
612061	9	19	15	30	8	45
612062	10	19	16	30	8	45
612063	11	19	17.5	30	9	45
612064	12	19	19	30	9	45
612065	13	22	20	30	9	61
612066	14	22	21	30	9	55
612067	15	22	22	30	11	58
612068	16	22	24	30	11	65
612069	17	22	25	30	11	65
612070	18	22	26	30	11	69
612071	19	22	27.5	30	11	66
612072	20	22	28	30	13	66
612073	21	22	30	30	13	73
612074	22	23	32	30	13	86

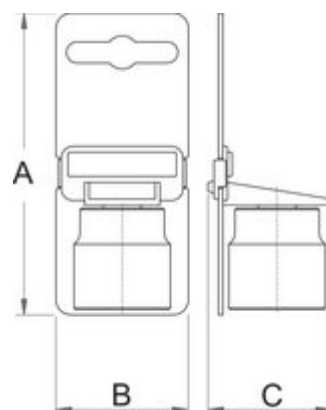

Ambalaj pentru retail

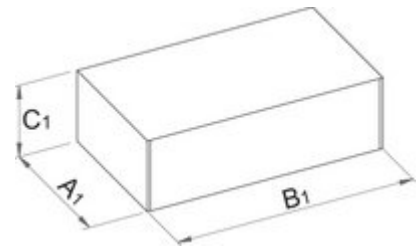

Barcode	MA	MB	MC	Icon
---------	----	----	----	------

Barcode	MA	MB	MC	Height
612060	100	44	34	50
612061	100	44	34	50
612062	100	44	34	50
612063	100	44	34	50
612064	100	44	34	50
612065	100	44	34	66
612066	100	44	34	60
612067	100	44	34	63
612068	100	44	34	70
612069	100	44	34	70
612070	100	44	34	74
612071	100	44	34	71
612072	100	44	35	71
612073	100	44	36	78
612074	100	44	37	91



### Ambalaj pentru transport

Barcode	Quantity	TA	TB	TC	Height
612060	4	83	131	55	325
612061	4	83	131	55	325
612062	4	83	131	55	325
612063	4	83	131	55	325
612064	4	83	131	55	325
612065	4	83	131	55	389
612066	4	83	131	55	365
612067	4	83	131	55	377
612068	4	83	131	55	405
612069	4	83	131	55	405

		TA	TB	TC	
612070	4	83	131	55	421
612071	4	83	131	55	409
612072	4	83	131	55	409
612073	4	83	131	55	437
612074	4	83	131	55	489