

Capete chei tubulare de impact 1" cu 4 laturi

233/4SQ







Profile

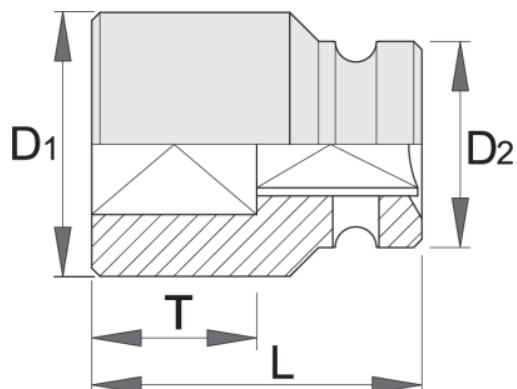

Caracteristicile produsului

- material:crom molibden
- forjata, calire si revenire totala
- acoperire prin brunare dupa standardul ISO 9717



		D1	D2	L	T		
618763	18	42	52	57	24	572	1
618764	23	48	54	60	27	672	1



Ambalaj pentru retail

Barcode	MA	MB	MC	Weight
618763	52	52	57	577
618764	54	54	60	677

Ambalaj pentru transport

Barcode	Hand icon	TA	TB	TC	Weight
618763	1				
618764	1				