

Clesti combinati izolati la 1000 V

406/1VDEDP

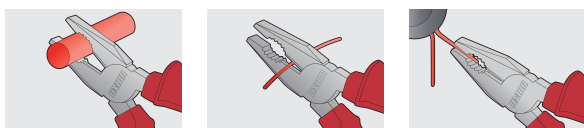

0



Profile



Caracteristicile produsului

- material:compozitie speciala pentru calire revenire
- tratat complet
- partile taietoare tratate prin inductie
- cap polizat
- finisare:cromat in conformitate cu standardul EN12540
- in conformitate cu standardul ISO 5746 si EN 60900:2004

Avantaje:

- manerele izolate cu doua straturi de culori diferite care permit o protectie suplimentara

Important

- daca al doilea strat devine vizibil inlocuiti scula VDE cu una noua

Standarde

EN60900:2005

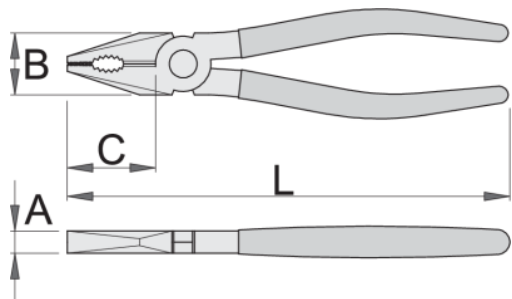

| Barcode | L | B | C | A | Icon |
|---------|-----|----|----|------|------|
| 619177 | 140 | 23 | 32 | 8 | 157 |
| 619178 | 160 | 24 | 35 | 9.5 | 219 |
| 619179 | 180 | 27 | 38 | 10 | 269 |
| 619180 | 200 | 29 | 41 | 10.5 | 321 |
| 619181 | 220 | 32 | 47 | 11 | 376 |

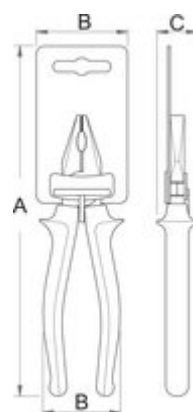

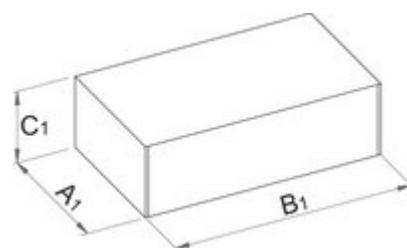

Ambalaj pentru retail

| Barcode | MA | MB | MC | Icon |
|---------|-----|----|----|------|
| 619177 | 210 | 67 | 30 | 156 |
| 619178 | 220 | 68 | 31 | 225 |
| 619179 | 240 | 65 | 30 | 266 |
| 619180 | 250 | 64 | 30 | 332 |
| 619181 | 300 | 67 | 30 | 385 |



Ambalaj pentru transport

| Barcode | Hand Icon | TA | TB | TC | Icon |
|---------|-----------|-----|-----|----|------|
| 619177 | 4 | 75 | 308 | 60 | 706 |
| 619178 | 4 | 104 | 277 | 68 | 1081 |

|  |  | TA | TB | TC |  |
|--|---|-----|-----|----|---|
| 619179 | 4 | 104 | 277 | 68 | 1145 |
| 619180 | 4 | 104 | 277 | 68 | 1409 |
| 619181 | 4 | 145 | 358 | 48 | 1665 |