

Foarfece de tabla

571L/3G

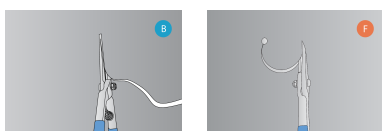

0



Profile



Caracteristicile produsului

- material: falci forjate din otel cabon
- manere din tabla
- lamele tratate prin inductie la max 57 HRC, pentru art.562 duritatea 52 HRC
- manere nichelate, manere din plastic rezistent la conditii grele

Avantaje:

- arc de redeschidere

Utilizare:

- pentru taierea de tabla de 400N/mm² grosime pana la 1,25mm

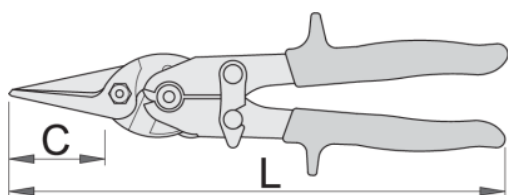

L

C





L

C



608774

260

40

497

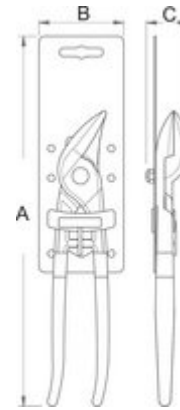

Ambalaj pentru retail



MA

MB

MC



608774

320

78

27

518

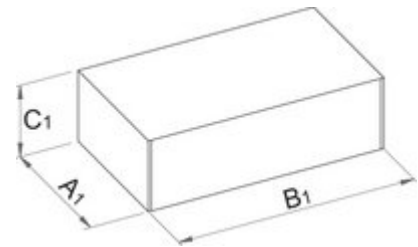

Ambalaj pentru transport



TA

TB

TC



608774

4

135

385

81

2165