

Cheie dinamometrica cu declansator

264

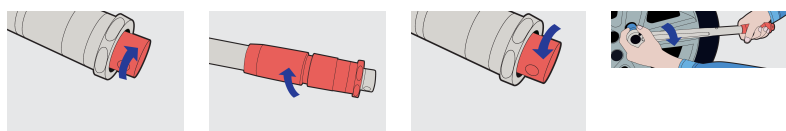

0



Profile



Caracteristicile produsului

- capul cu clichet reversibil
- Aplicarea momentului intr-un singur sens si intotdeauna in directia indicata pe manerul cheii
- cheia lucreaza in sensul acelor de ceasornic si in sens invers acestora
- pentru actionare la stanga sau la dreapta
- nu lipseste semnalul la momentul prestabilit
- Recalibrarea cheii se efectueaza la un interval de 12 luni de utilizare sau aproximativ 5000 de cicluri!
- in conformitate cu standardul ISO 6789
- scala dubla, Nm si Kg

Important

- Nu folosiți cheia dinamometrica pentru deșurubare!
- Aplicati momentul de torsiune numai in directia indicata pe stiker. Stikerul va indica sensul corect de strangere.
- Intervalul dintre doua calibrari ale cheii este de 12 luni sau 5000 de strangeri de la data cumpararii.

- INTOTDEAUNA aduceti mecanismul de reglare la punctul de start cand terminati lucrul.
- Cand momentul reglat este atins va rugam sa opriti actionarea cheii.
- Cheia dinamometrica poate fi deteriorata daca instructiunile din manualul de utilizare nu sunt respectate.

Standarde

ISO 6790

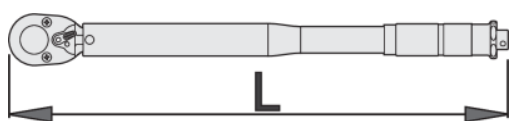

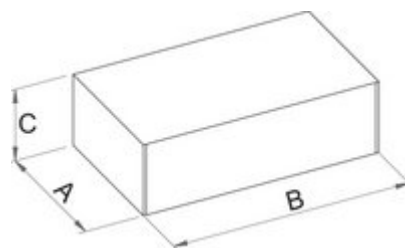

Barcode	Size	Range (Nm)	L	Weight
615485	1/4"	2 - 24	270	686
615486	3/8"	5 - 110	360	1100
615487	1/2"	28 - 210	465	1680
615488	1/2"	35 - 350	640	2930
615489	3/4"	70 - 560	840	5600
615490	3/4"	140 - 700	1070	8200
615491	1"	140 - 980	1220	8800





Ambalaj pentru retail

Barcode	MA	MB	MC	Weight
615485	315	72	72	686
615486	400	73	60	1100
615487	485	78	63	1680
615488	670	79	63	2930
615489	115	1250	115	5600
615490	115	1250	115	8200

	MA	MB	MC	
615491	115	1250	115	8800

Ambalaj pentru transport

		TA	TB	TC	
615485	1				
615486	1				
615487	1				
615488	1				
615489	1	115	1250	115	5600
615490	1	115	1250	115	8200
615491	1	115	1250	115	8800