

ASTI

Înterupătoare de curent rezidual cu protecție la supracurent LIMAT2-SD și LIMAT4-SD

Date Tehnice	
Tensiune nominală U_n	230/400 V a.c.
Curent nominal I_n	6 – 50 A
Frecvență f_n	50 / 60 Hz
Capacitate nominală de scurt-circuit I_{cn}	100 A gG
Caracteristici de declanșare	B, C
Curent nominal rezidual	100, 300 mA
Tip curent rezidual	AC, A
Rated short-circuit capacity I_{cn}	10 kA; $I_n \leq 40$ A 6 kA; $I_n \geq 50$ A
Clasa energetica	3
Sectiune conductor de conectare	1 – 25 mm ² , max. 3 Nm
Standarde	IEC 61009, EN 61009

LIMAT2-SD

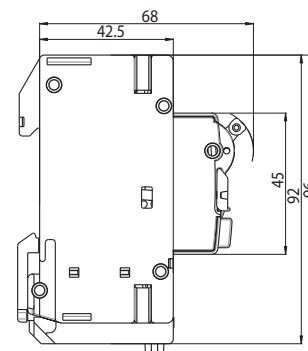
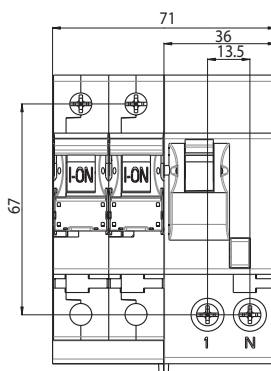
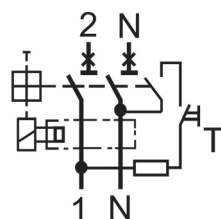

LIMAT4-SD

