

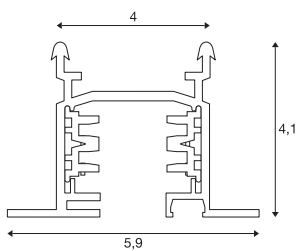

## EUTRAC 3-PHASE RECESSED TRACK

high-voltage track, white, 3 m

Aluminium carrier track of the EUTRAC 240V 3-circuit recessed track system. The surface-mounted version of this system is available in several lengths. The special design makes it possible for ceiling panels to be put onto the rail itself. For more detailed information about the maximum load, please refer to the instructions in the manual. Alternatively, there is a surface-mounted version available too. Please note that the white tone will be changing from RAL 9010 to RAL 9016 (traffic white) on 1st April 2018. More information can be found under Product Information in the Service" / Downloads area.



### TECHNICAL DATA

|                  |              |
|------------------|--------------|
| Item no.:        | 1001532      |
| Nominal voltage  | 230V ~50Hz V |
| Length           | 300.0 cm     |
| Width            | 5.9 cm       |
| Height           | 4.1 cm       |
| Net weight       | 3.52 kg      |
| Gross weight     | 5.15 kg      |
| IP Code          | IP 20        |
| Safety class     | I            |
| Assembly         | Recessed     |
| Assembly details | Ceiling      |
| Color            | white        |
| BIG WHITE Page   | 505          |



**Notes**

---

---

---

---

---