

D0

Siguranțe D0

Date Tehnice

Tensiune nominală $U_n$	400 Va.c., 250 Vd.c.
Curent nominal $I_n$	D01 2 - 16 A, D02 20 - 63 A, D03 80 - 100 A
Capacitate de rupere la $1,1U_n$	50 kA a.c. $\cos \phi = 0,1$ 8 kA d.c. $T = 15 \text{ ms}$
Caracteristicile de lucru	gG
Standarde	DIN EN 60269-1, IEC 60269-1:2005-04 (VDE 0636 Teil 10): 1999-11
	DIN EN 60269-3, IEC 60269-3:2003 (VDE 0636 Teil 30): 1995-12
	DIN EN 60269-3-1, IEC 60269-3-1: 2004-07 (VDE 0636 Teil 301): 1998-01
	DIN VDE 0635/02.84

D01 gG pentru socluri E14

$I_n$ [A]	Dimensiuni $\varnothing A$
2	7,3
4	7,3
6	7,3
10	8,5
13	8,5
16	9,7

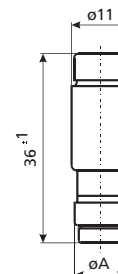

D02gG pentru socluri E18

$I_n$ [A]	Dimensiuni $\varnothing A$
20	10,9
25	12,1
32	13,3
35	13,3
40	13,3
50	14,5
63	15,9

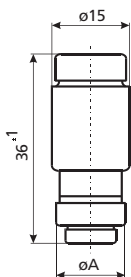

D03 gG pentru socluri M30x2

$I_n$ [A]	Dimensiuni $\varnothing A$
80	21,4
100	21,4

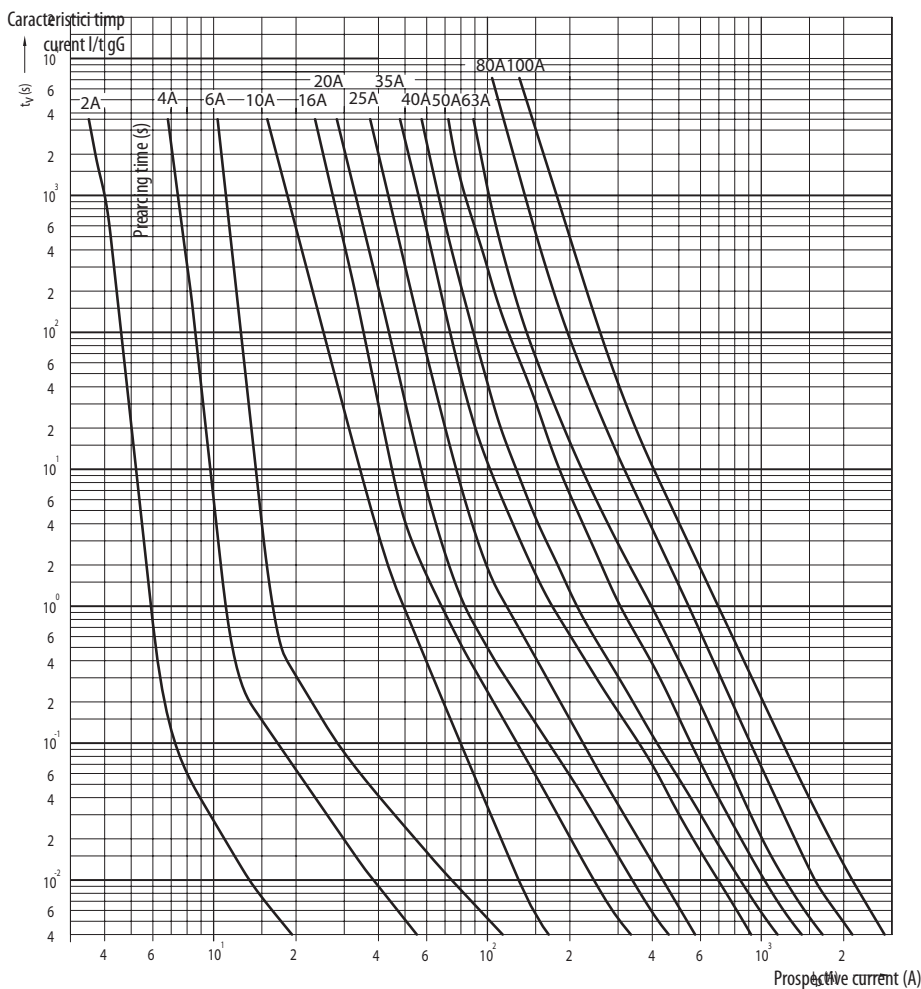
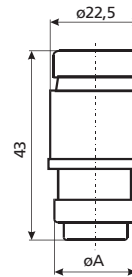

Caracteristica de  
întrerupere a  
curentului

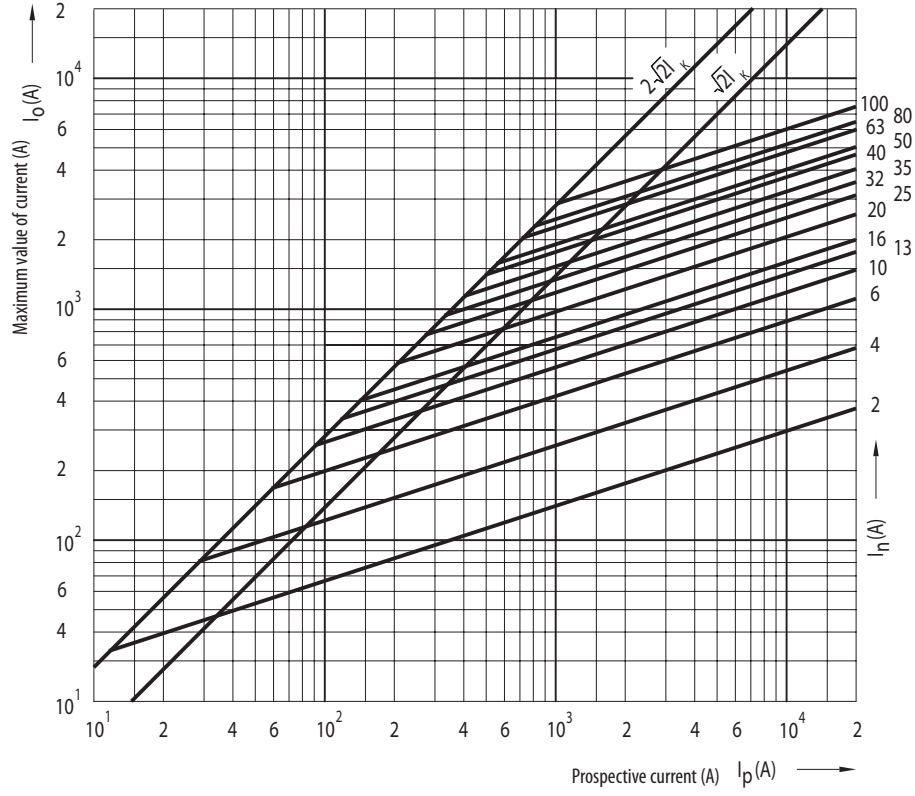

Caracteristici energie de  
topire siguranță I²t

