

Summary Alarm Indicators SSM 11-24V-DC



YY494006



YY494006



YY494006



YMR78700

Schrack-Info

YY494006

The type SSM 11 summary alarm indicator is a safe low-cost solution for many purposes, combining several functionalities in one unit:

- Motor monitoring
- Contact monitoring with change over contact
- High reliability lighting
- Acoustic signalling
- Optical collective signalling
- Compatible with 11 pole plug-in socket YMR78700

Dimensions SSM 11 (mm)



Summary Alarm Indicators SSM11-24V-DC

Dimensions YMR78700 (mm)

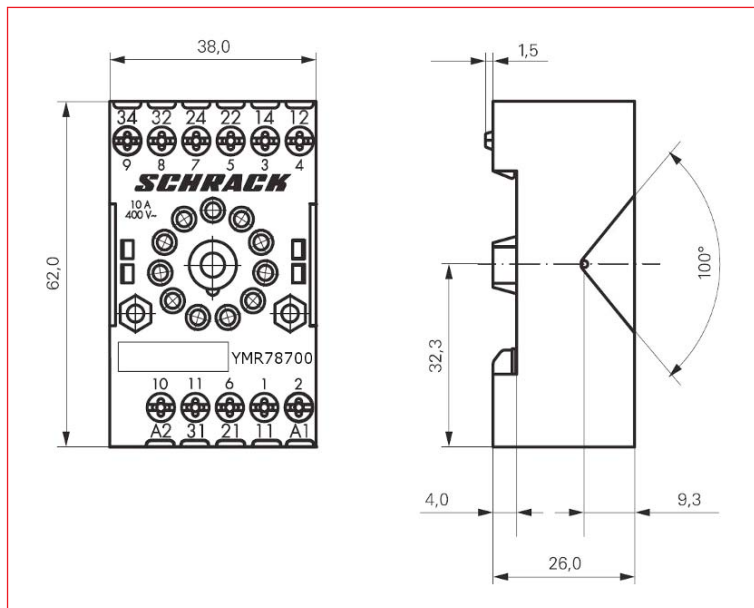

Functionalities SSM 11

Motor Monitoring

If the motor is not running, the light (H1) will be off; if the motor is running, the light will be on. In the event of faulty operation of the motor (F1), the light will flash on-off.

Contact monitoring with Change Over Contact

During regular operation the light will be on (H2); in the event of an interruption, the light will flash on-off (H3).

High Reliability Lighting

To maintain the functionality of acoustic and optical collective signalling, connecting a parallel resistor is recommended (at 24 V, 2K2 Ω / ½ W).

Acoustic Signalling

In the event of an interruption, the horn will signal approx. 15 sec. afterwards (H5). It can be reset by pressing the Acknowledge (B4) key.

Optical Collective Signalling

The Fault light (H4) will be on as long as there is one (or several) interruptions-regardless of whether the Acknowledge key has been pressed or not.

Circuit Diagram SSM 11

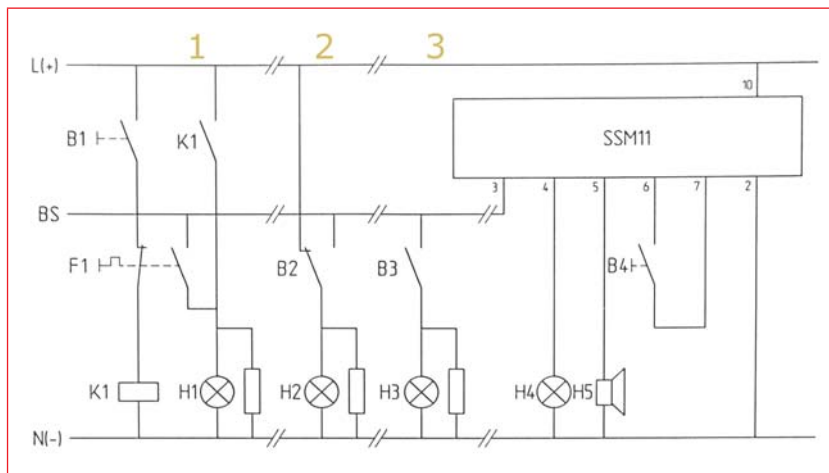

Circuit Diagram SSM 11

1	Option 1
2	Option 2
3	Option 3
B1	On-switch
B2	Operating- and fault signal contact (contactor)
B3	Fault message contact (contactor or control system)
B4	Acknowledge button
BS	Flashing bar
F1	Overcurrent relay
H1	Motor operation lamp
H2	Operation lamp
H3	Failure lamp
H4	Failure lamp
H5	Horn
K1	Motor contactor

Technical Data

Rated voltage		24 V DC +20 %
Contacts	Max.	250 V~ 8A
Power consumption	Idle	ca. 1 VA
	In operation	ca. 4 VA
Assembly		11-pole socket YMR78700

DESCRIPTION	AVAILABLE	ORDER NO.
Indicator for Summary-alarm SSM11-24V		YY494006
DIN rail mounted plug-in socket for MT3 relays and timer relays Series ZR4, 11 pole, 10A (3 CO), with screw terminals, not compatible with function modules		YMR78700