

■ DATASHEET: IG009201 – 05
CABLE DISTRIBUTION ENCLOSURE DIN PLAIN SURFACE, IP 44



■ SCHRACK INFO

MATERIAL

Glass-fibre reinforced polyester: RAL 7032

ELECTRICAL PROPERTIES

Surface resistance	IEC 60093	min. 10^{12} Ohm
Insulation resistance	IEC 60093	min. 10^{14} Ohm cm
Track resistance	IEC 60112	CTI 600
Dielectric strength	IEC 60243-1	min. 130 kV/cm

MECHANICAL PROPERTIES

Bending strength	EN ISO 14125	min. 165 MPa
Impact strength	EN ISO 179-1	min. 60 kJ/m ²
Tensile strenght	EN ISO 527-4	min. 70 Mpa

THERMAL PROPERTIES

Dimensional stability under heat	ISO 75 - 2a	min. 200°C
Glow wire test	EN 60695	960°C / 3mm
Flammability	EN 60695-11-10	V1
Fire resistance	ISO 3795	NBR

GENERAL

Protection class	II	
Protection	IP 44 (optional IP54)	
Ambient temperatures	-50°C upto +125°C	
Halogen free	yes	
Termite resistant	yes	
Weathering resistance	QUVB 1000h	No emissions of glass fibres
	QUVB 1000h	Deviation of colourdelta E<4 acc. CIE-Lab
Resistant against	Oil, gasoline, 10% hydrochlorid, sulphuric-, acetic acid, alcohol, seawater, sodium calcium-chloride, deicing salt, urine, bitumen, acid and alkaline substances in the soil	

DIMENSIONS

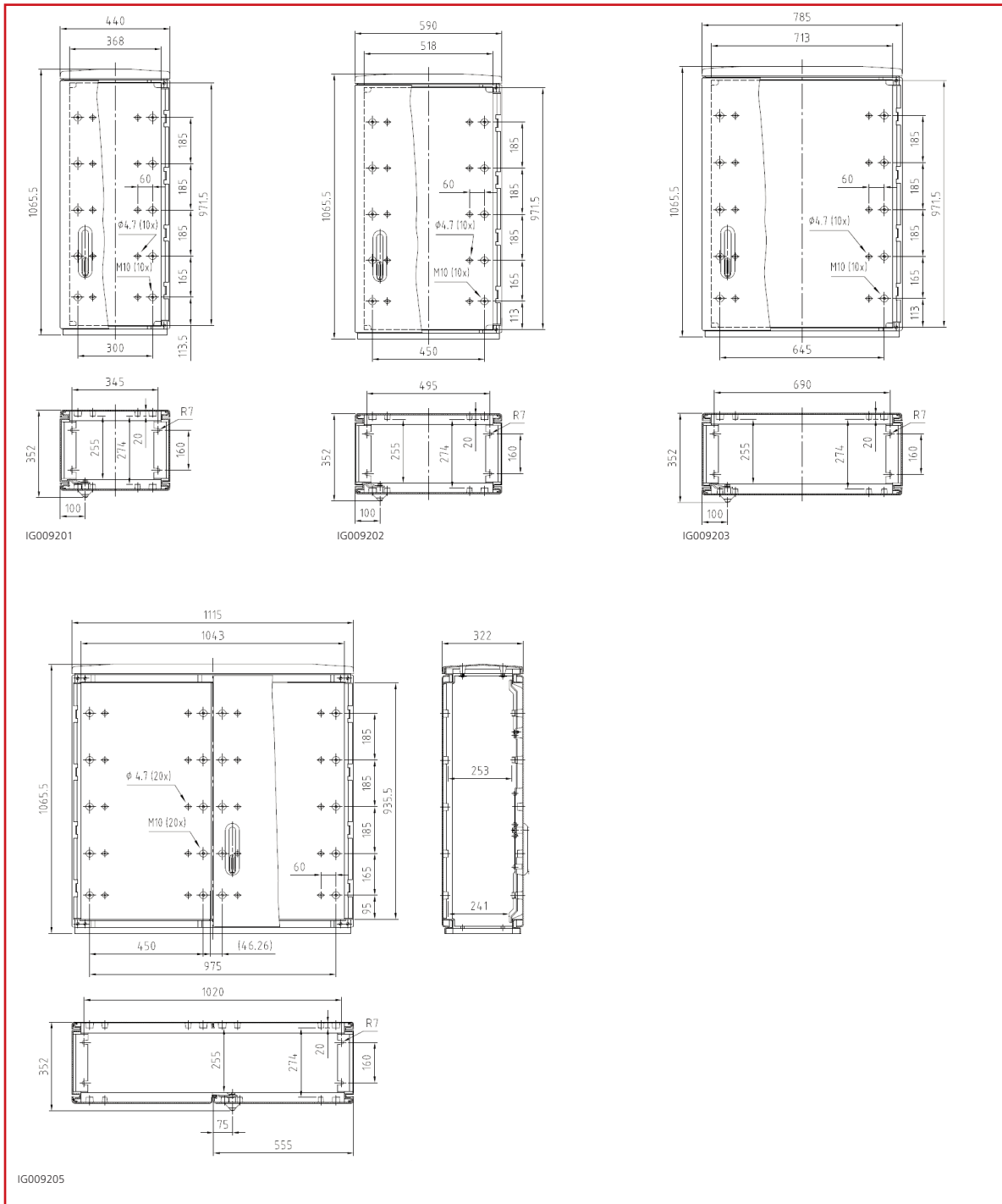

DESCRIPTION	HxWxD (mm)	ORDER NO.
Single door plain, RAL 7032	1065,5x440x322	IG009201
Single door plain, RAL 7032	1065,5x590x322	IG009202
Single door plain, RAL 7032	1065,5x785x322	IG009203
Double door plain, RAL 7032	1065,5x1115x322	IG009205

■ MOUNTING PLATES

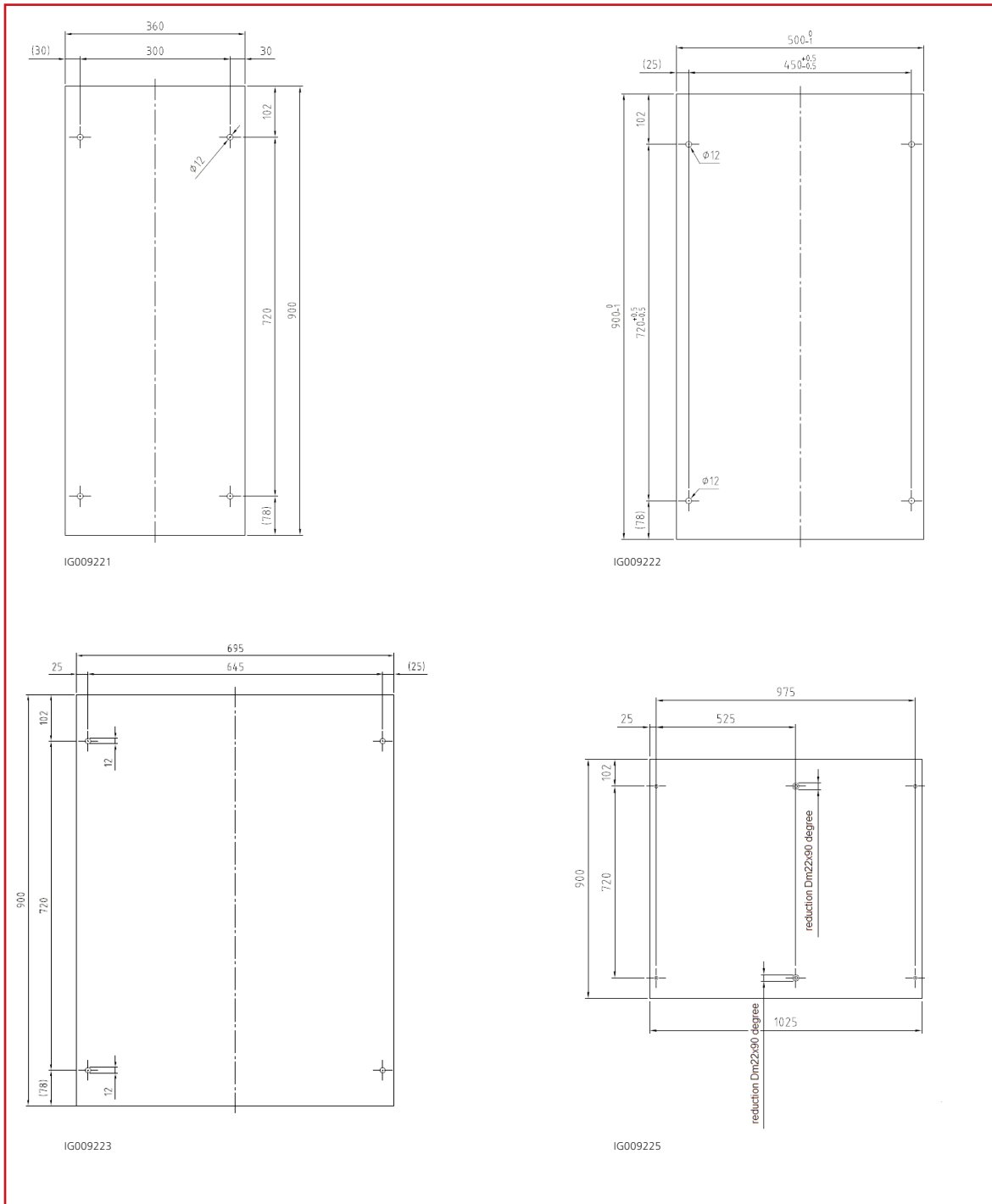

DESCRIPTION	HxWxD (mm)	ORDER NO.
Mounting plate for IG009201	900x360x6	IG009221
Mounting plate for IG009202	900x500x6	IG009222
Mounting plate for IG009203	900x695x6	IG009223
Mounting plate for IG009205	900x975x6	IG009225

BASES

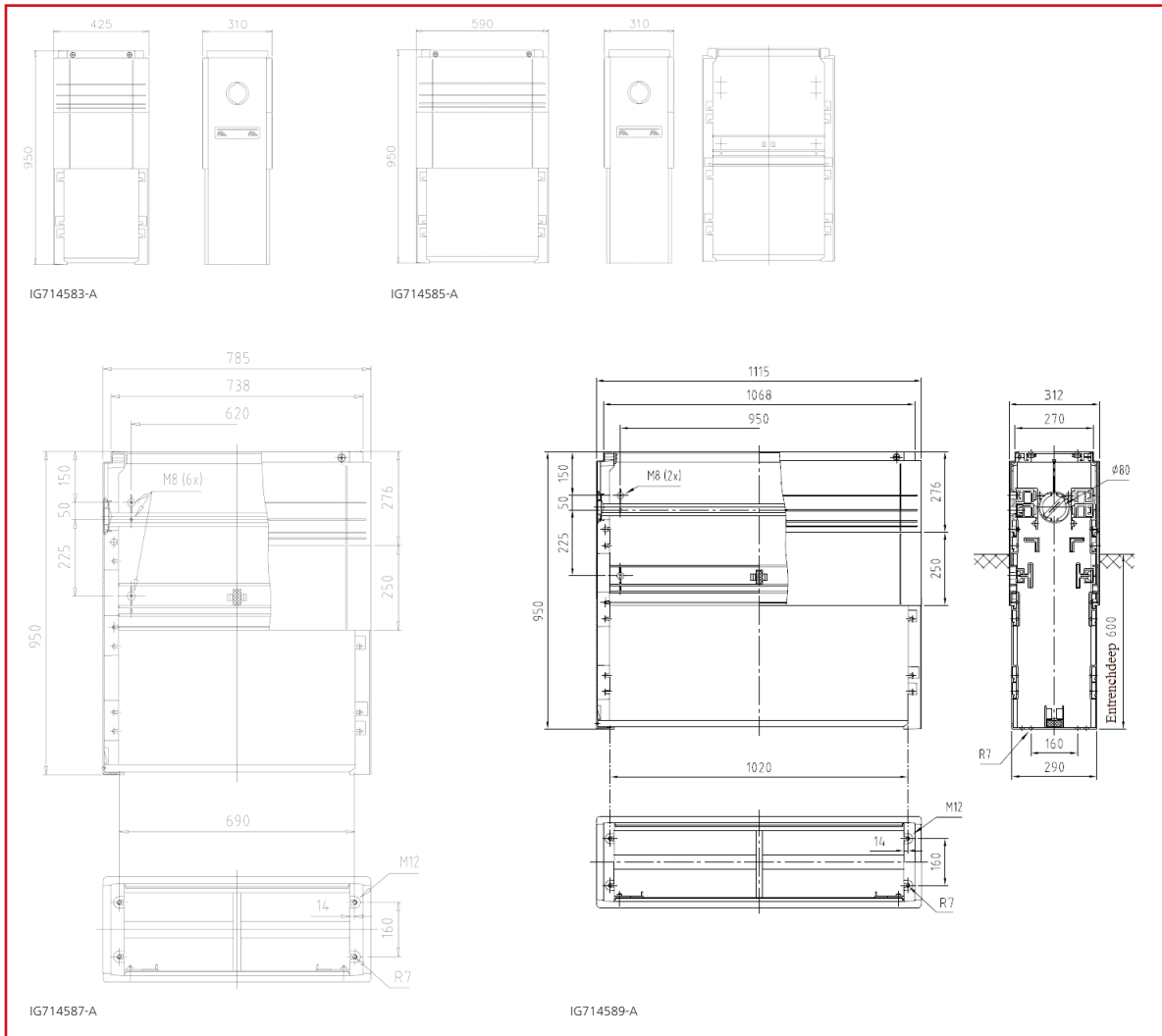

DESCRIPTION	HxWxD (mm)	ORDER NO.
Plastic base sz. 00 RAL7032	950x425x310	IG714583-A
Plastic base sz. 0 RAL7032	950x590x310	IG714585-A
Plastic base sz. 1 RAL7032	950x785x312	IG714587-A
Plastic base sz. 2 RAL7032	950x1115x312	IG714589-A

ADAPTER BARS

DESCRIPTION	PU	ORDER NO.
Adapter bar f. CDE - IG009201 Sz.00	1	IL900461
Adapter bar f. CDE - IG009202 Sz.0	1	IL900462
Adapter bar f. CDE - IG009203 Sz.1	1	IL900463
Adapter bar f. CDE - IG009204 Sz.2	1	IL900464