

## Earthing Connection



WSTCUF260



Mounting Example

## Schrack-Info

- Earthing connection between corpus and door
- Bare knitted earthing cable
- Length: 260 mm
- Material: Copper and tin
- PU: 1 piece

DESCRIPTION	AVAILABLE	ORDER NO.
Knitted earthing cable 260 mm long, blank		<b>WSTCUF260</b>

## Wall-Mounting Brackets



WSTWB004

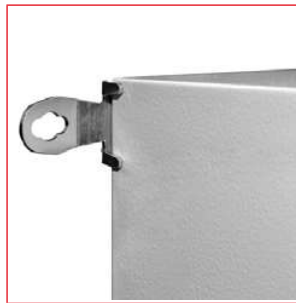

Mounting Example

## Schrack-Info

- Wall-mounting brackets for easy and fast mounting of WST enclosures, alternatively to the rear panel mounting
- For enclosures up to and including 800 mm height, the mounting kit **WSTWB004** is required, from a height of 1000 mm you have to use the mounting kit **WSTWB006**
- The four 8.5 mm diameter wall-mounting holes are arranged in the corners of the rear panel and the two additional holes are placed centrally at a height of 1000 mm, all at the edge distance of 20 mm
- The wall-mounting brackets can be mounted horizontally or vertically at the enclosure corners (see dimension drawing below)
- These brackets can be used in combination with the rain hoods WSTD...
- VE: 4 pieces (WSTWB004) respectively 6 pieces (WSTWB006) of wall-mounting brackets with gaskets and mounting material

## Dimensions Wall-Mounting Brackets WST

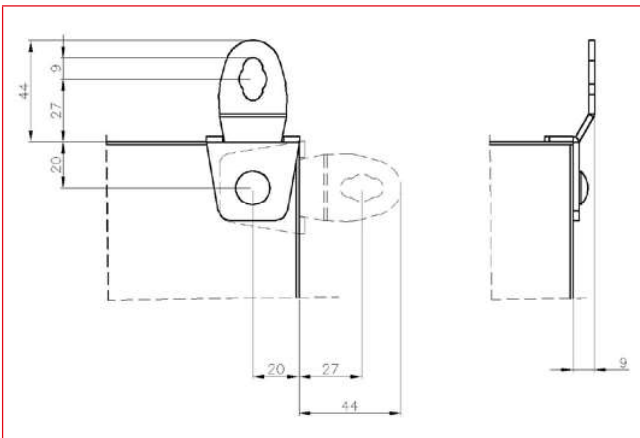

DESCRIPTION	AVAILABLE	ORDER NO.
Wall-mounting brackets for WST enclosures up to H=800 mm, PU=4 pcs.		<b>WSTWB004</b>
Wall-mounting brackets for WST enclosures from H=1000 mm and higher, PU=6 pcs.		<b>WSTWB006</b>