

| ITEM | DESCRIPTION | CHARACTERISTICS               | COLOR |
|------|-------------|-------------------------------|-------|
| 1    | CONNECTOR   | TYPE 2 - 32A AC SINGLE-PHASE  |       |
| 2    | PLUG        | TYPE 2 - 32A AC SINGLE-PHASE  |       |
| 3    | CABLE       | 3G6+1x0,5 EN50620-2017 SPIRAL | BLACK |

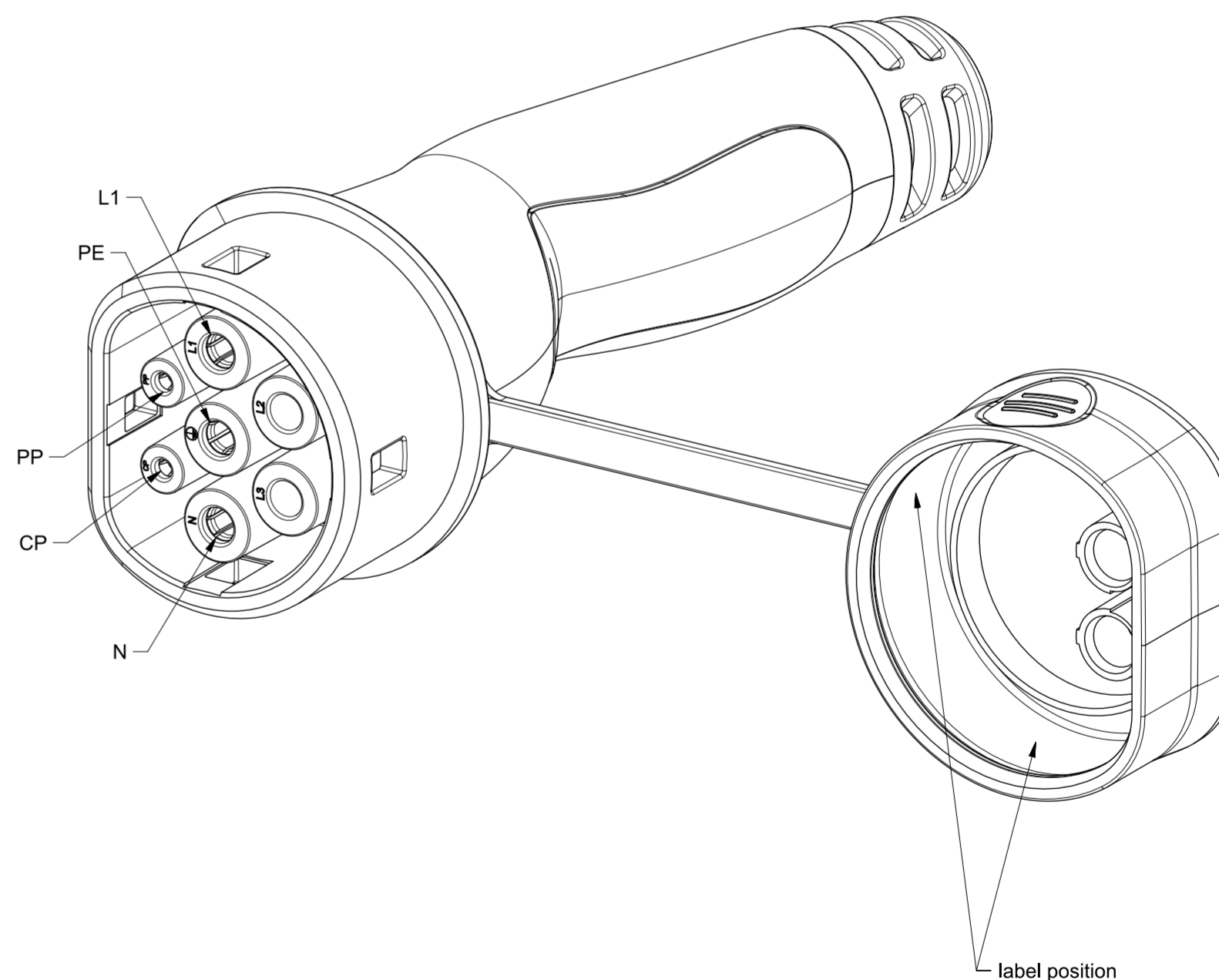
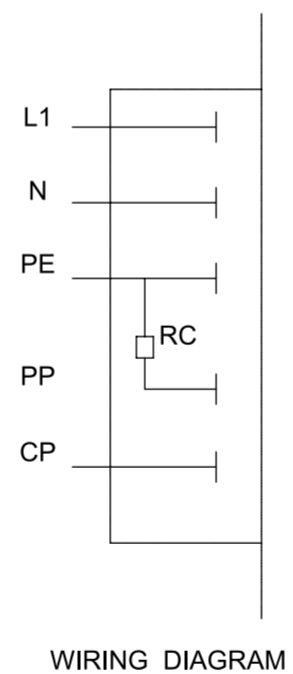

| PART NUMBER   | A (m) working length | B (m) line length |
|---------------|----------------------|-------------------|
| 201.CS2323-4S | 4 (0 ; 0,1)          | 6,5 ± 0,01        |

Via Costa Erika 15 - 24020 Parre (BG) ITALY
   
 XXXXXXXXXXXXXXXXXXXX
   
 XXXXXXXX
   
 201.XXXXXXXXXX

General data

201.XXXXXXXXXX
   
 ???????
   
 Year: xxxx

Batch data

|  |   |    |       |     |          |         |       |             |  |
|--|---|----|-------|-----|----------|---------|-------|-------------|--|
| Under the terms of the law we reserve the ownership of this design may not be copied and transfer it to third parties or competitors<br><br>S.p.A. PARRE - (Bergamo) | Format  | A2 | Scale | 1:1 | Mould N° |         | Drawn | SCAME       |  |
|  | Tolerances for linear and angular dimensions without indication of specific tolerances: JS13 / UNI 286-1:2010 |    |       |     |          |         |       | Date        |  |
|  | DESCRIPTION   |    |       |     |          |         | CODE  | Sheet 1 / 1 |  |
| CORD-SET PLUG-CONNECTOR T2 32A 1P 4M SPIR  |   |    |       |     |          | 4013647 |       |             |  |