



IP65 range of watertight enclosures from 4 to 72M with smoked transparent door. The main technical features are: reversible front and back panel, removable frames and panels with windows and detachable doors with up to 180° opening and lock accessory. The enclosures can be equipped with bipolar and unipolar terminal blocks, 80 A and 125 A, with screw wiring; they allow to create simple and neat wiring reducing the set-up time of the enclosure.

| | | | |
|----------------------------|--|-----------------------|--|
| Clasă izolație | II (conform standardelor IEC 61140) | Culoare | Gri RAL 7035 |
| Dim. exterioare LxHxP (mm) | 143x210x100 | Clasă de protecție IP | IP65 |
| Putere disipabilă (W) | 13 | Cod IK | IK09 |
| Tensiune nominală | 400 V | Nr. module EN 50022 | 4 |
| Curent nominal | 125 A | Glow Test conductori | 650 °C |
| Temperatură de operare | -25 +60 °C | Tensiune de izolare | 1000 V |
| Tip de material | Fără halogen conform EN 60754-2 | Electrocod | 0321 |
| Termo-presiune cu bilă | 70 °C | Standard | EN 60670-1 (CEI 23-48) IEC60670-24 CEI 23-49 |
| Tensiune izolație | 1000 V conform EN 62208 atât în AC, cât și în DC | | |



DIMENSIONAL

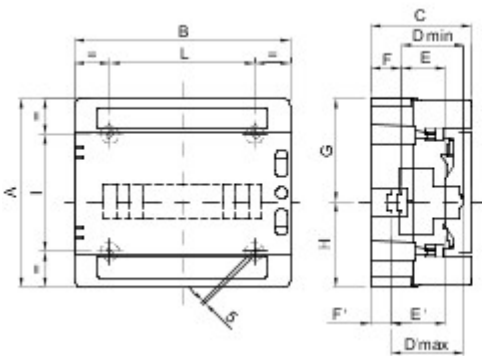

| | A | B | C | Dmin | E | F | G | H | Dmax | E' | F' | NR | I | L |
|-------------|-----|-----|-----|------|----|----|-----|-----|------|----|----|----|-----|----|
| 4M GW40 101 | 210 | 143 | 100 | 75 | 48 | 15 | 105 | 105 | | | | 3 | 156 | 67 |

TECHNICAL SYMBOLOGY

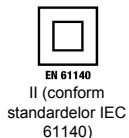

IP
IP65

IK
IK09

GWT
650 °C



HF
HALOGEN FREE
Fără halogen conform EN 60754-2

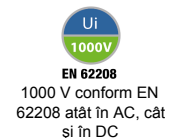
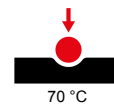

STANDARDS/APPROVALS

